

PLTLABS™

Wearable Concept 2

Wireless Headset System
(WC2)

User Guide

Contents

Welcome	3
Featured highlights	3
What's in the box	4
Overview	5
Headset	5
Bluetooth USB Adapter	5
The Basics	6
Call Controls	6
Mute	7
Adjust the volume	7
Use Smart Sensors	7
Play or pause streaming audio	7
Pair phone or tablet	8
Features	9
Listen to Audio via A2DP	9
Transmission Range	9
Simultaneous Call Handling Behavior (PC Mobile)	9
Voice alerts	9
Voice alerts list	9
Voice commands	10
Voice commands list	10
Fit	11
Change the eartip	11
Wear on the left or right	11
Charge	12
USB cable to PC or USB wall charger	12
Charge case to PC or USB wall charger	12
Charge stand to PC or USB wall charger	13
Low Battery Warnings	14
Pairing your Bluetooth USB Adapter	15
Initial Pairing	15
Re-Pair USB Adapter to headset	15
Auto Connect	15
Connect PC and Call	16

Welcome

Congratulations on receiving your new PLT Labs Wearable Concept 2 wireless headset system. This user guide contains instructions for setting up and using your Wearable Concept 2 Bluetooth Headset and BT600 Bluetooth USB Adapter.

Featured highlights

- Auto Answer calls by placing headset on your ear.
- Auto transfers calls between mobile phone and headset.
- When on a mobile or PC call, softphone presence is automatically updated.
- Eliminates accidental dialing by locking call button when headset is not worn.
- Features wideband audio for best audio quality.
- Integrated A2DP (Advanced Audio Distribution Profile for Bluetooth) lets you listen to music, driving directions, podcasts and more from your mobile phone.
- Automatically connects headset to PC and mobile phone when headset is within range and powered on.
- Voice prompts announce power on/off, talk time, connection status and the name of incoming callers (mobile phone only).
- Use Voice Commands to pair, answer or ignore incoming mobile calls, and more. Refer to the developer guide for additional sensor functionality: pltlabs.com/wc2
- Magnetic snap-fit charging for easy charging anywhere.
- Customize settings using MyHeadset Updater.

What's in the box



Wearable Concept 2 Bluetooth Headset

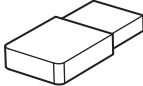

BT600 Bluetooth USB Adapter



Portable charge case

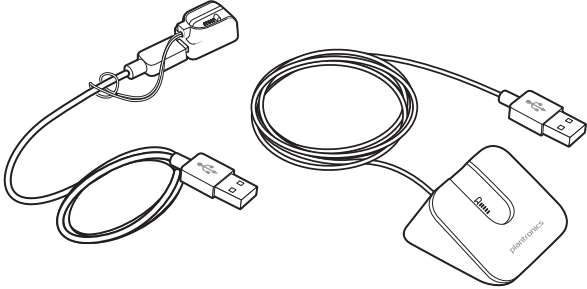

Micro USB charge cable with headset charge adapter

Desktop charge stand

Overview

Headset

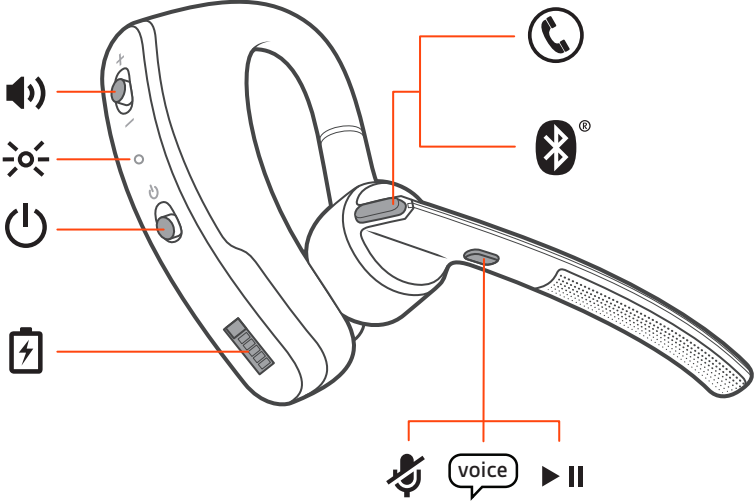

☎ Call button

🔊 Volume button

☀ Indicator light (LED)

⏻ Power button

🔋 Snap-fit magnetic charge connection

🔇 Mute button

🗨 Voice button

▶⏸ Play/Pause button

Bluetooth USB Adapter

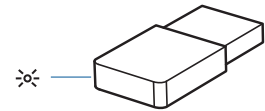

☀ Indicator light (LED)

The Basics

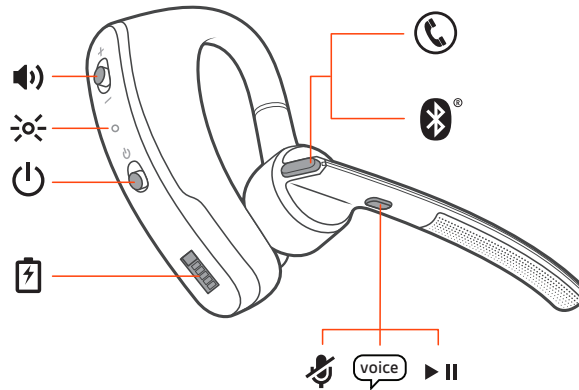

Call Controls

Answer a call

Choose:

- Tap the Call button ☎
- Put headset on (Smart Sensor)
- Say "answer" when prompted (mobile phone only)

Answer a second call

Choose:

- Tap the Call button ☎ to end current call, then tap the Call button ☎ again to answer the second call.
- Or, for mobile calls, tap the Call button ☎ once to end current call, then say "answer" when prompted to answer the second call.

End a call

Tap the Call button ☎ to end current call.

Reject a call

Choose:

- Press Call button ☎ for 2 seconds
- Say "ignore" when prompted (mobile phone only)

Call back last call

Double-tap the Call button ☎ to call back the last active call regardless of whether it was an inbound or an outbound call.

NOTE *If no calls have been made or received in the current connected session this feature will not function. Double-tapping the Call button ☎ will result in a single low tone for each button press; however will not connect you to the last active call from the previous session.*

Voice dial (mobile phone)

Press the Call button ☎ for 2 seconds, this will invoke the mobile phone's voice dial command feature.

Activate Siri (iPhone only)

Press the Call button ☎ for 2 seconds, this will engage Siri® on your iPhone.

Caller Announcement (mobile phone only)

When wearing your headset, you will hear the name of a contact calling you so you can decide whether to answer or ignore the call without having to check the phone screen.

An incoming caller name is announced:

- if your phone supports Phone Book Access Profile (PBAP)
- if you granted access to your contacts during pairing process (for many mobile phones this is preset out-of-the box and may not be necessary)
- if the caller is stored in the phone's contacts list

An incoming caller name is not announced: if the caller is unknown, unlisted, or blocked

You can mute the microphone during a conversation.



Mute

1 **Mute on:** During a call, tap the Mute  button, you will hear the "mute on" voice prompt. The mute reminder is repeated every 15 minutes alternating between the voice prompt and a tone.

2 **Mute off:** During a call, tap the Mute  button, you will hear "mute off".

NOTE *The mute off voice prompt and mute reminder timing can be customized in MyHeadset Updater. plantronics.com/myheadset*

Adjust the volume

Toggle the Volume button  up (+) or down (–) during a call or while streaming audio. While not on a call or streaming audio you can toggle the Volume button  to adjust the volume level for Caller Announce and other voice prompts.

Use Smart Sensors

Smart Sensors™ in this headset recognize if the headset is being worn and can automatically perform time-saving functions. Refer to the developer guide for additional functionality: pltlabs.com/wc2

Putting on your headset will:

- Answer an incoming call
- Transfer an active call from your phone
- Resume streaming audio

Taking off your headset will:

- Transfer an active call to your phone handset
- Pause streaming audio
- Lock the Call button to avoid accidental calls

Play or pause streaming audio

A 2-second press of the Play/Pause button  will either pause or resume playback of streaming audio.



NOTE *You must pause your streaming audio before*

- *use your headset's voice commands*
- *initiate an outbound call with your headset (call back or voice dial)*

NOTE *If you power off the headset or go out of phone range while streaming audio, your headset will not play/pause the stream upon reconnecting until you manually resume streaming with your phone.*

Pair phone or tablet

Pair your headset to your phone or another device, such as a tablet.

- 1 Switch on your headset then choose:
 - Tap the Voice button  and say "Pair mode," or
 - Press and hold the Call button  until you hear "Pairing"
- 2 While the headset LED is flashing red and blue, activate Bluetooth® on your phone and set it to search for new devices.
- 3 Select "Wearable_Concept_2."



- 4 If your phone asks for a passcode, enter four zeros (0000) for the passcode or accept the connection.

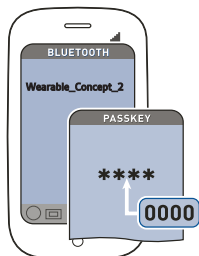

- 5 Once successfully paired, LED stops flashing red and blue and you hear "pairing successful."
NOTE To enable caller name announcement, allow access to your contacts if your phone prompts you.

Features

Listen to Audio via A2DP

Your Wearable Concept 2 headset can play media files (music, podcasts, navigation, etc.) from any A2DP (Advanced Audio Distribution Profile for Bluetooth)-enabled mobile device.

Transmission Range

Your Wearable Concept 2 Bluetooth headset has a 10 meter effective range. Voice prompts from your headset will alert you if you lose connection with your mobile phone or PC Bluetooth Adapter.

Simultaneous Call Handling Behavior (PC Mobile)

You can be on a call using a computer softphone application and receive a mobile phone call. The ringtone for the mobile phone call is heard in the headset. Tapping the call button on the headset will end the computer softphone call. Tapping the call button again will answer the mobile phone call.

NOTE *Answering the call on your mobile phone sends the audio to the mobile phone and leaves the computer softphone call active on the headset.*

You can be on a mobile phone and receive a call on your computer softphone. The ringtone for the computer softphone call is heard in headset during the call.

Tapping the call button on the headset ends the mobile phone call. Tapping the call button again answers the computer softphone call.

If you receive a computer softphone call and mobile call at the same time, tapping the call button will pick up the call that came in first.

Voice prompts

Your headset tells you about status changes with a U.S. English accent.

Basic voice prompts list

- "Power on/off"
- "Answering call"
- "Talk-time (x) hours"
- "Battery low"
- "Recharge headset"
- "Lost connection"
- "PC connected"/"PC disconnected"
- "Phone 1 connected/Phone 2 connected"
- "Pairing"
- "Pairing successful"
- "Pairing incomplete, restart headset"
- "Mute on/off"
- "Volume maximum/minimum"
- "Voice recognition on/off"
- "Calling back last number"

Refer to the developer guide for a complete list of advanced prompts: pltlabs.com/wc2

Basic Voice commands

Tap the Voice button , wait for command request, then say a command.

Basic Voice commands list

- distance
- what time is it
- pair mode
- talk to cortana
- launch it
- redial
- voice memo
- secure
- talk to siri
- step count
- unlock
- talk to google
- help me
- hello plantronics
- no
- yes
- answer
- ignore

NOTE *The voice-dial feature on your phone is initiated by pressing the Call button  for 2 seconds. The voice-dial feature is not a headset voice command.*

Fit

Change the eartip

Change the eartip for a better fit.

- 1 Push in eartip and rotate to the left to unlock it.

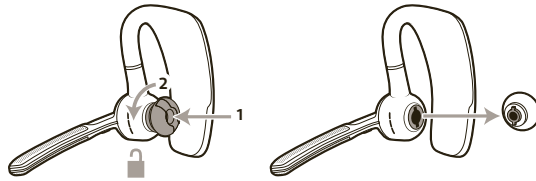

- 2 Align new eartip into slot.

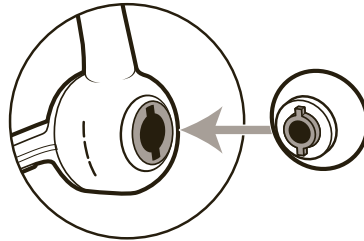

- 3 Push and rotate it to the right to lock it into place.

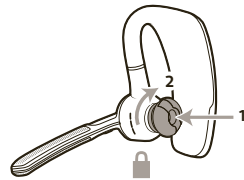

Wear on the left or right

To wear the headset on your other ear, rotate the boom upwards then twist it around so the eartip is on the other side before lowering the boom.

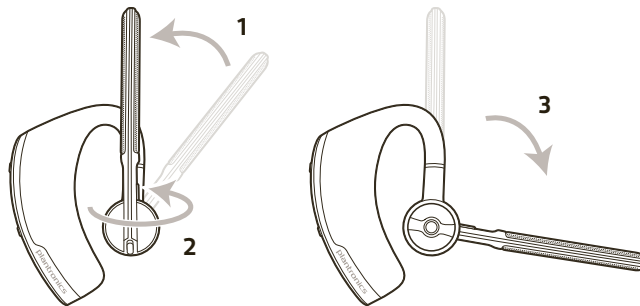

Charge

There are three ways to charge your headset. Your new headset has enough power to pair and make a few calls before charging is needed, though you may charge it at any time.

NOTE Always charge at near room temperatures; never charge battery at temperatures below 0°C (32°F) or above 40°C (104°F).

- 1 Align snap-fit magnetic areas of headset and charging device.
- 2 Attach charging device to USB wall charger or laptop. LED turns off once fully charged. A full charge will take 90 minutes. You may leave your headset connected to the charger once charging is complete without harming the battery. A full charge on the headset battery gives 2.5 hours of talk time.

USB cable to PC or USB wall charger

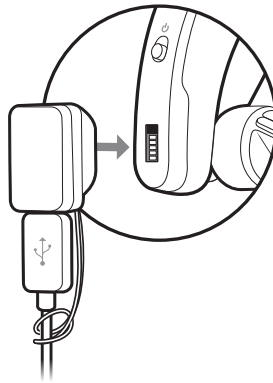



Charge case to PC or USB wall charger

Charge the case for 90 minutes before docking your headset. Once the case is fully charged, it can recharge your headset twice while on the go before needing connection to a charge cable providing up to 5 hours of talk time.



Understand the charge case lights

The indicator lights flash battery status for the charging case  and the headset .

- 3 red flashes = battery critical
- 2 red flashes = battery low
- 2 blue flashes = battery medium
- 3 blue flashes = battery full

The case indicator lights flash when:

- the headset is docked/undocked
- the case is connected/disconnected
- the battery status button is pressed

Test battery status

Press the battery status button  to see the battery status of the charging case or the headset.

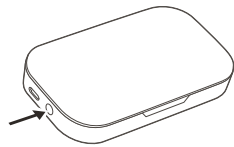

Charge stand to PC or USB wall charger

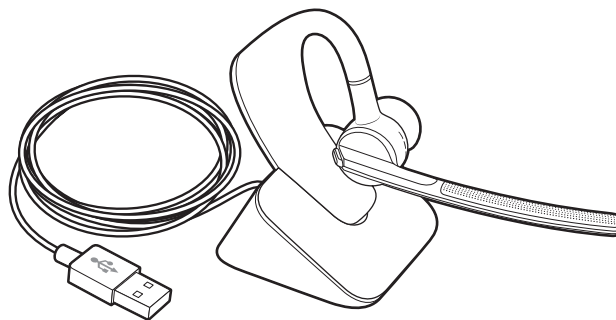

Low Battery Warnings

Battery Level	Tone	Voice Prompt
30 minutes of talk time remaining (this alert only occurs during an active call)	Double high tone every 15 minutes	"Battery Low" repeats every 30 minutes
10 minutes of talk time remaining	Triple high tone every 30 seconds	"Recharge Headset" every 3 minutes

Pairing your Bluetooth USB Adapter

Initial Pairing



Your Bluetooth USB adapter comes pre-paired to your Wearable Concept 2 headset.

Re-Pair USB Adapter to headset

In the event that your headset and Bluetooth USB adapter are not paired or become unpaired do the following:

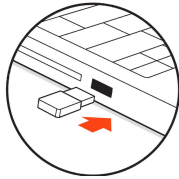
- 1 Remove the Bluetooth USB adapter.



- 2 Power on your headset then choose one of the following steps:
 - Tap the Voice button  and say "Pair Mode."
 - Press and hold the Call button  until you hear "Pairing."
- 3 Insert Bluetooth USB adapter directly into your PC USB port. Once successfully paired, headset LED stops flashing red and blue and you hear "PC connected."

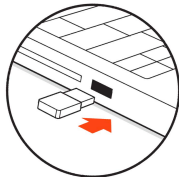

- 4 Headset will exit pairing mode.

Auto Connect

Your headset will automatically connect to paired devices such as your mobile phone and Bluetooth USB Adapter when the headset is on and within range. Voice prompts will also prompt you when you are out of range of devices.

Connect PC and Call

- 1 Power headset on.
- 2 Insert Bluetooth USB adapter directly into your PC USB port. The LED will flash and then turn solid blue to indicate the headset is connected to the USB adapter. The LED remains solid blue when not on an active call.

NOTE Insert your Bluetooth USB Adapter directly to your laptop or PC instead of connecting to a USB port on the docking station or hub.

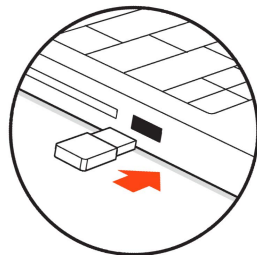

- 3 Load Plantronics Hub software by visiting plantronics.com/software and click on the "Download" button.

NOTE Hub software allows you to customize your headset's behavior through advanced settings and options.

- 4 Check your Audio Settings.

Confirm the speaker and microphone settings for your PC softphone are set to Plantronics BT600.

PC Audio Setup for Windows 7 and Windows 8

Go to Control Panel -> Sound-> Playback tab, and set the Plantronics BT600 device as the Default Communications Device. Next go to the Recording tab and set Plantronics BT600 as the Default Recording Device. If you plan to listen to streaming audio set the Plantronics BT600 device as the Default Audio Device as well. In the Playback tab, this is indicated by the green checkmark.

PC Audio Setup for Windows XP

Go to Control Panel -> Sounds and Audio Devices, and in the Audio tab set the Plantronics BT600 as the default device for the Sound playback and Sound recording sections.

- 5 Place a call from your computer softphone. During an active call, the Bluetooth USB adapter will flash blue.

Bluetooth USB Adapter LED indicators

Headset powered off	None
Paired/connected	Solid blue
Active call or audio	Flashing blue

NEED MORE HELP?

<http://developer.plantronics.com>

PLTLABS™

Plantronics, Inc.

345 Encinal Street
Santa Cruz, CA 95060
United States

Plantronics BV

South Point Building C
Scorpius 140
2132 LR Hoofddorp, Netherlands

© 2015 Plantronics, Inc. PLT Labs is a trademark of Plantronics, Inc. registered in the US and other countries. Bluetooth is owned by Bluetooth SIG Inc., and any use by Plantronics, Inc. is under license.

Patents: US 8,208,673; 8,504,629; 8,805,992; D617,316; D681,002; D681,003; D681,014; CN ZL201230489876.9; EM 002109637; and TW D159650; D159651; D162314.

xxxxxx-xx 10.15 Rev10