

First-time pairing

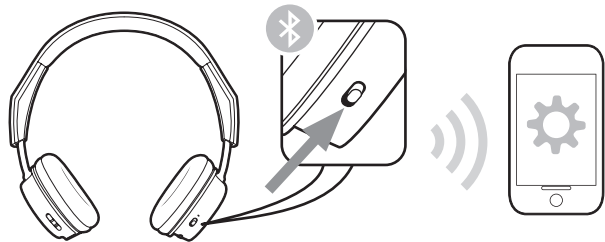

PLT BB500 Series

plantronics®

QUICK START

BackBeat 500 SERIES

Designed in Santa Cruz, California

Support and software

plantronics.com/setup/backbeat-500



© 2015 Plantronics, Inc. Plantronics is a trademark of Plantronics, Inc. registered in the US other countries. Bluetooth is a registered trademark of Bluetooth SIG, Inc. and any use by Plantronics, Inc. is under license. All other trademarks are the property of their respective owners. Patents pending. XXXXXX-XX 00.16 Model ID: S5XX17