

Helmet Mounted Wireless Headset

Reference Guide



NYSNO-10

©2017 Sony Corporation Printed in Malaysia

About the manual

The following three types of manuals are available:

Operating Instructions



Reference Guide (this manual)



Help Guide (web manual)



For details on how to operate or troubleshoot this unit, refer to the Help Guide.

You can read this manual on your computer or smartphone.

URL:

<http://rd1.sony.net/help/nysno/nysno10/en/>

Two-dimensional code:



Warning

To reduce the risk of fire, burns or bursting, do not open, crash, short, heat 60 °C (140 °F) or above, or incinerate.

This device complies with Part 15 of the FCC Rules. Operation is subject to the following two conditions: (1) this device may not cause harmful interference, and (2) this device must accept any interference received, including interference that may cause undesired operation.

You are cautioned that any changes or modifications not expressly approved in this manual could void your authority to operate this equipment.

This equipment must not be co-located or operated in conjunction with any other antenna or transmitter.

Note

This equipment has been tested and found to comply with the limits for a Class B digital device, pursuant to Part 15 of the FCC Rules. These limits are designed to provide reasonable protection against harmful interference in a residential installation. This equipment generates, uses and can radiate radio frequency energy and, if not installed and used in accordance with the instructions, may cause harmful interference to radio communications. However, there is no guarantee that interference will not occur in a particular installation. If this equipment does cause harmful interference to radio or television reception, which can be determined by turning the equipment off and on, the user is encouraged to try to correct the interference by one or more of the following measures:

- Reorient or relocate the receiving antenna.
- Increase the separation between the equipment and receiver.
- Connect the equipment into an outlet on a circuit different from that to which the receiver is connected.
- Consult the dealer or an experienced radio/TV technician for help.

The available scientific evidence does not show that any health problems are associated with using low power wireless devices.

There is no proof, however, that these low power wireless devices are absolutely safe.

Low power Wireless devices emit low levels of radio frequency energy (RF) in the microwave range while being used.

Whereas high levels of RF can produce health effects (by heating tissue), exposure of low-level RF that does not produce heating effects causes no known adverse health effects.

Many studies of low level RF exposures have not found any biological effects. Some studies have suggested that some biological effects might occur, but such findings have not been confirmed by additional research.

The model has been tested and found to comply with FCC radiation exposure limits set forth for an uncontrolled environment and meets the FCC radio frequency (RF) Exposure Guidelines.

Notes on water resistant and dust proof features (Read before using NYSNO-10)

Water resistant and dust proof performance

The main unit and the remote control have a water resistant specification of IPX5¹ as specified in "Degree of protection against water immersion" of the IEC60529 "Ingress Protection Rating (IP Code)", and a dust proof specification of IP6X² as specified in "Degrees of protection against solid foreign objects."

Liquids that the water resistant performance specifications apply to

Applicable:	fresh water, tap water, perspiration
Not applicable:	liquids other than the above (soapy water, water with detergent or bath agents, shampoo, hot spring water, pool water, sea water, etc.)

¹ IPX5 equivalency: The main unit, with the micro-USB port cover closed, has been tested under and maintains its operability under the following test conditions: When exposed to direct streams of water from any direction where approximately 12.5 L / min. of water is supplied for more than 3 minutes from a distance of approximately 3 m (9 ft 10 5/8 in) using a nozzle with an inner diameter of 6.3 mm (1/4 in).

² IP6X equivalency: The main unit, with the micro-USB port cover closed, has been tested to and continues to block dust after stirring for 8 hours in a testing device which contains dust particles that are up to 75 µm in diameter.

The water resistant and dust proof performance of NYSNO-10 is based on our measurements under the conditions herein described. Note that malfunctions as a result of water immersion or dust intrusion caused by misuse by the customer are not covered by the warranty.

To avoid deterioration of water resistant and dust proof performance

- Check the following and use NYSNO-10 correctly. Do not use and leave NYSNO-10 in a location where temperature is very high (approx. 41 °C (105.8 °F) or above) and low (approx. -11 °C (12.2 °F) or below). Use or leave of NYSNO-10 in a location where is out of the range above, the operation may stop automatically to protect internal circuit.
- NYSNO-10 passes the drop test from 1.2 m (3 ft 11 1/4 in) on plywood of 5 cm (2 in) thickness conforming to MIL-STD 810 F Method 516.5-Shock. However, this does not guarantee no damage, no breakdown, or water resistant and dust proof performance in all conditions. Deformation or damage from dropping NYSNO-10 or subjecting it to mechanical shock may cause deterioration of the water resistant and dust proof performance.
- Do not use NYSNO-10 in a location where water or hot water may splash on it heavily. NYSNO-10 does not have a design that is resistant to water pressure. Use it in a location where high water pressure is applied, such as under running water or in the shower, may cause a malfunction.
- Do not pour high-temperature water or blow hot air from a hair dryer or any other appliance on NYSNO-10 directly. Also, never use it in high temperature locations such as in saunas or near a stove.
- To prevent foreign objects from attaching the main unit on the port part, make sure that the micro-USB port cover is closed completely when not used.

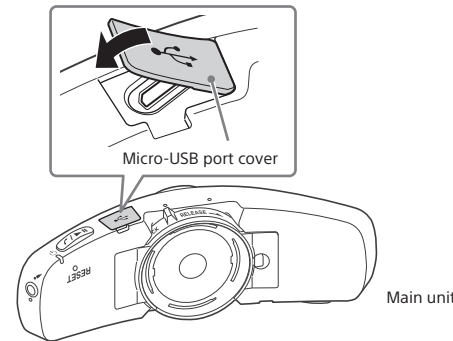

How to care

- If you leave the main unit wet, it may develop scales, molds, etc. We recommend that you wipe off water droplets after use and dry it in a well-ventilated place until moisture disappears.
- Especially in cold regions, be sure to wipe off the moisture after use. Leaving moisture on its surface may cause the main unit to freeze and malfunction.
- If sand grains, etc. enter the adhesive mount attaching part, remove them carefully.

Trademarks

- The Bluetooth® word mark and logos are registered trademarks owned by the Bluetooth SIG, Inc. and any use of such marks by Sony Corporation is under license.
- The N-Mark is a trademark or registered trademark of NFC Forum, Inc. in the United States and in other countries.
- Microsoft, Windows and Windows vista are registered trademarks or trademarks of Microsoft Corporation in the United States and/or other countries.
- Mac and Mac OS are trademarks of Apple Inc., registered in the U.S. and other countries.
- iPad, iPhone and iPod touch are trademarks of Apple Inc., registered in the U.S. and other countries.
- Android is trademark of Google Inc.
- Other trademarks and trade names are those of their respective owners.

Precautions

On BLUETOOTH® communications

- Bluetooth wireless technology operates within a range of about 10 m (30 feet)¹⁾. Maximum communication range may vary depending on obstacles (human body, metal, wall, etc.) or electromagnetic environment.
- ¹⁾ Approx. 1 km (0.62 miles) for Group Talk.
- The antennas are built into the main unit and the remote control as illustrated in the dotted line. The sensitivity of the Bluetooth communications will improve by turning the direction of the built-in antenna of the main unit to the connected Bluetooth device. When obstacles are between the antenna of the connected device and the built-in antennas of the main unit and the remote control, noise or audio dropout may occur, or communications may be disabled.

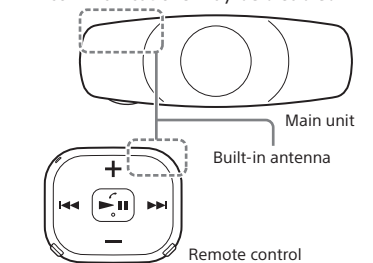

- Bluetooth communications may be disabled, or noise or audio dropout may occur under the following conditions.

- There is a human body between the main unit and the Bluetooth device.

This situation may be improved by placing the Bluetooth device facing the antenna of the main unit.

- There is an obstacle, such as metal or wall, between the main unit and the Bluetooth device.

- A device using 2.4 GHz frequency, such as a Wi-Fi device, cordless telephone, or microwave oven, is in use near the main unit.

• Because Bluetooth devices and Wi-Fi (IEEE802.11b/g/n) use the same frequency (2.4 GHz), microwave interference may occur resulting in noise or audio dropout or communications being disabled if the main unit is used near a Wi-Fi device. In such a case, perform the following.

- Use the main unit at least 10 m (30 feet) away from the Wi-Fi device.

- If the main unit is used within 10 m (30 feet) of a Wi-Fi device, turn off the Wi-Fi device.

- Install the main unit and the Bluetooth device as near to each other as possible.

• Microwaves emitting from a Bluetooth device may affect the operation of electronic medical devices. Turn off the main unit and other Bluetooth devices in the following locations, as it may cause an accident:

- where inflammable gas is present, in a hospital, or a petrol station

- near automatic doors or a fire alarm.

• Due to the characteristic of the wireless technology, the sound played on the main unit is delayed from the sound and music played on the sending device.

• NYSNO-10 supports security capabilities that comply with the Bluetooth standard to provide a secure connection when the Bluetooth wireless technology is used, but security may not be enough depending on the setting. Be careful when communicating using Bluetooth wireless technology.

• We do not take any responsibility for the leakage of information during Bluetooth communications.

• Connection with all Bluetooth devices cannot be guaranteed. - A device featuring Bluetooth function is required to conform to the Bluetooth standard specified by Bluetooth SIG, Inc. and be authenticated.

- Even if the connected device conforms to the above mentioned Bluetooth standard, some devices may not be connected or work correctly, depending on the features or specifications of the device.

- While talking on the phone hands free, noise may occur, depending on the device or communication environment.

• Depending on the device to be connected, it may require some time to start communications.

On charging the main unit

• This main unit can be charged using USB only. Personal computer with USB port is required for charging.

• This main unit cannot be turned on, nor can the Bluetooth function be used, during charging.

• If you do not use the main unit for a long time, the rechargeable battery may not be able to keep sufficient charge. The battery will be able to keep a charge properly after repeatedly discharging and charging several times.

• If you store the main unit for a long time, charge the battery once every half year to prevent over-discharge.

• If the length of time you can use the unit became extremely short, the rechargeable battery should be replaced with a new one. Please contact your nearest Sony dealer for a battery replacement.

If NYSNO-10 does not operate properly

• Reset the main unit and the remote control. Press the RESET button with something fine-tipped such as a hairpin until you feel the button. The pairing information and the other settings are retained.

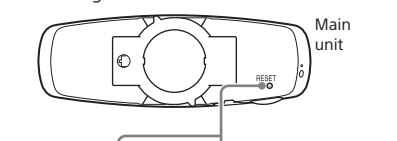

• Microwaves emitting from a Bluetooth device may affect the operation of electronic medical devices. Turn off the main unit and other Bluetooth devices in the following locations, as it may cause an accident:

- where inflammable gas is present, in a hospital, or a petrol station

- near automatic doors or a fire alarm.

• Due to the characteristic of the wireless technology, the sound played on the main unit is delayed from the sound and music played on the sending device.

