

# SONY®

## Video Projector

For Dealers

Pour les revendeurs

Setup Guide

GB

Guide d'installation

FR

**For customers**

Secure installation is required. This unit should only be installed by the dealer to ensure safety and accuracy.

**Pour les clients**

Une installation sûre est nécessaire. Cet appareil ne doit être installé que par le revendeur pour garantir la sécurité et la précision.

LSPX-A1

### Note

When moving the projector, note the following.

- Only lift the projector with four or more people. Firmly grasp the handles located at the bottom of the projector with both hands.
- Do not drag the projector when moving it.
- Do not step on the cables when moving the projector.
- Do not place the projector on top of the cables.
- Be careful not to get caught in the cables.

## 8 Connecting the AC power cord to a power source

Connect the AC power cord to a wall outlet (wall socket).

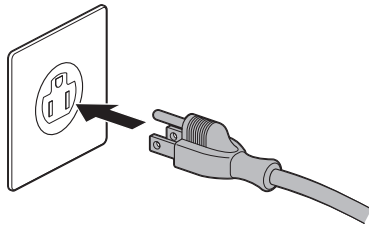

### Note

The type of AC power cord and the shape of the wall outlet (wall socket) depend on the country or region of use.

## 9 Turning the power on

### 1 Insert two size AAA (R03) batteries (supplied) into the remote control.

Push in the button (1) at the bottom of the back of the remote control and lift up the battery cover (2) to remove it. Confirm the **+** and **-** ends of the two size AAA (R03) batteries, and insert them into the remote control in the correct positions.

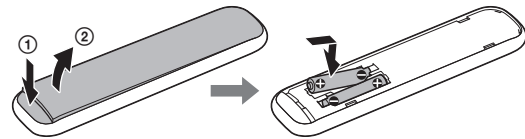

When you close the battery cover, align the projections on the cover with the remote control, and first push in the top part of the cover until it clicks (1). Then, push in the bottom part of the cover (2) while holding the top part of the remote control.

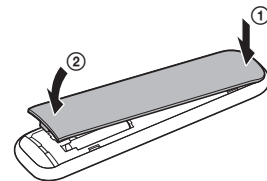



### 2 Press (power) on the remote control to turn the power on.

An image (black) will be projected onto the projection surface.

## 10 Selecting the display language

You can set the language for menu items or messages displayed on the screen from the menu.

Use the control key (up/down/left/right) on the remote control to select a menu item, and press  (enter) to confirm the selection.

Press  (menu) and select  [Setup] – [Language] – desired language setting.

The display language will be set.

To close the menu window, press  (menu) again.