

## SDA-SC510

### Owner's Manual

Thank you for buying this Pioneer product. Please read through these instructions so you will know how to operate your model properly. After you have finished reading the instructions, keep this document in a safe place for future reference. Always read and follow the "Safety Precautions" described in this manual when installing this product in a vehicle. There is a risk of accident and injury if this product is installed using methods other than those described in this manual, or if parts are used other than those described in this manual. Pioneer accepts no responsibility whatsoever in these cases.

Register your product at

<https://www.pioneerelectronics.com>

in Canada

<https://www.pioneerelectronics.ca>

#### PIONEER CORPORATION

28-8, 28-8, Honkomagome 2-chome, Bunkyo-ku, Tokyo 113-0021, JAPAN

#### PIONEER ELECTRONICS (USA) INC.

P.O. Box 1540, Long Beach, California 90801-1540, U.S.A.  
TEL: (800) 421-1404

© 2020-2021 PIONEER CORPORATION.  
< KYT221C > < 10.0105.0677 >

## Precaution

Certain country and state laws may prohibit or restrict the placement and use of this product in your vehicle. Please comply with all applicable laws and regulations regarding the use, installation and operation of this product. It is the user's responsibility to comply with all applicable laws, rules, regulations and ordinances.

- This device complies with part 15 of the FCC Rules. Operation is subject to the following two conditions: (1) This device may not cause harmful interference, and (2) this device must accept any interference received, including interference that may cause undesired operation.
- FCC Radiation Exposure Statement: This equipment complies with FCC radiation exposure limits set forth for an uncontrolled environment and meets the FCC radio frequency (RF) Exposure Guidelines.
- Information to User - Alteration or modifications carried out without appropriate authorization may invalidate the user's right to operate the equipment.
- NOTE: This equipment has been tested and found to comply with the limits for a Class B digital device, pursuant to Part 15 of the FCC Rules. These limits are designed to provide reasonable protection against harmful interference in a residential installation. This equipment generates, uses and can radiate radio frequency energy and, if not installed and used in accordance with the instructions, may cause harmful interference to radio or television reception, which can be determined by turning the equipment off and on, the user is encouraged to try to correct the interference by one or more of the following measures:
  - Reorient or relocate the receiving antenna.
  - Increase the separation between the equipment and receiver.
  - Connect the equipment into an outlet on a circuit different from that to which the receiver is connected.
  - Consult the dealer or an experienced radio/TV technician for help.

FEDERAL COMMUNICATIONS COMMISSION  
SUPPLIER'S DECLARATION OF CONFORMITY  
Product Name: Wireless Charging Cradle  
Model Number: SDA-SC510  
Responsible Party Name: PIONEER ELECTRONICS (USA) INC.  
SERVICE SUPPORT DIVISION  
Address: 2050 W. 190TH STREET, SUITE 100,  
TORRANCE, CA 90504, U.S.A.  
Phone: 1-800-421-1404  
URL: <https://www.pioneerelectronics.com>

#### CAUTION

- The graphical symbol  placed on the product means direct current.

#### After-sales service for Pioneer products

Please contact the authorized Pioneer dealer from which you purchased this unit or an authorized Pioneer service company for after-sales service or questions you may have about the product. You may contact Pioneer directly as follows:

**Do not ship your unit in for repair without contacting Pioneer first. Units sent without a return authorization number will be refused.**

#### USA & CANADA

Pioneer Electronics (USA) Inc.  
CUSTOMER SUPPORT DIVISION  
P.O. Box 1760  
Long Beach, CA 90801-1760 U.S.A.  
800-421-1404

For warranty information, please see the Limited Warranty sheet included with this unit.

#### Visit our website

**U.S.:**  
<https://www.pioneerelectronics.com>  
**Canada:**  
<https://www.pioneerelectronics.ca>

#### If you experience problems

Should this product fail to operate properly, please contact your dealer or nearest authorized Pioneer Service Company.

#### Safety Precautions

Always observe the precautions described here to prevent harm to yourself and others and to prevent damage to property before it happens.

#### Important safeguards

##### WARNING

- Do not install this product where it may
  - obstruct the driver's vision,
  - impair the performance of any of the vehicle's operating systems or safety features, including airbags, indicators (lights) and hazard lamp buttons, or
  - impair the driver's ability to safely operate the vehicle. It is also the driver's responsibility to know and comply with the laws, rules, and regulations of the driving location and not to use the device in any location where its installation or use is prohibited.

- Any obstruction of or other interference with the airbag, either deployed or non-deployed, or with the clear view of the road must be avoided.

#### Important safety information

##### WARNING

- If liquid or foreign matter should get inside this product, park your vehicle in a safe place, turn the ignition switch off (ACC OFF) and unplug the cigarette lighter plug immediately, and consult your dealer or the nearest authorized Pioneer Service Company. Do not use this product in this condition because doing so may result in a fire, electric shock, or other failure.
- If you notice smoke, a strange noise or odor from this product, turn off the power immediately and consult your dealer or the nearest authorized Pioneer Service Company. Using this product in this condition may result in permanent damage.
- Do not disassemble or modify this product, as there are high-voltage components inside which may cause an electric shock. Be sure to consult your dealer or the nearest authorized Pioneer Service Company for internal inspection, adjustments or repairs.

Before using this product, be sure to read and fully understand the following safety information:

- Do not operate this product if doing so will divert your attention in any way from the safe operation of your vehicle. Always observe safe driving rules and follow all existing traffic regulations. If you experience difficulty in operating this product, park your vehicle in a safe location and apply the parking brake before making the necessary adjustments.
- Keep this manual handy as a reference for operating procedures and safety information.
- It is extremely dangerous to allow cables to become wound around the steering column or gearstick. Be sure to install this product, its cables, and wiring in such a way that they will not obstruct or hinder driving.**
- Make sure that the cable will not interfere with or become caught in any of the vehicle's moving parts, especially the steering wheel, gearstick, handbrake, sliding seat tracks, doors, or any of the vehicle's controls.**

#### Precautions before installing

##### WARNING

- Firmly install this product so it does not fall off. If this product is not firmly installed, it may fall off while driving and cause an accident. Periodically inspect this product.
- Do not shorten any cables. If you do, the protection circuit (fuse holder, fuse resistor or filter, etc.) may fail to work properly.
- Never feed power to other electronic products by cutting the insulation of the power supply cable of this product and tapping into the cable. The current capacity of the cable will be exceeded, causing overheating.

#### Precautions before installation

##### CAUTION

Never install this product in places where, or in a manner that:

- Could injure the driver or passengers if the vehicle stops suddenly.
- May interfere with the driver's operation of the vehicle, such as on the floor in front of the driver's seat, or close to the steering wheel or gearstick.
- To ensure proper installation, be sure to use the supplied parts in the manner specified. If any parts are not supplied with this product, use compatible parts in the manner specified after you have the parts' compatibility checked by your dealer. If parts other than supplied or compatible ones are used, they may damage internal parts of this product or they may work loose and the product may become detached.
- Never install this product in front of or next to the place in the dashboard, door, or pillar from which one of your vehicle's airbags would deploy. Please refer to your vehicle's owner's manual for reference to the deployment area of the frontal airbags.
- Consult with your nearest dealer if installation requires drilling holes or other modifications of the vehicle.
- Do not install this product in places subject to high temperatures or humidity, such as:
  - Places that may be exposed to rain.
  - Close to the door or on the vehicle's floor.

#### Precautions for cigarette lighter plug

##### WARNING

- When using a power supply in the vehicle, use the dedicated cigarette lighter plug. Using a plug other than specified may result in fire, electric shock, or product failure.
- Unplug the cigarette plug after using the product and when the product will not be used for a long period of time. Depending on the vehicle, the cigarette socket may not be turned off even when the engine is turned off. For this reason, there is a risk of fire or a dead battery.
- Fully insert the cigarette lighter plug. Poor contact may occur due to vibrations while driving, resulting in an extremely dangerous situation where the unit overheats.
- Regularly inspect and clean the cigarette lighter socket. Foreign material inside the cigarette lighter socket, such as ashes, may cause heat generation due to poor contact, resulting in fire or electric shock.

#### When Using Wireless Charger

##### WARNING

- Do not affix metal objects (such as stickers made of material containing metal) to the wireless charger or compatible device. A fire, burn, or injury may occur.
- Do not place metal objects (such as a strap or clip made of material containing metal) between the

wireless charger and compatible device. A fire, burn, or injury may occur.

- Never move a credit card or other magnetic card, magnetic recording media, or other magnetized item near the charging area. Magnetic data may be deleted.
- Never place a watch or other precision device near the charging area as failure may occur.
- Remove any cover or other item attached to the compatible device before charging with the wireless charger.

Normal charging may not be possible and a fire, burn, or injury may occur due to the material or thickness of the cover or other item, or due to dirt or other foreign material trapped between the compatible device and cover.

- Do not place this product in direct sunlight for an extended amount of time, or where it could be exposed to extreme temperatures. Store out of direct sunlight when not in use.

## Usage Precautions

#### Precautions When Handling this Product

- Do not adjust this product while driving.
- Although this device should not interfere with a vehicle's automatic anti-theft system (immobilizer), keyless entry system, or other control equipment or devices, confirm that there are no electromagnetic issues by starting the vehicle or using the keyless entry system, if any. If any malfunctions should occur and the problem is not resolved by moving this device to a different suitable location within the vehicle, stop usage and contact Pioneer or your authorized Pioneer dealer.

#### Conditions Under Which Functions May Not Work Normally

- Normal charging may not be possible under the following conditions.
  - When the device to be charged is already fully charged.
  - When there is foreign material between this product and the device.
  - When the temperature of the device becomes very high.
  - When the device is placed with the front screen facing the charger.
  - When the device and this product's charging area are misaligned.
  - When used in a location where strong radio waves and noise are generated such as a location near a TV antenna, power plant, petrol/gas station, broadcasting station, large display, or airport.
  - When the device is contacting a card with aluminum foil or other metal.
  - When the device to be charged has been covered by a material, such as a smartphone cover, etc., that obstructs or does not transmit electromagnetic waves.
  - When used near a wireless remote control.

## Features

- This product is a wireless charging cradle that uses electromagnetic induction technology.
- You can release the cradle lock with a single touch to remove your smartphone.
- Your smartphone is removable even when the vehicle's engine is off thanks to an electric double-layer capacitor (storage capacitor).
- This product is compliant with the Qi wireless charging standard.
- Any product compliant with Qi can be charged by simply placing it in this product.
- Quick charging can be performed in fast wireless charging mode at 10 W.
  - Can be used by connecting to a USB charger compatible with Qualcomm® Quick Charge™ 2.0 Technology or higher.
  - Smartphones compatible with 5 W or higher wireless charging are supported.
  - Charging at 5 or 7.5 W is possible for iPhone®, and charging at 5, or 10 W depending on the specifications of the smartphone is possible for Android™. (Must be compliant with the Qi standard.)
  - There is no guarantee that charging or quick charging will be possible with all models. (For quick charging, a unique standard may be used depending on the smartphone. In such a case, charging will be limited to a maximum of 5 W.)

## Trademarks & Copyrights

- Qi is a registered trademark of the Wireless Power Consortium.
- Qualcomm Quick Charge is a product of Qualcomm Technologies, Inc. and/or its subsidiaries. Qualcomm and Quick Charge are trademarks or registered trademarks of Qualcomm Incorporated. Permission has been obtained to use all Qualcomm marks.
- Android is a trademark of Google LLC.
- iPhone is a trademark of Apple Inc., registered in the U.S. and other countries.
- USB Type-C® and USB-C® are registered trademarks of USB Implementers Forum.
- Pioneer is a registered trademark of Pioneer Corporation.

## Specifications

### This product

<b>Input</b>	Max. 5 V / 2 A, 9 V / 1.67 A, or 12 V / 1.67 A
<b>Output</b>	Android™ max 10 W, iPhone max 7.5 W / Minimum 5 W
<b>Input port</b>	USB Type-C® female
<b>Frequency Range</b>	110 kHz to 205 kHz
<b>Operating temperature range</b>	-10 °C to +50 °C (14 °F to +122 °F)
<b>Charging efficiency</b>	≥70%
<b>Possible electric power transmission distance</b>	≤6.0 mm
<b>External dimensions (W x H x D)</b>	66.8 mm x 120 mm x 24.5 mm (2-5/8 in. x 4-3/4 in. x 1 in.)
<b>Product weight</b>	Approx. 140 g (5 oz)

### USB charger

<b>Connector</b>	USB A connector female
<b>No. of ports</b>	2
<b>Input</b>	12 V / 24 V DC
<b>Operating temperature range</b>	-10 °C to +50 °C (14 °F to +122 °F)
<b>Output</b>	5 V / 3 A, 9 V / 2A, or 12 V / 1.5 A DC (Quick Charge 3.0 Standard)
<b>Max. output</b>	30 W

## Checking the Contents of the Package

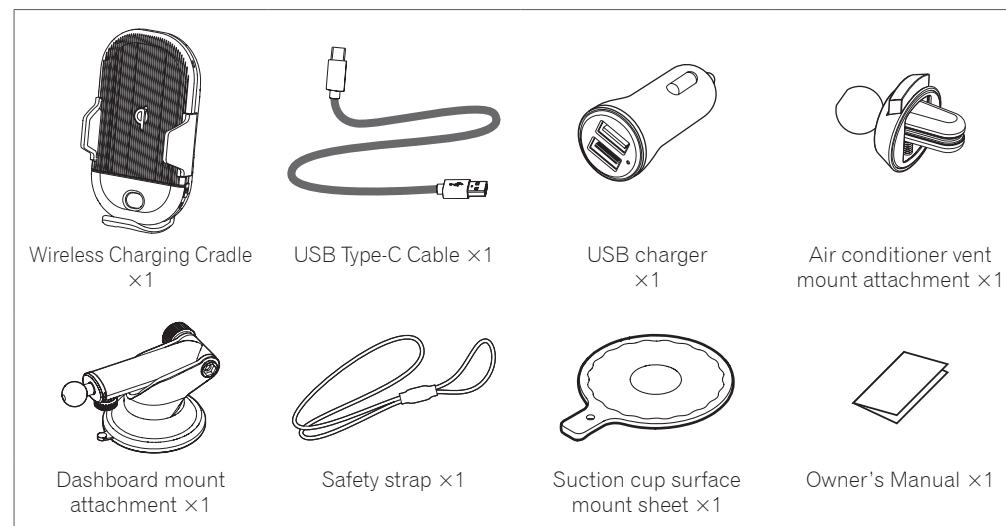

## Part Names

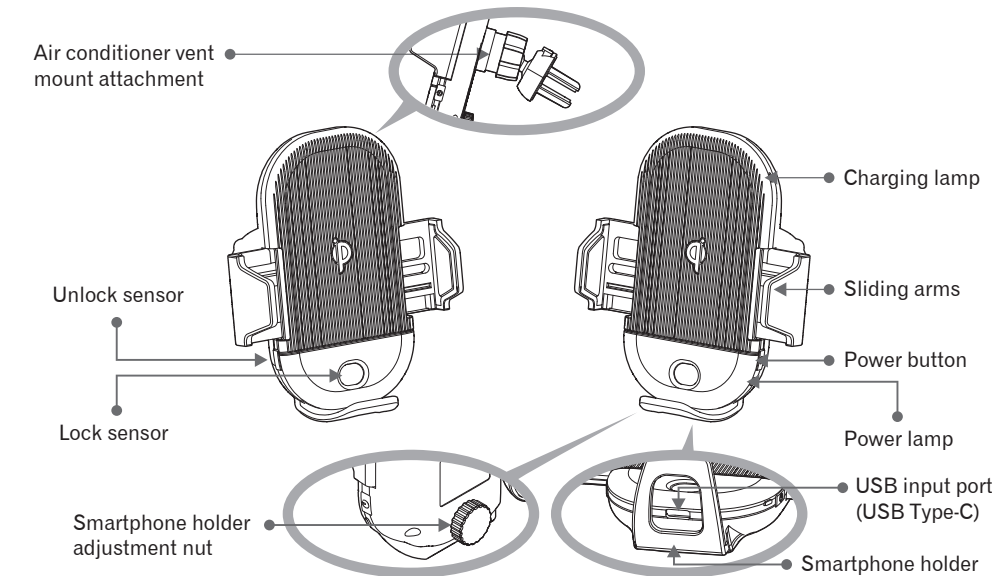

## Before Installing the Product

### ⚠ Precautions for installing this product in the vicinity of the dashboard

- Observe the following points.
- Do not block the view ahead.
  - Do not block the view immediately in the front and at the sides.
  - Do not obstruct air bag system operation.
  - Install where there will be little eye movement for navigation purposes during driving.
  - Do not install in the following locations.
    - \* Front windscreen
    - \* Where rain is likely to get on the product
    - \* Where baggage and other objects will bump into the product
  - Always use the parts supplied with the product as specified. Using other than the specified parts may result in damage to components inside the device or the product falling due to not being firmly secured.

## Installation

This product can be mounted to either an air conditioner vent or the dashboard.

### Mounting to Air Conditioner Vent

#### ⚠ CAUTION

- Some vehicle side vents defrost the side windows, so blocking those vents may decrease visibility in cold locations. Do not mount on a side vent that defrosts the side window.

### 1 Turn the nut counterclockwise and remove it.

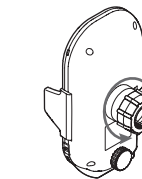

### 2 Assemble the air conditioner vent mount attachment and nut, and insert them into the attachment hole of the product.

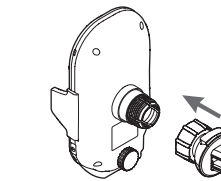

### 3 Fix them in place by turning the nut clockwise.

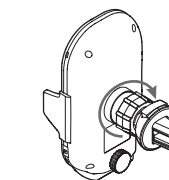

### 4 Insert and fix the clip in an air conditioner vent.

Firmly press the lock button on the air conditioner vent mount attachment to release the lock and then open the air conditioner louvre (slats) and attach the product to the air vent.

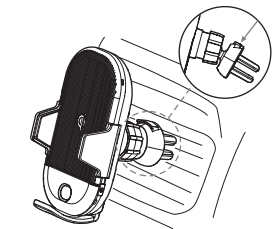

When attaching the product to an air conditioner vent, take care not to damage the air conditioner louvre (slats).

### Removing from Air Conditioner Vent

Firmly press the lock button on the air conditioner vent mount attachment to release the lock and then remove the product from the air vent.

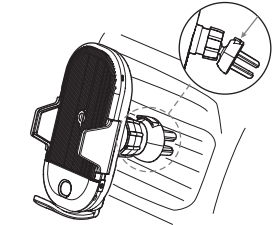

When removing the product from an air conditioner vent, take care not to damage the air conditioner louvre (slats).

# Installation

## Mounting to Dashboard

- Protective film is affixed to the suction surface (back side) of the suction cup. Do not peel off the film until step 10. If the suction surface of the suction cup becomes dirty, the suction power will be reduced and the product may fall.
- Select the following location to install the product. If the product is not installed correctly, it will fall, etc.
  - \* Smooth and level location on the dashboard
  - \* Location where the entire suction surface can be affixed
- Be sure to attach the supplied safety strap to prevent the product from falling.

### 1 Turn the nut counterclockwise and remove it.

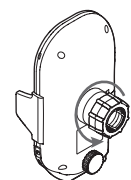

### 2 Assemble the dashboard mount attachment and nut, and insert them into the attachment hole of the product.

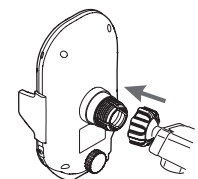

### 3 Fix them in place by turning the nut clockwise.

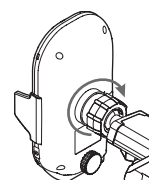

### 4 Determine the mount position.

Determine the mount position of the product by placing the attachment on the dashboard without removing the film.

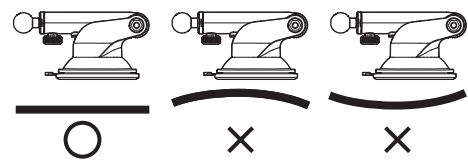

### 5 Adjust the angle and height.

Loosen each of the screws for the angle ① and height ②, make adjustments, and then tighten the screws.

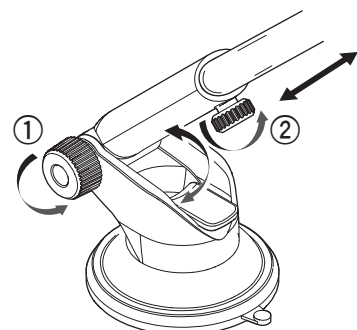

### 6 Pass the safety strap through the hole in the suction cup surface mount sheet and fasten the strap.

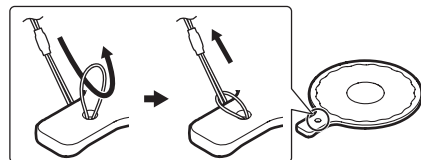

Pass the shortest loop of the safety strap through the hole in the suction cup surface mount sheet and fasten the strap.

### 7 Pass the other end of the safety strap through the gap in the dashboard mount attachment and fasten the strap.

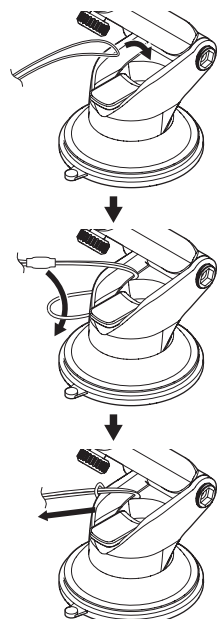

Pass the longest loop of the safety strap through the gap in the dashboard mount attachment, pass the suction cup surface mount sheet at the other end through the loop, and fasten the strap.

### 8 Peel off the double-sided tape release paper on the back of the suction cup surface mount sheet and affix the suction cup surface mount sheet to the dashboard.

- Affix the suction cup surface mount sheet to the desired mounting position.
- Wipe clean and dry the affixing location before affixing.

### 9 Raise the suction surface lock lever.

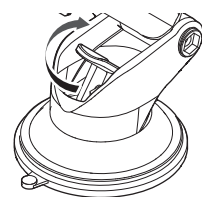

### 10 Peel off the film from the suction surface and place the suction surface on the suction cup surface mount sheet.

### 11 Lower the suction surface lock lever to lock the suction surface in place.

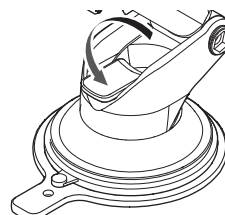

Move the product up, down, left, and right to check that it does not rattle.

# Connecting

### 1 Insert the supplied USB charger into the vehicle's cigarette lighter socket.

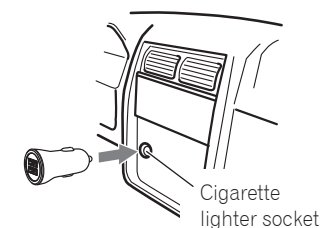

Use the supplied USB charger to perform quick charging. Quick charging may not be possible with a charging port fitted to the vehicle as standard or a commercially available USB charger with an insufficient voltage/current because USB output equivalent to the product input specification is required.

### 2 Connect the USB input port of this product and the USB charger with the supplied USB Type-C Cable.

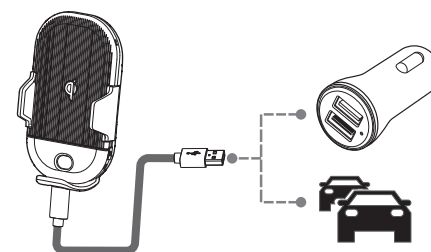

When inserting the USB connector into this product, insert it until you hear a click. When the cable is connected, the power lamp and charging lamp will illuminate. For details on illumination status, see "Product Status Display".

# Turning the Power On and Off

## Turning the Power On

### 1 Press the power button.

The power lamp (blue) lights. For details on illumination status, see "Product Status Display".

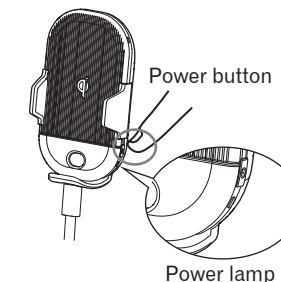

- Normally, when the vehicle's engine is turned on (ACC ON), power is supplied from the USB charger and the product power turns on automatically.
- When the product power on state continues for 5 minutes after power stops being supplied from the USB charger, the product power will turn off automatically.
- If the charge of the electric double-layer capacitor has run out due to opening and closing the arms several times while there is no power supplied from the USB charger, the product power will not turn on.

## Turning the Power Off

### 1 Press and hold down the power button for 3 seconds.

The power lamp (blue) goes out and the power turns off.

## Inserting and Removing a Smartphone

### Inserting a Smartphone

#### 1 Touch and hold the unlock sensor.

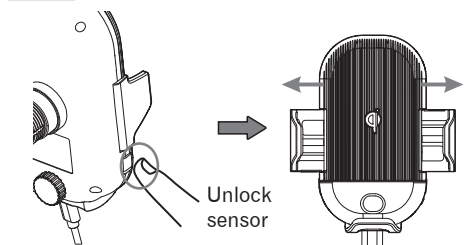

The sliding arms widen automatically. If the product does not operate, start the vehicle's engine and then perform the operation.

#### 2 Insert your smartphone.

Always insert your smartphone by sliding it from the top of the cradle as shown in the figure.

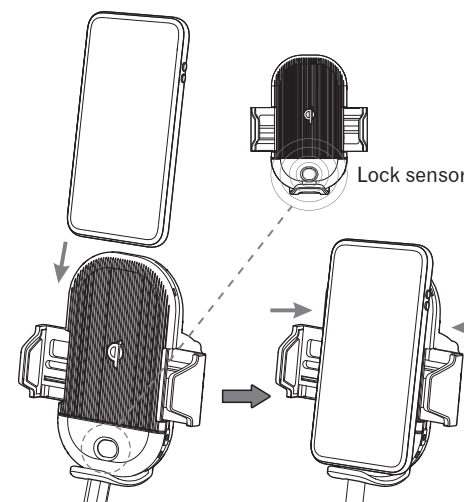

The lock sensor senses the smartphone and the sliding arms close automatically.

#### Note

- Take precaution that your hand does not get caught between the phone and the sliding arms when the sliding arms are closing.

Once a compatible smartphone is inserted, wireless charging will start automatically.

The charging lamp will illuminate during charging. For details on illumination status, see "Product Status Display".

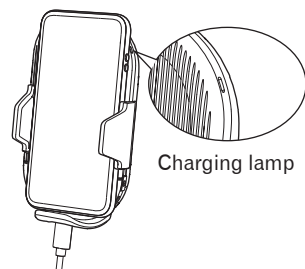

In the following cases, adjust the length of the holder from the bottom of the cradle.

- If a sliding arm is pressing the power button or volume button of the smartphone.
- If the charging indicator does not light even though a compatible smartphone is inserted.

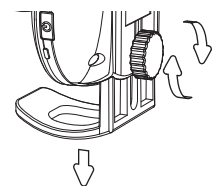

### Removing a Smartphone

#### 1 Touch and hold the unlock sensor.

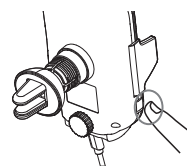

The sliding arms widen automatically.

#### 2 Removing a Smartphone

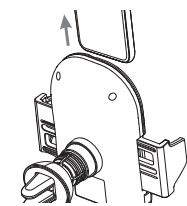

When the power turns off, the sliding arms close automatically.

## Product Status Display

### Power Lamp Display

The product status is indicated by the lighting/flashing state.

Status	Display
Storing	Flashing blue
Storing complete	Solid blue
Power off	Off

### Charging Lamp Display

The wireless charging status of the smartphone is indicated by the lighting/flashing state.

The charging lamp may not turn off after charging completes depending on the smartphone you are using.

Status	Display
Waiting to charge	Solid red
Charging	Solid blue
Charging complete	Off
High temperature or overvoltage	Flashing red
Abnormality detected or incompatible smartphone inserted	Flashing red and blue alternately

## Troubleshooting

Check the following information before sending the product in for service.

Symptom	Cause	Action
Power does not turn on.	No charge is stored in the product.	Connect the USB cable and check that the power lamp of the product lights or flashes.
	The connection of the supplied USB charger is poor.	Reinsert the USB charger into the cigarette lighter socket.
Sliding arms do not open even when touching and holding the unlock sensor.	The charge of the product ran out while the USB cable is not connected.	Connect the USB cable to charge the product.
	The unlock sensor does not respond.	Try touching the sensor for a longer period.
Wireless charging is not performed even though a smartphone is inserted.	The smartphone is not positioned correctly.	Adjust the position of the smartphone so that the charging lamp lights green.
	The smartphone cover is thick.	Remove the smartphone cover and place the smartphone on this product.
	A metal smartphone cover is attached.	Use a device that is compliant with the Qi wireless charging standard.