

C=90

8

Visit the FAQs sections on our website for warranty information.

<https://www.securifi.com/faq>

 support@securifi.com

1-855-969-7328 (US & Canada)
 +44-800-078-6277 (UK)
 +49-800-723-7994 (Deutsch)
 +33-805-080-447 (Français)
 +971-800035704234 (UAE)
 +800-101-3371 (Singapore)
 +886-800-000-152 (台灣)

1



Almond 3S

Quick Start Guide

 support@securifi.com  <http://www.securifi.com/support>

2

Inside the Box

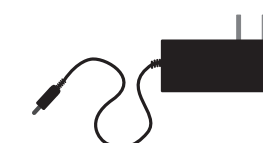

12V, 1A Power Adapter

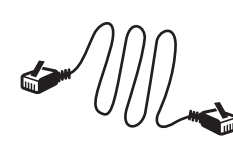

Ethernet Cable

7

Federal Communication Commission Interference Statement

This equipment has been tested and found to comply with the limits for a Class B digital device, pursuant to Part 15 of the FCC Rules. These limits are designed to provide reasonable protection against harmful interference in a residential installation. This equipment generates, uses and can radiate radio frequency energy and, if not installed and used in accordance with the instructions, may cause harmful interference to radio communications. However, there is no guarantee that interference will not occur in a particular installation. If this equipment does cause harmful interference to radio or television reception, which can be determined by turning the equipment off and on, the user is encouraged to try to correct the interference by one of the following measures:

- Reorient or relocate the receiving antenna.
- Increase the separation between the equipment and receiver.
- Connect the equipment into an outlet on a circuit different from that to which the receiver is connected.
- Consult the dealer or an experienced radio/TV technician for help.

FCC Caution: Any changes or modifications not expressly approved by the party responsible for compliance could void the user's authority to operate this equipment.

This device complies with Part 15 of the FCC Rules. Operation is subject to the following two conditions:
 (1) This device may not cause harmful interference, and (2) this device must accept any interference received, including interference that may cause undesired operation.

For product available in the USA/Canada market, only channel 1-11 can be operated. Selection of other channels is not possible.
 This device and its antenna(s) must not be collocated or operation in conjunction with any other antenna or transmitter.

IMPORTANT NOTE: FCC Radiation Exposure Statement:

This equipment complies with FCC radiation exposure limits set forth for an uncontrolled environment. This equipment should be installed and operated with minimum distance 20cm between the radiator & your body.

This Class B digital apparatus complies with Canadian ICES003.

Cet appareil numérique de la classe B conforme à la norme NMB003 du Canada.

This device complies with Industry Canada license exempt RSS standard(s). Operation is subject

6

Visit the FAQs sections on our website for detailed setup guides.

<https://www.securifi.com/faq>



Download the Almond App



Join our Forum

Get the most out of your Almonds and learn from the Pros on our Forums. We also have giveaways from time to time.

<http://forum.securifi.com>

3

Introduction

Almonds is a highly flexible Wi-Fi system that can be used in any of the following modes.

Smart Home Wi-Fi System (Recommended)

You can create a Home Wi-Fi network by setting up two or more Almonds units around your home. The Almonds communicate with each other wirelessly or through Ethernet, if your home is already wired. Together they form a single Wi-Fi network across your whole home, and eliminate Wi-Fi dead zones.

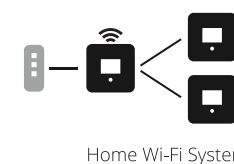

Home Wi-Fi System



Router

Standalone Router

You can create your main Wi-Fi network by connecting an Almonds directly to your ISP modem using the Internet cable. All your devices can connect to this Wi-Fi network to access the Internet.

4

Set up a Smart Home Wi-Fi System

Start by setting up any of your Almonds units as a router. This will act as your primary Almond. The additional Almonds can be connected to the primary Almond via wired interface or wirelessly.

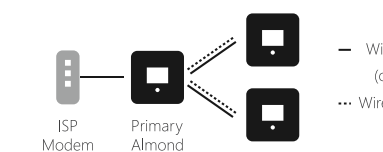

Step 1. Set up your first Almond as a Router

- Take any of your Almonds units and follow these instructions to set it up as a primary router.
- Unplug the power adapter & ethernet cables of your Internet Modem (Cable, DSL or Fiber). If your modem has a battery remove it. Wait for 1 minute.
- Power up your modem by plugging in the power adapter or re-inserting the batteries. Wait for 1 minute.
- Connect the WAN port of your Almonds to any of the LAN ports on your modem using the internet cable provided.

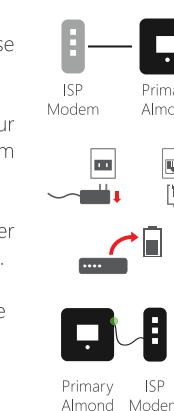

Primary Almond ISP Modem

5

e) Power up the Almonds and follow the instructions on the Almond's touch screen to complete the setup process.

Step 2. Create a seamless network by adding second Almond

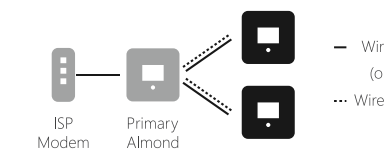

- After you have set up your primary Almonds as a router and set up your Almond account, continue on the set up wizard and tap on the 'Add Almond' button.
- Follow the on-screen instructions to complete the setup of your second Almonds to create a seamless Wi-Fi network.
- You can continue in the wizard for adding more Almonds units to expand Wi-Fi coverage in your home.

You can also add more Almonds units to your Home Wi-Fi network later via the 'Add Almond' icon on the primary Almonds touch screen.



Set up a Router

Refer to **step 1** of **Set up a Smart Home Wi-Fi System** and follow the steps from 'a' to 'e'