

## Antenna specification

- Model name AN01DL25C00R3200
- Antenna Manufacturer
  - Name Japan Aviation Electronics Industry, Ltd
  - Address 21-1, Dogenzaka 1-chome, Shibuya-ku, Tokyo 150-0043, Japan  
Herd Office SIBUYA SOLASYA 12F
- Frequency Range
  - From 2.4 [GHz] to 2.5 [GHz]
  - From 5.15 [GHz] to 5.85 [GHz]
- Antenna format Split ring
- Connector type Surface mount device
- Antenna gain

Frequency[MHz]	Peak gain [dBi]
2400~2500	1.15
5150~5320	0.15
5450~5825	0.62

- Impedance  $50\Omega$
- External view

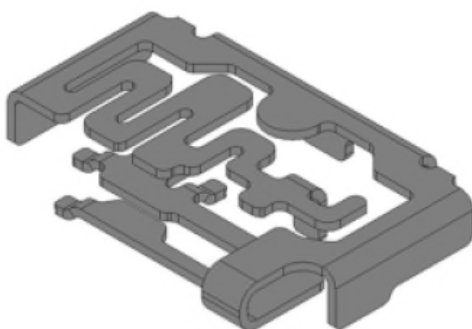

• Antenna patterns

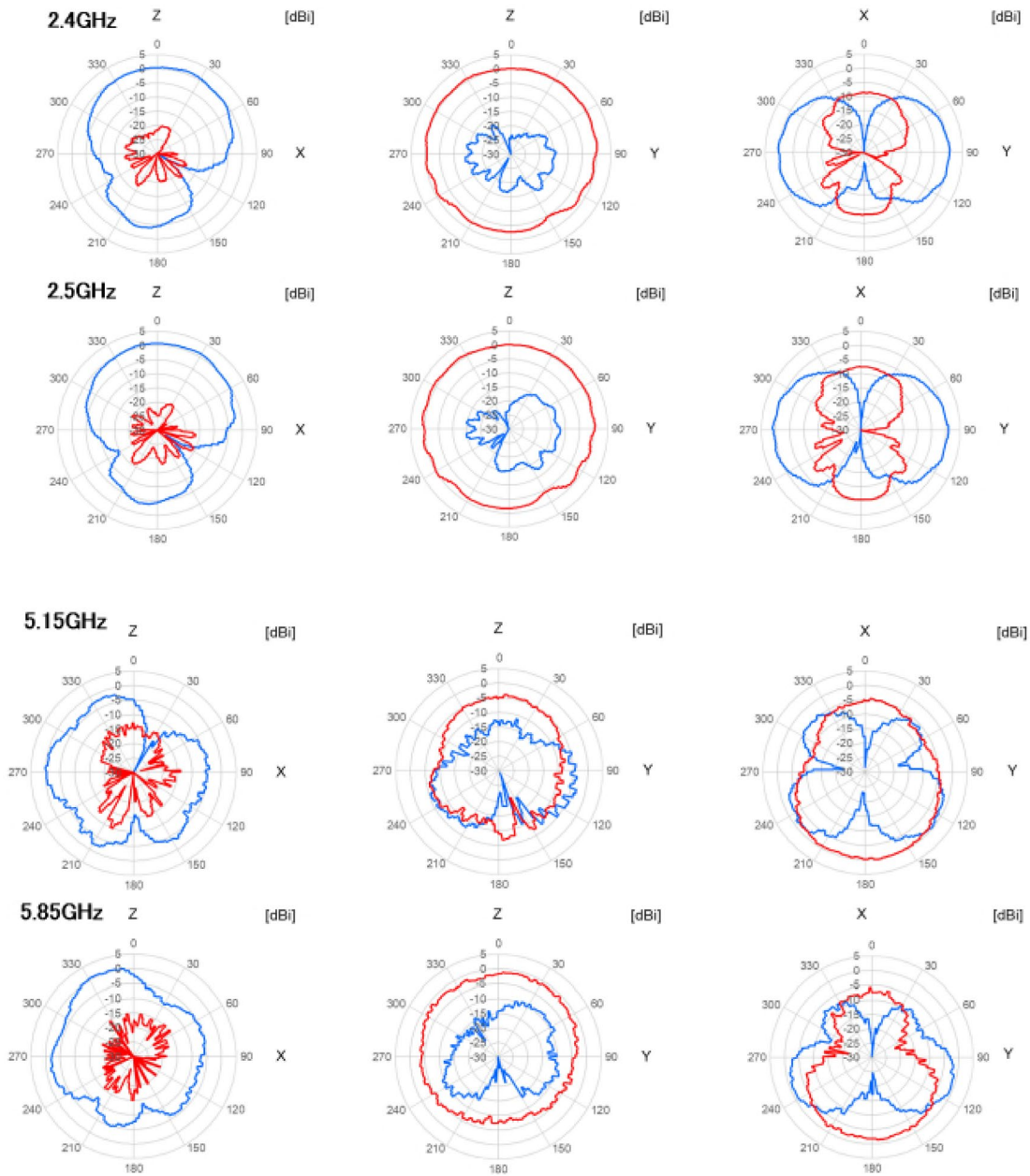

blue line: horizontal polarization  
 red line: vertical polarization