

Position of label AT1805

Top side

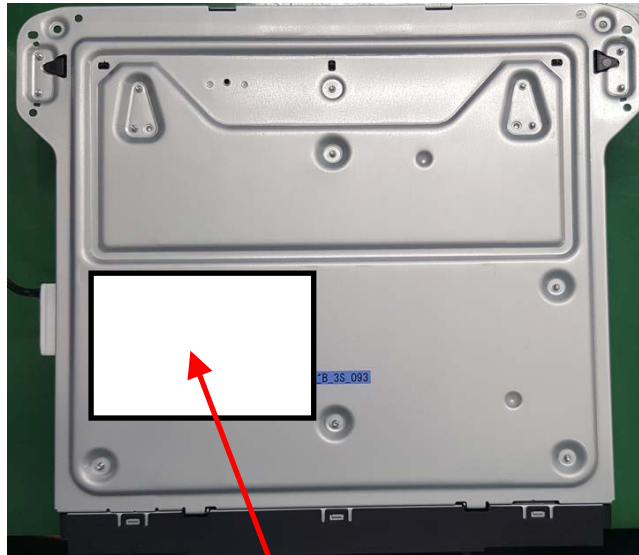

Model No. <input type="text"/>	CLASS 1 LASER PRODUCT	A
Ref. No. <input type="text"/>		
Set No. AT1805	Product complies with DHHS Rules 21 CFR Subchapter J in effect as of date of manufacture. Panasonic Corporation Matsumoto, Japan MANUFACTURED <input type="text"/>	
DC <input type="text"/> Negative Ground		
Panasonic Corporation Made in Japan		
Serial No. <input type="text"/>		
FCC ID : ACJ932AT1805 IC : 216J-AT1805		
For DTS patents, see http://patents.dts.com .		
Manufactured under license from Dolby Laboratories. Dolby, Dolby Audio and the double-D symbol are trademarks of Dolby Laboratories.		
This device complies with part 15 of the FCC Rules. Operation is subject to the following two conditions: (1) This device may not cause harmful interference, and (2) this device must accept any interference received, including interference that may cause undesired operation.		
YEFM012032		

“Set No.” described in Label means “Model No.”.