



EXHIBIT 3

Transmit Label Photo

Applicant: Northern Telecom Ltd.

For Certification on:

AB6UMTS1900IND

NOTES:

- UNLESS OTHERWISE SPECIFIED, ALL DIMENSIONS ARE EXPRESSED IN MILLIMETERS. TOLERANCES SHALL BE:
 2 DECIMAL PLACES = ±.25
 3 DECIMAL PLACES = ±.125
 ALL LABEL CORNERS SHALL HAVE A .75 RADIUS.
- TO CONVERT MILLIMETERS TO INCHES:
 25.40 MILLIMETERS = 1 INCH.
- THIS DESIGN FILE WAS CREATED IN ACCORDANCE WITH NT STD 1517.20. LABEL/ARTWORKS MUST BE MANUFACTURED IN ACCORDANCE WITH NPS90942.
- THE ARTWORK SHALL BE PLOTTED AT A MINIMUM OF 1200 DPI. THE TEXT FONT(S) SHALL BE: UNIVERS 67 CONDENSED BOLD PER NPS90942. TEXT ABOVE AND BELOW UL OR CSA SYMBOLS SHALL BE UNIVERS 57 CONDENSED PER NPS90942.
- MATERIAL: .25 CLEAR POLYCARBONATE PER R0115902
 FINISH: VELVET/MATTE
 ADHESIVE: .05 PRESSURE SENSITIVE WITH PEEL OFF LINER PER R0113138
- COLOURS SHALL CONFORM TO NORTHERN TELECOM OBSERVATIONAL STANDARD 2701.01.
 BACKGROUND: BTS LIGHT GREY PER NORTHERN TELECOM STANDARD S-33470
 TEXT AND GRAPHICS: NORTEL DARK GRAY PER NORTHERN TELECOM STANDARD S-33310
 BACKGROUND AT TOP OF LABEL: NORTEL LIGHT GRAY PER NORTHERN TELECOM STANDARD S-33310
- LABEL TO BE REVERSE SCREEN PRINTED PER NPS90942-2.

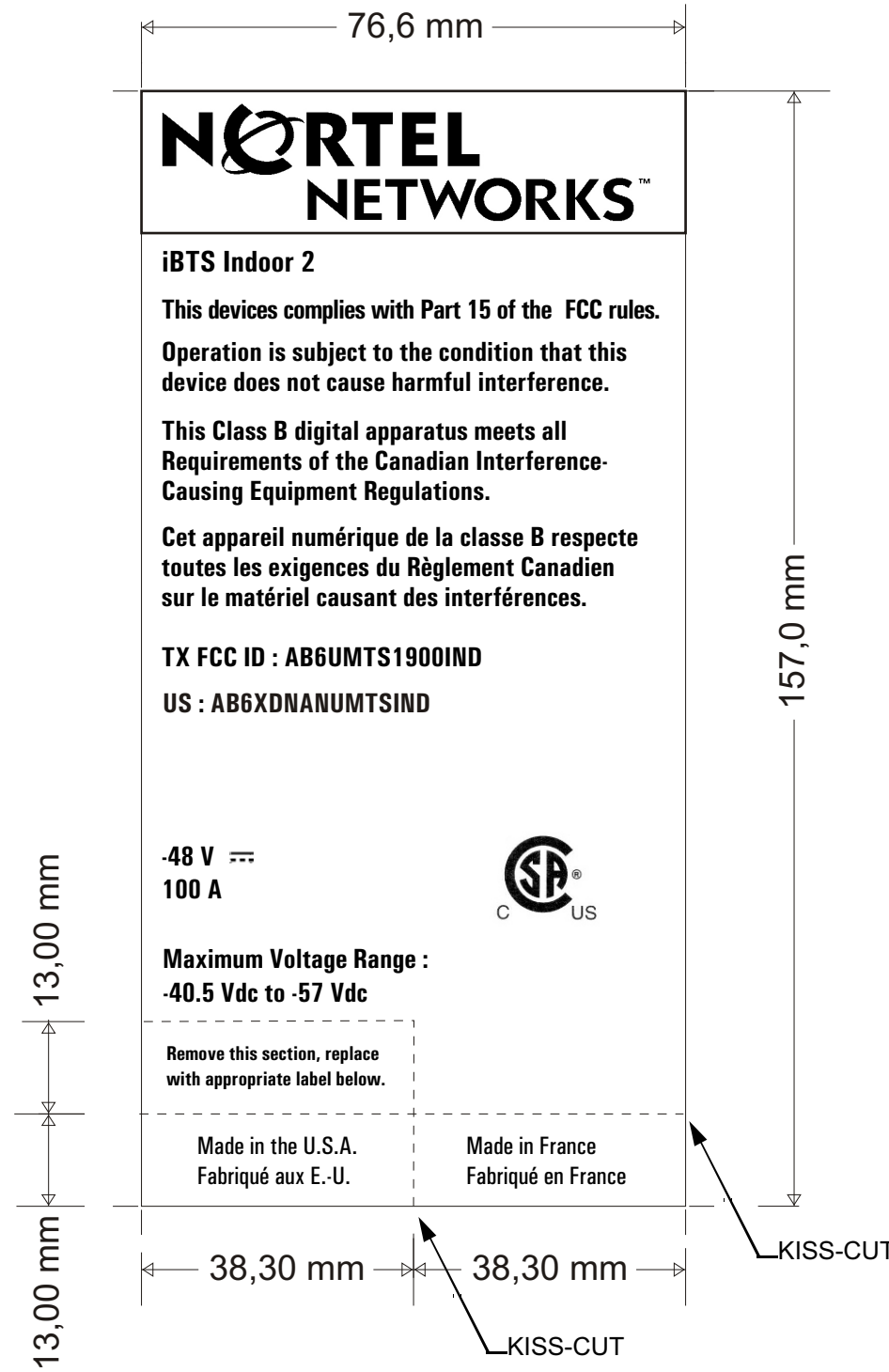

EC: 103-11137
 16/10/2002

DRAWN	APPD	STREAM	ISSUE
LV	HP	00	03

PROPRIETARY INFORMATION :
 THE INFORMATION CONTAINED IN THIS DOCUMENT IS THE PROPERTY OF NORTEL NETWORKS LIMITED. EXCEPT AS SPECIFICALLY AUTHORIZED IN WRITING BY NORTEL NETWORKS LIMITED, THE HOLDER OF THIS DOCUMENT: (1) SHALL KEEP ALL INFORMATION CONTAINED HEREIN CONFIDENTIAL AND SHALL PROTECT SAME IN WHOLE OR IN PART FROM DISCLOSURE AND DISSEMINATION TO ALL THIRD PARTIES AND (2) SHALL USE SAME FOR OPERATING AND MAINTENANCE PURPOSES ONLY.

INITIAL APPLICATION

TITLE

CSA MARK Regulatory Label
iBTS indoor 2

DRAWING NUMBER

P0602307

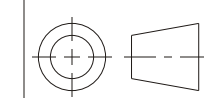

SCALE

1:1

NORTEL NETWORKS

SIZE
 C

SHEET
1 OF 1