

NORTEL
NETWORKS™

800 FRM
TX FCC ID: AB6NT800FRMA
CANADA: 332291120A

P0941271

STREAM 00/ ISSUE 01

FULL SCALE

6

5

4

3

2

1

D

C

B

A

D

C

B

A

NOTES:

1. UNLESS OTHERWISE SPECIFIED, ALL DIMENSIONS ARE EXPRESSED IN INCHES. TOLERANCES SHALL BE:
 2 DECIMAL PLACES = ±.01
 3 DECIMAL PLACES = ±.005
 ALL LABEL CORNERS SHALL HAVE A .03 RADIUS.
2. THIS DESIGN FILE WAS CREATED IN ACCORDANCE WITH NT STD 1517.20. LABEL/ARTWORKS MUST BE MANUFACTURED IN ACCORDANCE WITH NPS90942.
3. THE ARTWORK (SEE SHEET 2) SHALL BE PLOTTED AT A MINIMUM OF 1200 DPI PER NPS90942. THE TEXT FONT(S) SHALL BE: UNIVERS 67 CONDENSED BOLD PER NPS90942.
4. MATERIAL: .010 CLEAR POLYCARBONATE PER R0115902
 FINISH: VELVET/MATTE
 ADHESIVE: .002 PRESSURE SENSITIVE WITH PEEL OFF LINER PER R0113138
5. COLORS SHALL CONFORM TO NORTHERN TELECOM OBSERVATIONAL STANDARD 2701.01.
6. LABEL TO BE REVERSE SCREEN PRINTED PER NPS90942-2.
7. LABEL TO BE UL-969 APPROVED.

EC 102-XXXXX
12/17/2001

DRAWN	APPD	STREAM	ISSUE
JOM	AW	00	02

PROPRIETARY INFORMATION:
 THE INFORMATION CONTAINED IN THIS DOCUMENT IS THE PROPERTY OF NORTHERN TELECOM LIMITED. EXCEPT AS SPECIFICALLY AUTHORIZED IN WRITING BY NORTHERN TELECOM LIMITED, THE HOLDER OF THIS DOCUMENT: (1) SHALL KEEP ALL INFORMATION CONTAINED HEREIN CONFIDENTIAL AND SHALL PROTECT SAME IN WHOLE OR IN PART FROM DISCLOSURE AND DISSEMINATION TO ALL THIRD PARTIES AND (2) SHALL USE SAME FOR OPERATING AND MAINTENANCE PURPOSES ONLY.

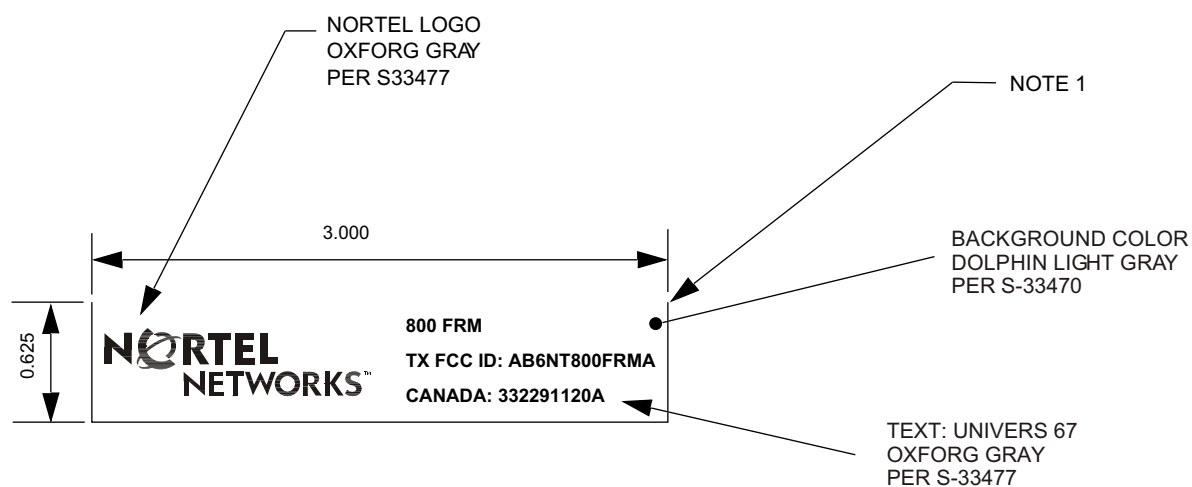

INITIAL APPLICATION

NTGS85BA

TITLE

REGULATORY LABEL
800 FRM

DRAWING NUMBER

P0941271

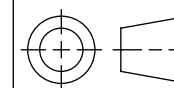

SCALE

1/1

NORTHERN
TELECOM

SIZE

B

SHEET

1 of 2

6

5

4

3

2

1