

BOSE[®]



WAVE[®] SOUNDLINK[™] ADAPTER

FOR THE BOSE[®] WAVE[®] MUSIC SYSTEM AND THE BOSE WAVE[®] RADIO II

Owner's Guide | Bedienungsanleitung | Guía de usuario | Notice d'utilisation | Manuale di istruzioni
Gebruiksaanwijzing | คู่มือผู้ใช้ | 사용자 안내서 | 用户指南 | ليل المالك

Safety Information

Please read this owner's guide



Please take the time to follow the instructions in this owner's guide carefully. It will help you set up and operate your system properly and enjoy all of its advanced features. Please save this owner's guide for future reference.

WARNING: To reduce the risk of fire or electrical shock, do not expose the product to rain or moisture.

WARNING: Do not expose this apparatus to dripping or splashing, and do not place objects filled with liquids, such as vases, on or near the apparatus. As with any electronic products, use care not to spill liquids into any part of the system. Liquids can cause a failure and/or a fire hazard.





	CAUTION RISK OF ELECTRICAL SHOCK DO NOT OPEN	
<p>CAUTION: TO REDUCE THE RISK OF ELECTRIC SHOCK, DO NOT REMOVE COVER (OR BACK). NO USER-SERVICEABLE PARTS INSIDE. REFER SERVICING TO QUALIFIED PERSONNEL.</p>		

	AVIS RISQUE DE CHOC ELECTRIQUE NE PAS OUVRIR	
<p>ATTENTION : POUR RÉDUIRE LE RISQUE DE DÉCHARGE ÉLECTRIQUE, NE RETIREZ PAS LE COUVERCLE (OU L'ARRIÈRE). IL NE SE TROUVE À L'INTÉRIEUR AUCUNE PIÈCE POUVANT ÊTRE RÉPARÉE PAR L'USAGER. S'ADRESSER À UN RÉPARATEUR COMPÉTENT.</p>		

 The lightning flash with arrowhead symbol within an equilateral triangle alerts the user to the presence of uninsulated dangerous voltage within the system enclosure that may be of sufficient magnitude to constitute a risk of electrical shock.

 The exclamation point within an equilateral triangle, as marked on the system, is intended to alert the user to the presence of important operating and maintenance instructions in this owner's guide.

 **CAUTION:** Make no modifications to the system or accessories. Unauthorized alterations may compromise safety, regulatory compliance, and system performance and will void the product warranty.

 **CAUTION:** Do not use any liquid cleaning solutions, solvents, chemicals, alcohol, ammonia, or abrasives.

 **CAUTION:** Do not allow liquids to spill into any openings in the enclosure. If liquids get into the unit, turn it off immediately. Call Bose® Customer Support as soon as possible to arrange for service. See the address list included in the carton.

 **WARNING:** Keep the remote control battery away from children. It may cause a fire or chemical burn if mishandled. Do not recharge, disassemble, heat above 100°C (212°F), or incinerate. Dispose of used batteries promptly. Replace only with a battery of the correct type and model number.

 **WARNING:** Danger of explosion if battery is incorrectly replaced. Replace only with Duracell, Eveready, Energizer, Maxell, Toshiba, or Shun Wo CR2032 or DL2032 3-volt lithium battery.



Please dispose of used batteries properly, following any local regulations. Do not incinerate.

 **WARNING:** Do not place any naked flame sources, such as lighted candles, on or near the apparatus.

 **WARNING:** Contains small parts that may be a choking hazard. Not suitable for children under age 3.

Note: The product label is located on the bottom of the product.

Note: Where the mains plug or appliance coupler is used as the disconnect device, such disconnect device shall remain readily operable.

Note: Operating temperature range: 0 to 35°C. This product is intended for indoor use only.

Note: This product is intended for use only with the power supply provided.



This product conforms to all EU Directive requirements as applicable by law. The complete Declaration of Conformity can be found at: www.Bose.com/static/compliance.

For the SoundLink™ USB key:

This device complies with FCC and Industry Canada RF radiation exposure limits set forth for general population. It must not be co-located in conjunction with any other antenna or transmitter within a host device.

This device complies with Part 15 of the FCC Rules, Operation is subject to the following two conditions: (1) This device may not cause harmful interference, and (2) this device must accept any interference received, including interference that may cause undesired operation.

In Canada, operation is subject to the following two conditions: (1) this device may not cause interference and (2) this device must accept any interferences, including interference that may cause undesired operation of the device.

For the SoundLink™ adapter:

To comply with FCC and Industry Canada RF radiation exposure requirements, this device must be installed to produce a separation distance of 20 cm from all persons. It must not be co-located or operating in conjunction with any other antenna or transmitter.

This product complies with the Canadian ICES-003 Class B and RSS-210 specifications.

In the U.S. only, this product complies with CFR 47 Part 15 specifications.

Additional safety information: See the additional instructions on the Important Safety Instructions sheet (North America only) enclosed in the shipping carton.

Contents

Product parts	2
A. Using a kit with basic contents only	2
B. Using a kit with both basic and upgrade contents	2
Upgrading your Wave® music system, as needed	3
Preparing your Wave® music system or Wave® radio II for wireless	4
If your kit includes an adapter power pack	5
Preparing your computer	6
To disconnect your Wave® music system from the computer	8
To reconnect to your Wave® system	8
Listening to music on your computer	9
Battery replacement	10
Troubleshooting	10
Manually linking the SoundLink™ adapter and USB key	15
Customer service	15
Limited warranty	16
Technical information	17

Product parts

There are two versions of the SoundLink™ kit. Which version you chose for your specific Wave® system determines which steps you follow in making the connections.

Identify your kit as A. or B. and follow the instructions that apply.

A. Using a kit with basic contents only

If you have only the basic contents kit directly below:

Skip ahead to “Preparing your Wave® music system or Wave® radio II for wireless” on page 4.

B. Using a kit with both basic and upgrade contents

If you have all of the contents shown below:

1. Begin with “Upgrading your Wave® music system, as needed” on page 3.
2. Proceed with “Preparing your Wave® music system or Wave® radio II for wireless” on page 4.

Basic contents

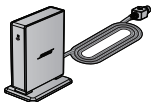

SoundLink™
adapter



SoundLink™
USB key



SoundLink™
remote control
(battery installed)

Upgrade contents



Upgrade CD

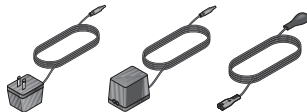

Adapter power pack
100-120V OR 220-240V

Upgrading your Wave® music system, as needed

If your kit includes an upgrade CD, it is important to use the CD before making any SoundLink™ kit connections.

Follow this procedure:

1. Make sure your Wave® music system is plugged in and ready to use.
For detailed instructions, refer to the Bose® owner's guide that came with the system.
2. Insert the update CD, label side up, into the disc drive on the system.
The update process begins automatically and **UPDATING** appears on the Wave® system display.

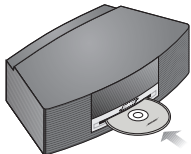

When the update is complete, the system ejects the disc. Your system is now compatible with the SoundLink™ adapter.

Preparing your Wave® music system or Wave® radio II for wireless

The SoundLink™ adapter connects directly to your Wave® system.

1. Plug the SoundLink™ adapter cable (with the words Bose link facing up) into the **Bose link** connector on the rear of the system.

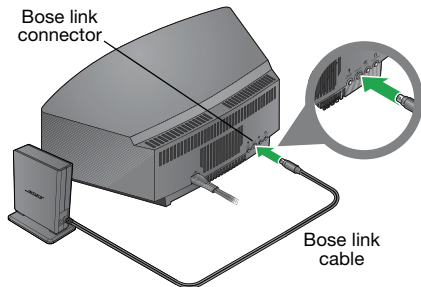

2. Place the adapter in a convenient location. It does not need to be within view. If the adapter is to the left of the system (as you face it), be sure the two are at least 2 in. (5 cm) apart to eliminate any interference with AM reception.

If your kit includes an adapter power pack

1. On the rear of the SoundLink™ adapter, insert the small end of the adapter power cable into the **DC power** connector.
2. Plug the other end of the power cable into an AC power outlet that is close to your system.

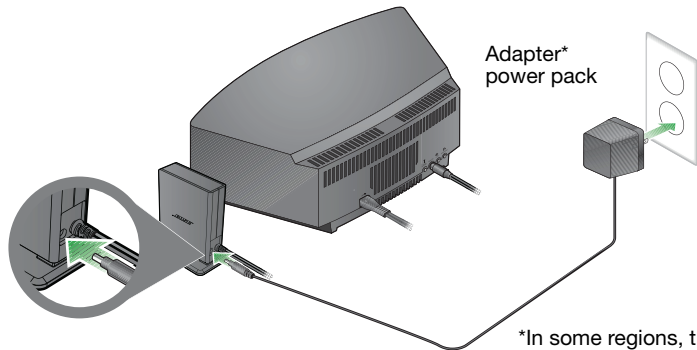

SOUNDLINK POWER CABLE UNPLUGGED

scrolls across the Wave® system display if the required power pack is not connected when you press the SoundLink/**CD** button.

*In some regions, the kit includes a separate power cable that connects to the power supply.

Preparing your computer

1. Using the provided SoundLink™ remote control, press the SoundLink/**AUX** button to select the computer as the music source.
Your Wave® system turns on and **SOUNDLINK, CONNECTING, DISCOVERABLE** appear in sequence on the front panel display.
If no text appears, see “Troubleshooting” on page 11.
2. With your computer turned on, lift the antenna on the SoundLink™ USB key to the vertical position and plug the key into a USB port on your computer.

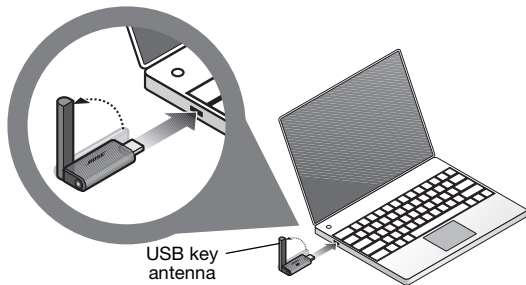

To locate a USB port on your computer, look for the identifying symbol .

If you are using a USB hub with your computer, make sure it is a powered hub.

3. Check to be sure the SoundLink™ USB key power light turns on and begins to flash.

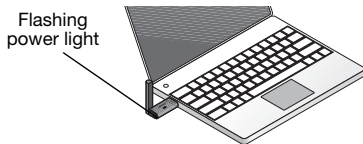

4. Wait for your computer to recognize the SoundLink™ USB key. It may take up to 20 seconds the first time this occurs.

CONNECTING appears on the Wave® system display and lights on the USB key and SoundLink™ adapter flash rapidly. The lights stop blinking and the Wave® system emits a brief beep when the SoundLink™ connection is ready for use.

5. For best performance, set your computer volume control to the maximum level you use. Then open a music application or locate an Internet radio station and set the music to play.

Important for Mac computer users: *On first using the USB key, you may need to open your computer Sounds settings in System Preferences and select “Bose SoundLink Audio.”*

Note: *While listening to music from your computer, no sound plays through the computer’s internal speakers or sound card. On some computers, you can choose a separate audio output for your music and still hear computer alerts on its internal speakers.*

To disconnect your Wave® music system from the computer

Press the button on the end of the SoundLink™ USB key. Then remove the USB key from the computer USB port.

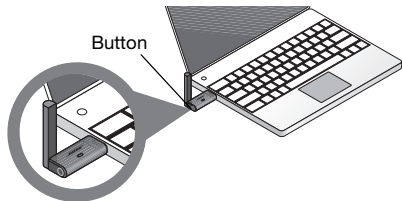

To reconnect to your Wave® system

When you plug the SoundLink™ USB key into the USB port on your computer, it should automatically reconnect to your Wave® system. Make sure your system is turned on and **COMPUTER** appears on the system display.

If you have problems connecting, see “Troubleshooting” on page 11.

Listening to music on your computer

Your SoundLink™ kit remote control gives you access to the music on your computer. It works much like the original Wave® music system remote and controls all of the system features. The buttons that operate with your computer include:

Mute

- Press to silence audio.
- Press again to restore audio.

Volume

- Press: Turns the volume up or down.
- *Press and hold:* Adjusts the volume faster.

Seek/Track*

- Press: Skips to the previous or next CD track or music track on your computer.
- *Press and hold:* Scans back or ahead through the current track.



SoundLink/AUX

- Press: Selects the audio from your computer or an AUX device (if one is connected to the system).
- *Press again:* Switches between your computer and the AUX device.

Play/Pause*

- Begins music track play.
- Pauses a playing track.

Note for Wave® radio II owners:

The new remote provides all of the buttons needed to operate the Wave® radio II, plus some that work solely with the Wave® music system.

May not work with Internet radio and some music applications.

Battery replacement

WARNING: Keep the remote control battery away from children. It may cause a fire or chemical burn if mishandled. Do not recharge, disassemble, heat above 212°F (100°C), or incinerate. Dispose of a used battery promptly. Replace only with a battery of the correct type and model number.

CAUTION: Danger of explosion if battery is incorrectly replaced. Replace only with Duracell, Eveready, Energizer, Maxell, Toshiba, or Shun Wo CR2032 or DL2032 3-volt lithium battery.

Troubleshooting

Problem	What to do
Computer does not recognize the SoundLink™ USB key (in its list of connected devices).	<ul style="list-style-type: none"> • Remove the SoundLink™ USB key from your computer, wait 30 seconds, and insert it again. • If you are using a USB hub, make sure the hub is powered. • Try a different USB port. If you are using a powered USB hub, try moving the SoundLink™ USB key to a USB port on the computer. • Remove the SoundLink™ USB key, restart your computer, and insert the USB key again. • Refer to the owner's guide, help system, or technical support for your computer to learn how to detect and install new hardware.

Problem	What to do
<p>Computer and Wave® system do not connect.</p> <p>Symptom A: SOUNDLINK or COMPUTER never appear on the Wave® system display and no lights blink.</p> <p>Or see Symptom B on the next page.</p>	<ul style="list-style-type: none">• Press the SoundLink/AUX button to turn on the system and select the computer.• Make sure the SoundLink™ adapter is connected to the Wave® system.• Unplug the Wave® music system for 30 seconds and plug it back in.• If you received an upgrade CD with your kit and have not used it, be sure to run it now.• If this does not resolve the problem, contact Bose Customer Service. Refer to the address list included in the carton.

Problem	What to do
<p>Computer and Wave® system do not connect.</p> <p>Symptom B: CONNECTING remains on the Wave® system display and the adapter light blinks continuously.) – NO SIGNAL – appears eventually on the system display.</p> <p>Or, see Symptom A on the previous page.</p>	<ul style="list-style-type: none">• Make sure the USB key is plugged in and your computer is turned on.• Decrease the distance between the Acoustic Wave® system and your computer. See “Connection range” on page 17.• Try moving the Wave® system away from possible sources of interference such as another wireless device, a microwave oven, or wireless computer network router.• If you are using a desktop computer, try moving the USB key to a port that provides a more direct path to the adapter. Or use a USB extension cable, available for purchase at computer stores.• Remove the USB key from your computer, wait 30 seconds and insert it again.• Disconnect the power supply from the Wave® system and reconnect it.• Try restoring the wireless link between the speaker and the USB key. See “Manually linking the SoundLink™ adapter and USB key” on page 15.

Problem	What to do
No sound when the computer music plays.	<ul style="list-style-type: none">• Press the SoundLink/AUX button on the SoundLink™ remote to select your computer as the source. COMPUTER should be displayed.• Make sure your Wave® system volume is turned up and the sound is not muted.• Make sure the volume on your computer is turned up and is not muted.• Make sure your music application is running and the volume is turned up and not muted.• Check your computer Sound settings to make sure “Bose SoundLink Audio” is selected as the audio output device.• Close or quit the music application on your computer and restart it.• Restart your computer.

Problem	What to do
<p>Reception of sound from the computer is poor or the sound is dropping out.</p>	<ul style="list-style-type: none"> • Move the SoundLink™ adapter farther from the Wave® system. • Change the angle of the antenna on the SoundLink™ USB key. • Decrease the distance between the Acoustic Wave® system and your computer. See “Connection range” on page 17. • Try moving the Acoustic Wave® system away from possible sources of interference such as another wireless device, a microwave oven, or wireless computer network router. • Use a USB extension cable, available for purchase at computer stores. Plug the USB key into the appropriate end of the cable and the computer into the other end. • Close other applications that can tax your computer memory. • If you continue to experience reception problems, contact Bose Customer Service. Refer to the address list included in the carton.
<p>Play/Pause and Seek buttons do not control music on the computer.</p>	<ul style="list-style-type: none"> • Make sure your computer media player or Internet radio application is selected as the active window. <hr/> <p>Note: <i>Not all players and Internet radio services support this form of playback control.</i></p> <hr/>

Manually linking the SoundLink™ adapter and USB key

You may be using a replacement SoundLink™ USB key or SoundLink™ adapter or troubleshooting the wireless connection. In either case you should link the USB key and adapter manually.

1. Using the provided SoundLink™ remote control, press the SoundLink/**AUX** button to select the computer as the music source.
2. *Press and hold* the **Presets 5** button on the remote control until **DISCOVERABLE** is displayed and flashing on the Wave® system display.
3. With your computer turned on, lift the antenna on the SoundLink™ USB key to the vertical position and plug the key into a USB port on your computer.
4. *Press and hold* the button on the USB key for more than 3 seconds until the light begins to flash. When the USB power light changes from flashing to solid and the Wave® system emits a beep, linking is complete.

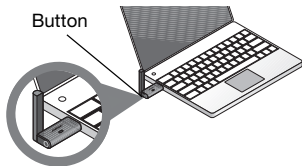

Customer service

For additional help in solving problems, see notes about the product at: Owners.Bose.com. To contact Bose Customer Service for help, or to replace a lost remote control, see the phone numbers on the inside the back cover of your Wave® music system guide.

Limited warranty

Your Bose® SoundLink™ kit is covered by a limited transferable warranty. Details of the limited warranty are provided on the product registration card that is included in the carton. Please complete the information section on the card and mail it to Bose. Failure to do so will not affect your limited warranty rights.

What you must do to obtain Limited Warranty Service:

Return product, with proof of purchase from an authorized Bose® dealer, using the following procedures:

- 1.** Contact the Bose organization in your country/region (visit Global.Bose.com for Bose contact information in your country/region) for specific return and shipping instructions;
- 2.** Label and ship the product, freight prepaid, to the address provided by the Bose organization in your country; and
- 3.** Place any necessary return authorization number prominently on the outside of the carton. Cartons not bearing a return authorization number, where required, will be refused.

Technical information

Adapter power rating

100V 50/60Hz with 5V output at 500mA
120V 60Hz with 5V output at 500mA
220-240V 50 or 60Hz with 5V output at 500mA

Connection range

Wireless capability covers a range of up to 60 ft (18.5 m), which can vary according to the type of home construction and signal obstructions (multiple walls, metal appliance, etc.). It can also be affected by the presence of other wireless devices (such as network routers or microwave ovens.)

Dimensions

SoundLink™ adapter: 3.6" H x 2.6" D x 1" W
(9.1 cm H x 7.6 cm D x 2.3 cm W)

Weight

SoundLink™ adapter: 0.33 lb.
(150 grams +/-10 grams)

Computer requirements

Compatible with computers running Windows XP or Vista systems or MAC OSX (10.4 or later).

Requires use of a USB port on a computer or a powered USB hub connected to the computer.

Bose® system requirement

Exclusive use of the **Bose link** connector on the rear of the Wave® system.

Bluetooth® QD ID

SoundLink™ USB key: B015403

SoundLink™ Adapter: B015665

The *Bluetooth*® word mark and logos are registered trademarks owned by Bluetooth SIG, Inc. and any use of such marks by Bose Corporation is under license.

Important Safety Instructions

- 1. Read these instructions** – for all components before using this product.
- 2. Keep these instructions** – for future reference.
- 3. Heed all warnings** – on the product and in the owner's guide.
- 4. Follow all instructions.**
- 5. Do not use this apparatus near water** – Do not use this product near a bathtub, washbowl, kitchen sink, laundry tub, in a wet basement, near a swimming pool, or anywhere else that water or moisture are present.
- 6. Clean only with dry cloth** – and as directed by Bose® Corporation. Unplug this product from the wall outlet before cleaning.
- 7. Do not block any ventilation openings. Install in accordance with the manufacturer's instructions** – To ensure reliable operation of the product and to protect it from overheating, put the product in a position and location that will not interfere with its proper ventilation. For example, do not place the product on a bed, sofa, or similar surface that may block the ventilation openings. Do not put it in a built-in system, such as a book-case or a cabinet that may keep air from flowing through its ventilation openings.
- 8. Do not install near any heat sources, such as radiators, heat registers, stoves or other apparatus (including amplifiers) that produce heat.**
- 9. Do not defeat the safety purpose of the polarized or grounding-type plug. A polarized plug has two blades with one wider than the other. A grounding-type plug has two blades and a third grounding prong. The wide blade or the third prong are provided for your safety. If the provided plug does not fit into your outlet, consult an electrician for replacement of the obsolete outlet.**
- 10. Protect the power cord from being walked on or pinched, particularly at plugs, convenience receptacles, and the point where they exit from the apparatus.**
- 11. Only use attachments/accessories specified by the manufacturer.**
- 12. Use only with the cart, stand, tripod, bracket or table specified by the manufacturer or sold with the apparatus. When a cart is used, use caution when moving the cart/apparatus combination to avoid injury from tip-over.**
- 13. Unplug this apparatus during lightning storms or when unused for long periods of time** – to prevent damage to this product.



- 14. Refer all servicing to qualified service personnel. Servicing is required when the apparatus has been damaged in any way: such as power-supply cord or plug is damaged; liquid has been spilled or objects have fallen into the apparatus; the apparatus has been exposed to rain or moisture, does not operate normally, or has been dropped** – Do not attempt to service this product yourself. Opening or removing covers may expose you to dangerous voltages or other hazards. Please call Bose to be referred to an authorized service center near you.
- 15. To prevent risk of fire or electric shock, avoid overloading wall outlets, extension cords, or integral convenience receptacles.**
- 16. Do not let objects or liquids enter the product** – as they may touch dangerous voltage points or short-out parts that could result in a fire or electric shock.
- 17. See product enclosure for safety related markings.**

Information about products that generate electrical noise

If applicable, this equipment has been tested and found to comply with the limits for a Class B digital device, pursuant to Part 15 of the FCC rules. These limits are designed to provide reasonable protection against harmful interference in a residential installation. This equipment generates, uses, and can radiate radio frequency energy and, if not installed and used in accordance with the instructions, may cause harmful interference to radio communications. However, this is no guarantee that interference will not occur in a particular installation. If this equipment does cause harmful interference to radio or television reception, which can be determined by turning the equipment off and on, you are encouraged to try to correct the interference by one or more of the following measures:

- Reorient or relocate the receiving antenna.
- Increase the separation between the equipment and receiver.
- Connect the equipment to an outlet on a different circuit than the one to which the receiver is connected.
- Consult the dealer or an experienced radio/TV technician for help.

Note: *Unauthorized modification of the receiver or radio remote control could void the user's authority to operate this equipment.*

This product complies with the Canadian ICES-003 Class B specifications.

Important Safety Instructions

- 18. Use proper power sources** – Plug the product into a proper power source, as described in the operating instructions or as marked on the product.
- 19. Avoid power lines** – Use extreme care when installing an outside antenna system to keep from touching power lines or circuits, as contact with them may be fatal. Do not install external antennas near overhead power lines or other electric light or power circuits, nor where an antenna can fall into such circuits or power lines.
- 20. Ground all outdoor antennas** – If an external antenna or cable system is connected to this product, be sure the antenna or cable system is grounded. This will provide some protection against voltage surges and built-up static charges.
Section 810 of the National Electrical Code ANSI/NFPA No. 70 provides information with respect to proper grounding of the mast and supporting structure, grounding of the lead-in wire to an antenna discharge unit, size of grounding conductors, location of antenna-discharge unit, connection to grounding electrodes, and requirements for the ground electrode. Refer to the antenna grounding illustration on this page.

Antenna grounding

Example of antenna grounding as per National Electrical Code, ANSI/NFPA 70.

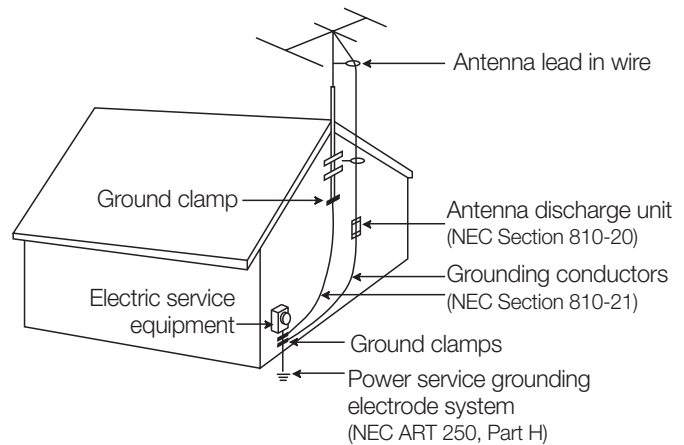

Note to CATV system installer

This reminder is provided to call the CATV system installer's attention to Article 820-40 of the NEC (of USA) that provides guidelines for proper grounding. In particular, it specifies that the cable ground shall be connected to the grounding system of the building, as close to the point of cable entry as is practical.



255805

BOSE
Better sound through research®

©2007 Bose Corporation, The Mountain,
Framingham, MA 01701-9168 USA
255805 AM Rev.03