













Desktop Audio System

**TSX-N237**

**TSX-N237D**

**EN** Owner's Manual

# Table of contents

<b>Introduction .....</b>	<b>3</b>	Adjusting sound quality .....	29
Accessories .....	3	Registering favorites with SCENE .....	30
About this document .....	3	Alarm (IntelliAlarm) .....	31
<b>Using the unit .....</b>	<b>4</b>	Using the sleep timer .....	33
<b>Part names .....</b>	<b>5</b>	Child lock function .....	34
The unit .....	5	Charging a mobile device (Qi) .....	35
Display .....	6	Adjusting display brightness (dimmer) .....	36
Remote control .....	7	Option settings .....	37
<b>Preparation .....</b>	<b>9</b>	 Pair the unit with MusicCast-enabled devices .....	40
Turn on the unit .....	9	 Firmware updates .....	41
Set the unit's clock .....	10	<b>Connecting to a network manually .....</b>	<b>43</b>
 Use MusicCast CONTROLLER to connect to a network .....	11	 Wired network connection .....	43
<b>Play from an input source .....</b>	<b>12</b>	 Using WPS (Wi-Fi Protected Setup) to connect to a network wirelessly .....	44
Listening to an audio CD .....	12	 Using iPhone settings to connect to a network wirelessly .....	45
Listening to music via Bluetooth® .....	13	<b>Troubleshooting .....</b>	<b>46</b>
Listening to DAB stations (Australia, U.K., and Europe models only) .....	15	<b>Messages in the display .....</b>	<b>54</b>
Listening to FM radio stations .....	18	<b>Devices/media, and file formats supported by the unit .....</b>	<b>55</b>
Listening to music on USB flash drives .....	20	<b>Specifications .....</b>	<b>57</b>
Listening to music from an external device .....	21	<b>Trademarks .....</b>	<b>58</b>
Listening to music stored on the mobile device .....	22		
 Listening to Internet radio .....	23		
 Listening to streaming services .....	24		
 Listening to music stored on a media server (computer or NAS) .....	25		
 Listening to music via AirPlay .....	26		
<b>Useful features .....</b>	<b>27</b>		
Shuffle/repeat playback .....	27		
Playback information .....	28		

Functions that require a network connection are indicated with the  icon.

Thank you for purchasing this Yamaha product.  
Before using the unit, be sure to read this document and the supplied "Safety Brochure" to ensure proper and safe use. Keep these documents readily available for future reference.

# Introduction

Confirm package contents and important information about this manual.

## Accessories



Remote control



Non-skid pad (🔗 p. 35)

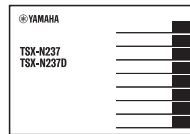

Quick Manual

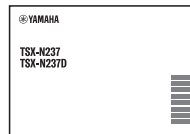

Safety Brochure

## About this document

- This document provides detailed instructions on operating all of the unit's functions.
- Instructions concentrate on use of the remote control to operate the unit.
- Illustrations are provided for reference purposes only, and should not be considered completely accurate in every case.
- In this document, smartphones and other mobile devices running the iOS or Android operating systems are collectively referred to as "mobile devices".
- Screenshots in this document were captured on a device running the English version of iOS. Actual screen displays may differ depending upon the version of the app or iOS used.
- Symbols and conventions



This content indicates "risk of serious injury or death."

### Notice

Indicates points that you must observe in order to prevent product failure, damage or malfunction and data loss, as well as to protect the environment.

### Note

Indicates notes on instructions, restrictions on functions, and additional information that may be helpful.



References another page or pages that provide additional information.

# Using the unit

- This unit is a desktop audio system that can play audio from an incredibly wide range of input sources, including CDs, Bluetooth devices, and radio stations. This unit can also be used with a home network or audio system to play audio from a media server (computer or NAS), Internet radio, or AirPlay devices on the same network.
- This unit is equipped with a convenient charging function and an alarm function that wakes you gently.
- The free dedicated MusicCast CONTROLLER app for mobile devices can be used to easily control playback or configure the unit's settings. Download the MusicCast CONTROLLER app to your mobile device from the App Store or Google Play™.

**IntelliAlarm wakes you up gently.**  
“Alarm (IntelliAlarm)” (☞ p. 31)

**Support for a broad range of input sources.**  
“Play from an input source” (☞ p. 12)

**The unit’s top panel supports wireless smartphone charging.**  
“Charging a mobile device (Qi)” (☞ p. 35)

\* A wireless LAN router (access point) is required when using a mobile device.

# Part names

## The unit

①, ②, ③, ⑥, and ⑦ are touch sensors. Tap icons with your finger to control functions.

### Top /front panels

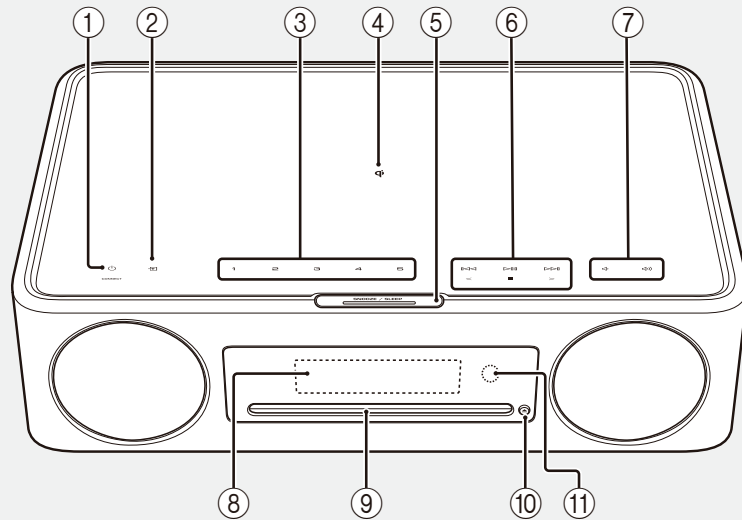

### Rear panel

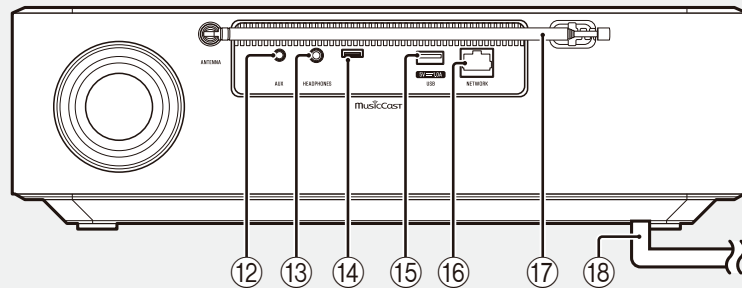

- ① Turn the unit on and off (standby)/CONNECT (☞ p. 9, 11).
- ② Switch the input source.
- ③ **1, 2, 3, 4, 5** SCENE function (☞ p. 30)
- ④ Wireless charger (☞ p. 35)
- ⑤ SNOOZE/SLEEP (☞ p. 33, 31)
- ⑥ Control audio (☞ p. 12).
- ⑦ Volume -/+
- ⑧ Display (☞ p. 6)
- ⑨ Disc slot (☞ p. 12)
- ⑩ Eject a disc (☞ p. 12).
- ⑪ Remote sensor (☞ p. 9)
- ⑫ AUX jack (Mini jack input) (☞ p. 21)
- ⑬ HEADPHONES jack  
No sound is heard from the unit when the headphones are connected.
- ⑭ Service jack  
Use when the unit requires maintenance.
- ⑮ USB jack (☞ p. 20)
- ⑯ NETWORK jack (☞ p. 43)  
The unit can be connected to a network using either a wired or a wireless connection. For a wired network connection, connect a standard shielded twisted pair (STP) network cable (straight, category 5 or higher; sold separately).
- ⑰ FM antenna (☞ p. 18)  
FM/DAB antenna (Australia, U.K., and Europe models only) (☞ p. 15)
- ⑱ Power cord (☞ p. 9)

# Display

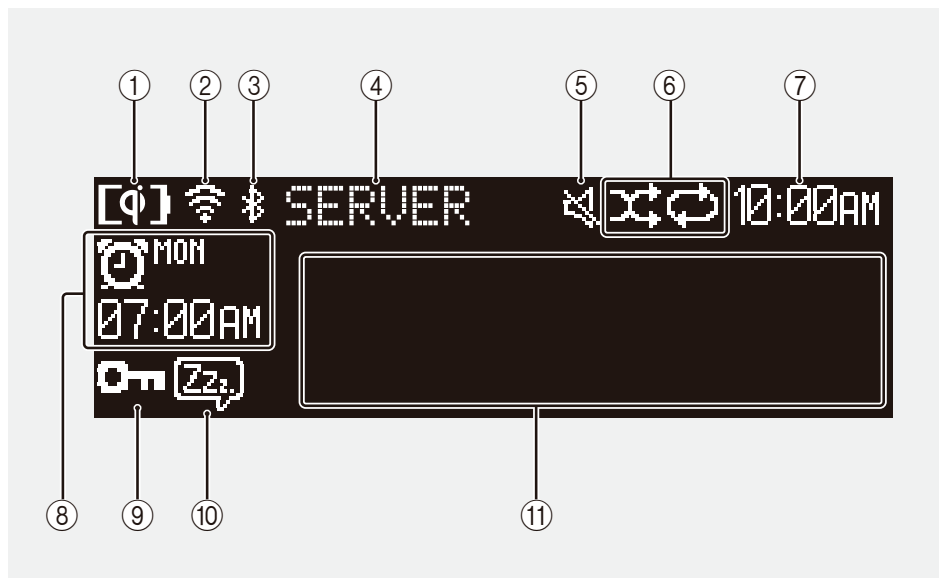

① Qi wireless charging indicator (☞ p. 35)

② Wireless LAN indicator (☞ p. 45)

Glow steadily when the unit is connected to a wireless LAN router via Wi-Fi. If the unit is connected to other MusicCast-enabled devices, this indicator will glow steadily even if the unit is connected to the network via a network cable.

③ Bluetooth indicators (☞ p. 13)

④ Input source indicator

The selected input source is displayed.

⑤ Mute indicator

The indicator is displayed while muted.

⑥ Shuffle and repeat indicators (☞ p. 27)

⑦ Current time

⑧ Alarm indicators (☞ p. 31)

⑨ Child lock indicator (☞ p. 34)

⑩ Sleep indicator (☞ p. 33)

⑪ Multi display

Displays a variety of information, including that for a song as it plays, radio frequency, etc.

Some information may be cut off as there is a limit on the number of characters that can be displayed.

## Note

Display brightness can be adjusted as required.

- Automatic (default setting; adjusted automatically in accordance with ambient lighting.)
- Manual (10 levels)

See "Adjusting display brightness (dimmer)" (☞ p. 36) to configure this function.

# Remote control

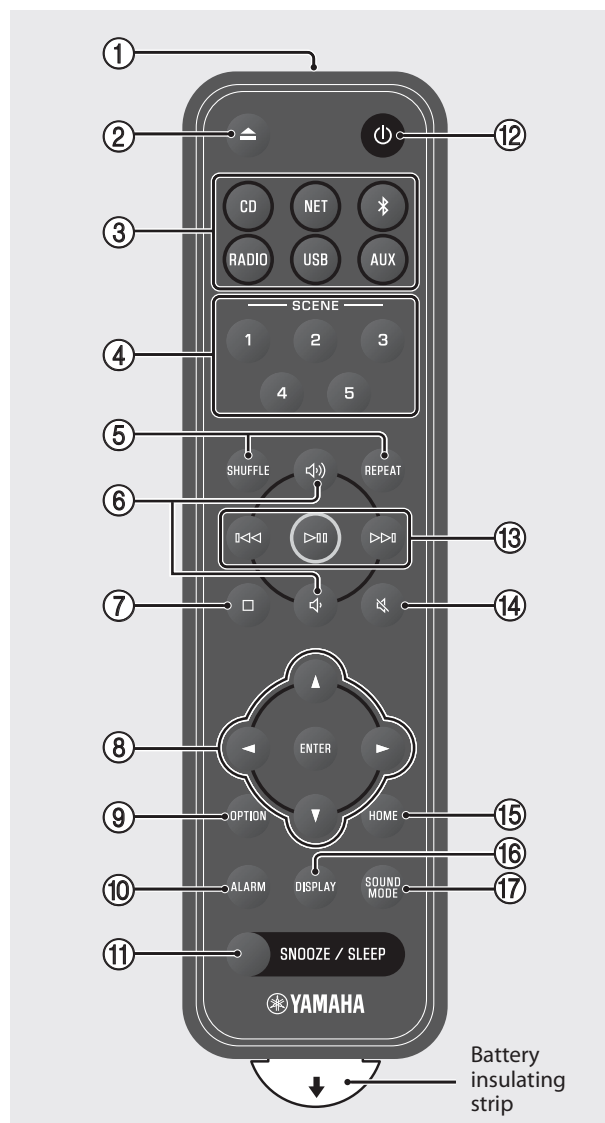

- ① Transmit infrared (IR) signals (☞ p. 9).
- ② ▲ Eject a disc (☞ p. 12).
- ③ Input source buttons (☞ p. 12)  
Switch the input source.
- ④ SCENE function (☞ p. 30)
- ⑤ SHUFFLE/REPEAT (☞ p. 27)
- ⑥ 🔊/🔊 Volume +/-
- ⑦ □ Stop playback (☞ p. 12, 20).
- ⑧ Cursor control buttons (☞ p. 10)
- ⑨ OPTION (☞ p. 37)
- ⑩ ALARM (☞ p. 31)
- ⑪ SNOOZE/SLEEP (☞ p. 33, 31)
- ⑫ ⏻ Turn the unit on and off (standby)  
(☞ p. 9).
- ⑬ Audio control buttons (☞ p. 12)
- ⑭ 🔇 Mute/unmute
- ⑮ HOME (☞ p. 23, 24)
- ⑯ DISPLAY (☞ p. 28)
- ⑰ SOUND MODE (☞ p. 29)

Remove the battery insulating strip before attempting to use the remote control.

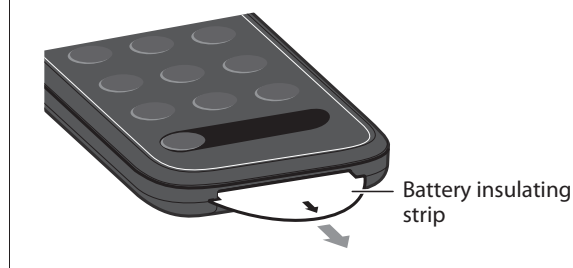

## Replacing the remote control battery

Press the release tab firmly to the right and hold it there while slowly sliding the battery holder out.

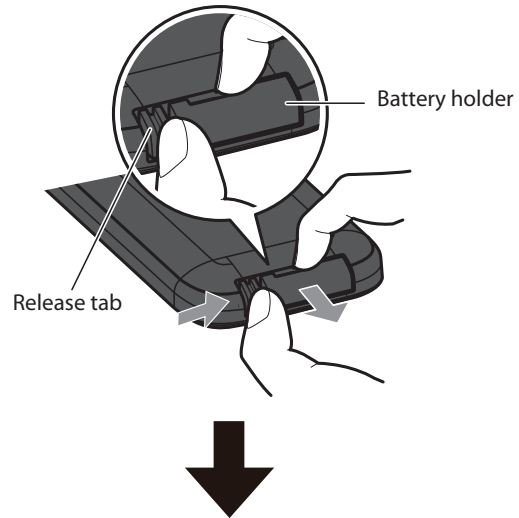

Replace the old battery with a new one.

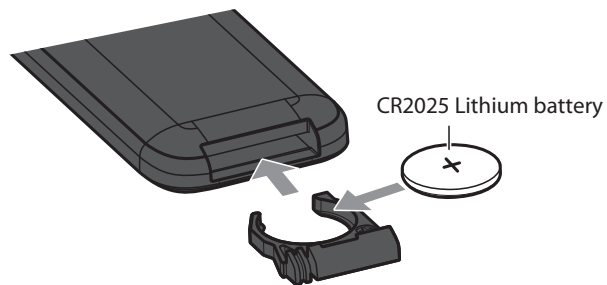

### **Note**

Replace the old battery with a new one when the remote control's range becomes very short.



## Turn on the unit

**1** Plug the power cord into an electrical outlet.

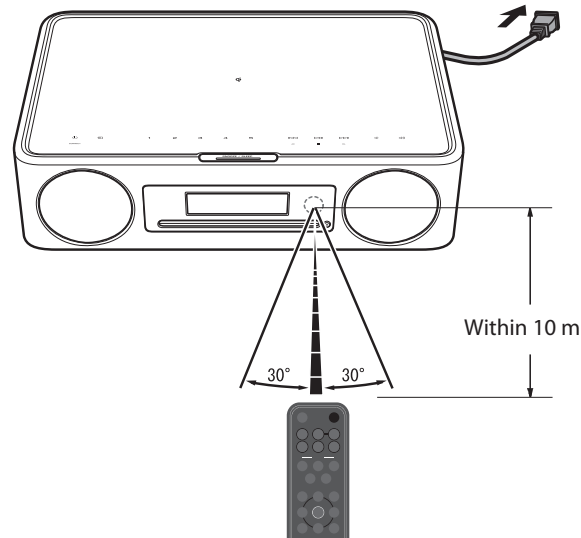

**2** Press  to turn on the unit.

The display on the front panel will be turned on.

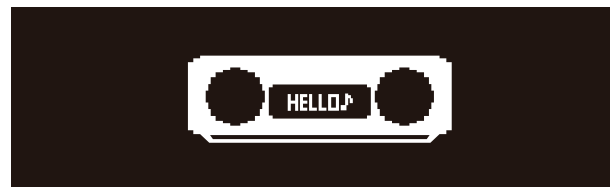

## Reducing power consumption

### Auto power standby (default: disable)

The unit will automatically enter auto power standby mode in any of the following situations:

- CD, BLUETOOTH, or USB is selected as the input source, but no audio is played and no operations are performed for more than 20 minutes.
- An input source other than any of those noted above is selected, but no operations are performed for more than 8 hours.

See "Auto Power OFF" in "Option settings" to enable the auto power standby function ( p. 37).



# Set the unit's clock

When the MusicCast CONTROLLER app is used to connect the unit to a network, the unit's clock can be set automatically. If you will utilize this feature, skip the procedure described below.



**1** Press **OPTION**.

The option menu is displayed.

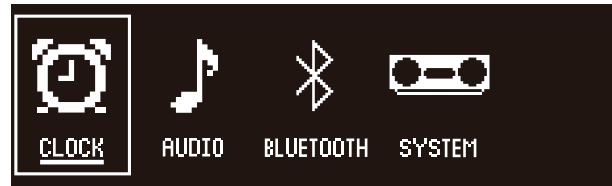

**2** Use ◀/▶ to select  and press **ENTER**.

**3** Use ▲/▼ to select **Clock setting** and press **ENTER**.

**4** Use ▲/▼/◀/▶ to adjust the date and time.

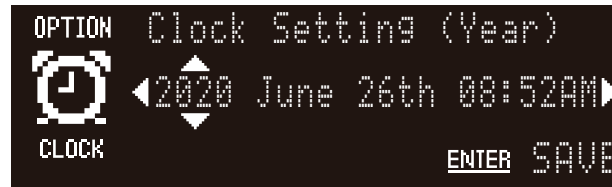

**5** Press **ENTER** to finalize and apply clock settings.

# Use MusicCast CONTROLLER to connect to a network

- 1 Download the dedicated MusicCast CONTROLLER app to your mobile device on the App Store or Google Play.

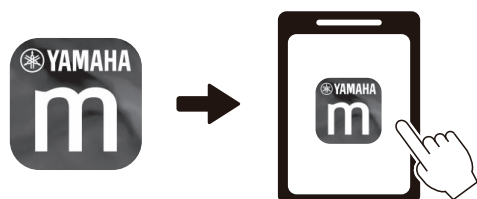

- 2 Follow the app's on-screen instructions to configure network settings.

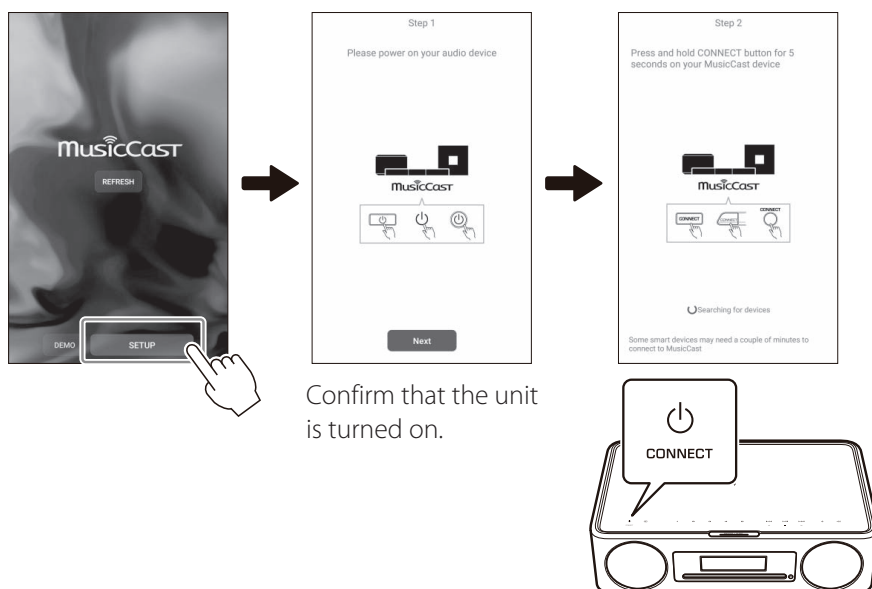

Confirm that the unit is turned on.

## Note

- See the following when connecting to a network without using the MusicCast CONTROLLER app.
  - Using a network cable to connect to a network (☞ p. 43)
  - Using Wi-Fi Protected Setup (WPS) to connect to a network wirelessly (☞ p. 44)
  - Using iPhone settings to connect to a network wirelessly (☞ p. 45)
 After connecting to a network using one of the methods described above, Yamaha recommends downloading and installing the MusicCast CONTROLLER app to your mobile device for simple operation of the unit.
- For more information on Internet connections, refer to the documentation provided with your network devices.
- Security software installed on your computer or network device settings (firewall, etc.) may prevent the unit from accessing your computer or Internet radio stations. If this occurs, modify security software or network device settings to permit access by the unit.

## Important notice regarding information security

Visit the website shown below for details.



<https://manual.yamaha.com/av/policy/mcc/>

# Play from an input source

## Listening to an audio CD

**1** Press **CD**.

**2** Insert a CD into the disc slot.

Music begins playing. Press ▲ to eject a CD.

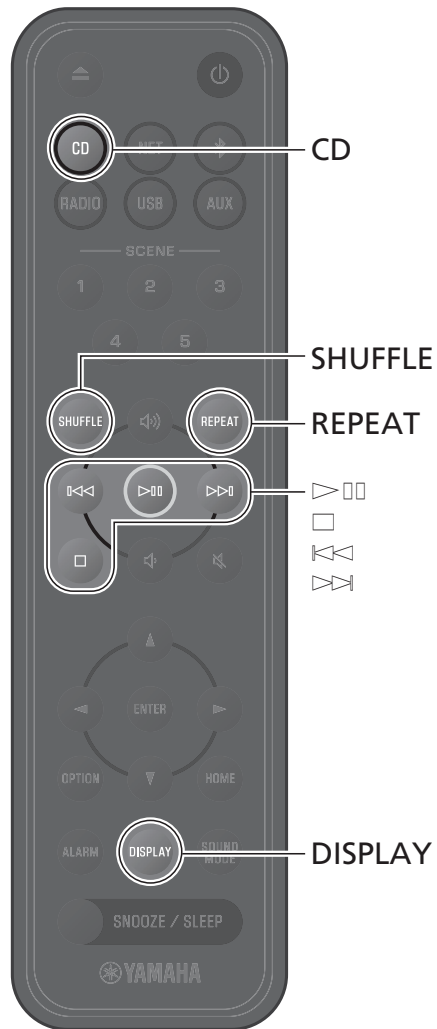
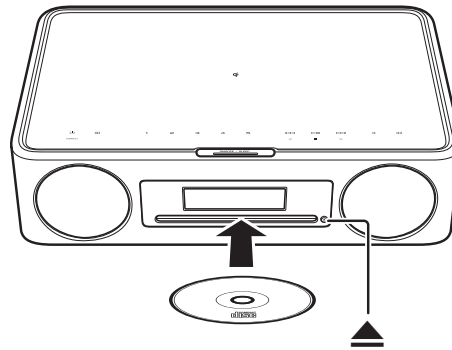

### Note

- This unit supports playback of audio and data CDs to which MP3 and or WMA files have been recorded.
- Music files stored on a data CD can be played using the same operations used to play music stored on a USB flash drive (☞ p. 20).
- This unit does not support 8-cm mini CDs. Do not insert an 8-cm mini CD, or an adapter containing an 8-cm mini CD, into the disc slot.
- If a CD that is not supported by the unit is inserted into the disc slot, it may not be possible to eject the CD. See “Devices/media, and file formats supported by the unit” for information on CDs supported by the unit (☞ p. 55).
- When CD playback is stopped, playback will resume from the beginning of the song last played. Pressing □ while playback is stopped will clear playback memory (resume playback feature).
- If the unit is turned off when CD has been selected as the input source and a CD has been inserted into the disc slot, CD playback will automatically begin the next time the unit is turned on.

### Audio control buttons

▶◻◻	Play/pause
◻	Stop
◀◀◀	Skip to the beginning of the song being played or previous song. Press and hold to fast rewind.
▶▶▶	Skip to the next song. Press and hold to fast forward.
DISPLAY	Information about an audio CD being played is displayed. (☞ p. 28)
SHUFFLE/ REPEAT	☞ p. 27

## Listening to music via Bluetooth®

The unit can be used to play music from a Bluetooth device, such as a mobile device or digital music player. In addition, Bluetooth wireless headphones or speakers can be used to listen to audio played via the unit.

For more information regarding Bluetooth, see documentation provided with Bluetooth devices.

### Note

- A Bluetooth device that transmits audio to the unit and Bluetooth speakers/headphones that receive audio from the unit cannot be connected at the same time.
- If a Bluetooth device has been connected before, the unit will connect to the last connected device. Terminate this connection to connect a new device.
- Press  for at least three seconds to terminate the Bluetooth connection on the unit.

### Listening to music from a Bluetooth device (Receiving)

Audio from a Bluetooth device can be played on the unit over a wireless connection.

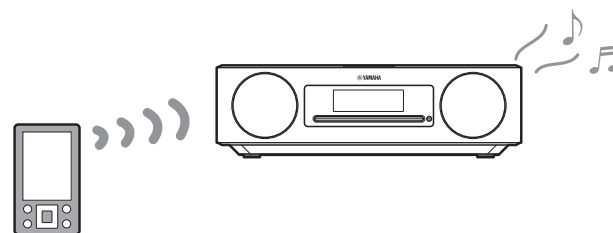

### 1 Press .

The unit's input source is switched to Bluetooth.

### 2 Enable the Bluetooth function of the Bluetooth device.

### 3 Select this unit from the Bluetooth device list on the Bluetooth device.

The Bluetooth indicators will be displayed once the connection has been established.



### 4 Play a music file on the Bluetooth device.

### Note

If a Bluetooth connection is not established, delete the unit's registration from the Bluetooth device, and then try to repeat steps **1-3**.



## Using Bluetooth speakers/headphones to listen to audio (transmitting)

Bluetooth speakers or headphones can be used to listen to audio played via the unit. This function can only be controlled using the MusicCast CONTROLLER app.

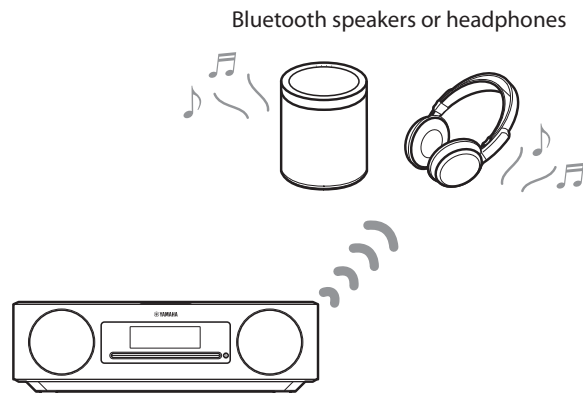

### Note

- This function cannot be used when Bluetooth is selected as the input source. Select an input source other than Bluetooth.
- Be sure to use Bluetooth speakers or headphone that are equipped with a volume control. Volume must be adjusted using the Bluetooth speakers or headphones. Volume cannot be adjusted from this unit.
- Use the volume control on the Bluetooth speakers or headphones to turn down the volume, and then connect the speakers or headphones to the unit. Failure to turn down the volume before connecting may result in extremely loud playback to begin when the Bluetooth connection is established.

- 1 Set Bluetooth speakers or headphones to pairing mode.
- 2 Use the MusicCast CONTROLLER app to select an input source.

- 3 Tap  in the playback screen.

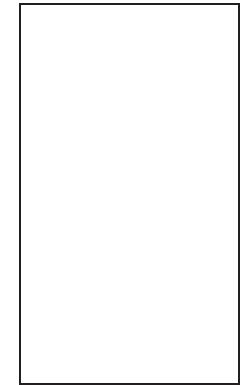

- 4 Tap **Bluetooth Transmission** in the **Sound Settings** screen.

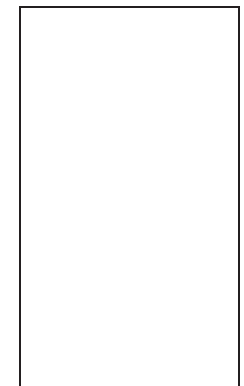

- 5 Enable the **Bluetooth transmission** function in the **Bluetooth Transmission** screen.
- 6 Select the Bluetooth speakers or headphones to be connected.

### Note

- If a Bluetooth connection is not established, repeat the connection procedure from step **1**.
- If Bluetooth speakers or headphones have been previously connected to the unit, the unit will connect to the last connected device when transmitting mode is applied.

# Listening to DAB stations (Australia, U.K., and Europe models only)



## Initial scan

Press **RADIO** repeatedly to select **DAB**.

- Initial scan starts automatically when you select **DAB** for the first time.
- When scanning is completed, the number of receivable DAB stations is displayed momentarily, and the first station stored is played.

## Tuning in DAB stations

**1** Press **RADIO** repeatedly to select **DAB**.

When the unit cannot receive the DAB signal, "Off Air" is displayed.

**2** Press ◀ or ▶ to select a DAB station.

### Note

- Initial scan can also be performed from the option settings.
  - 1 Press **OPTION** when **DAB** is selected as the input source.
  - 2 Use ◀/▶ to select , and press **ENTER**.
  - 3 Use ▲/▼ to select **Initial scan**, and press **ENTER**. The initial scan display is shown.
  - 4 Use ◀/▶ to select **OK**, and press **ENTER** to begin the initial scan. "Complete" is displayed when the initial scan is complete.
- If an initial scan is performed, stored DAB station information and preset DAB stations are cleared.
- This unit can receive only Band III DAB frequencies.

Frequency in MHz/Channel label

174.928/5A	176.640/5B	178.352/5C	180.064/5D
181.936/6A	183.648/6B	185.360/6C	187.072/6D
188.928/7A	190.640/7B	192.352/7C	194.064/7D
195.936/8A	197.648/8B	199.360/8C	201.072/8D
202.928/9A	204.640/9B	206.352/9C	208.064/9D
209.936/10A	211.648/10B	213.360/10C	215.072/10D
216.928/11A	218.640/11B	220.352/11C	222.064/11D
223.936/12A	225.648/12B	227.360/12C	229.072/12D
230.784/13A	232.496/13B	234.208/13C	235.776/13D
237.488/13E	239.200/13F		

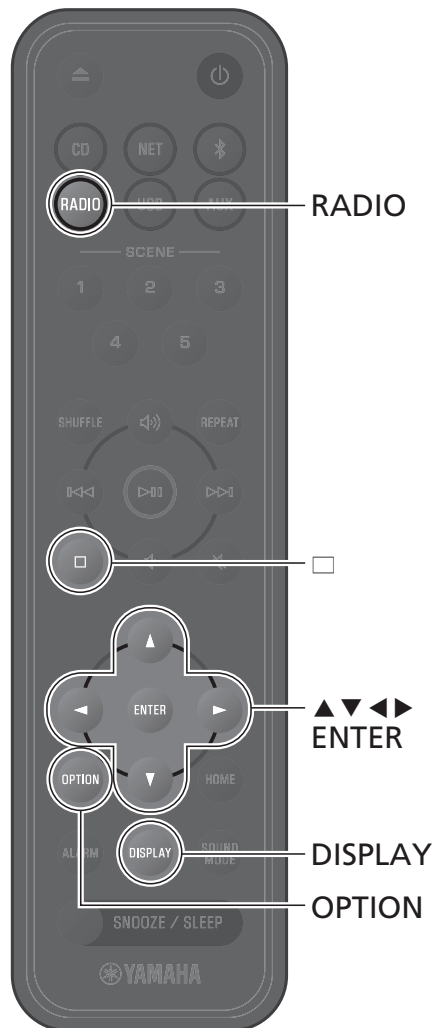

## Presetting DAB stations

Use the preset function to store your favorite 40 DAB stations.

- 1 Tune in to a DAB station (🔗 p. 15).
- 2 Press and hold **ENTER**.  
The preset display is shown.
- 3 Press ▲/▼ to select the required preset number, and press **ENTER**.  
To cancel the DAB preset setting, press □.

## Selecting preset DAB stations

- 1 Press **RADIO** repeatedly to select **DAB**.
- 2 Press ◀/▶ to select a preset station.

### Note

DAB station information shown in the display is switched in the following order each time **DISPLAY** is pressed.

Station Label (up to 8 characters), Preset number (default)
DLS (Dynamic Label Segment)
Ensemble Label
Channel label, Frequency, Signal Quality
Audio format, DRC

## Deleting a preset DAB station

- 1 Press **OPTION** when **DAB** is selected as the input source.
- 2 Press and hold  **ENTER**.  
The preset deletion display is shown.
- 3 Use ▲/▼ to select **Delete ALL** or the preset number to be deleted, and press **ENTER**.
- 4 Use ◀/▶ to select **OK**, and press **ENTER**.
- 5 Press **OPTION** to exit the settings display.





## Confirming the reception

You can confirm the DAB signal level. This is useful when setting up the antenna.

- 1 Press **OPTION** when **DAB** is selected as the input source.
- 2 Use ◀/▶ to select , and press **ENTER**.
- 3 Use ▲/▼ to select **Tuning Aid**, and press **ENTER**.  
The Tuning Aid display is shown.
- 4 Press **ENTER**.
- 5 Press ▲/▼ to change the channel label.  
The measured DAB signal reception level is displayed.



The level is from 0 (none) to 100 (best).

- 6 Press **OPTION** to exit the settings display.

### Note

When the DAB signal is weak in Tuning Aid, try adjusting the position of the antenna to obtain good reception.

# Listening to FM radio stations

Extend the antenna and position it for good FM reception.



## Tuning in to a station

- 1 Press **RADIO**.
- 2 Press and hold **▲** or **▼**.

Automatic tuning starts. Tuning will stop automatically when a station is tuned in.



### Note

If station reception is weak, tune in to a station manually by pressing **◀/▶** repeatedly. Sound will be heard in monaural.

## Presetting stations

### Auto preset

The unit tunes in stations with good reception and presets them automatically.

- 1 Press **RADIO**.
- 2 Press **OPTION**.
- 3 Use **◀/▶** to select , and press **ENTER**.
- 4 Use **▲/▼** to select **Auto preset**, and press **ENTER**.
- 5 Use **◀/▶** to select **OK**, and press **ENTER**.

Auto preset begins. "Complete" is displayed when auto preset is complete.

### Note

- Auto preset replaces all stations currently stored with new stations.
- Up to 40 FM stations can be preset.
- Press **OPTION** to cancel auto preset.

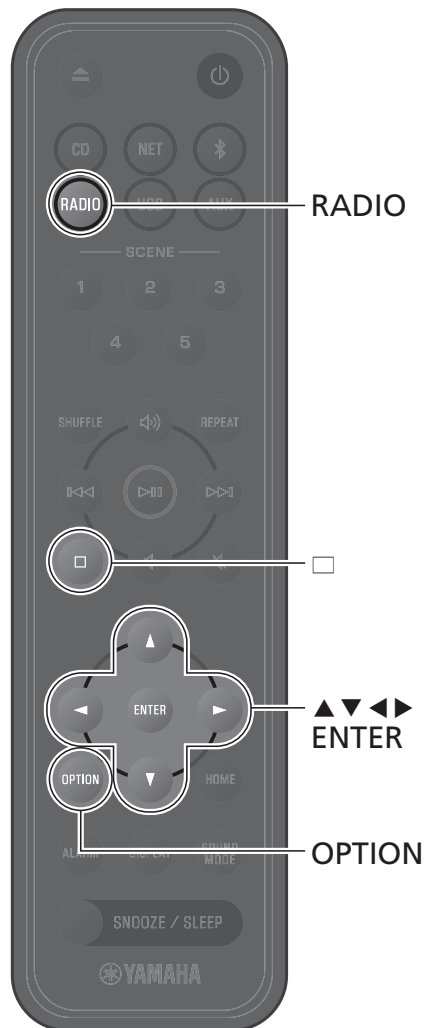

### Manual preset

**1** Tune in to a station (🔍 p. 18).

**2** Press and hold **ENTER**.

The manual preset display is shown.



**3** Press **▲/▼** to select the required preset number, and press **ENTER**.

#### Note

Press □ to cancel manual preset.

### Selecting a preset station

**1** Press **RADIO**.

**2** Press **◀/▶** to select a preset station.

### Deleting a preset station

**1** Press **RADIO**.

**2** Press and hold □.

The preset deletion display is shown.

**3** Use **▲/▼** to select **Delete ALL** the preset number to be deleted, and press **ENTER**.

**4** Use **◀/▶** to select **OK**, and press **ENTER**.

**5** Press **OPTION** to exit the settings display.

# Listening to music on USB flash drives

- 1 Press **USB**.
- 2 Connect a USB flash drive to the USB jack.

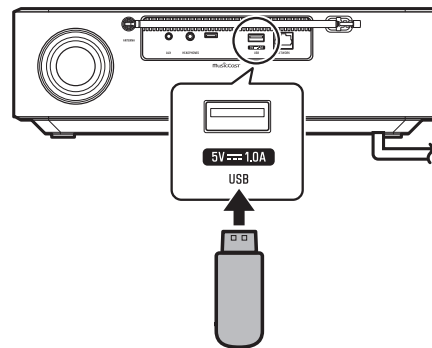
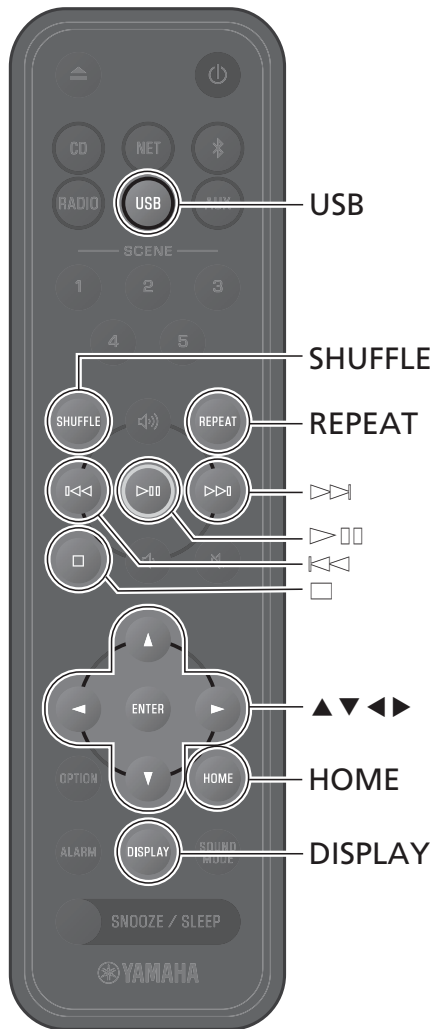

- 3 **Play a song.**  
Use the following buttons to play a song.

▲/▼/◀/▶	Control menu items.
⏮	Skip to the beginning of the song being played or previous song. Press and hold to fast rewind.
⏭	Skip to the next song. Press and hold to fast forward.
▶⏸	Play/pause
◻	Stop

SHUFFLE/ REPEAT	☞ p. 27
HOME	Move to the top layer of the folder hierarchy.
DISPLAY	Information about content being played is displayed. (☞ p. 28)

**Note**

- Music files stored on USB flash drives can be played via the unit. See “Devices/media, and file formats supported by the unit” for information on USB flash drives supported by the unit (☞ p. 56).
- Some USB flash drives may not work properly even if they meet the requirements. Playability of and power supply to all USB flash drives are not guaranteed.
- Stop playback before disconnecting the USB flash drive.
- A USB flash drive is automatically charged as long as it is connected to the unit. However, some devices may not charge when connected. See “Power Off Charge” in “Option settings” to disable the charge function (☞ p. 37).
- Connect a USB flash drive directly to the USB jack of the unit. Do not use extension cables.

# Listening to music from an external device

Music played on an external device connected to the AUX jack on the unit's rear panel can be heard through this unit. See documentation supplied with the external device for more information.



- 1** Unplug the power cord from the electrical outlet, and connect the external device to the unit.

Use cables sold separately for connections.

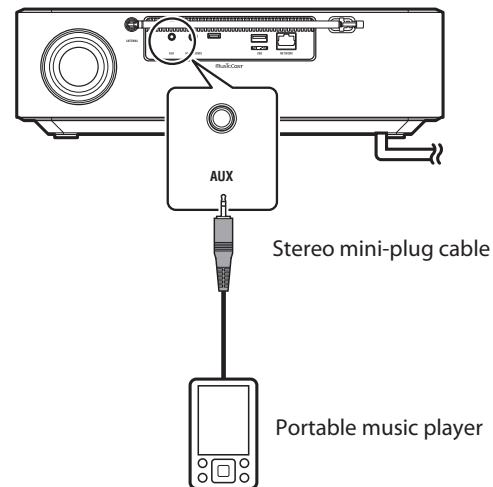

- 2** Plug the power cord into an electrical outlet, and turn on the unit.
- 3** Press **AUX**.

- 4** Play the external device connected to the unit.

**Note**

**Lower the volume sufficiently on the unit and external device before connection.** Otherwise, the volume may be unexpectedly loud when music begins playing.

# Listening to music stored on the mobile device

The unit can be used to play music files stored on the mobile device to which the MusicCast CONTROLLER app has been installed.

## **Note**

The types (formats) of audio files that can be played vary by mobile device. See documentation provided with your mobile device for information on the supported file formats.

- 1** Select this unit (specified room).
- 2** Select the mobile device to which the MusicCast CONTROLLER app has been installed.

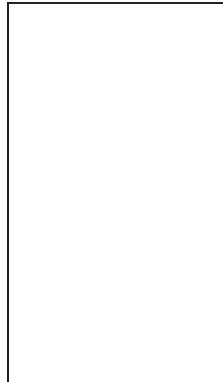

- 3** Select a music file.

Music begins playing.

# Listening to Internet radio

Use the MusicCast CONTROLLER app to listen to Internet radio.

- 1 Select this unit (specified room).
- 2 Select **Net Radio**.

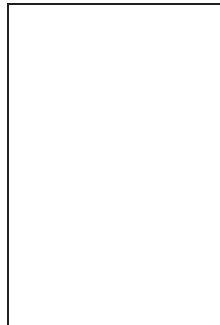

- 3 Select a radio station.

The radio broadcast begins playing and information is shown in the unit's display.



**Note**

- Internet radio stations can be registered as favorites with the unit using the MusicCast CONTROLLER app.
- Some Internet radio stations may not be available, or may be available only during certain hours.
- This function uses airable.Radio's extensive catalog. "airable" is a service of airable GmbH.
- This service may change, be discontinued, or be terminated without notice.

The remote control can also be used to control Internet radio listening.

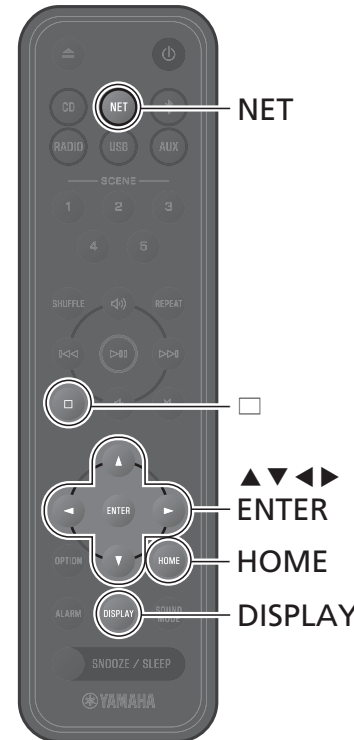



- 1 Press **NET** repeatedly to select **NET RADIO**.



- 2 Brows and select a radio station.

Remote control functions

	Move between options and layers of the folder hierarchy.
ENTER	Finalize the selected option.
HOME	Move to the top layer of the folder hierarchy.
DISPLAY	Display information regarding content being played.
	Stop playback.

## Listening to streaming services

This unit can be used to listen to content delivered by streaming services. The services available vary depending upon the unit and/or region. You can only listen to services that both have a local service area and are supported by the unit.

Streaming services supported by the unit are displayed in the MusicCast CONTROLLER screen. However, you can only listen to those operating locally (you cannot listen to services if you are outside of their service area).

To listen to a streaming service, sign-in to your account for that service from the MusicCast CONTROLLER app and start using the service.



Streaming services can also be selected by pressing **NET**. Previously selected content will play.

### **Note**

- Some streaming services require users to apply and pay for an account. For more information, visit the website for the particular service.
- Streaming services may change, be discontinued, or be terminated without notice.



# Listening to music stored on a media server (computer or NAS)

Music files stored on a media server (computer or network attached storage (NAS) device) on the same network as the unit can be played.

**Note**

- Connect the unit and computer (or NAS) to the same wireless LAN router (access point).
- Media sharing must be enabled for all applicable devices and media server software before music files can be played. For more information, see documentation supplied with devices and software for instructions on enabling media sharing.
- For information on music files that can be played using the unit, see “Devices/media, and file formats supported by the unit” (p. 55).

Play a music file using the MusicCast CONTROLLER app.

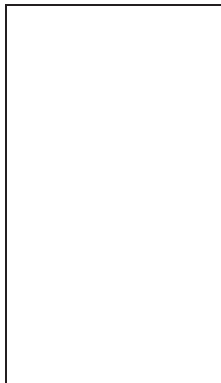

The remote control can be used to control the playback of music files on the media server.

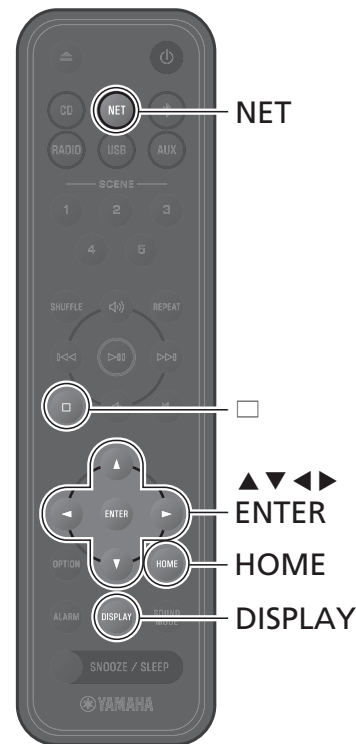



**1** Press **NET** repeatedly to select **SERVER**.



**2** Brows and select a music file.

Remote control functions

	Move between options and layers of the folder hierarchy.
ENTER	Finalize the selected option.
HOME	Move to the top layer of the folder hierarchy.
DISPLAY	Display information regarding content being played. Press and hold <b>DISPLAY</b> to switch the time counter at the bottom of the display between a bar display and a numerical display.
	Stop playback.

# Listening to music via AirPlay

Music files in iTunes, or stored on an iPhone, can be played using the AirPlay function.

## **Note**

- Connect the unit, computer (or NAS), and iPhone to the same wireless LAN router (access point).
- For information on the iPhone supported by the unit, see "Devices/media, and file formats supported by the unit" (☞ p. 55).
- For information on AirPlay, visit the Apple website.

## **1** Start iTunes, or display the iPhone's music playback screen.

When iTunes, or the iPhone, recognizes the unit, the AirPlay icon will be displayed on the screen.



## **Note**

If the icon is not displayed, check to see that the unit and the computer (or iPhone) are correctly connected to the wireless LAN router.

## **2** Click or tap the AirPlay icon, and select the unit (a room specified for the unit) as the audio output destination.

## **3** Play a music file.

The unit's input source changes to AirPlay, and music will begin playing.

# Useful features

Features such as shuffle and repeat playback, display of song information, and a SCENE function make this unit even more convenient and enjoyable to use.

## Shuffle/repeat playback

Press **SHUFFLE** or **REPEAT** during playback.

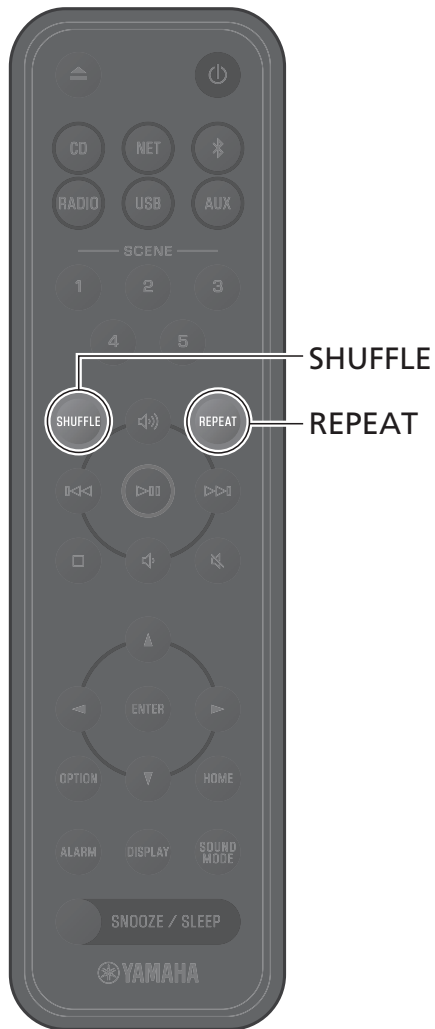

The indicators will change each time **SHUFFLE** or **REPEAT** is pressed, and songs will play as follows.



### Shuffle playback

Shuffle indicators	Audio/data CD, USB, media server
	Shuffle all songs
Goes off	The shuffle function is not applied.

### Repeat playback

Repeat indicators	Audio/data CD, USB, media server
	Repeat all songs
	Repeat the song being played.
Goes off	The repeat function is not applied.

# Playback information

While content from input sources below is being played, information such as playing time can be shown in the display.



Press **DISPLAY** during playback.

The display switches each time **DISPLAY** is pressed.





## Note

Press and hold **DISPLAY** to switch the playing time or remaining time display between a bar display and a numerical display.

## Audio CD

Display	Information
	Song title
	Artist name
	Album title

**Data CD, USB, SERVER (music files stored on a computer or NAS), or NET RADIO (Internet radio)**

Display	Information
	Song title
	Artist name
	Album title
	Folder name
	File name

## Note

Information such as the album title may not be properly displayed for songs played from some types of media.



# Adjusting sound quality

Adjust audio parameters as needed to suit individual preferences.

## Adjusting tones

Adjust the level at which low, middle, and high tones are output.

### Note

Press **OPTION** to cancel setup before it is completed.

- 1 Press **OPTION**.
- 2 Use ◀/▶ to select  and press **ENTER**.
- 3 Use ▲/▼ to select **EQ setting** and press **ENTER**.
- 4 Adjust low, middle, and high tones.

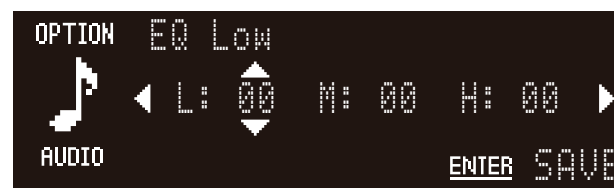

Use ▲/▼ to change the level. Use ◀/▶ to select another tone. Press **ENTER** to save settings.

Default: 0

Adjustable level: -10 to +10

- 5 Press **OPTION** to exit the settings display.

## Selecting the sound mode

Each time **SOUND MODE** is pressed, sound mode is switched between Bass Boost and Standard.

- Bass Boost (default)  
Best for music
- Standard  
Best for human voices (talk radio, etc.)

### Note

Sound mode is not available when headphones are connected to the unit.



## Registering favorites with SCENE

Favorite songs and radio stations can be assigned to the SCENE (1 to 5) buttons. Once registered, favorites can easily be selected for listening.

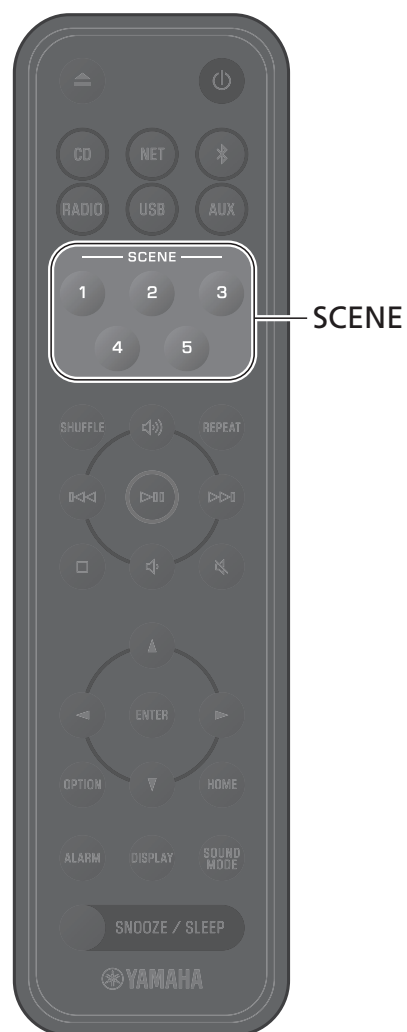

### Registering favorites

Press and hold one of the SCENE buttons while the input source to be registered is playing.

The song or radio station that is playing will be assigned to that SCENE button.



### Listening to favorites

Press the SCENE button to which a favorite song or radio station has been assigned.

- The song or radio station assigned to that SCENE button will play. When the SCENE button is pressed in standby mode, the unit will be turned on and playback will begin.
- Individual songs stored on a Bluetooth or other external device cannot be assigned to SCENE buttons. The Bluetooth or other external device will be selected as the input source by pressing the SCENE button to which it has been assigned.

#### Note

- When a favorite is registered with a SCENE button to which another favorite was previously assigned, the new favorite will replace the previous favorite.
- If an audio/data CD not registered with a SCENE button is loaded in the unit, or a USB flash drive not registered with a SCENE button is connected to the unit, the song assigned to a SCENE button will not play when the SCENE button is pressed.

# Alarm (IntelliAlarm)

Five alarm options—music, beeps, combination of music and beeps—are available. A CD, USB flash drive, radio station, or network content can be selected as the source of music used for the alarm (alarm source).

## Alarm type

<b>Music only</b>	Music begins playing at the specified time. Music begins playing at low volume 10 seconds prior to the specified time, increasing to the specified volume at the specified time.
<b>Music + beeps</b>	Music begins playing at the specified time and beeps begin sounding at the same time. Music begins playing at low volume three minutes prior to the specified time, increasing to the specified volume at the specified time. Beeps begin sounding over the music at the specified time.
<b>Beeps only</b>	Beeps begin sounding at the specified time.

## Alarm sources (CD, USB flash drive, radio station, and network content)

The following types of playback can be selected according to the alarm source.

### Note

When using a CD, USB flash drive, or network content as the alarm source, be sure the CD is loaded, the USB flash drive is connected, or the unit is connected to a network. If the proper alarm source is not available, music will not play, and only beeps will sound when the alarm is triggered.

<b>CD</b>	<b>Audio CD</b>	<ul style="list-style-type: none"> <li>• <b>Specified song:</b> Play the specified song repeatedly.</li> <li>• <b>Resume playback:</b> Play from the last song played.</li> </ul>
	<b>Data CD</b>	<ul style="list-style-type: none"> <li>• <b>Specified folder:</b> Play the specified folder.</li> <li>• <b>Resume playback:</b> Play from the last song played.</li> </ul>
<b>USB</b>		<ul style="list-style-type: none"> <li>• <b>Resume playback:</b> Play from the last music file played.</li> </ul>
<b>Radio station</b>		<ul style="list-style-type: none"> <li>• <b>Specified radio station:</b> Select from preset stations to play (🔊 p. 16, 18).</li> <li>• <b>Resume playback:</b> Play the radio station last received.</li> </ul>
<b>Note</b>		
Network content can only be selected using the MusicCast CONTROLLER app.		
<b>Network content</b>		<ul style="list-style-type: none"> <li>• <b>Specified network content:</b> Select from network content such as Internet radio that has been registered with the MusicCast CONTROLLER app.</li> <li>• <b>Resume playback:</b> Play the last network content played.</li> </ul>



## Setting the alarm

### 1 Press **ALARM**.

The alarm setup display in the option settings is shown.

#### **Note**

Press **OPTION** to close the alarm display while setting the alarm.

### 2 Use ▲/▼ to select the alarm number (1 to 5) and press **ENTER**.

### 3 Configure the alarm function.

Use ▲/▼ to select the item and then press **ENTER** to complete setup.

- ① Hour and minute
- ② Alarm type (☞ p. 31)
- ③ Alarm source (☞ p. 31)
- ④ Playback type (☞ p. 31)
- ⑤ Repeat (Day of the week can be specified using the Multimedia Music Controller app.)
- ⑥ Volume

### 4 Press **OPTION** to exit the settings display.

The alarm indicator is displayed.



## Turning on and off the alarm

### 1 Press **ALARM**.

The alarm display in the option settings is shown.

### 2 Use ▲/▼ to select the alarm number and press **ENTER**.

### 3 Use ▲/▼ to select **ON** or **OFF**.

### 4 Press **OPTION** to exit the settings display.

When the alarm is turned on, the alarm indicator is displayed.





## Stop the alarm

### Stop the alarm temporarily

Press **SNOOZE/SLEEP** while the alarm is sounding to stop the alarm. The alarm stops temporarily and begins sounding again five minutes later (snooze function).

#### Note

When "Music + beeps" is selected as the alarm type, pressing **SNOOZE/SLEEP** while the alarm is sounding will stop only the beeps. Press **SNOOZE/SLEEP** again to stop the music as well. Note that the alarm will sound again five minutes later.

### Stop the alarm completely

Press and hold **SNOOZE/SLEEP** or press **ALARM** once while the alarm is sounding to stop the alarm completely.

#### Note

If the alarm is not stopped manually, it will stop automatically after 60 minutes have passed.

## Using the sleep timer

The unit automatically enters standby mode when the specified time has elapsed. The time can be selected from 30, 60, 90, or 120 minutes, or the sleep timer can be disabled (OFF).

### Press **SNOOZE/SLEEP**.

The time selected changes each time **SNOOZE/SLEEP** is pressed. The sleep indicator is displayed when the sleep timer is set.



#### Note

To cancel the sleep timer, press **SNOOZE/SLEEP**.

## Child lock function

The child lock function disables operations from the controls on the unit to prevent unintended or accidental operation. This function is disabled by default. When the child lock function is enabled, only the following functions can be operated via the controls on the unit. Use the remote control or MusicCast CONTROLLER app to operate other functions.

- turn on the unit/set the unit to standby mode
- stop the alarm
- insert a CD  
Take all necessary precautions to prevent children from inserting other objects into the disc slot.

### Enabling/disabling the child lock function

- 1 Press **OPTION**.
- 2 Use **◀/▶** to select  and then press **ENTER**.
- 3 Use **▲/▼** to select **Child lock** and then press **ENTER**.



- 4 Use **▲/▼** to select **ON** and then press **ENTER**.
- 5 Press **OPTION** to exit the settings display.

The child lock indicator is displayed.

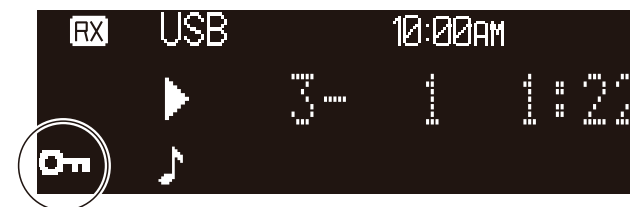

#### Note

Press **OPTION** to cancel setup before it is completed.

## Charging a mobile device (Qi)

A mobile device with the Qi icon can be charged with this unit. For more information regarding the Qi charging function, see documentation provided with your mobile device.

### Note

The Qi charging function is not available in any of the following situations:

- The Qi function is disabled.
- Power Off Charge is disabled (☞ p. 38) and the unit is in standby mode.

Place the mobile device with its Qi icon facing down on the unit's Qi icon.

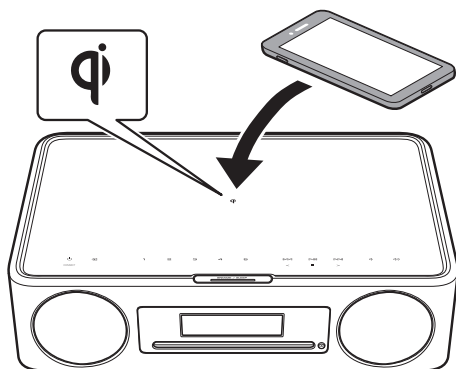

**WARNING**

Do not place metallic objects, such as straps with metal components, near the Qi icon. Failure to observe this precaution may result in a fire, burn, or other injury.

Charging status can be confirmed using the Qi charging indicator.

	Charging possible
	Charging in progress
	Charging complete The indicator may not change to the charging complete indicator with some devices, even when they are fully charged.
	Charging failed Be sure that no other objects are positioned near the Qi icon. If you have confirmed that nothing is interfering with Qi function, see "Troubleshooting" for more information (☞ p. 51).

### Note

- If charging does not begin, remove the device and place it on the Qi icon again.
- Remove any cover or case attached to the mobile device while charging. If a magnetic card or smart card is positioned between the unit and the mobile device during charging, the magnetic stripe or radio-frequency identification (RFID) chip used on some credit cards or passports may be damaged.
- Charging may take longer at high ambient temperatures.
- If vibrations generated by audio output cause the mobile device to move, position the non-skid pad (supplied) with the rough surface upward between the mobile device and the unit.

## Adjusting display brightness (dimmer)

Display brightness can be adjusted automatically or manually.

<p><b>Automatic</b></p> <p>The unit automatically selects brightness for bright and dark levels in accordance with ambient lighting. Brightness for both levels can be fine-tuned. Higher values are brighter.</p>	<p>Bright level options 6 to 10 (default: 8)</p> <p>Dark level options 1 to 5 (default: 3)</p>
<p><b>Manual</b></p> <p>Select the preferred brightness level from 10 options.</p>	<p>1 to 10 (default: 8)</p>



- 1 Press **OPTION**.
- 2 Use **◀/▶** to select , and press **ENTER**.
- 3 Use **▲/▼** to select **Dimmer**, and press **ENTER**.
- 4 Use **▲/▼** to select **Automatic** or **Manual**, and press **ENTER**.

- 5 Use **▲/▼/◀/▶** to select an option and/or level.

The following display is shown when **Automatic** is selected.



- 6 Press **ENTER** to save settings.
- 7 Press **OPTION** to exit the settings display.

# Option settings

Various settings can be configured using the option menu. See “Option menu list” on the next page for available options.



- 1 Press **OPTION**.





- 2 Use ◀/▶ to select a menu group, and press **ENTER**.



- 3 Use ▲/▼/◀/▶ to select a setting, and press **ENTER**.

Press **OPTION** to cancel setup before it is completed.

- 4 Press **OPTION** to exit the settings display.

## Option menu list

Group	Setting		
 CLOCK	Clock setting (🔗 p. 10)		
	Alarm list (🔗 p. 31)		
 SOUND	EQ setting (🔗 p. 29)		
	Sound mode (🔗 p. 29)		
 SYSTEM	Child lock (🔗 p. 34)		
	Dimmer (🔗 p. 36)		
	Language setting	Select a display language.	
	Qi function setting (🔗 p. 35)		
	BT function setting	When this function is disabled, the Bluetooth connection is not available (default: Enable).	
	Power off setting	Auto Power OFF (🔗 p. 9)	
		Power Off Charge	When this function is disabled and the unit is in standby mode, the Qi/USB charging function is not available (default: Enable).
		NETWORK Standby	When this function is disabled, the following functions are not available (default: Enable). <ul style="list-style-type: none"> <li>• Turn on the unit using the MusicCast CONTROLLER app</li> <li>• Bluetooth connection</li> <li>• Charge a USB flash drive</li> </ul>
		PW Off Clock Display	When this function is disabled, the clock is not displayed while the unit is in standby mode.
	Disc manual eject	Eject the CD.	
	Factory setting	Restore the unit to factory default settings (reset).	
	Firmware information	Version information	Display the unit's firmware version.
		USB update (🔗 p. 42)	
NETWORK update (🔗 p. 41)			

Group		Setting
 NETWORK	Network information	NW Route & Condition    Display NETWORK connection status.
		Wireless (Wi-Fi) SSID    Display the SSID.
		IP Address    Display the IP address.
		Subnet Mask    Display the subnet mask.
		Default Gateway    Display the default gateway.
		Preferred DNS Server    Display the primary DNS server.
		Alternate DNS Server    Display the secondary DNS server.
		MAC Address (Wired)    Display the MAC address.
		MAC Address (Wireless)    Display the MAC address.
		Network Name    Display the network name.
		MusicCast Network    Display information regarding the MusicCast network.
Network route setting	Wired (🔗 p. 43)	
	Wireless (Wi-Fi)	WPS Button (🔗 p. 44) Share Wi-Fi (iOS) (🔗 p. 45)
IP Address setting	Obtain an IP addr auto	When this function is disabled, the following settings can be specified manually. • IP Address • Subnet Mask • Default Gateway • Preferred DNS Server • Alternate DNS Server
 FM	<sup>1)</sup> Auto preset (🔗 p. 18)	
	Preset delete (🔗 p. 19)	
 DAB	<sup>2)</sup> Initial scan (🔗 p. 15)	
	Tuning Aid (🔗 p. 17)	
	Preset delete (🔗 p. 16)	

<sup>1)</sup> Displayed only when the input source is FM<sup>2)</sup> Displayed only when the input source is DAB

## Pair the unit with MusicCast-enabled devices

The MusicCast CONTROLLER app can be used to pair the unit with other MusicCast-enabled devices to share music between the devices (MusicCast Link). Enjoy listening to music from your smartphone, Internet radio, or streaming services anywhere in your home with simple operation.

Visit the Yamaha website for details regarding MusicCast and MusicCast-enabled devices.

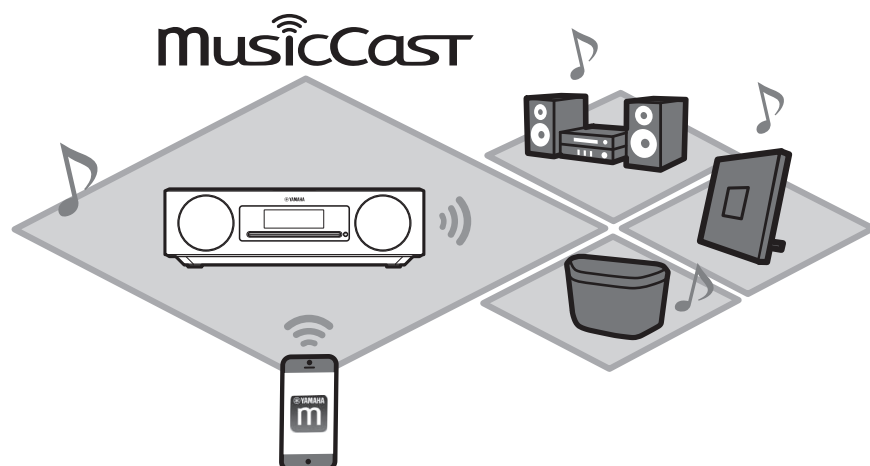

Register the unit with the MusicCast CONTROLLER app, and then register other MusicCast-enabled devices with the app.

### Note

To register the unit with the app, see "Use MusicCast CONTROLLER to connect to a network" (p. 11).

- 1 Tap  (Settings).

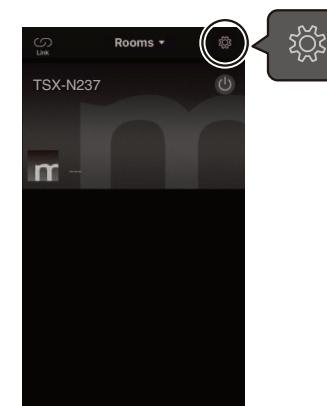

TSX-N237D will be displayed as the name for units purchased in some regions.

- 2 Follow the app's on-screen instructions to register MusicCast-enabled devices.



# Firmware updates

## Updating the firmware

New firmware will be provided as features are added and issues are resolved. Visit the Yamaha website for details regarding the unit's firmware. The firmware can be updated using the MusicCast CONTROLLER app, a USB flash drive, or via the Internet.

### **Notice**

Do not attempt to operate the unit, or disconnect the power cord or network cable while firmware is being updated. If the firmware update is interrupted, the unit may cease to function. In this case, contact your nearest authorized Yamaha dealer or service center.

## When the unit is connected to the Internet

When new firmware is released, a notice is displayed in the MusicCast CONTROLLER app or on the unit. There firmware can be updated using the app or the unit itself.

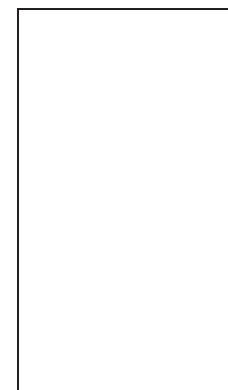

- When using the MusicCast CONTROLLER app to update the unit's firmware, simply follow the app's on-screen instructions.
- When using the unit itself to update firmware, see "Updating firmware via the unit itself" (🔗 p. 42).

### **Note**

Insufficient Internet speed or other wireless network issues may prevent the unit from receiving firmware update notifications. If this occurs, use a USB flash drive to update (🔗 p. 42).

## Updating firmware via the unit itself

Follow the procedure described below to update the unit's firmware.

- 1 Press **OPTION**.
- 2 Use ◀/▶ to select  **SYSTEM**, and then press **ENTER**.

The NETWORK update dialog is displayed.

- 3 Use ◀/▶ to select **OK**, and then press **ENTER**.

The firmware update will begin.

- 4 Press  when **Success** is displayed.

The firmware update has been successfully completed.

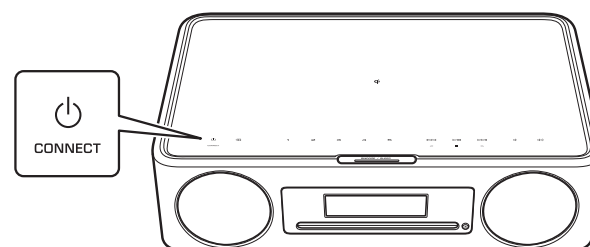

## When the unit is not connected to the Internet

If the unit is not connected to the Internet, or Internet speed is slow, use a USB flash drive to update the firmware.

Visit the Yamaha website for information on downloading and updating the firmware.

# Connecting to a network manually

## **Wired network connection**

For a wired network connection, connect a standard shielded twisted pair (STP) network cable (straight, category 5 or higher; sold separately) to the NETWORK jack on the rear panel.

**1** Press **OPTION**.

**2** Select  **NETWORK** in the option menu.

Select **Network route setting>Wired** and follow the instructions in the display to complete setup.

### **Note**

- When a router that does not support DHCP is used, use Network Config in the option settings to configure network settings (####).
- To configure your router's subnet mask manually, apply the same subnet used by this unit to all devices (####).



## Using WPS (Wi-Fi Protected Setup) to connect to a network wirelessly

A wireless LAN router (access point) equipped with a WPS button is required.

- 1 Press **OPTION**.
- 2 Select  NETWORK in the option menu.

Select **Network route setting>Wireless (Wi-Fi)>WPS Button** and follow the instructions in the display to complete setup.

The  indicator glows when a connection has been established.

### WPS

Wi-Fi Protected Setup (WPS) is a standard established by the Wi-Fi Alliance to allow for easy establishment of a wireless network.

### Note

- WPS cannot be used when a network cable is connected to the unit.
- A wireless connection may not be established if the unit and the wireless LAN router (access point) are too far apart. If you experience difficulty establishing a wireless connection, position the unit and the wireless router (access point) closer to each other.



## Using iPhone settings to connect to a network wirelessly

When the unit is turned on for the first time after purchase or after initializing the unit, the  indicator on the unit flashes, and the unit will automatically begin searching for an iOS device such as an iPhone. Network settings from your iOS device can be applied to the unit for easy connection to an existing wireless network.

iOS device network settings cannot be automatically applied to the unit (this feature) when a network cable is connected to the unit.

### Note

- Be sure that the iOS device is connected to the wireless LAN router (access point).
- An iOS device running iOS 7.1 or later is required.
- iOS device network settings cannot be applied to the unit to establish a wireless connection if the wireless LAN router uses WEP encryption.
- The following settings will be initialized:
  - Network settings
  - Bluetooth settings
- If any operation is performed while the  indicator flashes, setup will fail. If this occurs, use the remote control to share iOS device network settings.

**1** Press **OPTION**.

**2** Select  in the option menu.

Select Network route setting>Wireless (Wi-Fi)>Share Wi-Fi (iOS) and follow the instructions in the display to complete setup.

- 1** While the  indicator is flashing, open the iOS device's Wi-Fi settings, and then specify this unit as the AirPlay speaker.

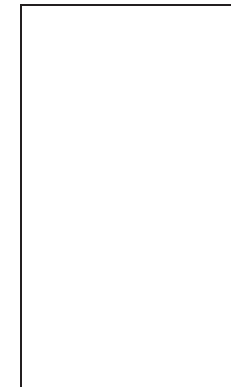

- 2** Choose the wireless network (access point) to which the unit will be connected.

Once network settings have been successfully shared, the unit will automatically connect to the selected wireless network.

# Troubleshooting

Refer to the table below if the unit fails to function properly. If the problem is not listed, or if the symptoms persist after following the instructions provided, turn off the unit, disconnect the unit from the electrical outlet, and contact your nearest authorized Yamaha dealer or service center.

## General

Problem	Cause	Solution
<b>The unit turns off as soon as it is powered on. The unit does not operate properly.</b>	The power cord is not properly connected.	Connect the power cord firmly.
<b>The unit cannot be operated.</b>	The internal microcomputer has frozen due to an external electrical shock (lightning, excessive static electricity, etc.) or a drop in power supply voltage.	Press and hold ▲ on the unit for at least eight seconds. The unit will be in standby mode.
<b>No sound comes from the unit.</b>	An input source has not been properly selected.	Use the input source buttons to select an input source (☞ p. 7).
	The volume level is set to the minimum level or volume is muted.	Increase the volume.
	The transmitting mode is applied to the Bluetooth function.	Apply the receiving mode to the Bluetooth function (☞ p. 13).
	The external device is not firmly connected to the AUX jack.	Confirm that the external device is firmly connected to the unit's jack. If there are no problems with connection, check that cables may be damaged.
<b>Noise is heard.</b>	The audio cable used to connect the unit and external device may be damaged.	Confirm the audio cable connection. If there are no problems with connection, use another audio cable.
<b>The unit suddenly turns off.</b>	The sleep timer has been set (☞ p. 33).	Turn on the unit and play the source again.
	The auto power standby function is activated. (☞ p. 9).	
	The protection function has been activated.	After confirming that there are no abnormalities, which may include strange noises emitted by the unit or a unit that is unusually warm or hot to the touch, press ▲ for at least 8 seconds. The unit will enter standby mode.
<b>Breaks, distortion, or unusual noise can be heard.</b>	The volume (especially the bass) is too high.	Decrease the volume, or adjust the bass (☞ p. 29).

Problem	Cause	Solution
<b>The unit's clock is reset.</b>	Power has not been supplied to the unit for more than one week.	If the power cord has been disconnected from the electrical outlet for more than one week, the clock may be reset. Set the clock again (☞ p. 10).
<b>Interference from nearby electronic equipment is producing noise.</b>	The unit is too close to other electronic equipment.	Position the unit farther away from other electronic equipment.
<b>The remote control does not work or does not function properly.</b>	The remote control may be outside its operation range.	Operate the remote control within its operation range (☞ p. 9).
	The remote control sensor on this unit may be exposed to direct sunlight or strong lighting such as an inverter type fluorescent lamp.	Change the orientation of lighting or the unit, or location of the unit.
	The battery may be worn out.	Replace the battery with a new one (☞ p. 8).
	There are obstacles between the sensor of this unit and the remote control.	Remove the obstacles.
<b>The touch sensors on the unit cannot be operated.</b>	The child lock function is enabled.	Disable the child lock function (☞ p. 34).
	Objects have been placed on the touch sensors.	Do not place objects on the touch sensors.

# Network

Problem	Cause	Solution
<b>Cannot configure connection using the MusicCast CONTROLLER app.</b>	The mobile device is not connected to the wireless LAN router (access point).	Connect the mobile device to the wireless LAN router, and then use MusicCast CONTROLLER to configure connection settings.
	The unit is turned off.	Turn on the unit.
<b>The MusicCast CONTROLLER app does not recognize the unit.</b>	The unit and the mobile device are not on the same network.	Confirm network connections and wireless LAN router settings, and then connect the unit and mobile device to the same network.
	A wireless LAN router that supports multiple SSIDs is used.	The router's network splitter may be blocking access to the unit. When connecting a mobile device, use an SSID that is able to access to the unit. Try connecting to the primary SSID.
<b>The network feature does not function.</b>	Network information (IP address) has not been properly obtained.	Enable the DHCP server function on the router.
	The unit is starting up (a period of approx. 20 seconds after the power cord is plugged into an electrical outlet).	Do not attempt to operate the unit until start-up is complete.
	An IPv6-only router is being used.	Use an IPv4-compatible router.
<b>Files on the media server (computer or NAS) are not displayed (do not play).</b>	The file format is not supported by the unit or the media server.	Be sure to use a file format that is supported by both the unit and the media server. For information on music files supported by this unit, see "Devices/media, and file formats supported by the unit" (🔗 p. 55).
	Media server sharing settings are not correct.	Configure sharing settings to allow the unit access to folders on the media server (🔗 p. 25).
<b>The MusicCast CONTROLLER app does not recognize the media server (computer or NAS).</b>	Security software installed on your media server is blocking access by the unit.	Confirm settings for security software installed on the media server.
	The unit and the media server are not connected to the same network.	Confirm network connections and wireless LAN router settings, and then connect the unit and media server to the same network.



Problem	Cause	Solution
<b>Unable to play Internet radio.</b>	The selected Internet radio station is currently offline.	The radio station may be experiencing problems with their network, may not be broadcasting, or their services may have been terminated. Try to play the station later or select another station.
	The selected Internet radio station is currently broadcasting silence.	Some Internet radio stations broadcast silence at certain times of the day. When this occurs, there are no problems with reception, but no sound plays. Try the station later or select another station.
	Access to the network is restricted by network device (wireless LAN router, etc.) firewall settings.	Check device firewall settings. Internet radio can be played only through the port specified by each radio station. The port number varies depending on the radio station.
<b>Firmware update failed.</b>	The network connection is unstable.	Try again later.
<b>The unit is unable to connect to the Internet via a wireless LAN router (access point).</b>	The wireless LAN router is turned off.	Turn on the wireless LAN router.
	The unit and the wireless LAN router are too far apart.	Place the unit and the wireless LAN router closer to each other.
	There is an obstacle between the unit and the wireless LAN router.	Move the unit and the wireless LAN router to a location with a direct line of sight (no obstacles) between the two.
	The unit's wireless LAN function is disabled.	Enable the unit's wireless LAN function (#####).
<b>The MusicCast CONTROLLER app does not detect a wireless network.</b>	A device that operates in the 2.4 GHz band (microwave oven, wireless network device, etc.) is interfering with wireless communication.	Turn off the offending device, or move it farther away from the unit and the wireless LAN router.
	Access to the network is restricted by the wireless LAN router's (access point's) firewall settings.	Confirm wireless LAN router firewall settings.
<b>My iPhone does not recognize the unit when using AirPlay.</b>	A wireless LAN router that supports multiple SSIDs is used.	The router's network splitter may be blocking access to the unit. When connecting a mobile device, use an SSID that is able to access to the unit. Try connecting to the primary SSID.

# Bluetooth

Problem	Cause	Solution
<b>Unable to connect the unit to a Bluetooth device.</b>	The unit is already connected to another Bluetooth device.	Terminate the current Bluetooth connection, and then connect to the new device.
	The unit and the Bluetooth device are too far apart.	Move the Bluetooth device closer to the unit.
	A device that operates in the 2.4 GHz-band (microwave oven, wireless network device, etc.) is interfering with wireless communication.	Move the unit and Bluetooth device farther away from the device. If the wireless LAN router supports the 5 GHz-band, connect network devices to the network using the 5 GHz-band.
	The passkey for devices such as a Bluetooth adapter is not "0000".	Use a Bluetooth device with a passkey of "0000."
	The Bluetooth device does not support the Advanced Audio Distribution Profile (A2DP).	Use a Bluetooth device that supports A2DP.
<b>No sound is played, or sound is interrupted during playback.</b>	The volume level on the Bluetooth device is set too low.	Increase the volume on the Bluetooth device.
	The Bluetooth device is not configured to transmit audio signal to this unit.	On the Bluetooth device, select this unit as the audio output destination.
	The Bluetooth connection has been terminated.	Establish the Bluetooth connection again (🔗 p. 13).
	A device that operates in the 2.4 GHz band (microwave oven, wireless network device, etc.) is interfering with wireless communication.	Move the unit and Bluetooth device farther away from the device. If the wireless LAN router supports the 5 GHz band, connect network devices to the network using the 5 GHz band.
	The unit and the Bluetooth device are too far apart.	Move the Bluetooth device closer to the unit.

## Disc

Problem	Cause	Solution
<b>Playback does not start after a disc is inserted. Some functions are not available.</b>	The unit does not support the disc inserted.	Use a disc that is supported by the unit (☞ p. 55).
	The disc may be dirty.	Wipe the disc clean (☞ p. 55).
<b>Playback does not start (or stops immediately) when ▷/⏮ is pressed.</b>	The unit does not support the disc inserted.	Use a disc that is supported by the unit (☞ p. 55).
	If the unit was moved from a cold to warm place, condensation may have formed on the disc reading lens.	Wait for an hour or two until the unit adjusts to the room temperature, and try again.
<b>The CD is not ejected when ▲ is pressed.</b>	_____	Use Disc manual eject in the option settings to eject the disc (☞ p. 38).

## Qi

Problem	Cause	Solution
<b>The unit stops charging.</b>	Objects are positioned near the Qi icon.	Remove the objects.
	The unit will temporarily stop charging when it or the mobile device becomes too hot.	Charging will resume once the temperature of the unit or mobile device has dropped to an acceptable temperature.

## USB flash drive

Problem	Cause	Solution
<b>The unit does not detect the USB flash drive.</b>	The USB flash drive is not connected to the USB jack securely.	Turn off the unit, reconnect the USB flash drive, and turn the unit on again (☞ p. 20).
	A USB flash drive in a format other than FAT16/32 format is used.	Use a USB flash drive with FAT16 or FAT32 format.
<b>Folders and files in the USB flash drive cannot be viewed.</b>	The data in the USB flash drive is protected by encryption.	Use a USB flash drive without an encryption function.
<b>Playback does not begin, or playback stops at the beginning.</b>	The music file is not supported by the unit.	Confirm the file formats that are supported by the unit (☞ p. 56).

## DAB reception (Australia, U.K., and Europe models only)

Problem	Cause	Solution
<b>Cannot tune in to any DAB stations.</b>	The initial scan operations were not performed.	Perform the initial scan operations (☞ p. 15).
<b>The initial scan operations are not successful and Not Found is displayed.</b>	DAB signals are too weak.	Use Tuning Aid to check reception strength, adjust the height or direction of the antenna, or move the unit (☞ p. 17).
	The antenna is not suitably positioned for receiving DAB stations.	
	There is no DAB coverage in your area.	Check with your dealer or WorldDMB online at <a href="http://www.worlddab.org">http://www.worlddab.org</a> for a listing of the DAB coverage in your area.
<b>There is noise interference (e.g. hiss, crackle or jitter).</b>	The antenna is not suitably positioned for receiving DAB stations.	Adjust the height or direction of the antenna.
	DAB signals are too weak.	Use Tuning Aid to check reception strength, adjust the height or direction of the antenna, or move the unit (☞ p. 17).
<b>The DAB station information is not shown or is inaccurate.</b>	The DAB station may be temporarily out of service, or the DAB station information is not provided by the DAB broadcaster.	Contact the DAB broadcaster.

# FM reception

Problem	Cause	Solution
<b>FM stereo reception is noisy.</b>	The radio station you selected may be far from your area, or the antenna input is poor.	Change the height or direction of the antenna, or change the position of the unit.
<b>Automatic tuning does not work.</b>	The radio station you selected may be far from your area, or the antenna input is poor.	Change the height or direction of the antenna, or change the position of the unit. Tune in to a station manually (☞ p. 18).
<b>Cannot select a preset radio station.</b>	The preset stations may have been erased.	Preset radio stations again (☞ p. 18).
<b>There is distortion, and clear reception cannot be obtained.</b>	Multipath reflection or other radio interference may be occurring.	Change the height or direction of the antenna, or change the position of the unit.
	Qi charging is interfering with radio reception.	Disable the Qi charging function (☞ p. 38).

# Messages in the display

Message	Description	Solution
<b>No Disc</b>	The disc inserted in the unit may not be supported.	Use the disc supported by the unit (☞ p. 55).
	The disc may be dirty, or foreign matter may be attached to it.	Wipe the disc clean. Alternatively, remove foreign matter adhered to the disc.
<b>Reading</b>	The unit is reading the specified file/content.	Wait until the unit finishes reading.
<b>Unknown disc</b>	Disc is set upside-down.	Set the disc with the labeled side facing up.
	A disc that is not recognized by the unit has been inserted.	Confirm that the disc is supported by the unit (☞ p. 55).
<b>Unknown device</b>	A disc or USB flash drive that is not recognized by the unit has been inserted or connected.	Confirm that the disc or USB flash drive is supported by the unit (☞ p. 55).
<b>No content</b>	A disc or USB flash drive does not contain files supported by the unit.	Use the disc or USB flash drive that contains files supported by the unit (☞ p. 55).
<b>Read error</b>	The unit failed to read the specified file/content.	Eject the disc or disconnect the USB flash drive, and then insert the disc or connect the USB flash drive again.
<b>(Bluetooth) is not connected</b>	The Bluetooth connection is not established.	Confirm the Bluetooth connection.

# Devices/media, and file formats supported by the unit

## Devices/media

### USB flash drives

- This unit is compatible with USB flash drives that are in FAT16 or FAT32 format. Do not connect any other type of USB flash drives.
- USB flash drives with encryption cannot be used.
- Operation of all USB flash drives cannot be guaranteed.

Yamaha and suppliers do not accept any liability for the loss of data saved on a USB flash drive connected to the unit. As a precaution, it is recommended to make backup copies of important files.

### Discs

- This unit is designed for use with audio CD, CD-R/RW (ISO 9660 format) with any of the following logos printed on the disc or the disc jacket.

#### Audio CD



#### CD-R/RW\*



\* Discs which bear one of the following.  
FOR CONSUMER  
FOR CONSUMER USE  
FOR MUSIC USE ONLY

### Notes on discs

- Do not use any other type of disc other than stated above. Doing so may damage the unit.
- CD-R/RW cannot be played back unless finalized. Finalization means the process for making a disc to be ready for playback on a compatible device.
- Some discs cannot be played back depending on the disc characteristics or recording conditions.

- Do not use any non-standard shaped discs such as a heart-shaped disc.
- Do not use discs with many scratches or a crack on their surface, or warped/glued discs.
- Do not touch the surface of the disc. Hold a disc by its edge or center hole.
- Use a soft-tipped pen when writing on the label side of a disc.
- Do not use a disc to which tape, stickers, or labels have been affixed. Discs with any of these inserted into the unit may not be ejected.
- Do not use a protective cover to prevent scratches.
- Do not insert any object other than a disc into the unit.
- Do not insert more than one disc into the unit at one time. This could cause damage to both this unit and the discs.
- If a disc becomes dirty, wipe it with a clean, dry soft cloth from the center out to the edge. Do not use record cleaner or paint thinner.
- Do not use any lens cleaners as they may cause malfunction.
- Do not expose discs to direct sunlight, high temperature, high humidity, or dust.
- When a disc is not being used, remove it from this unit and store in an appropriate case.

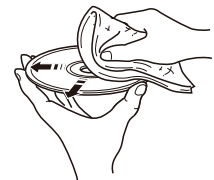

# File format

## USB

Format	Sampling frequency (kHz)	Quantization bits (bit)	Bitrate (kbps)	Number of channels	Support for gapless playback
<b>WAV*</b>	32/44.1/48/ 88.2/96/176.4/ 192	16/24/32	-	2	✓
<b>MP3</b>	32/44.1/48	-	8 to 320	2	-
<b>WMA</b>	32/44.1/48	-	8 to 320	2	-
<b>MPEG-4 AAC</b>	32/44.1/48	-	8 to 320	2	-
<b>FLAC</b>	32/44.1/48/ 88.2/96/176.4/ 192**	16/24	-	2	✓
<b>ALAC</b>	32/44.1/48/ 88.2/96	16/24	-	2	✓
<b>AIFF</b>	32/44.1/48/ 88.2/96/176.4/ 192	16/24/32	-	2	✓
<b>DSD</b>	2.8 MHz/ 5.6 MHz/ 11.2 MHz	1	-	2	✓

\* Linear PCM format only

\*\* Some music files and content utilizing certain compression ratios may not play properly.

Digital Rights Management (DRM) files cannot be played back.

## CD

Format	Sampling frequency (kHz)	Quantization bits (bit)	Bitrate (kbps)	Number of channels
<b>MP3</b>	32/44.1/48	16	8-320	2
<b>WMA</b>	32/44.1/48	16	8-320	2



# Specifications

## Input

AUX	3.5 mm stereo mini jack
-----	-------------------------

## Output

HEADPHONES	3.5 mm stereo mini jack
------------	-------------------------

## USB

Audio format	MP3, WMA, AAC, WAV, FLAC, ALAC, AIFF
--------------	--------------------------------------

## CD

Laser	Type	Semiconductor laser GaAs/GaAlAs
	Wave length	775 to 780 nm
	Output power	4 mW
Media*	CD, CD-R/RW	
Audio format	Audio CD, MP3, WMA	

\* An 8-cm mini CD is not available.

## Bluetooth

Bluetooth version	Ver. 4.2	
Supported profile	A2DP (sink and source functions) AVRCP	
Compatible codecs	SBC, AAC (sink function only)	
Maximum communication range	10 m (33 ft) (without interference)	
Bluetooth output	Class 1	

## Tuner

Tuning range	FM	Canada model: 87.5 MHz to 107.9 MHz Other models: 87.5 MHz to 108.0 MHz
--------------	----	--

## DAB (Australia model only)

Tuning range	DAB	174 MHz to 240 MHz (Band III)
--------------	-----	-------------------------------

## Amplifier section

Maximum output power	Speakers	25 W + 25 W (6 Ω, 1 kHz, 10 % THD)
	Headphones	20 mW + 20 mW (16 to 32 Ω, 1 kHz, 10 % THD)

## Wireless Charge

Standard	Qi certified
----------	--------------

## General

Power supply	Voltage/ frequency	<b>Europe</b> model: AC 230 V, 50 Hz U.S.A. and Canada model: AC 120 V, 60 Hz Asia model: AC 100 to 240 V, 50/60 Hz Taiwan model: AC 110 to 220 V, 50/60 Hz China model: AC 220 V, 50 Hz Korea model: AC 220 V, 60 Hz
		Power consumption
Standby power consumption		Eco Standby (enabled): 0.9 W or less (Option settings: Dimmer level 7) Eco Standby (disabled): 1.8 W or less (Option settings: Dimmer level 7, Charge disabled)
Dimensions (W × H × D)		370 × 111 × 252 mm (14-5/8 × 4-3/8 × 9-7/8 inch)
Weight		4.2 kg (9.3 lbs.)

The contents of this manual apply to the latest specifications as of the publishing date. To obtain the latest manual, access the Yamaha website then download the manual file.

# Trademarks



This Desktop Audio System is compatible with AirPlay 2. iOS 11.4 or later is required. Use of the Works with Apple badge means that an accessory has been designed to work specifically with the technology identified in the badge and has been certified by the developer to meet Apple performance standards.

Apple, AirPlay, Apple TV, Apple Watch, iPad, iPad Air, iPad Pro, iPhone, Lightning, and iTunes are trademarks of Apple Inc., registered in the U.S. and other countries.

## App Store<sup>SM</sup>

App Store is a service mark of Apple Inc.

## Android™, Google Play™

Android and Google Play are trademarks of Google LLC.



The Wi-Fi CERTIFIED™ Logo and Wi-Fi Protected Setup are certification marks of Wi-Fi Alliance®. Wi-Fi, Wi-Fi CERTIFIED, Wi-Fi Protected Setup and WPA2 are registered trademarks of Wi-Fi Alliance®.



The Bluetooth® word mark and logos are registered trademarks owned by Bluetooth SIG, Inc. and any use of such marks by Yamaha Corporation is under license.



MusicCast is a trademark or registered trademark of Yamaha Corporation.



The 'Qi' symbol is a trademark of the Wireless Power Consortium.



Australia model only

## GPL/LGPL

This product utilizes GPL/LGPL open-source software in some sections. You have the right to obtain, duplicate, modify, and redistribute this open-source code only. For information on GPL/LGPL open source software, how to obtain it, and the GPL/LGPL license, refer to the Yamaha Corporation website (<https://download.yamaha.com/sourcecodes/musiccast/>).

## Licenses

For information on the licenses of the third-party software in this product, refer to the following.

[http://\(IP address of this product\\*\)/licenses.html](http://(IP address of this product*)/licenses.html)

\* IP address of this product is checked with MusicCast CONTROLLER.

YAMAHA CORPORATION

10-1 Nakazawa-cho, Naka-ku, Hamamatsu, 430-8650 Japan

Yamaha Global Site  
<https://www.yamaha.com/>

Yamaha Downloads  
<https://download.yamaha.com/>

Manual Development Group  
© 2021 Yamaha Corporation  
Published 01/2021  
KSEM-A0

AV18-0115