



PORTABLE PLAYER DOCK
PDX-60 OWNER'S MANUAL

FROM YAMAGATA INTECH
1ST CHECK

English

IMPORTANT SAFETY INSTRUCTIONS

CAUTION RISK OF ELECTRIC SHOCK DO NOT OPEN
CAUTION: TO REDUCE THE RISK OF ELECTRIC SHOCK, DO NOT REMOVE COVER (OR BACK). NO USER-SERVICEABLE PARTS INSIDE. REFER SERVING TO QUALIFIED SERVICE PERSONNEL.

Explanation of Graphical Symbols

- The lightning flash with arrowhead symbol, within an equilateral triangle, is intended to alert you to the presence of uninsulated "dangerous voltage" within the product's enclosure that may be of sufficient magnitude to constitute a risk of electric shock to persons.
The exclamation point within an equilateral triangle is intended to alert you to the presence of important operating and maintenance (servicing) instructions in the literature accompanying the appliance.

IMPORTANT Please record the serial number of this unit in the space below.
MODEL:
Serial No:
The serial number is located on the rear of the unit. Retain this Owner's Manual in a safe place for future reference.

This device complies with Part 15 of the FCC Rules. Operation is subject to the following two conditions:
1) this device may not cause harmful interference, and
2) this device must accept any interference received including interference that may cause undesired operation. See user manual instructions if interference to radio reception is suspected.

- 1 Read these instructions.
2 Keep these instructions.
3 Heed all warnings.
4 Follow all instructions.
5 Do not use this apparatus near water.
6 Clean only with dry cloth.
7 Do not block any ventilation openings. Install in accordance with the manufacturer's instructions.
8 Do not install near any heat sources such as radiators, heat registers, stoves, or other apparatus (including amplifiers) that produce heat.
9 Do not defeat the safety purpose of the polarized or grounding-type plug. A polarized plug has two blades with one wider than the other. A grounding type plug has two blades and a third grounding prong. The wide blade or the third prong are provided for your safety. If the provided plug does not fit into your outlet, consult an electrician for replacement of the obsolete outlet.
10 Protect the power cord from being walked on or pinched particularly at plugs, convenience receptacles, and the point where they exit from the apparatus.
11 Only use attachments/accessories specified by the manufacturer.
12 Use only with the cart, stand, tripod, bracket, or table specified by the manufacturer, or sold with the apparatus. When a cart is used, use caution when moving the cart/apparatus combination to avoid injury from tip-over.
13 Unplug this apparatus during lightning storms or when unused for long periods of time.
14 Refer all servicing to qualified service personnel. Servicing is required when the apparatus has been damaged in any way, such as power-supply cord or plug is damaged, liquid has been spilled or objects have fallen into the apparatus, the apparatus has been exposed to rain or moisture, does not operate normally, or has been dropped.

We Want You Listening For A Lifetime
Yamaha and the Electronic Industries Association's Consumer Electronics Group want you to get the most out of your equipment by playing it at a safe level. One that lets the sound come through loud and clear without annoying blaring or distortion - and, most importantly, without affecting your sensitive hearing. Since hearing damage from loud sounds is often undetectable until it is too late, Yamaha and the Electronic Industries Association's Consumer Electronics Group recommend you to avoid prolonged exposure from excessive volume levels. Operate this unit by the following procedure.

CAUTION: Read this before operating your unit.

To assure the finest performance, please read this manual carefully. Keep it in a safe place for future reference.

- 1 Install this unit in a well ventilated, cool, dry, clean place - away from direct sunlight, heat sources, vibration, dust, moisture, and/or cold. (Do not use/keep this unit in a car etc.)
2 Locate this unit away from other electrical appliances, motors, or transformers to avoid humming sounds.
3 Do not expose this unit to sudden temperature changes from cold to hot, and do not locate this unit in an environment with high humidity (i.e. a room with a humidifier) to prevent condensation inside this unit, which may cause an electrical shock, fire, damage to this unit, and/or personal injury.
4 Avoid installing this unit where foreign objects may fall onto this unit and/or this unit may be exposed to liquid dripping or splashing. On the top of this unit, do NOT place:
- Other components, as they may cause damage and/or discoloration on the surface of this unit.
- Burning objects (i.e. candles), as they may cause fire, damage to this unit, and/or personal injury.
- Containers with liquid in them, as they may fall and liquid may cause electrical shock to the user and/or damage to this unit.
5 Do not cover this unit with a newspaper, tablecloth, curtain, etc. in order not to obstruct heat radiation. If the temperature inside this unit rises, it may cause fire, damage to this unit, and/or personal injury.
6 Do not operate this unit upside-down. They may overheat, possibly causing damage.
7 Do not use force on switches, knobs, and/or cords.
8 When disconnecting the power cable/AC adaptor from the wall outlet, grasp the AC plug; do not pull the cord.
9 Do not clean this unit with chemical solvents; this might damage the finish. Use a clean, dry cloth.
10 Only the voltage specified on this unit must be used. Using this unit with a higher voltage than specified is dangerous and may cause fire, damage to this unit, and/or personal injury. Yamaha will not be held responsible for any damage resulting from use of this unit with a voltage other than that specified.

- 11 Do not attempt to modify or fix this unit. Contact qualified Yamaha service personnel when any service is needed. The cabinet should never be opened for any reason.
12 When not planning to use this unit for long periods of time (i.e. when going on vacation), disconnect all AC plugs from the wall outlet.
13 Be sure to read the "TROUBLESHOOTING" section regarding common operating errors before concluding that the unit is faulty.
14 Before moving this unit, disconnect all AC plugs from the wall outlets.
15 Be sure to use the AC adaptors supplied with this unit. Using an AC adaptor other than those provided may cause fire or damage to this unit.
16 Install this unit near the wall outlet and where the AC plugs can be reached easily.
17 For added protection for this product during a lightning storm, or when it is left unattended and unused for long periods of time, unplug it from the wall outlet. This will prevent damage to the product due to lightning and power-line surges.
18 The batteries shall not be exposed to excessive heat such as sunshine, fire or the like.

There is a chance that placing this unit too close to a CRT-based (Braun tube) TV set might impair picture color. Should this happen, move this unit away from the TV set.

Do not use this unit within 22 cm (9 inches) of persons with a heart pacemaker implant or defibrillator implant.

WARNING TO REDUCE THE RISK OF FIRE OR ELECTRIC SHOCK, DO NOT EXPOSE THIS UNIT TO RAIN OR MOISTURE.

Even if an iPhone or iPod is not connected to this unit, this unit is not disconnected from the AC power source as long as it is connected to the wall outlet. In this state, this unit is designed to consume a very small quantity of power.

INTRODUCTION

PDX-60 is a portable player dock designed for iPhone/iPod series. By connecting the iPhone/iPod to the transmitter, wireless operation via the connected iPhone/iPod is possible. With the iPhone/iPod connected to the dock terminal, the unit can be operated by the remote control. Also the charging cradle can be used for charging the iPhone/iPod, or to play music or movies for an extended time.
Alphabetical letters below (A, B, etc.) can be used for reference to the illustrations on the separate sheet "Quick Manual" for details.

Supplied accessories

Table listing accessories: Charging cradle (PDX-50BC), AC adaptor (for the charging cradle: DC 5 V, 1 A), Transmitter (PDX-50TX), AC adaptor (for the speaker: DC 15 V, 2.66 A), Power cable, iPod dock adaptor, Remote control, Owner's Manual, Quick Manual.

Replacing the battery in the remote control

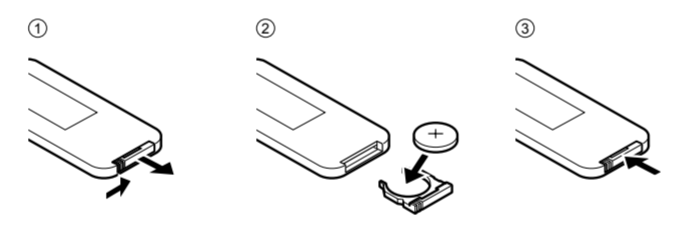

Inserting an iPod dock adaptor

Insert the iPod dock adaptor supplied with your iPod into the slot of the speaker. Depending on the type of your iPod, you may need to insert one of the iPod dock adaptors supplied with this unit. See the "Quick Manual" for details on how to insert/remove the iPod dock adaptor.

1 Insert the stoppers of the iPod dock adaptor into the slits of the speaker.

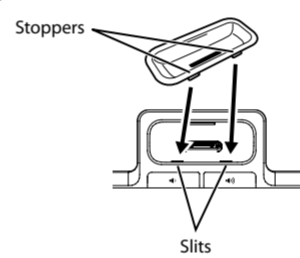

2 Insert the iPod dock adaptor until it snaps into the slot of the speaker.

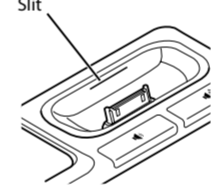

When you remove the iPod dock adaptor from the speaker, insert one of your finger nails into the slit on the iPod dock adaptor and pull it up.

CONTROLS AND FUNCTIONS

Charging cradle (PDX-50BC)

Charges the battery of the iPhone/iPod.

Transmitter (PDX-50TX)

Connect an iPhone/iPod series. When the iPhone/iPod is disconnected from the transmitter/dock terminal, the speaker will be in standby mode. The iPhone/iPod can be connected (or disconnected) anytime.

DC IN 5V jack

Connect the AC adaptor (for the charging cradle) to this jack to supply power to the charging cradle.

DC IN 15V jack

Connect the AC adaptor (for the speaker) to this jack to supply power to the speaker. When the AC adaptor is connected, the speaker will be in standby mode, consuming a small quantity of electricity. When an iPhone/iPod is connected to the transmitter (PDX-50TX)/dock terminal, the speaker turns on from standby mode. When the iPhone/iPod is disconnected from the transmitter/dock terminal, the speaker returns to standby mode.

Volume keys

Adjusts the volume level.

Dock terminal

Connect the iPhone/iPod series. When the iPhone/iPod is connected to the dock terminal and wireless communication is disconnected, its battery will be charged. When the iPhone/iPod is disconnected, the unit will be in standby mode. The iPhone/iPod can be connected (or disconnected) anytime.

Note When the iPhone/iPods are connected to both the transmitter and the dock terminal, the iPhone/iPod connected to the transmitter has priority.

Status indicator (LED)

Indicates the current status of the unit.

Table with columns: LED status (speaker/transmitter), The current status of this unit. Rows include Off, Flashes green, Flashes green once, Lights up green, Lights up green and flashes red, Flashes red, Flashes red once, Flashes red (regardless of green status).

Group selection switch

Use these switches to change the group setting for both speaker and transmitter.

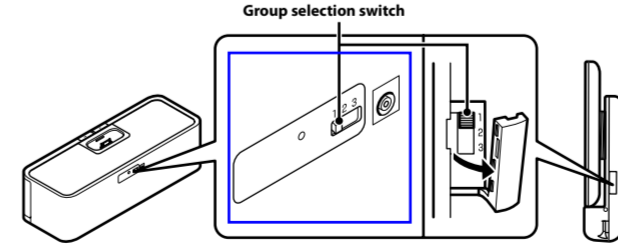

TROUBLESHOOTING

Refer to the table below if the unit does not function properly. If the problem you are experiencing is not listed below, or if the instruction below does not help, turn off this unit, disconnect the power cable, and contact the nearest authorized Yamaha dealer or service center.

Troubleshooting table with columns: Problem, Cause, Remedy. Issues include No sound, Cannot change the volume, iPhone/iPod display does not change, Power of the speaker does not turn off, Suddenly the speaker produces sound, When iPhone/iPods are connected to both transmitter and dock terminal, There is noise interference.

SPECIFICATIONS

Specifications table listing supported iPod/iPhone models, maximum playback duration, power supply, power consumption, dimensions, and weight.

iPod, iPhone

iPod is a trademark of Apple Inc., registered in the U.S. and other countries. iPhone is a trademark of Apple Inc. "Made for iPod" means that an electronic accessory has been designed to connect specifically to iPod and has been certified by the developer to meet Apple performance standards. "Works with iPhone" means that an electronic accessory has been designed to connect specifically to iPhone and has been certified by the developer to meet Apple performance standards. Apple is not responsible for the operation of this device or its compliance with safety and regulatory standards.

