

**P23BT**  
STEREO BLUETOOTH HEADSET  
无线立体声耳机

声美，我们听的更多！  
**SoundMAGIC, we listen more!**

**使用说明书**  
**User Manual**



NOTE: This equipment has been tested and found to comply with the limits for a Class B digital device, pursuant to part 15 of the FCC Rules. These limits are designed to provide reasonable protection against harmful interference in a residential installation. This equipment generates uses and can radiate radio frequency energy and, if not installed and used in accordance with the instructions, may cause harmful interference to radio communications. However, there is no guarantee that interference will not occur in a particular installation. If this equipment does cause harmful interference to radio or television reception, which can be determined by turning the equipment off and on, the user is encouraged to try to correct the interference by one or more of the following measures:

- Reorient or relocate the receiving antenna.
- Increase the separation between the equipment and receiver.
- Connect the equipment into an outlet on a circuit different from that to which the receiver is connected.
- Consult the dealer or an experienced radio/TV technician for help

Changes or modifications not expressly approved by the party responsible for compliance could void the user's authority to operate the equipment.

This device complies with Part 15 of the FCC Rules. Operation is subject to the following two conditions:

- (1) this device may not cause harmful interference, and
- (2) this device must accept any interference received, including interference that may cause undesired operation.

## 一、装箱清单



① 耳机 ② 说明书 ③ 耳机包 ④ 带麦杆耳机线 ⑤ 数据线

## 二、技术参数

技术标准.....	Bluetooth V5.0
单元.....	40mm钕铁硼磁动圈
传输距离.....	约13m
直流电阻.....	32±10%Ω
MIC灵敏度.....	-42±3dB
连续播放音乐时间.....	54~60h
持续通话时间.....	39~45h
待机时间.....	50天
耳机重量.....	156g
环境温度.....	-20°C~60°C

### 功能示意图:



## 三、操作/功能

### 1、开机



1、长按3秒开机，无连接时自动进入配对状态，红蓝灯闪；2、已连接设备，开机后自动回连。

### 2、关机

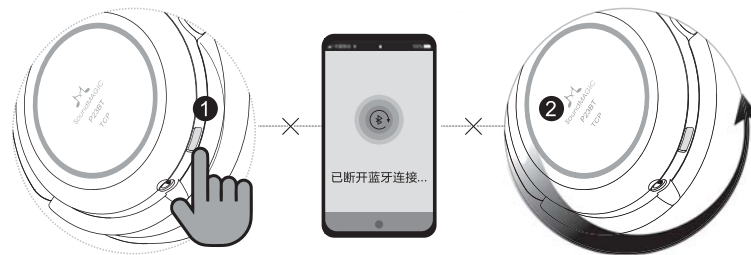

1、手动关机：长按5秒关机，红灯亮3次提示，2、自动关机：无连接设备时，5分钟后来电或通话中屏蔽关机功能。自动关机，红灯亮3次提示。

### 3、来电

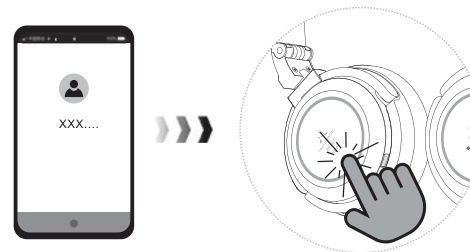

双击：接听/挂断

#### 4、音乐播放

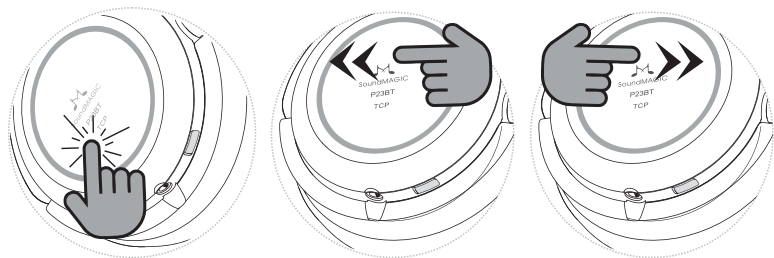

双击：播放/暂停

前滑：上一首

后滑：下一首

#### 5、音量调节

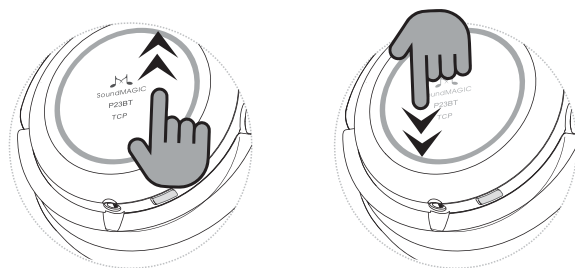

上滑一次音量调大一格  
上滑并停顿音量调最大

下滑一次音量调小一格  
下滑并停顿音量调最小

#### 6、切换通话

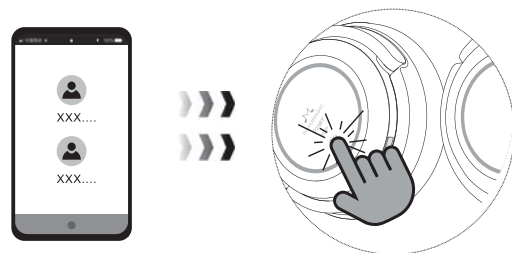

通话时来电：长按2秒，保持当前通话/切换通话。

#### 7、连接手机

##### 一、NFC连接

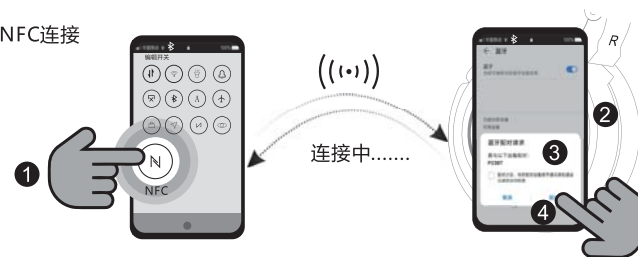

- 1、手机打开NFC功能
- 2、耳机进入配对状态，手机贴合NFC感应区。
- 3、手机弹出配对请求
- 4、点击"配对"成功连接

##### 二、配对连接

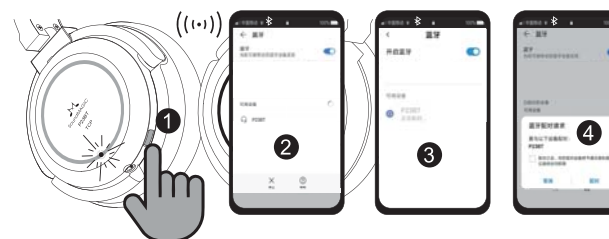

- 1、耳机进入配对状态
- 2、打开手机搜寻蓝牙
- 3、发现蓝牙耳机P23BT
- 4、确认配对请求，连接成功

#### 8、耳机回连

##### 一、自动回连

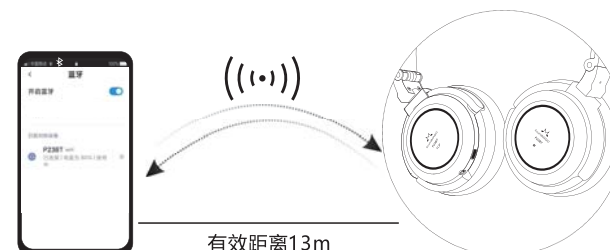

有效距离13m

手机与耳机开启状态下

## 二、手动回连

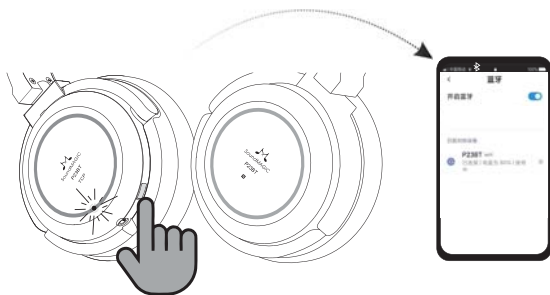

在无法自动回连时，点击开关键，耳机与手机自动连接。

## 9、语音功能

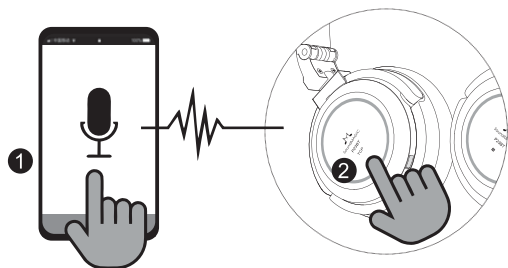

1、手机开启语音助手 2、在耳机触控面板上3击，激活语音助手功能。

## 10、耳机重置

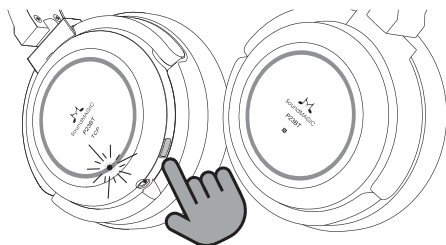

关机状态下长按10秒，红蓝灯双闪3次重置成功。

## 11、有线耳机使用状态

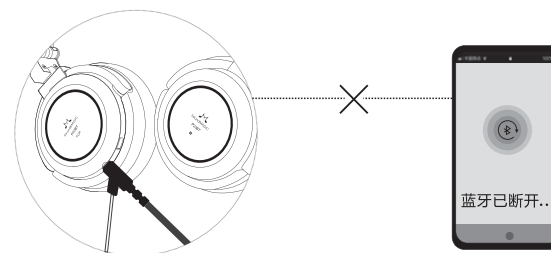

插入耳机线时，电源被断开，蓝牙功能将无法使用。

## 12、耳机充电

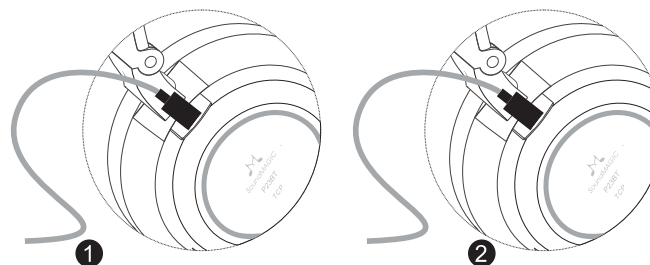

1、开机状态下充电：红蓝光跳闪，充满蓝光长亮。2、关机状态下充电：红灯长亮，充满灯灭。

## 四、注意事项

- 1、任何由于个人使用不当或非专业人士的维修对耳机造成破坏不列入保修范围。
- 2、不可使用尖锐的物体接触耳机。
- 3、不可使耳机一直处于充电状态。
- 4、不可存放在有化学腐蚀性环境中使用。
- 5、不可将产品放置于强磁的环境中。
- 6、不可让耳机长期处于无电状态。
- 7、长时间不使用，请隔一段时间进行充电，保护电池。

## 五、问题与维护

常见问题	常见原因	解决方案
不能开机	电量不足	进行充电
无法连接	其他电磁波干扰	换个环境重新匹配连接
打电话时声音仍然为听筒	手机接听方式设置为听筒	设置为蓝牙接听
有杂音	手机离耳机太远或者周围环境有干扰	拉近距离或更换环境
耳机声音调大后声音依然小	手机播放的声音太小	调大手机音量

**在需要服务时，请联系我们。  
专业的客服人员第一时间为您服务！**

**服务热线：0769-81270118**

**深圳市声美科技发展有限公司**  
中国广东深圳市龙华区卫东龙商务大厦A栋1613室  
电话：0755-88316487

## 关于声美

SoundMAGIC是深圳市声美科技发展有限公司旗下注册品牌，由许先生于2005年创立。作为专业的集音频产品设计、研发、生产、销售于一体的创新型科技企业，深圳市声美科技发展有限公司主营产品包括入耳式有线耳机、头戴式耳机、蓝牙耳机、耳机放大器等多种中高端影音产品。

公司于2009年3月成立香港公司“SoundMAGIC Technology development Co.,Ltd”，专注于海外市场拓展，并逐步建立与稳固了全球范围内的分销网络，至今在亚洲、欧洲和美国等30多个国家共有80多个分销商。2012年9月，公司因生产规模扩大，在东莞成立“东莞市年瑞电子科技有限公司”。

SoundMAGIC拥有集研发设计、品牌运营、市场营销、生产制造于一体的完善体系，这一切也为用户提供高性价比的品质耳机奠定坚实基础。

SoundMAGIC is a registered brand of Shenzhen SoundMAGIC Technology Development Co.,Ltd, founded by Mr Xu in 2005. As an innovative technology enterprise specializing in audio product design, development, production and sales, the products range from in-ear wired headphones, on-ear Headphones, Bluetooth Headsets, headphone amplifiers and other high-end audio products.

In March 2009, we established the Hong Kong company "SoundMAGIC Technology Development Co.,Ltd", focusing on overseas market expansion, and gradually established and stabilized the global distribution network. Up to now, we have more than 80 distributors in more than 30 countries in Asia, Europe and USA. In September 2012, due to the expansion of production scale, "Dongguan Nianrui Electronic Technology Co., Ltd." was established in Dongguan.

SoundMAGIC has a complete system integrating R&D, brand operation, marketing and manufacturing, which also lays a solid foundation to provide high-quality headphones with high cost performance for users.

## Packing list



- ① Headphone    ② User manual    ③ Carrying case  
④ Microphone cable    ⑤ USB cable

## Technical specification

Bluetooth.....	Bluetooth V 5.0
Driver.....	Dynamic, 40mm, Neodymium
Transmission Range.....	up to 13m
Impedance.....	32±10% Ω
MIC Sensitivity.....	-42±3dB
Continuous Playback music.....	54-60h
Continuous Talk Time.....	39-45h
Standby time.....	50days
Weight.....	156g
Ambient Temperature.....	-20°C-60°C

## Functional diagram:

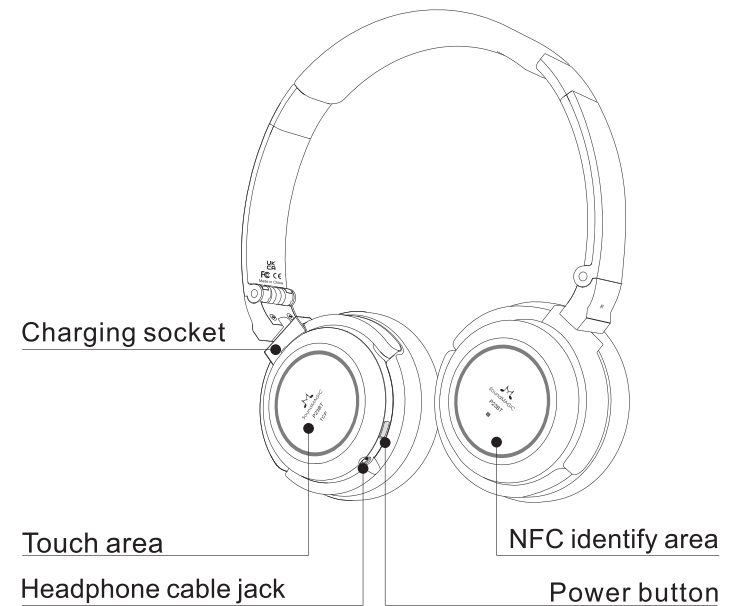

## Operation/Function

### 1、 Power on



- 1、 Long press the button for 3 seconds, it will automatically enter the pairing state when there is no connection
- 2、 If connected, it will automatically enter the connection state

### 2、 Power off

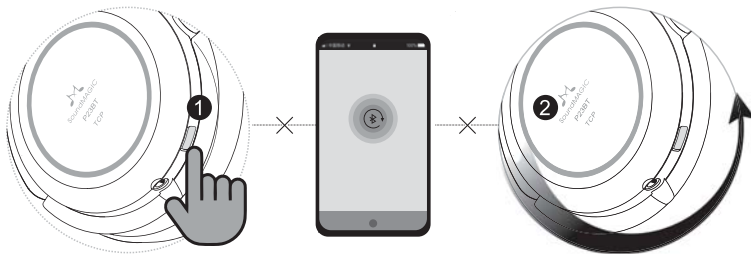

- 1、 Manual power off: long press 5 seconds to power off, the red light will light up 3 times. The power off function is shielded during incoming call or in a call
- 2、 Automatic power off: when there is no connected device, it will automatically power off after 5 minutes, and the red light will light up 3 times

### 3、 Incoming call

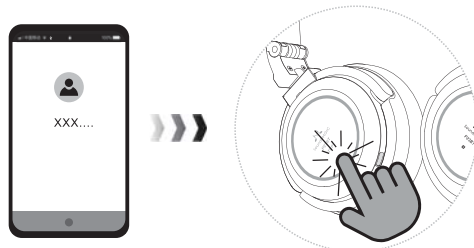

Double-click: answer/hang up

### 4、 Play music

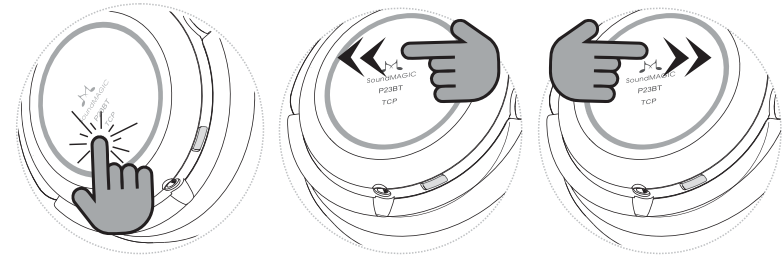

Double-click: play/pause Forward slide: prev song Back slide: next song

### 5、 Volume control

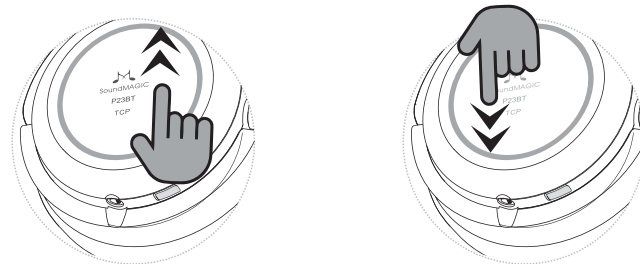

Slide up once to turn the volume up a notch

Slide down once to turn the volume down a notch

Slide up and pause to turn the volume up on maximum

Slide down and pause to turn the volume down on minimum

### 6、 Swap calls

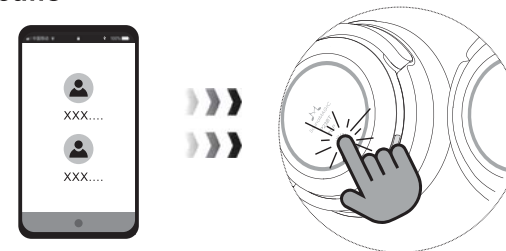

During a call, long press for 2 seconds to put the current call on hold and answer the incoming call



## 7、Phone connection

### NFC connection

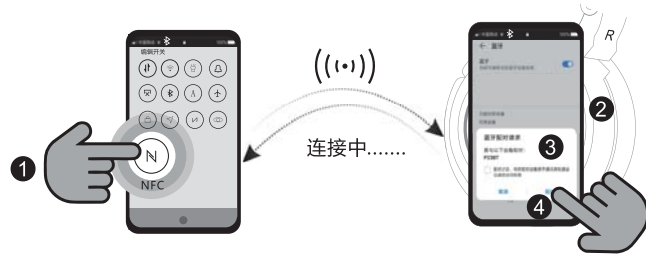

- 1、 Turn on NFC on your phone
- 2、 The headset enters the pairing state, and the phone is attached to the NFC sensing area
- 3、 The phone pops up with a matching request
- 4、 Click "Pair" to connect successfully

### Pair connection



- 1、 The headset enters pairing mode
- 2、 Turn on your phone and search for Bluetooth
- 3、 Find Bluetooth Headset P23BT
- 4、 Confirm the pairing request and the connection is successful

## 8、 Headset reconnection

### Automatic reconnection

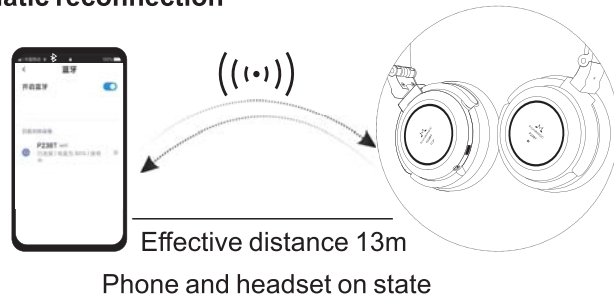

## Manual reconnection

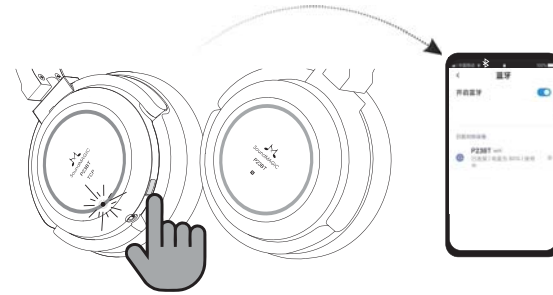

When unable to auto-reconnection, click the power button and the headset will automatically connect with the phone

## 9、 Voice function

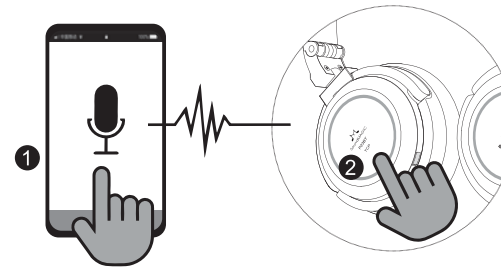

- 1、 Turn on voice assistant on the phone
- 2、 Three taps on the headphone touch panel to activate the voice assistant function

## 10、 Reset headset

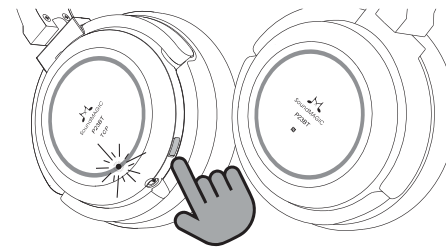

Turn off the headset, long press the button for 10 seconds, the red and blue lights 3 times, reset successful

## 11、Wired headset usage status

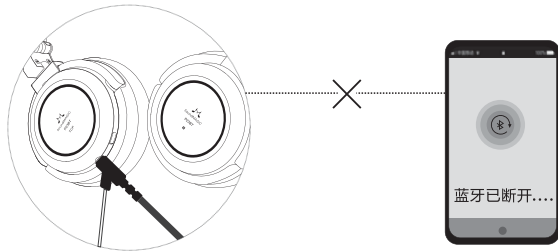

Once the headphone cable is plugged in, the power will be cut off, and the Bluetooth function will be disabled

## 12、Headset charging

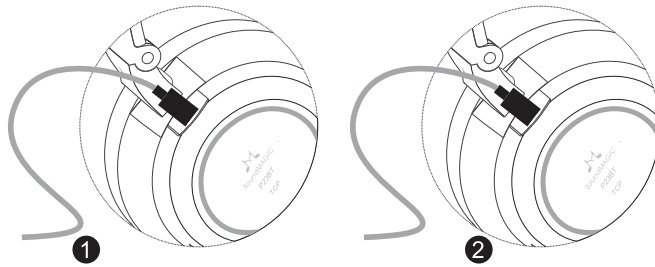

- 1、 Being charged when the headset is on: the red and blue lights will flash, and the blue light will on long bright when fully charged
- 2、 Being charged when the headset is off: the red light will long bright, and light off when fully charged

### Precautions

- 1、 Any improper use or unauthorized servicing that results in damage to your P23BT will void the warranty
- 2、 Do not use sharp objects near your P23BT
- 3、 Do not keep your P23BT in charging mode for long period
- 4、 Do not store your P23BT near toxic chemicals
- 5、 Do not store your P23BT near magnets
- 6、 Do not leave your P23BT with a fully drained battery for long period
- 7、 If your P23BT is out of use for a long time, please charge it periodically to protect the battery

## Common problems and solutions

Problem	Reasons	Solutions
Not turning on	Battery low	Charge battery
Disconnecting	Signal subject to interference	Re-pair the devices in a different place
Voice is still coming from smartphone during calls	Smartphone call audio is set to smartphone	Set to Bluetooth answer
Noise	Smartphone is too far away from P23BT or there's interference in the surrounding environment	Move closer to smartphone or move to a different place
The sound of headset is still low after the volume is turned up	The volume on the smartphone is too low	Increase the smartphone's volume

### Shenzhen SoundMAGIC Technology Development Co.,LTD

#### Address:

1613# Building A, Weidonglong Business Building, Meilong Road  
No 2125, Qinghua Community, Longhua District, Shenzhen, China  
TEL : 0755-88316487 FAX : 0755-88316487

FCC ID:A6B-P23BT

