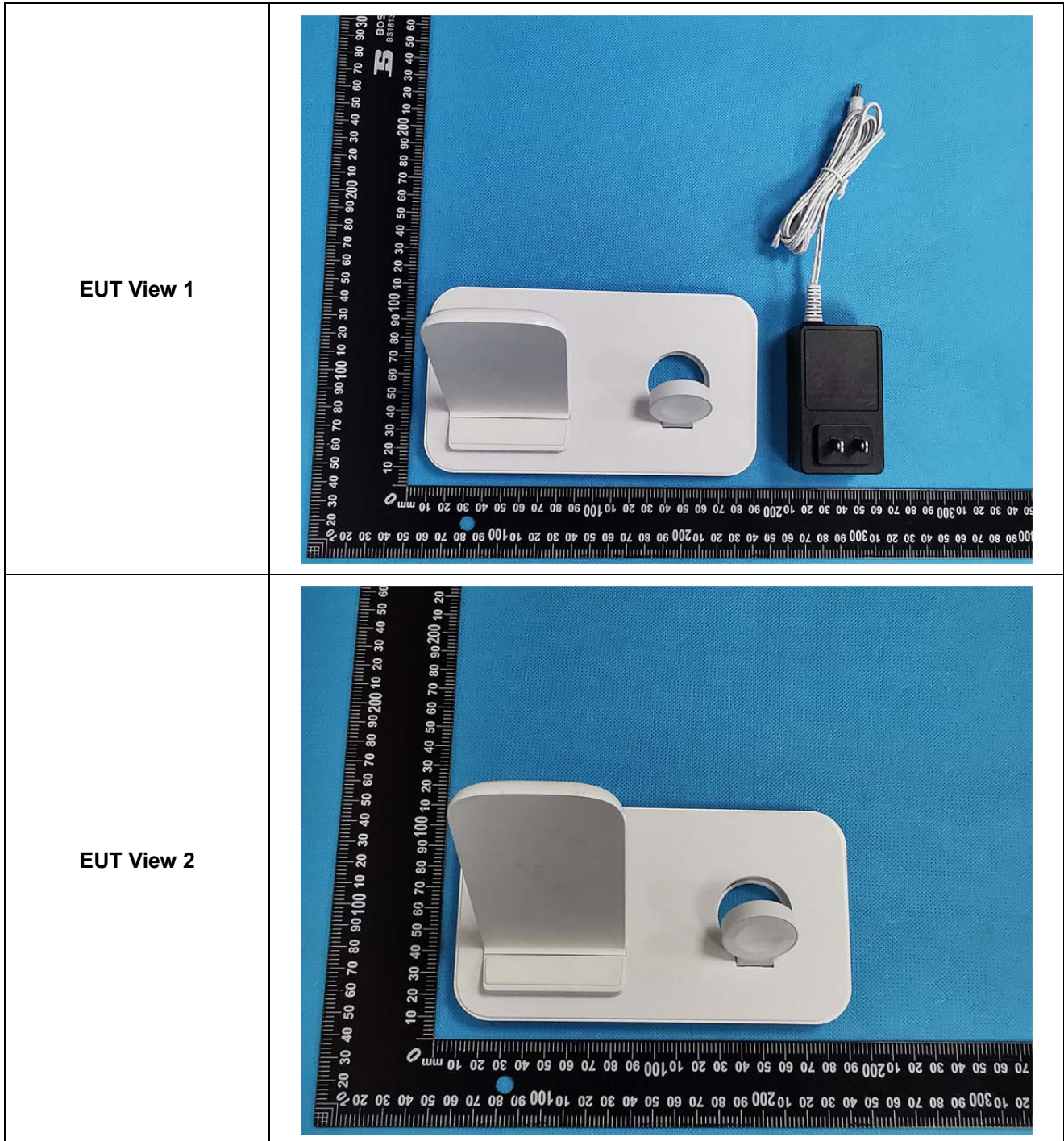

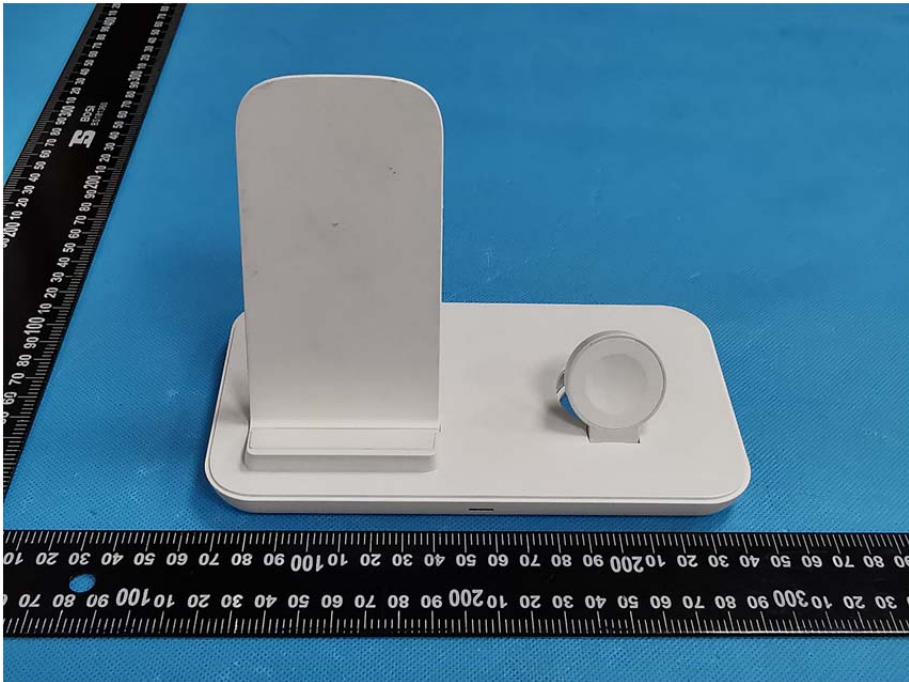

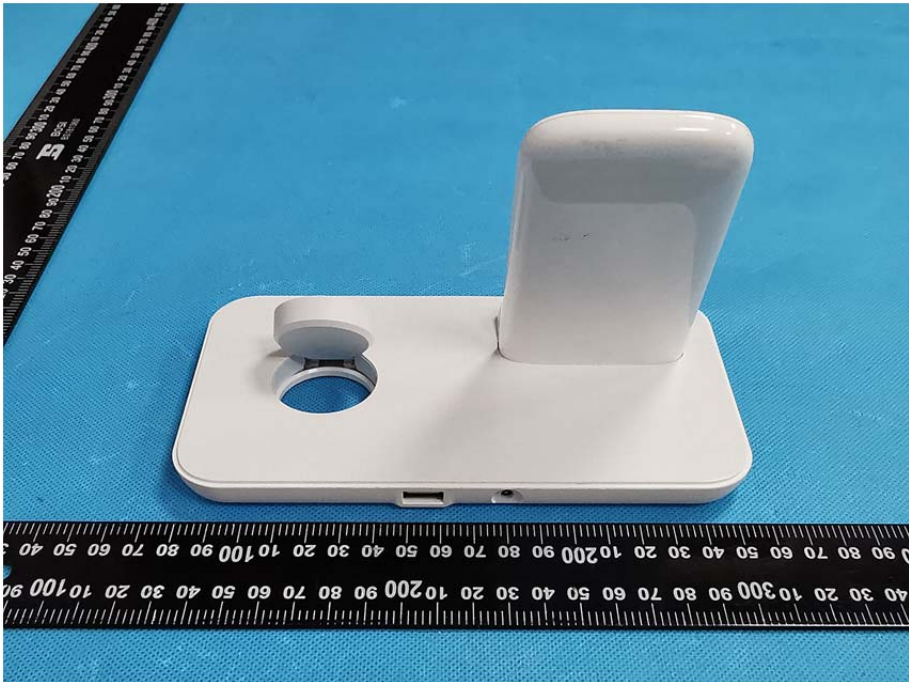

EXHIBIT 2 - EUT EXTERNAL PHOTOGRAPHS



<p>EUT View 3</p>	 A photograph of a white, rectangular electronic device (EUT) from a top-down perspective. The device has a circular opening on its front face and a vertical tab extending from its back. It is placed on a blue textured surface next to a black ruler with white markings for scale. The ruler shows centimeter and millimeter increments.
<p>EUT View 4</p>	 A photograph of the same white, rectangular electronic device (EUT) from a side perspective. The vertical tab is prominent, and the circular opening is visible on the side. The device is placed on a blue textured surface next to a black ruler with white markings for scale. The ruler shows centimeter and millimeter increments.

<p>EUT View 5</p>	 A photograph of a white plastic component, labeled 'EUT View 5'. The component has a rectangular base with rounded corners. On the right side of the base, there is a vertical, slightly curved stand. On the left side of the base, there is a circular hole with a small, raised rim. The component is placed on a blue textured surface. A black ruler with white markings is positioned horizontally below the component and vertically to its left for scale. The ruler shows measurements in millimeters and centimeters.
<p>EUT View 6</p>	 A photograph of the same white plastic component, labeled 'EUT View 6'. This view shows the component from a slightly different angle, highlighting the top surface of the vertical stand and the circular hole. The component is placed on the same blue textured surface. A black ruler with white markings is positioned horizontally below the component and vertically to its left for scale. The ruler shows measurements in millimeters and centimeters.

EUT View 7

