

## Mount the Doorbell

### Power the doorbell with battery

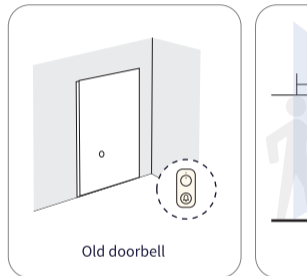

Old doorbell

#### Step 1

Remove the existing doorbell button at the front door.

Remove traces left on the door or wall.

12

#### Step 2

Determine the mounting position of the doorbell and the recommended mounting height is 1.5m (4.9 ft) from the ground.

13

#### Step 3

There are two methods to install the bracket. If you don't want to drill holes, you can use method 2 to install it.

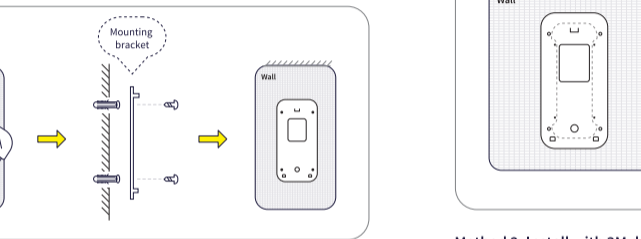

### Method 1: Install with screws

- 1 If you can reuse the existing holes and anchors on the wall or door frame, skip ①, otherwise, please align the mounting bracket and mark the four circles where the holes need to be drilled. Drill four holes above the four marked circles.
- 2 Insert four anchors into the holes and use the screws to affix the bracket over the anchors.

14

#### Step 4

### Method 2: Install with 3M double-sided tape

- 1 Stick 3M double-sided tape on the bracket.
- 2 Tear off the 3M release paper.
- 3 Select a glossy surface and press it to affix the bracket.

### Method 2: Install with 3M double-sided tape

Align the doorbell with the bottom of the mounting bracket, then press the top of the doorbell into place until it clicks.

After completion of installation, please jump to "Connect to the Doorbell Chime" on page 21.

15

#### Step 1

### Power the Doorbell with existing Doorbell Wires

Shut off the doorbell power supply. If you're not sure, shut off the main power supply in your house. Turn the lights in your home on / off to make sure the electricity in your house is properly shut off.

16

#### Step 2

### Remove the existing Doorbell Wires

Remove the existing doorbell button at the front door. Pull the two wires out carefully when removing the old doorbell.

17

#### Step 3

### Disconnect the doorbell from the wires

Disconnect the doorbell from the wires. Straighten the wire ends if necessary.

18

#### Step 4

### Determine the mounting position of the doorbell

Determine the mounting position of the doorbell and the recommended mounting height is 1.5m (4.9 ft) from the ground.

19

#### Step 5

### Method 1: Install with screws

- 1 If you can reuse the existing holes and anchors on the wall or door frame, skip ①, otherwise, please align the mounting plate and mark the four circles where the holes need to be drilled. Drill four holes above the four marked circles.
- 2 Insert four anchors into the holes and use the screws to affix the bracket over the anchors.

20

#### Step 6

### Method 2: Install with 3M double-sided tape

- 1 Stick 3M double-sided tape on the bracket.
- 2 Tear off the 3M release paper.
- 3 Select a glossy surface and press it to affix the bracket.

21

#### Step 7

### Connect the extension wires to the doorbell

Connect the extension wires and the doorbell wires with wire nuts provided. Use electrical wiring tape to secure the connection if the wall doesn't have space for wire nuts.

22

#### Step 8

### Align the doorbell with the mounting bracket

Align the doorbell with the bottom of the mounting bracket, then press the top of the doorbell into place until it clicks.

23

#### Step 9

### Switch the main circuit breaker back to ON

Switch the main circuit breaker back to ON. You're all set!

24

## Connect to the Doorbell Chime

### 1. Please plug the chime into the outlet first.

The AC outlet must be 100~240V and 50~60Hz.

### 2. Press and hold the [bell] button for more than 3 seconds.

You will see that the light turns a static white, indicating the chime is ready to pair with the doorbell.

### 3. Please ring the doorbell and press the [bell] button to confirm.

After you ring the doorbell and hear a beep, press the doorbell chime [bell] button to confirm the doorbell connection.

Press the [up] and [down] buttons to switch ringtones; press the [bell] button briefly to switch between 4 levels of volume.

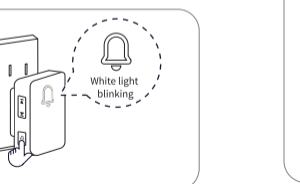

25

## Remove the Doorbell Chime

### Rest the Doorbell Chime

Long press the [bell] button until you hear a beep, then release it. Long press the [bell] button again until you hear 3 beeps, the reset is successful.

### Remove the Doorbell

Insert the detaching pin into the pin hole on the top of the doorbell, then lift the top for removal.

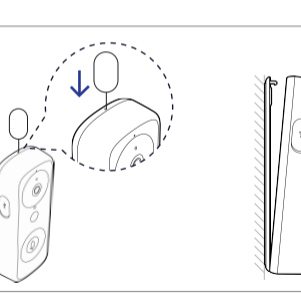

26

## Notice

### CAUTION

Risk of fire or explosion if the battery is replaced by an incorrect type.

Avoid replacement of a battery with an incorrect type that can defeat a safeguard.

Avoid disposal of a battery into fire or a hot oven, or mechanically crushing or cutting off a battery, that can result in an explosion.

Do not leave a battery in an extremely high temperature surrounding environment that can result in an explosion or the leakage of flammable liquid or gas; Do not leave a battery subjected to the extremely low air pressure that may result in an explosion or the leakage of flammable liquid or gas.

### Customer Service

### Warranty

12-month Limited Warranty

27