

JP
製品の保証について
詳細は当社ウェブサイトをご参照ください。http://jp.pqigroup.com

ユーザーガイド
より詳しい使用説明書が必要な場合は、弊社ウェブサイトにてご確認ください。
http://jp.pqigroup.com

取扱説明書
ステップ1: Air Pen express の USB コネクタをパソコンやUSB電源アダプタ等の USBポートに挿入して給電します。

ステップ2: LANケーブルを Air Pen express のLANポート (RJ45) に挿入します。
ステップ3: デバイス側の無線LAN機能をオンにしてAir Pen express に接続します。

ステップ4: インターネットブラウザを開き、アドレスバーに「192.168.200.1」と入力します。

ステップ5
Air Pen express 管理画面により各種設定を行います。

RU
Гарантия.
Для получения подробной информации о гарантии посетите наш веб-сайт по адресу www.pqigroup.com

Инструкция по эксплуатации
Для получения полного руководства пользователя посетите наш веб-сайт: www.pqigroup.com.

Начало работы
Этап 1. Вставьте USB-разъем устройства PQI Air Pen Express в питающий USB-порт компьютера.

Этап 2. Подсоедините кабель Ethernet от маршрутизатора к порту Ethernet на устройстве PQI Air Pen Express.

Этап 3. Откройте меню "wireless connection" (Радиосвязь) и выберите "Air Pen Express".

Этап 4. Запустите веб-браузер и в поле URL-адреса введите: "192.168.200.1".

Этап 5. Теперь вы можете использовать интерфейс управления для настройки устройства PQI Air Pen Express.

Warranty Card / 保 證 卡

Place of purchase / 購買地:

Customer Name / 消費者姓名:

Phone Number / 聯絡電話:

Product Description / 商品名稱:

Date of Purchase / 購買日期:

Distributor's Stamp / 經銷商店章:

PQI and PQI logo are registered trademarks of POWER QUOTIENT INTERNATIONAL CO.,LTD. All other trademarks and logos are the property of their respective owners. The advertised memory capacity of this device represents unformatted capacity. Please note that once formatted and due to variations in flash module block formations, the functional storage space will be lower than the advertised capacity.

Please ask the store or the distributor to fill out the warranty card as your proof of purchase. 請要求您所購買之經銷商將此保證卡填妥，以作為保單依據。

FCC Statement:

Federal Communication Commission Interference Statement
This equipment has been tested and found to comply with the limits for a Class B digital device, pursuant to Part 15 of the FCC Rules. These limits are designed to provide reasonable protection against harmful interference in a residential installation. This equipment generates, uses and can radiate radio frequency energy and, if not installed and used in accordance with the instructions, may cause harmful interference to radio communications. However, there is no guarantee that interference will not occur in a particular installation. If this equipment does cause harmful interference to radio or television reception, which can be determined by turning the equipment off and on, the user is encouraged to try to correct the interference by one of the following measures:
1. Reorient the receiving antenna.
2. Increase the separation between the equipment and receiver.
3. Connect the equipment into an outlet on a circuit different from that to which the receiver is connected
4. Consult the dealer or an experienced radio/TV technician for help.
FCC Caution: Any changes or modifications not expressly approved by the party responsible for compliance could void the user's authority to operate this equipment.

This device complies with Part 15 of the FCC Rules. Operation is subject to the following two conditions: (1) This device may not cause harmful interference, and (2) this device must accept any interference received, including interference that may cause undesired operation.
For product available in the USA/Canada market, only channel 1~11 can be operated. Selection of other channels is not possible.
This device and its antenna(s) must not be co-located or operation in conjunction with any other antenna or transmitter.

IMPORTANT NOTE: Federal Communication Commission (FCC) Radiation Exposure Statement

This EUT is compliant with SAR for general population/uncontrolled exposure limits in ANSI/IEEE C95.1-1999 and has been tested in accordance with the measurement methods and procedures specified in OET Bulletin 65 Supplement C.

NCC/DGT 警語

第十二條
型式認證合格之低功率射頻電機，非經許可，公司、商號或使用者均不得擅自變更頻率、加大功率或變更原設計之特性及功能。

第十四條
低功率射頻電機之使用不得影響飛航安全及干擾合法通信；經發現有干擾現象時，應立即停用，並改善至無干擾時方得繼續使用。
前項合法通信，指依電信法規定作業之無線電通信。
低功率射頻電機須忍受合法通信或工業、科學及醫療用電波輻射性電機設備之干擾。

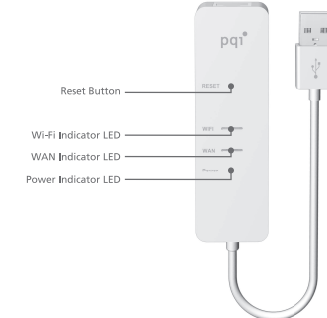

EN Warranty Information

For detailed warranty information, please visit our website at www.pqigroup.com.

User Guide
For the complete User Manual, please visit our website www.pqigroup.com.

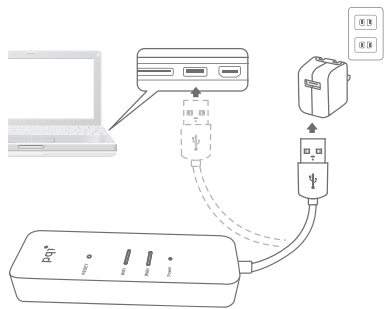

Getting Started
Step 1: Plug the USB connection on the PQI Air Pen express into any powered USB port.

Step 2: Plug an Ethernet cable into the PQI Air Pen express's Ethernet port.

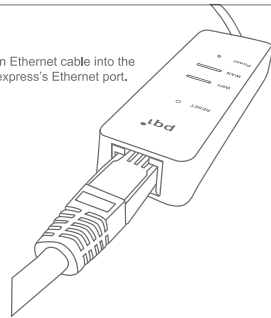

Step 3: Open the wireless setting menu on your device and select "PQI Air Pen express."

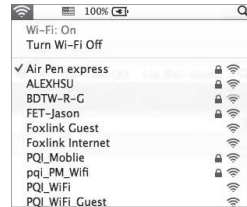

Step 4: Open the network browser and enter "192.168.200.1" into the web address box.
Step 5: Begin using the Air Pen express management interface.



GR
Garantie
Ausführliche Garantieinformationen finden Sie auf unserer Website www.pqigroup.com.

Bedienungsanleitung
Das ausführliche Benutzerhandbuch finden Sie auf unserer Website: www.pqigroup.com.

Erste Schritte
Schritt 1: Schließen Sie PQI Air Pen express mit einem USB-Kabel an einen USB-Anschluss des Computers an.
Schritt 2: Schließen Sie den PQI Air Pen express mit einem Netzwerk-Kabel an den Router an.
Schritt 3: Öffnen Sie das Menü "wireless connection" (Drahtlosverbindung), und wählen Sie "Air Pen express".
Schritt 4: Öffnen Sie den Webbrowser, und geben Sie in das URL-Feld "192.168.200.1" ein.
Schritt 5: Jetzt können Sie den PQI Air Pen express über die Benutzeroberfläche konfigurieren.

SP
Garantía
Para información detallada sobre la garantía, visite nuestro sitio web en www.pqigroup.com.

Manual del usuario
Para el manual del usuario completo, visite nuestro sitio web www.pqigroup.com.

Primeros pasos
Paso 1: Inserte el conector USB del PQI Air Pen express en un puerto USB con alimentación en el ordenador.
Paso 2: Conecte un cable Ethernet del router al puerto Ethernet del PQI Air Pen express.
Paso 3: Despliegue el menú "wireless connection" (Conexión inalámbrica) y seleccione "Air Pen express".
Paso 4: Abra su navegador Web y escriba "192.168.200.1" en el campo URL.
Paso 5: Ahora puede usar la interfaz de gestión para configurar su PQI Air Pen express.

FR
Garantie
Pour les informations détaillées concernant la garantie, veuillez visiter notre site Web à www.pqigroup.com

Guide de l'utilisateur
Pour le manuel utilisateur complet, veuillez visiter notre site Web www.pqigroup.com.
Mise en route
Étape 1: Insérez le connecteur USB du PQI Air Pen express dans n'importe quel port USB alimenté de votre ordinateur.
Étape 2: Connectez un câble Ethernet de votre routeur au port Ethernet du PQI Air Pen express.
Étape 3: Déroulez le menu «connexion sans fil» et sélectionnez «Air Pen express».
Étape 4: Ouvrez votre navigateur Web et saisissez «192.168.200.1» dans le champ d'URL.
Étape 5: Maintenant, vous pouvez utiliser l'interface de gestion pour configurer votre PQI Air Pen express.

TCN
保固說明
有關保固之詳細規定，請參閱本公司網站 www.pqigroup.com。

使用說明
如需完整使用手冊，請上網連結至 www.pqigroup.com。

第一次使用
步驟1 將 Air Pen express 的 USB 接頭插入有供電的 USB 插槽。
步驟2 將以太網路線連接至 Air Pen express 之 乙太網路連接線插槽。
步驟3 開啟無線網路並連接至 "Air Pen express"。
步驟4 開啟網路瀏覽器並於網址列輸入 "192.168.200.1"
步驟5 開始使用 Air Pen express 管理介面。

CN
保修说明
有关保固之详细规定，请参阅本公司网站 www.pqigroup.com。

使用说明
如需完整使用手册，请上网链接至 www.pqigroup.com。

第一次使用
步骤一: 将 Air Pen express 的 USB 接头插入可供电的 USB 插槽。
步骤二: 将以太网网线连接至 Air Pen express 的以太网连接插槽。
步骤三: 开启无线网络并连接至 "Air Pen express"。
步骤四: 开启网络浏览器并在网址列中输入 "192.168.200.1"。
步骤五: 开始使用 Air Pen express 管理界面。

FCC WARNING

This device complies with Part 15 of the FCC Rules. Operation is subject to the following two conditions:

- (1) This device may not cause harmful interference, and
- (2) this device must accept any interference received, including interference that may cause undesired operation.

NOTE 1: Any changes or modifications to this unit not expressly approved by the party responsible for compliance could void the user's authority to operate the equipment.