

Introduction

What is the WEA524i?

The Samsung WEA524i is an Access Point (AP) which has been designed for connecting a UE such as a smart phone, a tablet PC or a laptop that supports the wireless LAN to a wired network.

WEA524i supports the following features:

- IEEE 802.11a/b/g/n/ac standards
- PoE (Power over Ethernet) IEEE 802.3af/802.3at
- 4 x 4 MU-MIMO (Multi User-Multiple Input Multiple Output)
- 2.4 GHz and 5 GHz concurrent radios

Components

After unpacking the WEA524i, confirm that all of the following items have been included.



WEA524i

Package Contents

Mounting Bracket	5 M3 x L6 screws (Including 1 spare)	Installation Manual
Security Torx (T10) Screw	Plastic 4 anchors	4 M4 x L28 screws



- It is recommended to keep all packaging materials and the box.
- The power adaptor is sold separately. If necessary, contact the retailer.

Functions

Front View

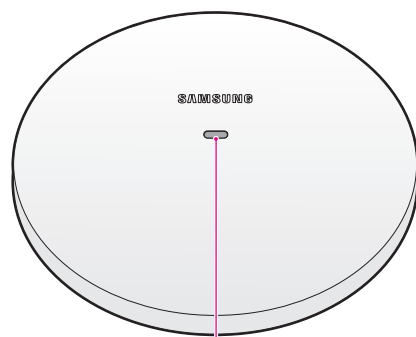

Status LED

Rear View

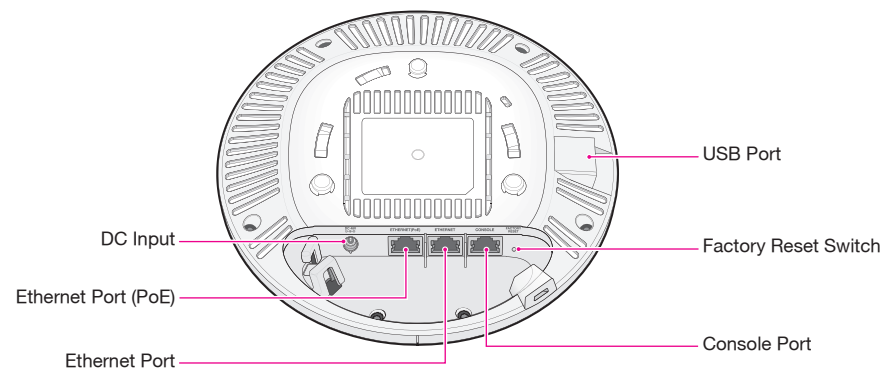

- USB Port
- Factory Reset Switch
- Console Port
- Ethernet Port (PoE)
- Ethernet Port
- DC Input

Interface

Port Name	Description
Status LED	Displays the operational status of the WEA524i via LED.
DC Input	This is for connecting the power adapter.
Ethernet Port (PoE)	Supports 1000 BASE-T Gigabit Ethernet and PoE IEEE 802.3af/802.3at.
Ethernet Port	Supports 1000 BASE-T Gigabit Ethernet.
Console Port	Used for checking the operational status of the WEA524i and for CLI input.
Factory Reset Switch	Used to reset the WEA524i to the initial factory settings.
USB Port	Supports USB 2.0

Status LED

LED	Status	Description
System start status	White On	Initial LED status
	Blue On	Device reset and test in progress
	Red On	Booting failure (Device reset failure)
Normal operation status	Green On	When there is no connected wireless UE
	Blue On	When there is a connected wireless UE
Upgrade	Green blinking	Software upgrade in progress
Error status	Red blinking	Physical connection error of network
	Yellow blinking	IP address conflict
	Violet blinking	Dynamic IP address allocation failure
	Red, green and off repeated	Wireless interface error

Installation

The WEA524i can be installed on ceilings or walls.

Please confirm that all of the components have been included before installation.

Before Installation

Safety Requirements

Carefully observe the following safety warnings in order to avoid the risk of damage or injury. For safe use, make sure to be well-informed.



- There is a risk of electrical shock. Make sure that the power is turned off during installation. Do not proceed with the installation if there is any electrical current leaking. It may cause a serious electric shock.
- Wear anti-static gloves or take an appropriate action to prevent ESD when handling the product.
- Do not connect a phone line to an Ethernet port. This may damage the product.
- This product must be connected to a power supply in compliance with IEEE 802.3af/at or connected to a limited power supply in compliance with IEC/EN/UL 60950-1.



- This product must be installed or removed by only appropriately trained service personnel.
- This product operates in the Safety Extra Low Voltage (SELV) state in compliance with IEC/EN/UL 60950-1.
- All the connected equipment including this product must be installed inside of the same building.
- For more details, refer to the Environment A of IEEE 802.3af/at standards.
- During installation, this product must be installed at least 3 m or more apart from WIMAX/3G/4G repeater or antenna.

Installation Instructions

The following instructions must be carefully observed during installation.

- The system must be installed in a place that is easily accessible for product installation, cable connections, and maintenance.
- The PoE cable must be always installed away from any electrical interference source such as power lines, fluorescent lights or transmitters.
- The PoE cable must be CAT 5e or higher.
- When PoE is unavailable, a power adapter (sold separately) can be used. The 3-pin (including ground) power socket that supplies 100~240 V AC, 50~60 Hz must be located within 2 m from each equipment and the power must be supplied through an independent circuit breaker. It is recommended to use the equipment that uses a filter or a surge protector.

Installation on Ceilings (When the ceiling type is T-bar)



- When incorrectly installed on the ceiling, the WEA524i may drop onto a person or equipment. Therefore, make sure to fix it firmly.
- If the ceiling type is not T-bar, please refer to the 'Installation Manual' provided separately. For this installation manual, please contact the dealer.

1. Remove the holding tape that was attached to fix the ceiling clip.

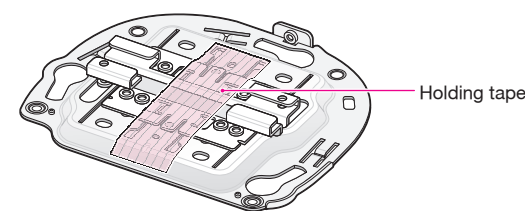

- Open the ceiling clip so that it is wider than the width of the T-bar.

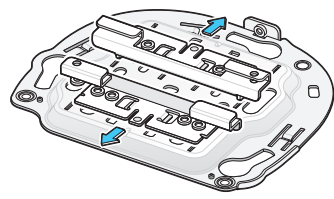

- Move the ceiling clip so that it is appropriate for the T-bar width.



- Fix the ceiling clip in place by tightening the 4 designated screws.

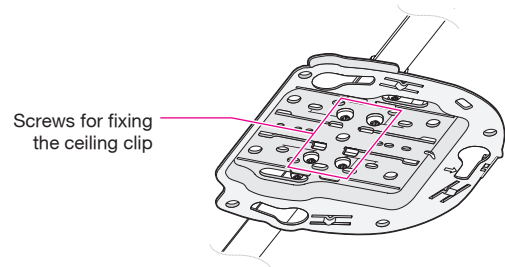

- Fix the T-bar in place by fastening the screws (total of 2) that are on the ceiling clip.

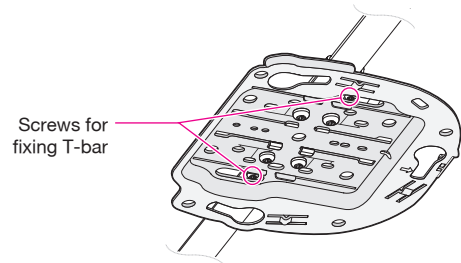

If the T-bar size of the ceiling is 15 mm, 24 mm or 38 mm, the position to fix the ceiling clip can be checked from the bottom surface of the mount bracket. If the T-bar size is unknown, push the ceiling clip to check the fixing positions.

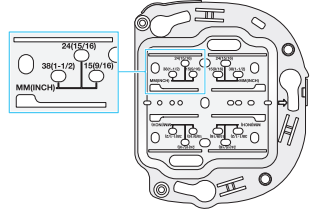

- Pull out a LAN cable through a hole on the ceiling and connect it to an Ethernet port (PoE) on the back side of the WEA524i.

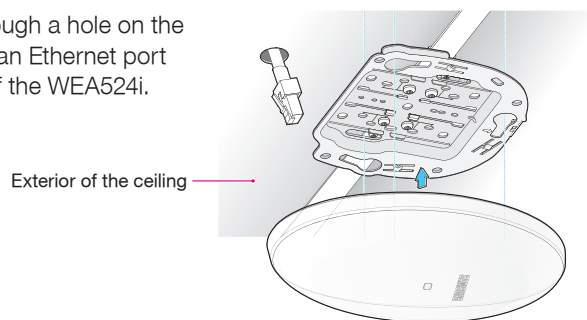

If PoE is not supported, connect the power adapter to the DC input on the back side of the WEA524i.

- Align the WEA524i with the 3 holes on the mount bracket and then turn clockwise to fix it in place. Clean up the ceiling and other cables.

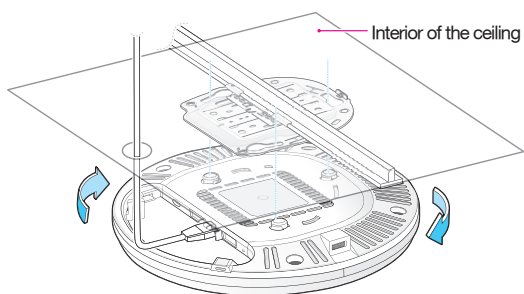

Installation on Walls

- Remove the holding tape that was attached to fix the ceiling clip.

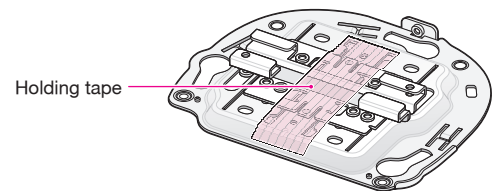

- Remove the ceiling clip from the mount bracket.

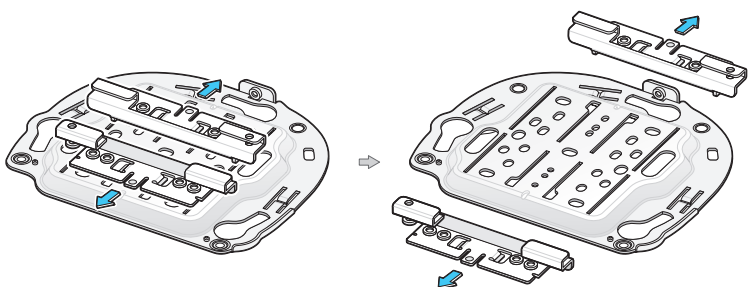

- Place the mount bracket on the wall. Mark and drill 4 screws in appropriate spots.

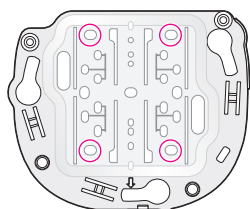

- Use a hammer to insert 4 plastic anchors into the drilled holes on the wall. Align the inserted plastic anchors and the screw holes of the bracket. Fix the bracket to the wall by fastening four M4 x L28 screws.

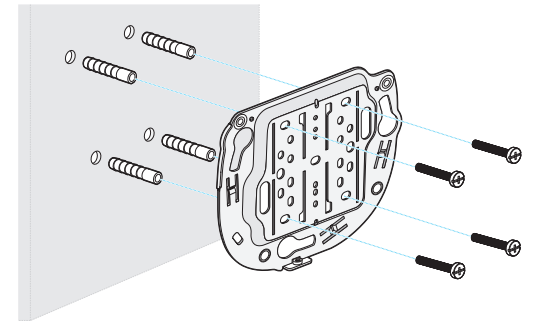

- Insert a LAN cable into the Ethernet port (PoE) on the back side of the WEA524i.



If PoE is not supported, connect the power adapter to the DC input on the back of the WEA524i.

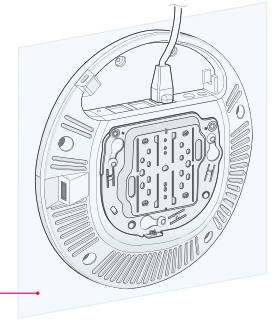

Installing Anti-Theft Lock Cable

When installing the WEA524i in a public place, it is recommended to use anti-theft lock cables to prevent any loss. (An anti-theft lock cable can be purchased separately and a variety of products can be found in the market.)

- Connect the anti-theft lock cable to the WEA524i.

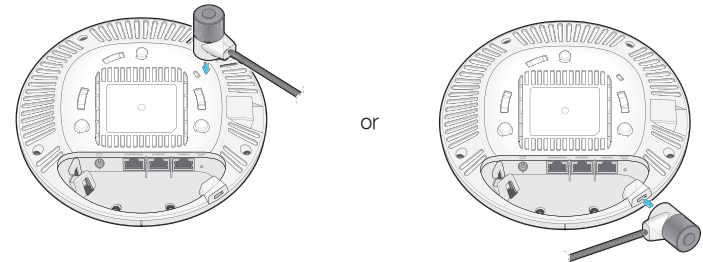

- Turn the lock cable key to lock the cable.
- Remove the key from the lock cable and keep it in a separate location.



Using the anti-theft Torx screws

The WEA524i can be prevented from being stolen when tightening the Torx screws as shown below. (Torx screws can be easily tightening when they are fixed to the mount bracket before assembling the AP product.)

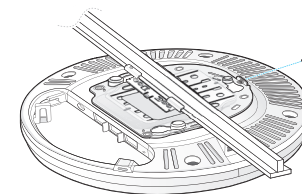

This equipment has been tested and found to comply with the limits for a Class B digital device, pursuant to part 15 of the FCC Rules. These limits are designed to provide reasonable protection against harmful interference in a residential installation.

This equipment generates, uses and can radiate radio frequency energy and, if not installed and used in accordance with the instructions, may cause harmful interference to radio communications. However, there is no guarantee that interference will not occur in a particular installation. If this equipment does cause harmful interference to radio or television reception, which can be determined by turning the equipment off and on, the user is encouraged to try to correct the interference by one or more of the following measures:

- Reorient or relocate the receiving antenna.
- Increase the separation between the equipment and receiver.
- Connect the equipment into an outlet on a circuit different from that to which the receiver is connected.
- Consult the dealer or an experienced radio/TV technician for help.



Changes or modifications not expressly approved by the party responsible for compliance could void the user's authority to operate the equipment.

The 5150-5250 MHz band is restricted to indoor use only. (Canada)

The 5150-5350 MHz band is restricted to indoor use only. (Europe)

This device complies with Industry Canada license-exempt RSS standard(s). Operation is subject to the following two conditions: (1) this device may not cause interference, and (2) this device must accept any interference, including interference that may cause undesired operation of the device.

Le présent appareil est conforme aux CNR d'Industrie Canada applicables aux appareils radio exempts de licence. L'exploitation est autorisée aux deux conditions suivantes: (1) l'appareil ne doit pas produire de brouillage, et (2) l'utilisateur de l'appareil doit accepter tout brouillage radioélectrique subi, même si le brouillage est susceptible d'en compromettre le fonctionnement.

RF Radiation Exposure Statement:

This equipment complies with RF radiation exposure limits set forth for an uncontrolled environment. This equipment should be installed and operated with a minimum distance of 50 cm between the radiator and your body. This transmitter must not be co-located or operating in conjunction with any other antenna or transmitter.

RSS-102 RF Exposure

L'antenne (ou les antennes) doit être installée de façon à maintenir à tout instant une distance minimum de au moins 50 cm entre la source de radiation (l'antenne) et toute personne physique. Cet appareil ne doit pas être installé ou utilisé en conjonction avec une autre antenne ou émetteur.



Should the AP be installed in a ceiling with ventilation, the AP Ethernet port must be horizontally placed.

This product is RoHS compliant.

Regulatory Information

"Hereby, Samsung Electronics declares that the WEA524i is in compliance with Directive 2014/53/EU. The full text of the EU declaration of conformity is available at the following internet address: <http://www.samsungdocs.com>, go to Search Product and enter the model name."

<http://www.samsungenterprise.com>

Part No.: EC68-00233A (Ver.1.0)