

# TOSHIBA

## Leading Innovation >>>

### Audio Base Speaker System

### User's Guide:

### ABX3250KN

If you need assistance:

- ❖ Toshiba's Support Web site : [support.toshiba.com](http://support.toshiba.com)  
Toshiba Canada Support Web site : [www.toshiba.ca/support/ceg](http://www.toshiba.ca/support/ceg)
- ❖ Call Toshiba Customer Support Center:  
Within the United States at (888) 592-0944  
Outside the United States at (949) 583-3305  
From Canada at (800) 268-3404

For more information see "Troubleshooting" on page 18 in this guide.

#### Owner's Record

The model number and serial number are on the back and underside of your Audio Base. Record these numbers, and use them whenever you communicate with your Toshiba dealer about this Audio Base.

Model name \_\_\_\_\_

Serial number \_\_\_\_\_

---

# Contents

Introduction .....	6
Safety icons used in this manual.....	6
Audio Base Speaker System controls .....	7
Remote control .....	10
Audio Base Speaker System placement .....	12
Audio Base Speaker System connections .....	13
Troubleshooting .....	18
Specifications .....	19
Maintenance .....	19

## Safety Precautions



The lightning flash with an arrowhead symbol, within the equilateral triangle, is intended to alert the user to the presence of uninsulated "dangerous voltage" within the product's enclosure that may be of sufficient magnitude to constitute a risk of electric shock to persons.

The exclamation point within the equilateral triangle is intended to alert the user to the presence of important operating and maintenance (servicing) instructions in this User's Guide.

**WARNING:** TO REDUCE THE RISK OF FIRE OR ELECTRIC SHOCK, DO NOT EXPOSE THIS APPLIANCE TO RAIN OR MOISTURE. DANGEROUS HIGH VOLTAGES ARE PRESENT INSIDE THE ENCLOSURE. DO NOT OPEN THE CABINET. REFER SERVICING TO QUALIFIED PERSONNEL ONLY.

TO PREVENT ELECTRIC SHOCK, MATCH WIDE BLADE OF PLUG TO WIDE SLOT OF AC POWER OUTLET, THEN FULLY INSERT.

CHANGES OR MODIFICATIONS MADE TO THIS EQUIPMENT, NOT EXPRESSLY APPROVED BY TOSHIBA, OR PARTIES AUTHORIZED BY TOSHIBA, COULD VOID THE USER'S AUTHORITY TO OPERATE THE EQUIPMENT.

To ensure proper use of this product, please read this User's Guide carefully and retain for future reference. Should the unit require maintenance, contact an authorized service location. Use of controls or adjustments or performance of procedures other than those specified herein may result in hazardous radiation exposure.



The symbol for Class II  
(Double Insulation)

### Warnings:

- The mains plug is used as a disconnect device and it should remain readily operable during intended use. In order to disconnect the apparatus from the mains completely, the main plug should be disconnected from the mains socket outlet completely.
- The apparatus shall not be exposed to dripping or splashing and that no objects filled with liquids, such as vases, shall be placed on apparatus.
- The mains plug is used as disconnect device. The mains plug of apparatus should not be obstructed OR should be easily accessed during intended use.
- To be completely disconnect the power input, the mains plug of apparatus shall be disconnected from the mains.

## Important Safety Instructions

1. Read these instructions.
2. Keep these instructions.
3. Heed all warnings.
4. Follow all instructions.
5. Do not use this apparatus near water.
6. Clean only with a dry cloth.
7. Do not block any of the ventilation openings. Install in accordance with the manufacturer's instructions.
8. Do not install near any heat sources such as radiators, heat registers, stoves, or other apparatus (including amplifiers) that produce heat.
9. Do not defeat the safety purpose of the polarized or grounding - type plug. A polarized plug has two blades with one wider than the other. A grounding type plug has two blades and a third grounding prong. The wide blade or the third prong are provided for your safety. When the provided plug does not fit into your outlet, consult an electrician for replacement of the obsolete outlet.
10. Protect the power cord from being walked on or pinched particularly at plugs, convenience receptacles, and the point where they exit from the apparatus.
11. Only use attachments/accessories specified by the manufacturer.
12. Use only with a cart, stand, tripod, bracket, or table specified by the manufacturer, or sold with the apparatus. When a cart is used, use caution when moving the cart/apparatus combination to avoid injury from tip-over.
13. Unplug this apparatus during lightning storms or when unused for long periods of time.
14. Refer all servicing to qualified service personnel. Servicing is required when the apparatus has been damaged in any way, such as the power-supply cord or plug is damaged, liquid has been spilled or objects have fallen into the apparatus, the apparatus has been exposed to rain or moisture, does not operate normally, or has been dropped.



## Additional Safety Instructions

15. Do not overload wall outlets; extension cords, or integral convenience receptacles as this can result in a risk of fire or electric shock.
16. Never expose the apparatus to dripping or splashing or place items such as vases, aquariums, any other item filled with liquid, or candles on top of the unit.
17. Do not place the apparatus on amplifiers or equipment that may produce heat.
18. Never block or cover the slots or openings in the unit. Never place the unit:
  - on a bed, sofa, rug or similar surface;
  - too close to drapes, curtains, or walls; or
  - in a confined space such as a bookcase, built-in cabinet, or any other place with poor ventilation.

### USA

#### Federal Communications Commission Statement

#### FCC Compliance Statement

This device complies with Part 15 of the FCC Rules. Operation is subject to the following two conditions: (1) This device may not cause harmful interference, and (2) This device must accept any interference received, including interference that may cause undesired operation.

#### FCC RF Radiation Exposure Statement

**Caution:** To maintain compliance with the FCC's RF exposure guidelines, place the Audio Base Speaker System at least 20cm from nearby persons.

#### Interference

*This equipment has been tested and found to comply with the limits for a Class B digital device, pursuant to Part 15 of the FCC Rules. These limits are designed to provide reasonable protection against harmful interference in a residential installation. This equipment generates, uses, and can radiate radio frequency energy and, if not installed and used in accordance with the instructions, may cause harmful interference to radio communications. However, there is no guarantee that interference will not occur in a particular installation. If this equipment does cause harmful interference to radio or television reception, which can be determined by turning the equipment off and on, the user is encouraged to try to correct the interference by one of the following measures:*

- Reorient or relocate the receiving antenna.
- Increase the separation between the equipment and receiver.
- Connect the equipment into an outlet on a circuit different from that to which the receiver is connected.
- Consult the dealer or an experienced radio/TV technician for help.

The slots and openings are provided to protect the unit from overheating and to help maintain reliable operation.

19. If the apparatus should emit smoke or an unusual odor, immediately disconnect the power cord from the wall outlet. Wait until the smoke or smell stops, then ask your dealer for a check and repair. Neglecting to do so may cause fire.
20. During thunderstorms, do not touch the connecting cables or the apparatus.
21. Warning: To prevent spread of fire, keep candles or other open flames away from this product at all times.

This device complies with Industry Canada Licence-exempt RSS-210. Operation is subject to the following two conditions: (1) this device may not cause interference, and (2) this device must accept any interference, including interference that may cause undesired operation of the device.

#### CAN ICES-3 (B) / NMB-3 (B)

#### Bluetooth® Wireless Technology and Your Health

The products with Bluetooth® wireless technology, like other radio devices, emit radio frequency electromagnetic energy. The level of energy emitted by devices with Bluetooth® wireless technology however is much less than the electromagnetic energy emitted by wireless devices such as mobile phones.

Because products with Bluetooth® wireless technology operate within the guidelines found in radio frequency safety standards and recommendations, TOSHIBA believes Bluetooth® wireless technology is safe for use by consumers.

These standards and recommendations reflect the consensus of the scientific community and result from deliberations of panels and committees of scientists who continually review and interpret the extensive research literature.

In some situations or environments, the use of Bluetooth® wireless technology may be restricted by the proprietor of the building or responsible representatives of the organization. These situations may, for example, include in any other environment where the risk of interference to other devices or services is perceived or identified as harmful.

If you are uncertain of the policy that applies on the use of wireless devices in a specific organization or environment (e.g. airports), you are encouraged to ask for authorization to use the device with Bluetooth® wireless technology prior to turning on the equipment.

## Precautions

### On Safety

Do not handle the AC power cord with wet hands. When connecting or disconnecting the AC power cord, grip the plug and not the cord itself. Pulling the cord may damage it and create a hazard. When you are not going to use the unit for a long period of time, disconnect the AC power cord.

### On Recycling

This unit's packaging materials are recyclable and can be reused. Please dispose of any materials in accordance with your local recycling regulations. Batteries should never be thrown away or incinerated but disposed of in accordance with your local regulations concerning chemical wastes.

## Copyright

Under the copyright laws, this guide cannot be reproduced in any form without the prior written permission of Toshiba. No patent liability is assumed, however, with respect to the use of the information contained herein.

© 2014 by Toshiba America Information Systems, Inc.. All rights reserved.

### Notice

The information contained in this manual, including but not limited to any product specifications, is subject to change without notice.

TOSHIBA AMERICA INFORMATION SYSTEMS, INC. AND TOSHIBA OF CANADA LIMITED. (COLLECTIVELY TOSHIBA) PROVIDES NO WARRANTY WITH REGARD TO THIS MANUAL OR ANY OTHER INFORMATION CONTAINED HEREIN AND HEREBY EXPRESSLY DISCLAIMS ANY IMPLIED WARRANTIES OF MERCHANTABILITY OR FITNESS FOR ANY PARTICULAR PURPOSE WITH REGARD TO ANY OF THE FOREGOING. TOSHIBA ASSUMES NO LIABILITY FOR ANY DAMAGES INCURRED DIRECTLY OR INDIRECTLY FROM ANY TECHNICAL OR TYPOGRAPHICAL ERRORS OR OMISSIONS CONTAINED HEREIN OR FOR DISCREPANCIES BETWEEN THE PRODUCT AND THE MANUAL. IN NO EVENT SHALL TOSHIBA BE LIABLE FOR ANY INCIDENTAL, CONSEQUENTIAL, SPECIAL, OR EXEMPLARY DAMAGES, WHETHER BASED ON TORT, CONTRACT OR OTHERWISE, ARISING OUT OF OR IN CONNECTION WITH THIS MANUAL OR ANY OTHER INFORMATION CONTAINED HEREIN OR THE USE THEREOF.

## Trademarks

Android™ and Google Play™ are trademarks of Google Inc.

 **Bluetooth®** The Bluetooth® word mark and logos are registered trademarks owned by Bluetooth SIG, Inc. and any use of such marks by Toshiba Corporation is under license.

Blu-ray™, Blu-ray Disc™, and the logo are trademarks of the Blu-ray Disc Association.

 **DOLBY DIGITAL** Manufactured under license from Dolby Laboratories. Dolby, and the double-D symbol are registered trademarks of Dolby Laboratories.

 **HDMI®** The terms HDMI and HDMI High-Definition Multimedia Interface, and the HDMI Logo are trademarks or registered trademarks of HDMI Licensing LLC in the United States and other countries.

 **dts®** For DTS patents, see <http://patents.dts.com>. Manufactured under license from DTS Licensing Limited. DTS, the Symbol, & DTS and the Symbol together are registered trademarks, and DTS Studio Sound and DTS TruVolume are trademarks of DTS, Inc. © DTS, Inc. All Rights Reserved.

 **N™** The N Mark is a trademark or registered trademark of NFC Forum, Inc. in the United States and in other countries.

All other brand and product names are trademarks or registered trademarks of their respective companies.

---

## Introduction

### Safety icons

This guide contains safety instructions that must be observed to avoid potential hazards that could result in personal injuries, damage to your equipment, or loss of data. These safety cautions have been classified according to the seriousness of the risk, and icons highlight these instructions as follows:

---

**⚠ DANGER** Indicates an imminently hazardous situation which, if not avoided, will result in death or serious injury.

---

**⚠ WARNING** Indicates a potentially hazardous situation which, if not avoided, could result in death or serious injury.

---

**⚠ CAUTION** Indicates a potentially hazardous situation which, if not avoided, may result in minor or moderate injury.

---

**CAUTION** Indicates a potentially hazardous situation which, if not avoided, may result in property damage.

---

**NOTE** Provides important information.

---

### Supplied Accessories

Remote Control (SE-R0451) with Batteries (AAA x 2)

User's Guide (this manual)

Quick Start

Warranty

Stop Return Sheet

## Audio Base Speaker System controls

### Audio Base top & front panel controls

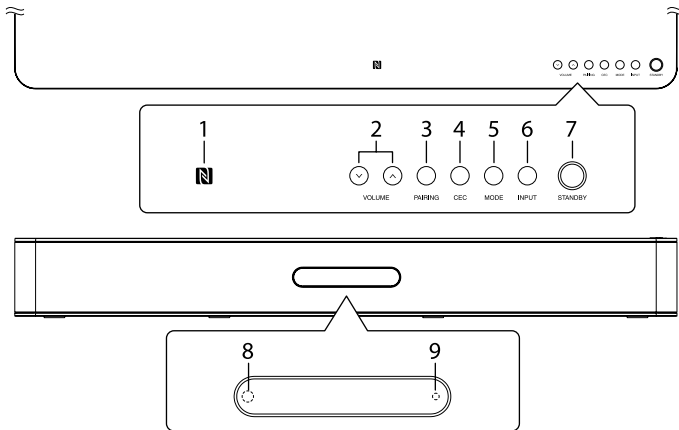

(Sample Illustration) Top & Front panel controls

Item:	Description:	Function:
1	NFC (N-Mark)	NFC tag indicator/touch point. In NFC tag applications, the N-Mark is used to identify the position over an NFC tag where the consumer can align an NFC-enabled device to initiate an NFC interaction.
2	<b>VOLUME</b> button	Press to adjust the volume level.
3	<b>PAIRING</b> button	Press to pair the Bluetooth® enabled device.
4	<b>CEC</b> button	Press to turn the HDMI® (High-Definition Multimedia Interface) CEC on/off.
5	<b>MODE</b> button	Press to select the sound setting. (Flat/Music/Live/News/Drama/Cinema/Stadium/Game)
6	<b>INPUT</b> button	Press to switch between HDMI 1/2 (HDMI® IN), ARC (HDMI® ARC) , BT (Bluetooth®), OPT 1/2 (OPTICAL IN), AUX (AUX IN) or LINE-IN.
7	<b>STANDBY</b> button	Press to turn on the unit or place it into standby mode. To completely turn the unit off, you must unplug the AC power cord.
8	Remote Sensor	Receives the signal from the remote control.
9	Standby Indicator	Indicates whether the unit is ON or in STANDBY (OFF) mode. Light On: The unit is in STANDBY. Light Off: The unit is turned ON.

## Audio Base back panel

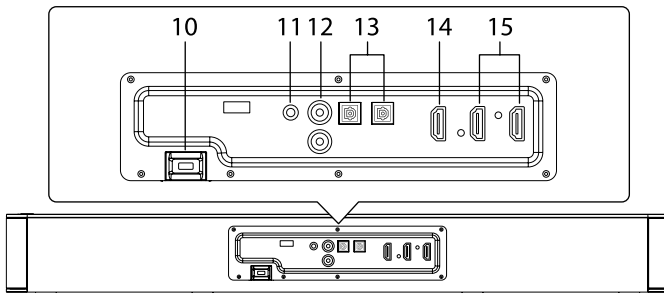

*(Sample Illustration) Back panel connections*

Item:	Description:	Functions:
10	AC power cord	Connects to a standard AC outlet to supply power to the Audio Base.
11	LINE IN jack	Connects other AV devices through the LINE IN jack, see “Connect audio through an analog audio cable” section on page 15.
12	AUX IN jack (L / R)	Connects other AV devices through the AUX IN jack, see “Connect audio through an analog audio cable” section on page 14.
13	OPTICAL IN jack (1) & (2)	Connects the optical audio input to another device, see “Connecting to an Audio System” on page 14.
14	HDMI® OUT jack	Audio Return Channel (ARC) enables the audio signal of the TV to be sent to the Audio Base via the HDMI® cable. See “Connecting to a TV using an HDMI® (ARC) cable” on page 13.
15	HDMI® IN jack (1) & (2)	HDMI® cable connects to devices that have an HDMI® output. See “Connecting to a compatible device” section on page 13.



## Subwoofer

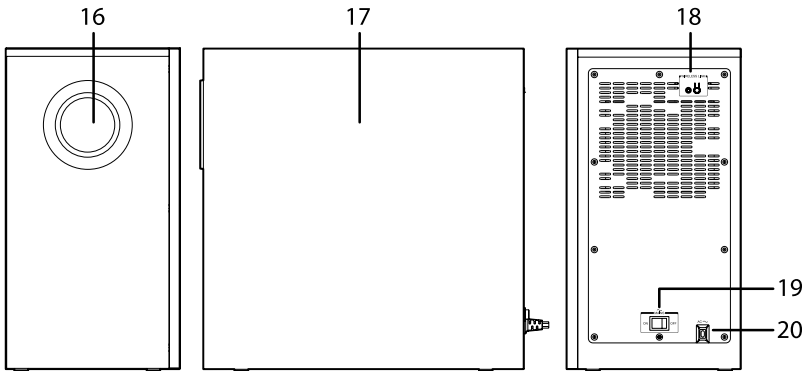

*(Sample Illustration) Subwoofer connections*

Item:	Description:	Functions:
16	Bass port	Provides the rich bass response.
17	Subwoofer Speaker	Provides the different of sound field.
18	<b>WIRELESS LINK</b> button <b>WIRELESS LINK</b> indicator	Press to pair the subwoofer with the Audio Base. The indicator is red when the wireless link is activated.
19	<b>POWER</b> switch	Turns the subwoofer <b>ON/OFF</b> .
20	Power cord	Connects to a standard AC outlet to supply power to the subwoofer.

## Remote control

Item:	Description:	Operation:
1	<b>MUTE</b>	Press to turn the sound off. Press again to cancel.
2	<b>AUTO VOL.</b>	DTS TruVolume™(AUTO VOLUME) is an intelligent approach to eliminating disparities in volume levels. Press to turn the AUTO VOLUME on/off.
3	<b>^ VOLUME v</b>	Press to adjust the volume level.
4	<b>◀◀ PRE/NEXT ▶▶</b>	Press to go to the last track or advance to the next track in Bluetooth® mode.
5	<b>▶▶ PLAY/PAUSE</b>	Press to play/pause the track in Bluetooth® mode.
6	<b>MODE</b>	Press to select the sound setting. (Flat / Music / Live / News / Drama / Cinema / Stadium / Game)
7	<b>^ BASS v</b>	Press to adjust the bass volume level.
8	<b>^ SUB v</b>	Press to adjust the subwoofer volume level.
9	<b>POWER</b>	Press to turn the Audio Base <b>ON/OFF</b> .
10	<b>INPUT</b>	Press to select the source. (HDMI® 1/2 (HDMI® IN), ARC (HDMI® ARC), BT (Bluetooth®), OPT 1/2 (OPTICAL IN), AUX (AUX IN), LINE-IN)
11	<b>SURROUND</b>	Press to select the Surround on/off.
12	<b>^ TREBLE v</b>	Press to adjust the treble volume level.

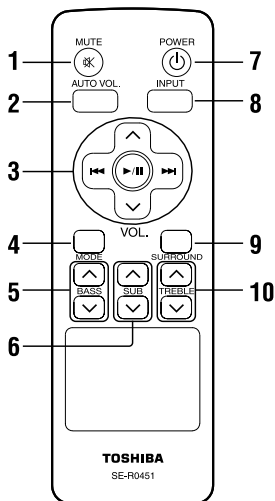

(Sample Illustration)  
Remote control

## Installing the batteries

Install the batteries (AAAx2), matching the polarity indicated inside the battery compartment of the remote control.

- 1 Open the battery cover.

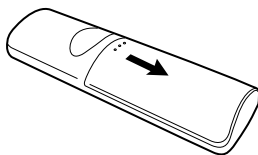

*(Sample Illustration) Remote control - Opening the battery cover*

- 2 Insert batteries.

Make sure to match the polarity marks (+ / -) on the batteries to the marks indicated in the battery compartment.

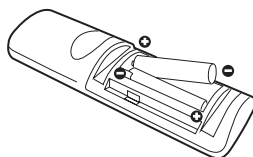

*(Sample Illustration) Remote control - inserting the batteries*

- 3 Replace the battery cover.

---

**▲ WARNING** Never throw batteries in a fire. Doing so may cause the batteries to explode.

---

---

**CAUTION** Battery shall not be exposed to excessive heat such as sunshine, fire or the like.

---

### NOTE

- ❖ Dispose of batteries in a designated disposal area.
  - ❖ Always consider the environment when disposing of batteries.
  - ❖ Always follow applicable laws and regulations.
  - ❖ If the remote does not operate correctly, or if the operating range is reduced, replace the batteries.
  - ❖ Always replace both batteries with new ones. Never mix battery types or use new and used batteries together.
  - ❖ Always remove batteries from the remote if they are dead or if the remote control is not to be used for an extended period of time.
  - ❖ This prevents battery acid from leaking into the battery compartment.
-

## Audio Base Speaker System placement

You can put the TV on top of the Audio Base Speaker System.

In order to put the Audio Base under a TV, the TV must be less than:

- ❖ 99 lbs (45kg) and
- ❖ the TV's bottom stand must be approximately 25.1 inches (638mm) by 11.8 inches (302mm) in depth.

### **▲ WARNING**

- ❖ Keep the TV at the center of the surface of the Audio Base Speaker System. Do not place the TV on the edge of the unit. Placing the TV incorrectly may result in a personal injury and/or property damage.
- ❖ DO NOT cover the controls and/or the NFC tag on the top of the Audio Base. The minimum distance from the edge is 2.4 inches (60mm).
- ❖ DO NOT connect the TV to the Audio Base Speaker System. Please refer to TV's user's manual for installation and fall prevention.
- ❖ DO NOT place a CRT type TV on this Audio Base Speaker System. It is not designed for use with CRT TVs.

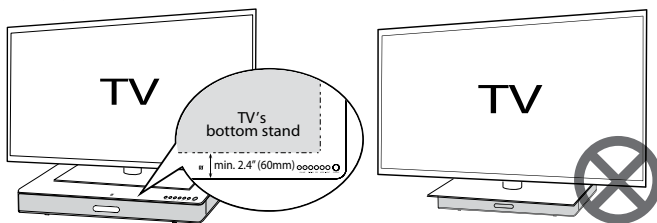

- ❖ Place the subwoofer at least 11.8" (300mm) away from the Audio Base.

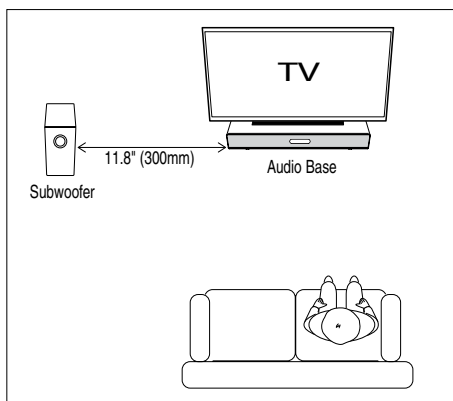

*(Sample Illustration) Subwoofer placement*

## Audio Base Speaker System connections

### Connecting to a TV using an HDMI® (ARC) cable.

This feature enables the audio signal of the TV to be sent to the Audio Base via the HDMI® cable. The HDMI® cable is not included and must be purchased separately. Be sure that the connected TV has an HDMI® (ARC) compatible terminal. To connect the HDMI® ARC cable:

1. Connect an HDMI® cable from the HDMI® output jack on the Audio Base to the HDMI® input jack on the TV.
2. Press the **INPUT** button to select the HDMI®-ARC mode and the display will be shown “ARC”.

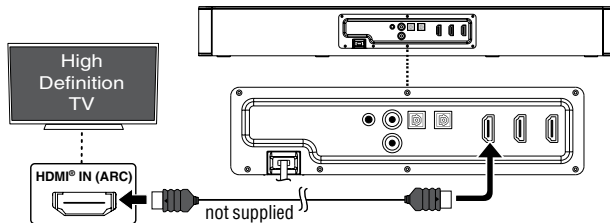

(Sample Illustration) HDMI® OUT ARC connection

#### NOTE

- ❖ Do not tilt the connector when inserting it into the HDMI® jack, and make sure the shapes of the jack and the connector are aligned properly.
- ❖ If your TV is not HDMI® (ARC) compliant, connect your Audio Base to the TV through a standard HDMI® connection.
- ❖ The optical digital audio cable connections is needed when the HDMI® cable is connected to a terminal that is not HDMI® (ARC). (For more information, please refer to “Connecting to an audio system” on page 14.)

### Connecting to a compatible device.

You can output the audio signal from the compatible device (e.g. Blu-ray Disc™ player, DVD player etc.) with this Audio Base and pass the signal through to your TV.

1. Connect an HDMI® cable from the HDMI® input jack on the Audio Base to the HDMI® output jack on the other device.
2. Connect an HDMI® cable from the HDMI® output jack on the Audio Base to the HDMI® input jack on the TV.
3. Press the **INPUT** button to select the HDMI® mode and the display will be shown “HDMI-1” or “HDMI-2”.

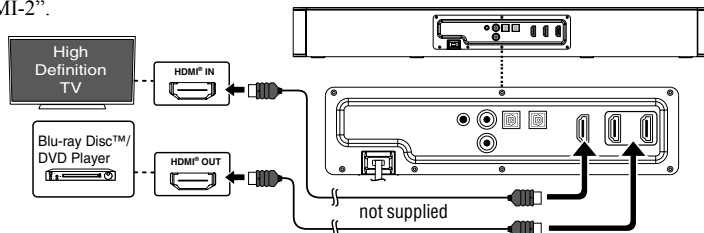

(Sample Illustration) HDMI® compatible device connection

## Connecting to an Audio System.

You can connect your Audio Base to an audio system to play audio from other devices.

### Connect audio through a digital optical cable

1. You can connect a optical cable from the OPTICAL input jack on the Audio Base to the OPTICAL output jack on the other device.
2. Press the **INPUT** button to select the OPTICAL mode and the display will show “OPT-1” or “OPT-2”.

**NOTE** When your Audio Base and TV are connected through HDMI® (ARC), an audio connection is not required.

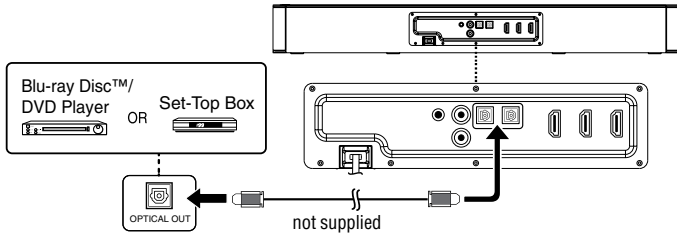

(Sample Illustration) Digital optical cable connections

### Connect audio through an analog audio cable.

You can connect an audio cable (not included) from the L/R AUX input jack on the Audio Base to the Audio output jack on the other device.

1. Press the **INPUT** button to select the AUX IN mode and the display will show “AUX”.

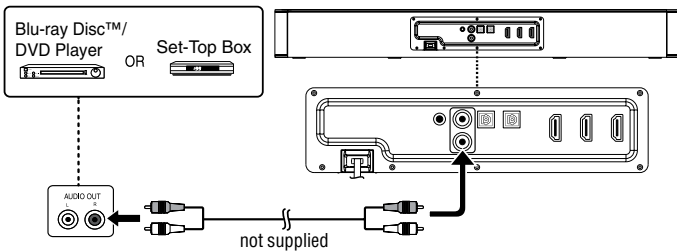

(Sample Illustration) Analog audio connections

2. Connect a 3.5mm cable (not included) from the LINE input jack on the Audio Base to the other device.
3. Press the **INPUT** button to select the LINE IN mode and the display will show “LINE-IN”.

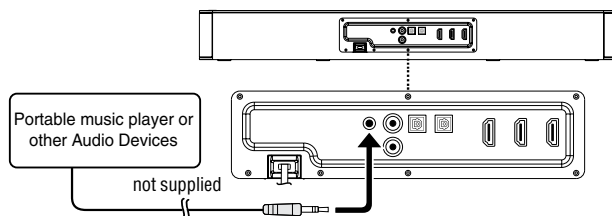

(Sample Illustration) 3.5mm connection to audio device

### Connecting to a AC power cord.

Connect the AC power cord on both the Audio Base and the Subwoofer to the electrical wall outlet.

#### CAUTION

- ❖ Before use, ensure the rated voltage of the AC power cord matches your local voltage.
- ❖ Be sure the AC power cord is disconnected and all functions are off before making connections.
- ❖ **To prevent electrical shock, match wide blade of plug to wide slot of wall outlet, then fully insert.**
- ❖ If you are not going to use the unit for an extended period of time, disconnect the AC power cord from the wall outlet.
- ❖ Whenever the AC power cord is plugged in to a wall outlet, the AC power cord will draw some power, even when the unit is turned off.

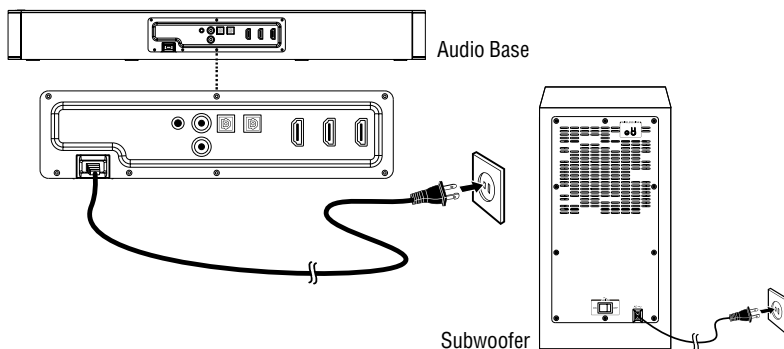

(Sample Illustration) Connecting the AC power cord

---

## Subwoofer wireless connection

In order to use the subwoofer, you must pair it with the Audio Base.

1. Connect the power cord to a wall outlet.
2. Turn on the Audio Base.
3. Turn the **ON/OFF** switch on the back of subwoofer to the “on” position.
4. The Audio Base and the subwoofer will automatically pair up. The pairing indicator located in upper right corner of the rear panel will appear red when the wireless link is activated.

- 
- NOTE**
- ❖ When the wireless link is deactivated, the Audio Base will show “NO SUBWOOFER” on the front panel display. You can press and hold the ►► button on the remote control for 8 seconds in HDMI®-2 mode. And then, press and hold the **WIRELESS LINK** button of the subwoofer for approximately 5 seconds until the red indicator flashes.
  - ❖ The Audio Base will show “PAIRED” when the Audio Base and the subwoofer link are active.
- 

## Bluetooth® connection by NFC

NFC (Near Field Communication) is a technology enabling short-range wireless communication between various devices, such as mobile phones and IC tags.

By just touching the Audio Base where the “N-mark” is located with an NFC compatible device, the Audio Base is turned on automatically and then paired and connected with the various devices, such as mobile phones. To locate the “N-mark” on the unit, please see “NFC (N-Mark)” on page 7.

1. Start and turn on the NFC function on the device. Keep touching the device on the “N-Mark” of the Audio Base until the device vibrates or a message pops up; the Bluetooth® will be paired automatically.
2. Touch the device to the Audio Base again to disconnect. In order to avoid unintentional disconnection, it is advised that you place your device away from the “N-mark” once connected.

- 
- NOTE**
- ❖ The NFC function is built into devices for Android™ 4.1 Jellybean or later.
  - ❖ If your device is powered by a previous version than Android™ 4.1 Jellybean, you must download the relevant application from the Google Play™ store to use the NFC function.
  - ❖ The position of the NFC antenna differs on devices. Check the NFC antenna location before connecting. If your device is covered with a thick case, the connection may not succeed.
  - ❖ For details, please refer to the user’s manual of your NFC device.
-



---

## Playback via Bluetooth® enabled devices

1. Press the **INPUT** button on the remote control or using the Audio Base controls to select the Bluetooth® mode. The display shows “BT” when in the Bluetooth® mode.  
Your pairing device must have the Bluetooth® feature turned on.
2. Once the Audio Base is detected by your Bluetooth® enabled device, select the “ABX3250” on your device.
3. Enter the PIN code if necessary.  
**PIN code : 0000**
4. When this unit is successfully paired with your Bluetooth® device, it will display “CONNECTED”.
5. Select the desired music and press the **PLAY/PAUSE** button on your device.
6. If the connection fails, ‘PAIRING’ will still be displayed.

## Disconnect Bluetooth® enabled device

1. Press the **INPUT** button to select Bluetooth® mode until the display on the Audio Base shows “BT”.
  2. Select disconnect or unpair menu on paired Bluetooth® enabled device.
- The Audio Base is now able to pair with another Bluetooth® enabled device.

## Pairing Audio Base with a Bluetooth® enabled devices manually

If you intend to connect another Bluetooth® enabled device, manual pairing is necessary.

1. Press the **INPUT** button to select Bluetooth® mode until the display on the Audio Base shows “BT”.
2. Press the **PAIRING** button on the Audio Base. This will disconnect the current Bluetooth® enabled device and then search for the other Bluetooth® enabled device.

---

### NOTE

- ❖ The Audio Base must disconnect or unpair from a previous paired device in order to properly pair with another Bluetooth® enabled device.
  - ❖ The Audio Base can only be connected to one Bluetooth® enabled device at a time.
  - ❖ Press the **PAIRING** button on the Audio Base to switch to Bluetooth® mode directly.
  - ❖ For details, please refer to the user’s manual of your Bluetooth® device.
-

## Troubleshooting

Problem:	Solution:
The unit does not switch on.	<p>Make sure it is plugged into a AC power outlet and the outlet is turned ON.</p> <p>Press the <b>STANDBY</b> button located on the top of the Audio Base, and check to see if the STANDBY indicator turns off.</p> <p>Turn the subwoofer power switch to <b>ON</b>.</p>
No sound from the Audio Base	<p>Press the <b>VOL</b> ^ button of the Audio Base.</p> <p>Ensure the source you have selected is outputting audio. If you are using "audio out" from your TV, please ensure your TV is configured to output audio (see TV's menu settings).</p> <p>Ensure your audio connections are properly made (check that you don't have any loose connections).</p> <p>Ensure you have selected the correct source (input) - the display of the Audio Base will show the currently-selected source (input).</p> <p>Press the <b>MUTE</b> button on the remote control to ensure the Audio Base is not muted.</p>
No sound from the subwoofer	<p>Move the subwoofer closer to the Audio Base.</p> <p>Ensure the subwoofer is turned on. Turn the subwoofer power switch to <b>ON</b>.</p> <p>Press the <b>WIRELESS LINK</b> button on the back of the subwoofer to re-link the subwoofer with the Audio Base.</p>
The sound of Bluetooth® device is interrupted.	<p>The device is out of the 33ft (10m) communication range. Bring the Bluetooth® device closer to the main unit.</p> <p>Remove any obstacles between the main unit and the device.</p> <p>Other devices that use the 2.4GHz frequency band, like a wireless router, microwave, cordless phone, etc. may interfere.</p> <p>Bring the Bluetooth® device closer to the main unit and distance it from the other devices.</p>
Remote control does not work properly	<p>Check the following:</p> <p>The batteries are inserted correctly.</p> <p>The batteries are new.</p> <p>The remote control is pointed directly at the remote sensor of the unit.</p> <p>The remote control is not being used from too far a distance from the unit.</p> <p>Nothing is obstructing remote sensor (located on front of the unit).</p>
Connection (NFC) is not available	<p>Keep the device close to the system until the device vibrates.</p> <p>Check the NFC function of the device is set to on.</p>

## Specifications

- NOTE**
- ❖ These models comply with the specifications listed below.
  - ❖ Designs and specifications are subject to change without notice.
  - ❖ These models may not be compatible with features and/or specifications that may be added in the future.

### Audio Base:

Power requirements	AC 120V ~ 60Hz
Power output	75 watts (per channel at 4 ohms, 1 kHz/THD10%)
Power consumption	27W
Impedance	4 Ω
Dimensions (width x height x depth)	25.1" x 3" x 11.9" (638 x 75 x 302mm)
Weight	11.7 lbs (5.3kg)

### Subwoofer:

Power requirements	AC 120V ~ 60Hz
Power output	150 watts (at 3 ohms, 100Hz/THD10%)
Power consumption	34W
Impedance	3 Ω
Dimensions (width x height x depth)	7.5" x 13.9" x 12.7" (193 x 355 x 321mm)
Weight	13.7 lbs (6.2 kg)

## Maintenance

### Servicing

Please refer to relevant topics in “Troubleshooting” on page 18 before returning the product. If this unit becomes inoperative, do not try to correct the problem by yourself. There are no user-servicable parts inside. Turn off, unplug the power plug, and please call our helpline to locate an Authorized Service Center.

### **CAUTION** Cleaning the cabinet

Never use a solvent, thinner, benzene or alcohol to clean the unit. Do not spray insecticide liquid near the unit. Such chemicals may discolor the surface or damage the unit.

**TOSHIBA**  
**Leading Innovation >>>**