

# **DIY Pixel Display Kit**



## **User Manual**

**Full color pixel display/Custom graffiti**

# 1. Safety Tips

- ① Please tear off the protecti film before using.
- ② Please place the equipment on a stable and safe level surface to avoid falling and causing damage or injury.
- ③ Do not insert any foreign objects into the device socket.
- ④ Do not knock or strike the device with force.
- ⑤ Keep away from heat sources and avoid electrical appliances such as open flames, microwave ovens, and electric heaters that can generate high heat.  
To ensure safety, only use the supplied accessories when using the product.
- ⑥ The signal cable is only for use with this product and should not be used on other devices, as it may cause damage to the equipment.

## 2. Product Information

Product Name: DIY Pixel Display Kit

Pixel Dot: 16\*16/8\*32

LED Qty: 256pcs

Power Supply: DC 24V

Product Power: 36W

Voltage/Current: 24V/1.5A

Product Size: 15.7\*15.7\*0.9/7.8\*31.4\*0.9inches

Package Size: 17.9\*17.9\*17.7inches

### 3. Product Accessories

- ① Pixel Screen    ② User Manual    ③ Signal Short Line    ④ Signal Long Line  
⑤ Screwdriver    ⑥ Screw Set    ⑦ Angle Bracket  
⑧ Cross Bracket    ⑨ Hanger Screw Set    ⑩ Power Adapter

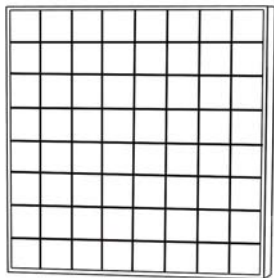

① 4pcs



② 1pcs



③ 3pcs



④ 1pcs



⑤ 1pcs



⑥ 12pcs



⑨ 1pcs



⑦ 4pcs



⑧ 1pcs



⑩ 1pcs

## 4. Installation Method/Identify Main and Secondary Screens

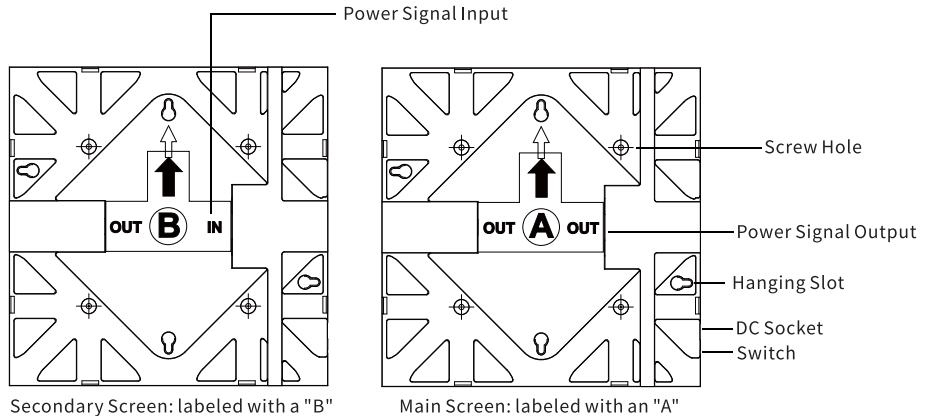

## 5. Installation Diagram for 16X16

- 1.Remove accessories from packaging.
- 2.According to the diagram, label "A" is the only main screen, and label "B" is the secondary screen.  
Align the label arrows on the main and secondary screens to face upwards. Place the secondary screen "B" to the left and above the main screen "A" in sequential order.
- 3.Connecting signal lines.
- 4.First, install the bracket securely, and then tighten it with screws.
- 5.Plug the power supply into the DC port on the right side of the main screen A and power it on.

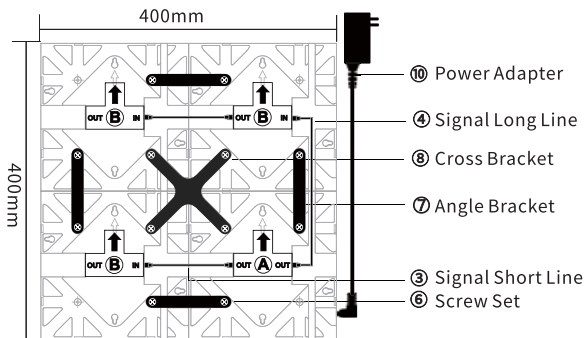

## 6. List of Accessories Required for Installing the 16X16

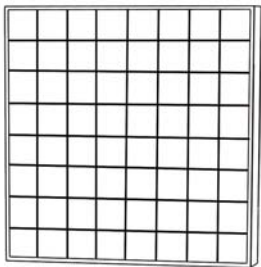

Pixel Screen 4pcs



Signal Short Line 2pcs



Signal Long Line 1pcs



Screw Set 12pcs



Angle Bracket 4pcs



Hanger Screw Set 1pcs



Cross Bracket 1pcs



Power Adapter 1pcs

## 7. Installation Diagram for 8X32

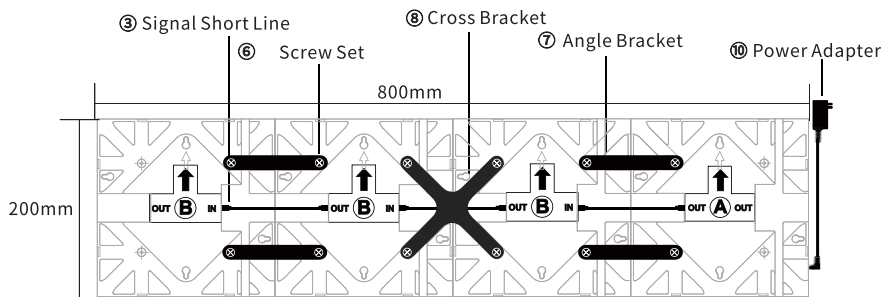

- 1.Remove accessories from packaging.
- 2.According to the diagram, label "A" is the only main screen, and label "B" is the secondary screen.  
Align the label arrows on the main and secondary screens to face upwards. Place the secondary screen "B" to the left and above the main screen "A" in sequential order.
- 3.Connecting signal lines.
- 4.First, install the bracket securely, and then tighten it with screws.
- 5.Plug the power supply into the DC port on the right side of the main screen A and power it on.



## 8. List of Accessories Required for Installing the 8X32

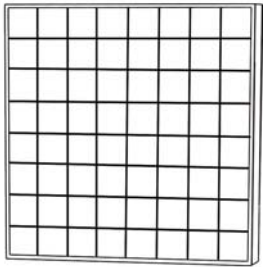

Pixel Screen 4pcs



Signal Short Line 3pcs



Angle Bracket 4pcs



Hanger Screw Set 1pcs



Screw Set 12pcs



Cross Bracket 1pcs



Power Adapter 1pcs

## 9.Download the 'iDotMatrix' APP

1.Scan the QR code below or go to Google Play/App Store and search for 'iDotMatrix' to download the app.



2.Turn on Bluetooth



## 10. Connect to Device

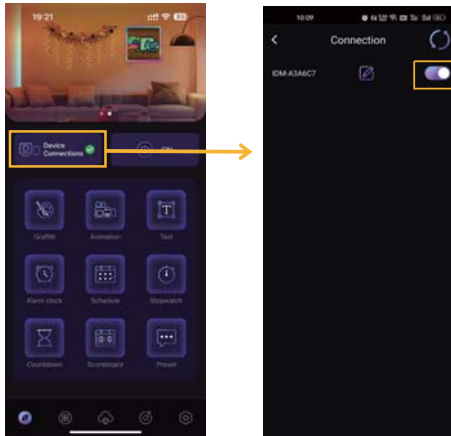

Notes:

1. When first time open the app, the pop-up option of whether to allow permissions, please select 'allow'.
2. Turn on Bluetooth and connect the device.
3. If Android phone can't retrieve the Bluetooth, please check to open the location

## 11.Creative Graffiti

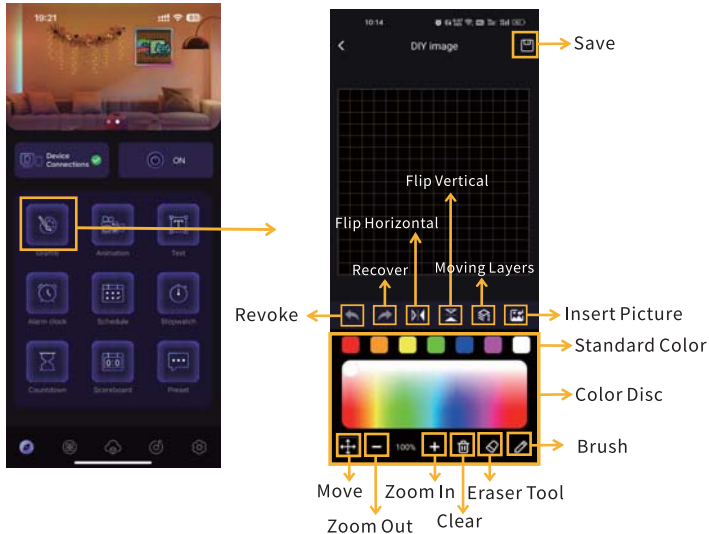

## 12.Creative Animation

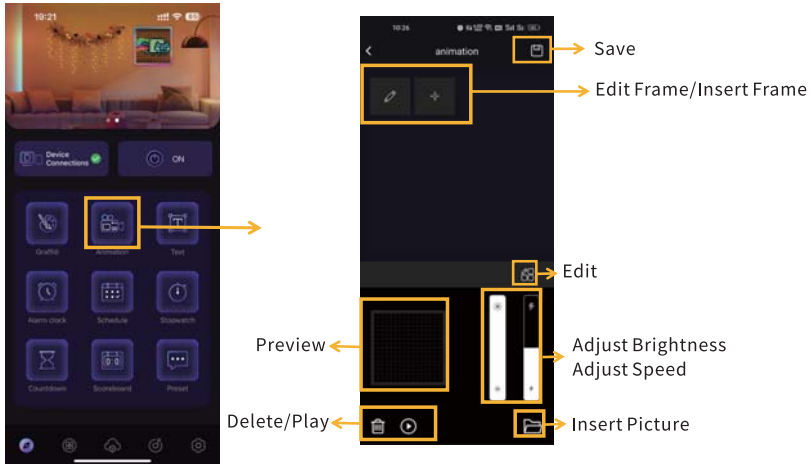

## 13.Text Editing

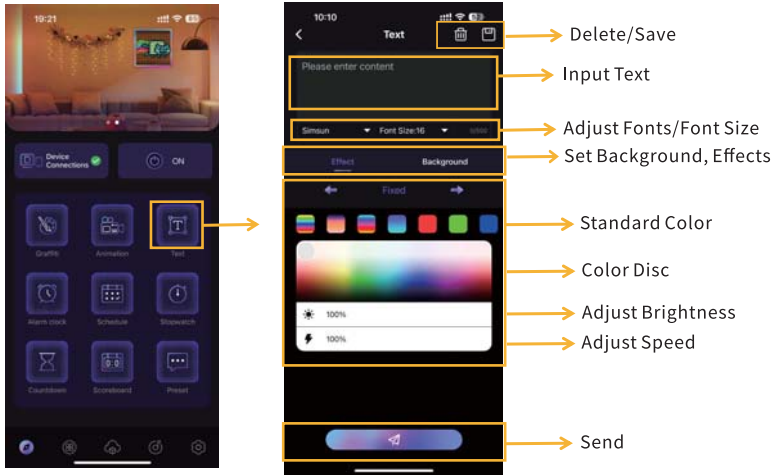

## 14.Alarm Clock

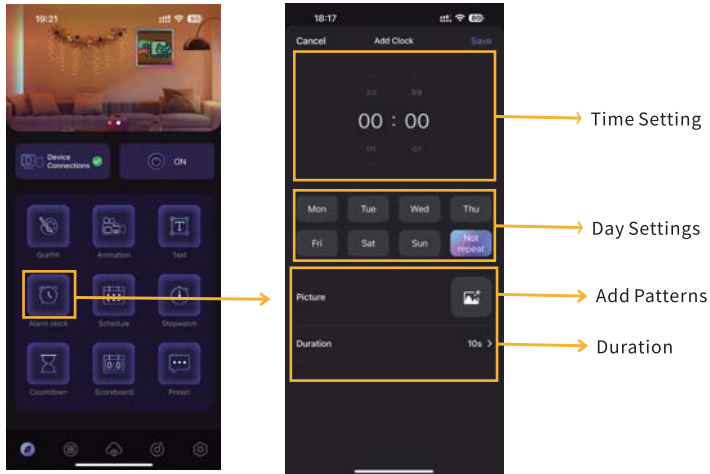

## 15.Schedual

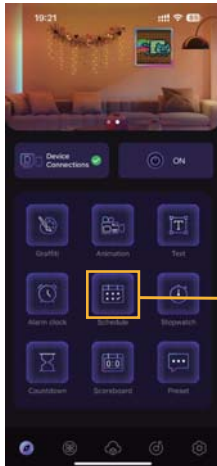

Initial Schedule ←

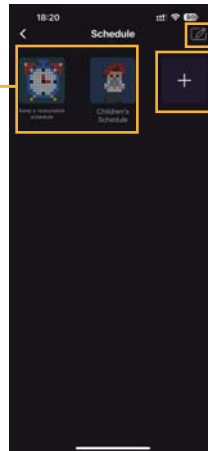

Choice/Delete

Add Schedule



## 16.Stopwatch

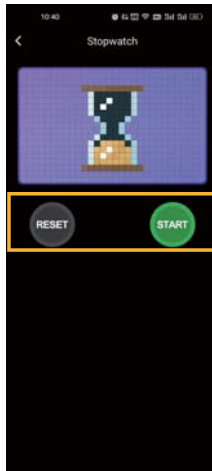
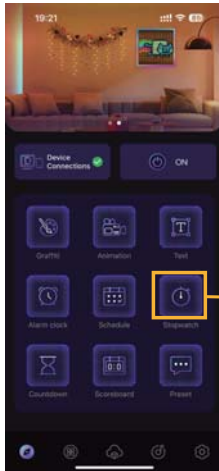

Reset/Start/End

## 17.Countdown

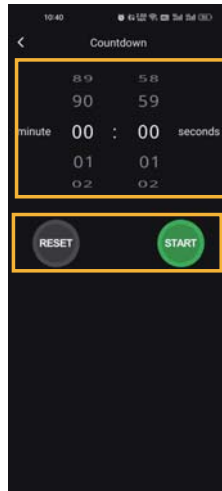
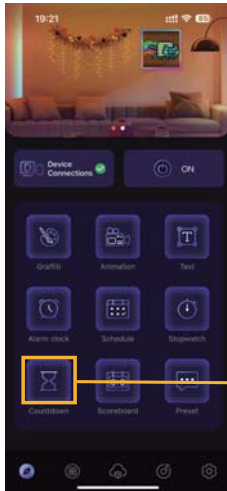

Duration Setting

Reset/Start/End

## 18.Scoreboard

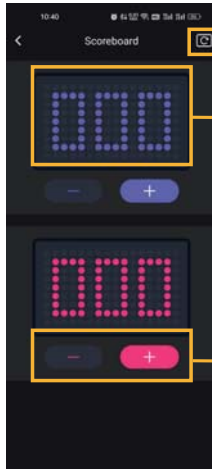
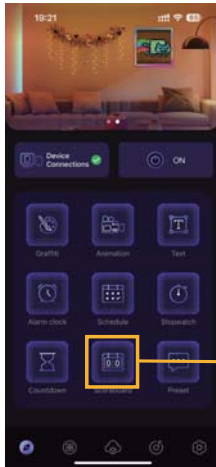

Reset

Preview Display

Plus/Minus Score

## 19.Preset Phrase

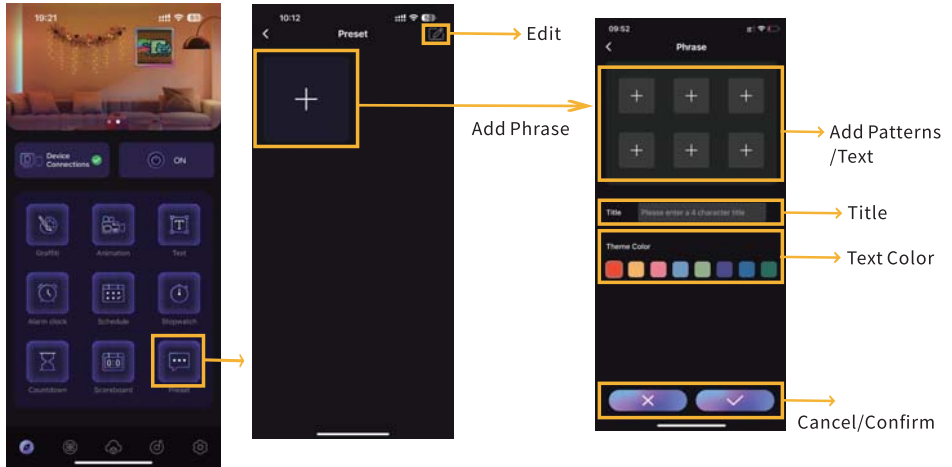

## 20.Mode-Digital Clocks

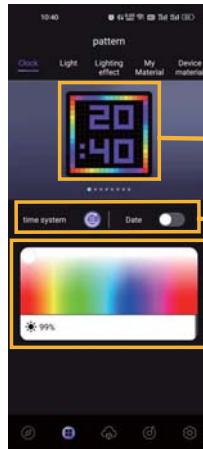
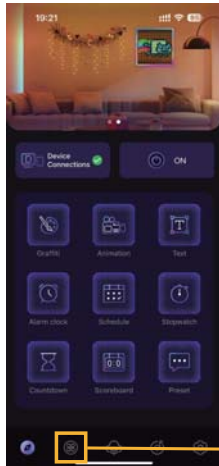

Effect Preview

12/24 Hour System/Date Adjustment

Color Disc

Brightness Adjustment

## 21.Mode-Lighting

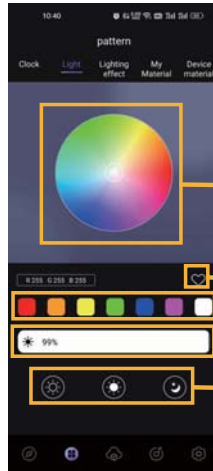
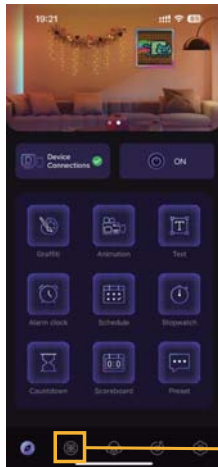

Color Disc

Add My Material

Standard Color

Brightness Adjustment

Warm Light/Nature White/Warm White

## 22.Mode-Dynamic Lighting

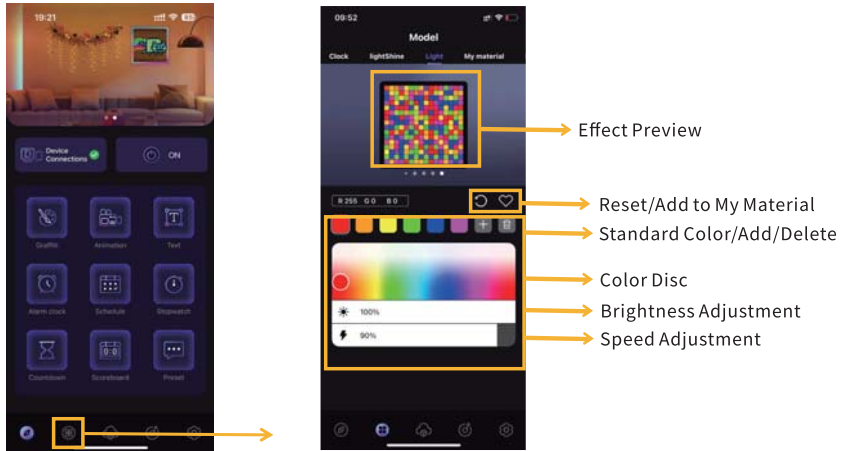

## 23.Mode-My Material

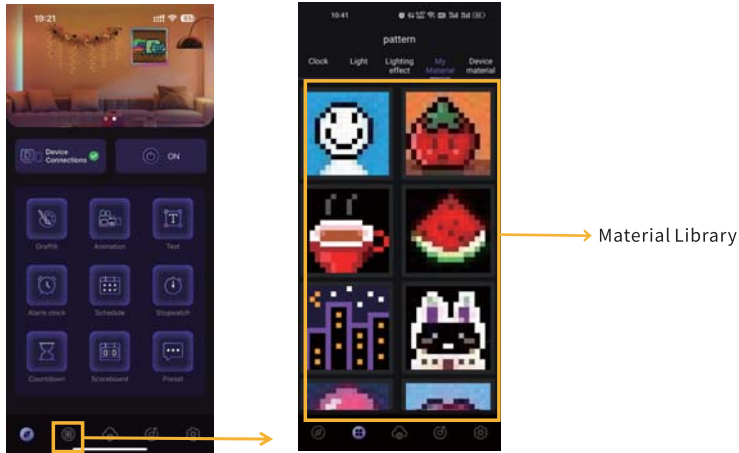



## 24.Mode-Equipment Materials

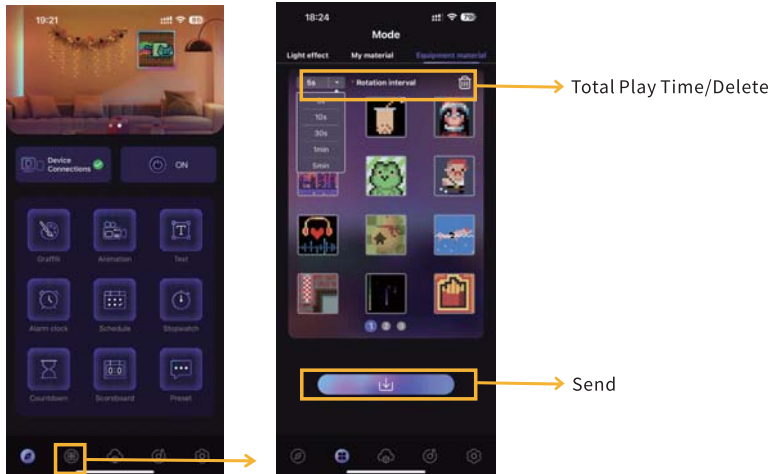

## 25.Cloud Material

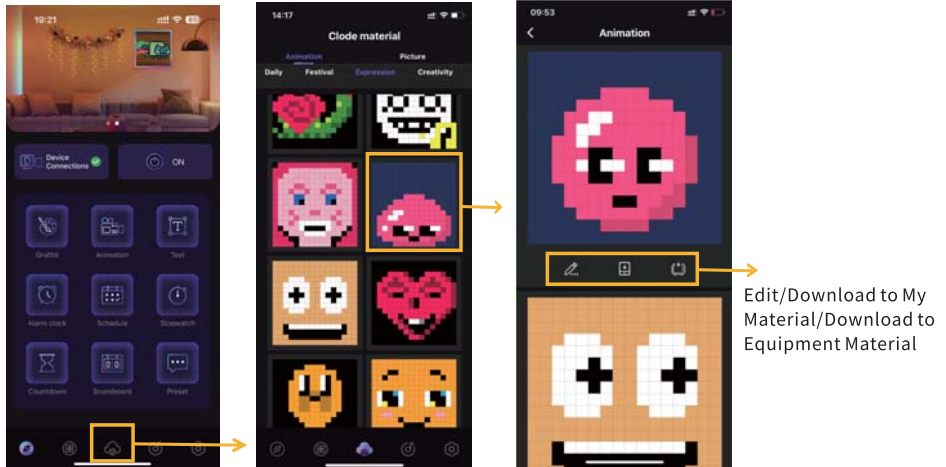

## 26.Rhythm

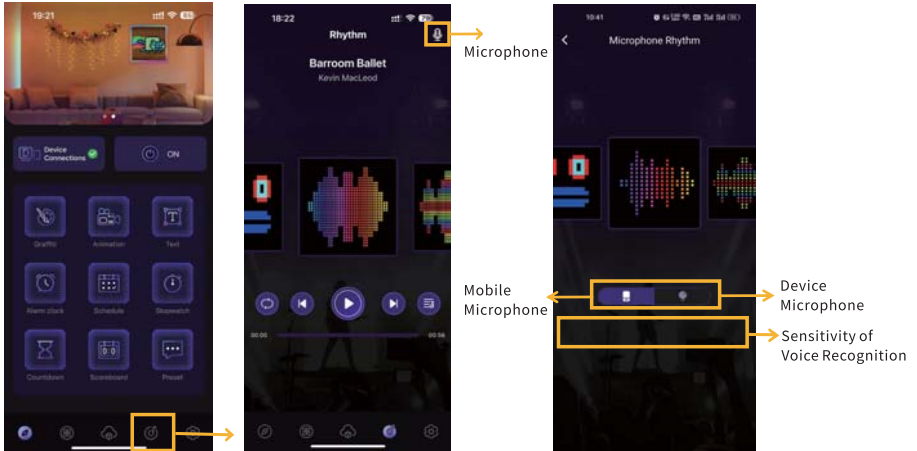

## 27.Settings

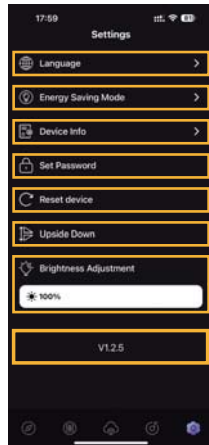
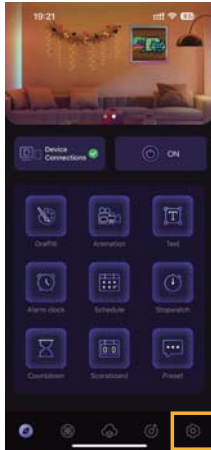

Language

Energy Saving Mode

Device Information

Set Password

Reset the Device

Upside Down

Brightness Adjustment

App Version

**Warning:**

This device complies with Part 15 of the FCC Rules. Operation is subject to the following two conditions: (1) this device may not cause harmful interference, and (2) this device must accept any interference received including interference that may cause undesired operation.

Changes or modifications not expressly approved by the party responsible for compliance could void the user's authority to operate the equipment.

NOTE: This equipment has been tested and found to comply with the limits for a Class B digital device, pursuant to Part 15 of the FCC Rules. These limits are designed to provide reasonable protection against harmful interference in a residential installation. This equipment generates uses and can radiate radio frequency energy and, if not installed and used in accordance with the instructions, may cause harmful interference to radio communications. However, there is no guarantee that interference will not occur in a particular installation. If this equipment does cause harmful interference to radio or television reception, which can be determined by turning the equipment off and on, the user is encouraged to try to correct the interference by one or more of the following measures:

- Reorient or relocate the receiving antenna.
- Increase the separation between the equipment and receiver.
- Connect the equipment into an outlet on a circuit different from that to which the receiver is connected.
- Consult the dealer or an experienced radio/TV technician for help.

NOTE: This device and its antenna(s) must not be co-located or operation in conjunction with any other antenna or transmitter

---

#### RF Exposure Statement

To maintain compliance with FCC' s RF Exposure guidelines, This equipment should be installed and operated with minimum distance of 20cm the radiator your body. This device and its antenna(s) must not be co-located or operation in conjunction with any other antenna or transmitter



**RoHS**



Made in China