

190.00 mm



HI-3 USER MANUAL

Thank you for choosing mini PC. For your convenience in using the product, please read this User manual, and keep the User manual after use for future use.

### 1、Products and accessories:



1.MINI PCx1

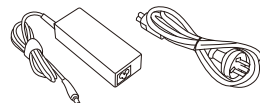

2.Power adapter x1

 Failure to use the included power adapter may violate regulatory compliance requirements and may expose the user to safety hazards.  
\*Specifications are subject to the physical product.

### 2、Basic Operation

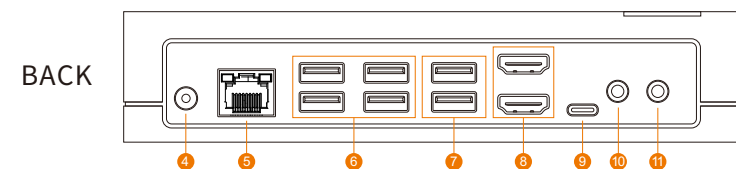
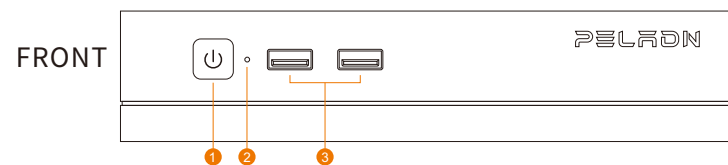

### 3、Quick Installation

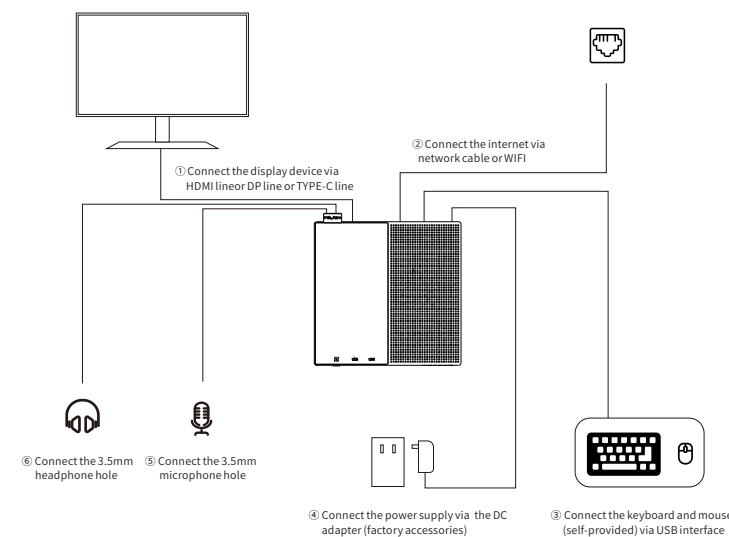

### 4、Wall-Mounted bracket installation instructions

The accessory also comes with a Wall-Mounted bracket to hang the mini-console from a wall-mounted display on the back;  
Remove the bracket first, then screw the mini to the bracket, and screw the host and bracket to the back of the monitor.

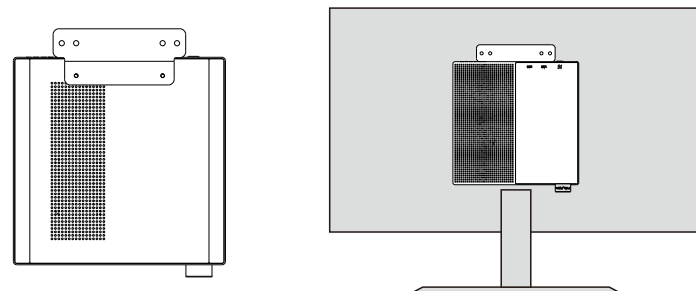

### 5、DIY installation instructions

If you want to upgrade the mini host by DIY, please refer to the following installation guide for installation. This mini host can be easily upgraded by DIY using the quick disassembly method.

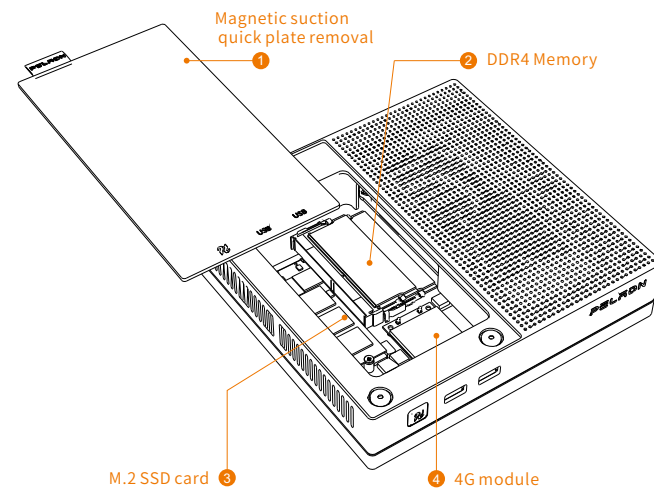

### ①.DDR4 Memory Installation

Please follow belowing steps after turn off and cool down the device:  
1. After disconnecting the power cord, align the memory strip to the card slot, insert it into the slot at an inclined Angle, press the two ends downward, there is a clack if success

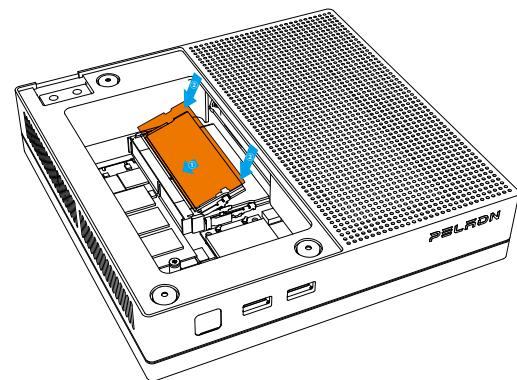

### ②.SSD M.2 Card Installation (Only the M.2 interface is supported)

1.After disconnecting the power cord, align the SSD card with the card slot and tilt it into the slot. (As shown in Arrow ①)  
2.Lay the other end of the SSD card flat and lock the screw. (As shown in Arrow ②)

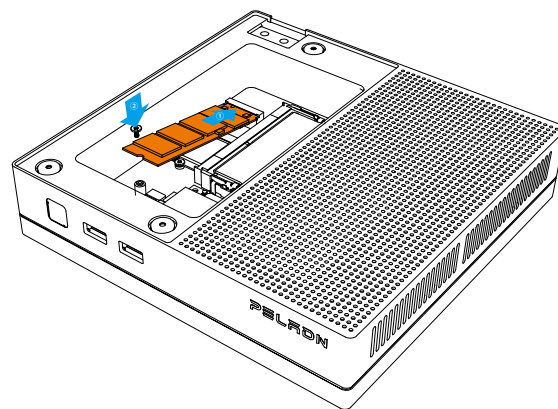

### ③ 5G module installation

Before installation, ensure that the device is powered off and cooled down before performing the following operations.  
The 5G module is used as an example.  
Determine the front and back sides of the hard disk through the anti-stick port, align the 5G module with the card slot, insert it diagonally into the card slot, lay it flat, and tighten the screws.

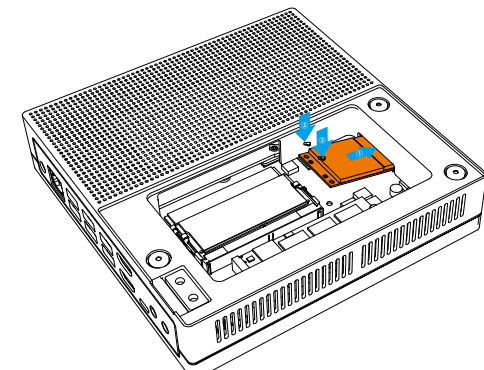

### ④.SIM card installation

Before installation, please make sure to shut down and cool down, and then follow the following steps.  
then use a screwdriver to remove the bottom six screws and open the bottom Cover, see the SIM card slot, push the slot in the direction of the arrow, then open the card banknote and put the SIM card into the card inside, and lock the clamping slot. Finally, fix the bottom screw.

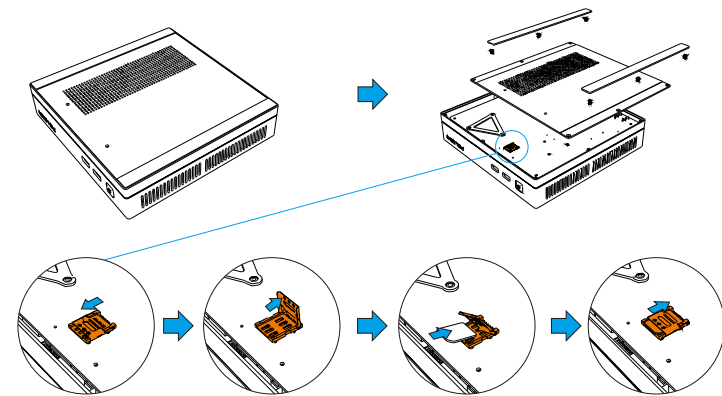

### FCC Requirement

Any changes or modifications not expressly approved by the party responsible for compliance could void the user's authority to operate the equipment. This device complies with Part 15 of the FCC Rules. Operation is subject to the following two conditions:  
(1) this device may not cause harmful interference, and  
(2) this device must accept any interference received, including interference that may cause undesired operation.

Note: This equipment has been tested and found to comply with the limits for a Class B digital device, pursuant to Part 15 of the FCC Rules. These limits are designed to provide reasonable protection against harmful interference in a residential installation. This equipment generates, uses, and can radiate radio frequency energy, and if not installed and used in accordance with the instructions, may cause harmful interference to radio communications. However, there is no guarantee that interference will not occur in a particular installation. If this equipment does cause harmful interference to radio or television reception, which can be determined by turning the equipment off and on, the user is encouraged to try to correct the interference by one or more of the following measures:  
- Reorient or relocate the receiving antenna.  
- Increase the separation between the equipment and receiver.  
- Connect the equipment into an outlet on a circuit different from that to which the receiver is connected.  
- Consult the dealer or an experienced radio/TV technician for help.  
This equipment complies with FCC radiation exposure limits set forth for an uncontrolled environment. This equipment should be installed and operated with a minimum distance of 20cm between the radiator & your body. This transmitter must not be co-located or operating in conjunction with any other antenna or transmitter.  
CAUTION: Any changes or modifications not expressly approved could void the user's authority to operate the equipment."

## Warranty Card

Product NO. \_\_\_\_\_

Product Order NO. \_\_\_\_\_

Maintenance Records \_\_\_\_\_

Warranty Time \_\_\_\_\_

Name \_\_\_\_\_ Phone/E-mail \_\_\_\_\_

Return Address \_\_\_\_\_

Producer: Shenzhen Panmin Technology Co.,Ltd  
Origin: Shenzhen, China  
Address: 501 Building A, Weihuada Industrial Park, No.5, Lirong Road, Dalang Street, Longhua District, Shenzhen, Guangdong, China  
Tel:400-998-3678  
Web: www.peladn.com  
E-mail: support@peladn.com