

## ▶ SIMPLE TROUBLESHOOTING

Try the troubleshooting steps below if you are having problems while using your speaker.  
If problems still exist, please look for a qualified technician or contact our company.  
To prevent electric shock or expand the scope of the malfunction, do not repair by yourself.

Symptom	Possible problem	Solution
No function light & No sound	1.Plug is not well connected	Insert the plug into electrical outlet
	2.Speaker power button is not turned on	Turn on the button
Function light on but no sound	1.Cable misconnected	Turn off the power,check the input jack to ensure proper audio signal is connected to relevant input jack
	2.Speaker are not connected or misconnected	Power off ,then check and confirm the cable connection again
	3.Audio signal is not transmitted to speaker	Check all the speaker if there is audio signal output
Remote control does not work	1.Before you press any function button,first select the correct source with the remote control instead of the main unit	
	2.Reduce the distance between the remote control and the unit	
	3.Insert the battery with its polarities(+/-signs) aligned as indicated	
	4.Replace the battery	
	5.Aim the remote control directly at the sensor on the front of the unit	
If the problem exists after checking related procedures above , please refer to the appointed service agent or professional technician to fix it.Do not attempt to open the cover, otherwise we assumes no responsibility.		

## ▶ SPECIFICATION

### AMP

Power output-----2000 W (P.M.P.O)  
Impedance-----4 ohms  
Frequency response-----45 Hz-20KHz  
S/N Ratio-----93 dB±3 dB

### OTHER ITEM

Electricity supply-----AC110/60Hz,220V/50Hz

### PACKING LIST

Manual-----1book  
Remote control-----1piece  
Signal Mire-----1piece  
Power cord-----1piece

# PYLE®

PyleUSA.com

## USER MANUAL

PSUFM1043BT



We greatly appreciate your purchase of the speaker.  
To be sure you take maximum advantage of all the speaker has to offer, read these instructions carefully and use the set properly. Be sure to keep this manual for future reference, should any questions or problems arise.

## ▶ CAUTION

No users serviceable parts inside. Please return to the agents or a similar qualified service center for repair.

## ▶ SAFETY INSTRUCTION

1. Before using, please read the user manual carefully. Retain for future reference.
2. All warnings on the speaker and in the user manual should be adhered to.
3. Do not use the speaker near water.
4. For Ventilation Purposes:
  - ~Do not block any of the ventilation openings.
  - ~Do not install near any heat sources or fire.
  - ~Do not install in an airtight location.
5. Keep the cord and plugs in good order.
6. The speaker may be wiped down with a damp cloth once the unit has been switched off and the plug removed.
7. Unplug the speaker during lightning storms or when not in use for long periods of time.
8. Keep foreign objects and liquid from entering the unit to avoid a short circuit, fire and electrical accidents.
9. Keep the speaker in a dry location.
10. Refer all servicing to the agent or a similar qualified service center for repair.

## ▶ REMOTE CONTROL

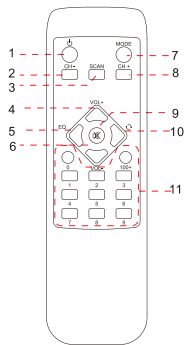

1. Standby
2. MP3 last song/FM last frequency
3. MP3 pause. Play/FM scan frequency
4. Sound volume "+" of main channel
5. EQ mode adjustment
6. Sound volume "-" of main channel
7. AUX/USB/SD/FM/BT input selected
8. MP3 next song
9. Mute
10. Repeat
11. 0~9: through selected song

## ▶ FUNCTION OF BACKBOARD

1. AUX input
2. 110V and 220V voltage switch
3. Electricity supply AC 110V/60Hz, AC 220V/50Hz
4. FM ant
5. LED power ON/OFF
6. Power ON/OFF

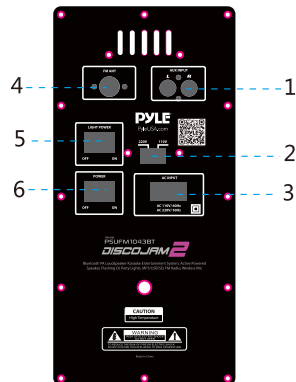

## ▶ CONTROL PANEL

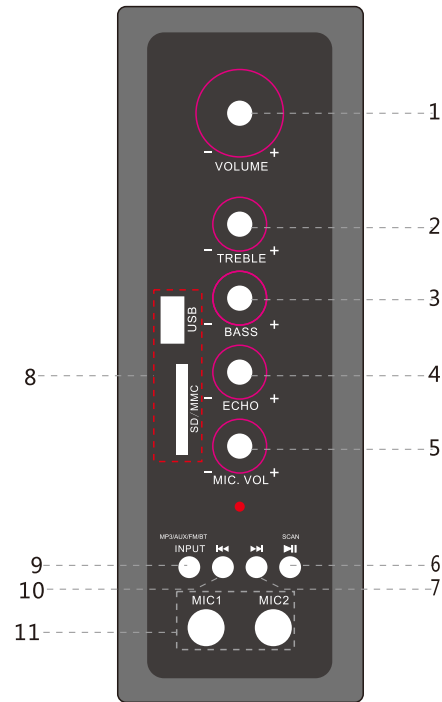

Function of front board:

1. Volume adjustment
2. Treble adjustment
3. Bass adjustment
4. MIC echo adjustment
5. MIC volume adjustment
6. MP3 pause or play
7. MP3 next song/ FM next frequency/ VOL +
8. USB/SD/MMC card connector
9. AUX/ DVD/ MP3/FM /BT input selected
10. MP3 last song/ FM last frequency / Volume -
11. MIC input jack

## ▶ WIRELESS USING

### Wireless microphone using

1. When the noise occurs during use, staccato, or distortion, please replace the battery.
2. After use, please turn off the power switch.
3. When not in use for a long time, please remove the batteries to avoid leakage of battery corrosion of internal parts.
4. When turn on the power switch, such as power indicator does not light to dark, check whether the battery polarity is placed correctly or not.

WIRELESS MICROPHONE

MIC

ON/OFF

BATTERY COVER



## FCC Warning

This device complies with part 15 of the FCC Rules. Operation is subject to the following two conditions: (1) This device may not cause harmful interference, and (2) this device must accept any interference received, including interference that may cause undesired operation.

Any Changes or modifications not expressly approved by the party responsible for compliance could void the user's authority to operate the equipment.

**Note:** This equipment has been tested and found to comply with the limits for a Class B digital device, pursuant to part 15 of the FCC Rules. These limits are designed to provide reasonable protection against harmful interference in a residential installation. This equipment generates uses and can radiate radio frequency energy and, if not installed and used in accordance with the instructions, may cause harmful interference to radio communications. However, there is no guarantee that interference will not occur in a particular installation. If this equipment does cause harmful interference to radio or television reception, which can be determined by turning the equipment off and on, the user is encouraged to try to correct the interference by one or more of the following measures:

- Reorient or relocate the receiving antenna.
- Increase the separation between the equipment and receiver.
- Connect the equipment into an outlet on a circuit different from that to which the receiver is connected.
- Consult the dealer or an experienced radio/TV technician for help.

This equipment complies with FCC radiation exposure limits set forth for an uncontrolled environment. This equipment should be installed and operated with minimum distance 20cm between the radiator & your body.