

Netvue Technologies Co.,Ltd.

**Address:**

A501-502, Academy of Aerospace Technology,  
10th Kejinan Road, Shenzhen Science Park,  
Nanshan District, Shenzhen, P.R.China

**Customer Service :** +1 ( 866 ) 749-0567

**Fax :** +86-755-8660 7322

**Email :** support@netvue.com

**Website :** www.netvue.com

©Netvue Technologies Co., Ltd  
All rights reserved.

Version 1.1

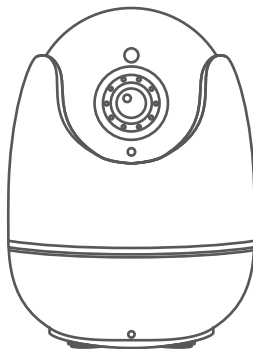

**netvue**  
Orb Cam

# Quick Start Guide

# Quick Start Guide

## Packing List



Orb Cam X1



Quick Start Guide \*1

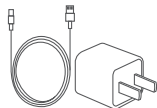

Power Adapter \*1



Screw Accessories \*1



Mounting Bracket \*1



Location \*1

## More About Orb Cam

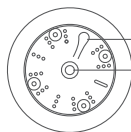

Bottom

- Reset
- Support hole

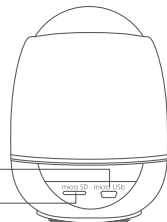

Back

- Power input
- TF card

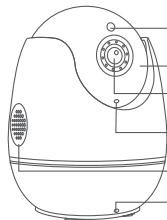

Side

- Light Sensor
- Night Vision Lights
- Lens
- Indicator Light
- Speaker
- Microphone

## Download Netvue App



App Store



Google Play

Scan Qr code to download  
netvue app

## Power On Device

### LED Indicator Status

#### Green

- A. Flash slowly: Connecting server.
- B. Solid green: Connected server
- C. Flash rapidly: WiFi configuration mode

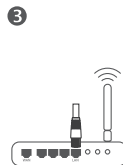
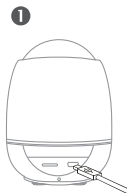

# Add Device

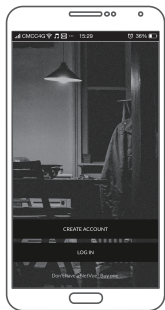

Open the app

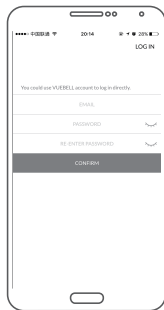

Register account

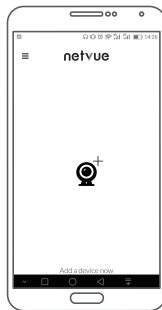

Add device



Choose Netvue Ord Cam

1.Open the APP,register an account and log in.

2.After logging in, click“+”sign, and choose Netvue Orb Cam.

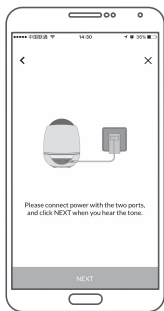

Connect power



Enter password

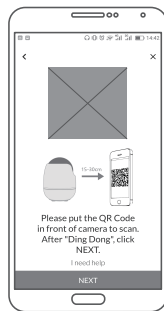

Scan Qr code

### 3.Configure WiFi step by step.

## Notes

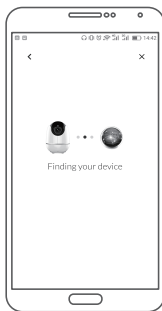

Device added



Device list

4. Device added successfully. Return to app home page, your device should appear in the list of device.

1. Use a valid email address to register your account.
2. Keep the device in a 2.4G WiFi environment with good signal.
3. After connecting to power, the device will make a "Di" sound for 3 seconds. Afterwards press the reset button, the indicator light will then flash rapidly.
4. Strong lights may interfere with the ability for the device to read the QR code.
5. After connecting to the router, the device will make a "ding dong" sound effect. After connecting to the server successfully, it will play a cheerful chime; if it fails, it will play a sad sound effect.
6. If the server fails to connect, you may scan the device ID to connect the device.

# App Features

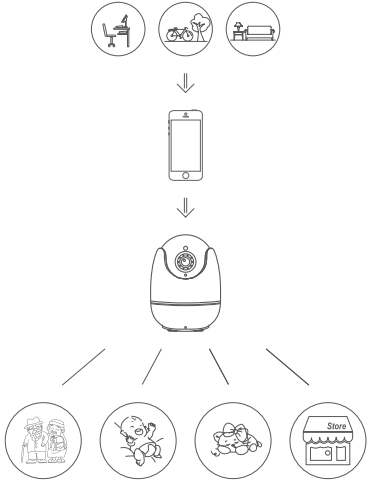

Congratulations ! You have completed installation of your camera, you can watch your home anywhere and anytime.

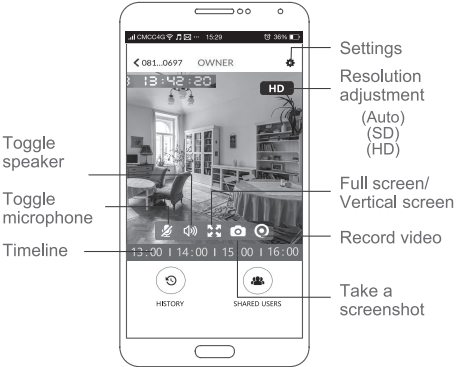



## Caution

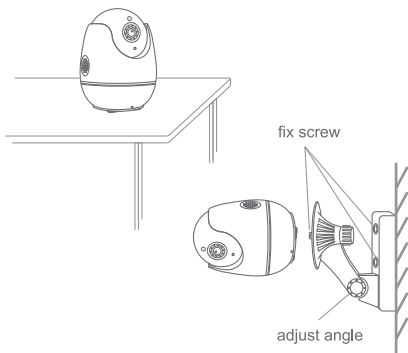

1. The device should be kept in open areas and be away from metal. Avoid placing behind furniture or near microwaves. Keep away from areas with lots of cables if possible. Try to keep your device within range of your Wi-Fi signal.

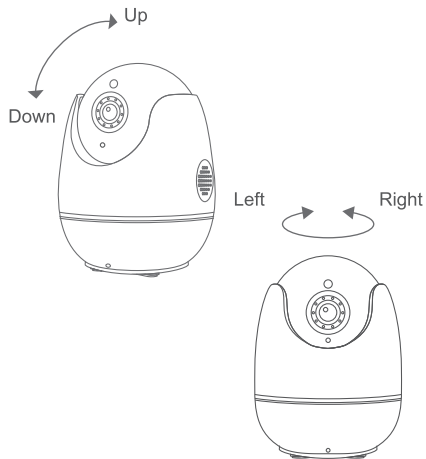

2. If you want to move the device to a new Wi-Fi environment, reconfigure the Wi-Fi settings by following the instruction on the app.

## Warning

This device complies with part 15 of the FCC Rules. Operation is subject to the following two conditions: (1) this device may not cause harmful interference, and (2) this device must accept any interference received, including interference that may cause undesired operation.

Any changes or modifications not expressly approved by the party responsible for compliance could void the user's authority to operate the equipment.

NOTE: This equipment has been tested and found to comply with the limits for a Class B digital device, pursuant to Part 15 of the FCC Rules.

These limits are designed to provide reasonable protection against harmful interference in a residential installation. This equipment generates, uses and can radiate radio frequency energy and, if not installed and used in accordance with the

instructions, may cause harmful interference to radio communications. However, there is no guarantee that interference will not occur in a particular installation.

If this equipment does cause harmful interference to radio or television reception, which can be determined by turning the equipment off and on, the user is encouraged to try to correct the interference by one or more of the following measures:

- Reorient or relocate the receiving antenna.
- Increase the separation between the equipment and receiver.
- Connect the equipment into an outlet on a circuit different from that to which the receiver is connected.
- Consult the dealer or an experienced radio/TV technician for help.

The device has been evaluated to meet general RF exposure requirement. The device can be used in portable exposure condition without restriction.

FCC ID: 2A08RNI-3221

Manufacturer's Name:  
NetVue Technologies Co. Ltd.  
Importer: Cédrus Számítástechnikai Kft. Netvue  
Orb Cam  
Model number: Netvue Orb Cam  
Operating Temperature: -20° C to 50° C

This device was tested for typical body-worn operations. To comply with RF exposure requirements, a minimum separation distance of 20cm must be maintained between the user's body and the handset, including the antenna.

Third-party belt-clips, holsters, and similar accessories used by this device should not contain any metallic components. Body-worn accessories that do not meet these requirements may not comply with RF exposure requirements and should be avoided. Use only the supplied or an approved antenna.

This device in compliance with the essential requirements and other relevant provisions of Directive 2014/53/EU. All essential radio test suites have been carried out.

1. Caution : risk of explosion if battery is replaced by an incorrect type.dispose of used batteries

- according to the instructions.
2. Adapter shall be installed near the equipment and shall be easily accessible.
  3. The plug considered as disconnect device of adapter.
  4. The device complies with RF specifications when the device used at 20cm from your body.



This product can be used across EU member states.

Function	Operation Frequency	Max RF outputpower	Limit
WiFi 802.11B/G/N (HT20,HT40)2.4G.	802.11b/g/n(20MHz): 2412-2472MHz; 802.11n(40MHz): 2422-2462MHz;	13.9dBm.	20dBm.