

# GiONEE S plus User Guide



**Disclaimer:** The colors, specifications, functions and graphics shown/mentioned in the user manual may differ from the actual product. In such a case, the latter shall govern. Images shown are for representation purpose only. Specifications are subject to change without prior notice. GiONEE keeps the right to modify the content in this user guide without prior notice.

# Contents

1. For your safety .....	1
2. Learn about the phone .....	2
● Overview .....	2
● Function Keys .....	2
3. Before using .....	3
● Insert Micro SIM and SD cards .....	3
● Charge the Battery .....	4
4. Getting started.....	4
● Basic Function .....	4
● Home screen.....	4
● Touch screen .....	6
5. Communication .....	7
● Make a call .....	7
● Incoming call .....	8
● Send a Message .....	8
6. Multimedia.....	8
● Camera .....	9
● Gallery .....	11
● Music .....	11
7. Connection.....	12
● Airplane mode .....	12
● Mobile Networks.....	12
● WLAN.....	13
● Bluetooth.....	13
● Hot Knot .....	13
● USB .....	14
8. Advanced Functions.....	14
● Secret shooting .....	14
● Extreme mode .....	17
● Chameleon .....	17
9. Operation .....	18
● Smart gestures .....	18
● Black screen gestures .....	19
● Suspend option .....	20
10. Warnings and notes .....	21
11. FAQ.....	22

# 1. For your safety

Please read this manual before using the cell phone to ensure safe and proper use.



## SWITCH OFF IN HOSPITALS

Please abide by relevant provisions or regulations. Please turn off your mobile phone near medical equipment.



## SWITCH OFF WHEN REFUELING

Don't use the phone at a refueling point. Don't use near fuel or chemicals.



## MICRO SIM CARDS AND SD CARD ARE PORTABLE

Keep your phone, phone parts and accessories out of children's reach.



## BATTERY

Please do not destroy or damage the battery, it can be dangerous and cause fire.

Please do not throw battery in fire to avoid hazard.

When battery cannot be used, please dispose in safe environment.

Do not try to dismantle the battery.

If the battery or the charger is broken or old, please stop using them, and replace with certified genuine battery



## USE QUALITY EQUIPMENT

Use authorized equipment to avoid danger



## ROAD SAFETY COMES FIRST

Give full attention while driving, Park before using your phone. Please follow traffic rules of local city town.



## INTERFERENCE

All wireless devices may be susceptible to cause interference, which could affect performance.



## SWITCH OFF IN AIRCRAFT



Wireless devices can cause interference in aircraft. It's not only dangerous but also illegal to use mobile phone in an aircraft.

## 2. Learn about the phone

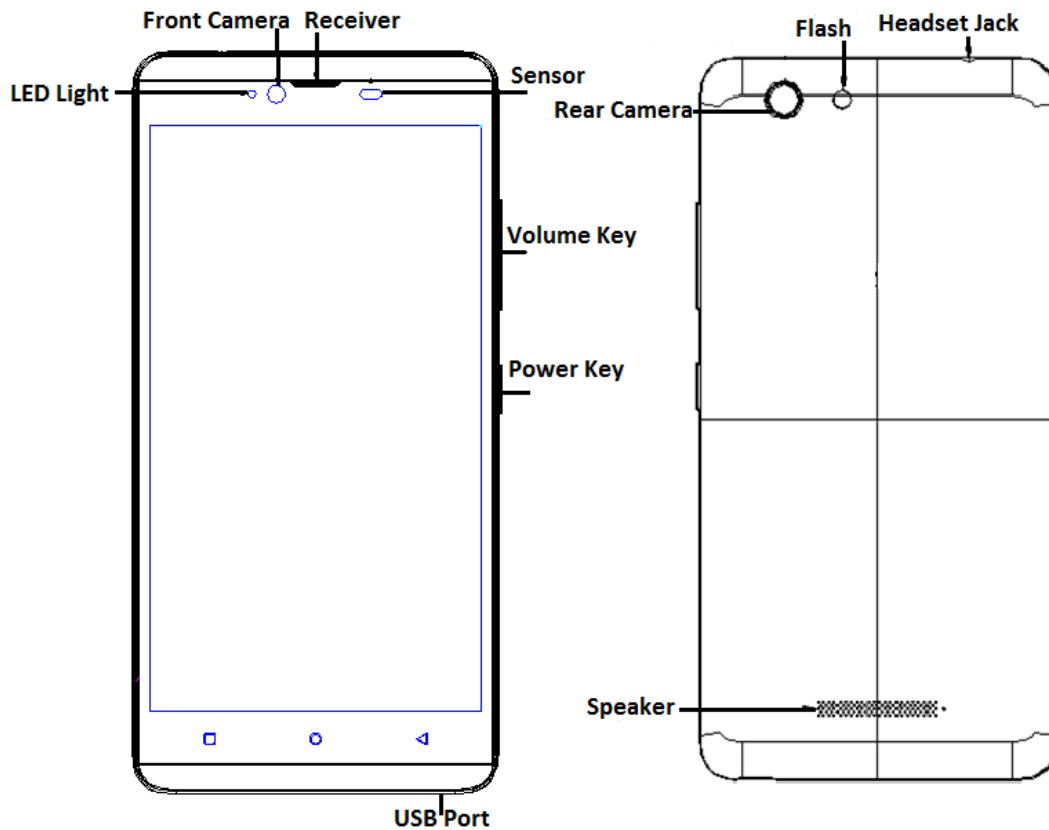
### Overview



### Function Keys

Keys	Icon	Function
<b>Power key</b>		a) Press to Turns on/off the screen. b) Press and Hold to power off the phone or reboot.
<b>Volume key</b>		Press to adjust the volume of device.
<b>Recent task key</b>		Tap to open the list of recent used apps. Shake the phone to clean all of recent used apps.
<b>Home key</b>		Tap to return to Home screen. Long press to access Google™ search.
<b>Back key</b>		Tap to return to the previous screen.

### 3. Before using

The phone is a Dual SIM mobile allowing you to use the facility of two networks.

#### Insert Micro SIM and SD cards

1. Switch off the mobile phone. Then remove the cover as shown in figure.  
Notice: Please start from the bottom left while removing the cover, and flip it up at the bottom.

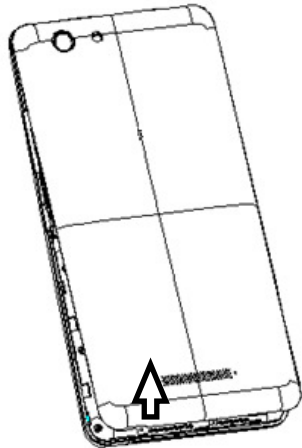

2. Remove the battery and insert the Micro SIM and SD cards to the card slots correctly.

①

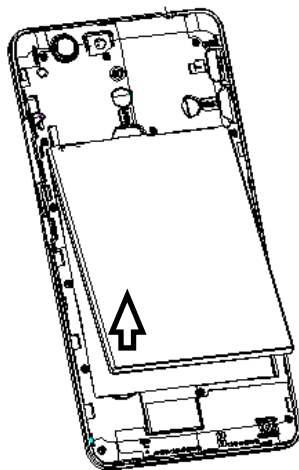

②

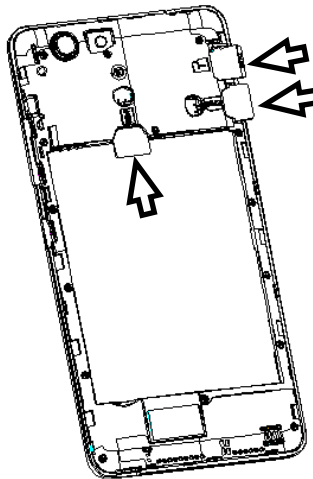

3. Put back the battery and cover.

#### ✓ **Note:**

- Micro SIM and SD cards are not supported to hot plugging.
- Do not remove the Micro SIM and SD cards while the device is transferring data. Doing so may cause data to be lost or damage to the cards and device.
- The Micro SIM card and SD card are small parts. Please keep away from Children to avoid swallowing the card by accident.

- Please do not touch the metal surface of Micro SIM and SD cards away from electromagnetic field to avoid damage data.

#### **Charge the Battery**

Charge the battery before using it. Connect the USB cable to the USB power adaptor, and then plug the end of the USB cable into the USB Port.



## 4. Getting started

#### **Basic Function**

- Turn on the phone  
Press and hold a while of power key to turn on the phone.
- Turn off the phone  
Long press the power key until a menu will show. Choose “Power off” to turn off the phone.
- Restart the phone  
Long press the power key until a menu will show. Choose “Reboot” to restart the phone.
- Lock the screen  
Option 1: Press the power key to turn off the screen and lock it  
Option 2: In the Home screen, double tap the screen to lock it.  
Option 3: The screen will auto lock if you don't use the phone for a while.
- Unlock the screen  
Press the power key, and then slide to top for unlocking.

#### **Home screen**

The Home screen is your starting point to access all the features on your phone. It displays application icons, widgets, and other features. You can customize the Home screen with different wallpaper and display the items you want.

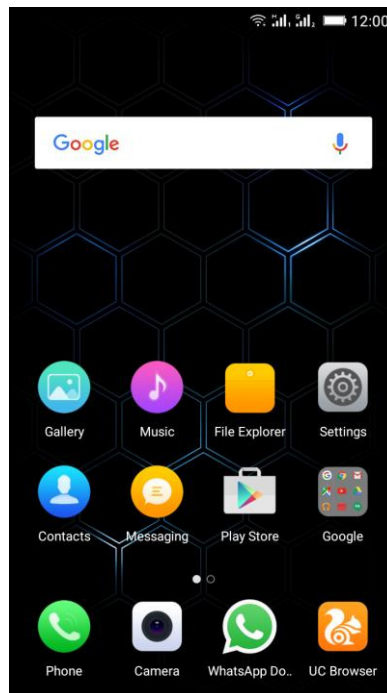

- Status Bar  
At the top of the screen, it displays the time, signal, battery information, and icons for notifications that you've received.
- Notification Center  
Swipe down from the top edge to see more detail of the new notification, such as messaging, missed call, Wi-Fi connection. Tap the notification and drag to left or right to delete it.
- Control Center  
Swipe up from the bottom edge. In the control center, it's quick to access to Torch, Fake call, Calculator, and Camera. You can also adjust the brightness and turn on / off Airplane mode, Wi-Fi, Data connection, Bluetooth, Location, Rotate screen, Vibrate, Sound, Extreme mode, Super screenshot.

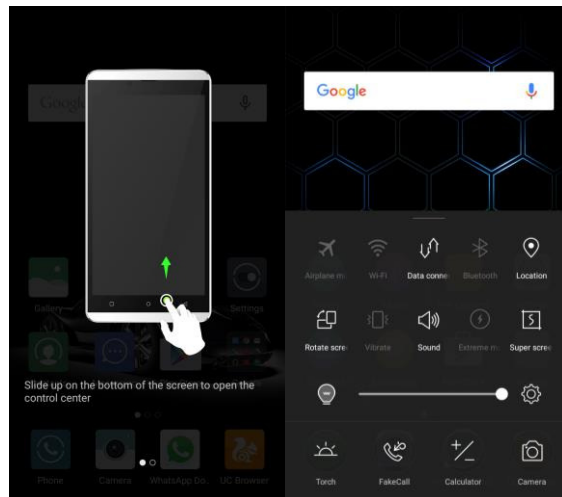

- Desktop Menu  
Slide to top on the touch screen to open the desktop menu. You can change the Launcher Theme & Wallpaper, edit desktop. It's quick to access to Desktop Settings, System Settings and Search.

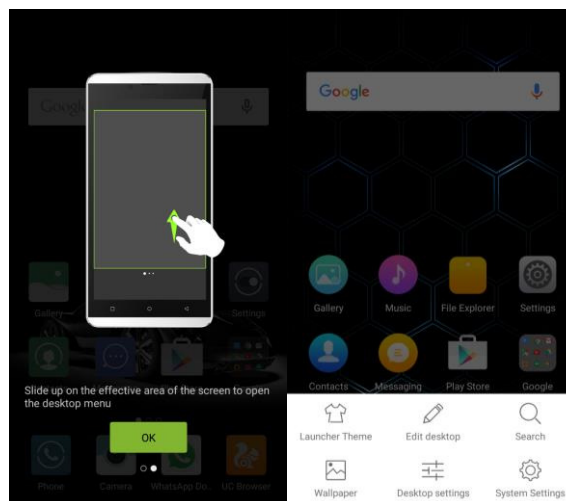

- Move an application  
Touch & hold the icon you want to move. Drag the icon to move or cross at the edge of the screen to move into another screen.
- Uninstall an application  
Touch & hold the icon you want to uninstall. The top / bottom of the icon will appear "Uninstall". Tap it to uninstall.
- Creating a folder  
Drag an icon on the top of another one to create a folder. Open the folder and then touch & hold the folder name to rename it.

#### **Touch screen**

The main way to control Android™ 5.1 features is by using your finger to touch icons,

buttons, menu items, the onscreen keyboard, and other items on the touch screen.

- **Touch:** To act on items on the screen, such as application and settings icons, to type letters and symbols using the onscreen keyboard, or to press onscreen buttons, you simply touch them with your finger.
- **Touch & hold:** Touch & hold an item on the screen by touching it and not lifting your finger until an action occurs.
- **Drag:** Touch & hold an item for a moment and then, without lifting your finger, move your finger on the screen until you reach the target position. You drag items on the Home screen to reposition them and you drag to open the Notification panel.
- **Swipe or slide:** To swipe or slide, you quickly move your finger across the surface of the screen, without pausing when you first touch (so you don't drag an item instead). For example, you slide the screen up or down to scroll a list, and in some Calendar views you swipe quickly across the screen to change the range of time visible.
- **Pinch:** In some applications (Such as Maps and Gallery) you can zoom in and out by placing two fingers on the screen at once and pinching them together (to zoom out) or spreading them apart (to zoom in).
- **Rotate the screen:** On most screens, the orientation of the screen rotates with the phone as you turn it from upright to its side and back again. You can turn this feature on and off.

## 5. Communication

### Make a call

- Touch the phone icon on the Home screen.
- Enter the phone number you want to dial.
- Touch the phone icon to dial the number that you entered.

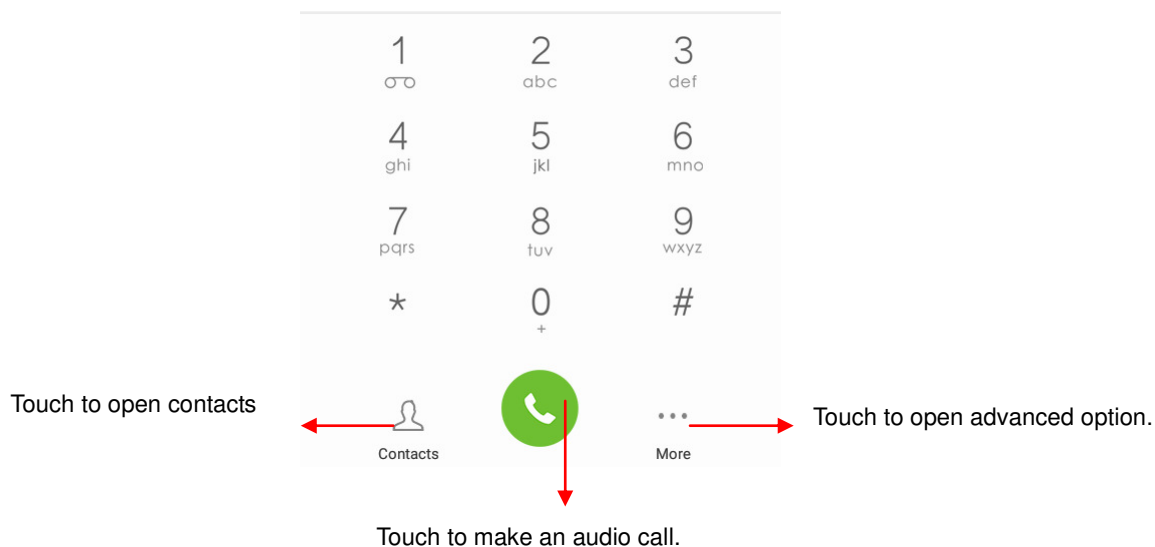

## Incoming call



## Send a Message

You can use this phone to exchange text messages and multimedia messages with your friends on their mobile phones. The messages come to and from the same contact or phone number will be visible into a single conversation, so you can see your entire message history with a person conveniently.

### Enter text

- Tap a text field to see onscreen keyboard.
- Tap the keys on the keyboard to type; the characters you've entered appear in a strip above the keyboard. With suggestions for the word you are typing to the right.
- Use the Delete key to erase characters to the left of the cursor.
- When you're finished typing, Press Back to close the keyboard.

Choose a language and keyboard mode.

Search

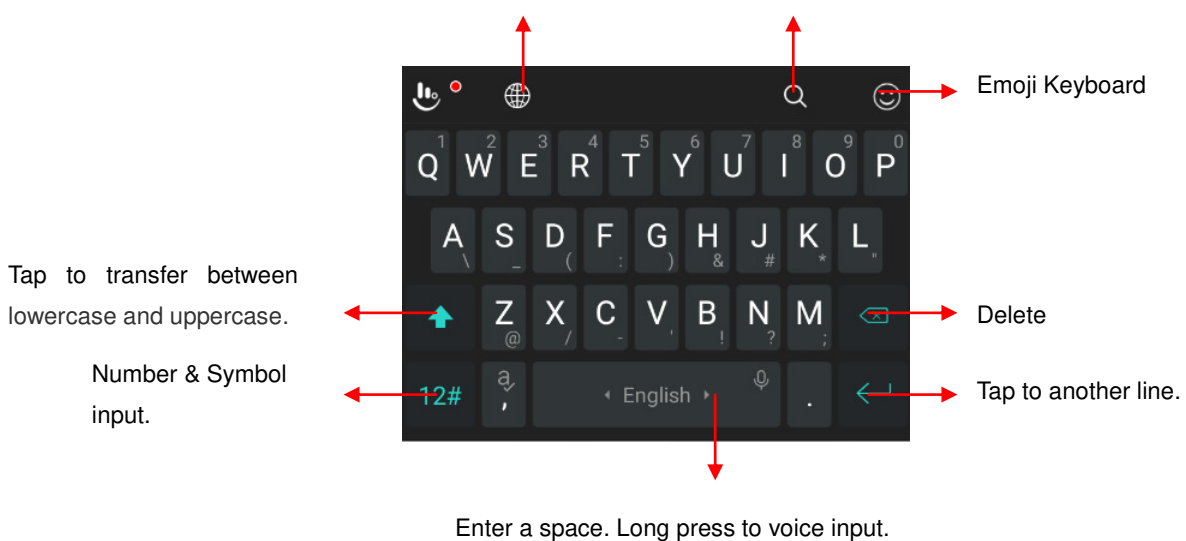

## 6. Multimedia

## 📷 Camera

Camera is a combination of camera and camcorder that you use to shoot and share pictures and videos.

### Take a photo

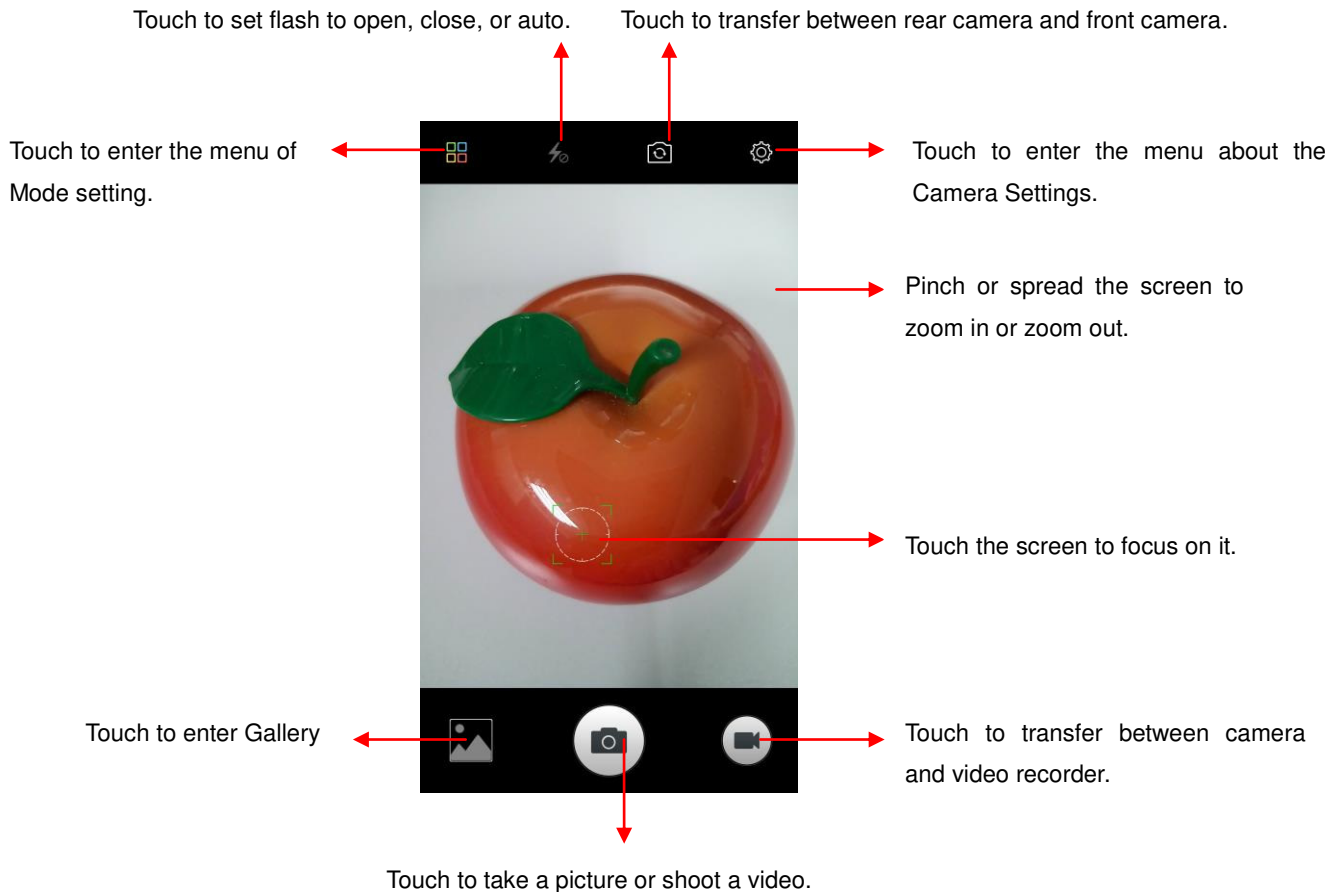

- **Normal** Take a photo.
- **Professional** Change the clarity and focus mode. For Rear camera only.
- **Face Beauty** DIY your face with Smoother, Whitening, Slimming, Enlarger. Drag the slider to adjust it.
- **Take anytime**
  - Best shoot, recommend the best photo.
  - Tracks, record the object movement trail and then merge into a picture.
  - Best face, focus on the best facial expressions while taking a group photo.
  - Motion blur, make the moving object clear as the background is fuzzy.
  - Eraser, remove the moving objects from the photos.
- **Magic Focus** The effect will be better if closed-range and long-range object included.



- **Filter** Multiple filters can choose. Normal, LOMO, Hazy, Halos, Time, Food, Beauty, Sweet, Vintage, B&W.

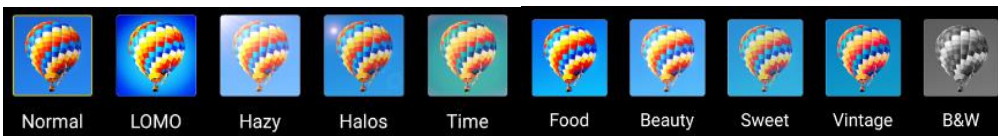

- **HDR** High-Dynamic Range mode will improve the light and the shadow effect at the same time. For Rear camera only.



- **Panorama** Press camera button and move the phone on one direction slowly. For Rear camera only.



- **Night** Through nightscape noise reduction, we see the thing in the photo as it actually is. For Rear camera only.



- **Pic Note** Intelligent crop and optimize the text photo once shooting. For Rear camera only.

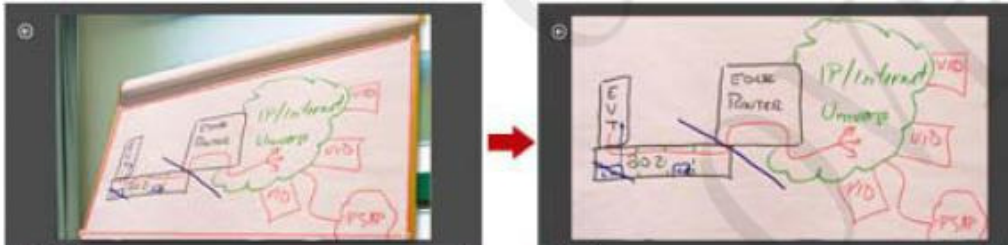

- **Ultra pixel** Take the HD photos in a size of 5 times as larger as the maximum pixel.
- **Smart scene** Change camera mode of night, HDR, fog/flare, auto base on the view.

### Shoot a Video

- Tap video icon to transfer it.
- Adjust the quality and other settings if you wish. Or leave them on automatic mode.
- Point the lens to frame the scene where you want to start.
- Touch the Start Video icon. Camera starts shooting the video.
- Touch Stop video icon to stop shooting. An image from your most recent video is displayed as a thumbnail at the bottom left

### 📁 Gallery

Touch the Gallery icon in the Launcher to view albums of your pictures and videos which you've taken with camera. You may share the pictures and videos with your friends by Messaging, Email, Bluetooth and so on.

For the private photo, you can encrypt it and save on:

**File Explorer --> File --> Phone storage --> Pictures --> More --> Show hidden files --> .Gallery Safe**

### 📁 Music

You use Music player to organize and listen to music and other audio files that you transfer to your phone from your computer.

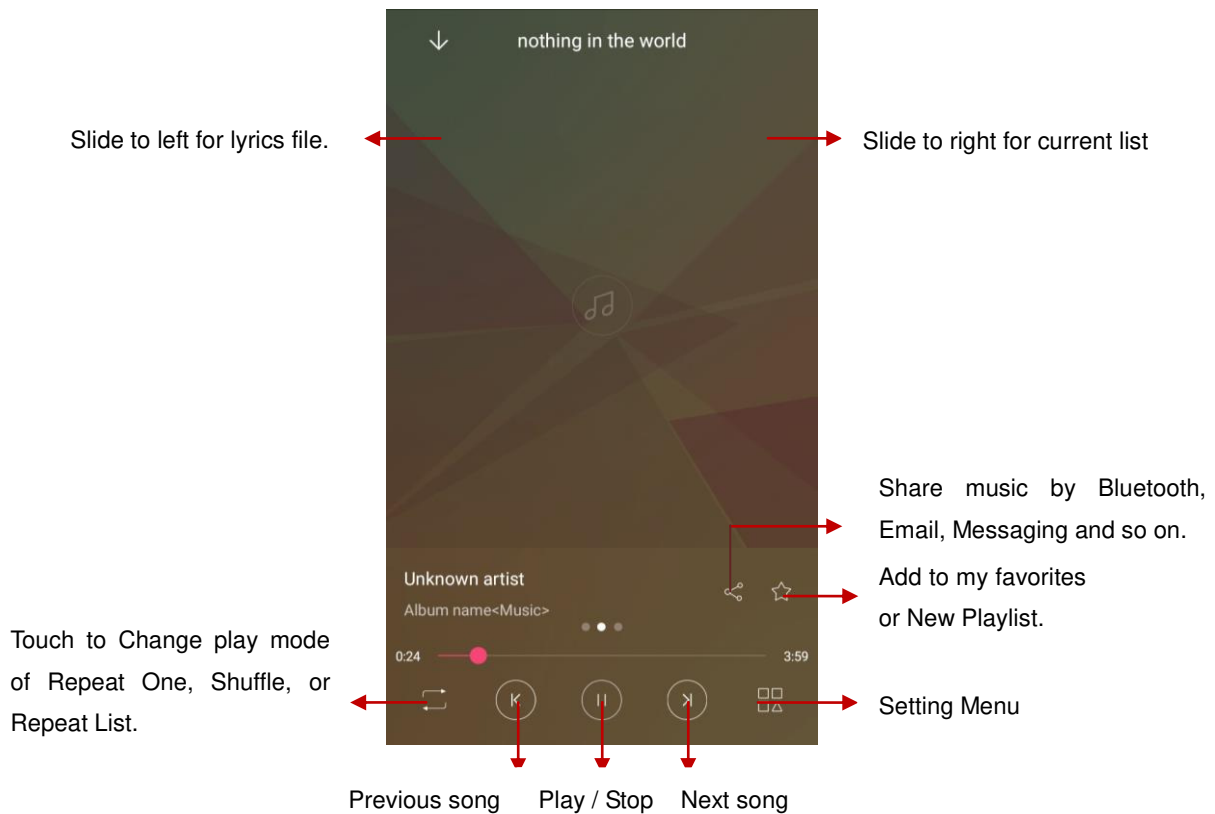

## 7. Connection

Your phone can connect to a variety of networks and devices, including mobile networks for voice and data transmission, WLAN data networks, and Bluetooth devices, such as headsets. You can also connect your phone to a computer, to transfer files from your phone storage, and share your phone's mobile data connection via USB or as a portable WLAN hotspot.

### Airplane mode

Option1: **Settings-->Airplane mode** to turn it on

Option2: Swipe up from the bottom edge to open control center--> tap Airplane mode

Some locations may require you to turn off your phone's Cellular network, WLAN, and Bluetooth wireless connections. You can turn off all these wireless connections at once by placing your phone in Airplane mode.

### Mobile Networks

When you assemble your phone with a SIM card from your wireless service provider, your phone is configured to use your provider's mobile networks for voice calls and for transmitting data.

#### **Settings-->Mobile networks-->Network operators**

The name of the wireless service provider you're currently registered with is selected in the list.

## **WLAN**

WLAN is a wireless networking technology that can provide internet access at distance of up to 100 meters, depending on the WLAN router and your surroundings. You can configure the WLAN as follow:

- **Settings-->WLAN**, check **WLAN** to turn it on.
- Enter **WLAN**. The phone scans for available WLAN networks and displays the names of those it finds. Secured networks are indicated with a Lock icon. The phone will auto login the network if you previously connected.
- Touch a network to connect to it.  
If the network is open, you are prompted to confirm that you want to connect to that network by touching connect. If the network is secured, you're prompted to enter a password or other credentials.

## **Bluetooth**

Bluetooth is a short-range wireless communications technology that devices can use to exchange information over a distance of about 10 meters. The most common Bluetooth devices are headphones for making calls or listening to music, hands-free kits for cars, and other portable device, including laptops and cell phones.

### To send a file

- **Settings--> Bluetooth**, check **Bluetooth** to turn it on.
- Enter **File Explorer** to select a file, Select **Share--> Bluetooth**.
- Touch **Scan for devices**, the phone will scan for and display the names of all available Bluetooth devices in range.
- Touch the names of the other device in the list to pair them. After paired the file will be sent.

### To receive a file

**Settings--> Bluetooth**, check **Bluetooth** to turn it on. Ensure your Bluetooth has been connected within visibility time.

You can receive files from the devices which are paired with yours. The file you received will be saved to the "bluetooth" folder in the File Explorer.

### To connect to a Handsfree device

- Turn on the Handsfree device, make it in a searchable state;
- Settings-->Bluetooth, Select "Search for devices";
- After searched the Handsfree device, Select it in the list to pair.
- After paired, you can use the Handsfree device to listen to music and receive call.

## **Hot Knot**

Hot Knot is used for data exchange when the screen touches another device.

**Settings--> Hot Knot**. Turn on the **Hot Knot**.

**Gallery-->Choose a Picture or Video -->Share --> Hot Knot Share**, then use screen to touch another device and the picture or video will be sent to another device.

- Ensure the receiving device has turned on Hot Knot and keep its screen unlocked.

- Put your device onto the receiving device screen to screen.
- Take your device away from the receiving device after you hear a voice prompt.

## 🚦 USB

You can connect the phone to your computer with a USB cable to transfer music, pictures, and other files.

### Turn on USB connection

1. Connect the phone to your computer with a USB cable.
2. Open the notification center and tap **Connected as a media device** to access files on this device.
3. Other USB options can be chosen.

**Charge Phone**, connected as a USB for charging.

**View photos**, connected as a camera to browse photos on PC only.

### ✓ **Notice:**

Do not disconnect the USB cable from the phone when you are transferring files. Doing so may cause data loss or phone damage.

## 8. Advanced Functions

### 🚦 Secret shooting

In the control center, long press the Camera key at 3 seconds to take a phone in secret. The secret photo is auto saved in “Gallery”.



### 🚦 Super screenshot

In control center, tap to access Super screenshots. Super screenshots included Normal

screenshots, Long screenshots and Part screenshots. The image is saved in the “Screenshots” folder.

To view it on

**File Explorer --> Phone Storage / SD Card --> Screenshots**

- Normal screenshots  
Capture one page in screenshots.



Rain gardens are growing in popularity as an environmentally friendly way to infiltrate stormwater into the home landscape. They have great potential to decrease overall demand on municipal sewer systems and are a cost-effective means of effectively managing storm runoff on site.

There are many different ways of creating rain gardens, and the first step is to determine where

- Long screenshots  
Capture 10 pages at most in screenshots. It's easy for you to save conversations in commutation tools, articles in website and so on.

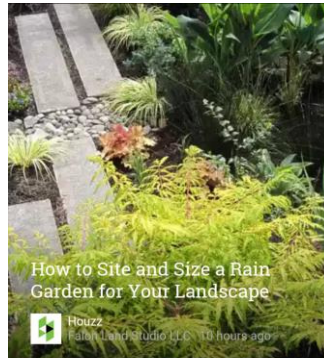

Rain gardens are growing in popularity as an environmentally friendly way to infiltrate stormwater into the home landscape. They have great potential to decrease overall demand on municipal sewer systems and are a cost-effective means of effectively managing storm runoff on site.

There are many different ways of creating rain gardens, and the first step is to determine where you'll put yours and how big it will be. In this series, we'll explore the basics of designing a rain garden. You can use it to guide a DIY installation or to gain a fuller understanding of rain garden best practices.

[View original article with high res images](#)



by *Anne Roberts Gardens, Inc.* | See large photo

**What is a Rain Garden?** Rain gardens are planted areas that are designed to capture and slowly allow rainwater and stormwater runoff to infiltrate the landscape. They use natural processes to slow, filter and soak up stormwater, recharging the groundwater and contributing to the overall water quality of our communities.

[Upgrade to the full Houzz experience](#)

by *Banyon Tree Design Studio* | See large photo

- Part screenshots  
Capture part size in screenshots. You can adjust the size with square on the screen.

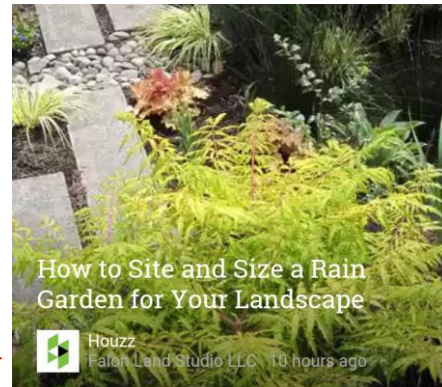
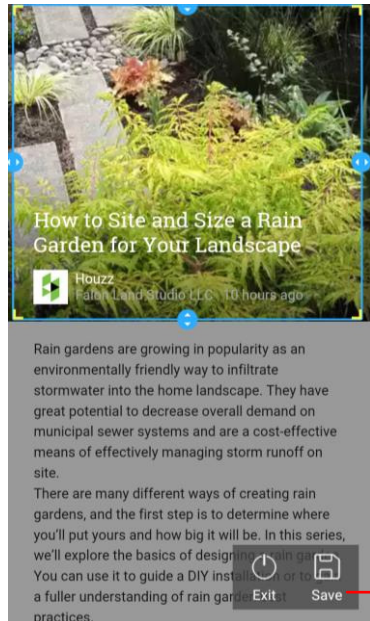

### 🚩 Extreme mode

Extreme mode let mobile phone enter the minimalist desktop to extend standby time. But it only available for phone, contacts, messaging and clock can be used during this time.

#### Access to extreme mode

- 1) Home screen-->Control center-->Tap Extreme mode
- 2) Home screen-->System manager-->Power-->Tap Extreme mode
- 3) Settings--> Power management -->Power manager-->Select Extreme mode

Tap to exit the extreme mode

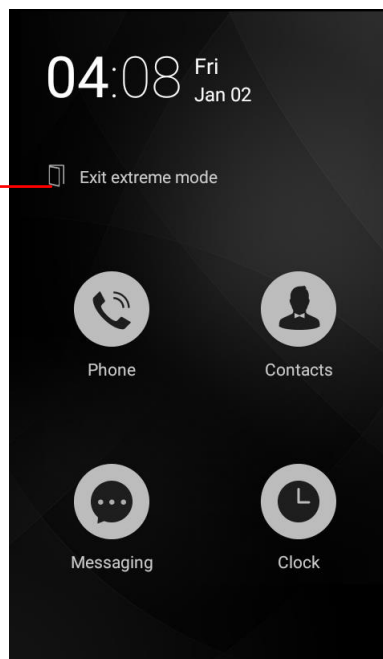

### 🚩 Chameleon

With Chameleon, you can pick color with front or rear camera. Click anywhere or drag the

color point to choose your favorite to design the colors of phone background.

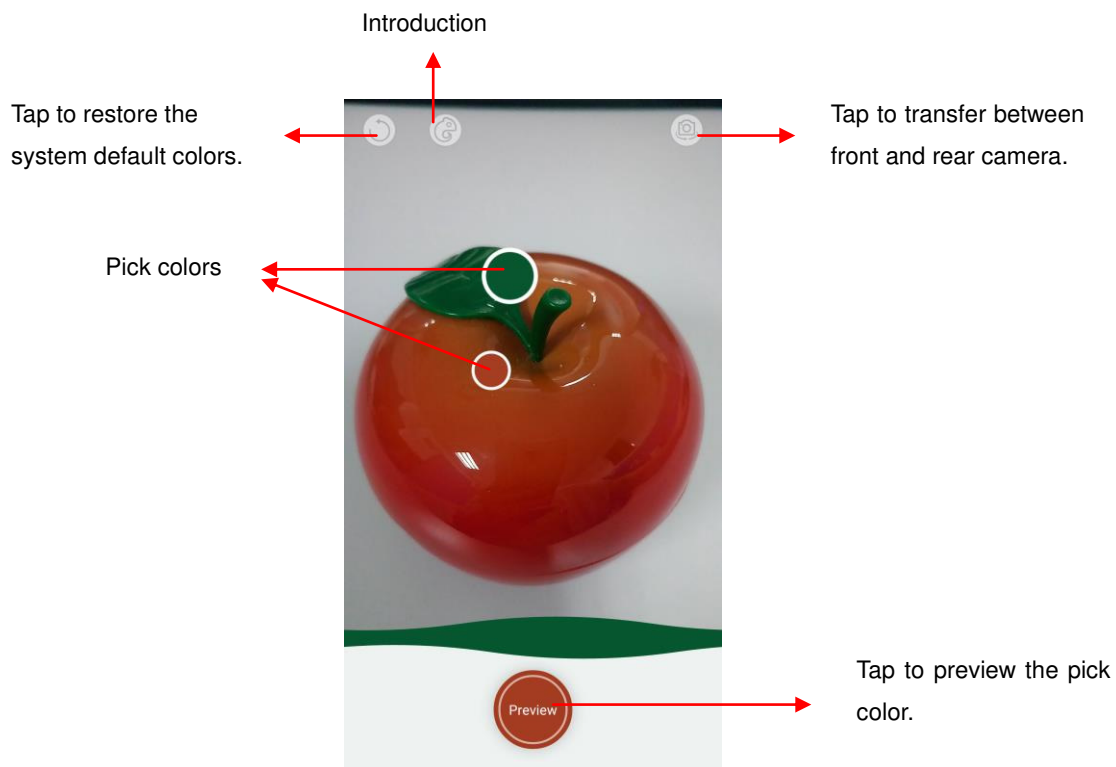

### Color Preview



## 9. Operation

### Smart gestures

**Settings-->Advanced settings--> Smart gestures** to turn it on.

The smart gestures system supports a variety of experience and control, through gesture can be more convenient operation. Some of the smart gesture functions will not work while flip cover is closed.

- Pause alarm

**Settings--> Advanced settings--> Smart gestures -->Select Pause alarm**

Flip back the phone to pause the on-going alarm.

①



②



- Smart vibration remind

**Settings--> Advanced settings--> Smart gestures -->Select Smart vibration remind**

Phone vibrate to remind the unread message or missed call notification in sleep mode.

①

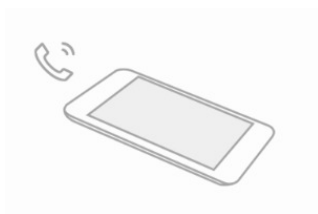

②

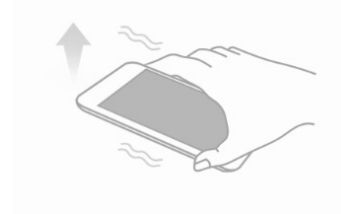

- Smart bright screen

**Settings--> Advanced settings--> Smart gestures-->Select Smart bright screen**

When front camera detects you are viewing screen, the screen can be maintained normally. Enable this function, the status bar will display this icon .

The following scenario, the function maybe failure:

- User doesn't face on the screen
- The light is too strong or too dark
- Front camera in use by other applications

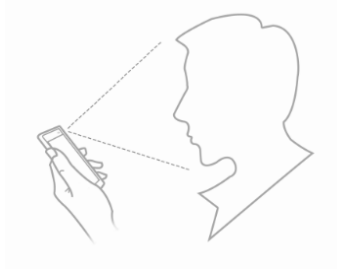

- **Black screen gestures**

**Settings--> Advanced settings--> Black screen gestures**

Draw pattern to access menu quickly while phone is in sleep mode.

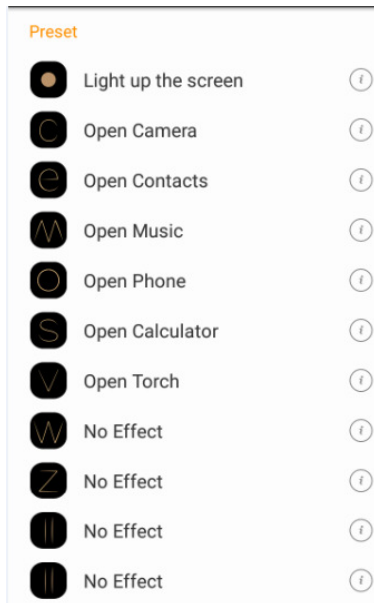

### Custom gestures

Support only three or less pens to complete a simple graphics or symbols.

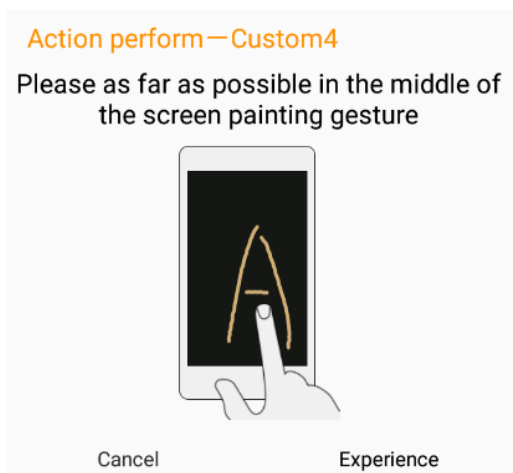

### **Suspend option**

Suspend option helps you to use the mobile phone without press the key. You can do the action just by tapping the screen.

**Settings--> Advanced settings--> Suspend option** to turn it on.

Long press can be hidden in the notification bar.

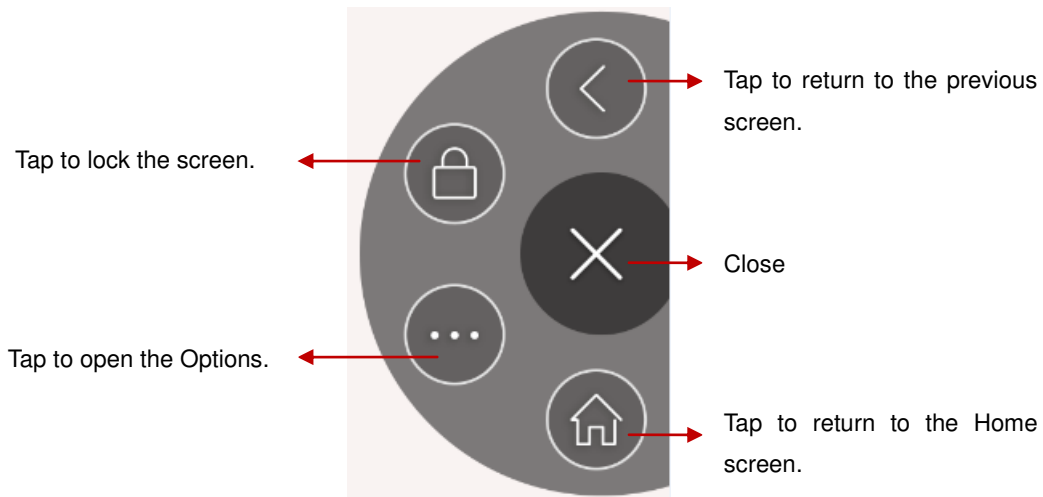

## 10. Warnings and notes

### Operational Warnings

**IMPORTANT INFORMATION ON SAFE AND EFFICIENT OPERATION.** Read this information before using your phone. For the safe and efficient operation of your phone, observe these guidelines:

**Potentially explosive at atmospheres:** Turn off your phone when you are in any areas with a potentially explosive atmosphere, such as fueling areas (gas or petrol stations, below deck on boats), storage facilities for fuel or chemicals, blasting areas and areas near electrical blasting caps, and areas where there are chemicals or particles (Such as metal powders, grains, and dust) in the air.

**Interference to medical and personal Electronic Devices:** Most but not all electronic equipment is shielded from RF signals and certain electronic equipment may not be shielded against the RF signals from your phone.

**Audio Safety:** This phone is capable of producing loud noises which may damage your hearing. When using the speaker phone feature, it is recommended that you place your phone at a safe distance from your ear.

**Other Medical Devices, hospitals:** If you use any other personal medical device, consult the manufacture of your device to determine if it is adequately shielded from external RF energy. Your physician may be able to assist you in obtaining this information. Turn your phone OFF in health care facilities when any regulations posted in these areas instruct you to do so. Hospitals or health care facilities may be using equipment that could be sensitive to external RF energy.

**Product statement on handling and use:** You alone are responsible for how you use your phone and any consequences of its use.

You must always switch off your phone wherever the use of a phone is prohibited. Use of your phone is subject to safety measures designed to protect users and their environment. Always treat your phone and its accessories with care and keep it in a clean and dust-free place

Do not expose your phone or its accessories to open flames or lit tobacco products.

Do not expose your phone or its accessories to liquid, moisture, or high humidity.

Do not drop, throw, or try to bend your phone or its accessories

Do not use harsh chemicals, cleaning solvents, or aerosols to clean the device or its accessories.

Do not attempt to disassemble your phone or its accessories; only authorized personnel must do so.

Do not expose your phone or its accessories to extreme temperatures, minimum 32°F and maximum 113°F (0°C to 45°C).

**Battery:** Your phone includes an internal lithium-ion or lithium-ion polymer battery. Please note that use of certain data applications can result in heavy battery use and may require frequent battery charging. Any disposal of the phone or battery must comply with laws and regulations pertaining to lithium-ion or lithium-ion polymer batteries.

**Faulty and damaged products:** Do not attempt to disassemble the phone or its accessory. Only qualified personnel must service or repair the phone or its accessory. If your phone or its accessory has been submerged in water, Punctured, or subjected to a severe fall, do not use it until you have taken it to be checked at an authorized service center.

## 11. FAQ

S.No.	FAQ	Answers
1	How to Add or Remove account in Android?	Settings->Advanced Setting ->Account ->Add Accounts a) To add an Account: Add Credential to add account b) To remove an Account: Select account that you need to remove->Option->Remove account
2	How to Factory Reset Android phone?	Settings -> Advanced Settings ->Backup & reset -> Factory data reset ->Confirm restore <b>Note:</b> Reset Factory default will remove all user data; do take a backup of your data in PC or on Gmail™.
3	In what scenario does the user have to factory reset Android phone?	In the following scenarios user needs to reset his phone. a) Phone not responding b) Phone automatically Restarting c) Erratic behavior of phone d) Bad Battery backup or charging issues e) Apps not working f) Deleted any pre-installed apps by mistake g) Erased customer data & settings h) To remove an account. <b>Note:</b> If the problem persists, please visit your nearest Service Center.

4	How to connect device via portable hotspot?	<p>Please follow the listed steps.</p> <p>a) Plug in your USB cable and connect it to PC.</p> <p>b) Settings -&gt; More -&gt; Tethering &amp; Portable hotspot-&gt; Select USB tethering.</p> <p>Let it install all the drivers first and after that you will be connected to Internet automatically. Drivers can be downloaded from our Website: <a href="http://global.gionee.com">http://global.gionee.com</a></p>
5	How to connect your device as USB mass storage?	<p>Please follow the listed steps.</p> <p>a) Plug in USB cable and connect it to PC.</p> <p>b) Select File copy.</p> <p>Let all the drivers install first and then your Device will be connected as a USB Mass Storage. Drivers can be downloaded from our website <a href="http://global.gionee.com">http://global.gionee.com</a>.</p>
6	How to add Data Account or APN settings?	<p>All GiONEE Smart phones come with Pre-loaded Internet Settings. User needs to insert SIM and turn the Data Connectivity On. The phone will automatically detect settings.</p>
7	How to do Data account or APN setting if user has edited or erased pre-installed data settings?	<p>There are two ways to resolve it.</p> <p>a) Do Reset Factory Default Setting.</p> <p>b) Settings-&gt; Mobile Networks-&gt;Access Point Names-&gt; Add new APN / Reset to default / Edit access point</p>
8	How to select Data mode (Auto or GSM or WCDMA)?	<p>Settings-&gt; Mobile Networks-&gt;Preferred Networks Type-&gt; Select Mode as per your need from 4G/3G/2G (Auto), 3G/2G, 3G or 2G only.</p>
9	How to reboot or reset to factory settings?	<p>Power off the phone-&gt;Press and Hold Volume up and Power key-&gt; Select the option based on your requirement.</p>
10	How to install applications that are not downloaded from Google play™ store?	<p>To install applications directly, do following.</p> <p>Settings -&gt; Security -&gt;DEVICE ADMINISTRATION-&gt; Select unknown sources.</p>

11	How to backup contacts and SMS?	<p>(a) For Contact Backup  (i) User can take backup on Gmail  (ii) Contact-&gt; More-&gt;Import/Export -&gt; Select Source &amp; Destination point to take back-up.  (b) For SMS Backup  (i) User can take backup on Gmail  (ii) Messaging -&gt; More-&gt; Import/Export SMS-&gt; Import SMS from storage or Export SMS to storage.</p> <p>On a device running Android User can take backup of Contacts, SMS, Call logs, Calendar with following steps.  Settings -&gt; Advanced settings -&gt; Backup &amp; reset  -&gt;System Backup and restore -&gt; Backup to storage</p>
12	Why the actual capacity may differ from the one mentioned on product label?	A certain portion of capacity of ROM may be used for system files and maintenance, thus actual capacity may differ from that indicated on the product label.

## FCC Regulations:

This mobile phone complies with part 15 of the FCC Rules. Operation is subject to the following two conditions: (1) This device may not cause harmful interference, and (2) this device must accept any interference received, including interference that may cause undesired operation.

This mobile phone has been tested and found to comply with the limits for a Class B digital device, pursuant to Part 15 of the FCC Rules. These limits are designed to provide reasonable protection against harmful interference in a residential installation. This equipment generates, uses and can radiated radio frequency energy and, if not installed and used in accordance with the instructions, may cause harmful interference to radio communications. However, there is no guarantee that interference will not occur in a particular installation. If this equipment does cause harmful interference to radio or television reception, which can be determined by turning the equipment off and on, the user is encouraged to try to correct the interference by one or more of the following measures:

- Reorient or relocate the receiving antenna.
- Increase the separation between the equipment and receiver.
- Connect the equipment into an outlet on a circuit different from that to which the receiver is connected.
- Consult the dealer or an experienced radio/TV technician for help.

FCC Note:

Caution: Changes or modifications not expressly approved by the party responsible for compliance could void the user's authority to operate the equipment.

## **RF Exposure Information (SAR)**

This phone is designed and manufactured not to exceed the emission limits for exposure to radio frequency (RF) energy set by the Federal Communications Commission of the United States.

During SAR testing, this device was set to transmit at its highest certified power level in all tested frequency bands, and placed in positions that simulate RF exposure in usage against the head with no separation, and near the body with the separation of 10 mm. Although the SAR is determined at the highest certified power level, the actual SAR level of the device while operating can be well below the maximum value. This is because the phone is designed to operate at multiple power levels so as to use only the power required to reach the network. In general, the closer you are to a wireless base station antenna, the lower the power output.

The exposure standard for wireless devices employing a unit of measurement is known as the Specific Absorption Rate, or SAR.

The SAR limit set by the FCC is 1.6W/kg.

This device is complied with SAR for general population /uncontrolled exposure limits in ANSI/IEEE C95.1-1992 and had been tested in accordance with the measurement methods and procedures specified in IEEE1528.

The FCC has granted an Equipment Authorization for this model phone with all reported SAR levels evaluated as in compliance with the FCC RF exposure guidelines. SAR information on this model phone is on file with the FCC and can be found under the Display Grant section of [www.fcc.gov/oet/ea/fccid](http://www.fcc.gov/oet/ea/fccid) after searching on FCC ID: 2AFWFSPLUS.

For this device, the highest reported SAR value for usage against the head is 0.71 W/kg, for usage near the body is 1.40 W/kg.

While there may be differences between the SAR levels of various phones and at various positions, they all meet the government requirements.

SAR compliance for body-worn operation is based on a separation distance of 10 mm between the unit and the human body. Carry this device at least 10 mm away from your body to ensure RF exposure level compliant or lower to the reported level. To support body-worn operation, choose the belt clips or holsters, which do not contain metallic components, to maintain a separation of 10 mm between this device and your body.

RF exposure compliance with any body-worn accessory, which contains metal, was not tested and certified, and use such body-worn accessory should be avoided.

## **COPYRIGHT**

All rights reserved. Reproduction, transfer, distribution or storage of part or all of the contents in this document in any form without the prior written permission of GiONEE is strictly prohibited.

Android, Google, Google Play, the Google Play logo and other marks are trademarks of Google Inc.