



#### Furrion Innovation Center & Institute of Technology

- 52567 Independence Ct., Elkhart, IN 46514, USA • Toll free:1-800-789-3341
- Email: support@furrion.com

©2007-2021 Furrion Ltd. Furrion® and the Furrion logo are trademarks licensed for use by Furrion Ltd. and registered in the U.S. and other countries.

FURRIION.COM

IG-FAV00056 V1.0

## 2. Mount on wall

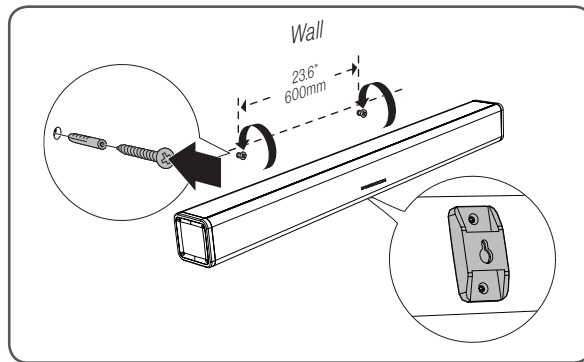

## CONNECT POWER

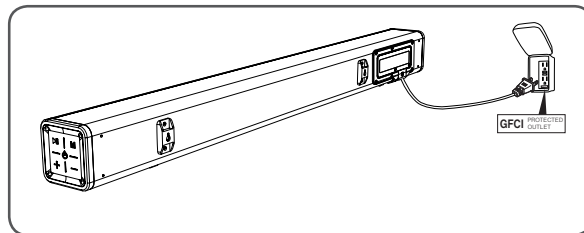

## INSTALL REMOTE CONTROL BATTERY

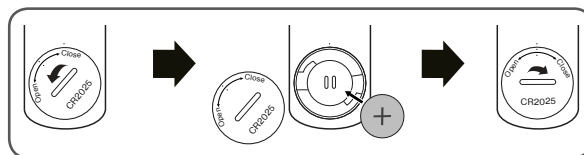

## BASIC OPERATION

### Soundbar Buttons

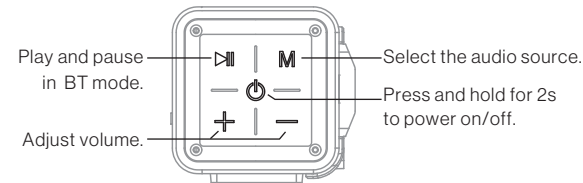

Remote control Button	Function
	Power on/off.
	Short press to switch the source mode to Bluetooth; Press and hold it for 3s to unpair and launch pairing again. (BT Name: Furrion SB 2.1)
Source	Select the audio source (AUX, RCA, COAX, BT).
	Mute or un-mute the audio output.
	Skip to the previous track in BT mode.
	Start or pause playback in BT mode.
	Skip to the next track in BT mode.
	Adjust volume.
Music	Select the different EQ mode.
TV	
Movie	
Sport	

Tip: See the complete user manual online for detailed functional explanation.

# FURRIION

## Aurora™ Bluetooth Soundbar



## Quick Start Guide

Model: FSBNN30MSS-BL



<https://furrion.com/pages/downloads-audio-visual>

\* To view the multi-language user manual, please access the link or scan the QR code.

\* Pour obtenir le manuel d'utilisateur multilingue, accédez au lien ou scannez le QR code.

\* Para ver el manual de usuario en otros idiomas, acceda al siguiente enlace o escanee el código QR.

This quick start guide will help you install and use the device properly.  
For further support and to download the complete user manual please visit [www.furriion.com/support](http://www.furriion.com/support).

**WHAT'S IN THE BOX**

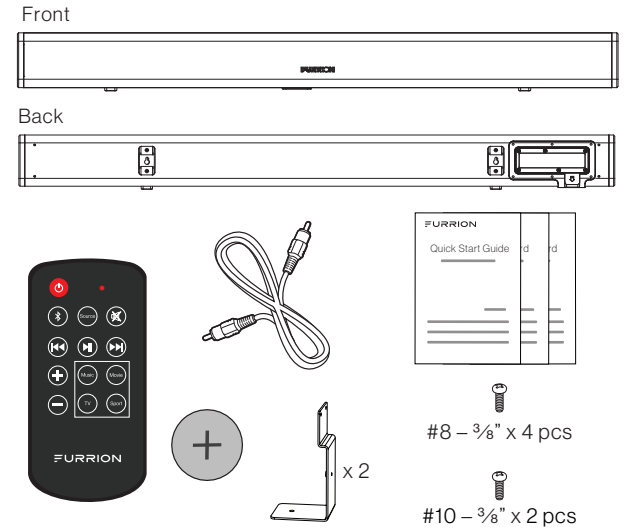

**NOTE:** Product design and packaging may change without notice.

**CONNECT**

- Open the protective cover on the back by removing the screws then connect the cables.

**Note:** All external devices and cables shown in the diagram are for reference only and not included in the package.

**1. Connect Soundbar with TV**

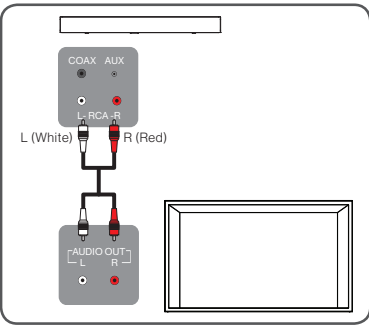
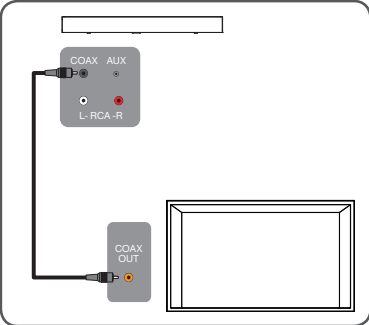

**2. Connect Soundbar with other devices**

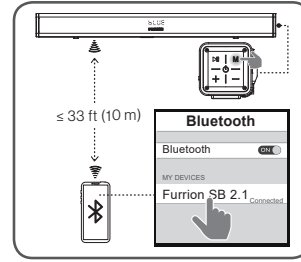
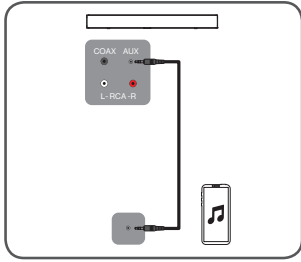
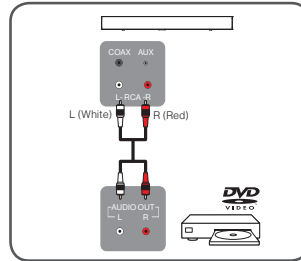
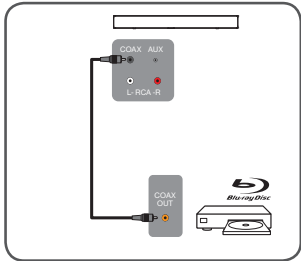

- After the connections are completed, close the protective cover and tighten the screws for the best weatherproof effect.

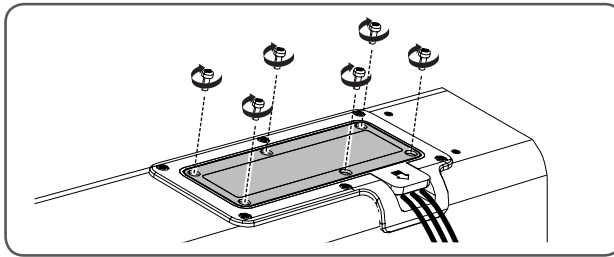

**INSTALL**

**IMPORTANT:** Before final installation, check by powering the Soundbar on to make sure the unit operates properly.

**1. Install Soundbar to the compatible Furriion Aurora™ TV**

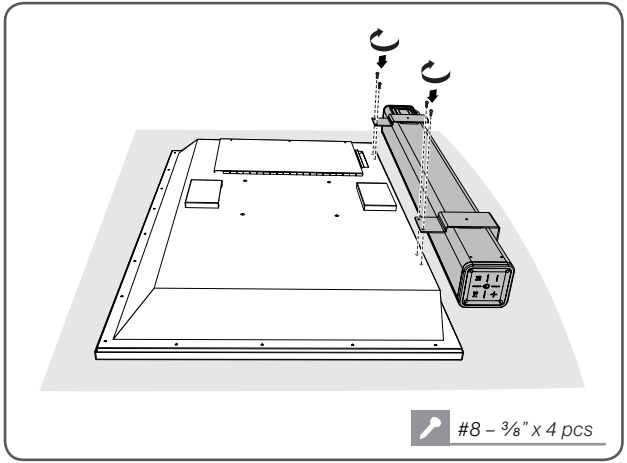
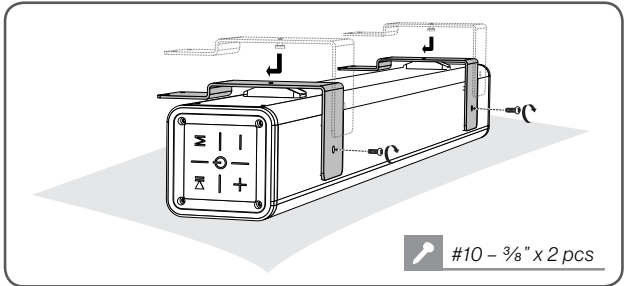

## FCC WARNING

This device complies with part 15 of the FCC Rules. Operation is subject to the following two conditions: (1) this device may not cause harmful interference, and (2) this device must accept any interference received, including interference that may cause undesired operation.

Any changes or modifications not expressly approved by the party responsible for compliance could void the user's authority to operate the equipment.

NOTE: This equipment has been tested and found to comply with the limits for a Class B digital device, pursuant to Part 15 of the FCC Rules. These limits are designed to provide reasonable protection against harmful interference in a residential installation. This equipment generates, uses and can radiate radio frequency energy and, if not installed and used in accordance with the instructions, may cause harmful interference to radio communications. However, there is no guarantee that interference will not occur in a particular installation.

If this equipment does cause harmful interference to radio or television reception, which can be determined by turning the equipment off and on, the user is encouraged to try to correct the interference by one or more of the following measures:

- Reorient or relocate the receiving antenna.
- Increase the separation between the equipment and receiver.
- Connect the equipment into an outlet on a circuit different from that to which the receiver is connected.
- Consult the dealer or an experienced radio/TV technician for help.

To maintain compliance with FCC's RF Exposure guidelines, This equipment should be installed and operated with minimum distance between 20cm the radiator your body: Use only the supplied antenna.