

Phone Case Video Light  
(User Manual)

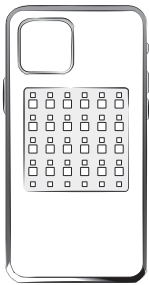

Really thanks for you using this product,  
please read this manual carefully before use to  
avoid product damage caused by improper operation.

Functions Introduction

- 360°Full Color Adjustment
- Colorful Light Effects
- Music & Light Sync
- APP Wireless Control
- Multiple Device Control

Product Parameters

Name	Phone Case Video Light
Model	A12
Material	TPU+ABS
Size	149*74*14mm
Input	5V/0.5A
Color Temperature	3000-6500K/RGBW
Consumption	1.5W (Max)
Working Time	>1.5H
Battery Capacity	600mAh

Product Appearance

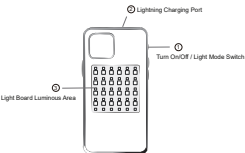

Button Functions

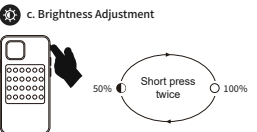
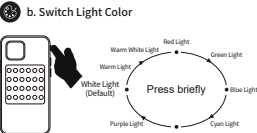
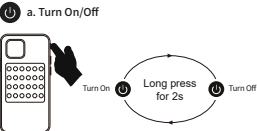

APP

A. APP Installation

a1. Search "Rajdo Smart"  
or scan the QR to download:



B. Add Devices

b1. Turn on the video light



b2. Turn on the Bluetooth of the smartphone and enter the APP; click the "+" icon in the upper right corner, select the "LED Color", and then confirm the "OK" icon.

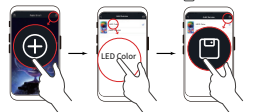

b3. Enter the LED Color page, click the "B" icon in the upper left corner to add the devices.



b4. Click the search icon "Q" in the upper right corner, and the "Scan Device" list will display the searched Device, it displays "not connected", click on the device until it is in the "bound" device list The red "Connected" indicates that the device is successfully connected.



b5. Click the upper left corner to return to the home page, the number displayed in the upper left corner is the number of devices that have successfully connected to this APP.



Product List



Warning

- The input power of this product is 5V-0.5A, please do not use a power supply that does not conform to the specifications of this product.
- Do not immerse the product or power cord in water to avoid damage to the product.
- Do not disassemble the product shell privately to avoid possible circuit damage or other dangers.
- It is strictly forbidden to disassemble, squeeze, deform, puncture, short-circuit the product, or throw it into water, fire, or expose to an environment with a temperature higher than 45°C.

FCC Statement

Changes or modifications not expressly approved by the party responsible for compliance could void the user's authority to operate the equipment.

This equipment has been tested and found to comply with the limits for a Class B digital device, pursuant to Part 15 of the FCC Rules. These limits are designed to provide reasonable protection against harmful interference in a residential installation. This equipment generates uses and can radiate radio frequency energy and, if not installed and used in accordance with the instructions, may cause harmful interference to radio communications. However, there is no guarantee that interference will not occur in a particular installation. If this equipment does cause harmful interference to radio or television reception, which can be determined by turning the equipment off and on, the user is encouraged to try to correct the interference by one or more of the following measures:

- Reorient or relocate the receiving antenna.
- Increase the separation between the equipment and receiver.
- Connect the equipment into an outlet on a circuit different from that to which the receiver is connected.
- Consult the dealer or an experienced radio/TV technician for help

This device complies with part 15 of the FCC rules. Operation is subject to the following two conditions (1) this device may not cause harmful interference, and (2) this device must accept any interference received, including interference that may cause undesired operation.