

AlfaBot

WINDOW CLEANING
ROBOT WITH DUAL WATER SPRAY

USER MANUAL



AlfaBot X7 Pro

Thanks for your purchase. Any questions please don't hesitate to contact us, we will handle all your problem ASAP. Your feedback is vital to us! And we will always try to do better. For more details, please contact us by email alfabotou@hotmail.com (Write your Order #on the subject of the email, so that we can find your order and better assist your issue)

1. Safety Instructions

1.1 About the scope of product application.

The product is suitable for cleaning all kinds of smooth surfaces, including glass, floor, ceramic tile, marble, etc.

*This product is a glass cleaning tool. The place and safety of use must be judged and responsible by the user.

1.2 Something you need to know before use.

- Be sure to fasten the safety rope before use, and tie the safety rope to the indoor to avoid falling of the machine.
- Please check if the safety rope is damaged and the knot is loose before use.
- For glass doors and windows without a balcony, a hazard warning area must be set up on the ground downstairs, and people are prohibited from approaching.
- The machine must be connected to the power cord to be used normally.
- Try to use it when the built-in battery is fully charged (green light is on).
- Please turn on the power before placing the machine.
- When putting the machine on the glass, please make sure that the machine can be attached to the glass before letting go.
- Please take off the machine before turning off the power.
- Please be cautious when using on frameless glass.
- Make sure to put the cleaning ring on the cleaning wheel to avoid air leakage.
- Do not use in rainy or humid weather.
- Do not spray water directly on the machine.
- Do not let children use it.
- Remove the obstacles on the glass. It is forbidden to use it on cracked glass. When using reflective glass and coated glass, be careful to scratch the glass surface due to wind and sand.
- Do not let hair, clothing corners, hands, fingers and any part of the body close to the product opening or rotating parts.
- Do not allow the machine to inhale flammable liquids or gases such as gasoline, or use it near flammable liquids or gases.

1.3 When there is a problem with the product.

□If the power cord is damaged or other accessories fail, please do not repair or disassemble it by yourself to avoid possible personal injury.

□Please contact our company's after-sales service department or a professional maintenance organization designated by our company, and professional maintenance personnel will provide after-sales service and maintenance. Email: alfabotou@hotmail.com

2. Product Informations

2.1 Product Features.

- Can wipe any thickness of glass.
- Artificial Intelligence Technology.
- Three directions of automatic mode, automatic cleaning of the whole window.
- Automatically stop after cleaning.
- Built-in uninterruptible power UPS system, which can maintain power for 30 minutes when the power is off.
- Anti-drop design.
- Automatically detect window frame.
- Manual remote control mode.
- Dual ultrasonic automatic water spray.
- Microfiber cleaning pads.
- High-strength safety rope.
- 2.4G wireless remote control operation.
- Power consumption: 80W, 100~240VAC, 50~60Hz

2.2 Product body and accessories.

- Window cleaning robot x1
- AC power cord x1
- Cleaning ring x4
- Remote control x1
- DC extension cord (5M) x1
- Safety rope (5M) x1
- Transformer (100~240V, 50~60Hz) x1
- Cleaning pads x12
- Water injecting bottle x1
- Instruction Manual x1

2.3 Introduction to product structure.

① Indicator light description

- White light: the white light is always on when it is turned on
- Charging indicator: red light is on during charging; green light is on when fully charged

- Red light: error warning light

- Blue light: in normal work;

Blue light always on: manual water spray mode.

Blue light flashing: automatic water spray mode.

② Warning buzzer

③ Water spray nozzle

④ Exhaust vent

⑤ Power switch

⑥ Power interface

⑦ Safety rope hole

⑧ Water injecting hole

⑨ The bottom red light flashes: abnormal working status, the bottom blue light on: working normally

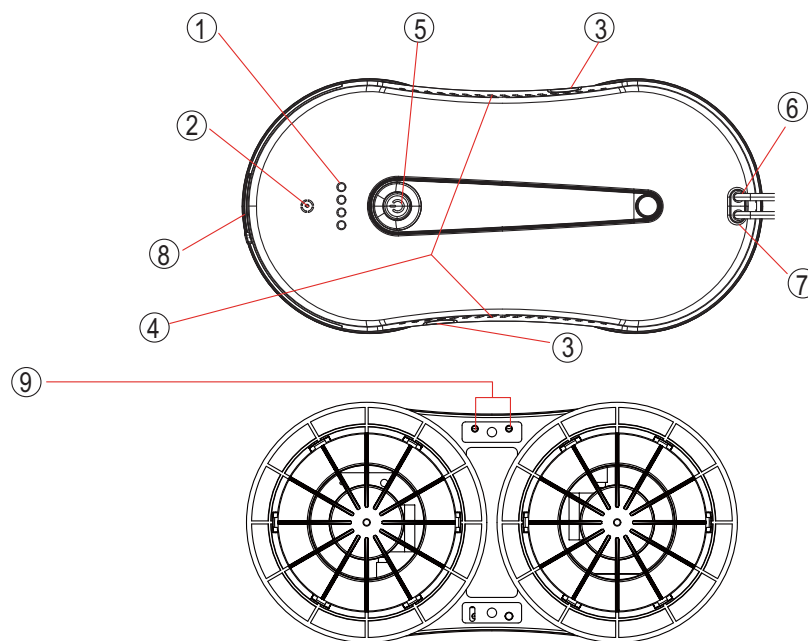

3. How to clean windows

3.1 Dry wipe first.

- The first time you wipe, you must "dry wipe" (turn off the water spray function and do not spray any water), and first remove the wind and sand on the glass surface.
- If you spray some water on the cleaning cloth or glass first, the water will mix with the sand and turn into yellow muddy water, and the wiping result will be poor.
- Use the machine in sunny or low-humidity weather, dry wiping works best.
- Do not use in rainy or humid weather, there will be white misty moisture traces.



※ If it's slipping on the glass, you can spray a little water on the cleaning pads※

3.2 Then wet wipe.

Replace the clean cleaning pads, turn on the automatic water spray function or keep the upper cleaning wheel clean and dry. Spray a little water on the lower cleaning wheel (1~2 sprays are sufficient). Do not make it too wet, the completely wet cleaning pad will affect the machine Running.



4. Steps for usage

4.1 Connect correctly.

1. Connect the adapter.
2. Connect the AC power cord to the adapter.
3. Plug the power supply into the socket.

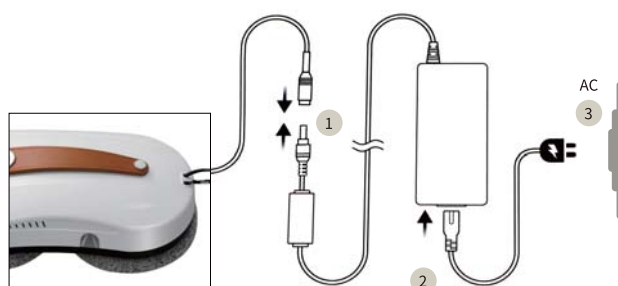

4.2 Charge the back-up battery.

The machine has a built-in battery for backup power in case of power failure. Before use, please make sure that the battery is fully charged (green light is on).

- First turn off the power switch on the machine, after connecting the power cord, the red light is on to indicate the charging state.
- When the green light is on, it means the battery is fully charged.

4.3 Install the cleaning pads and cleaning rings.

As shown in the below pic, make sure that the cleaning cloth is placed on the cleaning ring, and then the cleaning ring is correctly placed on the cleaning wheel to prevent air leakage from the machine.

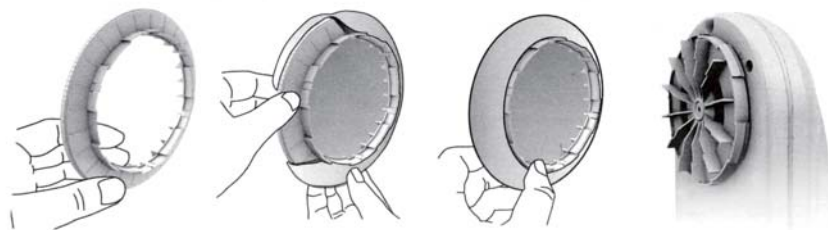

4.4 Install the safety rope.

- (1) For glass doors and windows without a balcony, a hazard warning area must be set up on the ground downstairs, and people are prohibited from approaching.
- (2) Please check whether the safety rope is damaged and the knot is loose before use.
- (3) Be sure to fasten the safety rope before use, and tie the safety rope to the fixed objects in the house to avoid danger.

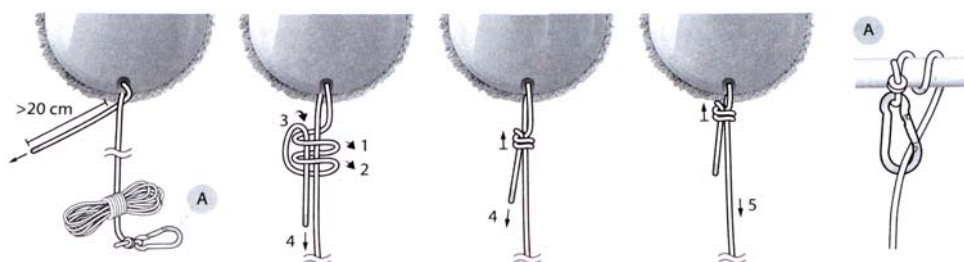

4.5 Fill in pure water (you can add cleaning solution into the water).

Only use clean water or clean solutions with pure water.







The robot design with 2 separate water tank 25ml, it can spray water in 2 directions, spraying water to the left when going left or spraying water to the right when going right.



4.6 Attach the machine to the window.

- (1) Press and hold the power button for 2 seconds to start the machine and confirm the fan is rotating.
- (2) Put the machine on the glass, and some distance away from the window frame.
- (3) Confirm that the machine can be attached to the glass before letting go.

4.7 Automatic cleaning mode and manual cleaning mode.

- (1) Choose the three automatic modes (  ) to automatically clean the entire window.
- (2) Press the  button to stop the machine.
- (3) Press the  to manually operate the machine.
- (4) Press the () button to enter the fully automatic mode, and one key to clean the window.

4.8 Remove the machine from the window.

- (1) Grasp the window cleaner with one hand and turn off the power with the other hand (press and hold the power switch for 2 seconds).
- (2) Remove the window cleaner.

5. Uninterruptible power system (UPS)

- (1) When the power is cut off, the machine will start the built-in battery power, which can maintain power for 30 minutes.
- (2) When the power is cut off, the machine will stay in place and will not move forward, and will emit a warning sound and the red/blue light will flash alternately. At this time, the user should retract the machine as soon as possible to avoid the power being run out and falling.
- (3) The safety rope can be used to gently pull the machine back; when pulling the safety rope, it should be as close to the glass as possible to avoid falling.

6. Cleaning and maintenance

- Washing temperature is lower than 40oC (104oF).
- Do not use bleach.
- Do not use soft essence.
- Do not dry.
- Do not iron.
- Do not dry clean.

Maintenance frequency: after each use

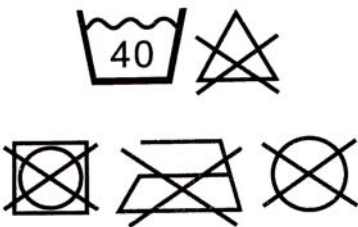

7. Remote control instructions

Automatically move up then down	Manually move up
Automatically move left then down	Manually move down
Automatically move right then down	Manually move right
Auto spray switch on/off	Manually move left
Manual spray switch	Start Cleaning
Stop Cleaning	

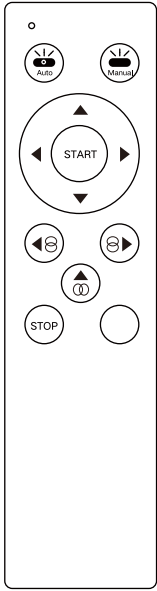

Three auto cleaning modes option

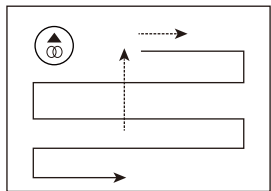

Auto Up then Down

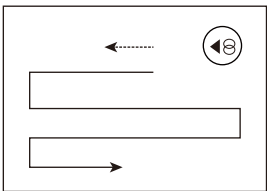

Auto Left then Down

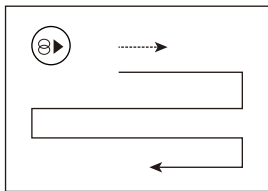

Auto Right then Down

8. Troubleshooting

1.Problem: The first use of the cleaning pads (especially on the dirty exterior windows) may cause the machine to run slowly or even unable to rotate.

Solutions:



- (1) When unpacking the machine, clean the cleaning pads and dry it before use.
- (2) Spray a little water on the cleaning pads or the surface of the glass to be wiped.
- (3) After the cleaning pads is dampened and wrung out, put it into the cleaning ring of the machine for use.

2.Problem: The machine will self-test when it works for the first time. If it fails to run smoothly and there is a warning sound, it means that the friction on the glass is too large or too small.

Solutions: Please check as follows

- (1) Whether the cleaning pads is too dirty.
- (2) The friction coefficient of glass stickers and matte stickers is relatively low, so they are not suitable for use.
- (3) When the glass is wiped very clean, the glass will be too slippery.
- (4) When the humidity is too low (air-conditioned room), the glass will be too slippery after wiping for many times.



3.Problem: When pressing  the upward automatic cleaning mode, the machine cannot detect the upper edge of the window smoothly due to the slippage of the upper frame of the window.

Solutions: Please press  to switch to  or  or auto cleaning mode.

4.Problem: The machine cannot clean the upper left position of the glass.



Solutions: You can choose the manual window cleaning mode to wipe the parts that have not been wiped (sometimes the glass or cleaning cloth is slippery, the width of the wiped glass is large, and the top row appears to slip a little bit and the upper left position cannot be wiped).

5.Problem: The machine was unable to clean the window completely, and the window cleaning operation was completed early.

Solutions: You can press  or  to continue the unfinished part in auto window cleaning mode.

6.Problems: The possible reasons for slipping while climbing and unable to climb up.

Solutions:

- (1) The friction is too small. The coefficient of friction of stickers, heat-insulating stickers or matte stickers is relatively low.
- (2) The cleaning pads is too wet.
- (3) When the glass is wiped very clean, the glass will be too slippery.
- (4) When the humidity is too low (air-conditioned room), the glass will be too slippery after wiping several times.
- (5) When starting the machine (press  or  or ), place the machine at a distance from the window to avoid machine judgment errors.

7.Problem: The machine is not walking smoothly, there are possible reasons.

Solutions:

- (1) The cleaning pads is too dirty, please replace it with a new set of clean pads.
- (2) There are different areas on the glass surface (glass area, sticker area, heat insulation sticker area or matte sticker area), please use it in a single area.
- (3) The cleaning wheel screw is loose, please tighten it (do not lock it too tight, otherwise it may affect the glass glue at the bottom of the window frame is too thick or the performance of the beveled window frame).

8.Problem: After cleaning, the round streaks remains on the glass surface.

Solutions: The cleaning pads is too dirty, please replace it with a set of clean pads and wipe it again.

9.Problem: The machine stops working due to a power failure and emits a warning sound and the red light flashes. How to deal with it?

Solutions:

- (1) Pull back the machine gently with the safety rope; when pulling the safety rope, try to be as close to the parallel glass as possible to avoid falling.
- (2) Turn off the power switch of the machine.
- (3) Check whether the wires are in poor contact or disconnected.

10.Problem: The machine stops when encountering an unknown obstacle, the red light is flashing, and there is no warning sound, how to deal with it?

Solutions:

- (1) Remote control the machine to a safe location. Or use the safety rope to gently pull back the machine; when pulling the safety rope, try to be as close to the parallel glass as possible to avoid falling.
- (2) Eliminate obstacles on doors and windows.
- (3) Check if there is any cause of air leakage.

11.Problem: It leaves streaks when illuminated at night?

Solutions: For the first cleaning, turn off the water spray function and use a clean cloth to remove wind and sand. Wipe for the second time, clean and replace with a clean cleaning pads, turn on the water spray function or keep the upper cleaning wheel clean and dry, spray a little detergent or alcohol (1~2 sprays is sufficient) on the lower cleaning wheel, not all wet, it can eliminate the streaks. A completely wet cleaning pads will affect the operation of the machine.

12.Problem: The machine has cleaned all windows, but it cannot stop automatically.

Solutions: Please press the button  to stop the working.

13.Problem: The machine can not spray water.

Solutions:

- (1) Please use the auto spray mode.
- (2) Clean the ultrasonic nozzle with a clean soft cloth.
- (3) Turn off the robot, fill the water tank with water, and shake the robot for a few seconds. Then try again to press the manual-spray button to spray water(blue light on). If it still doesn't spray, repeat from the shaking operation.

9. Specifications

Brand	AlfaBot
Model	X7 Pro
Net weight	900g/2.0lb
Item size	290 * 142 * 86 mm / 11.4 * 5.6 * 3.4 inches
Cleaning method	Rotary cleaning
Auto water spray	Yes, dual water spray
Build-in Water tank	2 * 25ml water tanks separate
Applicable glass thickness	All
Input Voltage	AC110-240V, 50/60Hz
Power	80W
Run time of built-in battery	30 minutes, 600mAh, 14.8V
Certification	UL, CCC, FCC, TUV, LPS, BSMI, PSE, KC, RoHS
Cleaning speed	2-4 minutes per square meter

10. Contact us

alfabot@hotmail.com

If you receive a defective item or have any problems with this item, please email us at

- Amazon Order ID
- Short description of the defect
- Your Shipping Address and Phone Number



Disposal

Do not dispose of the device in normal domestic waste.

Dispose of the device over a registered waste disposal firm or through your communal waste disposal facility.

Note the currently valid Regulations. In case of Doubt, consult your waste disposal facility.

Warning Statement

This device complies with part 15 of the FCC Rules. Operation is subject to the following two conditions: (1) This device may not cause harmful interference, and (2) this device must accept any interference received, including interference that may cause undesired operation.

Any Changes or modifications not expressly approved by the party responsible for compliance could void the user's authority to operate the equipment.

Note: This equipment has been tested and found to comply with the limits for a Class B digital device, pursuant to part 15 of the FCC Rules. These limits are designed to provide reasonable protection against harmful interference in a residential installation. This equipment generates uses and can radiate radio frequency energy and, if not installed and used in accordance with the instructions, may cause harmful interference to radio communications. However, there is no guarantee that interference will not occur in a particular installation. If this equipment does cause harmful interference to radio or television reception, which can be determined by turning the equipment off and on, the user is encouraged to try to correct the interference by one or more of the following measures:

- Reorient or relocate the receiving antenna.
- Increase the separation between the equipment and receiver.
- Connect the equipment into an outlet on a circuit different from that to which the receiver is connected.
- Consult the dealer or an experienced radio/TV technician for help.

This equipment complies with FCC radiation exposure limits set forth for an uncontrolled environment.