

D602无线收音麦克风

使用说明书



版本:A2403-1

产品介绍

感谢您选择我们的的产品

本产品为智能无线麦克风,可提供专业级的录音输出,即插即用,无需APP,可实现网络直播(需直播APP支持)、视频Vlog拍摄、节目访谈、采访录音、视频教学等场合的使用,无线收音麦克风由三部分构成:麦克风发射端、接收端和充电仓(选配)(如下图所示)

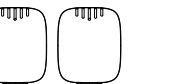

麦克风发射端(TX)

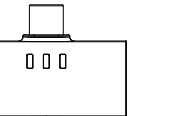

接收端(RX)



收纳式充电仓

ID图示

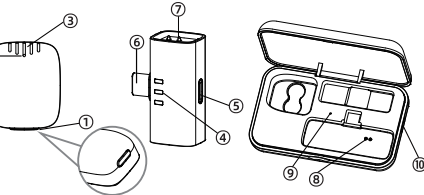

①开/关机按键/功能调节按键

开机:短按开机,绿灯闪烁,表示开机成功,进入搜索配对中
配对:开机成功后,将接收器插到手机或其他设备上,即可自动配对连接,配对成功后发射器、接收器指示灯长亮。

静音:连接成功后,单击发射器开机键,转为静音状态,绿灯熄灭;再次单击发射器开机键解除静音,绿灯长亮。

关机:长按开机键3秒
(注:发射器3分钟内未与接收器连接,将进入关机状态)
▲个别版本因软件不同,操作方法可能会不一样。

②指示灯

开机:绿灯闪烁
配对:绿灯闪烁
静音状态:绿灯熄灭
充电:红灯长亮

关机:灯灭
连接成功:绿灯长亮
低电状态:红灯
充电完成:红灯熄灭

③内置麦克风

④接收器指示灯

左右两个是TX1/TX2连接指示灯,连接成功指示灯亮,中间是USB连接指示灯,USB连接常亮,录音时闪烁。

⑤接收端充电接口

如果直播时,在手机电量不足的情况下,可直接使用电源设备通过此接口为手机充电。

⑥接收端手机接口

连接手机上显示设备名称DareFly D602-LB。

⑦发射器充电触点

1.接收器插入安卓手机时,可通过此触点给发射器充电,注意:苹果手机无此功能;
2.接收器放置在充电仓中,通过此触点给发射器充电;
3.接收器连接手机,插入充电线,给手机充电的同时,可以通过此触点给发射器充电。

⑧充电仓充电触点

接收器放入充电仓,充电仓电源5V电压从充电触点传到接收器,通过接收器充电触点给发射器充电。

⑨充电仓指示灯

外接电源给充电仓充电亮红灯,给发射器充电时充电仓绿灯长亮。

⑩充电仓Type-C接口

可以给充电仓和入仓的发射器充电。

使用方法

1、单击麦克风的开机键,指示灯亮绿灯,即为开机成功。



2、将接收端插口插入手机的接口。

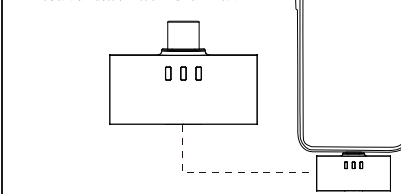

注:OPPO/MIVO/IQOO/Readme或其他部分品牌手机需要到手机设置里面,搜索“OTG”并打开OTG能使用,部分手机还需要设置默认录音设备,在设置中改成外接设备

3、接收器中间指示灯连接USB成功后灯常,录音时闪烁,两边两颗指示灯分别为两个发射器的指示灯,发射器连接成功后,指示灯常亮。

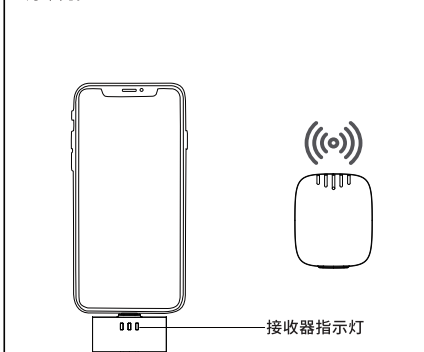

技术规格

通讯方式:2.4G无线传输
传输延时:<20ms
频率响应:30HZ-18KHZ
灵敏度:-38dB
信噪比:65db
最大声压级:115dB
传输距离:≥20米(空旷环境)
麦克风指向性:全指向型
充电仓电池容量:500mAH(3.7V)
发射器电池容量:40mAH(3.7V)
续航:4-6h,配合充电仓续航可达25小时左右
*包装标识无线传输距离50米是指产品在部分环境能承载的最远距离
本手册及产品技术指标如有更新恕不另行通知

包装清单

- | | |
|--------------|---------|
| 1、麦克风(发射器)*2 | 2、接收器*1 |
| 3、充电仓*1 | 4、衣领夹*2 |
| 5、吸附磁铁*2 | 6、充电线*1 |
| 7、防风海绵*2 | 8、说明书*1 |
| 9、合格证*1 | |

售后保修

用户信息

型号	
产品编号	
购买日期	

保修记录

保修日期	故障及处理方法	完成日期	签名

合格证

检验员
日期

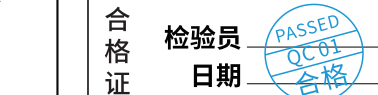

此产品已通过
检验

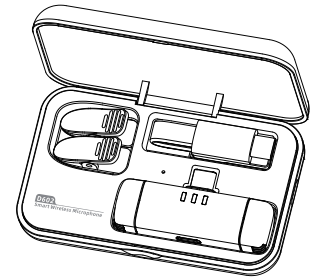

D602 Wireless Radio Microphone

operation instructions



REV:A2403-1

Product Introduction

Thank you for choosing our product

This product is an intelligent wireless microphone that can provide professional audio output, plug and play, without the need for an app. It can be used in online live streaming (supported by the live streaming app), video Vlog shooting, program interviews, interview recording, video teaching, and other occasions. The wireless radio microphone is composed of three parts: microphone transmitter, receiver, and charging compartment (optional). (As shown in the following figure)

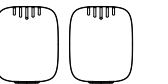

Microphone transmitter (TX)

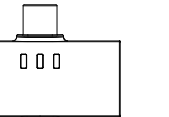

Receiver (RX)



Charging Dock Storage Box

ID diagram

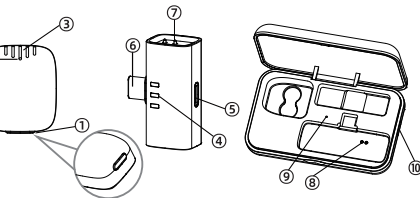

① On/Off button/Function adjustment button

Power on: Short press the power on button, the green light flashes, indicating successful power on and entering the search pairing process
Pairing: After successful startup, plug the receiver into your phone or other device to Automatic pairing connection, after successful pairing, the transmitter and receiver indicator lights remain on.

② Pilot lamp

Power on: Green light flashing
Power off: Light off
Pairing: Green light flashing
Successfully connected: the green light remains on
Mute state: green light off
Low battery state: red light
Charging: The red light remains on for a long time
Charging completed: red light off

③ Built-in microphone

④ Receiver indicator light

The left and right two are TX1/TX2 connection indicators, the connection success indicator is on, and the USB connection indicator is in the middle, the USB connection indicator is steady on and blinks during recording.

⑤ Receiving end charging port

If the phone's battery is low during live streaming, you can directly use the power device to charge the phone through this interface.

⑥ Receiver phone interface

Connect the device name DareFly D602-LB displayed on the phone.

⑦ Transmitter charging contact point

1. When the receiver is inserted into an Android phone, the transmitter can be charged through this contact point. Note: Apple phones do not have this function;
2. Place the receiver in the charging compartment and charge the transmitter through this contact point;
3. Connect the receiver to the phone, insert a charging cable, and charge the phone while also using this contact point to charge the transmitter.

⑧ Charging contact point for charging compartment

The receiver is placed in the charging compartment, and the 5V power supply voltage of the charging compartment is transmitted from the charging contact to the receiver, which charges the transmitter through the charging contact of the receiver.

⑨ Charging compartment indicator light

The external power supply lights up the red light when charging the charging compartment, and the green light remains on when charging the transmitter.

⑩ Type-C interface of charging compartment

It can charge the charging compartment and the incoming transmitter.

Usage method

1. Click the power button of the microphone. If the indicator is green, it means that the microphone is powered on successfully.

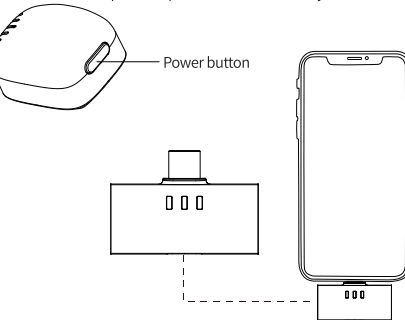

2. Insert the receiving port into the phone's interface.

Note: OPPO/VIVO/IQOO/Readme or some other brand phones need to go to the phone settings, search for "OTG" and turn on OTG to use. Some phones also need to set default recording devices and change them to external devices in the settings

3. After the middle indicator light of the receiver is successfully connected to USB, the light remains constant and flashes during recording. The two indicator lights on both sides are the indicator lights for the two transmitters. After the transmitter is successfully connected, the indicator light remains on.

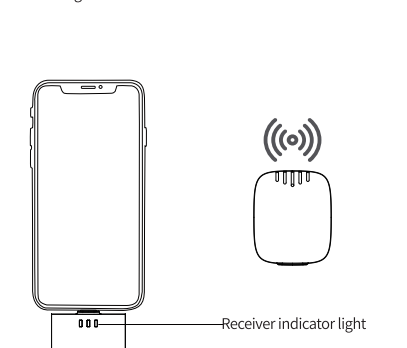

technical specifications

Wireless frequency range:2.40-2.48GHz
Transmission delay:<20ms
Audio Frequency Response:30HZ-18KHZ
Microphone sensitivity: -38dB±2dB
Signal-to-noise ratio: 65db
Sound pressure level: 115dB
Transmission distance: ≥20 meters (open environment)
Microphone directionality: omnidirectional
Charging box battery capacity: 500mAH (3.7V)
Transmitter battery capacity: 40mAH (3.7V)
Range: 4-6h, with a charging box, the range can reach about 25 hours
*The 50 meter transmission distance indicated on the package refers to the farthest distance measured in some environments
(This manual and product technical specifications are subject to update without prior notice)

Packing list

- | | |
|---------------------------------|--------------------------|
| 1. Microphone (transmitter) * 2 | 2. Receiver*1 |
| 3. Charging box (optional) *1 | 4. Collar clip * 2 |
| 5. Adsorption magnet *2 | 6. Charging cable*1 |
| 7. Windproof sponge*2 | 8. Instruction manual *1 |
| 9. Certificate*1 | |

After-sale warranty

User Info

Model	
Product number	
Purchase date	
Customer name	

Warranty records

Warranty date	Troubleandhandlingmethod	CompletionDate	Sign

Certificate	CHECKER	PASSED QC01 合格	This product has passed the inspection
	DATE		

FCC ID: 2BNKF-D602

FCC Caution:

This device complies with part 15 of the FCC Rules. Operation is subject to the following two conditions: (1) This device may not cause harmful interference, and (2) this device must accept any interference received, including interference that may cause undesired operation.

Any changes or modifications not expressly approved by the party responsible for compliance could void the user's authority to operate the equipment.

NOTE: This equipment has been tested and found to comply with the limits for a Class B digital device, pursuant to Part 15 of the FCC Rules. These limits are designed to provide reasonable protection against harmful interference in a residential installation. This equipment generates, uses and can radiate radio frequency energy and, if not installed and used in accordance with the instructions, may cause harmful interference to radio communications. However, there is no guarantee that interference will not occur in a particular installation. If this equipment does cause harmful interference to radio or television reception,

which can be determined by turning the equipment off and on, the user is encouraged to try to correct the interference by one or more of the following measures:

- Reorient or relocate the receiving antenna.
- Increase the separation between the equipment and receiver.
- Connect the equipment into an outlet on a circuit different from that to which the receiver is connected.
- Consult the dealer or an experienced radio/TV technician for help.

The device has been evaluated to meet general RF exposure requirement. The device can be used in portable exposure condition without restriction.