

User's Manual

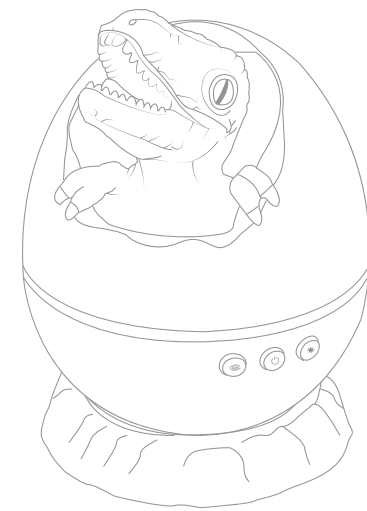

TYD-KLD-001



Attention

- ◆ The intensity of the stars and nebulae light is high, so please don't look at the light source directly.
- ◆ This light is not replaceable, when the light reaches the end of life, the entire lamp should be replaced.
- ◆ **Highlight Note:** The brightness of the stars (laser brightness) is greatly affected by the ambient temperature and use time, and the laser operating temperature is 10°-40C; When the ambient temperature is lower than 10°C, the laser cold start time is longer, and it is possible that the stars will not be seen when you first turn it on, but the stars will gradually return to normal after a few minutes of turning on; When the ambient temperature is hot, the laser projector will inevitably dim after working for a long time (the laser itself will heat up when working). At this time, please turn the lights off and release its heat (usually it takes more than 15 minutes to dissipate heat). Then restart the star projector to restore normal brightness.

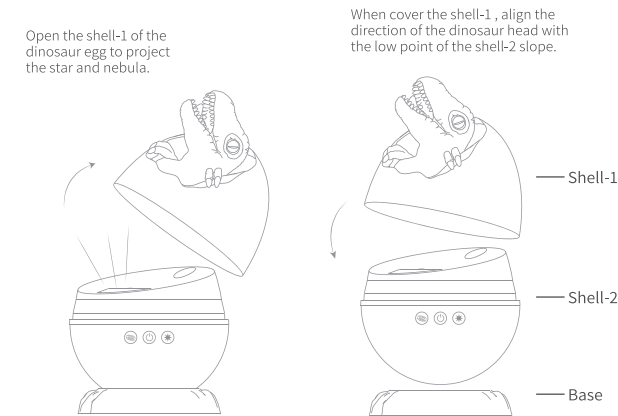

Host Key Operation Instructions

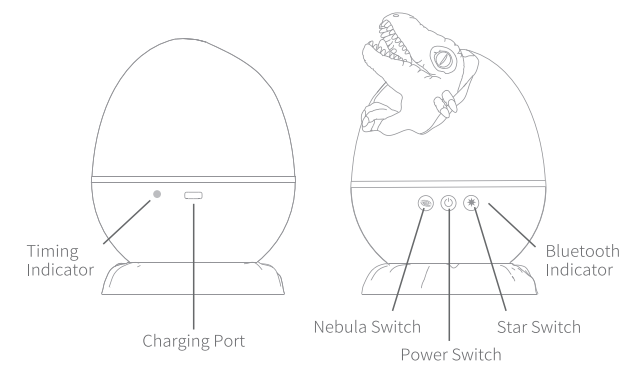

- Note:** The product needs to be connected to a power cord for use.
- ◆ **Power Switch:** Short press the power switch to turn on the equipment, and nebula and star light are turned on by default after turning on. Long press the button again after turning on to turn off.
 - ◆ **Nebula Switch:** Short press the nebula button, you can switch the color of the nebula, every time you press to switch a color, so the cycle; Long press to turn off the nebula function, short press to turn on the nebula function again.
 - ◆ **Star Switch:** Press the button to switch a star breathing rate every time. There are three modes of star breathing rate, namely "star breathing slow", "star breathing fast" and "star steady on". Long press the button to turn off the star function.

Material: ABS/PVC/TPE
 Laser Class : CLASS I
 Rated Voltage: 5V = 2A
 Control Mode: Remote control
 Remote Control Range: <5meters(Best distance)
 Product Size: 110*110*159mm
 Applicable Environment: Indoor Home(Better in a dark environment)
 Working Temperature: 10°-40°Celsius

Do not look directly at the laser light source!
 This is not a toy, children should not use it alone, please use it with an adult!



- ◆ **Bluetooth Indicator:** After the Bluetooth is turned on, the indicator light will be on (the indicator is blinking before the pairing, and the indicator will be steady after the pairing is successful), and the indicator light will be off after the Bluetooth is turned off.
- ◆ **Timing Indicator:** After pressing any timing button of the remote control, the timing indicator lights up, and the indicator lights out after closing the timing.

How does the phone connect to the product via Bluetooth?

Turn on the Bluetooth function of the product, and when the Bluetooth indicator flashes, it means that the Bluetooth function has been turned on and can be connected to the mobile phone at any time. The Bluetooth name of the product is "Dinosaur lamp", turn on the Bluetooth of the mobile phone and search for it. When "Dinosaur lamp" appears, you can select this option to pair the product. At the same time, the indicator changes from blinking to steady on.

Remote Control Instructions

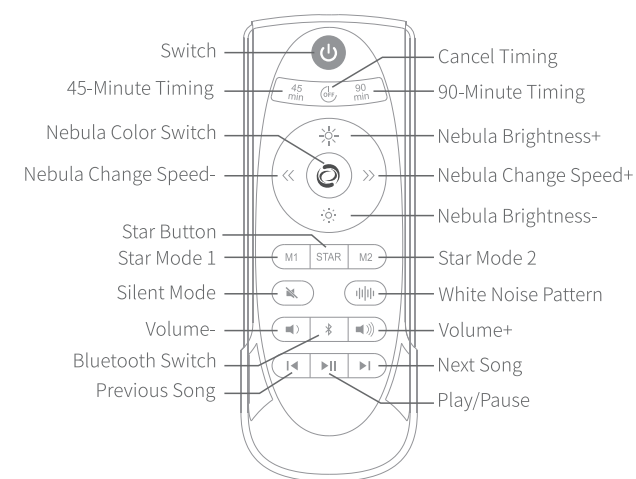

- ◆ **Switch:** press the turn on key to turn on the machine. After turning on the machine, the nebula and stars will be turned on by default. Press the button again to turn off the machine.
- ◆ **Cancel Timing:** Press this button to cancel timing.
- ◆ **45-Minute Timing:** After pressing this button, the product enters the 45-minute timing, and emits a prompt tone "drop" will be issued once, and the timing indicator lights up blue.
- ◆ **90-Minute Timing:** After pressing this button, the product will enter the 90-minute timing, and the prompt tone "drop" will be issued twice at the same time, and the timing indicator will light up red.
- ◆ **Nebula Color Switch:** Each time the key is pressed, the nebula switches a color, and then returns to the default after a cycle Color, long press the key to close the nebula, close the nebula after short press the key to reopen the nebula.
- ◆ **Nebula Brightness+:** There are 5 levels of nebula brightness, the default brightness is the middle range, and the brightness increases one step with each press.
- ◆ **Nebula Change Speed-:** The nebula change speed is divided into five gears, 0-1-2-3-4, 0 gear is static, 4 gear is the fastest change speed, the default gear is 2 gear, each press the nebula change speed reduces one gear until 0 gear.
- ◆ **Nebula Change Speed+:** Each time you press the nebula change speed, increase one step to 4.
- ◆ **Nebula Brightness-:** There are a total of 5 levels of nebula brightness, the default brightness is the middle range, and the brightness is reduced by one step each time you press.
- ◆ **Star Mode 1:** Star breathing rate slow mode.
- ◆ **Star Mode 2:** Star breathing rate fast mode.
- ◆ **Star Button:** The star is turned on by default when the star is turned on. When the star is breathing, press the "Star" button and the star will light up Degree pause at current brightness; Star brightness In the paused state short press the "Star" button, the star resume call Suction pattern; Long press the button to turn off the star, then short press the button to turn on the star.
- ◆ **Silent Mode:** When playing audio, press the key to enter the mute mode, and press the key again to cancel the mute mode.
- ◆ **White Noise Pattern:** Short press the button to automatically play white noise after powering on, and long press the button to turn off the white noise mode.
- ◆ **Volume-:** When playing audio, this button can reduce the volume.
- ◆ **Volume+:** When playing audio, this button can increase the volume. When the volume reaches the highest level, there will be a beep.
- ◆ **Bluetooth Switch:** Turn on Bluetooth by default when starting up the equipment, long press the Bluetooth Switch to turn off Bluetooth, short press the Bluetooth Switch to turn on Bluetooth.
- ◆ **Next Song:** When playing audio, this button can select the previous song.
- ◆ **Previous Song:** When playing audio, this button can select the next song.
- ◆ **Play/Pause:** When playing audio, press the key to pause the playback and press again to restart the playback.

FCC Caution:

This device complies with part 15 of the FCC Rules. Operation is subject to the following two conditions: (1) this device may not cause harmful interference, and (2) this device must accept any interference received, including interference that may cause undesired operation.

Any changes or modifications not expressly approved by the party responsible for compliance could void the user's authority to operate the equipment.

NOTE: This equipment has been tested and found to comply with the limits for a Class B digital device, pursuant to Part 15 of the FCC Rules. These limits are designed to provide reasonable protection against harmful interference in a residential installation. This equipment generates, uses and can radiate radio frequency energy and, if not installed and used in accordance with the instructions, may cause harmful interference to radio communications. However, there is no guarantee that interference will not occur in a particular installation.

If this equipment does cause harmful interference to radio or television reception, which can be determined by turning the equipment off and on, the user is encouraged to try to correct the interference by one or more of the following measures:

- Reorient or relocate the receiving antenna.
- Increase the separation between the equipment and receiver.
- Connect the equipment into an outlet on a circuit different from that to which the receiver is connected.
- Consult the dealer or an experienced radio/TV technician for help.

To maintain compliance with FCC's RF Exposure guidelines, This equipment should be installed and operated with minimum distance between 20cm the radiator your body:

Use only the supplied antenna.