

BUNACET

2040FT COB LED Strip Lights
English

Smart Lighting Comfort Your Home



PACKAGE INCLUDING

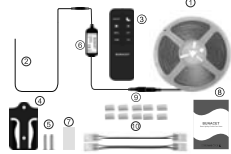

- ① 2040R COB LED Strip Lightsx 1
- ② 24V Power Adapterx 1
- ③ RF Remote Controlx 1
- ④ Remote Holderx 1
- ⑤ Holder Screwx 2
- ⑥ Signal Receiverx 1
- ⑦ Signal Receiver Tapex 1
- ⑧ User Manualx 1
- ⑨ Fixed Clipx 10
- ⑩ Two Ends Wire Connectorx 2

1

SPECIFICATION

Total Length: 2040R	Light Output (Lumen): 520LMM
LED Type: COB	Input Voltage: 105-240V AC
CRI: > 90	Waterproof Rating: IP20
Color: White	Frequency: 50/60 Hz
Strip Width: 8mm	Lifetime: 50,000+ Hours
Wattage: Max 24.06W	Controller Type: RF Remote Control
Working Voltage: DC 24V	Working Temperature: -4°F~104°F
Beam Angle: 180°	Battery of Remote: AAA*2 (Not Included)

KINDLY TIPS

- (1) No wiring lighting? As it affects heat dissipation & might cause danger.
- (2) Check that the light and parts are intact and energized before plugging the light.
- (3) Make sure that the power supply is disconnected before installation & the location where the light strip is pasted is clean and dry.
- (4) To ensure proper operation, use the voltage indicated on the package.
- (5) Do not use the light in the open air or in a humid environment.
- (6) Better not to put the controller near metal. It will affect the remote sensitivity.
- (7) If you need help with the use of the light, please feel free to contact us by email.
- (8) The light strip is does NOT include remote control batteries (AAA*2).

Manufacturer: Shenzhen Yatai Photolabor Co., Ltd.
Address: Room 201, Bldg. No. 11, Changhe Rd., Zhongge Community, Fucheng St., Longhua Dist., Shenzhen, China, 518110
Email: bunacet@163.com

2

RF REMOTE CONTROL

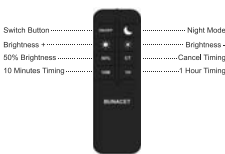

Carrier Frequency: 433.92 Mhz
Remote Control Distance: 4960 Feet (1500 Meters)

Remote Control Pairing & Unpairing

- (1) **PAIRING:** Within 5 seconds after the power supply is, press and hold on the Brightness + button until the light strip flashes, then the **PAIRING** completed.
- (2) **UNPAIRING:** Within 5 seconds after the power supply is, press and hold on the Brightness - button until the light strip flashes, the **UNPAIRING** completed.

This remote control and signal receiver in this led strip light kit have been paired. If you buy multiple sets and want to use only one remote to control them, you need to make additional settings. Refer to FAQ for specific steps.

3

COB LED STRIP LIGHT

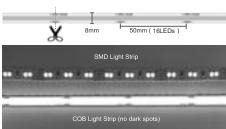

Upgraded version of high brightness LED light strip. Different from ordinary SMD strip, the COB led strip light has a more dense number of beads, a silicone protective shell on top of the beads, higher brightness and more uniform light, which can be used in study tool rooms and garages, wide living rooms and bedrooms, kitchens for making gourmet food, suitable for study and office, beautiful vanity walking stairs, display cabinet for model toys, etc.

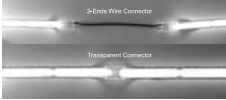

4

COB LED STRIP LIGHT



EASY TO INSTALL



When you receive the goods, please first spread the light strip, connect the power, check whether the whole strip is lit. If there are some light beads do not light or other parts (such as signal receiver, remote control) do not work, please contact us by email, we will send you a free replacement.

After checking, disconnect the power, clean up the location where you need to stick the led strip light, tear off the blue back of the strip, stick the strip on, then connect the controller and power supply, you can use the strip through the remote control.

5

2-PIN CONNECTOR

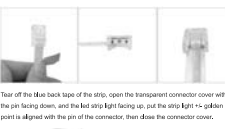

Tear off the blue back tape of the strip, open the transparent connector cover with the pin factory down, and the led strip factory up, put the area light + - gold face point is aligned with the pin of the connector, then close the connector cover.



6

FAQ (Frequently Asked Questions)

Question 1: What is the difference between the COB strip light and the ordinary LED strip? Why is it so much more expensive?

Answer 1: The most obvious difference is that this COB strip is up to 480 beads per meter, about four times more than ordinary LED strip, brighter. Moreover, the surface of the COB strip is covered with a layer of orange silicone shell, so that the light is more uniform and not blurry.

Question 2: The surface of the strip has a silicone shell, so is it waterproof? Can it be installed for outdoor use?

Answer 2: Not. The silicone shell on top of the COB strip light only covers the lamp beads and does not wrap the entire strip, so it does not reach the IP65 level for outdoor use, it is only IP20.

Question 3: If I buy multiple sets, can I use one remote to control all of them?

Answer 3: Yes, you just need to pair them. Within 5 seconds of connecting each set of lights to the power supply, please press and hold the brightness + button until the lights flash, at which point the controller completes the pairing.

Tips: We are a professional manufacturer of various LED lights, if you are a Business Customer and want to customize LED lights, welcome to contact us by email (Amazon or our after-sales email - step 2), we can set the remote control and mobile app program, modify the parameter specifications of the goods, match different accessories, design a unique color box with your brand logo according to your needs, looking forward to cooperating with you!

7

This device complies with part 15 of the FCC Rules. Operation is subject to the following two conditions:
(1) This device may not cause harmful interference, and (2) this device must accept any interference received, including interference that may cause undesired operation.

Any Changes or modifications not expressly approved by the party responsible for compliance could void the user's authority to operate the equipment.

Note: This equipment has been tested and found to comply with the limits for a Class B digital device, pursuant to part 15 of the FCC Rules. These limits are designed to provide reasonable protection against harmful interference in a residential installation. This equipment generates uses and can radiate radio frequency energy and, if not installed and used in accordance with the instructions, may cause harmful interference to radio communications. However, there is no guarantee that interference will not occur in a particular installation. If this equipment does cause harmful interference to radio or television reception, which can be determined by turning the equipment off and on, the user is encouraged to try to correct the interference by one or more of the following measures:
-Reorient or relocate the receiving antenna.
-Increase the separation between the equipment and receiver.
-Connect the equipment into an outlet on a circuit different from that to which the receiver is connected.
-Consult the dealer or an experienced radio/TV technician for help.

This device has been evaluated to meet general RF exposure requirement. The device can be used in portable exposure condition without restriction.