

Intelligent interactive integrated machine



User's Guide

Catalogue

Product overview	2
Main page renderings	3
Power supply mode	3
Preface and warning	3
Packing list	5
Size of product	6
Conditioning and	
Port description	7
Keys and touch instructions	8
Description of the battery	
And anti-skid device	9
Screen projection and	
Software download	10
Declaration of toxic and	
Harmful substances	10
Warranty card	11
Warranty instructions	12

Introduction

Thank you for choosing TD-LTE wireless data terminal!

Before starting the machine, please read this manual carefully to understand the use of the machine and precautions.

Warn

- ★ Only use the power adapter accessories provided by the original factory.
- ★ The gaps and openings on the machine are used for ventilation and heat dissipation. Do not block or cover these gaps and openings.
- ★ Do not use or store the machine in a dusty, wet and high-temperature environment.
- ★ When the machine fails, do not disassemble and repair it by yourself. You should contact the original factory or dealer to solve the problem.
- ★ Avoid trampling on the power line or power adapter, so as not to cause leakage and other dangers. If the power adapter wire has been used Damage, do not continue to use, otherwise the danger may occur.
- ★ Unplug the power cord during a thunderstorm or when not using the machine for a long time.
- ★ When using, please do not put the machine on the edge of the table or easy access to the child, to avoid the machine fall or harm to the child.
- ★ Do not squeeze the display screen hard during transportation, and do not touch the display screen with sharp tools or hard objects to avoid causing damage to the display screen.
- ★ Please use the dry soft cloth or the soft cloth slightly dipped in the flexible cleaner cleaning machine.
Do not use any kind of solvents, such as alcohol
Or gasoline, otherwise it may damage the surface treatment layer.
- ★ Be sure to let children understand the dangers of climbing the product, the product drop or dumping will cause serious life damage.
- ★ Do not place the product in an unstable or tilted position.
- ★ Be sure to timely arrange the cable connected to the product to avoid tripping, pulling or grabbing.



Suitable only for safe use in non-tropical climate

Product standards and technical requirements

GB 17625.1-2012; GB 4943.1-2011; GB/T 9254.1-2021

Note: If consumers use a power adapter to charge, they should purchase a power adapter that is certified by CCC and meets the requirements of the standard.

Packing list

After opening the package, please confirm the following package contents.



lifter



Mobile power base



Host display



Installation tool



Product installation
and use manual



Power adapter

Install



A 21.5-inch video
installation tutorial



A 27-inch video
installation tutorial

Scan the QR code above to watch the installation tutorial video

Product overview

DM88 motherboard, using eight-core high-performance processor, equipped with Android 12 system, strong computing power, smooth operation. Set 4G communication, intelligent voice control, intelligent fingerprint recognition and other functions in one, at the same time support wireless screen, HDMI IN video input, electronic whiteboard, new human-computer interaction software interface, is widely used in TD-LTE, wireless data terminal and other fields.



1. HD display

Support 1920 * 1080P video decoding and LVDS interface LCD display.

2. Audio interface

Support 2-channel MIC input, left and right dual channels support the maximum 8 Ω 15W speakers, support 4-segment 3.5mm headphone jack.

3. High degree of integration

SIM card holder, support for MIPI camera.

Main interface renderings

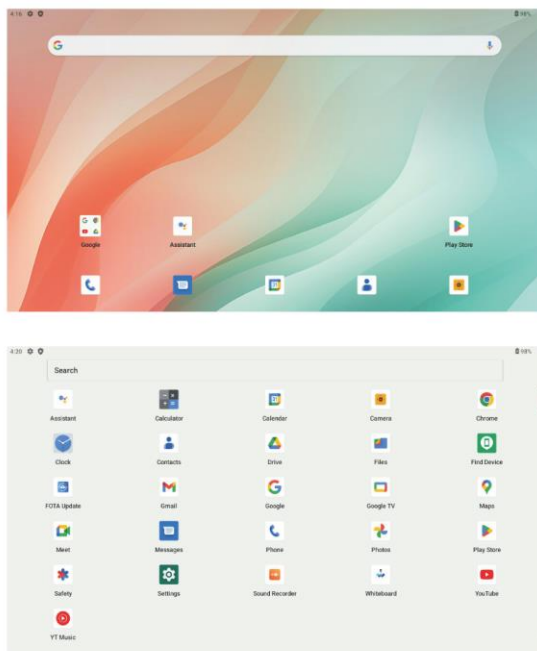

Power supply mode

The whole machine has a battery pack

DC IN With TO BMS is the channel, the battery pack from the From BMS socket to the motherboard power supply, DC12V-5A

The whole machine has no battery pack

Power the DC12V-5A from the DC IN socket

Product specification

System	CPU	MT6769
	RAM	4GB/8GB
	Internal storage	128 GB
	Operating system	Android 12
Specifications	Display screen	21.5 / 27 in
	Resolution ratio	1920*1080
	Touch screen	10 Point to the touch
	Screen ratio	16:9
	Wi-Fi	802.11 a/b/g/n/ac or 802.11 a/b/a/n/ac BT 5.0
	Network	WCDMA Band2/5 LTE band 2/4/5/12/66
Joggle	Headphone output	Stereo output
	Microphone input	Supports the external microphone input
	Type-c	Support for full function (except for the charging function)
	USB	USB Host
Else	VESA	100x100mm
	Key	Power Supply / Volume + / Volume-
	Gravity sensor	Support 90°
	Suona	4Ω*5W*2
	Microphone	Built-in dual microphone, support noise reduction, echo elimination
	Input voltage	19V/3.42A
	Built-in battery capacity	14.4V/7800mAh
	Storage temperature	-20°C—60°C
	Working temperature	0°C—45°C 10~90%RH

Product specification

For better viewing effect, the tilt can be adjusted (leaning forward - leaning back $-20^{\circ} \sim 20^{\circ}$).
Turn (left/right $-15^{\circ} \sim 15^{\circ}$), rotate (90° clockwise), lift (up and down 180mm).

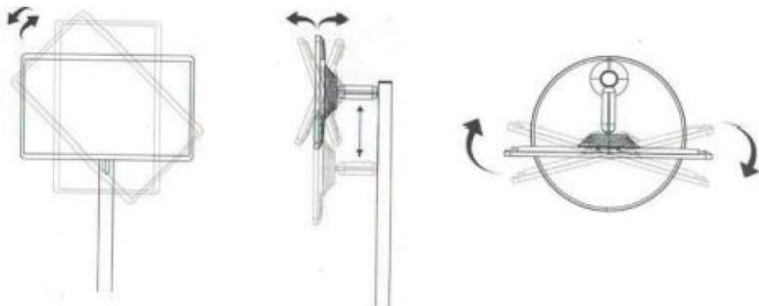

Port connection instructions

Rich interfaces, and support a variety of peripheral connections

DC IN: DC charging interface, used for charging and battery power guarantee.

SIM card slot: SIM card card hole, insert the SIM card can realize the call and traffic data Internet function.

Type-C: Connect Type-C dock, can connect U disk, mouse, etc.

USB: Use USB storage device or for mouse / keyboard receiver.

ON / OFF: Power key for switching machine.

Headphone Hole: 3.5mm headphones output stereo sound for connection to an external power amplifier or headset

Key instructions

Use the standard power adapter.

Push-button	Function
	When turned off: press for 2-3 seconds to power on When in the boot state: ① press for 2-3 seconds to enter the shutdown confirmation [shutdown / restart] ② short press to enter the screen state, short press again to release the screen
On	Press to light up / extinguish the screen

*When the adapter AC plug is inserted into the wall to power the bracket, move the product as little as possible to avoid pulling removal.

Or tear off the power cord to cause electricity leakage danger.



Step 1:

Start the power for the first time, press the button for 3 seconds, and the front light will light up

Step 2:

Press the button for 3 seconds to start the system

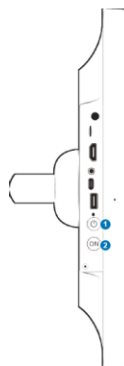

Touch function instructions

Using the INCELL full HD ten-point capacitive touch LCD screen.

To keep the screen clean, please ensure that it is clean.



Built-in battery instructions

Pay attention to:

While charging, use the product for about 6 hours, and after shutting off the product, charge for about 4 hours. After full charge, the battery life of the device is about 5 Hours +.

The service length of the product increases, and the battery life and battery life decrease in proportion.

In order to extend the service life of the battery, it is recommended to charge the battery after a period of use. After the battery is fully charged, unplug the charger, Do not keep the battery in a full state, and the battery

Instructions for use of anti-skid device

Anti-skid device is used for stationary use scenarios or ground with slope.

Installation method: remove the original screws in the corresponding position of the anti-skid device to be installed in the figure, put the PM4.0 * 16mm screws into the foot pad,



Projection screen

Wireless screen projection, support a variety of protocols: Apple AirPlay, Miracast, Android DLNA, Chromecast.

Android phone: Mobile phone and device are in the same network-> mobile phone enter the shortcut menu-> click "screen" -> select the name of the screen device-> device appears, the screen is successful.

Iphone: The phone and the device are in the same network-> iphone enter the shortcut menu-> click "screen mirror" -> select the name of the screen projection device-> iphone device appears screen, the screen projection is successful.

Windows: Computer and device are in the same network-> Windows Enter Settings- -> system-> screen-> Multiple display- -> Click "Connect to wireless display" -> Select the name of the screen projection device-> Device appears screen, screen projection successfully.

Mac: The computer and device are in the same network- -> Mac entry preferences- -> Display- -> Add Display- -> Select the Name of screen projection device- -> Device appears screen and screen projection is successful.

Audio and video push: The screen projection device and device are in the same network-> Screen projection device enters the video APP-> Select video-> Click "Screen projection icon" in the upper right corner of the video-> Select the name of the screen projection device-> Video screen appears in the device, and the screen projection is successful.

Projection screen

Overseas: The device enters "Google play store" -> Log in to the Google account-> Select the downloaded app-> install successfully.

Domestic: The device enters the "application market" -> Select the downloaded application-> install successfully.

Call Functions

At the dial keyboard, enter the tablet number and then click the dial key. If dialing an extension, you may click the dial pad icon in the bottom of the screen to open the interface and enter the number of the extension. You may also press and hold the 0 key to add a (+) sign when adding an international dialing prefix.

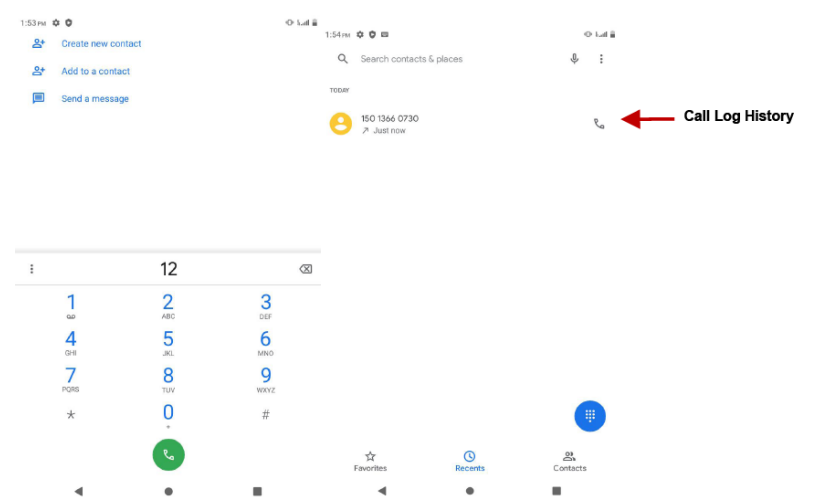

Call Logs

Every telephone number called and received will be saved in the tablet's call log. All numbers in the call log can be dialed directly by clicking the dial icon on the screen. When the number appears on the list, click it to view details. To clear the call logs, press the menu key and select delete. You may remove one or multiple calls.

Call Options

There are different options that can be used in the call log and dialing interface. You may press the menu key while in the dial interface and adjust call settings. In the call logs, you may press browse through contacts list or set default contact resources.

Notifications Bar

The notification bar is located on the top of the screen which contains useful and important information regarding your tablet and the applications that are installed. On the notification bar, several icons will

appear such as signal bar, battery indicator, data indicator, Bluetooth and Wi-Fi. You may slide the notification bar down with your finger to display any pending notifications or actions.

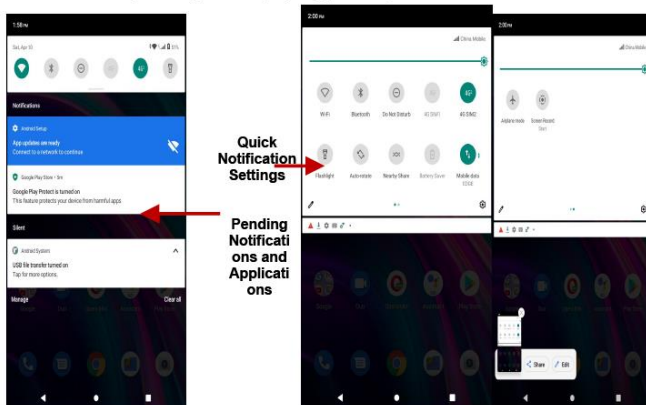

Notification Settings

The notification settings window provides shortcuts to different tablet settings for quick access. Click on

any of the shortcut notification icons to power on or off.

Note: To clear notifications, drag down the notification bar and click the clear notification icon on the upper right hand part of the screen (3 horizontal lines). The notification settings menu is located by dragging down the notification bar and is located on the upper right hand part of the screen next to the clear notification icon.

Contacts

Enter: Click on the applications menu and select contacts.

- The default display is the tablet contacts.
- The contacts are organized alphabetically by default.

After signing in to your Google account, Google contacts will be displayed in sync.

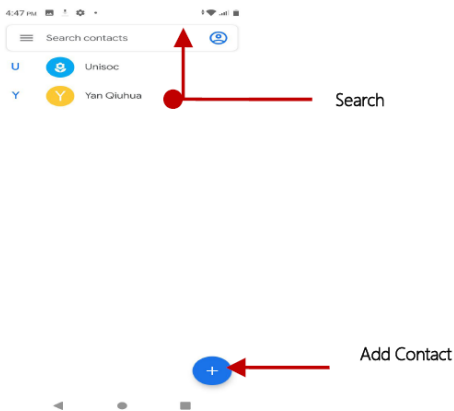

Click the Search icon to enter the contact search interface. Any numbers or letters associated with any of the contacts saved in the list will be shown in the search results.

Add New Contact

-

Contact information entry field

Delete Contact

- Click on the Contacts icon to enter the tablet book.
- Click the menu key to access the Contacts menu.
- Click on Delete Contact and scroll to select which contact(s) you wish to delete.

Note: You may also search for an individual contact in the tablet book. Once the contact is found click the contact name to enter the contact profile, press the menu key to bring up the contact menu and select delete to eliminate from the tablet book.

Messaging

You may use this function to exchange text messages and multimedia messages with your family and friends. The messages to and from the same contact or tablet number will be saved into a single conversation so you may see the entire message history conveniently.

Send an SMS

Application Menu » Messaging » New message (or shortcut icon)

- Click the contact icon to enter text message recipient
- Compose Text Message and click Send

Send an MMS

When creating message, the default message style is SMS.

- Click the attachment icon in the messaging interface.
- Click to add attachments and create an MMS message.

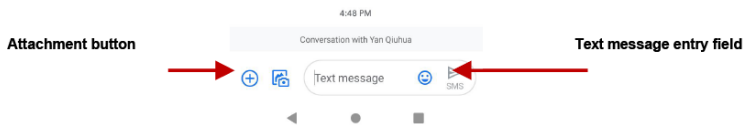
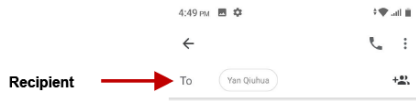

Bluetooth & Wi-Fi

Bluetooth is a short-range wireless communications technology that devices can use to exchange information and connect to different types of devices which include headsets and other devices.

Power on Bluetooth

Settings » Connected devices and select to power on Bluetooth.

- The Bluetooth icon will appear in the notification bar. The Bluetooth will then start to scan for all devices within its range and will display all available devices in a list.
- In Bluetooth settings, all the devices found will be displayed in a list.

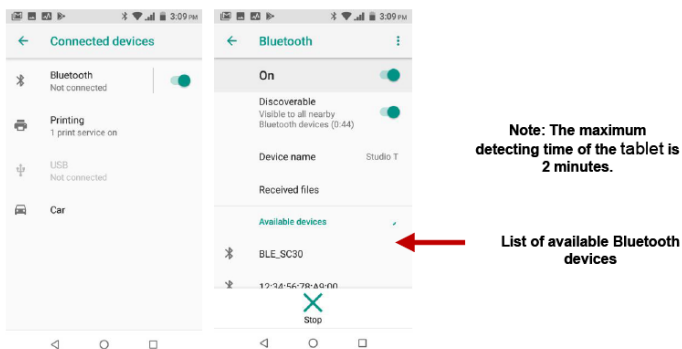

Power on Wi-Fi

Settings » Network & Internet and select ON to power on Wi-Fi

- Click on the desired Wi-Fi network to be connected.

Note: Unsecured networks can be connected to directly - secured networks require a password or credentials prior to connection.

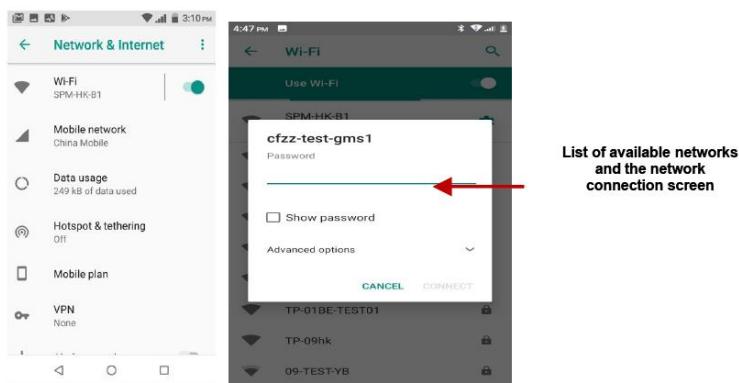

Gmail

Gmail is Google's free email service. To access the Gmail program, click the applications menu and click on the Gmail icon and either sign in with your existing account or create a new one.

Note: In order to keep accounts streamlined with Google services, your Gmail account user name and password will be used for some Google programs which include: Google Play Store, Google Drive, Google +, Google Photos, and Google Wallet.

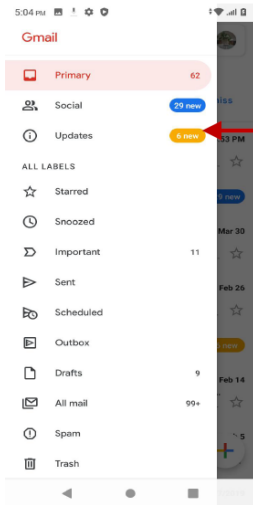

The Gmail inbox is separated by default in three different categories.

These categories include primary inbox, social inbox where all your Facebook, Twitter, and social media emails are separated to and your Promotions inbox where all your commercial emails are separated.

You may add or delete other categories in Gmail settings

Settings

Wireless & Networks



Wi-Fi

- **Settings » Wi-Fi** to power on. When on, the Wi-Fi will automatically search for available networks. Any unsecured network can be used directly and any secured network requires a password or credentials prior to connection.



Bluetooth

- Power on Bluetooth. Once on, Bluetooth will automatically scan for any nearby open devices.
- Click to connect device.



Data Usage

- Mobile and Wi-Fi Data Usage

More Wireless & Networks

- Tethering, Portable Hotspot, VPN, APN
- Airplane Mode

Note: When in flight mode, all network connections will turn off automatically.

Device



Audio Profiles

This option sets the tablet ring tone settings for receiving calls and notifications. Some of the settings include:

- Vibrate, volume, ring tones, ring tones notification, dial touchpad, and haptic feedback and tones



Display

- Brightness, Auto rotating screen, Wallpaper, Screen Timeout



Storage

- View the tablet memory usage



Battery

- General power usage



Apps

- Manage applications - Manage and delete installed applications
- Running Applications- Press the 'Force Stop' button to stop any of the applications listed and removes from the running apps list.

**Location**

- High Accuracy – Use GPS, Wi-Fi and Mobile Networks
- Battery Saving – Use Wi-Fi and Mobile Networks
- Device Only – Use GPS only to determine location

Note: GPS is dependent on tablet hardware.

**Security**

Set up basic screen locks: Use slide, pattern, PIN or password to lock the screen.

- Pattern: The first time there will be simple unlock instructions and examples. Click "next step" to continue the security pattern step
- PIN: Enter PIN number to unlock the screen
- Password: Use password to unlock the screen

You may stop the security feature at any time.

Set up SIM card PIN lock

- SIM card PIN (Personal Identification Number) is used to prevent unauthorized use of SIM card.

To change a blocked PIN code, you will need to unlock the SIM lock then go to the Change Password screen. The tablet will automatically prompt you enter the old PIN code and ask to enter a new PIN code twice. The tablet will then prompt you that the change was successful. If you enter the PIN incorrectly

three

times, the SIM and PIN codes will be automatically locked. You will need the PUK code to unlock the tablet which is available through your service provider. If you enter the PUK code incorrectly 10 times, the SIM card will be permanently locked. Please see your service provider for a new SIM card

- Password visible – Make the password visible when it's typed
- Use security credentials - Allow applications to visit security credentials or other credentials

**Language and Input**

- Language – Change the language of the tablet
-
- Custom Dictionary - Add or delete words to the custom dictionary

**Backup & Reset**

- Backup Data – Will back up all application data, WLAN passwords, and other settings to Google's servers
- Restore to Factory Settings - Clear all data stored

**Date & Time**

- Date and Time adjustment.
- Select Date Format - There are 3 kinds of formats you can choose from: Month-Day-Year, Day-Month-Year and Year-Month-Day, and Year-Month-Day which is the default setting



Schedule Power On & Off

- Schedule power on and off



Accessibility

- Power button ends call and auto rotate screen
- Speak Passwords and large text



Printing

- You may print files via Cloud Ready printers.
(Please check Google Cloud Print website for printer compatibility information)



Developer Options

If the tablet does not display Developer options press "build number" seven (7) times in the about tablet tab in settings.

- The developer option gives access to USB Debugging and other developer options



About Device

- Tablet information status and firmware updates

Storage

Connect the tablet with the USB cable provided. Once connected, a connection interface will appear. In the connection mode interface, select one of the available options to transfer files to your computer.

Electronic information products

Part name	Toxic and harmful substances or elements					
	lead (Pb)	mercury (Hg)	cadmium (Cd)	hexavalent chromium Cr6+	PBB (PBB)	PBDE (PBDE)
Appendix	X	O	O	O	O	O
Plastic shell	O	O	O	O	O	O
Metal structure parts	O	O	O	O	O	O
PCB motherboard	O	O	O	O	O	O
LCD display screen	O	O	O	O	O	O
Polymer lithium battery	O	O	O	O	O	O
Touch the screen	O	O	O	O	O	O
Suona	O	O	O	O	O	O
Pack	O	O	O	O	O	O

O : Indicates that the content of the toxic and harmful substance in all homogeneous materials of the component is within the limit requirements specified in GB / T26572-2011.

X : Indicates that the content of the toxic and harmful substance in at least one homogenized material of the component exceeds the limit requirements specified in GBT26572-2011.

Note:

1. The product is produced according to the environmental protection design and lead-free production process, which meets the EU RoHS requirements.
2. The toxic and harmful substances indicated by "" in the table are mainly due to the current technical level development restrictions. This product contains rechargeable lithium battery, which is strictly prohibited to dismantle, hit, squeeze or put into fire.
If severe inflation occurs, do not continue to use it. Do not keep it in a high-temperature environment.
3. Circuit board components: including printed circuit board and its parts, electronic components, solder joints, etc.;
4. Depending on the product model, the product you buy may not contain all of the above parts
The environmental protection service life of the product is 10 years, and the logo is shown in the figure

FCC Statement

This equipment has been tested and found to comply with the limits for a Class B digital device, pursuant to Part 15 of the FCC Rules. These limits are designed to provide reasonable protection against harmful interference in a residential installation. This equipment generates uses and can radiate radio frequency energy and, if not installed and used in accordance with the instructions, may cause harmful interference to radio communications. However, there is no guarantee that interference will not occur in a particular installation. If this equipment does cause harmful interference to radio or television reception, which can be determined by turning the equipment off and on, the user is encouraged to try to correct the interference by one or more of the following measures:

- Reorient or relocate the receiving antenna.
- Increase the separation between the equipment and receiver.
- Connect the equipment into an outlet on a circuit different from that to which the receiver is connected.
- Consult the dealer or an experienced radio/TV technician for help.

This device complies with part 15 of the FCC Rules. Operation is subject to the following two conditions: (1) This device may not cause harmful interference, and (2) this device must accept any interference received, including interference that may cause undesired operation.

Changes or modifications not expressly approved by the party responsible for compliance could void the user's authority to operate the equipment.

This equipment should be installed and operated with minimum distance 20cm between the radiator & your body.