

Kids GPS Smart Watch

User Manual

Items of insert in package and specifications

Items of insert in package:

Watch	1
USB Cable	1
Instruction	1
SIM Kits	1

Specifications:

Product:GPS smart watch
Charging Volt: 5V
Working Temperature: -20°C-60°C
Networks supported: 2G GSM, 3G WCDM and 4G TDD/FDD-LTE

Operation Manual

1. Get a Nano SIM card

1) Prepare for a Nano SIM card firstly and the phone card package should include internet flux and voice call. You can buy it from local telecom operators. Please inquiry presale customer service if you have any questions.
2)The SIM card must support 4G network with data streaming and airtime

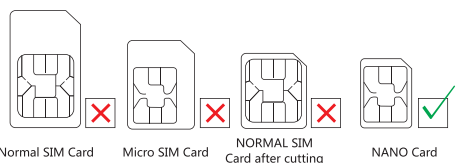

Operation Manual

2. How to install SIM card ?

1)Draw out SIM card tray , then chipset side face up and put into the tray.
2)Power on the watch till signal catching.

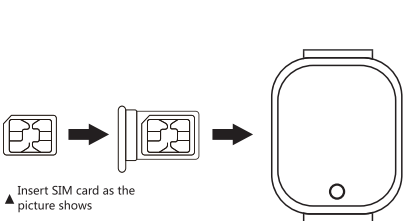

Operation Manual

3. Download the APP

1): Open your Wechat and scan the QR code below, download and install it.

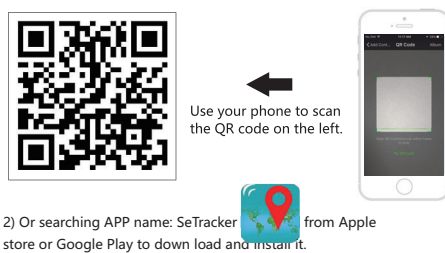

Operation Manual

4. Register

1): When the installation is completed, start to register your personal account.

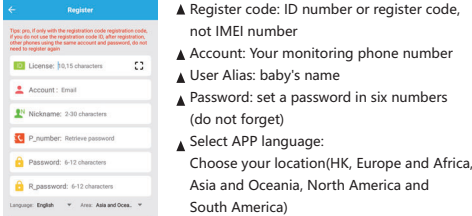

Operation Manual

5. Log in

After registration, try to log in.

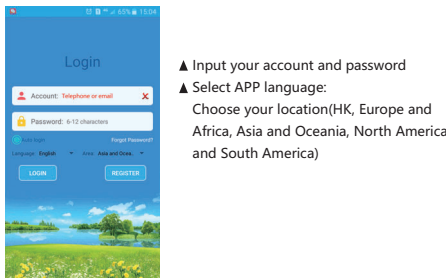

Operation Manual

6. Add device

Pls go to Me to find device list, and scan Reg code (in watch menu or stick on watch backside) to add your watch.

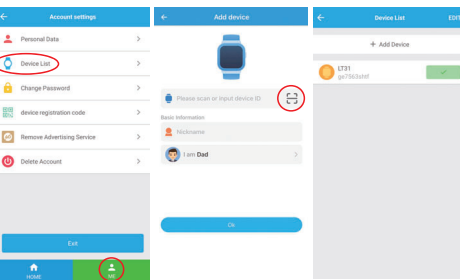

Operation Manual

7. Verify successful bundling with watch

Pls go to Find Watch to verify watch bundling well, it means watch and APP connection successfully.

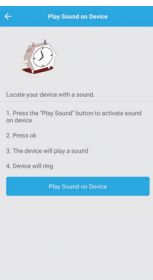

Operation Manual

8. Setting

1): Log in and find the setting, click the phone book or contacts and save the numbers you need. The same goes for the other functions.

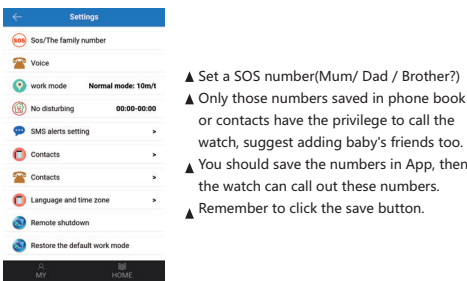

Operation Manual

9. Calling

A: To call the phone with watch. 1) Use your finger slide the screen left or right, find the surface of Phone book and click, it will show the numbers you saved before in APP(can set 10 numbers), click the number you need to call out. 2) Keep pressing the Button 1 for few seconds as the picture show below. It will call the three SOS number one by one if the first one or the next one didn't answer and will not end until the second round. 3) Press the Button 1 to cancel the call.
B: To call with the phone. Just dial the number you save in APP when the watch receives a calling, press the Button 2 to answer, press the Button 1 to cancel.

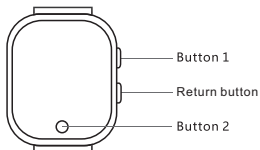

Operation Manual

10. Location

1): Turn on the watch and make sure that it got signal.
2): Open the map on APP, click the location then it will shows your baby's real-time position.

Notes: If the watch is indoors, it usually position yourself via LBS or WIFI, and the deviation is inevitable, which depends on the distance between the watch and Base Station and the environment as well. If you're in outside, it switch to GPS automatically, the range of deviation will also narrowed, but will still become unstable while the watch moved, which is normal, you can't regard it as quality issues, won't be listed in After-sale service.

FAQ Center

Few points need to be confirmed about the SIM card

- 1: Has GPRS Network
- 2: Has 4G data streaming
- 3: Can show callers ID

FAQ:

1. Even if you inserted the SIM card, it still got no signal

1): Check the card's type and size to see if it's inserted properly. First shut down the watch, second, insert the card, then reboot.

2. When you save the numbers it indicates that the device can not connect the network.

1): Is there any signal after inserting the card, please check, and can the watch rings when receiving a phone call.
2): Check whether the watch is on or not.(before using the APP, the watch must be on)

FAQ Center

3): Make sure that the SIM card has the data package and make sure you have paid the phone charge and the SIM card is available to call.
4): Check whether the watch ID match the ID on the tags or not.
5): If still not working, please send pw,123456,ts# to the number that inserted in watch, then your phone will receive a message from your watch, please send the message and the rear cover of the watch to your local dealer, they will solve this problem as soon as possible.
3. When you call the watch, it reminds you the number you have dialed is busy, please try again later.

1): Is there any signal after inserting the card, please check.
2): Please check you have saved phone numbers on your APP.
3): Check If you have turn on the DO NOT DISTURB in App and set a time, if yes, please switch to OFF.

FAQ Center

4. The time can not update automatically.

When you manage inserting the card(must have data), the watch will update the time automatically, which might take few minuets. If not, please send pw,123456,ntpservers,121.43.19.219,8089# via your phone to the watch, once your phone got answer, reboot the watch.

5. The positioning function is not working.

1): Go outside and try again.
2): Once the watch goes to SLEEP MODE, it will switch to SAVE POWER MODE, which means the function of uploading data is OFF, at this time, you can refresh the positioning and shake the watch to wake it up.

6. Neither charge nor boot

The battery enter into a self-protection mode, do as the following step by step:
1): Try another USB Cable to see if the original one was damaged.

FAQ Center

2): Press the POWER key for 50 seconds, then recharge, it will indicate recharging on the watch after 1 minutes, at this time you can reboot.
3): If still not working, the watch has a recovery time, after two days, it has no power and then recharge it ,it should be work.

7. No voice on watch or phone.

Check the volume + - while calling. If the watch switch to max: still no voice, the speaker must damaged, it need be repaired.

8. The watch can receive any call.

Apply to your local operator for a function of showing callers ID.

9. When use the watch to call, it indicates that can not connect

Check the GSM signal, it shows on the screen. If not, maybe your SIM card has loosened, try to reload again.

FAQ Center

10. How to remove PIN lock screen after install SIM card.

Please set smartphone to remove, Setting→Security&Privacy→Set SIM lock, then turn off "Lock SIM card" as per below picture.

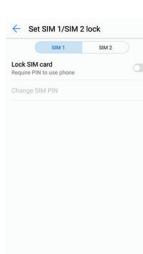
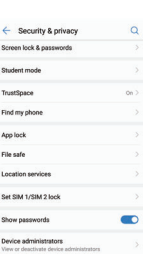

Size: 70x62mm 折页印刷

FCC Caution:

This device complies with part 15 of the FCC Rules. Operation is subject to the following two conditions:

(1) This device may not cause harmful interference, and (2) this device must accept any interference received, including interference that may cause undesired operation.

Any changes or modifications not expressly approved by the party responsible for compliance could void the user's authority to operate the equipment.

NOTE: This equipment has been tested and found to comply with the limits for a Class B digital device, pursuant to Part 15 of the FCC Rules. These limits are designed to provide reasonable protection against harmful interference in a residential installation. This equipment generates, uses and can radiate radio frequency energy and, if not installed and used in accordance with the instructions, may cause harmful interference to radio communications. However, there is no guarantee that interference will not occur in a particular installation.

If this equipment does cause harmful interference to radio or television reception, which can be determined by turning the equipment off and on, the user is encouraged to try to correct the interference by one or more of the following measures:

- Reorient or relocate the receiving antenna.
- Increase the separation between the equipment and receiver.
- Connect the equipment into an outlet on a circuit different from that to which the receiver is connected.
- Consult the dealer or an experienced radio/TV technician for help.

The device has been evaluated to meet general RF exposure requirement. The device can be used in portable exposure condition without restriction.

Specific Absorption Rate (SAR) information:

This device meets the government's requirements for exposure to radio waves. The guidelines are based on standards that were developed by independent scientific organizations through periodic and thorough evaluation of scientific studies. The standards include a substantial safety margin designed to assure the safety of all persons regardless of age or health. FCC RF Exposure Information and Statement the SAR limit of USA (FCC) is 1.6 W/kg averaged over one gram of tissue. Device types: This device has also been tested against this SAR limit.

This device was tested for typical body-worn operations with the back of the This device kept 0mm from the body. To maintain compliance with FCC RF exposure requirements, use accessories that maintain an 0mm separation distance between the user's body and the back of This device. The use of belt clips, holsters and similar accessories should not contain metallic components in its assembly. The use of accessories that do not satisfy these requirements may not comply with FCC RF exposure requirements, and should be avoided.