

DOOR SENDOR

INSTRUCTION



Product Configuration



Front

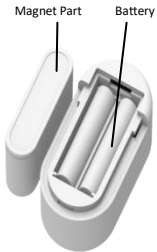

Back

Main Function:

Detect open/close status of the door/window

Specifications

Battery: AAA 1.5Vx2

Standby Current: $\leq 50\mu\text{A}$

Protocol: IEEE 802.11b/g/n

Wireless Range: 50m

Operating Temperature: -10°C -- 40°C (14°F -- 104°F)

Operating Humidity: 20%--85%

Storage Temperature: -10°C -- 60°C (14°F -- 140°F)

Storage Humidity: 0%--90%

Wireless Type: 2.4GHz

Standby Time: 4-6 months

Size: Magnet Part: 50x15x18

Device PART: 70x36x19



TuyaSmart



Google Home



Amazon Alexa

Download App

1. Android Smart Phone:download “Tuya Smart” from GooglePlay
2. IOS iphone:download “Tuya Smart” from App Store



Run App

- 1.Run “Tuya Smart” from your smartphone
- 2.Register and login

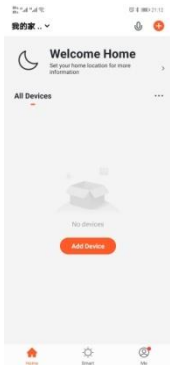

Door Sensor

Select Device Type, select “Security&Sensor” in the list to add the “Door Sensor” device

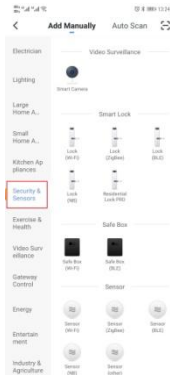

Network Configuration

There are two methods to bind door sensor to App. One is Smart Wifi Mode and the other is AP Mode

1. Smart Wifi Mode:

Press and hold: "WiFi Coding/RESET Button" for 6 seconds, the indicator will blink rapidly. The device is in Smart Wi-Fi Mode.



2.AP Mode

Select AP Mode at upper right corner on the App.

Press and hold: "WiFi Coding/RESET Button"for

6 seconds again,the indicator will blink slowly,and the

device is in AP mode.After entering your WiFi password

and connect your phone to door sensors WiFi hotspot

then press "Connect Now".

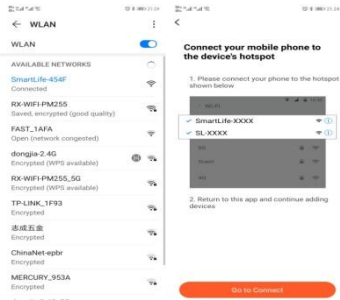

3. Connecting:

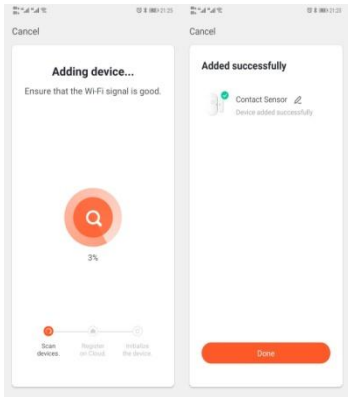

Finished

Operation instruction

Open the door magnetic alarm:open the dooralarm-close the door alarm-mobile phone notice bar prompt.

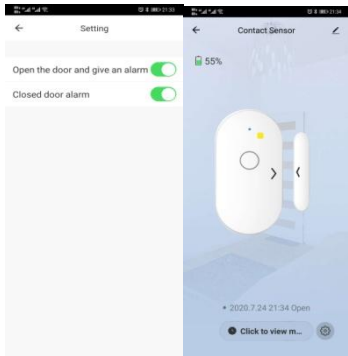

Alarm notification:

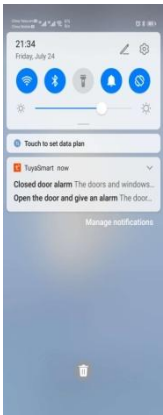

Customize Scenes

You can associate two devices to create your own scene.

1. Click+in the upper right corner to select the menu in the red box

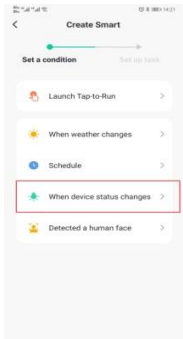
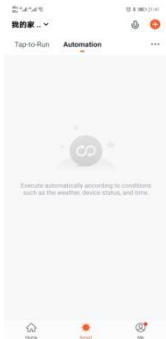

2. Magnetically separate the door and associate the camera with motion detection on.

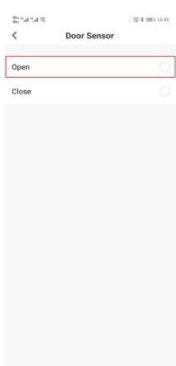
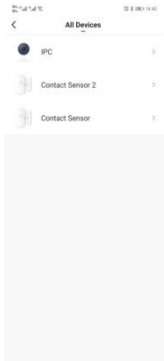

3. Click the menu in the red box

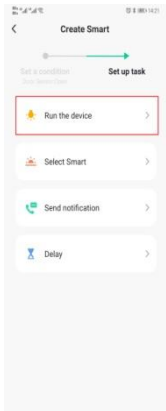

4. Click Save

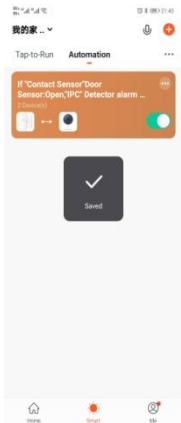
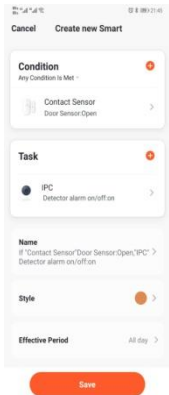

Association successful

5. When the door is magnetically separated, the associated camera movement detection is turned on.



Tips:

1. Please make sure connect 2.4GHz wifi

Network as the sensor do not support 5GHz wifi

2. The connect position for sensor and magnetic

FCC Warning:

This equipment has been tested and found to comply with the limits for a Class B digital device, pursuant to part 15 of the FCC Rules. These limits are designed to provide reasonable protection against harmful interference in a residential installation. This equipment generates, uses and can radiate radio frequency energy and, if not installed and used in accordance with the instructions, may cause harmful interference to radio communications. However, there is no guarantee that interference will not occur in a particular installation. If this equipment does cause harmful interference to radio or television reception, which can be determined by turning the equipment off and on, the user is encouraged to try to correct the interference by one or more of the following measures:

- Reorient or relocate the receiving antenna.
- Increase the separation between the equipment and receiver.
- Connect the equipment into an outlet on a circuit different from that to which the receiver is connected.
- Consult the dealer or an experienced radio/TV technician for help.

Caution: Any changes or modifications to this device not explicitly approved by manufacturer could void your authority to operate this equipment.

This device complies with part 15 of the FCC Rules. Operation is subject to the following two conditions:

(1) This device may not cause harmful interference, and (2) this device must accept any interference received, including interference that may cause undesired operation.

This equipment complies with FCC radiation exposure limits set forth for an uncontrolled environment. This equipment should be installed and operated with minimum distance 20cm between the radiator and your body.