

User's Manual

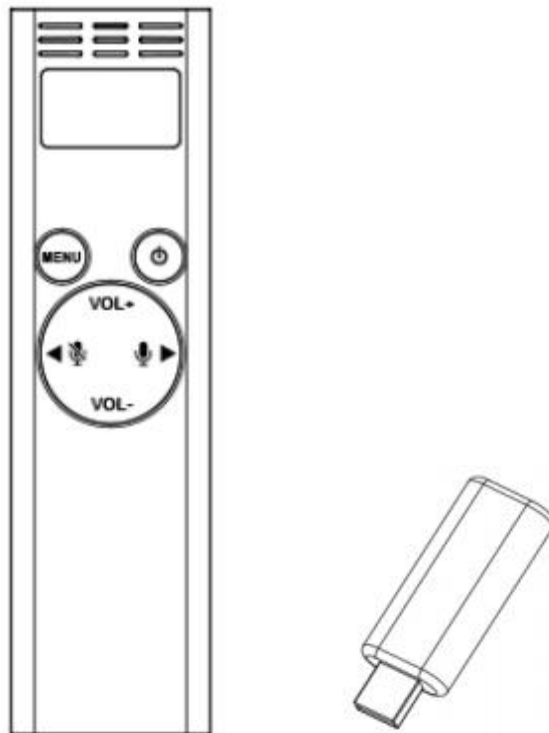

Wireless Microphone CH-30T & CH-30R

✓Note:

- All the pictures in this manual are for reference only, subject to our available products.

Contents

| | |
|--------------------------|----|
| Contents..... | 2 |
| Introduction..... | 3 |
| Notice..... | 3 |
| Introduction..... | 5 |
| Danger..... | 5 |
| Warning..... | 5 |
| Packing List..... | 6 |
| Installation..... | 7 |
| Microphone Receiver..... | 7 |
| Microphone Pairing..... | 7 |
| Microphone Function..... | 8 |
| Microphone Setting..... | 9 |
| Troubleshooting..... | 11 |
| Appendix..... | 12 |

Introduction

Thank you for purchasing this speaker and wireless microphone.

Please read the user manual carefully to ensure proper use before operating the devices.

keep the user manual in a fixed place for future reference.

- CH-30T(Microphone) electric equipment specification:

Input: DC 5V  1A 

Notice

< FCC Product >

changes or modifications not expressly approved by the party responsible for compliance could void the user's authority to operate the equipment.

This device complies with Part 15 of the FCC Rules. Operation is subject to the following two conditions:

- (1) this device may not cause harmful interference, and
- (2) this device must accept any interference received, including interference that may cause undesired operation.



Introduction

Notice

< FCC-Class B Product >

Note: This equipment has been tested and found to comply with the limits for a Class B digital device, pursuant to Part 15 of the FCC Rules. These limits are designed to provide reasonable protection against harmful interference in a residential installation. This equipment generates, uses, and can radiate radio frequency energy, and if not installed and used in accordance with the instructions, may cause harmful interference to radio communications. However, there is no guarantee that interference will not occur in a particular installation. If this equipment does cause harmful interference to radio or television reception, which can be determined by turning the equipment off and on, the user is encouraged to try to correct the interference by one or more of the following measures:

- Reorient or relocate the receiving antenna.
- Increase the separation between the equipment and receiver.
- Connect the equipment into an outlet on a circuit different from that to which the receiver is connected.
- Consult the dealer or an experienced radio/TV technician for help.

Notice

< FCC Certification >

This device complies with Part 15 of the FCC Rules. Operation is subject to the following two conditions: (1) this device may not cause harmful interference, and (2) this device must accept any interference received, including interference that may cause undesired operation.

changes or modifications not expressly approved by the party responsible for compliance could void the user's authority to operate the equipment.

Introduction

Danger

1. Don't modify product in any way. Otherwise, it will cause a fire, electric shock, serious personal injuries or product damaged. Only distributor or service center can do product internal checking, maintaining and repairing.
2. Please far away from lammable or explosive gases when use the product. Otherwise, it will result in explosion.
3. If any form of liquid or object into the product, please don't use the product. Please contact distributor or service center, and don't continue to use this product. otherwise, it will cause a fire or electric shock.
4. Operation this product with wethand against. Otherwise, it will cause electric shock.
5. Don't use this product in the light.

Warning

1. For safety reasons, please keep the product or accessories out of the reach of the reach of small children or animals against accidents such as:
 - Swallow product and accessories. If it happens, please go to see a doctor immediately.
 - Some parts of product will result in personal injuries.
2. Do not place this product under high temperature environment, high or low temperatire enviroment may cause negatively affect for internal parts, even result iin fire.
Such as: microwave oven, oven, radiator, inside or upside of refrigerator, it may cause the product overheating even explosion.

Packing List

Components

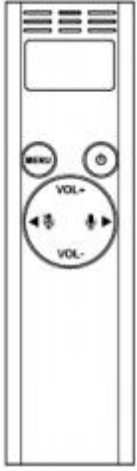

Microphone



Dongle
(receiver)



Sling

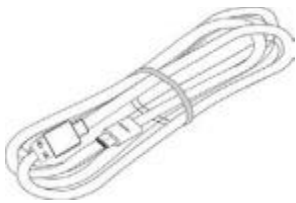

Type-C charging cable

Installation

Microphone Receiver

Plug in the receiver to USB-A slot.

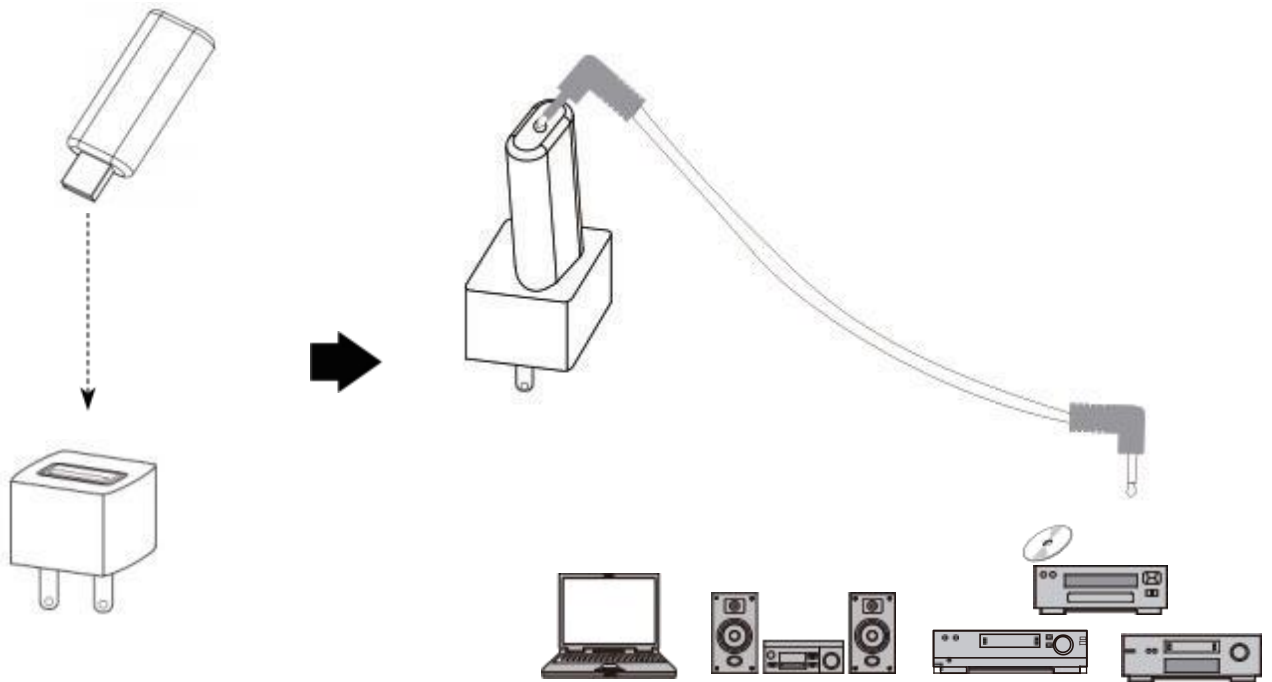

Microphone Pairing

The auto-pairing mechanism activates within a 3-meter range, after pressing the power button with 3 seconds.

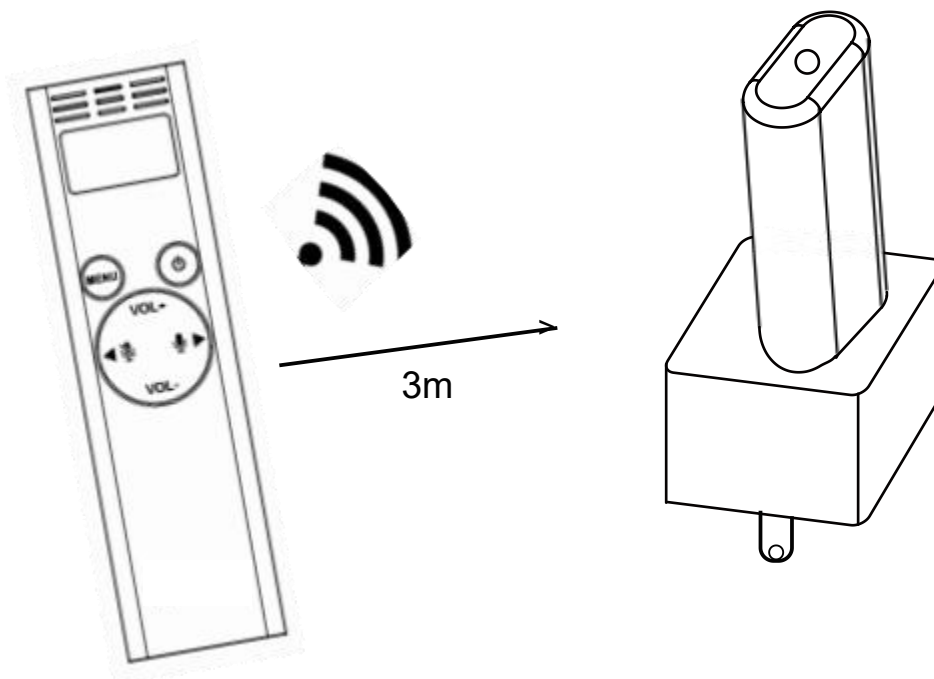

Microphone Function

Microphone

<Front>

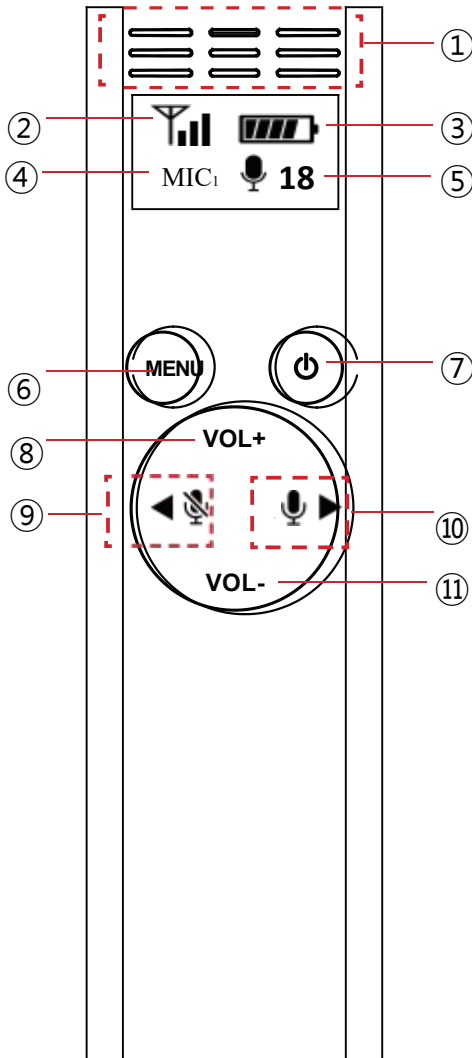

<Side>

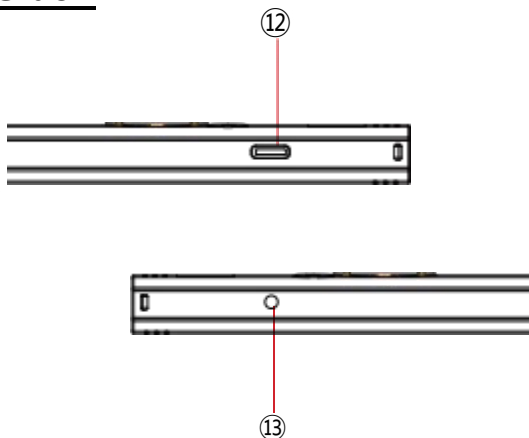

- ① **Microphone**
Built-in condenser capsule.
- ② **Signal intensity**
Display the signal intensity.
- ③ **Battery indicator**
Display the battery lifetime.
- ④ **Microphone channel**
Display No1. Or No. 2 microphone
- ⑤ **Volume**
Display the volume value.
- ⑥ **Menu button**
Press menu button with 3 sec to advanced function.
- ⑦ **Power button**
Press and hold the power button for 3 seconds to turn the device on or off
- ⑧ **VOL+ (▲)**
 - Increase the microphone volume.
 - After press menu button, select the advanced function.
- ⑨ **Mute on (<)**
 - Mute on the microphone sound.
 - After press menu button, adjust the advanced functional level
- ⑩ **Mute off (》)**
 - Mute off the microphone sound.
 - After press menu button, adjust the advanced functional level
- ⑪ **VOL- (▽)**
 - Decrease the microphone volume.
 - After press menu button, select the advanced function
- ⑫ **Type-C slot**
Type-C slot for charger
- ⑬ **3.5mm audio slot**
For lavalier or headset microphone.

Microphone Function

Microphone Setting

Press "Menu" button for 3 seconds, it can set more advanced function as below:

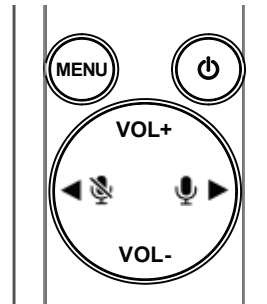
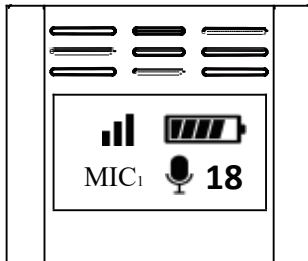

- Auto Gain Control (AGC):

Press "MENU" button within 3 second, for AGC function.

Value: On / Off

Default: Off



- LKID (Lock ID):

Press " » " button to select item, and press " ▲ ." or " ▼ " to change data.

Value: On / Off

Default: Off



- Signal intensity:

Press " » " button to select item, and press " ▲ ." or " ▼ " for change the intensity.

Value: 1~8

Default: 6.



- Channel select (CHN 24G / CHN ALL):

Press " » " button to select item, and press " ▲ ." or " ▼ " for setting data "CHN 24G" for 8 channel. "CHN ALL" for 10 channel.

Value: CHN 24G / CHN ALL

Default: CHN 24G.



Microphone Function

- Microphone channel:

Press " » " button to select item, and press

▲ "." or " ▾ " for setting channel.

Value: MIC 1 / MIC 2.



- Version:

Press " » " button to select item, and it will show the firmware information

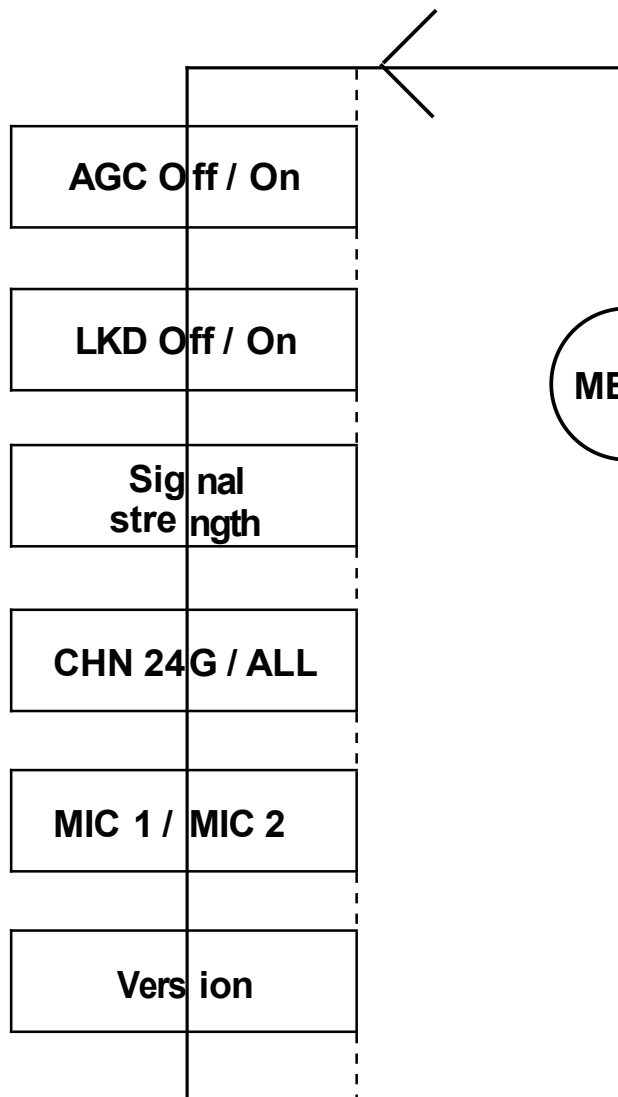
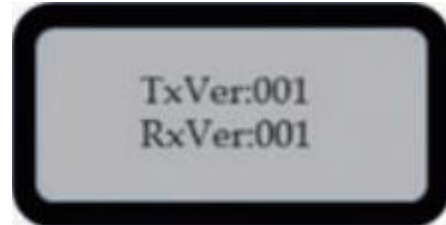

- Press "MENU" button within 3 second to enter setting function.

- Press " ♦ " or " » " button to select item.

- Press " ▲ ." or " ▾ " button to modify data.

- After setting, it can press power button back to status display.

NOTE:

- It will turnoff auto after 5 minutes, when without any matching
- After matching, it will turnoff auto after 1 hour without any input.

Troubleshooting

Q: Press the power button and go through the pairing process but the microphone is still no voice.

- A: (1) Please ensure the pairing distance within 3 meters.
(2) Please ensure the microphone is power on or off model.
(3) Please ensure the connection status from output to microphone.

Q: Low wireless microphone voice.

A: You can press the "VOL + / VOL- " button to adjust the microphone volume directly.

Q: No voice when using wireless microphone.

A: Please ensure the "Mute on" button off mode.
If yes, Please press the "Mute off" button to change this mode.

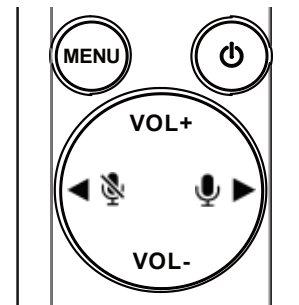

Q: Is it proper to use wireless microphone and charging at once.

A: The wireless microphone is working avoid charging.

Q: The wireless microphone can't complete the pairing process.

- A: (1) Please ensure the pairing distance within 3 meters without any shelter to output.
(2) Please make sure the wireless microphone is on mode.

Q: What is the battery life of the wireless microphone?

A: When the battery is fully depleted, it requires at least 2 hours to fully charge. Once fully charged, the battery can provide a minimum of 10 hours of continuous use.

Appendix

Technical specifications

Microphone (transmitter)

| | |
|-----------------------|-----------------|
| Dimensions (W×H×D) | 120mmX35mmX12mm |
| Net Weight | 40g |
| Operating temperature | 0~70 ℃ |
| Battery | 650mAh |

Wireless Dongle (Receiver)

| | |
|-----------------------|----------------|
| Dimensions (W×H×D) | 70mmX25mmX12mm |
| Net Weight | 14g |
| Operating temperature | 0~70 ℃ |

