

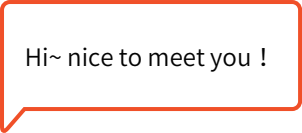

I'm  
the manual



Hi~ nice to meet you !

We will be good partners in the future.Let's meet your OneXPlayer X1 first.

This is what i m look like

This is a front photo

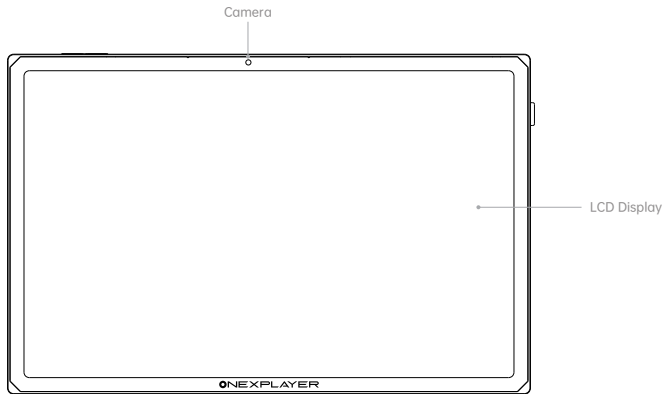

This is the back of my brevity

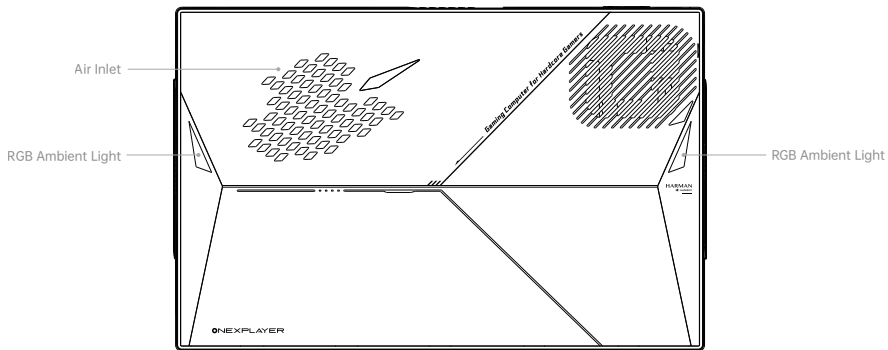

## Ports at the top and bottom of device

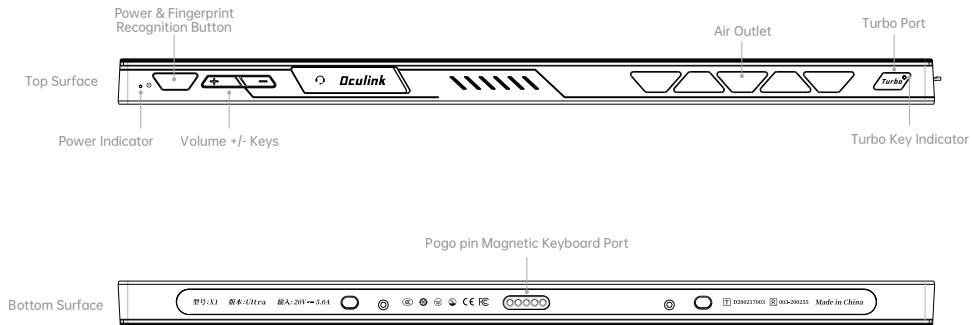

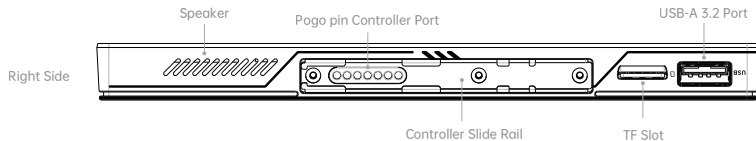
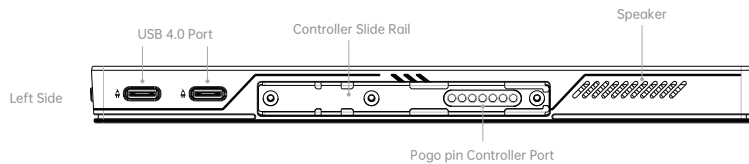

This is all I look like, come on and boot me on to check

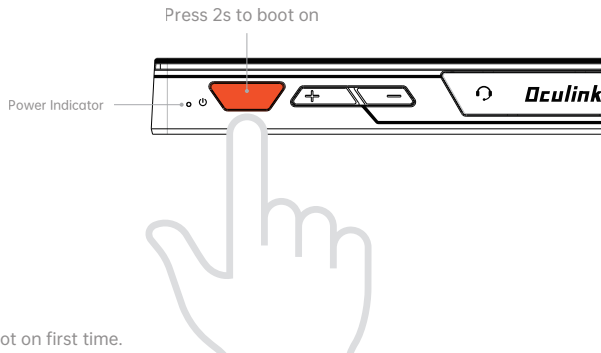

OneXPlayer X1 preinstall Windows 11 license os  
you need to finish the device setting when it boot on first time.

·Since the windows system will be updated continuously, the actual UI shall be subject to the real object.

## Let's start the system setting

### STEP 1

- ① chose the language you need and click the “yes” button.  
(note: if you want to change the language you can enter setting to download)



### STEP 2

- ② chose the location of yours click “yes” to continue

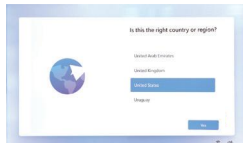



### STEP 3

③ chose the keyboard layout click “yes” to continue.



### STEP 4

④ chose to add more keyboard layout or skip to continue.



### STEP 5

⑤ connect to internet service and click next.

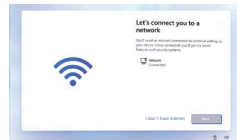

## STEP 6

⑥select "Continue with limited setup" in the lower left corner.



## STEP 7

⑦please review the license agreement carefully and click accept.



## STEP 8

⑧type the account ID you want and click "next" .



## STEP 9

⑨Create account password (system power-on password and management password) according to your needs, if you don't need to set it, please click "Next" in the lower right corner.

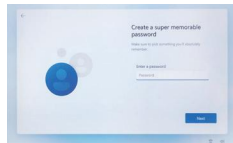

## STEP 10

⑩set privacy settings according to your needs.  
please read it carefully and set it up. Then click accept.

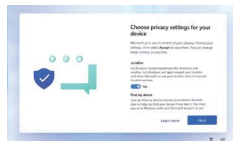

## STEP 11

⑪wait for few mins to enter Windows desktop.

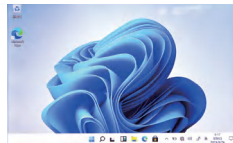

First boot on! Happy!

now let's connect the internet



1. click this icon as you see “  ”.

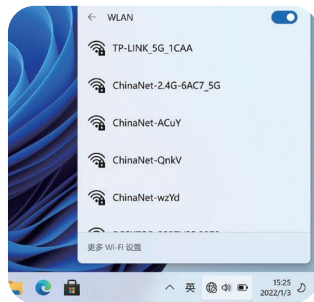

2. chose the Wi-Fi and connect to use it.

Indicator light will tell you the status of device



Blue  
Device boot on



Indicator light is breathing  
Device is in sleep mode.



Purple  
Device boot on under charging



Orange  
Device be charging under shut down

Windows os install the games you like

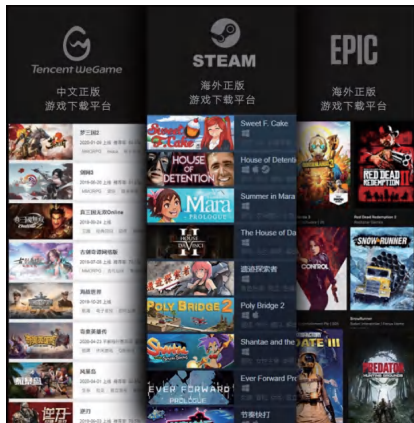

Click to [Turbo], enjoy more powerful performance

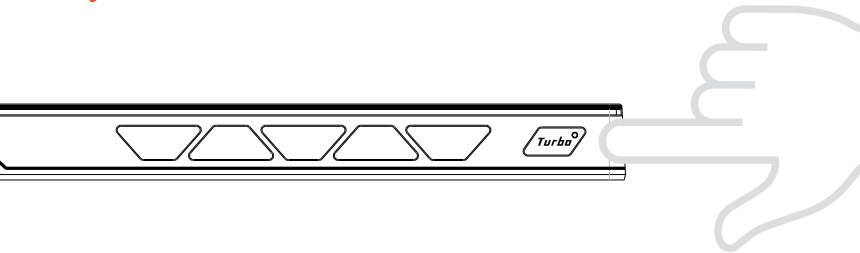



Click Turbo key to switch TDP, support hot switch

default TDP is 15W, click Turbo to switch to 28W( Turbo led in orange )

The function described on this page is the original function of the button. When the Onexplayer Player Center APP(OneXConsole) is started, this button function is to disable/enable the "OneXConsole" setting interface.

## OS Quick restore function

Device support quick restore function. click[turbo] to restore system by steps:

- 1  [Power Button] Press and hold for 2 seconds to power on
- 2 When the power indicator light is on, click the  [Turbo] key to enter the system restore boot interface.
- 3 Method 1. When an external keyboard is connected, select "UEFI OS (SSD)" by using the up and down keys.  
Method 2. When connecting the handle of the machine, please press and hold the  [Keyboard] button on the handle for 1.5 seconds to enter the keyboard and mouse mode, and select "UEFI OS (SSD)" through the cross key operation.



- 4 Method 1. When connecting an external keyboard, press the Enter key to enter the system one-key restore interface.

Method 2. When connecting the controller to the machine, please press and hold the  [start] key of the controller (the keyboard and mouse mode is equivalent to the Enter key) to enter the system one-key restore interface.

- 5 Select "Start" to start the restore (touch support)

· Please keep the charger connect,or make sure device battery 60% more,function not available when battery low.

Let me stay with you as long as i can

- **Precautions for use:**

Please do not use it near damp, dusty and strong magnetic field to avoid internal faults

Please do not use it in thunderstorm weather to avoid lightning damage.

Avoid falling and collision to avoid damaging the display screen and internal circuits fault of motherboard.

Please do not use it in high temperature environment to avoid damaging the internal motherboard

In order to protect your hearing, please do not use high volume for a long time.



## The battery something you need to know



- **battery safe info:**

Don't remove or exchange the battery by yourself. it may damage battery or make dangerous. if you need to exchange battery please contact onexplayer support. and dispose of batteries in accordance with local regulations

Please don't disassemble device when it under warranty.

Please charge device by original charger and cable,

Do not use third-party chargers to avoid danger.

Official service contact us when you need



- You can contact us by

- 1、Vist [www.onexplayerstore.com](http://www.onexplayerstore.com) and click service
- 2、Call us: 400-829-9293
- 3、Email us: [support@onexplayerstore.com](mailto:support@onexplayerstore.com)





The meaning of this symbol is: only suitable for safe use in non tropical climate conditions.

## Cautions

Replacing batteries with the wrong model poses a risk of explosion  
Be sure to dispose of used batteries according to the instructions



Scan the QR code and view the electronic document manual

- **Note:**

The key functions marked in this manual are the default functions set when the machine leaves the factory. If the relevant functions are changed subsequently due to software upgrade or other reasons, please refer to the real object. The functions of the operating system or any application software pre installed on the machine can be separated from the functions of the machine itself, and the functions of any pre installed software cannot be interpreted as the functions of the machine itself.

website: <http://www.onexplayer.com/manual/X1/>



- **This device complies with part 15 of the FCC Rules. Operation is subject to the following two conditions:**

(1) This device may not cause harmful interference, and

(2) this device must accept any interference received, including interference that may cause undesired operation.

FCC warning:

This device complies with part 15 of the FCC Rules. Operation is subject to the following two conditions: (1) This device may not cause harmful interference, and (2) this device must accept any interference received, including interference that may cause undesired operation.

Any Changes or modifications not expressly approved by the party responsible for compliance could void the user's authority to operate the equipment.

- Note: This equipment has been tested and found to comply with the limits for a Class B digital device, pursuant to part 15 of the FCC Rules. These limits are designed to provide reasonable protection against harmful interference in a residential installation. This equipment generates uses and can radiate radio frequency energy and, if not installed and used in accordance with the instructions, may cause harmful interference to radio communications. However, there is no guarantee that interference will not occur in a particular installation. If this equipment does cause harmful interference to radio or television reception, which can be determined by turning the equipment off and on, the user is encouraged to try to correct the interference by one or more of the following measures:
  - Reorient or relocate the receiving antenna.
  - Increase the separation between the equipment and receiver.
  - Connect the equipment into an outlet on a circuit different from that to which the receiver is connected.
  - Consult the dealer or an experienced radio/TV technician for help.

The Tablet ONE XPLAYER has been tested for body-worn Specific Absorption Rate (SAR) compliance. The FCC has established detailed SAR requirements and has established that these requirements. RF Exposure Information The radio module has been evaluated under FCC Bulletin C95.1 and IEEE 1528 and found to be compliant to RF Exposure from radio frequency devices. This model meets the applicable government requirements for exposure to radio frequency waves. The highest reported SAR level for usage near the body (0mm) is 1.574 W/kg,



Don't throw me away

if you meet problem when you use device  
contact us for tech support:)

---

Service phone:400-829-9293

Official web:www.onexplayer.com

Onexplayerstore:www.onexplayerstore.com

Note:The accessories and software contained in the manual maybe  
different from the order. Please take the physical object as the standard

版本:X1



OnexPlayer壹号掌机  
微信订阅号



official account