

SK58 | label printer

User Manual

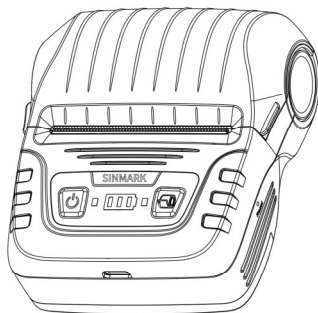

Table of contents

Preface

About this manual-----	I
Related manual information-----	I
Notes and Disclaimers-----	I
Safety instructions-----	II

One Including accessories-----	1
--------------------------------	---

Two Print part name-----	2
--------------------------	---

Three Preparation before use

3.1 Charging batteries-----	3
-----------------------------	---

3.2 Paper loading-----	4
------------------------	---

Four Basic functions

4.1 Power on-----	5
-------------------	---

4.2 Shut down-----	5
--------------------	---

4.3 paper feed-----	5
---------------------	---

4.4 Set print density-----	5
----------------------------	---

4.5 Set print quality-----	5
----------------------------	---

4.6 Print self-test page-----	6
-------------------------------	---

Five Indicator light status description----	7
---	---

Six Communication

6.1 Wired communication-----	8
------------------------------	---

6.2 Wireless communication-----	8
---------------------------------	---

Seven Repair and maintenance

7.1 Routine maintenance of printer---	9
---------------------------------------	---

7.2 Use and storage of printing paper---	9
--	---

Eight Troubleshooting-----	10
----------------------------	----

Nine Printer parameter table-----	11-14
-----------------------------------	-------

Preface



About this manual

Thank you for purchasing our SK58 label printer^①

This manual can help you learn to use this product simply. Please read this manual before use and keep it properly so that everyone who uses this product can read it.

International practice

To facilitate access to information, this manual uses the following symbols (icons) and conventions:

-  **Warn** This symbol indicates a warning that improper use may cause property damage.
-  **Notice** This symbol indicates caution. Improper use may cause personal injury or damage to items.
-  **Remark** This mark indicates remarks. The listed information will allow you to better use the product or extend the use of the project.

Related manual information

The following manuals provide detailed information on various technical issues:

1. "SK58 Product Specification" provides a detailed description of the hardware/physical/technical parameters of this product.
2. "SK58 Development Manual" provides detailed description of product development.

Precautions

As we strive to improve and upgrade the functionality and performance of all products, our company reserves the right to change the software and hardware specifications in these manuals with necessary prior notice.

Note^① From here on out in this manual "label printer" is referred to simply as "printer"

- If you find any errors or omissions in the information in these manuals, please report it to us or your dealer, for which we are deeply grateful.
- The contents of the manual attached to this product may not be reproduced, disseminated, stored in a retrieval system, or translated into other languages in any form or form without the prior written permission of our company.

Statement

This type of product is a Class A product. In a living environment, this product may cause radio interference. In this case, the user may be required to take effective measures against the interference.

Safety instructions

Please observe the following precautions when using the printer:

- ⚠ Notice Do not disassemble the printer by yourself, please read this manual carefully before use.
- ⚠ Warn In the event of a malfunction, please turn off the power immediately. When you find smoke or a strange smell coming from the printer or charger, please unplug the charger immediately and be careful to avoid burns.
- ⚠ Warn Please do not use the printer near flammable materials such as gas stations and fuel warehouses.
- ⚠ Warn When charging, be sure to place the printer and charger in a ventilated place with a temperature of -5°C to 50°C, and be sure to use the charger provided by the manufacturer. Using an unapproved charger may cause danger and also violates the manufacturer's regulations. stipulated warranty terms.
- ⚠ Notice When the printer is printing, please do not open the paper compartment cover, otherwise unpredictable conditions may occur and the printer may be damaged.
- ⚠ Notice After printing, the print head is still at a high temperature. Please do not touch it to avoid burns.
- ⚠ Notice Please do not use solvents. For example: wipe the printer casing with benzene, thinner or alcohol. Please do not use corrosive chemicals and detergents to contact the printer. Only use a clean soft cloth to gently wipe the printer.
- ⚠ Notice Please use our company's original or approved printing paper, otherwise it may lead to poor printing quality or even damage to the printer core.



The illustrations and text shown in this manual may be inconsistent with the actual

1. Including accessories

Standard accessories

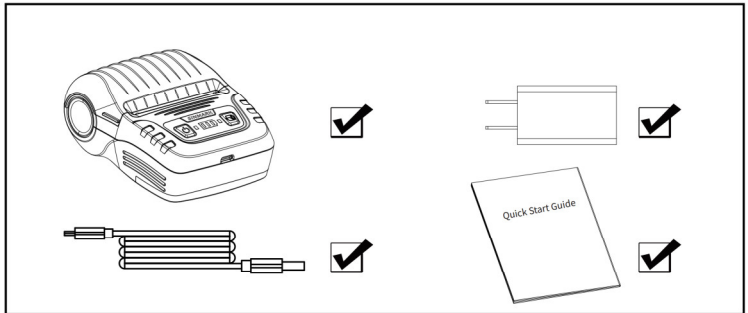

Optional accessories

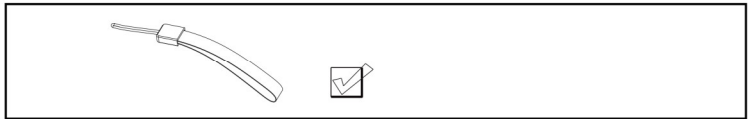

2. Print part name

Key parts list

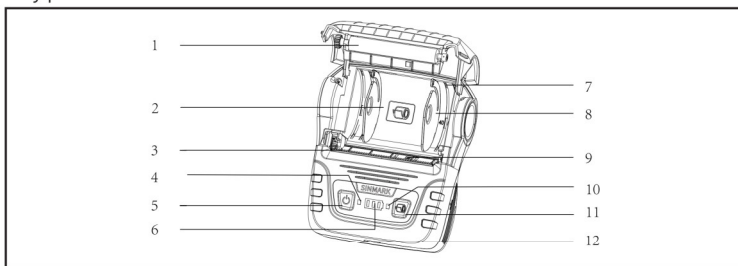

- | | | |
|------------------------|-------------------------|---------------------------|
| 1. Printing roller | 5. Power on button | 9. Paper detection sensor |
| 2. Paper warehouse | 6. Power indicator | 10. Abnormal indicator |
| 3. Tearing knife | 7. Paper stop card slot | 11. Feed button |
| 4. Bluetooth indicator | 8. Cardboard stopper | 12. USB interface |

3. Preparation before use

Precautions:

- ① Comes standard with 18650 (3.7V 2000mAh battery), removable.
USB-Type-C charging & communication interface (input 5V=1A)
- ② Please fully charge the battery before using it for the first time. When using the printer after long-term storage, it also needs to be fully charged to keep the battery in optimal condition.

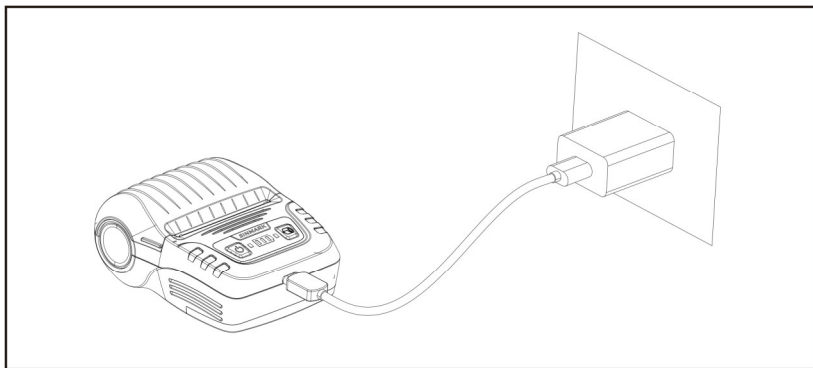

3. Preparation before use

① Open the paper compartment upwards



② Put the cardboard into the paper bin according to the roll paper specifications

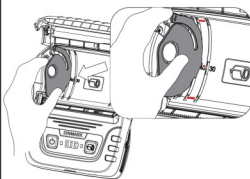

③ Place the roll paper into the paper bin, making sure the heat-sensitive side of the paper is facing downwards.

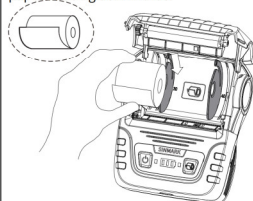

④ Close paper bin



⑤ Scan the QR code to download SINMARK APP



IOS/Android

⑥ Turn on Bluetooth, search for the device in the APP and connect it, and start printing.

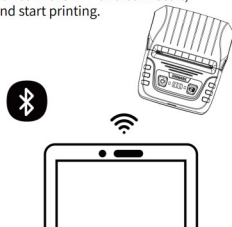

4. Basic functions

1. Power on: Press and hold the power button for 3 seconds, the printer will power on.
2. Shut down: When the printer is on, press and hold the power button for 2 seconds to shut down the printer.
3. Short press the paper feed button to feed the paper 20mm and stop when it encounters the label seal.
Press and hold the paper feed button to feed the paper 50mm and stop when it encounters the label seal.
4. Short-press the paper feed button 3 times continuously to increase the printing density (Darkness) by 1 level. When it exceeds the maximum 5 levels, it returns to 1 level.
5. Press the paper feed button 5 times continuously to increase the print quality by 1 level. When it exceeds the maximum level 3, it will return to level 1.

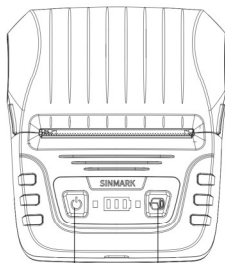

power button

Paper feed button

4. Basic functions

6. Print the self-test page

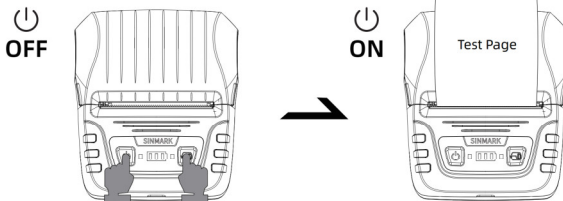

When the printer is turned off, press and hold the power button and paper feed button at the same time for 3 seconds. The printer will turn on and print a self-test page.

5. Indicator light status description

Detailed explanation of indicator lights

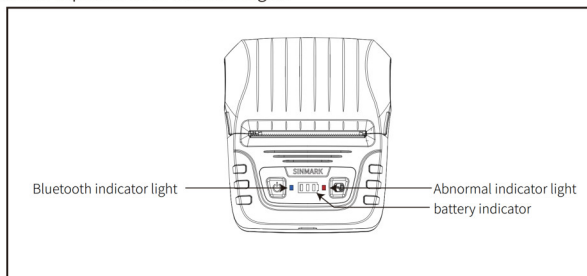

- | | | | |
|------------------------------------|--|---|--|
| <p>· Battery indicator</p> | <p>When the battery is normal, the battery indicator light displays white.
When the battery indicator light on the left keeps flashing, the printer will shut down after 10 seconds. Please charge it as soon as possible.</p> | <p>· Bluetooth indicator light</p> | <p>Blue: Bluetooth connection is normal.
Off: Bluetooth is not connected.</p> |
| <p>· Charging indicator</p> | <p>When the printer starts charging, the battery indicator light will flash from left to right, and will stop flashing after charging is completed.</p> | <p>· Abnormal indicator light</p> | <p>Red: 1. paper out of state.
2. The print head is overheated.
Off: normal state.</p> |

6. Communication

1. Wired communication

The printer is equipped with a USB2.0 communication interface (some models can be equipped with an optional RS232 interface), which can conduct wired communication with the host device equipped with a USB interface.

2. Wireless communication

The printer is equipped with a Bluetooth Class2 communication interface (Bluetooth2.0/4.2), which can communicate wirelessly with devices equipped with a Bluetooth interface. The Bluetooth name and address can be obtained by printing the self-test page.

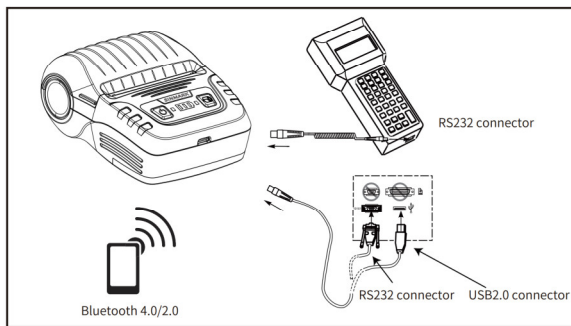

7. Repair and maintenance

1. Routine maintenance of printer

- ① Cleaning of the outside of the printer and the paper bin: Please use a wrung-out damp cloth to gently wipe the printer surface and the inside of the paper bin. Note that the wet cloth must be completely wrung out.
- ② Cleaning of the detection sensor: The detection sensor must be cleaned regularly. The cleaning method is as follows:

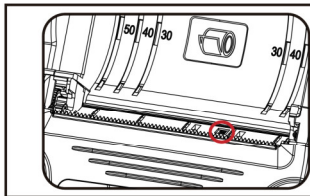

Use absorbent cotton dipped in absolute alcohol to gently wipe the part of the printer core indicated by the thick circle in the picture on the left until it is clean.

2. Use and storage of printing paper

- ① Please avoid storing newly purchased printing paper in places exposed to direct sunlight or high temperatures. Please do not tear open the wrapping paper when storing.
- ② Please store the printed documents at room temperature (around 20°C) and away from light. This can effectively extend the storage time of the documents.
- ③ If user documents need to be stored for a long time, please choose long-lasting thermal printing paper.

8. Troubleshooting

Anomalies	Abnormal	Solution	Refer to page number
Abnormal indicator light is on	Out of paper status	Load printing paper	4
	Paper bin cover turn on	Close the paper compartment cover	4
	Print head overheat	Wait for the print head to cool before printing	-
Print out blank page	Printing paper installed backwards	Printing paper direction change installation	-
Blurred printing	The print head has foreign body	Clean the print head	-
	Printer paper poor color development	Set higher blackness or change printing paper	-
Print receipts in weeks or The handwriting is blurred for several months	Printer paper poor quality	Choose printing paper with a longer shelf life	-
	Environment Temperature is too high	Please store away from light and at room temperature (20°C)	-
Printer automatically shuts down	Battery exhausted	Please charge now	3

9. Printer parameter table

Print parameters	Printing method	Line thermal printing
	Maximum print speed	50mm/s
	Resolution	203dpi
	Point distance	0.125mm
	Effective printing width	48mm
Print media	Type	Thermal receipt paper, thermal sticker paper
	Width	bill: 58mm Stickers: 50mm、40mm、30mm
	Paper thickness	0.05-0.18mm
	Paper roll outer diameter	No greater than40mm
	Paper loading method	Clamshell style paper loading, easy to load paper
	Paper ejection method	Paper ejects from top; thermal side faces out
Print content	Paper cutting method	Plastic paper tearing knife, manual tearing
	English Fonts	Height: 16, 20, 24, 28
	Chinese font	Height: 16, 20, 24, 28
	Encoding	ASCII; GBK (GB18030double byte) ; Unicode
	Print characters	Chinese, Chinese characters, numbers, various symbols
	Rotate printing	Support (0 degrees, 90 degrees, 180 degrees, 270 degrees)
	One-dimensional barcode	EAN-8; EAN-13; ITF; UPC-A; UPC-E; Codebar; Code93; Code39; Code128

9. Printer parameter table

	QR code	QRCode、PDF417、Data Matrix、Grid Matrix
	Bitmap	Black and white monochrome bitmap (straight line, curve, table, picture)
Physical properties	Dimensions	101.8mm*86.7mm*48mm
	Bare metal weight	188g(Battery included, paper roll not included)
	Packing box size	123.5mm*106.5mm*52.5mm
	Total weight (including packaging)	255g
	Full box size	535mm*344mm*182mm
	Quantity	36 units
	Full box weight	9.8kg
	Interactive interface	Operation input
Message output		Status indicator light, power indicator light
Wired communication		USB-Type-C
Wireless communication		Bluetooth 2.0+4.2Dual mode bluetooth
Tag detection		Reflective label detection, no virtual cutting seam, label seam $\geq 2\text{mm}$

9. Printer parameter table

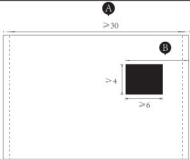
	Abnormal detection	Paper shortage prompt; cover opening detection; low battery prompt; overheating prompt										
	Black mark detection	<p>Middle black mark detection Black mark on printing surface location reference</p>  <table border="1" data-bbox="822 481 964 604"> <thead> <tr> <th>A</th> <th>B</th> </tr> </thead> <tbody> <tr> <td>30mm</td> <td>9.5mm</td> </tr> <tr> <td>40mm</td> <td>14.5mm</td> </tr> <tr> <td>50mm</td> <td>19.5mm</td> </tr> <tr> <td>58mm</td> <td>22mm</td> </tr> </tbody> </table>	A	B	30mm	9.5mm	40mm	14.5mm	50mm	19.5mm	58mm	22mm
A	B											
30mm	9.5mm											
40mm	14.5mm											
50mm	19.5mm											
58mm	22mm											
	Programming instructions	ESC/POS CPCL										
Power supply	Battery capacity	3.7V 2000mAh lithium ion										
	Battery removal method	Removable										
	Data cable	USB-Type-C data cable										
Environmental parameters	Operating temperature	0~50degrees celsius										
	Storage temperature	-20~60degrees celsius										
	Operating humidity	35%~85%No condensation										
	Storage humidity	10%~90%No condensation										
	Print life	50Km(12.5% printing density) / 100 million pulses										
	Battery Life	300 charge and discharge cycles >60% battery										

9. Printer parameter table

Reliability	Printing length on one charge	About 100m (12.5% printing density)
	Certification	CCC
Other	Printer parameter settings	Use App settings
	Charging time	4 hours
	Standby time	60 hours

FCC Statement:

This equipment has been tested and found to comply with the limits for a Class B digital device, pursuant to part 15 of the FCC Rules. These limits are designed to provide reasonable protection against harmful interference in a residential installation. This equipment generates, uses and can radiate radio frequency energy and, if not installed and used in accordance with the instructions, may cause harmful interference to radio communications.

However, there is no guarantee that interference will not occur in a particular installation. If this equipment does cause harmful interference to radio or television reception, which can be determined by turning the equipment off and on, the user is encouraged to try to correct the interference by one or more of the following measures:

- (1) Reorient or relocate the receiving antenna.
- (2) Increase the separation between the equipment and receiver.
- (3) Connect the equipment into an outlet on a circuit different from that to which the receiver is connected.
- (2) Consult the dealer or an experienced radio/TV technician for help.

Caution: Any changes or modifications to this device not explicitly approved by manufacturer could void your authority to operate this equipment.

This device complies with part 15 of the FCC Rules. Operation is subject to the following two conditions: (1) This device may not cause harmful interference. and (2) this device must accept any interference received, including interference that may cause undesired operation.

RF Exposure Information

The device has been evaluated to meet general RF exposure requirement. The device can be used in portable exposure condition without restriction.

The image shows a cover for a 'User Manual'. The background is a light gray color. A white diagonal line runs from the bottom-left corner towards the top-right corner, creating a white triangular area at the bottom. The text 'User Manual' is centered in the gray area in a black, sans-serif font.

User Manual