

Product instructions for use

Wired Carlife to Wireless CarPlay

Product connection principle

Freed from the shackles of wired Carlife connectivity, wireless CarPlay brings a more convenient connection experience. When you manually connect the wireless CarPlay feature for the first time, it automatically connects the feature the next time you enter the car.

Usage conditions

Scope of use: iPhone 6 or above, iOS 13.5 or above
above versions

Compatibility mode: for original vehicles with cable
Carlife

Wireless connection

Note: iPhone enters the settings page, opens the Bluetooth list, and deletes the Bluetooth connection record in the car or other devices.

1: Insert the product interface into the original vehicle interface (with data transmission function), please connect according to the prompt (Figure 1).

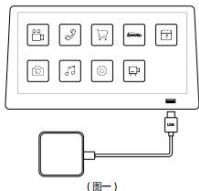

2: Click on the original screen "Carlife" function, the car will jump directly to the connection interface. (Figure 2)



3: Turn on iPhone Bluetooth and Wifi and search for devices in the Bluetooth name interface of the phone.

4: Click on the Bluetooth name that appears, and then click on "Use CarPlay in the car" to use Wireless CarPlay.

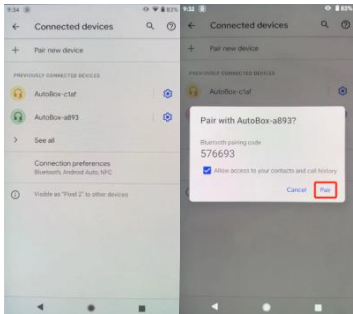

FCC WARNING

This device complies with part 15 of the FCC Rules. Operation is subject to the following two conditions: (1) this device may not cause harmful interference, and (2) this device must accept any interference received, including interference that may cause undesired operation.

Any changes or modifications not expressly approved by the party responsible for compliance could void the user's authority to operate the equipment.

NOTE: This equipment has been tested and found to comply

with the limits for a Class B digital device, pursuant to Part 15 of the FCC Rules. These limits are designed to provide reasonable protection against harmful interference in a residential installation. This equipment generates, uses and can radiate radio frequency energy and, if not installed and used in accordance with the instructions, may cause harmful interference to radio communications.

However, there is no guarantee that interference will not occur in a particular installation. If this equipment does cause harmful interference to radio or television reception,

which can be determined by turning the equipment off and on, the user is encouraged to try to correct the interference by one or more of the following measures:

- Reorient or relocate the receiving antenna.
- Increase the separation between the equipment and receiver.
- Connect the equipment into an outlet on a circuit different from that to which the receiver is connected.
- Consult the dealer or an experienced radio/TV technician for help.

To maintain compliance with FCC's RF Exposure guidelines,

This equipment should be installed and operated with minimum
20cm distance between the radiator and your body: Use only the
supplied antenn