

四合一无线充电器 说明书



注意：
为了确保设备的正常运行，请使用额定为9V2A或更高的适配器和快速充电线缆。
(使用替代适配器或充电线缆可能导致手机充电速度变慢，无法同时充电三个设备，
甚至损坏充电器。音质会有杂音。)
请将手表更新到最新的系统版本，并确保手表充电充足。

产品介绍

这款设备是一款四合一的音箱无线充电器，兼容Qi协议的手机、手表和耳机无线充电。音箱的设计独特且非常实用。手机位置采用折叠设计，便于更方便携带。它支持同时对多个设备无线充电。此外，该充电器允许手机既垂直放置或水平放置而不影响充电，同时播放音乐等，使用户能够在充电时进行视频聊天或观看他们喜欢的电影。

功能描述

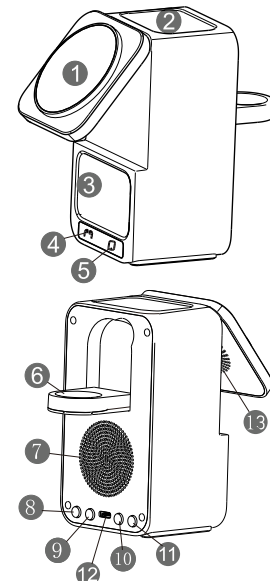

- ① 手机充电区
- ② 耳机充电区
- ③ 氛围灯
- ④ 耳机指示灯
- ⑤ 手机指示灯
- ⑥ 手表充电区
- ⑦ 音乐播放区
- ⑧ 音响开关机/暂停键
- ⑨ LED控制键
- ⑩ 上一曲/音量-控制键
- ⑪ 下一曲/音量+控制键
- ⑫ 电源输入
- ⑬ 散热孔

音箱使用

1. 长按POWER开机 蓝牙自动回搜搜索并连接上一次连接的蓝牙设备。
配对、开机、配对成功蓝牙有默认提示音；
2. POWER键；---长按开机/关机，短按播放暂停；
3. LED键；---开机进入跑马灯模式，短按音乐律动，再按关闭RGB灯；
4. VOL+；---长按音量加，短按下一曲；
5. VOL-；---长按音量减，短按上一曲；
6. 开机默认音量50%；提示音量50%。

充电使用

1. 首先，使用 Type-C 快速充电线将设备连接到支持 9V/2A以上的兼容适配器。
2. 打开设备，蓝色指示灯亮起。当无线充电器处于待机模式时，蓝色指示灯常亮。在手机/耳机充电期间，指示灯蓝色转绿色常亮。
3. 对于支持 Qi的手机、智能手表和耳机，将设备居中放置在相应的充电区域约0.1秒后即开始充电。当设备充电时或者您希望停止充电时，只需将其从充电区域取出即可。
- *无线充电感应范围受限，请将设备居中放置在充电器感应区域，放偏会导致充不满电/无法充电。

充电说明

- 注意：
*手机和耳机必须支持无线充电才能使用此功能，
*确保无效充电区域没有异物或厚度超过4mm的手机壳，以确保有效充电。

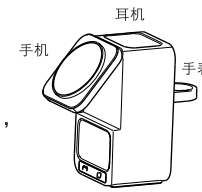

指示灯说明

指示灯状态	
待机	蓝灯常亮
手机充电	手机绿灯常亮
耳机充电	耳机绿灯常亮
异物检测	蓝绿闪烁
充满电	蓝灯常亮

蓝绿交替闪烁(无法充电)的常见原因：

1. 手机/耳机背面有金属/卡片/磁性物质会导致闪烁；
2. 手机/耳机以及耳机没有居中放置偏离线圈感应区域会导致闪烁；
3. 手机/耳机本身不支持无线充电会导致闪烁；
4. 适配器(支持9V/2A)功率不够会导致闪烁；
5. 手机/耳机保护壳过厚(2-4mm)会导致闪烁。

产品参数

产品参数	
产品名称	四合一无线充电器
产品输入	5V/3A, 9V/2A, 12V/2A
手机充电功率	5W/7.5W/10W/15W
耳机充电功率	5W
手表功率	2.5W
音箱功率	3W
产品材质	ABS+PC
产品尺寸	125.5*70*64mm
产品重量	558g

适用型号

智能手机-iPhone 12-15 系列以及最新型号支持 15W充电。支持其它 Qi认证的手机以及支持最新发布的 iPhone 无线充电兼容性的手机支持 10W 充电。
*请注意，厚度超过 4mm 的保护壳可能会影响无线充电，确保无线充电接触区域没有磁性材料、金属物体或卡片。-智能手表-仅与 Apple 手表系列 2131415161718/9/SEISE2/Ultra 112 以及最新发布Apple 手表兼容。-智能耳机-将您的 AirPods 或其他支持无线充电的耳机盒放置在后部指定区域进行无线充电。

注意事项

1. 充电支架上的充电线圈支持快速充电(15W/10W/7.5W)，而后底座上的充电线圈用于普通充电(5W)。请将您的手机放在在手机区域进行快速充电，将耳机其他手机放在前底座上进行普通充电。
2. 手机和手表的快速充电适用于正常室温(75° F-82° F)。在86° F-93° F的温度范围内，手机和手表的充电速度可能会减慢。如果室温超过100F，则手机和手表的过温保护系统可能会中断充电，直到温度降下来。在冬季，充电速度通常比夏季快。
3. 此充电器设计用于室内使用或干燥环境中使用。避免在高温、高湿度、静电充电或强磁环境中使用。
4. 为了您的安全，请勿在潮湿的手上插拔充电器
5. 将充电器放在婴儿和儿童无法触及的地方。
6. 如果充电器接触水或被污垢或灰尘粘住，请勿使用。
7. 未经授权的非专业人士严禁拆卸和修理。

4-in-1 Wireless Charger Instruction manual



Caution.
To ensure proper operation of your device, use an adapter and fast charging cable rated at 9V2A or higher.
(Using an alternative adapter or charging cable may result in slower charging of the phone, inability to charge three devices at the same time, and even damage the charger. The sound quality will be noisy.)Please update the watch to the latest system version and make sure the watch is fully charged. Translated with DeepL.com (free version)

Product Introduction

The device is a 4-in-1 wireless charger for speakers, compatible with Qi protocol for cell phones, watches and headphones wireless charging. The design of the speaker is unique and very practical. The cell phone position is folded to support wireless charging for multiple devices at the same time. It supports wireless charging of multiple devices at the same time. In addition, the charger allows the phone to be placed either vertically or horizontally without interfering with charging, while playing music, etc., enabling users to video chat or watch their favorite movies while charging. This allows users to video chat or watch their favorite movies while charging. Translated with DeepL.com (free version).

Function Description

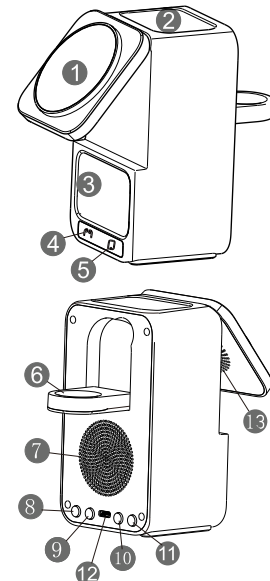

- ① Mobile charging area
- ② Headphone charging area
- ③ Atmosphere light
- ④ Headphone indicator light
- ⑤ Mobile phone indicator light
- ⑥ Watch charging area
- ⑦ Music playback area
- ⑧ Audio on/off/pause button
- ⑨ LED control keys
- ⑩ Previous Song/ Volume - Control Keys
- ⑪ Next track/ volume+ Control keys
- ⑫ Power input
- ⑬ Heat dissipation hole

Speaker usage

1. Long press and hold POWER to turn on the device, and the Bluetooth will automatically backlink and search for and connect to the Bluetooth device that was previously connected. Pairing, power on, pairing successful Bluetooth has a default prompt sound;
2. POWER button--- Long press to turn on/off, short press to pause playback;
3. LED button--- Turn on the device and enter the marquee mode. Short press the music rhythm, then press to turn off the RGB light;
4. VOL+; - Long press to increase volume, short press one song;
5. VOL - Long press to decrease the volume, short press the previous song;
6. The default volume upon startup is 50%; The volume of the prompt sound is 50%

Charging usage

1. Firstly, connect the device to a compatible adapter that supports 9V/2A or higher using a Type-C fast charging cable.
2. Turn on the device and the blue indicator light will light up. When the wireless charger is in standby mode, the blue indicator light always bright; During phone/headphone charging, the indicator light turns from blue to green and remains on.
3. For phones that support Qi Place the smartwatch and earphones in the center of the device in the corresponding charging area for approximately 0.1 seconds before charging begins. When the device is charging or you wish to stop charging, simply remove it from the charging area.
- *The wireless charging sensing range is limited. Please center the device in the charging sensing area, as misplacement may cause Not fully charged/unable to charge.

Charging instructions

Attention: Attention:
*Mobile phones and headphones must support wireless charging to use this feature.
*Ensure that there are no foreign objects or thicknesses in the ineffective charging area that exceed 4mm phone case to ensure effective charging.

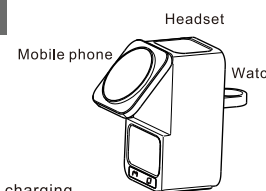

LED light status

Indicator status	
Standby	Blue light always on
Phone charging	Green light breathing
Earphone Charging	Green light breathing
Foreign object alarm	Blue green flash
Fully charged	Blue light always on

- Common reasons for alternating blue and green flashing lights (unable to charge):
1. Metal/cards/magnetic substances on the back of the phone/earphones can cause flashing lights;
 2. If the phone/earphones and earphones are not placed in the center and deviate from the coil sensing area, it will cause flashing lights;
 3. The phone/earphones themselves do not support wireless charging, which may cause flashing lights;
 4. Insufficient power of the adapter (supporting 9V/2A) may cause flashing lights;
 5. A phone/headphone case that is too thick (2-4mm) can cause flashing lights.

Product parameters

Product parameters	
Product Name	4 in 1 wireless charger
Product input	5V/3A, 9V/2A, 12V/2A
Mobile output	5W/7.5W/10W/15W
Headphone output	5W
Watch output	2.5W
Speaker output	3W
Product material	ABS+PC
Product size	125.5*70*64mm
Product weight	558g

Applicable equipment

Smartphones - iPhone 12-15 series and the latest models support 15W charging and other features Qi certified phones and phones that support the latest iPhone wireless charging compatibility support 10W charging. *Please note that protective cases with a thickness exceeding 4mm may affect wireless charging, ensuring there are no magnetic materials, metal objects, or cards in the wireless charging contact area- Smart Watch - Only compatible with Apple Watch Series 2131415161718/9/SEISE2/Ultra 112 and Latest Releases Cloth's Apple watch is compatible- Smart Earphones - Connect your AirPods or other devices that support wireless charging The earphone case is placed in the designated area at the rear for wireless charging.

Note

1. The charging coil on the charging bracket supports fast charging (15W/10W, /7.5W), and then the charging on the base The coil is used for regular charging (5W). Please place your phone in the phone area for quick charging. And turn on the headphones He placed his phone on the front dock for regular charging.
2. The fast charging of mobile phones and watches is suitable for normal room temperature (75° F-82° F). Between 86° F and 93° F Within the temperature range, the charging speed of mobile phones and watches may slow down. If the room temperature exceeds 100F, the hand The over temperature protection system of machines and watches may interrupt charging until the temperature drops. In winter, charging The speed is usually faster than in summer.
3. This charger is designed for indoor use or use in dry environments. Avoid high temperatures, humidity, and static electricity Used in charging or strong magnetic environments.
4. For your safety, please do not plug or unplug the charger in damp hands
5. Keep the charger out of reach of infants and children.
6. If the charger comes into contact with water or is stuck by dirt or dust, do not use it.
7. Unauthorized non professionals are strictly prohibited from disassembling and repairing.

This device complies with Part 15 of the FCC Rules. Operation is subject to the following two conditions: (1) this device may not cause harmful interference, and (2) this device must accept any interference received, including interference that may cause undesired operation.

Changes or modifications to this unit not expressly approved by the party responsible for compliance could void the user's authority to operate the equipment.

NOTE: This equipment has been tested and found to comply with the limits for a Class B digital device, pursuant to Part 15 of the FCC Rules. These limits are designed to provide reasonable protection against harmful interference in a residential installation. This equipment generates uses and can radiate radio frequency energy and, if not installed and used in accordance with the instructions, may cause harmful interference to radio communications. However, there is no guarantee that interference will not occur in a particular installation. If this equipment does cause harmful interference to radio or television reception, which can be determined by turning the equipment off and on, the user is encouraged to try to correct the interference by one or more of the following measures:

- Reorient or relocate the receiving antenna.
- Increase the separation between the equipment and receiver.
- Connect the equipment into an outlet on a circuit different from that to which the receiver is connected.
- Consult the dealer or an experienced radio/TV technician for help.

This device and its antenna(s) must not be co-located or operation in conjunction with any other antenna or transmitter.

Radiation Exposure Statement

The device has been evaluated to meet general RF exposure requirement in portable exposure condition without restriction.