

STUNT CAR INSTRUCTION

Please read this instruction manual carefully before use, and properly keep this manual for future use..

Packing list



Installation and charging method for the batteries of stunt car and remote control

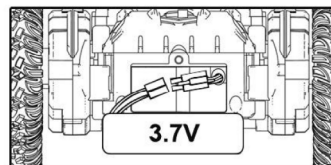
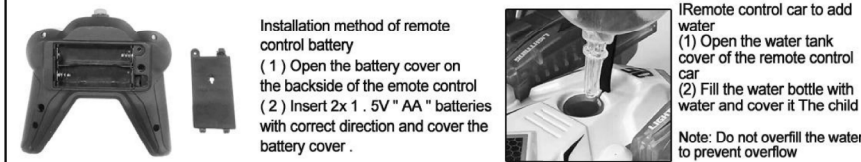
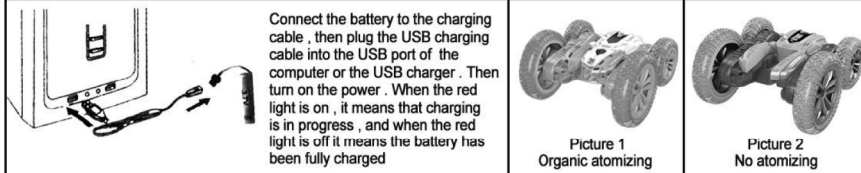

After charging is complete, open the battery cover and place the battery in the battery compartment

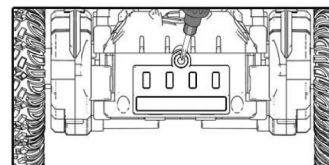

Connect the battery pack to the stunt car connector and close the battery cover

Remote Control Function

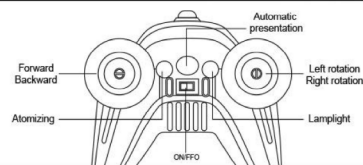

Instruction of light switch :

Short press one time to switch one lighting effect, long press to turn off the swing arm light, and long press again to turn it on

Operation Method

Turn on the rc car's power switch, On a flat surface stops flashing, you can operate the joystick and begin playing Remark: Cannot operate the joystick when the transmitter indicator is flashing

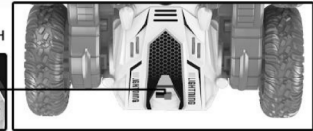
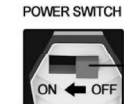

Basic operation picture showing how to USE this product

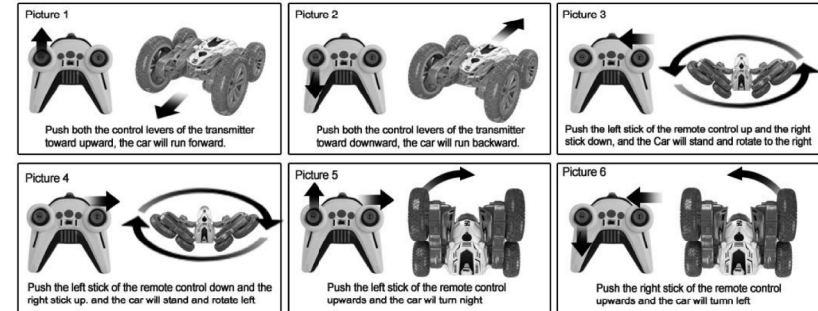

Care & Maintenance

- (1) If you plan to stop use for a long time, remember to remove all the batteries
- (2) If necessary, use a wet towel to gently wipe the car body clean
- (3) Do not expose this toy to high temperature, high humidity or direct sunlight
- (4) Do not put this toy in water to avoid damaging its electronic components.

Cautions

- Pay attention to the direction when installing or replacing batteries;•Do not use non-rechargeable batteries;•When charging the rechargeable battery, adult guardianship is required;
- Do not mix old and new batteries or different types of batteries;• During the operation, please pay attention to the nearby interference signal, otherwise the remote control distance will be affected;
- If the speed of the truck becomes more and more slow, it means the battery power is low; please charge the military truck as per the above method. •Please replace the battery in the following cases: the battery of the remote control is low; it is unable to charge the truck and the charging indicator becomes dark or is not turned on. •Please take out the battery in the remote control and take out the battery. put the power switch of the truck to the "OFF" position if the truck is not used for a long time

USE Cautions

When the car is in motion, do not touch the wheels by hand to avoid damages to the car.



Do not play by the roads or in any other dangerous places to avoid accidents.



Do not play in a place with puddle, mud or sand.

FCC Statement

This device complies with part 15 of the FCC Rules. Operation is subject to the following two conditions: (1) This device may not cause harmful interference, and (2) this device must accept any interference received, including interference that may cause undesired operation.

This equipment has been tested and found to comply with the limits for a Class B digital device, pursuant to part 15 of the FCC Rules. These limits are designed to provide reasonable protection against harmful interference in a residential installation. This equipment generates, uses and can radiate radio frequency energy and, if not installed and used in accordance with the instructions, may cause harmful interference to radio communications. However, there is no guarantee that interference will not occur in a particular installation. If this equipment does cause harmful interference to radio or television reception, which can be determined by turning the equipment off and on, the user is encouraged to try to correct the interference by one or more of the following measures:

- Reorient or relocate the receiving antenna.
- Increase the separation between the equipment and receiver.
- Connect the equipment into an outlet on a circuit different from that to which the receiver is connected.
- Consult the dealer or an experienced radio/TV technician for help.

Caution: Any changes or modifications to this device not explicitly approved by manufacturer could void your authority to operate this equipment.

RF Exposure Information

The device has been evaluated to meet general RF exposure requirement. The device can be used in portable exposure condition without restriction.