

## Unboxing Check

- Thank you for purchasing our products, please read the user manual carefully before use. The user manual contains necessary safety advice and user instructions, follow them to operate to avoid damaging the product for misuse.
- Check the product to ensure it is in good condition when received. Do not disassemble the host and component by yourself.

## Package List

- Meteor Galaxy Projector x 1
- USB Type-C Cable x 1
- Film Discs x 2 Boxes (6pcs/box)
- Base Spacer x 2 (1pcs preinstalled in the main unit)
- Wireless Remote Control x 1
- User Manual x 1

## Warm Tips

- Film discs are consumable accessories. To extend their lifespan, it is recommended to frequently alternate and replace them.
- When using the wireless remote control to operate the main unit, ensure that the remote control does not keep away from the main unit.
- For optimal projection results, it is suggested that users operate the projector in a dark environment, particularly when projecting onto a white background wall at a distance of 2 meters (6.56 feet) for best clarity and reality.
- The protruding device on the lens part of the main unit is the focus adjustment knob. By rotating it back and forth, the projection clarity can be adjusted.
- The slow-speed mode of this product simulates the slow orbit of planets. If users prefer a faster rotation effect, it is recommended to switch to the fast-speed mode.

- The product requires a power adapter with an output voltage of DC 5V/2A, and the main unit's power interface is Type-C.
- This product comes with two spacers of different lengths. Users can replace the spacers according to their needs to adjust the projection angle.

## Operation Instructions:

When using, insert the film disc with the "UP↑" side facing up into the film disc tray, and twist it into card slot to securely lock film disc in place. Powering on the product automatically activates the projection status when plugged in, and enables meteor and rainbow light effects, the default rotation speed is slow, bluetooth is enabled and in pairing mode, and the product is set to automatically shut down after 4 hours.

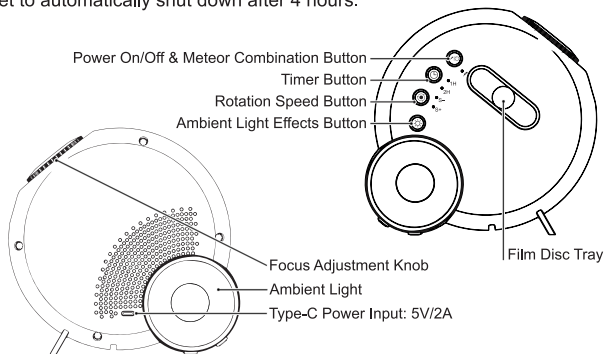

(1)  Power On/Off & Meteor On/Off Button: Long press to power on or off the device, short press to switch on/off meteor effect. When the meteor is activated, the meteor indicator lights up; when deactivated, the indicator goes off.

(2)  Timer Button: Sets the device's timer shutdown. Short press to cycle through timer settings: one-hour timer shutdown, two-hour timer shutdown, and cancel timer shutdown (automatically enters the default 4-hour auto-shutdown state). The indicator above the timer button shows the current timer setting: "1H" indicates one-hour timer shutdown, and "2H" indicates two-hour auto-shutdown.

(3)  Rotation Speed Button: Sets the projection rotation speed, defaulting to slow rotation. Short press to cycle through speed settings: slow rotation, fast rotation, and stop rotation. The indicator lights show the current speed setting: "S-" for slow, "S+" for fast, and both off for "stop."

(4)  Ambient Light Effects Button: Defaults to rainbow light effect. Short press to switch ambient light effects in sequence, (The cycle sequence is: varicolored light effects 1 to 15—white night light—warm white night light—turn off ambient light). Long press to adjust ambient light brightness: first long press increases brightness step by step, another long press decreases brightness step by step. In the off state, short press activates or deactivates the ambient light independently.

## Remote control function description

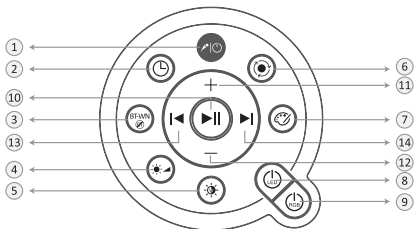

- ① Power Button: Long press to power on or off the device, short press to switch on/off meteor effect. When the meteor is activated, the meteor indicator lights up; when deactivated, the indicator goes off.

② **Timer Button:** Sets the device's timer shutdown. Short press to switch timer settings in sequence. The cycle sequence is: one-hour timer shutdown, two-hour timer shutdown, and cancel timer shutdown (automatically enters the default 4-hour auto-shutdown state). The indicator above the timer button shows the current timer setting: "1H" indicates one-hour timer shutdown, and "2H" indicates two-hour auto-shutdown.

③ **BT-WN Button:** Short press to switch between white noise playback mode and Bluetooth playback mode. Long press to disconnect the currently connected Bluetooth device, waiting for the varicolored light to flash blue three times, indicating that the current Bluetooth device has been disconnected.

④ **Brightness Button:** Short press to adjust the light brightness level, with four adjustable levels. Long press for stepless dimming mode: the first long press gradually increases brightness; release and long press again to gradually decrease brightness.

⑤ **Night Light Button:** Short press to switch between white night light and warm white night light. Long press to adjust the color temperature between cool and warm. (When the device is off, a short press can independently turn on the night light.)

⑥ **Rotation Speed Button:** Sets the projection rotation speed, defaulting to slow rotation. Short press to switch speed settings in sequence. The cycle sequence is 3 level speed: slow rotation, fast rotation, and stop rotation. The indicator lights show the current speed setting: "S-" for slow, "S+" for fast, and both off for "stop."

⑦ **Varicolored Light Effects Switch Button:** Short press to switch the varicolored light effects in sequence. The cycle sequence is: Rainbow - Fireworks - Neon - Variegated - Sunrise - Flowing Water - Marquee - Dynamic - Breathing - Red - Green - Blue - Yellow - Purple - Cyan. (When the device is off, a short press can independently turn on the varicolored light.)

⑧ **Projection Power Button:** Short press to turn the projection light and meteor effect on or off.

⑨ **Ambient Light Power Button:** Short press to turn the ambient light on or off. (When the main unit is off, a short press can independently turn on the ambient light, which will automatically turn off after 12 hours by default.)

⑩ **Play/Pause**

⑪ **Volume Up**

⑫ **Volume Down**

⑬ **Previous Song**

⑭ **Next Song**

## Film Discs Replacement Instructions:

(1) **Standard Configuration:** This product comes with 12 pieces of  $\phi 18\text{mm}$  large pattern film discs.

(2) **Place in film disc:** When installing the film disc, ensure that the side marked with "UP↑" is facing upwards. Align it with the groove and place it into the film disc slot. Firmly press down on the film gear with your hand, then rotate the film disc clockwise until it is fully locked into the film disc slot.

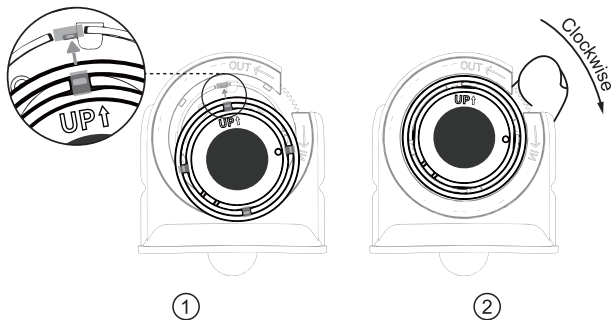

(3) Take out film disc: When replacing the film, firmly press down on the film gear with your hand while rotating the film disc counterclockwise to remove it or insert a new film disc.

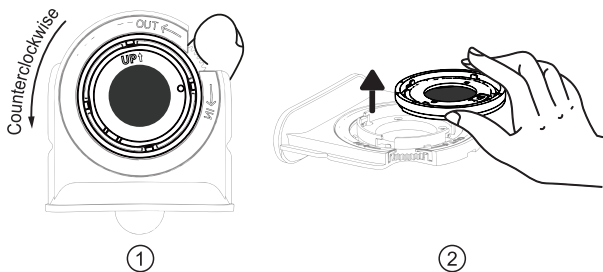

(4) Note: It is recommended to replace the film disc in the powered-off state.

## How to Adjust the Projection Angle:

- This product supports projection focus adjustment from 0.5 meters to 3 meters (1.64-9.84 ft).
- When adjusting the projection focus, rotate the focus adjustment knob in the positive or negative direction based on the current projection clarity to achieve a sharper image on the projection surface.

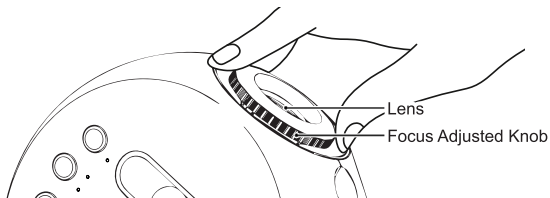

## How to adjust the projection angle:

- This product allows for adjusting the projection angle by replacing different spacers or inserting spacers into different socket positions.
- Using a long spacer in the bottom socket A can adjust the angle to a vertical upward position.

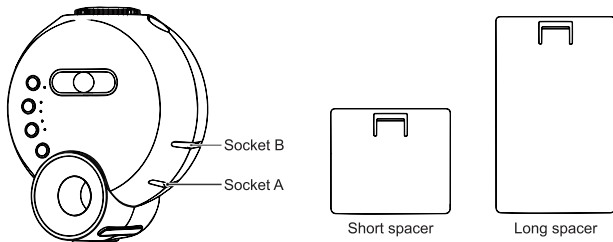

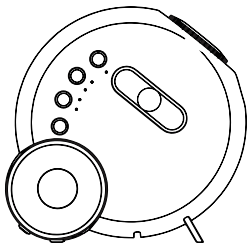

Socket B + Short spacer

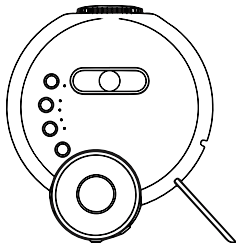

Socket A + Long spacer

## Bluetooth Playback and White Noise Playback

- This product has a built-in Bluetooth speaker. When powered on, Bluetooth is enabled by default and in pairing mode. You can use Bluetooth to connect to "XKM-003" to play music.
- This product has 15 built-in white noise tracks, which can be played or switched via the remote control. (The built-in white noise includes: 1-Rolling waves, 2-White noise, 3-Summer night insects, 4-Thunder and lightning, 5-Stream flowing, 6-Hypnosis song 01, 7-Hypnosis song 02, 8-Hypnosis song 03, 9-Bird chirping cicada, 10-Frog sounds water, 11. Continuous rain, 12-The wind blows the leaves, 13-Windbell waves, 14-Indulgent combustion, 15-Jungle waterfall)

## Specifications

Product Model	XKM-003
Material	PC+ABS
Power Input	DC 5V 2A
Maximum Power	10W
Projection Way	Film Disc Projection
Projection Source	LED Bulbs
Projection Distance	0.5m-3m/1.64-9.84ft
Projection Area	The projection area is 12.5m <sup>2</sup> ~23.75m <sup>2</sup> /134.55 sq.ft~255.64sq.ft at a 2m~3m/6.56ft~9.84ft projecting distance, and so on
Recommended Projection Environment	For optimal projection results, it is recommended to use the product in a dark environment, especially achieving the best clarity and reality when projecting onto a white background wall at a distance of 2 meters (6.56 feet).
Night Light Output Power	5W
Ambient Lighting	15 Varicolored Light Effects/ White Night Light / Warm White Night Light
Operating Temperature	-10°C~40°C/14°F~104°F
Storage Temperature	-20°C~60°C/-4°F~140°F
Operating Environment	Use in a dark indoor environment



This device complies with part 15 of the FCC Rules. Operation is subject to the following two conditions: (1) This device may not cause harmful interference, and (2) this device must accept any interference received, including interference that may cause undesired operation.

Any Changes or modifications not expressly approved by the party responsible for compliance could void the user's authority to operate the equipment.

**Note:** This equipment has been tested and found to comply with the limits for a Class B digital device, pursuant to part 15 of the FCC Rules. These limits are designed to provide reasonable protection against harmful interference in a residential installation. This equipment generates uses and can radiate radio frequency energy and, if not installed and used in accordance with the instructions, may cause harmful interference to radio communications. However, there is no guarantee that interference will not occur in a particular installation. If this equipment does cause harmful interference to radio or television reception, which can be determined by turning the equipment off and on, the user is encouraged to try to correct the interference by one or more of the following measures:

- Reorient or relocate the receiving antenna.
- Increase the separation between the equipment and receiver.
- Connect the equipment into an outlet on a circuit different from that to which the receiver is connected.
- Consult the dealer or an experienced radio/TV technician for help.

FCC Radiation Exposure statement

The device has been evaluatec to meel general RF exposure requirement. The device can be used in porlable exposure condition without restriction.