

Cat6 MIFI SLG-06

Quick start guide

Cognitive equipment



1. power button

Press and hold the power button to turn the device on/off.

2. SIM card socket

Nano(4FF) SIM card can be inserted.

3. USB class port

Use this C-port for battery charging, data sharing and equipment management.

4.M button

press 5s change the WIFI mode 2.4G/5G

Preparation before use

Install SIM card

1. Insert the SIM card into the correct position in the card slot.

note:

1. Do not take out the SIM card when the device is turned on, as this may damage the SIM card and the device.
2. Do not bend or scratch your SIM card. Avoid exposing the SIM card to static electricity, water or dust.

Take out the SIM card

1. press the SIM card .
2. Gently remove the SIM card from the SIM card slot.

charge a battery

MIFI's battery can be charged in two ways.

1. Use the power outlet to charge the battery.

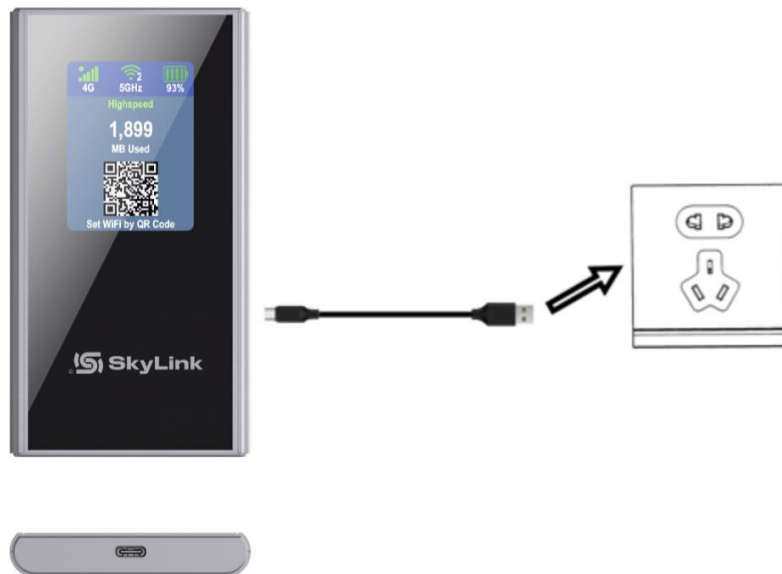

2. Use USB-A of a computer or laptop to charge the battery.



Access to the internet

After you are ready to insert the SIM card, charge the battery, and then your Wi-Fi devices and computers can access the Internet through MiFi and enjoy high-speed network services.



Smartphones, tablets, game consoles and other Wi-Fi devices can access the Internet through MiFi Wi-Fi connections.

Computers and laptops can be connected to MiFi through C-type cables to access the Internet.



Indicator status description



icon	describe
	Switch indicator light,
	Wi-Fi status shows that the indicator light is on when Wi Fi is turned on, and it is off when WiFi is turned off.
	After the network connection is successful, the cellular status indicators of 4G light up respectively, indicating that the registration in the 4G cellular network is successful.

Management equipment

Log on to the equipment management website

1. Make sure that your device is connected to MIFI through Wi-Fi or USB Type-C cable.
2. Open a browser and enter 192.168.43.1 in the address bar.
3. Enter the password and click "Login".

To access the web management page for the first time, you need to reset your password.

Set up Wi-Fi connection

1. Press and hold the "power" button for 3 seconds until the Wi-Fi indicator lights up and Wi-Fi is turned on.
2. Use your terminal to search for a wireless network connection with the Wi-Fi name "MIFI-xxxxxx", and then click "Connect". If the security mechanism is applied, you need to enter the correct password.

The default password is 12345678.

How to change the Wi-Fi name and password?

Through the web user interface:

1. Log in to 192.168.43.1 and enter the management page.
2. Select WLAN > Wi-Fi basic settings, and then you will see "Wi-Fi name" and "Wi-Fi password", make sure you delete the old name and password, and enter a new name and password according to your requirements.
3. Select the Save button, wait for the prompt "Success" on the screen, and then log out.
4. Wait for the Wi-Fi icon to appear on the computer or laptop screen. This means that the wireless network connection has been successful.

switch an electrical device off

Press and hold the power button for 9 seconds, and power off will be displayed.

Restore factory settings

Poke the 'R' hole for 12S to restore the factory settings

Note: Restoring the factory settings will delete all user-defined Wi-Fi settings of the device and restore the management settings and Wi-Fi settings to the factory default settings.

Common troubleshooting QA

If you encounter problems when using MIFI, please try the following.

1. If MIFI doesn't respond, press the Power button for about 5 seconds to display the restart option, and then restart.
2. Poke the 'R' hole for 12S to restore the factory settings.

If the connection between your MiFi and the client device cannot be established through Wi-Fi, please try the following.

1. Make sure that the Wi-Fi function is enabled.
2. Refresh the network list and select the correct SSID.
3. Check the IP address and ensure that your client can automatically obtain the IP address.
4. When connecting the client device to MiFi, please enter the correct network key (Wi-Fi password).

If the client device connected to your MiFi cannot access the Internet, try the following.

1. Make sure your nano-SIM card is available.
2. Change the location and find a place with a good signal.
3. Check the setting of WAN connection mode.
4. Please contact your service provider and confirm your APN settings.

If you can't access the MiFi configuration page, try the following.

1. Enter the correct address. Please check the label on your device to get the default IP address of the device manager website.
2. Use only one network adapter in your computer.
3. Do not use any proxy server.

safety/security information

Before using and operating the equipment, please read and observe the following precautions to ensure the best performance of the equipment and avoid dangerous or illegal situations.

operating environment

Please use the equipment in the range of -0C~45C, and store the equipment and its accessories in the temperature range of -0C~+50C. When the ambient temperature is too high or too low, it may cause equipment failure.

Accessories requirements

Please use the accessories approved by the equipment manufacturer and matched with this type of equipment. If other types of accessories are used, it may violate the warranty terms of this equipment and the relevant regulations of the country where this equipment is located, and may lead to safety accidents. Please contact an authorized service center if you need to obtain approved accessories.

Power supply safety

Power sockets should be installed in the equipment accessories and easily accessible.

When not using this equipment, please disconnect the power supply from the equipment and unplug the power plug from the power socket.

environmental protection

Please do not treat this equipment and its accessories as ordinary domestic garbage.

Please comply with the local laws and regulations on the disposal of this equipment and its accessories, and support the recycling action.

FCC Statement

This equipment has been tested and found to comply with the limits for a Class B digital device, pursuant to part 15 of the FCC Rules. These limits are designed to provide reasonable protection against harmful interference in a residential installation. This equipment generates, uses and can radiate radio frequency energy and, if not installed and used in accordance with the instructions, may cause harmful interference to radio communications. However, there is no guarantee that interference will not occur in a particular installation. If this equipment does cause harmful interference to radio or television reception, which can be determined by turning the equipment off and on, the user is encouraged to try to correct the interference by one or more of the following measures:

- Reorient or relocate the receiving antenna.
- Increase the separation between the equipment and receiver.
- Connect the equipment into an outlet on a circuit different from that to which the receiver is connected.
- Consult the dealer or an experienced radio/TV technician for help.

Caution: Any changes or modifications to this device not explicitly approved by manufacturer could void your authority to operate this equipment.

This device complies with part 15 of the FCC Rules. Operation is subject to the following two conditions:

(1) This device may not cause harmful interference, and (2) this device must accept any interference received, including interference that may cause undesired operation.

Specific Absorption Rate (SAR) information:

This Device meets the government's requirements for exposure to radio waves. The guidelines are based on standards that were developed by independent scientific organizations through periodic and thorough evaluation of scientific studies. The standards include a substantial safety margin designed to assure the safety of all persons regardless of age or health. FCC RF Exposure Information and Statement the SAR limit of USA (FCC) is 1.6 W/kg averaged over one gram of tissue. Device types: Device has also been tested against this SAR limit. This device was tested for typical body-worn operations with the back of the device kept 10mm from the body. To maintain compliance with FCC RF exposure requirements, use accessories that maintain an 10mm separation distance between the user's body and the back of the device. The use of belt clips, holsters and similar accessories should not contain metallic components in its assembly. The use of accessories that do not satisfy these requirements may not comply with FCC RF exposure requirements, and should be avoided.