



USER MANUAL

Model NO. GM08

GPS WIRELESS DOG FENCE SYSTEM

For Outdoor Use Only



PLEASE READ THE USER MANUAL CAREFULLY BEFORE OPERATING

If you have any issues, please contact our customer service team: Dogoitm@hotmail.com

Thank you for choosing DOGOITM GPS wireless dog fence system. The product is developed to support customers with efficient dog training solutions and upgrade your pet care. Well-trained dog with good behavior will not cause you to have unpleasant and awkward situations with the people around you.

DOGOITM GPS wireless dog fence system can support 4 positioning modes (GPS, Galileo, GLONASS, BeiDou) . It adopts the advanced technology of wireless transmitting and receiving module to make sure no error caused by unsteady satellite signals. It is designed to act as a deterrent to remind dogs to stay within the established safe boundary by 3 warning modes of beep, vibration and electric shock when your dogs go beyond the set area. Wireless fence instead of traditional physical fence, free the pets from the leash, enjoy playing within safe boundaries.

To ensure your satisfaction, please read this user manual thoroughly. If you have any issues, please contact our customer service team at Dogoitm@hotmail.com Our team is here for you and your dog, we will reply to you within 24 hours.

⚠ WARNING

DO NOT use the product if your dog is prone to aggressive behavior. Aggressive dogs can cause severe injury to their owners and others.

It's not a toy! Keep it out of the reach of children.

⚠ CAUTION

- DOGOITM GPS wireless dog fence system is for **OUTDOOR** use only due to no GPS signals indoors, to prevent an unintended correction. Turn off or remove the device from your dog when indoors.
- DOGOITM GPS wireless dog fence system is designed to be IPX6 waterproof. It's suitable for a wet environment, but it cannot be immersed in water for a long time.
- Avoid leaving the device on your dog for more than 12 hours per day.
- When possible reposition the collar on your dog's neck every 1 to 2 hours.
- You may need to trim the hair in the area of the contact points. Never shave your dog's neck, this may lead to a rash or infection.
- Never connect a leash to a collar with contact points. It will cause excessive pressure on the contact points.
- When using a separate collar for a leash, do not put pressure on the device.
- Wash your dog's neck area and the contact points of the device weekly with a damp cloth.
- Examine the contact area daily for signs of a rash or a sore.
- If a rash or sore is found, discontinue use of the device until the skin has healed.
- If the condition persists beyond 48 hours, see your veterinarian.
- Proper training of your dog is essential for successfully using the system. During the first 2 weeks of training, do not use the system without direct supervision of your dog.

- The device should not be on your dog when the system is tested. If it is, your dog may receive an unintended correction.
- The product does not include a charging header. You can use available DC5V charging header or purchase one to charge it. Any DC5V ranging from 500mA to 2000mA charging header is compatible.
- The DOGOITM GPS wireless dog fence system is **NOT a solid barrier**. It is designed to act as a deterrent to remind pets to remain within the established boundary by use of static correction. It is important that you reinforce training with your dog on a regular basis. Not all dogs can be trained to avoid crossing the boundary! Therefore, if you have reason to believe that your dog may pose a danger to others or harm himself /herself if he/she is not kept from crossing the boundary, you should NOT rely solely upon this system to confine your dogs.

TABLE OF CONTENTS

Components.....	4
Key Function.....	4
Introduction of Screen Icons.....	5
Set Up the Wireless Dog Fence Boundary.....	6
1. Install the Contact Points.....	6
2. Install the Collar.....	6
3. Positioning Center Point.....	6
4. Set Up Distance and Warning.....	6
5. Test the Electric Shock.....	6
6. Place Boundary Flags.....	7
7. Fit Your Training Collar.....	7
When Your Dog is Out of Set Range.....	7
Training Your DOG.....	8
Reference the Size and Weight for Dog.....	10
Warranty and Repair Information.....	10

Components



Package included:

1. GPS wireless dog fence training device (1 Pcs)
2. Collar (1 Pcs)
3. Charging cable (1 Pcs)
4. Electric shock test light (1 Pcs)
5. Contact points (3 pairs)
6. Silicone covers (3 pairs)
7. User manual (1 set)

Key Function

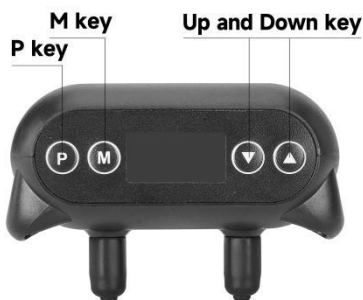

1. Turn on/off the device or fast positioning (P key)

- a. Long press the 'P' key for 3 seconds to turn on/off the device.
- b. Short press the 'P' key for 1 second to fast position the new center point without restarting the device.

Note: When the device is in use and the distance is found to be shifted, you can short press 'P' key to reposition the center point.

To extend the life of the battery, please turn off the device when it is not used for a long time.

2. Adjust the Distance Radius of the Boundary (M key)

Press the 'M' key to enter the distance adjustment mode. The minimum radius distance is

65ft, you can use the up and down keys to adjust it to the maximum 3290ft. The adjustment value for each gear is 10ft.

3.Adjust the warning-beep, vibration and electric shock (M key)

Press the 'M' to enter the warning adjustment mode. There are three warning modes (beep, vibration and electric shock). The beep mode is turned on by default (0-1). The vibration mode has six intensities (0-5). The electric shock has eleven intensities (0-10).

4.Up and Down Key

You can use the up and down keys to adjust the radius of distance or the intensity of the warning. All settings will be automatically saved after 3 seconds.

Introduction of Screen Icons



Positioning icon: When opening the device, the positioning icon will flash continuously. It indicates that the device is searching for satellite signals. The process will last for 1-2 minutes. During the process, you can adjust the distance, warning, and memory function settings by pressing the 'M' key.

Note: If the positioning is not completed, during the process of setting other modes, the screen will automatically turn back to the positioning interface after 12 seconds. You can press the 'M' key to continue setting.



Number of satellites icon: '00' represents the number of satellites received by the system, it will be affected by factors such as dense forests, weather, tall buildings, etc. If the number of satellites displayed is less than 5, we suggest that you change the location and search for the signal again. When the number of GPS satellites reaches 6 or more, the device starts working.

65 FT Distance icon: it represents the radius of distance. The default distance radius is 65FT. You can adjust the distance by pressing the up and down keys in the distance adjust mode. The adjustment value for each gear is 10ft. The system will automatically save the value you set after 3 seconds and then take it affect immediately.



GPS signal icon: it represents the strength GPS signal. The GPS signal icon lights up once the device gets a satellite signal. The stronger the signal, the more satellites the device searches. When the signal icon does not light up or only shows one frame, it means the environment is poor, you need to change a new place to reposition. When the signal icon shows full frame, it means that the environment is good.





Beep icon: '0' and '1', representing 'no beep sound' and 'beep sound' respectively.

Note: The system default setting is '1' with beep sound.



Vibration icon: '0', '1', '2', '3', '4' and '5' with '0' for no vibration, '1-2' for minor vibration, '3-4' for moderate vibration and '5' for strong vibration. The screen will show vibration icon at the top when the vibration is set to '1-5'.

 Eleven shock icon: From '0' to '10' with '0' for no shock, '1-3' for mild shock, '4-6' for medium shock, and '7-10' for highest-voltage shock. The screen will show shock icon at the top when the shock is set to '1-10'.

 Remember icon: '0' or '1'

'0' represents 'Remember' function is 'OFF'. The system defaults to 'Remember' as 'OFF'. In this mode, the device needs to be repositioned every time when it is turned on.

'1' represents 'Remember' function is 'ON'. In this mode, the device will automatically remember the last positioning center point for next using whatever it is turned off or charged.

When it is set to '1', the screen will display the memory icon at the top.

SUGGESTION: When you have completed the center point positioning, you can press M key to go to the 'Remember' setting interface. Use the up and down keys to adjust the 'Remember' to '1'. This ensures that the DOGOITM system will automatically locate the original center point when you use the device next time, without the need to reposition it again.

If you want to set new center point, please set the remember mode to be '1' and short press 'P' Key to fast positioning the new center point after the device is powered on and receive the satellite. The device will automatically remember the new center point for using next time.

 The battery power can support the DOGOITM device working continuously for 50 hours.

When the device runs normally for more than 30 seconds without performing any operation, the device enters the screen off state to save battery. If you need to set the device, press any key to wake it up, and then set the device as required.

When the battery level is below 25%, the battery enclosure will automatically flash to remind you to charge it. It will take about 6 hours to a full charge.

Note: **DO NOT** charge the unit near any flammable substance. Charging the unit full firstly if the device has been left unused more than 1 month.

The device will not be turned on/off when it's charging.

Set Up the Wireless Dog Fence Boundary

1. Install the Contact Points

DOGOITM dog fence system comes with three pairs of contact points. If your dog is a short haired pet, please use short or medium ones. For long haired or thick haired dogs, please use the long ones (the hair at the contact point can also be properly trimmed).

2. Install the Collar

Step 1: Pass the collar through the device.

Step 2: Pass the collar through the release buckle and slide it on the collar up and down to a proper position.

Step 3: Slide and thread the collar into the hole of the glide buckle to fix the collar length.

Step 4: Pass the excess belt through the release buckle.

Step 5: Cut up the extra collar and burn the end.

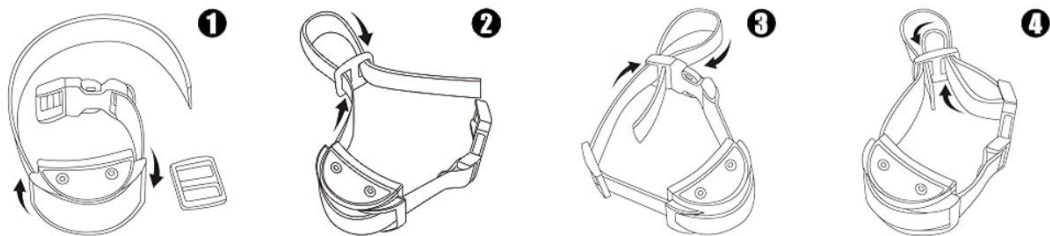

3. Positioning Center Point

Choose a suitable center point outdoors and mark it. Turn on the device. It will automatically search for satellite signals, and this process usually takes 1-2 minutes to complete.

4. Set Up Distance and Warning

Please see the details of setting distance and warning on page 2.

5. Test the Electric Shock

- Hold the test light against the contact points.
- Long press the up and down keys together for 3 seconds, the device will beep, vibrate and shock respectively.
- If the test light lights up, the shock mode functions.

6. Place Boundary Flags

Hold the collar and walk east/south/west/north from the center point towards the boundary until the device beeps. Slowly move the device towards the center point until it stops beeping. Place a flag.

Using one of the flags as a reference point, use the same method to detect specific boundaries along the boundary range and place the flags.

7. Fit the Training Collar

The proper fit and placement of your training collar is important for effective operation

The contact points must directly touch the neck skin of your dog

1. Start with the collar turned off and your dog standing comfortably, not sitting(A).
2. Put the device directly under the chin of your dog. Make sure both the contact points are in the center of your dog's neck and contacted his neck(B).

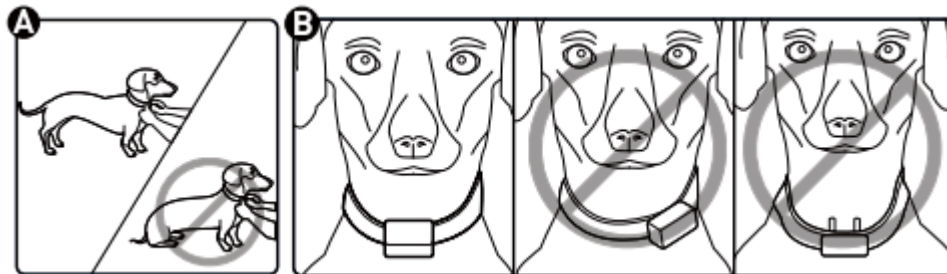

Note: Sometimes it's necessary to trim the hair around the contact points to make sure that contact is consistent. We also have included longer contact points.

When Your Dog is Out of Set Range

1. When your dog is out of set range, the warning modes will start to work. If you don't set any setting, the device defaults to only a beep sound.
2. If you set the vibration and shock intensity, **the device will only beep for the first 3 seconds** when your dog is out of the boundary. After 3 seconds, the device will beep, vibration, and electric shock at the same time (This process will last for 30 seconds). If the dog returns to the boundary within 3 seconds, the device will only beep and your dog will not be corrected by vibration or electric shock.
3. After 30 seconds of behavior correction, the device will stop working for 16 seconds. This process lasts for three times. After three corrections, if your dog is still outside the boundary. To protect your dog, the device will automatically stop vibration and electric shock.

Training Your DOG

NOTE

1. Please set up a separate collar belt on your dog's neck, and tie a traction rope.
2. The traction rope can not be put on the DOGOITM device, so make sure that it will not be subjected to other external pressure.
3. Bring your dog's favorite treats, available dry meat, hot dogs, etc.

Stage 1: Train the dog's border awareness (Day 1-3)

The training days are three days in total, three times per day, each lasting 10-15 minutes.

Training objective: Make your dog aware of the border signs of the collar and sound warnings to define a new safe activity area.

Setting: set the device to vibrate.

Steps:

1. Lead your dog to the safe radius area with a traction rope and talk to your dog to praise its behavior.
2. Please fully control your dog with the traction rope and take it to the flag representing the distance between the safety radius and the border. When the dog leaves the safe radius area, the device starts beeping. Let your dog stay for 3 seconds, then take it back to the safe radius. (When your dog returns to the safe radius, please praise him/her for good behavior immediately.)
3. Repeat this process on the same boundary sign until your dog actively refuses to go outside the safe radius area.
4. Continue to repeat the training around border flags and make the process fun! If your pet retreats quickly or refuses to enter the boundary area, offer praise and treats as a reward.

Stage 2: Train the dog's border awareness (Day 4-6)

The training days are three days in total, three times per day, each lasting 10-15 minutes.

Training objective: Train your dog to stay in fenced areas and respect boundaries.

Setting: Set the DOGOITM device mode to electric shock.

Steps:

1. Repeat steps 1-4 in Stage 1.
2. Notice the dog's slight reactions at first, such as lifting its ears, turning its head, and looking at the ground.
3. Stay on the same flag until your dog refuses to enter the boundary area.

Note: We suggest gradually adjusting the electric shock intensity from weak to strong during training until it reaches the most suitable intensity for your dog.

Stage 3: Distraction stage (Day 7-9)

The training days are three days in total, three times per day, each lasting 10-15 minutes.

Training objective: Train your pet to stay in the safe radius range area and have distractions outside the safe radius range area.

Setting: According to the dog reaction result from day 4 to day 6, the time the dog stays in the boundary area can be adjusted appropriately by continuing the training via the vibration or electric shock mode (the punishment intensity increases with the increase of the stay time).

Create distractions to tempt your dog to go out of the wireless boundary, such as:

1. Have a family member cross from inside the boundary to outside of it.
2. Throw a ball or treat outside of the safe radius range area.
3. Let a neighbor take their dog out of a safe radius.

Gradually increase distraction level.

Steps:

1. Completely control your dog with the traction rope, so that you can distract.
2. If your dog doesn't divert attention, praise and offer rewards.
3. If your dog really reacts to distraction, let it enter the boundary area.
4. If your dog does not turn back after 3 seconds, please help him/her return to the safe radius.
5. Whenever the dog returns to the safe radius, no matter whether you help it or not, treat and praise your dog as well.
6. If you do not use other interfering factors, please repeat this process and use other family members in this process.

Stage 4:(Day 10-14) Supervision and Inspection

Training time should be increased from 10-15 minutes to over 1 hour for each day.

Please train your dog to clearly avoid the entire boundary area, regardless of any distractions or temptations. This step requires someone to be present.

Training objective: Free your dog from restraints and allow it to move/play/run freely in a safe radius distance zone.

Setting: Adjust the DOGOITM device to fit your dog based on the first 9 days of training (To protect your dog, you can use vibration mode if the dog is no longer outside the boundary area.)

Steps:

1. Please let your dog wear DOGOITM device to enter the safety radius (no collar or traction rope is required).
2. Walk around the yard and play with your dog, staying within the safe radius range area at all times.
3. While watching your dog in the yard, you can also do other things. Just check your dog regularly to prevent it from escaping.
4. You can strengthen the training if your dog escapes multiple times.

Reference the Size and Weight for Dog

DOGOITM GPS wireless dog fence device is suitable for most of dogs (Neck 10~28inch, Weight 10~120lb)

Warranty and Repair Information

1-Year Limited Warranty

The original purchase for DOGOITM Wireless Dog Fence System is provided with 1-year warranty. The warranty begins from the date of purchase. For the first year, coverage is for device on warranty repair service, but the return postage is for the buyer's account.

Accessories such as charging cable, strap, contact points are covered for the first year only. When the warranty expires, customers will need pay for parts and repairs at their own expense.

To Qualify for the Warranty

All product must provide a proof of purchase in order to initiate repair work under warranty. We strongly recommend keeping the original receipt. If the proof of the purchase is not available, we will estimate the age of the unit by the Amazon order number. But it will be the only method that we judge your order time. (We strongly RECOMMEND that you register for warranty within 30 days of receiving the product.)

Won't Qualify for 1-Year Warranty

We **DO NOT** offer warranty for products that have been bought secondhand or as a resold product.

Issues of replacement and refunds, if unites are kept less than 30 days from an authorized dealer must be addressed to the dealer directly. If more than 30 days, please send the unites to us for after-sale.

Manual damage or loss is not covered by the warranty.

Any water damage on water resistant receivers of our product series will not be covered. All replacement costs for the device will be the owner's responsibility.

The warranty is void if the unit has been altered or an unauthorized person who attempting to repair work has damaged the unit.

If you have any issues, please feel free to contact our customer service team at Dogoitm@hotmail.com

FCC Warning:

This equipment has been tested and found to comply with the limits for a Class B digital device, pursuant to part 15 of the FCC Rules. These limits are designed to provide reasonable protection against harmful interference in a residential installation. This equipment generates, uses and can radiate radio frequency energy and, if not installed and used in accordance with the instructions, may cause harmful interference to radio communications. However, there is no guarantee that interference will not occur in a particular installation. If this equipment does cause harmful interference to radio or television reception, which can be determined by turning the equipment off and on, the user is encouraged to try to correct the interference by one or more of the following measures:

- Reorient or relocate the receiving antenna.
- Increase the separation between the equipment and receiver.
- Connect the equipment into an outlet on a circuit different from that to which the receiver is connected.
- Consult the dealer or an experienced radio/TV technician for help.

Caution: Any changes or modifications to this device not explicitly approved by manufacturer could void your authority to operate this equipment.

This device complies with part 15 of the FCC Rules. Operation is subject to the following two conditions:

(1) This device may not cause harmful interference, and (2) this device must accept any interference received, including interference that may cause undesired operation.

This equipment complies with FCC radiation exposure limits set forth for an uncontrolled environment. This equipment should be installed and operated with minimum distance 0cm between the radiator and your body.