

# Air Aromatherapy Purifier Instructions



## WG-03

Thank you for purchasing our products  
Please read the instruction manual carefully before use  
Please keep the instruction manual properly

## **Product parameters:**

Product name: Air aromatherapy purifier

Product model: WG-03

Product material: ABS/pp/filter element/circuit board

Operating voltage: d.c5v

Usage current: >2A

Product size:170\*170\*170mm

Water tank capacity: 500ml

Atomization volume: 30ml/H

Atomization vibration frequency: 2.4MHZ

Implementation standard: GB4706.45-2008

Please use an adapter plug with a d.c current output greater than 2A. If

the adapter plug power is insufficient, it will cause low fog;

# FUNCTION DISPLAY

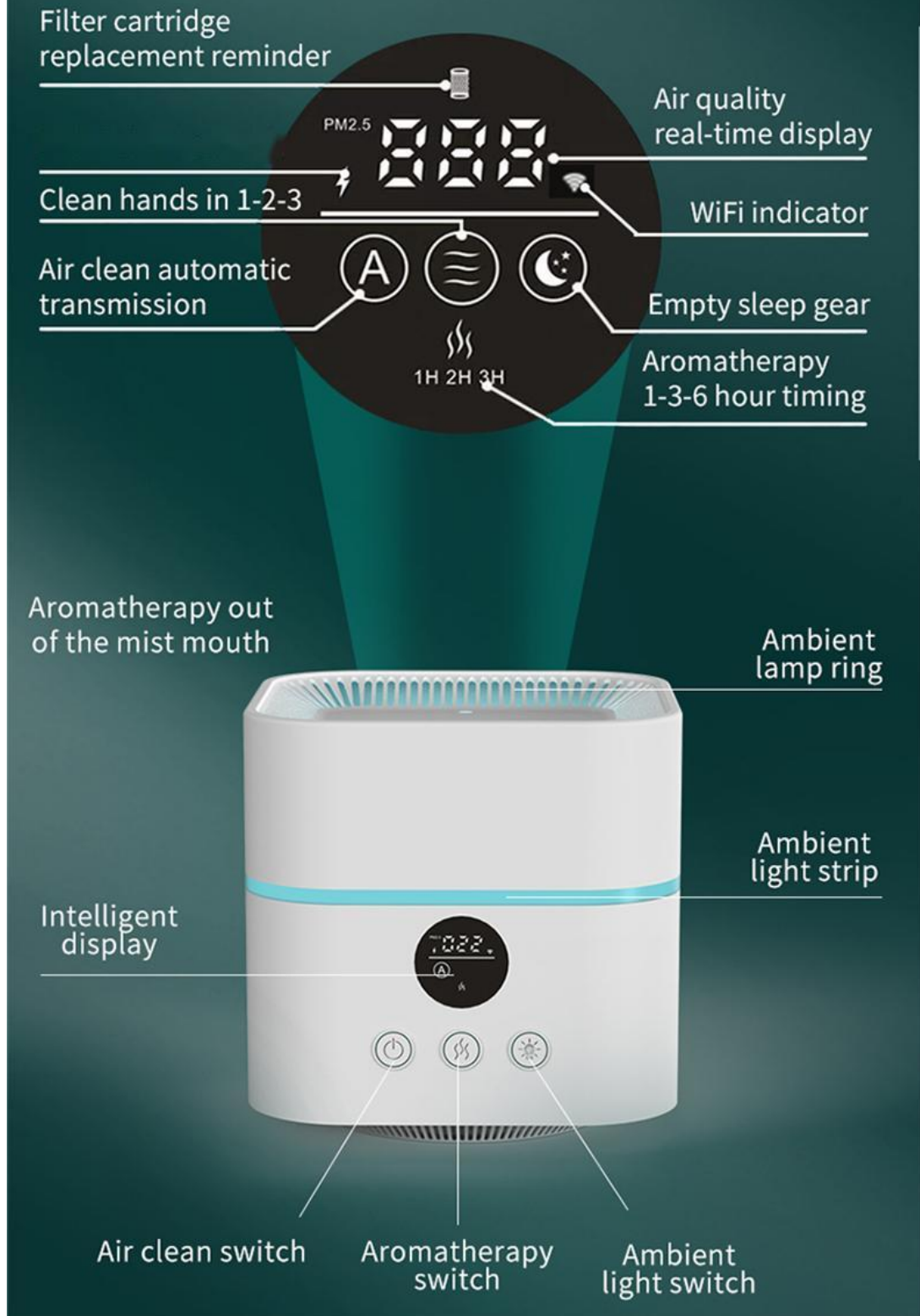

**Function operation:**

Air purifier switch: Click the air purifier to turn on the automatic mode, and the fan will automatically switch gears according to the air quality; click again to turn on the manual mode first;

Click again to turn on second gear in manual mode;

Click again to turn on manual mode third gear;

Click again to turn on sleep mode;

Click again to turn on the automatic mode and cycle through it;

Press and hold the air purifier button for 2 seconds in any mode to turn off the air purifier;

Aromatherapy switch: click to turn on continuous spray;

Click again to turn on the timer for 1 hour;

Click again to turn on the timer for 3 hours;

Click again to turn on the timer for 6 hours;

Click again to start the continuous spray cycle;

Press and hold the humidification button for 2 seconds in any mode to turn off the humidifier;

Light switch: Click to turn on the air quality indicator light;

Click again to turn on the colorful gradient ambient light;

Click again to turn on the monochrome ice blue ambient light;

Click again to turn on the single-color warm yellow ambient light;

Click again to turn on the air quality indicator light to cycle through;

Press and hold the light button in any mode to turn off the ambient light;

Filter replacement reminder light: When the air purifier is used for 2000 hours, the filter replacement reminder light will light up to remind you to replace the filter element.

Press and hold the air purifier button for 2 seconds to turn off the air purifier.

Don't let go and continue pressing for 2 seconds to turn off the air purifier.

Filter replacement reminder light and restart timing;

Air purifier filter element: primary effect net + H13 filter paper + activated carbon + sterilization net;

Note:

Negative (plasma) ions are normally on when the air purifier is on, and negative (plasma) ions are off when the air purifier is off;

### **Air purifier operation method**

1. After turning on the power, click the air purifier switch to turn on the air purifier;
2. When the air purifier is turned on, negative ions are automatically turned on, and when the air purifier is turned off, negative ions are turned off;
3. After the air purifier is turned on, the screen will display the air quality in real time. 0-35 is excellent, 35-75 is good. The lower the value, the better the air quality;
4. After 2000 hours of use, the filter replacement reminder light will light up, and the filter element can be replaced. The method is as follows:

### Filter replacement instructions



### Air purifier precautions

1. It is recommended to clean the filter element of this product every half a month and replace the filter element every three months.
2. When cleaning the filter element, do not wash it with water. You can wipe it with a rag, or use a small soft brush or toothbrush to clean the dust attached to the surface of the filter screen.
3. When cleaning the filter element, please do not knock the filter element, otherwise the internal structure of the filter element will be damaged and the filtering effect will not be achieved.
4. The applicable range of this product is 10-20 square meters. If the space is large, please use a suitable product.
5. This product will produce a very small amount of ozone when it is working. If you feel difficulty breathing, please turn off the machine and open the window for ventilation.
6. Please do not spray corrosive liquids such as essences, essential oils, perfumes, etc. on the filter.
7. When the product is not used for a long time, please place it in an environment with normal temperature and low humidity to avoid damage to product functions due to bad environment.

### Humidifying aromatherapy operation method

1. Please straighten the product and lift the upper cover vertically;
2. Add an appropriate amount of tap water into the water tank. Do not add water when using the product (water with too high temperature must not be used);
3. After placing water in the water tank, drop in essential oil (it is recommended to add 1 drop of essential oil per 100ml of water);
4. Put the upper cover back and drop it in the vertical direction. The direction of the mist outlet can be adjusted;
5. Plug in the power supply; remember to keep the machine flat and not tilted to avoid water overflow;

When the power is turned on, the initial state of the aromatherapy machine is off. If there is lack of water in the water tank, the aromatherapy function will automatically turn off even if the aromatherapy switch is turned on;

## Usage method



1. Remove top cover

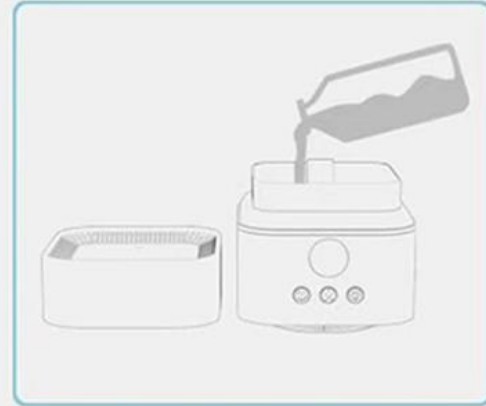

2. Add water, careful not to exceed the highest water level



3. Add proper amount of essential oil



4. Install the cover correctly



5. Insert the adapter and start running

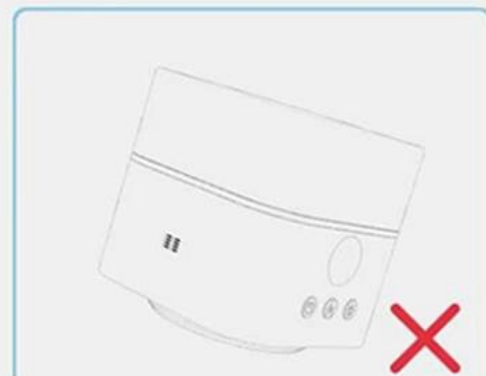

6. Remember not to tilt, nor to be placed on a tilted table that is not horizontal, to be placed on the table smoothly

## **Humidifying Aromatherapy Care**

Please handle the product as follows every 5-6 times or every 3-5 days of use:

- 1 Unplug the power cord and open the upper cover;
  2. Completely pour out the remaining water from the water tank;
  3. Dilute a small amount of kitchen detergent into warm water and then wipe the product with a rag;
  4. If you find dirt on the inside of the air outlet, please remove the container cover and clean it;
  5. Do not use medical diluent phenyl alcohol during maintenance, otherwise it may damage the product or erase various marks on the product;
- Be careful not to use neutral detergents

## **Things to note when using humidified aromatherapy**

- \* Please note that any slight difference in spray volume is normal.
- \* Different water temperatures, air temperatures and wind conditions will affect the fogging effect.
- \* Only applicable to 100% natural water-soluble aromatherapy essential oils (essential oils for humidifiers) if they contain chemical ingredients. It may cause damage to the product. Please clean the product according to the maintenance section before changing to another aromatherapy oil.
- \* Non-technical personnel are not allowed to modify, disassemble, or repair this product without permission. If repair is needed, please contact the sales office of this product.
- \* To ensure hygiene, the water in the water tank must be poured out and wiped clean with a rag after each use.
- \* Aromatherapy essential oils can cause staining. If accidentally spilled, wipe it with a rag immediately.
- \* Never let the spray spray directly on furniture, clothes or walls, etc.
- \* Avoid placing the product in direct sunlight, near air conditioner fans and other high-temperature places.
- \* It should be placed on a flat surface and not placed on carpets, mats or unstable places.
- \* Avoid placing it next to electrical appliances, such as TV speakers and equipment.
- \* The product should not be covered as it may cause water to accumulate inside the body and damage the product.
- \* After working for a long time, the humidification function should be turned off for 60 minutes and then re-enabled to avoid damage to the ultrasonic atomizer sheet.
- \* It should be placed out of reach of children and children should be properly taught not to play with the product. It is not suitable for use by children or people who lack knowledge and experience with the product.

WiFi connection steps (you can ask customer service for video operation tutorials)



1. Download the Smart Life (or Tuya Smart) APP on your mobile phone, register and log in; both apps can be used; you can use the WeChat applet, or search and download the app in the app store.
2. Turn on the machine and the WiFi icon will flash slowly; (make sure there is available WiFi).
3. Double-click the ambient light button, and the WiFi icon will enter a flashing state.
4. Turn on Bluetooth on your phone, enter the Smart Life app, and click Add Device on the homepage; the system automatically searches for the device, and click Add after discovering the device.

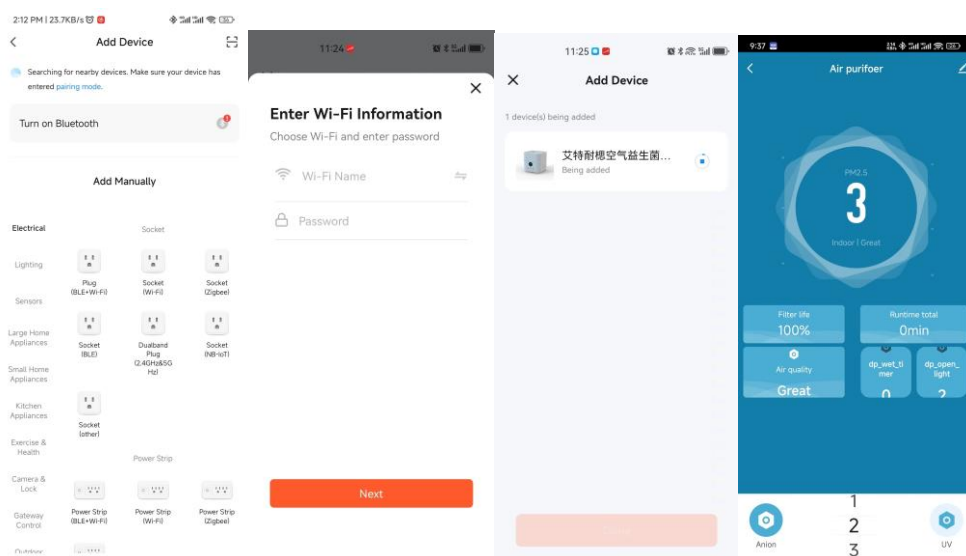

5. Enter the WiFi password to add the device; wait for the addition to be successful.
6. After the addition is successful, enter the operation background, the WiFi icon is always on, and you can use it.
7. The WiFi network will remain unchanged in the future. When you turn on the machine, it will automatically connect to the Internet, and there is no need to configure the network again.

Good air can be seen

Three-in-one ambient light to warm you every night



FCC Caution.

This device complies with part 15 of the FCC Rules. Operation is subject to the following two conditions:

- (1) This device may not cause harmful interference, and
- (2) this device must accept any interference received, including interference that may cause undesired operation.

Any Changes or modifications not expressly approved by the party responsible for compliance

could void the user's authority to operate the equipment.

Note: This equipment has been tested and found to comply with the limits for a Class B digital

device, pursuant to part 15 of the FCC Rules. These limits are designed to provide reasonable protection against harmful interference in a residential installation. This equipment generates uses and can radiate radio frequency energy and, if not installed and used in accordance with the

instructions, may cause harmful interference to radio communications. However, there is no guarantee that interference will not occur in a particular installation. If this equipment does cause harmful interference to radio or television reception, which can be determined by turning

the equipment off and on, the user is encouraged to try to correct the interference by one or more of the following measures:

- Reorient or relocate the receiving antenna.
- Increase the separation between the equipment and receiver.
- Connect the equipment into an outlet on a circuit different from that to which the receiver is connected.
- Consult the dealer or an experienced radio/TV technician for help.

FCC Radiation Exposure Statement:

This equipment complies with FCC radiation exposure limits set forth for an uncontrolled environment. This equipment should be installed and operated with minimum distance 20 cm between the radiator & your body.