

T16

WIRELESS EARBUDS

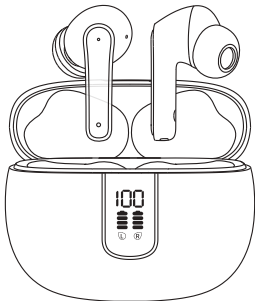

USER MANUAL

Packing List



Charging Case



Earbuds



User Manual



Ear Caps x 6[L\M\S]

NOTE:The medium size is on the earbuds



USB-C Charging Cable

Package Contents:

- A. Charging Case x 1
- B. Earbuds x 2
- C. USB-C Charging Cable x 1
- D. User Manual x 1
- E. Ear Caps x 6[L\M\S]

Warm Tips:

- * Please clean the charging contacts and eartip mesh with alcohol pads regularly to remove dust or earwax that may affect the charging or volume.
- * Please take good care of your earphones, lost earphones will not be covered by the warranty.
- * If there are any questions in the manual that are not answered, please check the product description on Amazon or contact our store's customer service team.

Product Overview

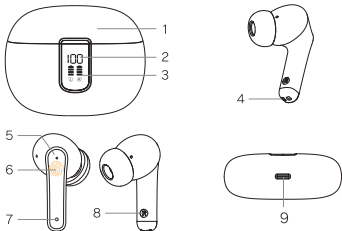

1. Charging Case
2. Charging Case Digital Display
3. Earphone Digital Display
4. Earphone Charging Terminal
5. Earphone Indicator Light
6. Touch Button
7. Microphone
8. L/R Indicator
9. Type-C Charging Port

Power On

Auto Power On:

Take out the earbuds from the charging case, they will power on automatically and prompts "power on, pairing".

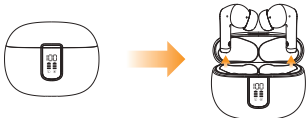

Manual Power On:

When the earbuds are OFF, keep pressing the touch button of L/R earbud for 3 seconds, the green indicator blinks and prompts "power on". (If you want to use two earbuds together, you need to power on them separately.)



Power Off

Method 1

Put the earbuds into the charging case, they will power off automatically.

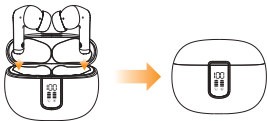

Method 2

When the device is disconnected, press the left or right earbud until the indicator goes off and prompts "power off".

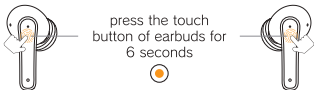

NOTE: In manual power-off state, only two earbuds can be switched off separately.

If the earbuds is away from the phone or the phone's Bluetooth is turned off, earbuds automatically switches off after 5 minutes.

Wear

1. Choose the right ear tip size: Earbuds come with 3 ear tip sizes to accommodate different ear sizes. It's important to choose the right size for your ears, as a loose or tight fit can affect sound quality and comfort.



2. Insert the earbuds correctly: Insert them into your ear canal and twist them slightly to secure them in place. The earbuds should sit comfortably and snugly in your ears, without feeling too tight.

3. Position the earbuds correctly: The earbuds should be positioned diagonally down so that they're pointing towards your ear canal. If they're not positioned correctly, you may experience a loss of sound quality or difficulty keeping them in place.



4. Take breaks: Wearing earbuds for an extended period of time can be uncomfortable and potentially harmful to your ears. Make sure to take breaks every few hours to give your ears a rest.

Pairing

Stereo Mode:

1. Open the charging case and take the earbuds out of the case, the two earbuds will automatically turn on and connect to each other, The master earbud's green indicator blinks to wait to be paired.
2. Turn on your phone's Bluetooth, search for "T16" and select it. The earbuds connect with your phone successfully and prompts "connected" .



Single Earbud Mode:

1. Take an earbud (left/right) out of the charging case.

2. Turn on your phones Bluetooth and select "T16". The earbud connect with your phone successfully and prompt "connected".



NOTE: When there is a pairing record, take one or two earbuds out of the charging case, and the earbuds will automatically connect to the phone.

Phone Calls Control

Answer/ End Calls:

Double tap the touch button of Right or Left earbud.



Reject Calls:

Long press 2s the touch button of Right or Left earbuds.



Music

Play/Pause:

Once tap the touch button of Right or Left earbud.



Next Track:

Double tap the touch button of Right earbud.



Previous Track:

Double tap the touch button of Left earbud.



Volume Up:

Long press the touch button of Right earbud.



Volume Down:

Long press the touch button of Left earbud.



*Volume can be adjusted through the earbuds during a call.

Active Siri

Active Siri:

Triple tap the touch button of Right or Left earbud.



Reset Earbuds

Reset earphones:

In the disconnected state

1. Press the touch button of the right or left earbud 4 times, the earbuds will power off.
2. Put earbuds back to charging case, and delete pairing record on the phone.
3. Repeat the pairing operation.

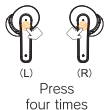

Charging

Digital Charging Display:

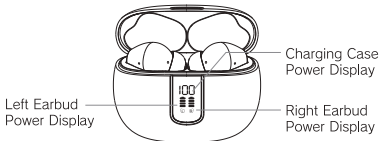

Charging Earbuds:

Put the earbuds into the charging case and close the case. The charging case power display will show the remaining charge level, both right and left earbud power display will flash. The display goes out after 10 seconds.

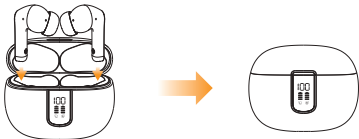

Charging the Charging Case:

When the battery level of the charging case falls below 5%, the power display will flash. Please charge it promptly.

Use the Type-C charging cable (provided) to connect your computer (with power on) or an adapter (not provided) to your charging case. The charging case power display will flash and show 100% after fully charged.

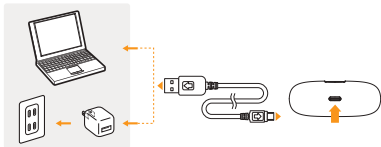

NOTE:

- * Please separate the charging cable and charging case when fully charged.
- * 5V adapter is the best choice for charging to avoid battery damage. Improper current and voltage may damage earbuds and charging case and thus warranty is not valid.

Specification

Model	T16
Version	V5.3
Charging Case Battery Capacity	500mAh
Charging Case Recharging Time	About 2H
Charging Port	Type-C
Operation Way	Touch Control
Working Temperature Range	-10℃ ~ +45℃
Maximum Transmission Range	≤15M (OPEN SPACE)

Safety Instruction

Pay close attention to the surrounding traffic when using it on foot. It may cause traffic accidents.

- Reduce the volume to a minimum before use. Sudden loud noises can damage your hearing.
- To protect your ears, do not turn the volume up too high.
- Stop using this product if it falls into flammable or liquid (such as water). Continued use may result in fire, malfunction or electric shock.
- Opening the inside may result in malfunction or electric shock.
- Do not touch the inside. Also, we cannot guarantee performance if the interior has been manually modified.
- Do not charge with wet hands or touch the charging port. This may result in electric shock.
- If you feel uncomfortable while using this product, stop using it immediately.
- If you are using a medical device such as a pacemaker, consult your doctor before using it.
- Do not allow small children to use it.

Q&A

If you are unable to connect your Bluetooth earphones to your computer or tablet, you can do the following:

1. Make sure your computer's Bluetooth is turned on: If not, turn on Bluetooth and reconnect the earphones.
2. Restart the computer: Please try to restart the computer, and then try to connect the earphones again.
3. Update your computer's Bluetooth driver: If your computer's Bluetooth driver is out of date, this may cause connection problems. Check the manufacturer's website for the latest drivers and install them.
4. Try to connect to another device: If you have another device that can connect to the earphones, such as a smartphone or tablet, try to connect to see if there is a problem with the earphones or computer.
5. Reset the earphones.

Bluetooth earphones can sometimes have trouble connecting to devices. This may be due to interference from other wireless devices, low battery or outdated software. There are several things you can try to improve this situation:

1. Reboot the earphones and the device to be connected.
2. Make sure your earphones are fully charged and in pairing mode, and that your earphones are not automatically connected to another device.
3. Disable any other Bluetooth devices that may interfere

- with the connection or change the usage environment.
4. Check your device for any software updates and install them when available.

The audio quality of Bluetooth earphones may deteriorate over time with use. There may be several reasons for this problem:

1. **Low battery:** Audio quality may be degraded when the earphones' battery are low. This is because when the battery is low, the earphones cannot transmit or receive signals effectively.
2. **Interference:** Bluetooth earphones use radio waves to transmit audio signals. If there are other electronic devices nearby that also use radio waves, such as a Wi-fi router or microwave, they may cause interference and degrade audio quality.
3. **Physical damage:** If the earphones get wet, the internal components may be damaged, which can affect the audio quality.
4. **Connection problems:** Sometimes the Bluetooth connection between the earphones and the paired device can become unstable over time. This can cause audio interruptions or sound distortion.

If you are often accidentally pressing the button on your wireless earphones when you try to adjust them. there are a few things you can do to try to avoid accidentally touching the button:

1. Use a different grip- try adjusting your earphones with a different grip. If you are using your fingers to adjust

them, try using your thumb instead, or vice versa. This might help you avoid accidentally touching the button.

2. Practice adjusting them—spend some time practicing adjusting your earphones so that you can do it without looking at them. This will help you avoid accidentally touching the button because you'll be more aware of where it is.

To improve the audio quality of Bluetooth earphones, try the following:

1. Charge the earphones fully before using them.
2. Clean the charging contacts, and mesh of ear tips with an alcohol pad to remove dust or earwax that might be affecting charging or sound volume.
3. Keep the earphones away from other electronic devices that use radio waves.
4. Avoid exposing the earphones to moisture.

If the charging case is not charging the earphones:

1. Make sure your case is fully charged.
2. Make sure the earbuds are properly plugged in or the case has enough battery to charge the earphones.
3. Check the charging ports on both the earphones and the charging case for any debris or damage. Clean the ports with a soft, dry cloth if necessary.

If you're having trouble charging the case, you can try these methods below:

1. Make sure the charging cable you are using is compatible with the charging case and is not damaged,

if the cable is damaged, try using a different charging cable.

2. Check the charging case and the charging port on the cable for debris or damage. If necessary, clean the ports with a soft, dry cloth.
3. Try using a different power source, such as a different USB port or wall adapter for charging. If the charging case does not use one power source for charging, it can use another power source.
4. We recommend that you use a 5v adapter to avoid damaging the battery.

Why is the play time different from what is described?

1. The volume during use or battery wear after long-term use will affect the duration.
2. After using two earphones at the same time, the power consumption of the main ear is slightly higher and will be the first to deplete the battery.

About waterproofing of the product:

1. Our earbuds allow you to use them in the light rain and during sports, but please do not use them for swimming or showering.
2. The charging case is not waterproof.

If none of the above solutions work or if you receive your package with missing parts or other problems not mentioned, please follow the steps below to contact brand support for further assistance:

1. Go to the Amazon website and log in to your account.

2. Click on the "Orders" button located on the top right corner of the screen.
3. Locate the order that you need help with and click on the "Contact Seller" button.
4. Choose the reason for your inquiry from the drop-down menu and provide a brief description of your issue.
5. Click on the "Send" button to submit your message to us.
6. Alternatively, you can also go to the seller's storefront on Amazon and click on the "Ask a Question" button located on the top right corner of the screen. This will allow you to send a message directly to us.

* It is recommended to be as clear and concise as possible when describing your problem to us, as this will help us understand your problem and provide you with the best solution.

Warning

This device complies with Part 15 of the FCC Rules. Operation is subject to the following two conditions:
(1) this device may not cause harmful interference, and
(2) this device must accept any interference received, including interference that may cause undesired operation.
Changes or modifications not expressly approved by the party responsible for compliance could void the user's authority to operate the equipment.

NOTE: This equipment has been tested and found to comply with the limits for a Class B digital device, pursuant to Part 15 of the FCC Rules. These limits are designed to provide reasonable protection against harmful interference in a residential installation. This equipment generates, uses and can radiate radio frequency energy and, if not installed and used in accordance with the instructions, may cause harmful interference to radio communications. However, there is no guarantee that interference will not occur in a particular installation.

If this equipment does cause harmful interference to radio or television reception which can be determined by turning the equipment off and on, the user is encouraged to try to correct the interference by one or more of the following measures:

- Reorient or relocate the receiving antenna.
- Increase the separation between the equipment and receiver
- Connect the equipment into an outlet on a circuit different from that to which the receiver is connected.
- Consult the dealer or an experienced radio/TV technician for help.

NOTE: This device and its antenna(s) must not be co-located or operation in conjunction with any other antenna or transmitter.

The device has been evaluated to meet general RF exposure requirement. The device can be used in portable exposure condition without restriction.

尺寸：60*70

材质：105g铜版纸

装订方式：20p骑马订