

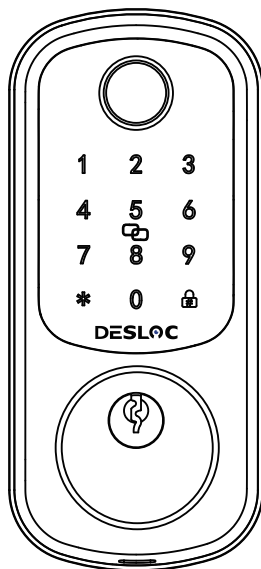

USER MANUAL

Deadbolt



// Product Details

Exterior lock:

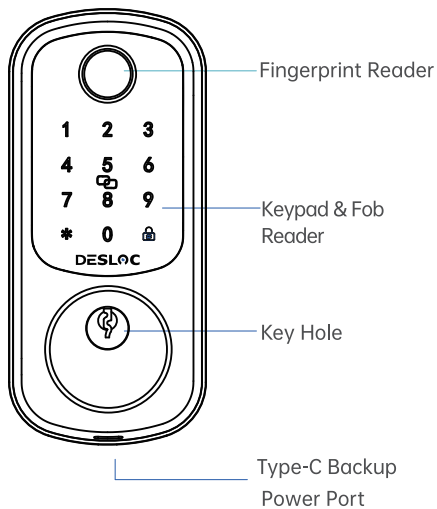

Interior lock:

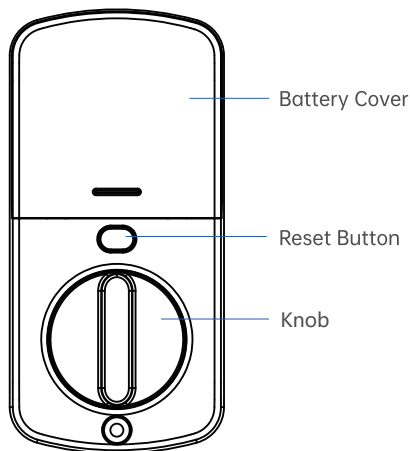

// What's included for installation



a. Exterior lock

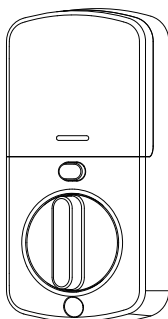

b. Interior lock

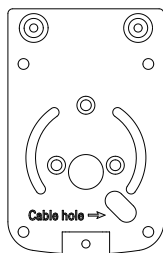

c. Mounting Plate

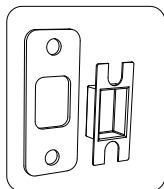

d. Strike Plate

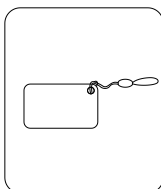

e. IC Card

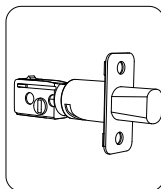

f. Deadbolt

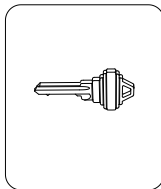

g. Mechanical key

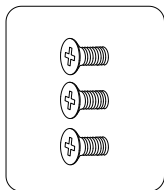

h. Interior Lock
Screws

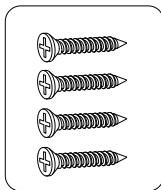

i. Deadbolt/Strike
Plate Screws

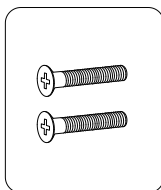

j. Mounting
Plate Screws

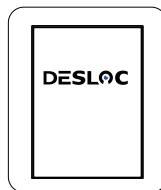

k. User Manual

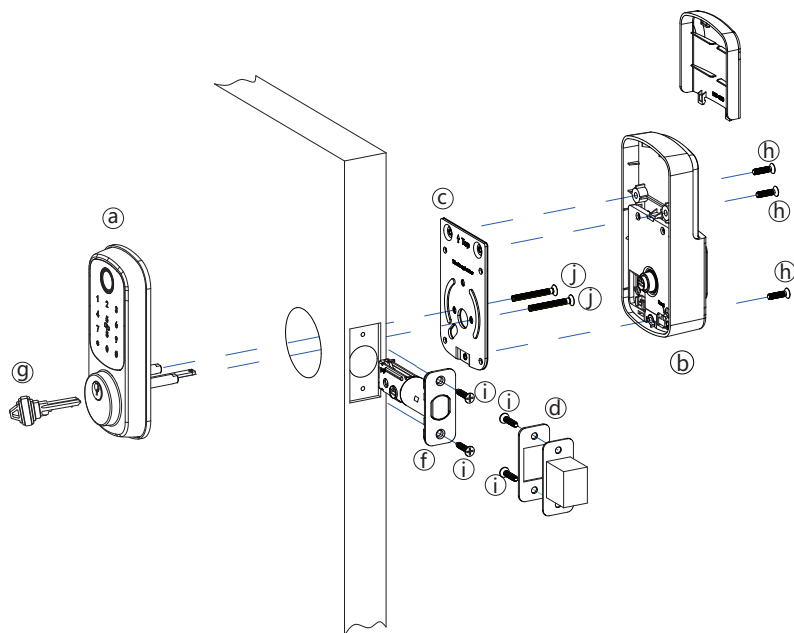

// Product Details

Category	Detailed parameters
The power supply voltage	DC 4.5V ~ 6.0V
Low voltage alarm voltage	4.8V±0.1V
Standby current	90μA
Working current	< 400mA
Working temperature	-30°C ~ +70°C
The keyboard type	Capacitive touch keyboard
Fingerprint type	Capacitive semiconductor sensor
Unlock modes	Fingerprint/Password/APP control/IC card /Mechanical key/eKey/Alexa

// How to Install the Lock

1. Measure the Door Size

Make sure door thickness is 1-3/8" to 2", door hole diameter is 2-1/8", measure backset size is 2-3/8" or 2-3/4" with the deadbolt.

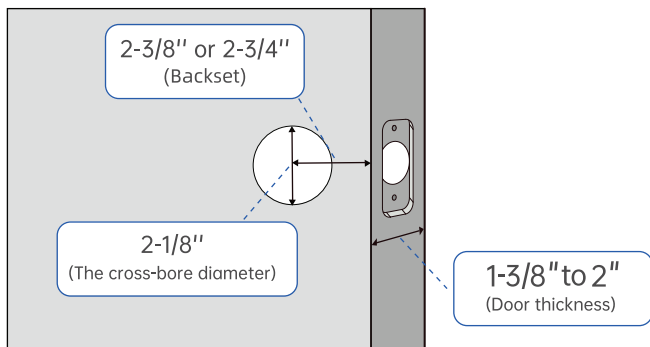

2. Adjust the Length of the Deadbolt

Check your door to see if the deadbolt requires adjustment. If the backset is 70 mm, turn the faceplate 180° to extend the length.

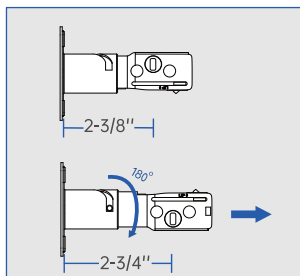

3. Install Deadbolt

Fix the deadbolt with 2pcs deadbolt screws ①, keep the deadbolt in retracted status.

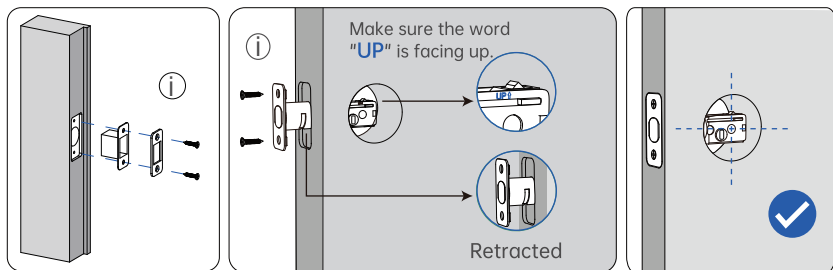

4. Install Exterior Lock

Route the cable below the deadbolt, paddle must be in 'vertical' status.

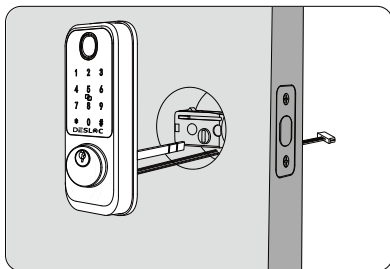

Route the IC cable below the deadbolt.

NOTE: Do not insert the key during the installation.

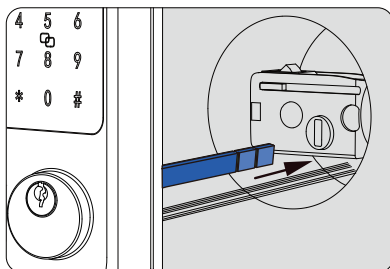

NOTE: deadbolt must be in unlock position and the paddle must be in 'vertical' status.

5. Fix the Mounting Plate

- Peel the tape off the mounting board, route the cable through the hole in the mounting plate, word with "Cable Hole" should face outside.
- Fix the plate with 2pcs mounting plate screws ①.

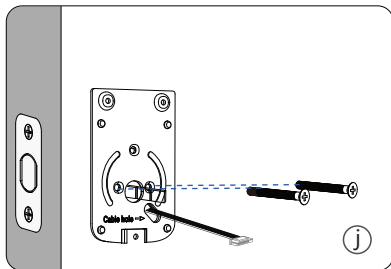
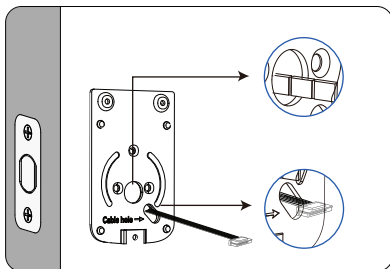

6. Install the Interior Lock

- Connect the cable tightly.
- Rotate the door knob in vertical position and insert the paddle (Don't load batteries until lock is completely installed).

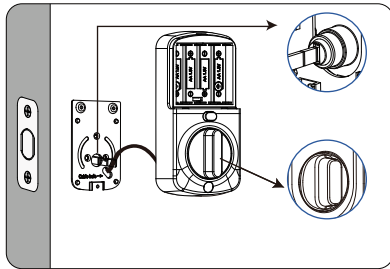
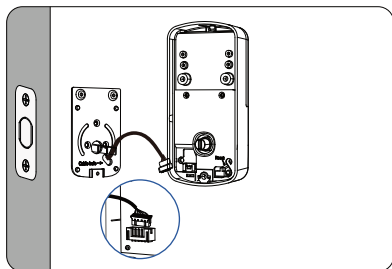

Note: When pressing the indoor panel against the door, please try to hide the wires inside the door as much as possible, or place them in the designated wire-housing areas of the indoor panel.

7. Fix Interior Lock

- Open the battery cover.
- Secure the lock with 3pcs interior lock screws.
- Test the lock by rotating the door knob to see if the deadbolt can be extended and retracted smoothly ^h.

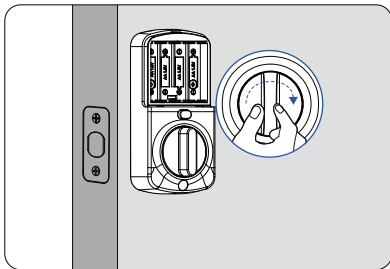
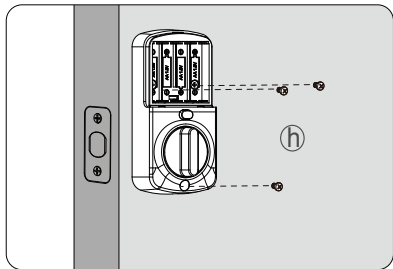

8. Install Batteries

Please install 4 pcs AA batteries in unlock status and keep the door open to avoid being locked out.

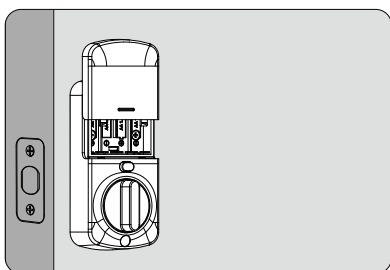
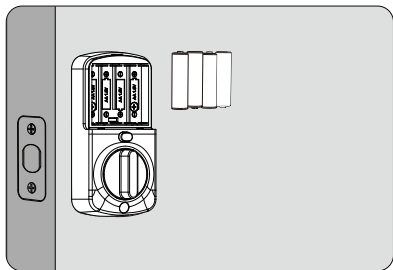

// Detect Left/Right Hand Door

Set left/right hand door

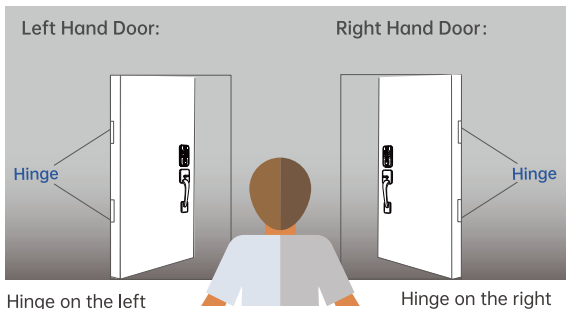

The most important step is to adjust this smart lock 'door opening direction' by phone App or programming code. Recommend to use TT lock App on phone for easier setting.

How to know your door opening direction?

Standing outside of your door(Facing the keypad), locate the door hinge.

Hinge is on the left

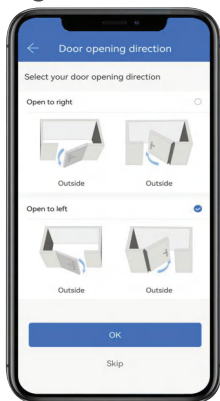

Hinge is on the right

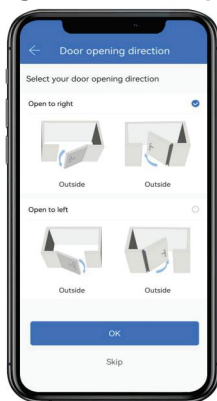



Scan me

APP download:



NOTE:

1. Please register a TT Lock account and make sure the lock is paired with TT Lock App before you set the 'door opening direction' on the phone.
2. Detailed steps about programming code can be seen on Page 27-28.

// How to Reset the Lock

Reset method 1:(Recommend)

1. Take down one battery and wait for 5 seconds.
2. Put the battery back.
3. Long press the reset button for 10 seconds while the keypad lighting up.
4. After hearing "Please input the initialization password", enter 000#.
5. After hearing "Administrator deleted successfully", reset successfully.

NOTE: If method 1 doesn't work, please try method 2 or contact customer service for help.

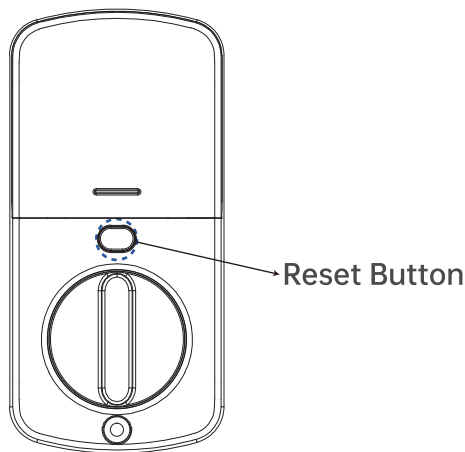

Reset method 2:

- (1) Uninstall the back lock by taking down the battery cover. take out the 3 screws on the back lock.
- (2) Load the batteries.
- (3) Hold the Reset Button (The position is shown below)for 5 seconds. You'll hear the sound"Input initialization passcode" from the lock.
- (4) Input 000# on the keypad after the sound. You'll hear "Administrator deleted successfully", which means reset successfully.

NOTE: If this method doesn't work, please contact customer service.

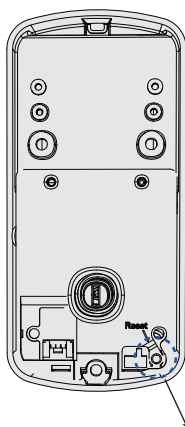

Reset Button

Quick Guide of Use the Lock

Your lock is now installed! Let's learn to use it!

Unlock the door from outside

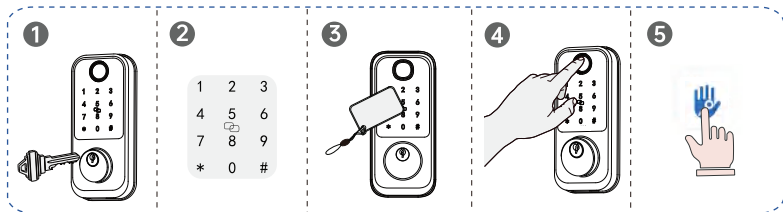

Unlock the door from inside

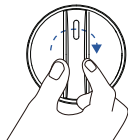

Rotate the turn piece to unlock position



TT Lock App

Lock the door from outside

1. Hold "#" on the keypad for 2S.
2. In auto lock mode, the bolt will extend out automatically.
3. Lock with physical keys.
4. Lock by App on the phone.

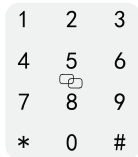

Lock the door from inside

1. Rotate the turn piece to lock position.
2. Lock by App on the phone.

// How to Use it by App

(1) Account Registration

① Download the Smart Lock app from Google play or APP Store.

② Search "TT Lock".



③ Click register to get started.

④ Enter the email or phone number (e.g.8669859909), and set the password, click Get Code and enter the verification code(Please select the correct Country/Region).

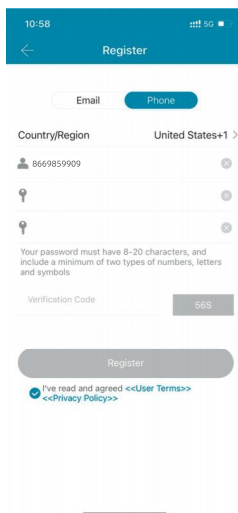
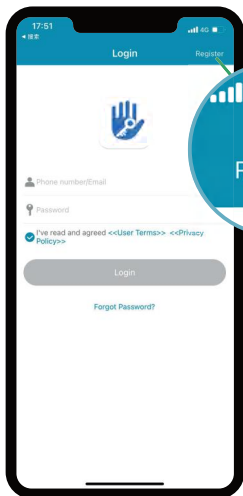

// How to Use it by App

(2) Pair the lock and TT Lock App

Step 1: Click "Big Plus", please make sure your phone bluetooth is turned on, and make sure you are nearby the lock within 3 meters.

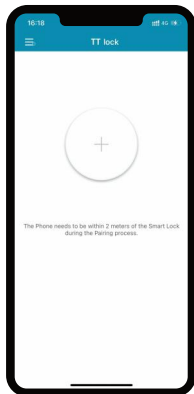

Step 2: Touch the keypad and click "Next".

Step 3: Click the blue plus sign to add the lock, please name the lock like "front door".



Touch any key to Activate the Keypad



Please touch any key to Activate the Lock and put it in PAIRING Mode. Press Next

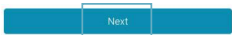

	M302_fc5c46	
	M302_e7ba71	
	M302_b113c8(Added)	
	M515_c31e1	
	M203T_ded38	
	M203T_9a2fa0	
	M203T_89e506	
	M203T_5f4202	
	M302_061385	

// How to Use it by App

(3) Modify Admin Passcode

Step 4:

NOTE: The default code(123456#) will be invalid after pairing successfully

Set your new Admin passcodes: Click settings > Basics > Admin Passcode.

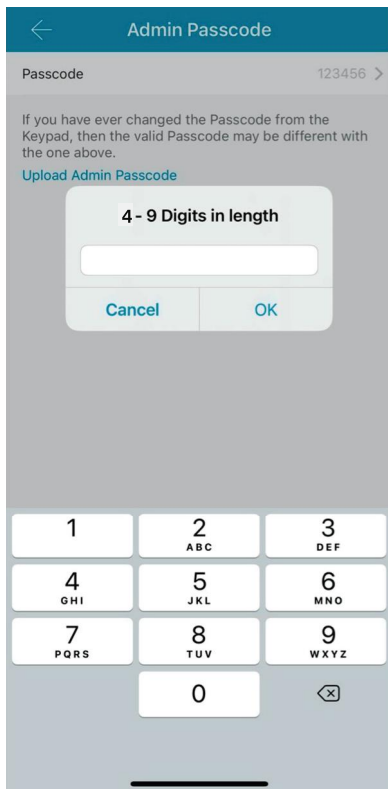
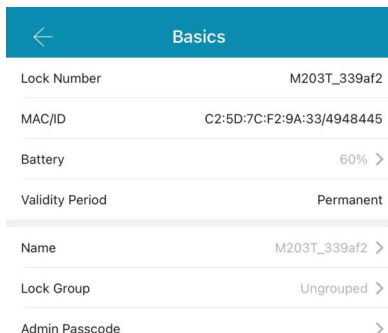

// How to Use it by App

(4) App Features Overview

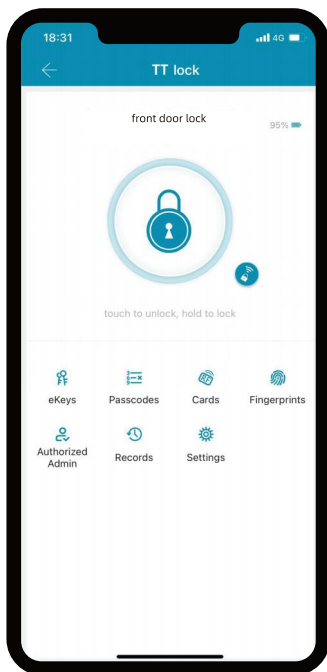

Unlock/Lock

Unlock/Lock using phone's bluetooth



Remote Unlock

Unlock remotely if G2 Gateway is connected nearby



eKeys

Others can control the lock via the app



Passcodes

Generate 5 different types of passcodes



Cards

Set up your fobs here



Fingerprints

Set up fingerprints



Authorized Admin

Create and edit admins



Records

View entry times, attempts and methods
Set auto lock and passage mode here



Settings

// How to Use it by App

(5) Unlock/Lock by App

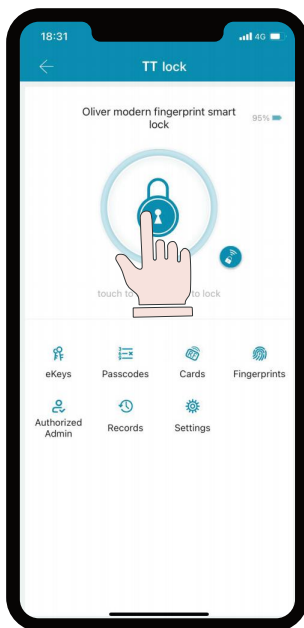

Unlock: Tap this big icon once.
Lock: Press this big icon for seconds.



Tap to remotely unlock
(Need extra G2 gateway, sold seperately)

// How to Use it by App

(6) Share Ekeys

NOTE: eKeys are different from passcodes. eKeys require the other user to download the TT lock app and then they can lock/unlock by APP too`

Step1: eKeys works by sharing app access of your lock with another TT lock account. eKey recipients will also be able to use their phone to unlock/lock the smart lock.

Step2: Enter recipient's account, it can be the phone number or email address used during registration.

Step3: The recipient needs to log into their tt lock account, then they can find the code in their messages and gain the privilege to lock/unlock.

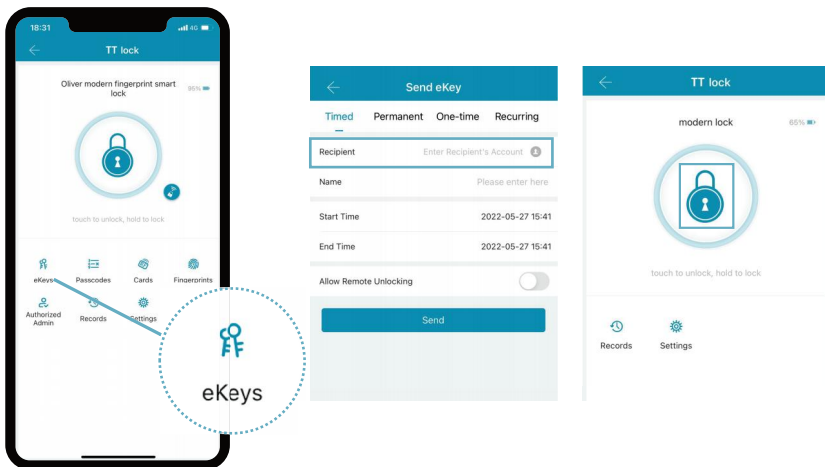

// How to Use it by App

(7) Share Passcodes

Step1: Click passcodes to code page.

Step2: Click generate passcode.

Step3: Name your code > set time duration > set 4-9 digits code> click generate(set passcode).

NOTE: To generate custom codes or change any type codes, please make sure you are nearby the lock within 3 meters and the bluetooth is turned on, unless you have the G2 gateway and it is connected.

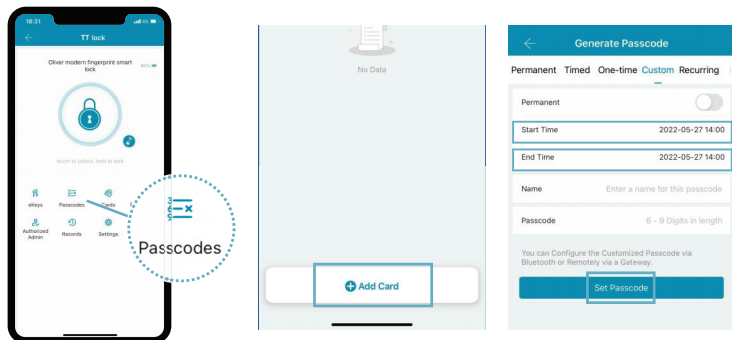

Here are some illustrations for 6 different codes.

Permanent	Lasts permanently
Timed	Lasts between selected hours
One-time	Lasts for one use
Erase	Erases all codes on lock
Custom	Set your own digits such as 123456 (permanent or timed)
Recurring	Lasts during scheduled hours weekly

// How to Use it by App

(8) Set IC cards

- ① Click "Cards".
- ② Click "Add Card".
- ③ Set up the valid period of the IC card.
- ④ Once the lock says "Please swipe your card" > place the IC card against 5 on the keypad.
- ⑤ If you hear prompt voice "input successful", the IC card can be used to unlock your door.

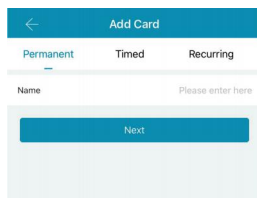
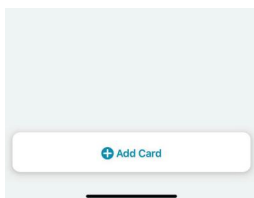
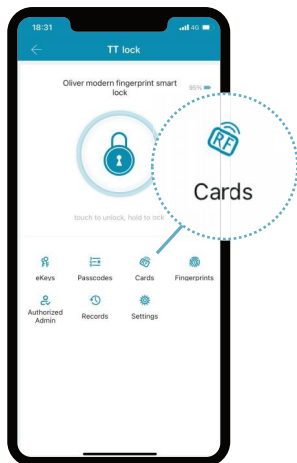

// How to Use it by App

(9) Add Fingerprints

Step1: Tap on "Fingerprints".

Step2: Tap on "Add Fingerprints".

Step3: Set up the validity period of the fingerprint.

Step4: Follow instructions on app, you will be asked to place your finger on the sensor 4 times.

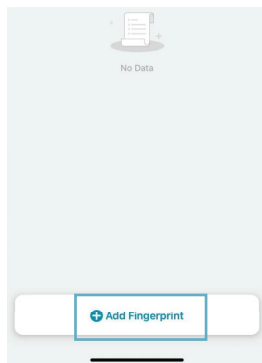
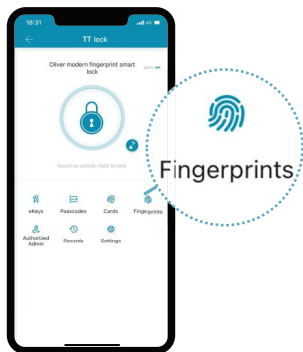

←

Add Fingerprint

Permanent

Timed

Recurring

Name

Please enter here

Start Time

2022-06-17 14:14

End Time

2022-06-17 14:14

Next



// How to Use it by App

(10) Authorized Admin

NOTE: Authorized Admin is similar to eKeys but has more rights than eKeys.

An authorized admin can do the following:

- ① Unlock/lock via the app.
- ② Generate/edit/delete passcodes/IC card/fingerprints.
- ③ Adjust settings like passage mode, auto-lock timer, and turn on/off the lock sound.

Step1: Click Authorized Admin.

Step2: Enter recipient's account, it can be the phone number or email address used during registration.

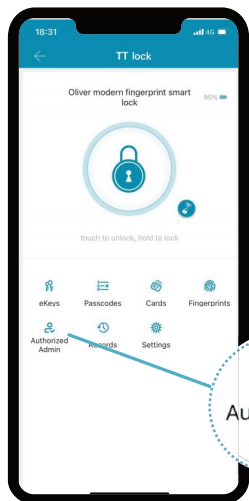

Admin eKey	
Timed	Permanent
Recipient	Enter Recipient's Account
Name	Please enter here
Start Time	2022-05-27 15:57
End Time	2022-05-27 15:57
<button>Send</button>	

// How to Use it by App

(11) Auto Lock/ Passage Mode

Auto Lock: Tap "Settings" > Tap "Auto Lock" > Auto-lock will automatically lock the door when it has be opened after 5 seconds by default.

Passage Mode: Tap "Settings" > Tap "Passage Mode" > set up the specific time period > During the specific time period, the lock remain unlocked until it is manually locked(Auto lock will be disabled during Passage Mode validity period).

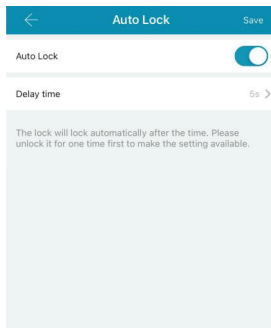
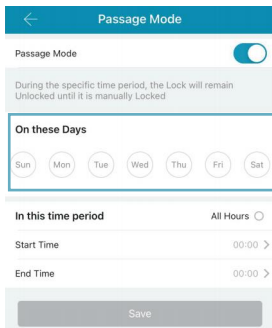
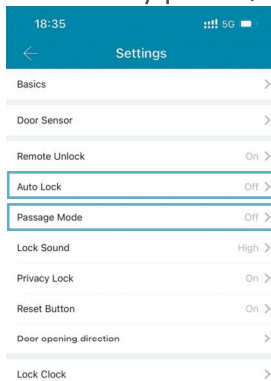
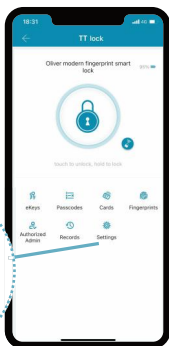
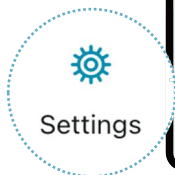

// How to Use it by App

(12) Lock Setting

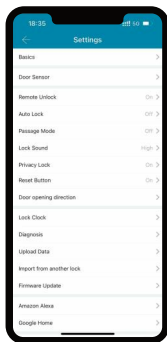

Basic: You can view and Lock basic information, lock name etc.

Door Sensor: You will be able to get door status and auto-lock the door with a door sensor (Sold separately).

Remote Unlock: Allows you to unlock the smart lock remotely via a gateway (Sold separately). This feature can only be turned on/off via Bluetooth.

Lock Sound: Turn on/off the sound of the lock. Adjust the lock prompt voice volume.

Door opening direction: If your door lock/unlock result is opposite as expected, you can change this feature.

Import from another lock: Allows for the transfer of eKeys, authorized Admin, passcodes and IC cards from one lock to another.

Privacy Lock: Turn on/off via the reset button on the back panel. This function prevent someone unlock from outside.

Reset Button: Turn on/off the reset function via the reset button on the back panel.

// How to Pair Gateway, Alexa

(1) Pair the Gateway

① After pairing, check the signal: click "Gateway" > choose the gateway connected > Nearby locks > check if the signal is strong > move the gateway closer to lock if the signal is weak. Please make sure the distance between the gateway and the smart lock is within 16feet, and make sure your phone and the gateway are connected to the same WiFi(The gateway only works with 2.4 GHz WiFi).

If you have 5G Wi-Fi, you can set and add 2.4Ghz Wi-Fi by dual band router.

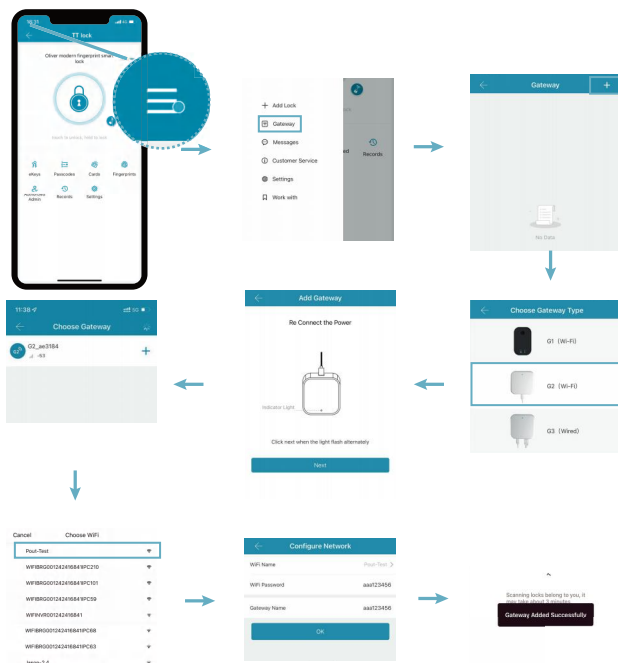

// How to Pair Gateway, Alexa

(2) Pair the Alexa

Hit setting (on the upper right)> Turn on the "unlock by voice", set the code for unlocking by voice every time.

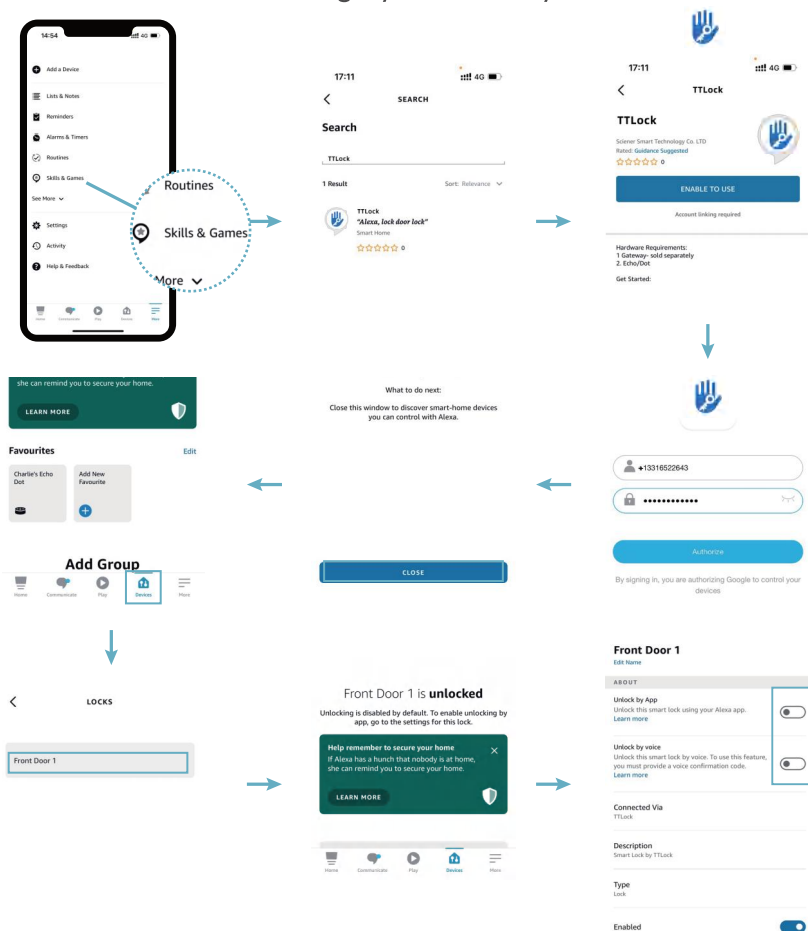

// How to Program by Keypad

* : Return to the previous step

: Press 1 second to confirm; long press for 2 seconds to lock the door

Default admin passcode: 123456#

Type	Method
Modify Admin Passcode	A:*12# > default admin passcode# > new admin passcode# > new admin passcode# B: Go to tt Lock App > Settings > Basics > Admin code > Modify New passcode
Set General Passcode	*85#admin passcode#new passcode
Modify General Passcodes	*10#original passcode#new passcode#new passcode#
Set Fingerprints	*85#admin passcode#collect fingerprints
Set IC cards	*85#admin passcode#add IC cards
Delete all Passcodes	*71#admin passcode#(note: admin passcode won't be deleted)
Delete all Fingerprints	*70#admin passcode#
Delete all IC cards	*69#admin passcode#
Delete single passcode	*72#admin passcode#the passcode you want to delete#

Type	Method
Set left hand lock	Standing outside of the door(facing the keypad), if the door hinge is on the left side: *46#Admin Password#1#
Set right hand lock	Standing outside of the door(facing the keypad), if the door hinge is on the right side: *46#Admin Password#2#
Open the door temporarily	Input 123# after unlock the door
Auto Lock	*21#admin passcode#1-900#(1-900 seconds is the auto lock time)
Turn on / Turn off the lock voice	*30#admin passcode#1#(turn on) #0#(turn off)
Set English as language	*39#admin passcode#2#

1. Installation

Questions	Answers
How to adjust left or right hand door?	A.Go to TT Lock App > setting > door opening direction > choose left or right hand door
How to modify passcode?	A.Go to TT Lock App > setting > basics > admin passcode>modify
How to set auto-lock timer?	A.Go to TT Lock App > setting > Auto lock > set timer B.After setting, lock the door from inside manually 1 time so it can be acticated. NOTE: Auto lock only trigged when you use digital unlock like fingerprint/keypad/TT Lock. It won't work if unlock manually.
How to make sure the door is open in a specific time?	A.Go to TT Lock App > setting > passage mode > set timer B.After setting, unlock the door from inside manually 1 time so it can be acticated. Note: passage mode only trigged when you use digital lock like fingerprint/keypad/TT Lock. It won't work if lock manually.
Why the deadbolt can't fully retracted?	Please follow the steps to re-install the lock correctly.
When I unlock/lock the door by fingerprints or passcodes, the lock doesn't work?	Please check if the motor make sounds when you unlock or lock by keypad or fingerprints. If motor doesn't make sounds, please contact our customer service team.

Questions	Answers
Can I remotely share a guest passcode/share E-key/share admin to visitors?	Yes, you can generate remotely and share the passcode/share e-Key/share admin to visitors even far away from the home (without Wi-Fi). NOTE: Only changing Custom Code needs to turn on the bluetooth and near to the lock or G2 gateway.
What if the batteries ran out, can I still use the key to enter?	Yes, you can open the lock with a mechanical key, and you can also use a type-C cable connecting the lock to charge it.
Why can't I unlock/lock by Wi-Fi on the phone?	You can unlock/lock by bluetooth on the phone. Wi-Fi unlock/lock remotely require to purchase an extra G2 gateway (sold separately).
Why can't i connect it with Alexa or Google assistant?	A.Make sure you purchased the G2 gateway. (sold separately). B.Follow the steps to Connect the G2 gateway correctly,make sure the gateway status is 'online' and the signal is 'strong'(check this on TT Lock app). 3.Follow the steps to connect the Alexa or google assistant correctly.
Fingerprints is not sensitive and seldom works.	A: Delete the fingerprint and add it again. B: Go to TT Lock App > fingerprints > choose to delete > add the new one. C: Completely put your finger on the reader and let it to collect more angles of your finger.
Why i can't register my account on TT Lock app with my phone number?	Please choose the country code as a prefix, for instance, United States country code is +1, then input your phone number.

Questions	Answers
Can not pair the lock with APP.	<p>A: Turn on the Bluetooth and near your lock > Open the TT Lock App > Click "+" button > Choose "All Locks" > Touch the lock keypad to lit up it > Click the "+" to add the lock while wake up the keypad.</p> <p>B: If no lock shows up(all gray), please reset your lock.</p> <p>C: Follow the above steps to add the lock again after the reset.</p> <p>NOTE: Reset steps can be found on page 10</p>
After replacing the new battery, the App shows that the batter level is incorrect.	<p>A: Go to TT Lock APP > Go to the Settings (main page) > Basics > Battery > Update.</p> <p>B: If it still fails, Open the TT Lock App > Click Settings > Click Basic > Lock Number, and send it to the customer service to update.</p>
How to lock/unlock via keypad?	<p>Lock: Wake up the keypad and press the # for 2 seconds.</p> <p>Unlock: Wake up the keypad, input passcodes#.</p>
The lock works backwards. Lock turns unlock while unlock turns lock.	<p>Go to TT Lock APP > Settings > Door opening direction > Open to right/left.</p>

This equipment complies with FCC radiation exposure limits set forth for an uncontrolled environment. This equipment should be installed and operated with minimum distance 20cm between the radiator & your body.

DESLOC



12-month warranty



+1 (888) 572 6136



support@desloc.com



www.desloc.com