

JETSON

**CONFIDENTIAL FILE INFORMATION
THIS PAGE NOT FOR PRINT**

DATE: 08/07/2024
FILE NAME: Loomis-manual-2024.indd
PAGE SIZE: L5.5" * H4.25" | L13.97cm * H10.795cm
BOOKLET FORMAT; SADDLE STITCHED BINDING
BLEED: .125" on all sides

PRINTER SPECIFICATIONS

SCALE: 100%
MATERIALS:
• 250g C2S
• Printed double sided: 4C



此页不印刷
形式: 骑马钉 (52P)
尺寸: 140x110mm
材质: 120g双铜
工艺: 四色 双面印刷, 封面覆哑膜

DO NOT PRINT COMMENT, SCORING OR DIELINES LAYERS!

Physical sample according to specs must be approved by
JETSON Bike before proceeding to production.
COMMENTS (Internal reference only)
File created by Day Chae, Jangmu Lama & Angelina
Zavilevich

JETSON

Loomis
Electric Scooter

A guide for your ride.

IMPORTANT: READ CAREFULLY AND RETAIN FOR FUTURE REFERENCE.

MODEL SKU: JLOOMS-GRY

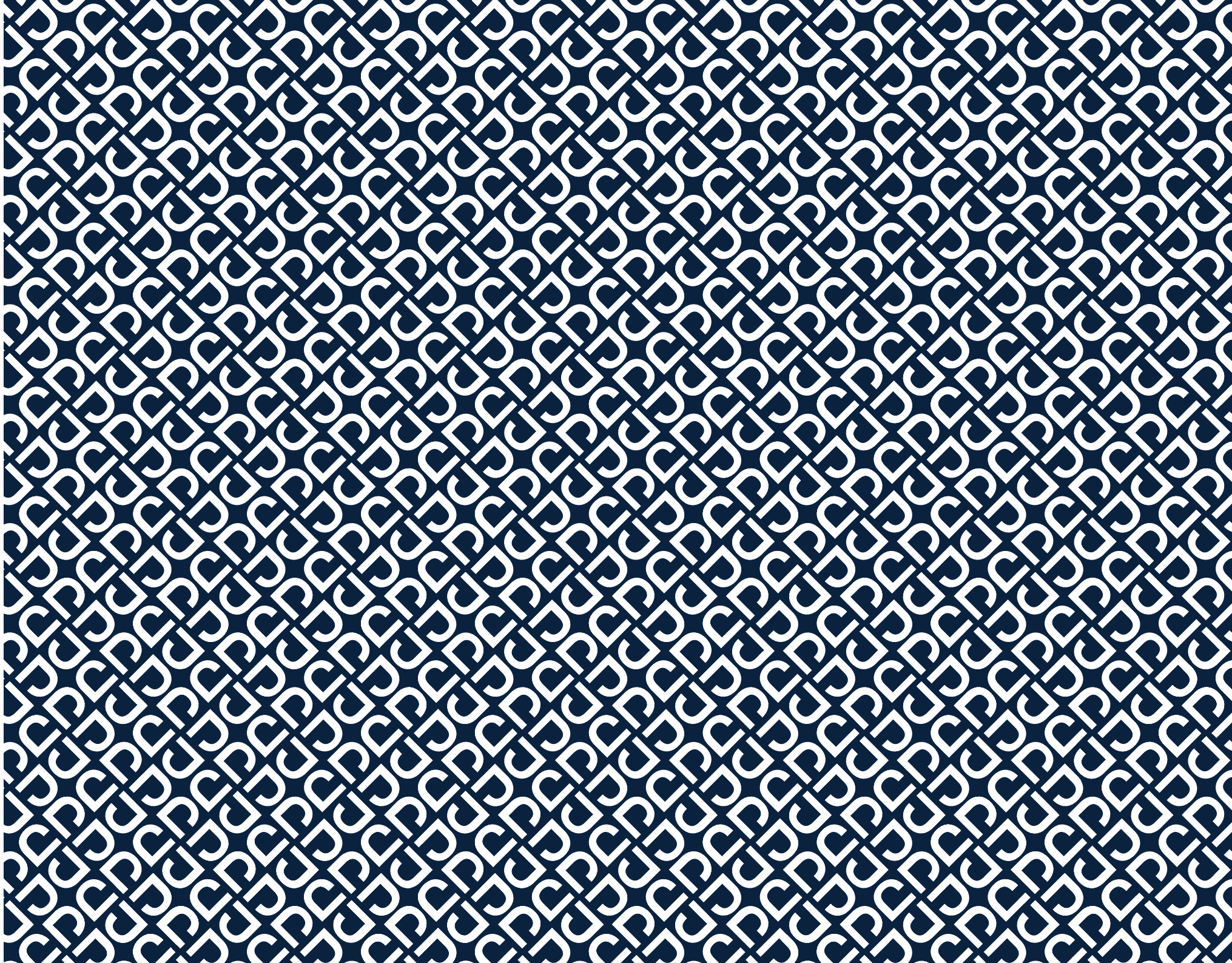

Jetson's top two riding rules:
Be safe. Have fun!

Contents

Safety Warnings	4
Warranty Coverage	6
1. About Your Product	
1.1 Product Overview	8
1.2 Product Specs	10
1.3 Online Resources	11
2. Getting Started	
2.1 Starting Notes	12
2.2 Assembling the Handlebar	13
2.3 Charging the Battery	18
3. Features & Functions	
3.1 Folding & Unfolding the Scooter	21
3.2 Powering On & Off	32
3.3 Using Speed Modes	34
3.4 Checking Battery Charge Level	35
3.5 Using the LED Lights	36
3.6 Using the Bluetooth® Speaker	36
3.7 Using the Bell	37

3.8 Using the Kickstand	38
4. Making Moves	
4.1 Using the Brake	40
4.2 Riding the Loomis	41
4.3 Maximizing Speed & Riding Range	42
5. Safe Journeying	
5.1 Pre-Ride Safety Checks	43
5.2 Helmet Safety	44
5.3 Care & Maintenance	45

Safety Warnings

- Before use, please read the user manual and safety warnings carefully, and make sure you understand and accept all the safety instructions. The user will be responsible for any loss or damage caused by improper use. Warning the risk of injury to rider that can result from over tightening stem-to-fork bolts.
- **Failure to use correct charger can result in fire and explosion, resulting in property damage, injury, and death.**
- Before each cycle of operation, the operator shall perform the preoperation checks specified by the manufacturer: That all guards and pads originally supplied by the manufacturer are in proper place and in serviceable condition; That the braking system is functioning properly; That any and all axle guards, chain guards, or other covers or guards supplied by the manufacturer are in place and in serviceable condition; That tires are in good condition, inflated properly, and have sufficient tread remaining; The area that the product is to be operated should be safe and suitable for safe operation.
- Components shall be maintained and repaired in accordance with the manufacturer's specifications and using only the manufacturer's authorized replacement parts with installation performed by dealers or other skilled persons.
- Warning against recharging non-rechargeable batteries.
- Don't allow hands, feet, hair, body parts, clothing, or similar articles to come in contact with moving parts, wheels, or drive train, while the motor is running.
- This product should not be used by children or persons with reduced physical, sensory or mental capabilities, or lack of experience and knowledge, unless they have been given supervision or instruction (IEC 60335-1/A2:2006).
- Unsupervised children should not play with the product (IEC 60335-1/A2:2006).
- Adult supervision is required.
- The rider should not exceed 220 lb.
- Units shall not be operated to perform racing, stunt riding, or other maneuvers, which may cause loss of control, or may cause uncontrolled operator/passenger actions or reactions.
- Never use near motor vehicles.
- Avoid sharp bumps, drainage grates, and sudden surface changes. Scooter may suddenly stop.
- Avoid streets and surfaces with water, sand, gravel, dirt, leaves, and other debris. Wet weather impairs traction, braking, and visibility.
- Avoid riding around flammable gas, steam, liquid, or dust that could cause fire.
- Operators shall adhere to all of the manufacturer's recommendations and instructions, as well as comply with all laws and ordinances: Units without headlights shall be operated only with adequate daylight conditions of visibility, and; Owners shall be encouraged to highlight (for conspicuity) using lighting, reflectors, and for low-riding units, signal flags on flexible poles.
- Persons with the following conditions shall be cautioned not to operate: Those with heart conditions; Pregnant women; Persons with head, back, or neck ailments, or prior surgeries to those areas of the body; and persons with any mental or physical conditions that may make them susceptible to injury or impair their physical dexterity or mental capabilities to recognize, understand, and perform all of the safety instructions and to be able to assume the hazards inherent in unit use.
- Do not ride at night.
- Do not ride after drinking or taking prescription medication.
- Do not carry items when riding.
- Never operate the product barefooted.
- Always wear shoes and keep shoelaces tied.
- Make sure your feet are always placed securely on the deck.
- Operators always shall use appropriate protective clothing, including but not limited to a helmet, with appropriate certification, and any other equipment recommended by the manufacturer: Always wear protective equipment such as helmet, knee pads, and elbow pads.
- Always give way to pedestrians.
- Be alert to things in front and far away from you.
- Do not allow distractions when riding, such as answering the phone or engaging in any other activities.
- The product cannot be ridden by more than one person.
- When you ride the product along with other riders, always keep a safe distance to avoid a collision.
- When turning, be sure to maintain your balance.
- Riding with improperly adjusted brakes is dangerous and can result in serious injury or death.
- The brake may become hot while operating, do not touch the brake with your bare skin.
- Applying brakes too hard or too suddenly can lock up a wheel, which could cause you to lose control and fall. Sudden or excessive application of the brake may

result in injury or death.

- If the brake loosens, please adjust with the hexagon wrench, or please contact the Jetson Care Team.
 - Replace worn or broken parts immediately.
 - Check whether all safety labels are in place and understood before riding.
 - The owner shall allow the use and operation of the unit after a demonstration that such operators can understand and operate all components of the unit before use.
 - Do not ride without proper training. Do not ride at high speeds, on uneven terrain, or on slopes. Do not perform stunts or turn abruptly.
- Recommended for indoor use.
- Prolonged exposure to UV rays, rain and the elements may damage the enclosure materials, store indoors when not in use.
 - Lubricating the scooter is not required.
 - WARNING – Risk of Fire, No User Serviceable Parts

MODIFICATIONS

Do not attempt to disassemble, modify, repair, or replace the unit or any components of the unit without instruction from the Jetson Care Team. This will void any warranty, and can lead to malfunctions which may cause injury.

ADDITIONAL OPERATION PRECAUTIONS

Do not lift the product off the ground while it is on and the wheels are in motion. This can result in freely spinning wheels, which may cause injury to yourself or others nearby. Do not jump on or off the product, and do not jump while using it. Always keep your feet firmly planted on the foot rest while in operation.

Devices are not intended for use at elevations greater than 2000 m above sea level.

DISPOSAL OF USED BATTERY



Battery may contain hazardous substances which could endanger the environment and human health. This symbol marked on the battery and/ or packaging indicates that used battery shall not be treated as municipal waste. Batteries should be disposed of at an appropriate collection point for recycling. By ensuring the used batteries are disposed of correctly, you will help preventing potential negative consequences for the environment and human health. The recycling of materials will help to conserve natural resources. For more information about recycling of used batteries, please contact your local municipality waste disposal service.

This device complies with Part 15 of the FCC Rules. Operation is subject to the following two conditions: (1) This device may not cause harmful interference, and (2) this device must accept any interference received, including interference that may cause undesired operation.

California Proposition 65

WARNING:

This product can expose you to chemicals including Cadmium, which is known to the State of California to cause cancer and birth defects or other reproductive harm. For more information go to: www.P65Warnings.ca.gov.

Warranty Coverage

GENERAL LIMITED WARRANTY

Your new Jetson product is warranted against defects in materials and workmanship as indicated on ridejetson.com/warranty for a period of time from the date of original retail purchase when used in accordance with Jetson's user manuals (refer to ridejetson.com/support). **Under this warranty, you will be able to direct your claims to Jetson even in situations where you purchased the Jetson Product from one of our authorized retailers.** To read the full terms of our warranty, visit ridejetson.com/warranty.

1. About Your Product

1.1 Product Overview

- | | | |
|--------------------------------|------------------|--|
| 1. HANDLEBAR* | 3. FOLDING HOOK* | 10. BATTERY CHARGING PORT WITH COVER |
| A. E-BRAKE | 4. FOLDING LATCH | 11. LED LIGHTS |
| B. BELL | 5. FRONT FORK | 12. REAR WHEEL |
| C. ACCELERATION THUMB THROTTLE | 6. FRONT WHEEL | 13. BATTERY CHARGE INDICATOR LIGHT (B) |
| D. LIGHTING BUTTON | (MOTOR WHEEL) | 14. SPEED MODE INDICATOR LIGHT (S) |
| E. POWER BUTTON | 7. KICKSTAND | 15. REFLECTOR |
| F. FOLDING HOOK CATCH | 8. DECK | 16. CHARGER |
| 2. STEM | 9. REAR FENDER | |

TOOLS INCLUDED FOR ASSEMBLY AND MAINTENANCE:



*REQUIRES ASSEMBLY.

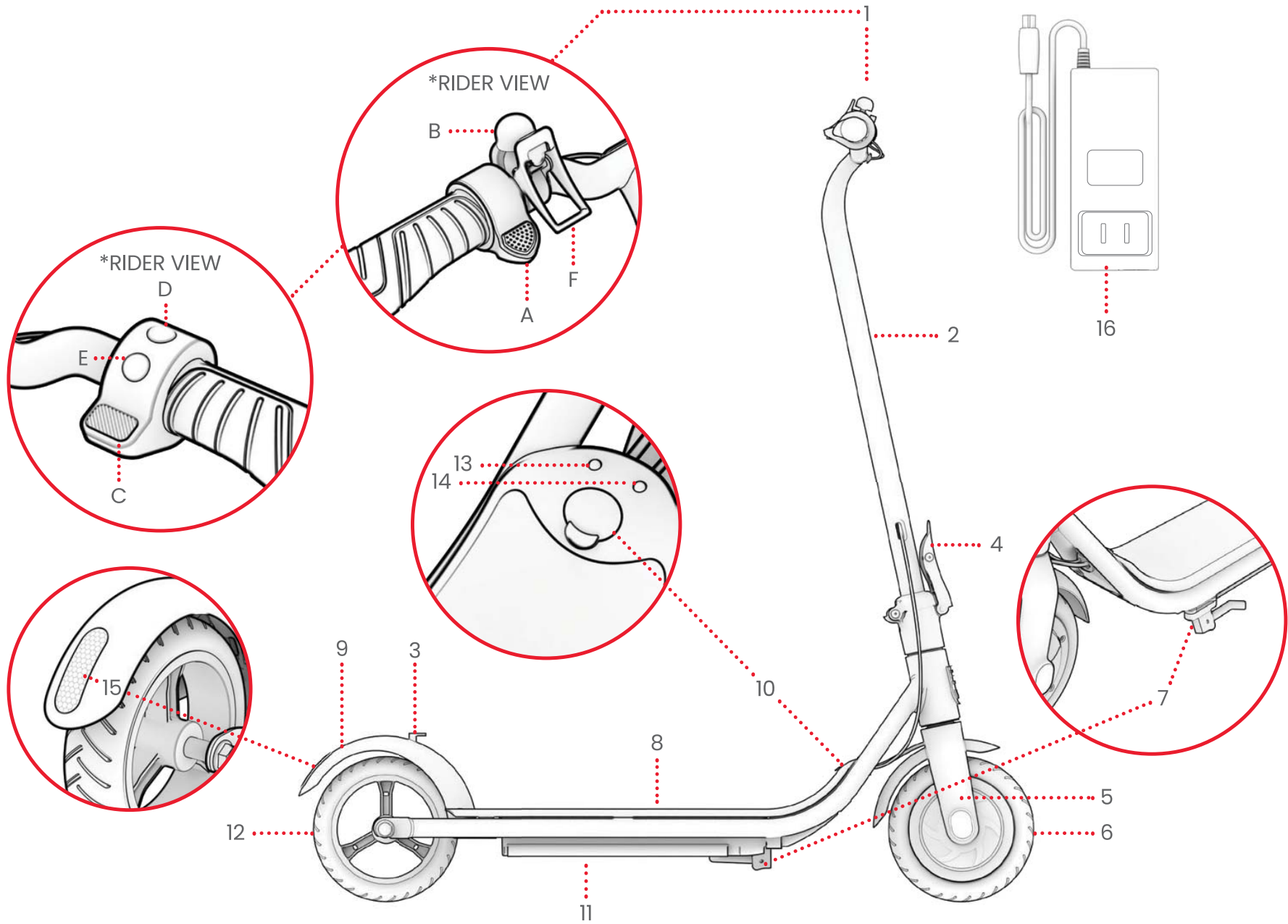

NOTE: IMAGES MAY NOT REFLECT EXACT APPEARANCE OF ACTUAL PRODUCT.

1.2 Product Specs

- PRODUCT DIMENSIONS, UNFOLDED : 36.8" (L) × 16.9" (W) × 40.3" (H)
- PRODUCT DIMENSIONS, FOLDED: 36.8" (L) × 16.9" (W) × 18.9" (H)
- DECK SIZE: 18" (L) X 6.0" (W)
- WEIGHT LIMIT: 220 LB
- MINIMUM RIDER WEIGHT: 100 LB
- PRODUCT WEIGHT: 24.2 LB
- RECOMMENDED AGE: 12+
- WHEEL SIZE: 8"
- MAX SPEED: 15 MPH*
- MAX RANGE: 8 MILES *, **
- BATTERY: 21.6V, 5.0AH
- BATTERY TYPE: LITHIUM-ION
- MOTOR: 200W***
- CHARGER OUTPUT: 25.2V 1A
- UL CERTIFICATION: UL 2272
- CHARGING TIME: APPROX. 6 HOURS
- MAX CLIMBING ANGLE: 10°

*PRODUCT RANGE, SPEED, BATTERY LIFE, AND OTHER SPECIFICATIONS MAY VARY BASED ON RIDER AND RIDING CONDITIONS.

**WHEN TESTED CARRYING 120 LBS, AT AN AIR TEMPERATURE OF 80°F, AT A SPEED OF 5 MPH. SEE SECTION 4.3 FOR MORE DETAILS ON CONDITIONS THAT CAN AFFECT RANGE.

***PEAK POWER

1.3 Online Resources

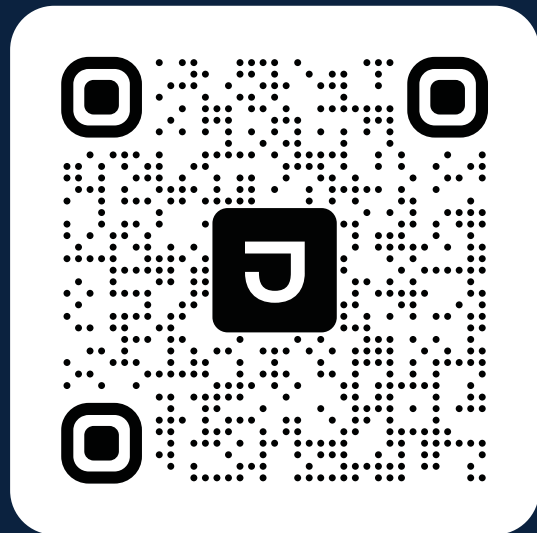

Scan for our most updated Loomis onboarding materials and support resources.

2. Getting Started

2.1 Starting Notes

- KICK OFF YOUR ADVENTURE RIGHT: PRIOR TO USE OF THIS PRODUCT, CAREFULLY READ THE ENTIRE USER MANUAL, INCLUDING SAFETY WARNINGS. MAKE SURE YOU UNDERSTAND, ACCEPT, AND ADHERE TO ALL:
 - MANUFACTURER'S RECOMMENDATIONS.
 - SAFETY INSTRUCTIONS AND WARNINGS.
 - LOCAL RIDING AND OPERATIONAL LAWS AND ORDINANCES.
- THE DIRECTIONS GIVEN IN THIS MANUAL—RIGHT, LEFT, FRONT, AND REAR—ARE ORIENTED AS THE RIDER WOULD SEE THEM WHEN STANDING ON THE SCOOTER. THE "RIGHT SIDE" OF THE SCOOTER, FOR EXAMPLE, IS THE SIDE WHERE THE RIDER'S RIGHT HAND WILL BE.
- TAKE CARE WHEN UNBOXING, REMOVING ALL PACKAGING MATERIALS, AND POSITIONING THE SCOOTER FOR ASSEMBLY, AS THE HANDLEBAR WILL ONLY BE SEMI-ATTACHED.

WARNING:

FAILURE TO COMPLY WITH THE FOLLOWING INSTRUCTIONS MAY RESULT IN INJURY TO THE CHILD OR OTHERS.

- KEEP SMALL PARTS AWAY FROM CHILDREN DURING ASSEMBLY.
- ACCESSORY MUST BE ASSEMBLED AND REMOVED BY AN ADULT.
- FREQUENTLY INSPECT THE PRODUCT FOR DAMAGE.

* ADULTS MUST ASSIST CHILDREN IN THE ASSEMBLY AND INITIAL ADJUSTMENT PROCEDURES OF THE PRODUCT.

2.2 Assembling the Handlebar

1. PROP THE SCOOTER BASE UP ON ITS KICKSTAND. (SEE SECTION 3.8)
⚠ IMPORTANT: HANDLE THE SEMI-ATTACHED STEM WITH CARE. TAKE CARE NOT TO TUG OR TANGLE THE WIRING.
2. LOOSEN AND REMOVE THE PRE-INSTALLED CENTER BOLT (M6 X 12MM) ON THE STEM BASE WITH THE HEAD DIRECTLY ABOVE THE DECK BY TURNING IT COUNTERCLOCKWISE WITH THE 5MM ALLEN KEY. SET THE CENTER BOLT ASIDE.

IMPORTANT: DO NOT LOOSEN OR REMOVE THE BOLT IN THE STEM BASE WITH THE HEAD FACING THE SIDE OF THE SCOOTER.

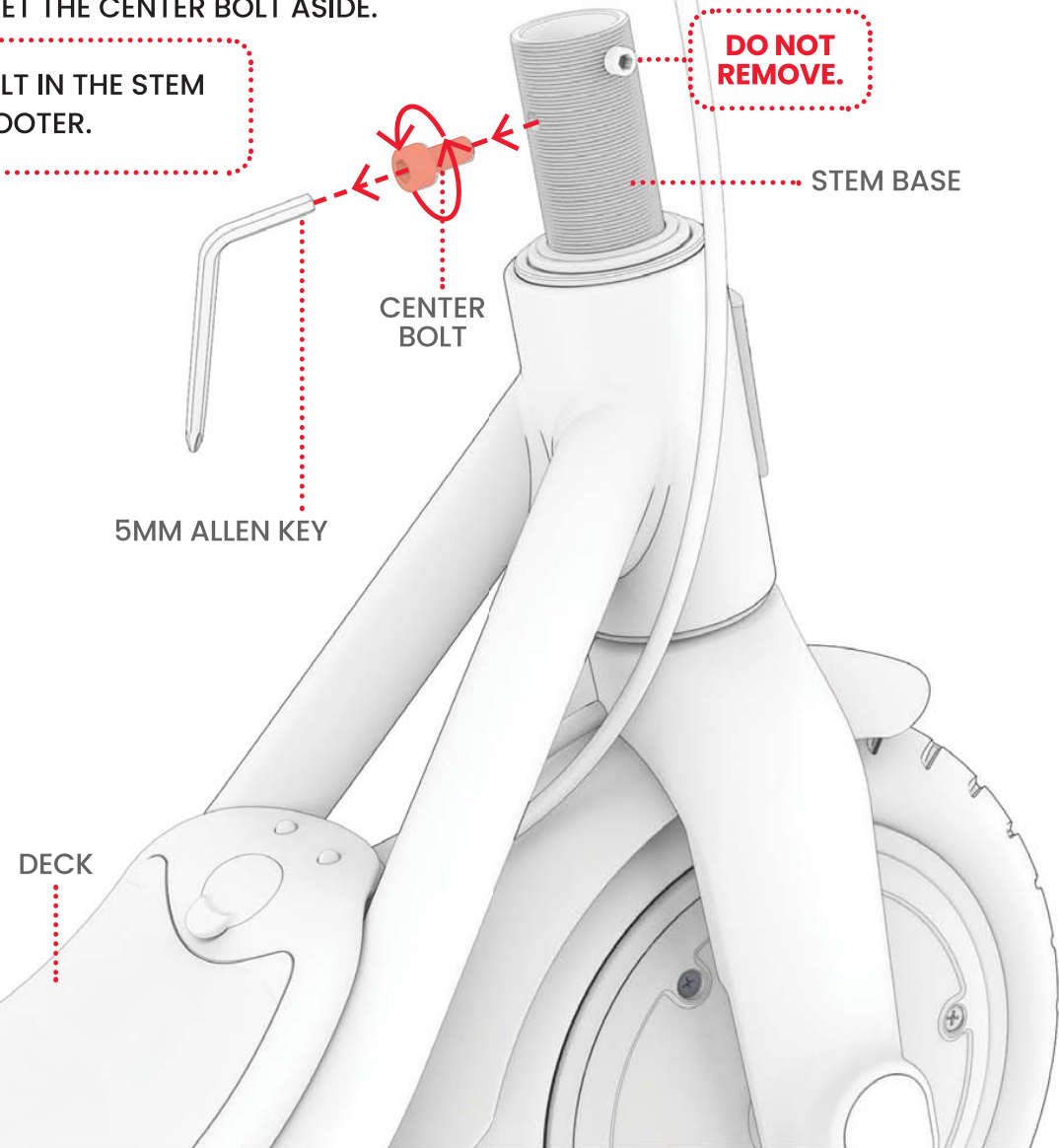

3. CAREFULLY RAISE THE STEM SO IT IS POSITIONED VERTICALLY ABOVE THE STEM BASE SUCH THAT THE FOLLOWING CONDITIONS ARE MET:
- THE SIDE OF THE HANDLEBAR WITH THE ACCELERATION THROTTLE IS ON THE RIGHT SIDE OF THE SCOOTER AS VIEWED FROM THE RIDING POSITION.
 - THE CHANNEL ON THE INSIDE OF THE STEM CLAMP IS OVER THE BOLT ON THE RIGHT SIDE OF THE STEM BASE.
- ⚠ IMPORTANT:** HANDLE THE SEMI-ATTACHED STEM WITH CARE. TAKE CARE NOT TO TUG OR TANGLE THE WIRING.
4. GENTLY SLIDE THE STEM DOWN ONTO THE STEM BASE.

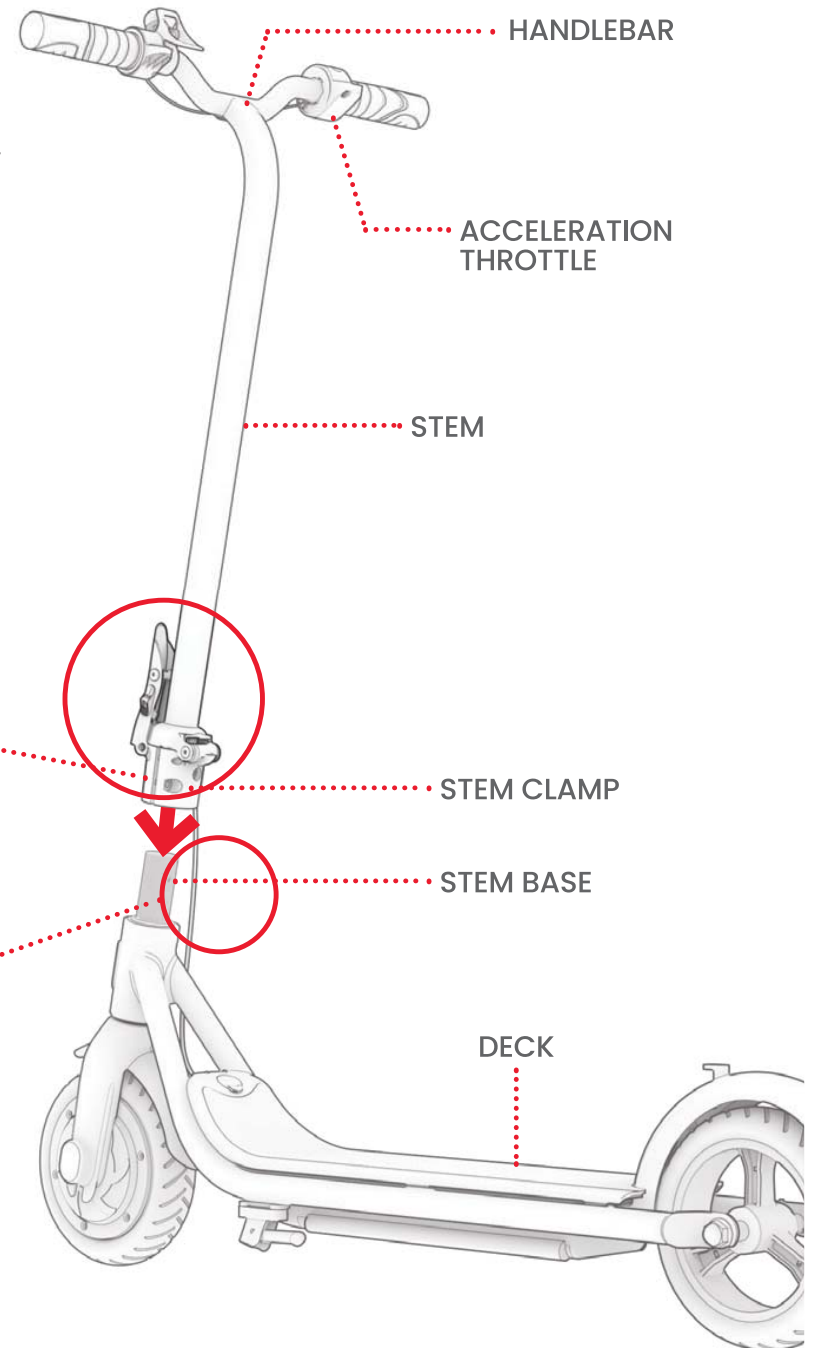
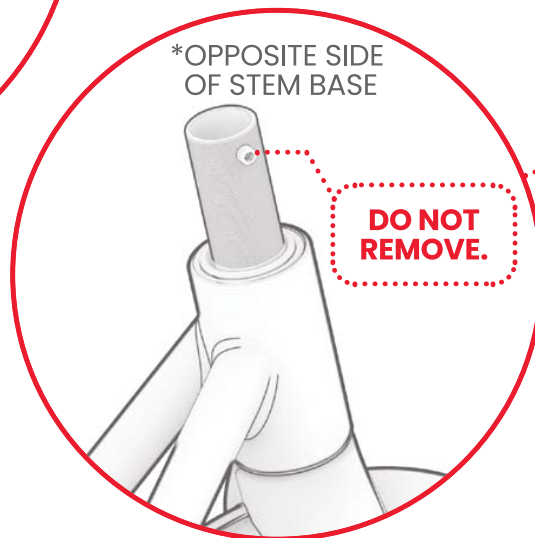
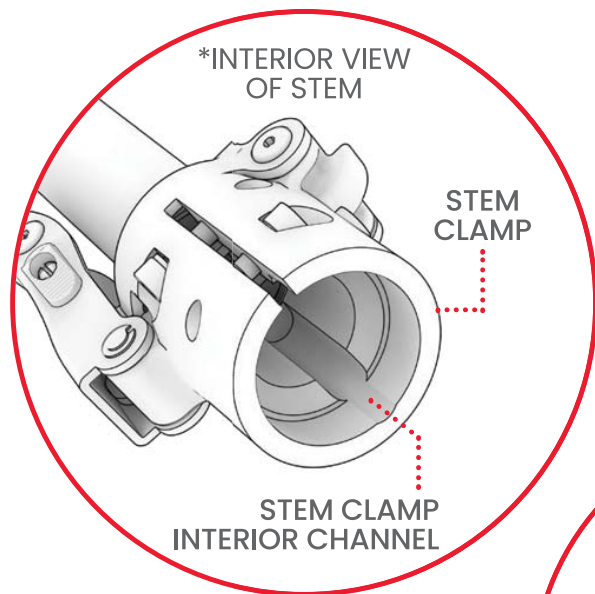

- REINSERT THE REMOVED BOLT THROUGH THE ALIGNED HOLES IN THE STEM CLAMP AND STEM BASE BY TWISTING IT IN CLOCKWISE. FULLY TIGHTEN THE BOLT WITH THE 5MM ALLEN KEY.

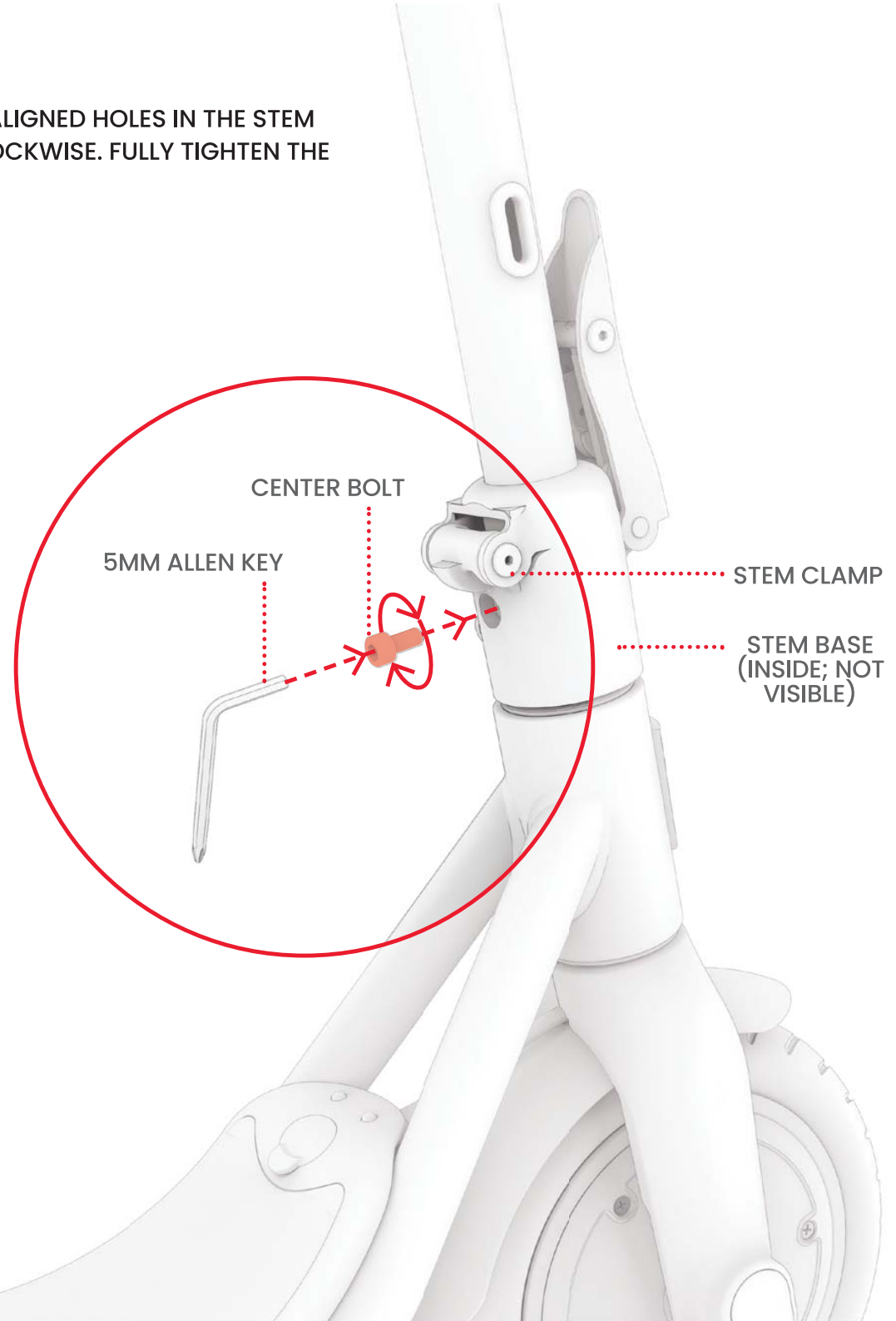

6. TIGHTEN THE TWO BOLTS ON THE LEFT SIDE OF THE STEM CLAMP BY TURNING THEM CLOCKWISE WITH THE 5MM ALLEN KEY.

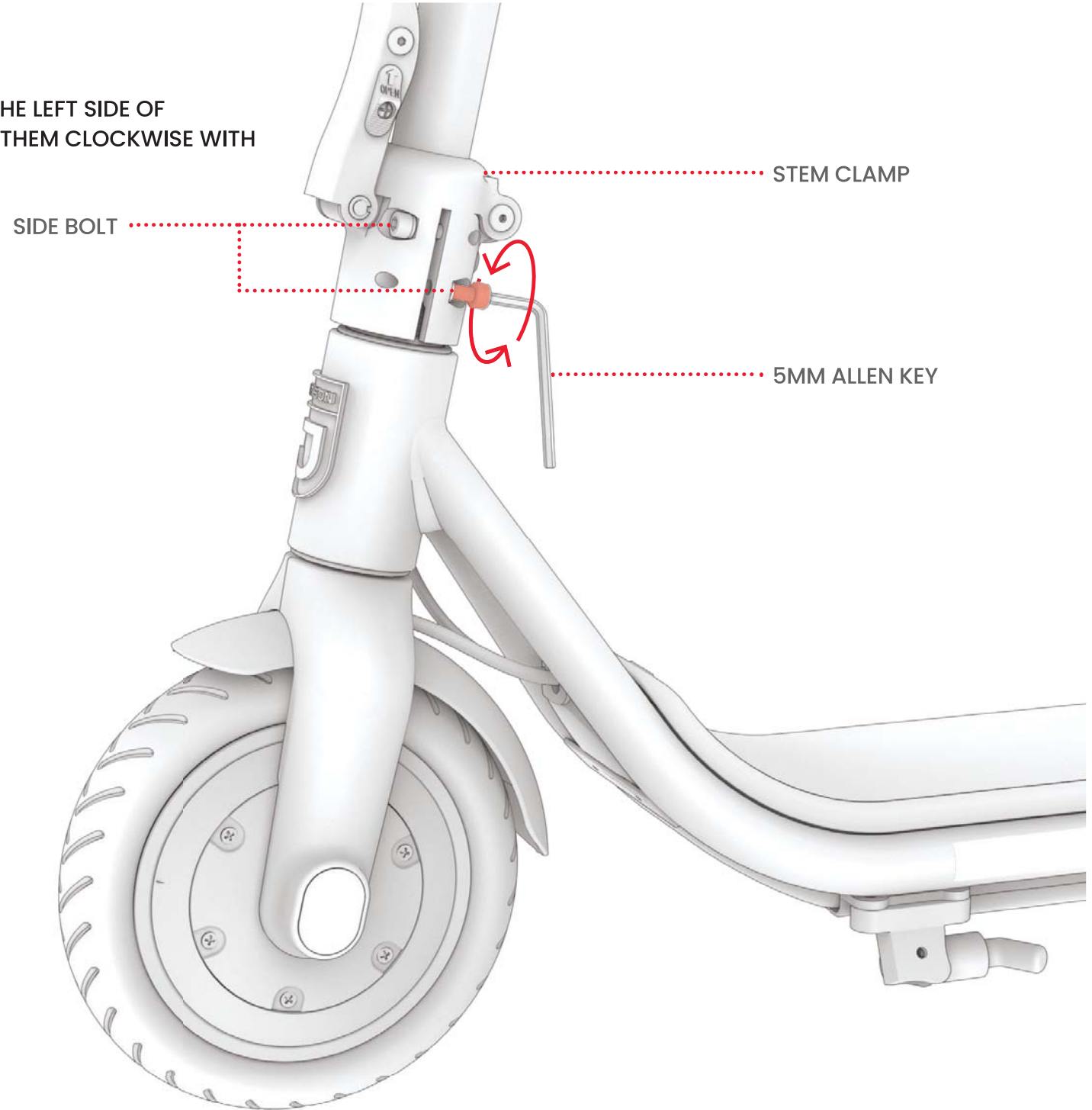

7. CHECK THAT THE STEM IS SECURE ON THE SCOOTER BASE AND THAT THE FRONT WHEEL ROTATES IN ALIGNMENT OF THE ROTATION OF THE HANDLEBAR.

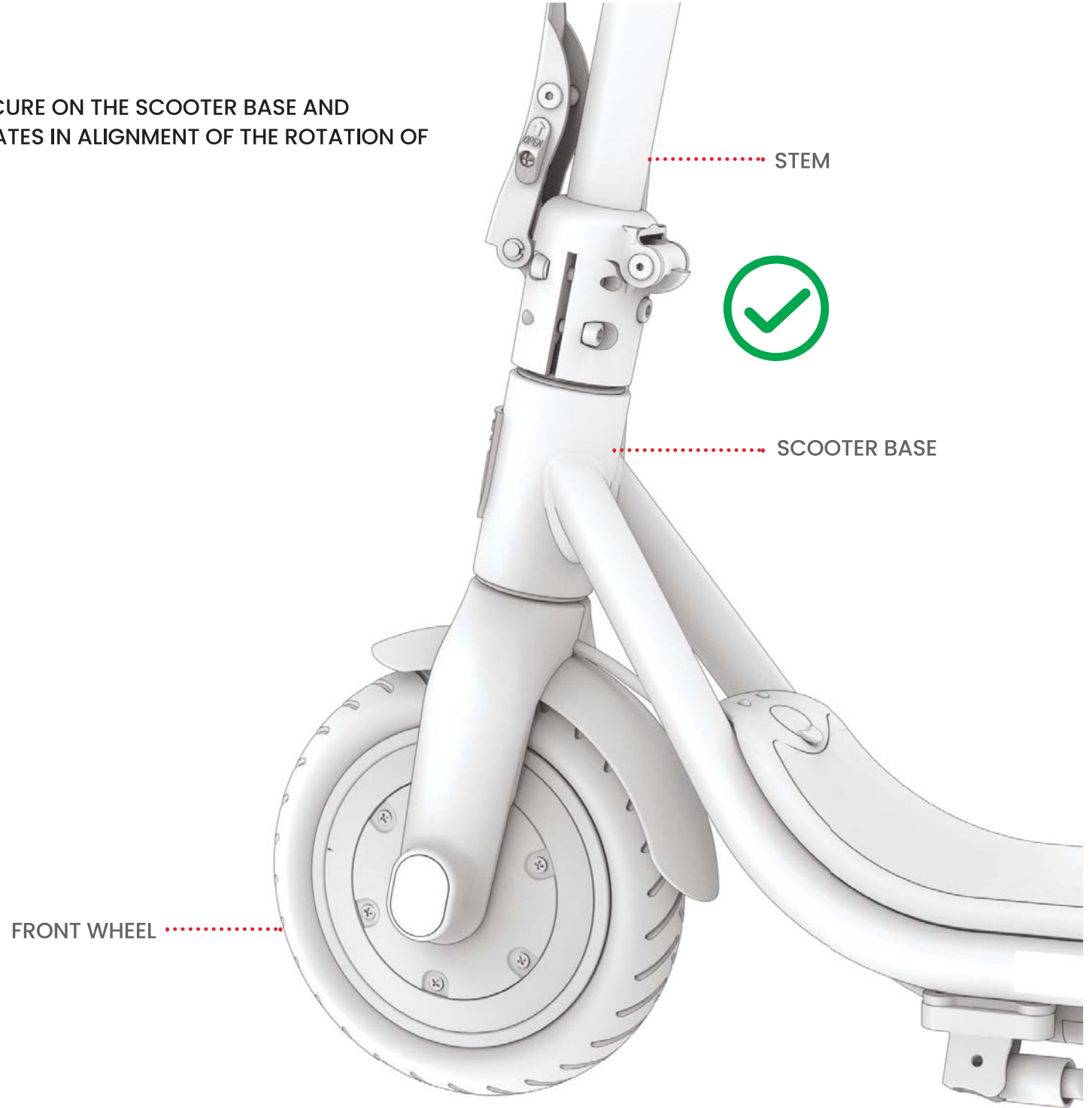

2.3 Charging the Battery

NOTE: IT CAN TAKE APPROXIMATELY 6 HOURS TO BRING THE BATTERY TO FULL CHARGE. FULLY CHARGE THE BATTERY PRIOR TO FIRST USE.

1. CONNECT THE CHARGING CABLE WITH THE CHARGER.
2. PULL OPEN THE CHARGING PORT COVER ON YOUR SCOOTER.
3. PLUG THE CHARGING CABLE INTO THE WALL, AND THEN PLUG THE CHARGER INTO THE CHARGING PORT.
4. WHEN THE INDICATOR LIGHT ON THE CHARGER CHANGES FROM RED TO GREEN, YOUR BATTERY HAS REACHED FULL CHARGE. REMOVE THE CHARGER FROM THE CHARGING PORT AND UNPLUG THE CABLE FROM THE WALL OUTLET.
5. CLOSE THE CHARGING PORT COVER.



CHARGING PORT
WITH COVER

IMPORTANT CHARGING NOTES:

- ONLY USE THE INCLUDED CHARGER OR ONE OBTAINED DIRECTLY THROUGH JETSON LABELED WITH FCA135-252010 (JETSON MODEL PJOOM-CH).

Model FCA135-252010, made by Shenzhen Feng Chi Electric Co Ltd

 FAILURE TO USE CORRECT CHARGER CAN RESULT IN FIRE AND EXPLOSION.

- PLUG THE CHARGER INTO THE WALL OUTLET BEFORE PLUGGING INTO THE CHARGING PORT ON THE SCOOTER.
- NEVER TURN ON THE SCOOTER WHILE IT IS CHARGING.
- CHARGE THE BATTERY UNTIL IT IS FULLY CHARGED—ABOUT 6 HOURS.
- NEVER LEAVE THE SCOOTER CHARGING OVERNIGHT OR FOR EXTENDED PERIODS OF TIME.
- DO NOT ATTEMPT TO REMOVE OR DISASSEMBLE THE BATTERY.
- CHARGING AMBIENT TEMPERATURE RANGE: 37.4°F(3°C) - 104°F(40°C)
- OPERATING AMBIENT TEMPERATURE RANGE: 1.4°F(-17°C) - 104°F(40°C)
- DO NOT USE THIS PRODUCTION IF THE FLEXIBLE POWER CORD OF OUTPUT CABLE FRAYED HAS BROKEN INSULATION, OR ANY OTHER SIGNS OF DAMAGES.

CHARGER INDICATOR LIGHT ON THE CHARGER:

- - CHARGING
- - CHARGING COMPLETE

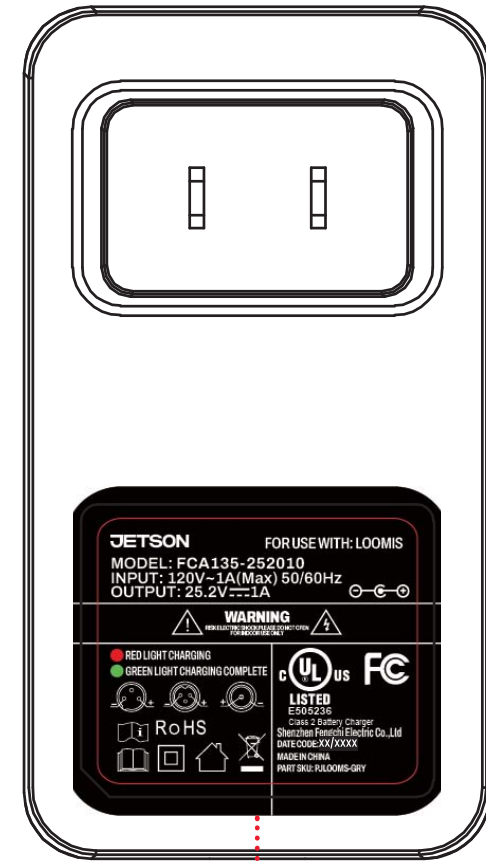
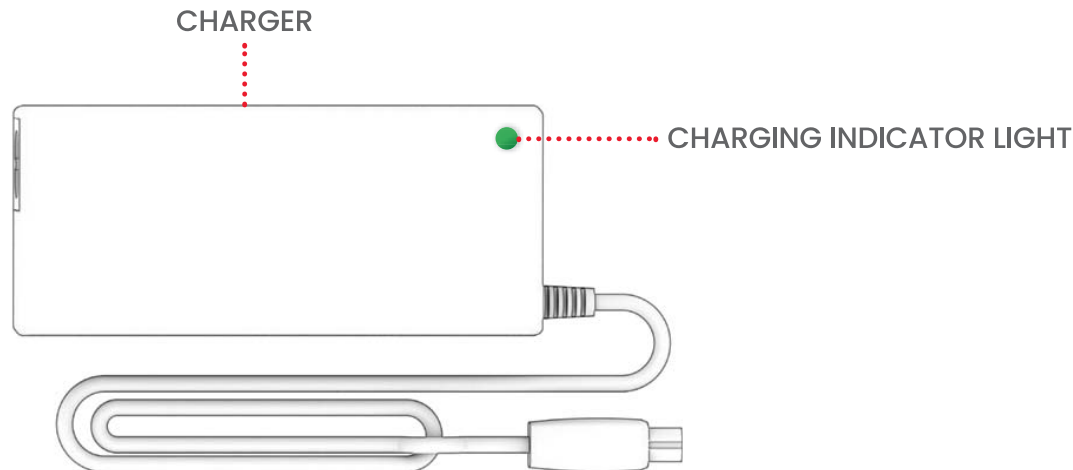

THIS IS THE MARKING YOUR CHARGER WILL HAVE.

3. Features & Functions

3.1 Folding & Unfolding the Scooter

WHEN TO FOLD: FOR STORAGE AND TRANSPORT
WHEN TO UNFOLD: FOR RIDING

IMPORTANT: DO NOT LIFT THE SCOOTER BY THE HANDLEBAR. TO TRANSPORT IT, SECURE IT IN THE FOLDED POSITION AND CARRY IT BY THE STEM.

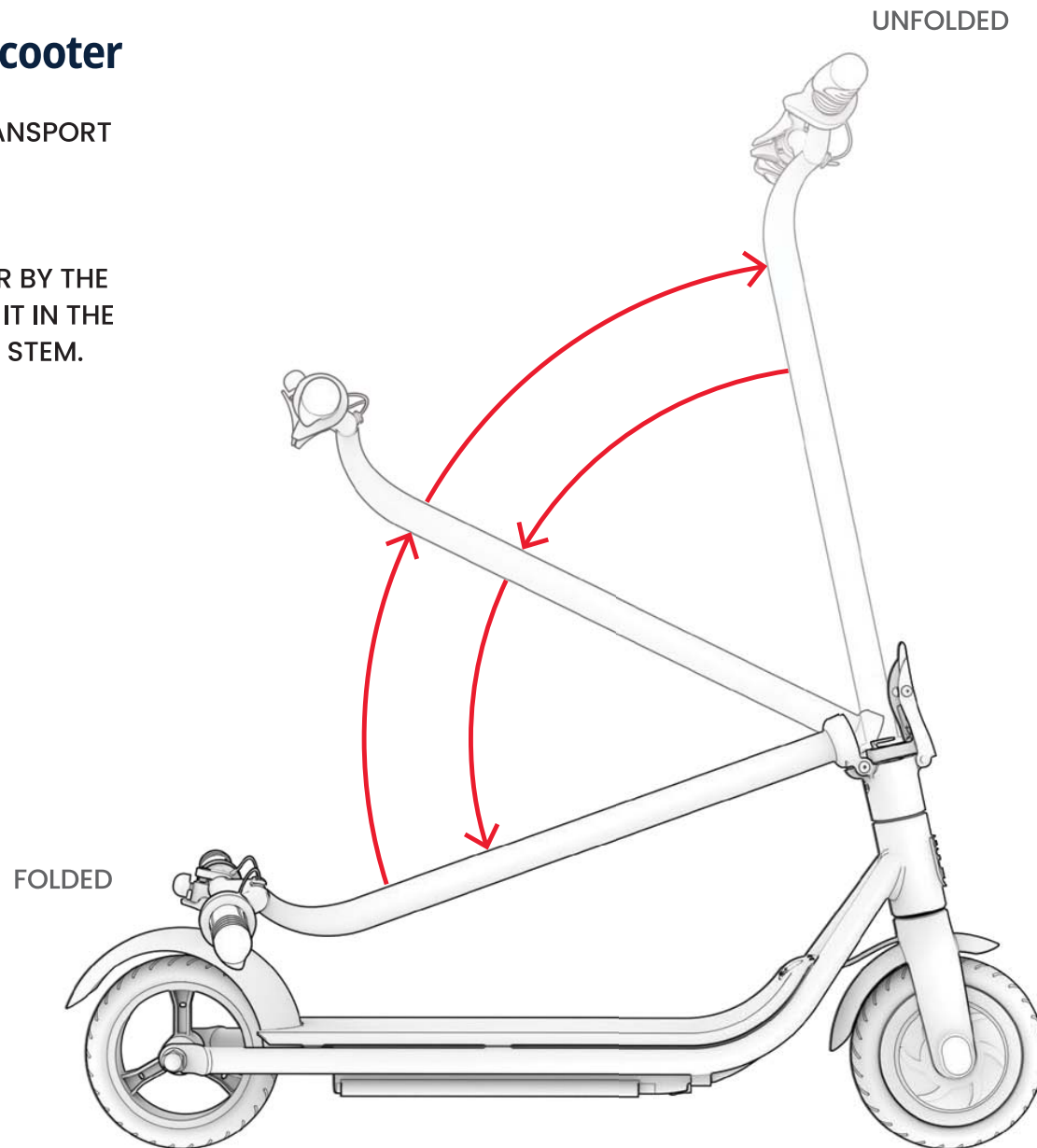

TO FOLD:

1. PUSH THE TAB ON THE FOLDING LATCH UP, THEN PULL THE LATCH OPEN AND AWAY FROM THE STEM.

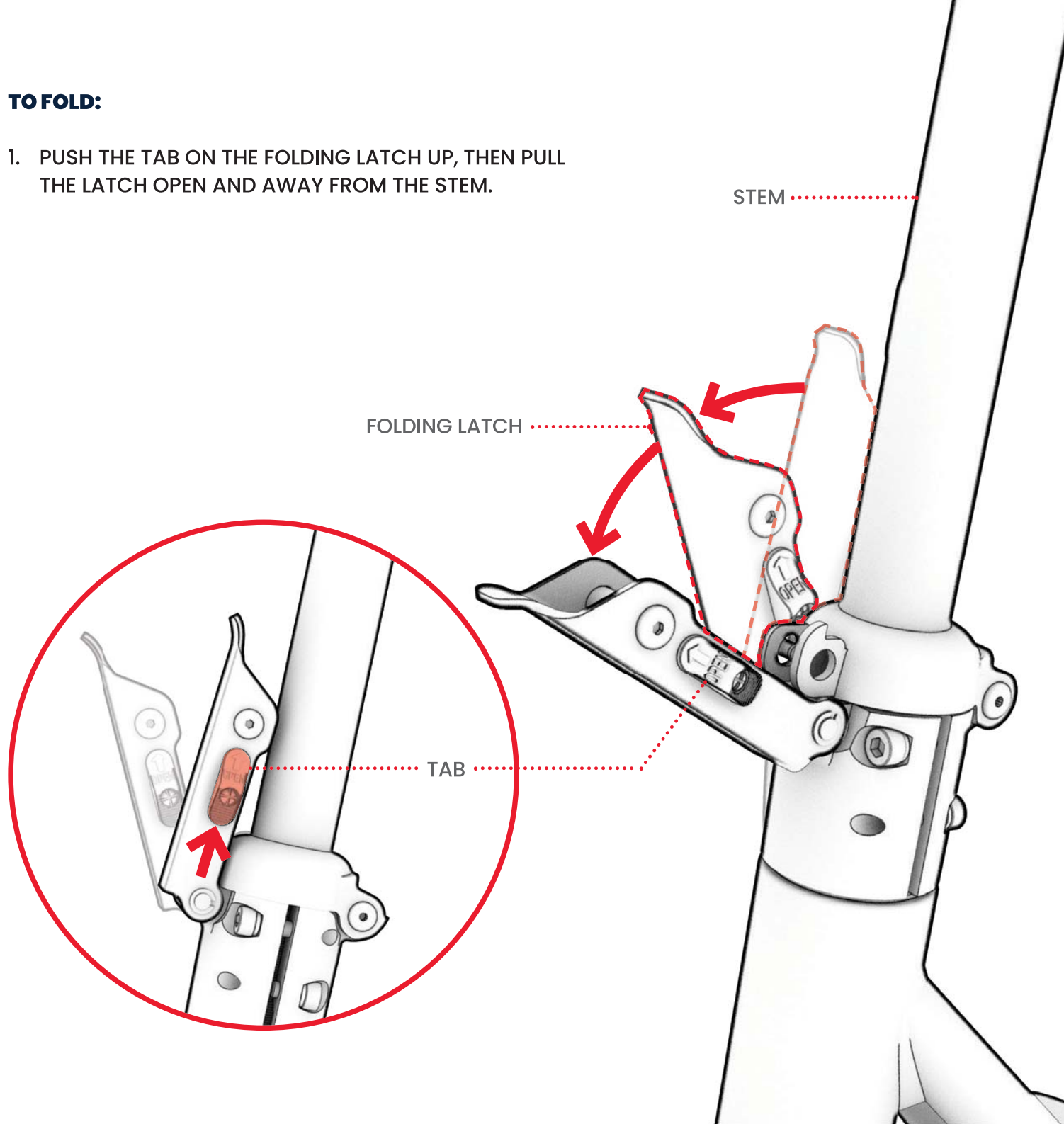

2. LOWER THE STEM DOWN OVER THE DECK.

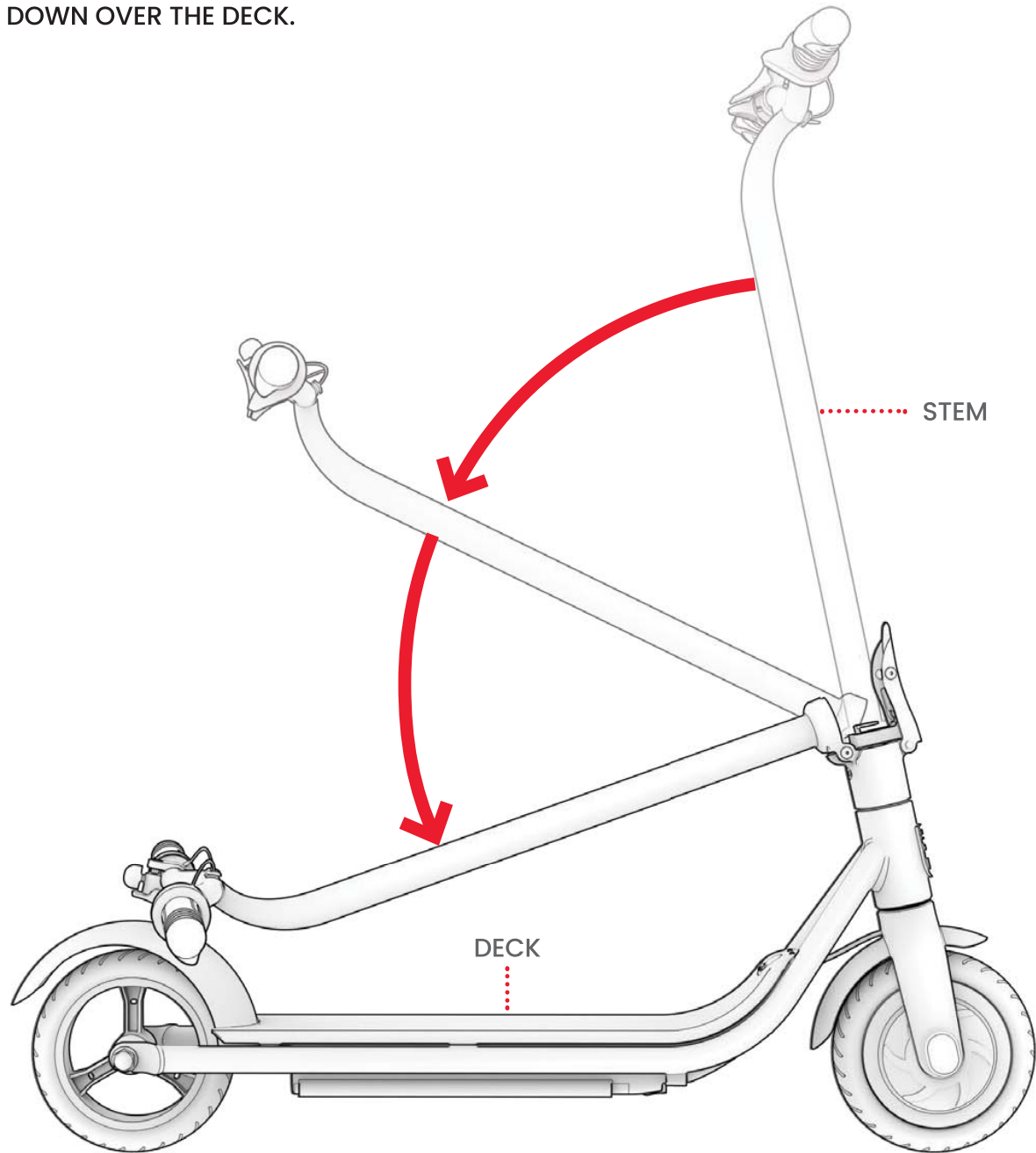

3. PUSH THE FOLDING HOOK CATCH DOWN UNTIL IT LOOPS AROUND THE FOLDING HOOK.
4. CHECK THAT THE SCOOTER IS SECURE IN THE FOLDED POSITION.

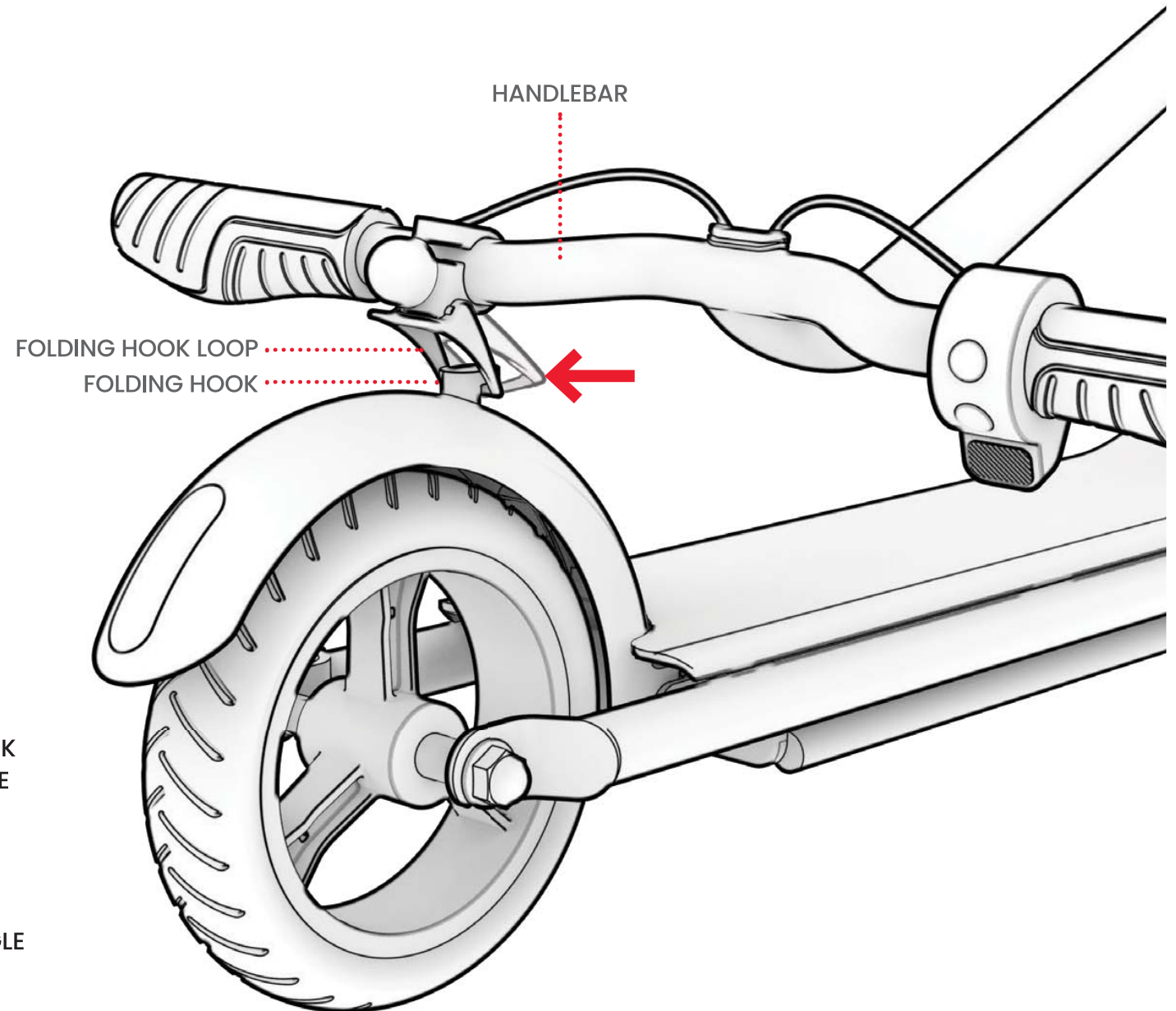

IMPORTANT: IF THE FOLDING HOOK CATCH IS NOT ALIGNING WITH THE HOOK OR LOOPING AROUND IT, IT MAY BE NECESSARY TO ROTATE THE CATCH MECHANISM ON THE HANDLEBAR UNTIL THE CATCH MECHANISM IS AT THE RIGHT ANGLE TO LOOP AROUND THE HOOK. SEE PAGE 25.

ADJUSTING THE CATCH MECHANISM

INCORRECT: FOLDING HOOK CATCH IS NOT ALIGNED WITH THE FOLDING HOOK. ROTATE THE BELL CLAMP AS NECESSARY AROUND THE HANDLEBAR UNTIL THE FOLDING HOOK CATCH IS PROPERLY POSITIONED TO "CATCH" THE HOOK.



FOLDING HOOK CATCH

FOLDING HOOK

BELL CLAMP

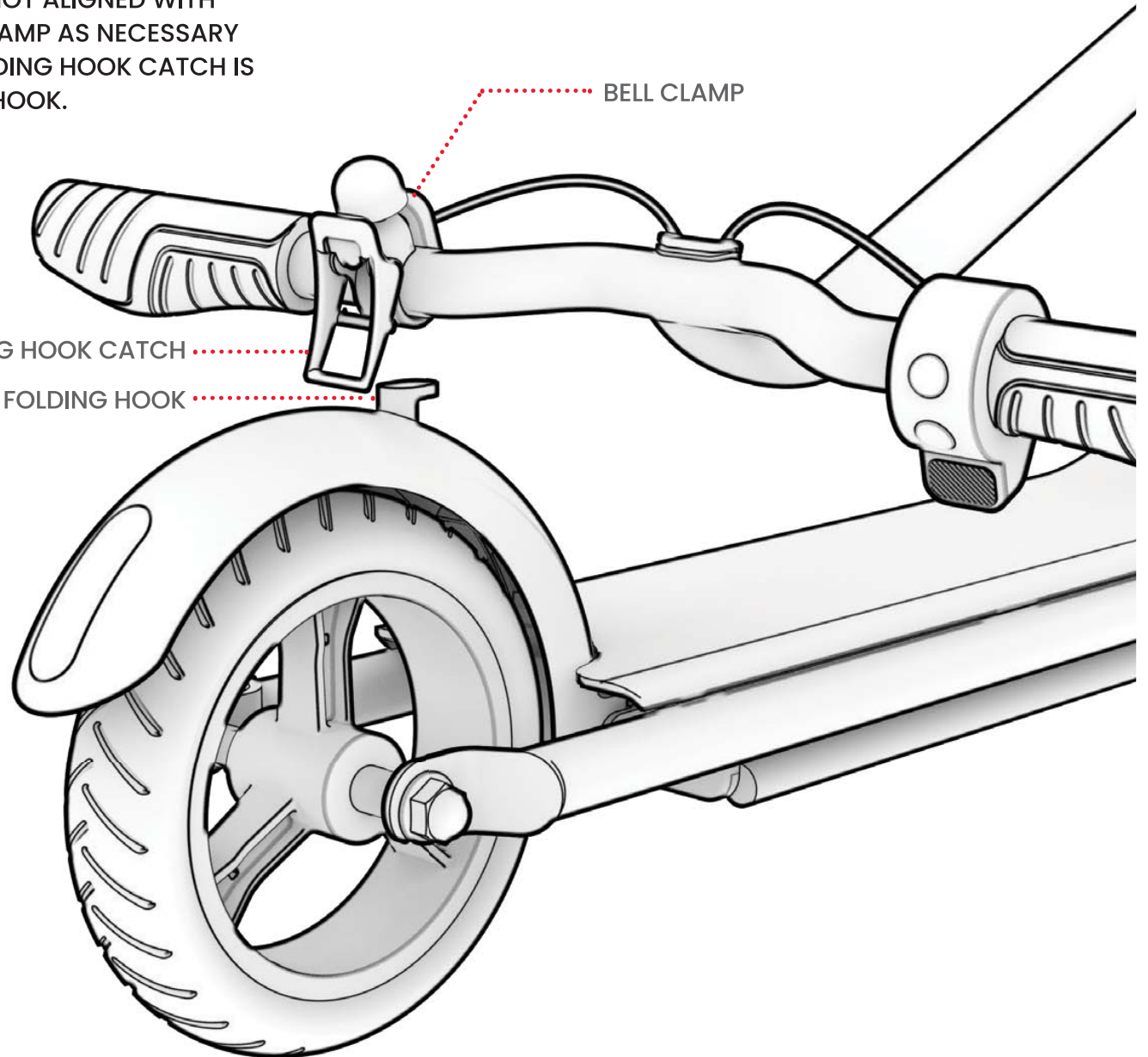

CORRECT: THE FOLDING HOOK CATCH IS PROPERLY ALIGNED TO "CATCH" THE HOOK.

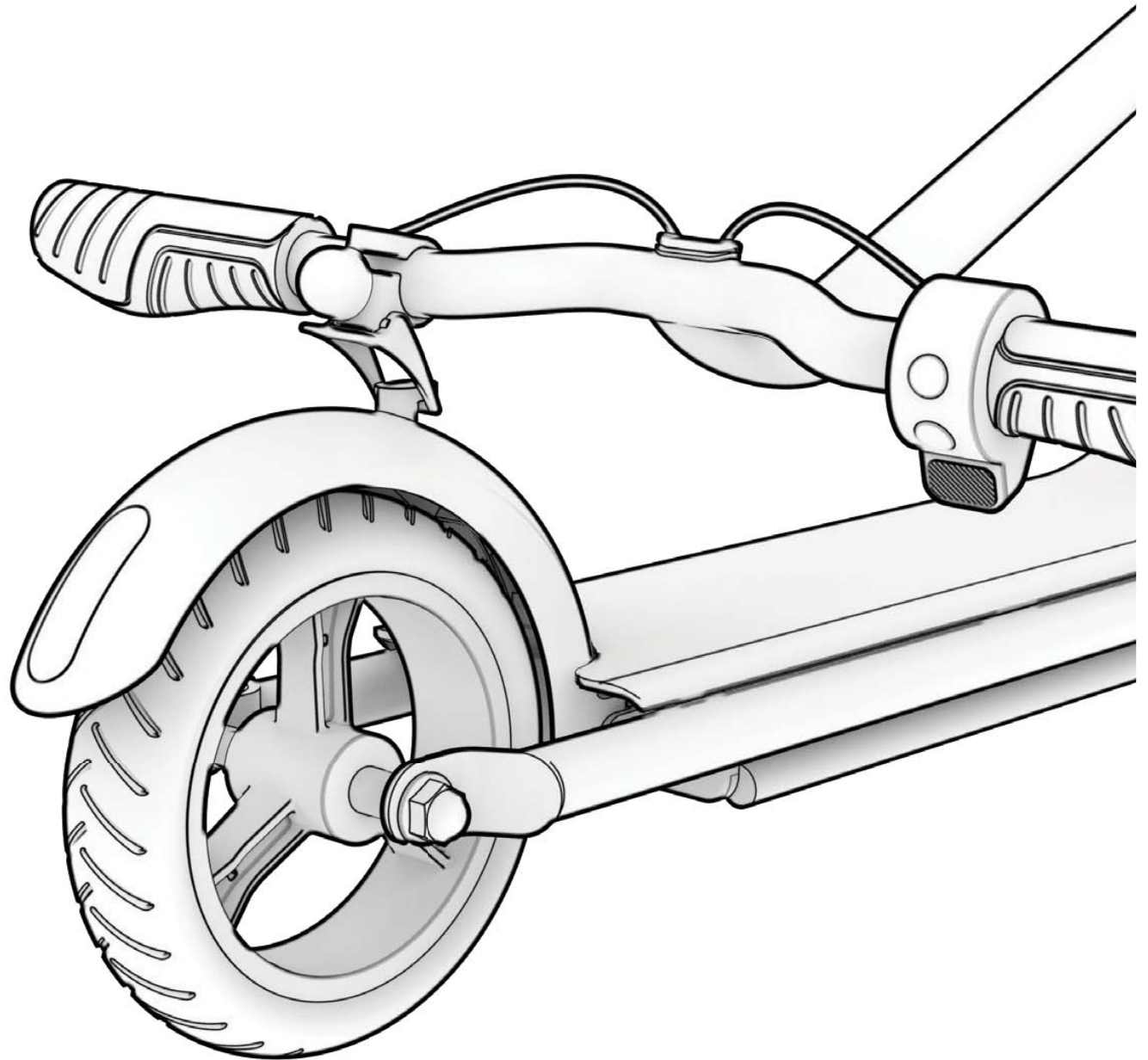

TO UNFOLD:

1. PUSH THE FOLDING HOOK CATCH AWAY FROM THE REAR FENDER TO RELEASE IT FROM THE FOLDING HOOK.

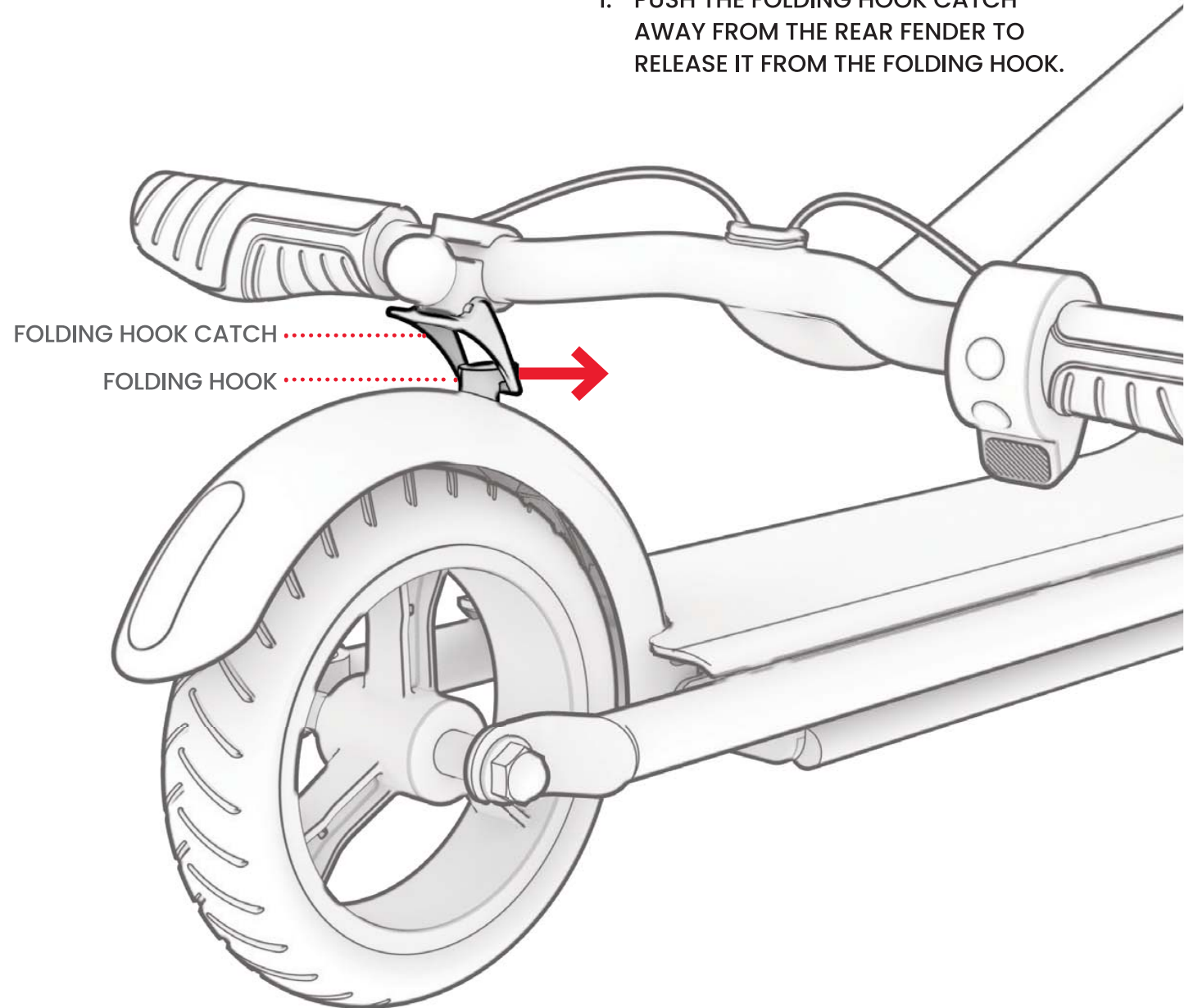

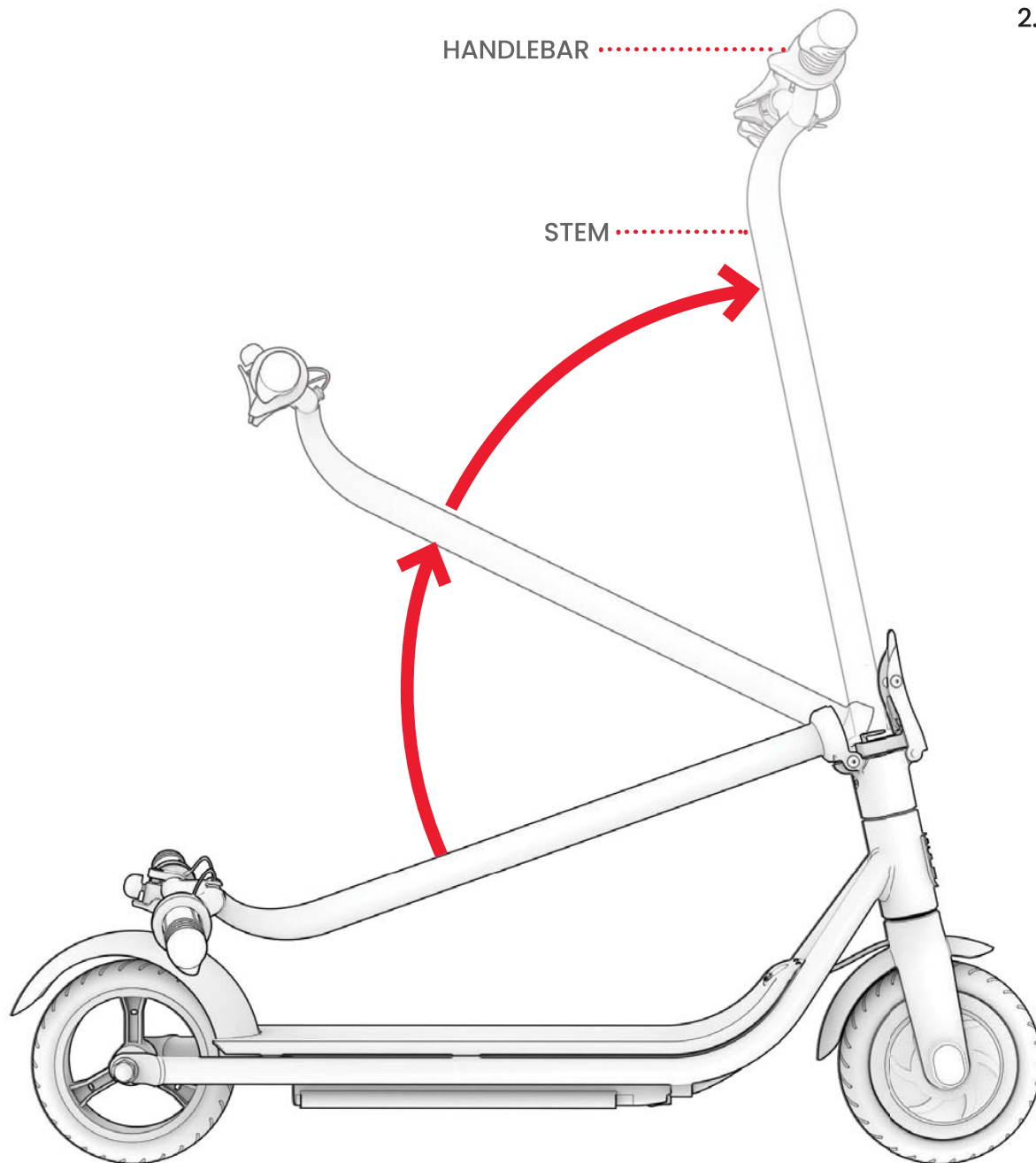

HANDLEBAR

STEM

2. RAISE THE HANDLEBAR TOWARDS THE FRONT OF THE SCOOTER UNTIL THE STEM IS FULLY UPRIGHT.

3. FORCEFULLY PUSH THE FOLDING LATCH AGAINST THE STEM UNTIL IT CLICKS CLOSED

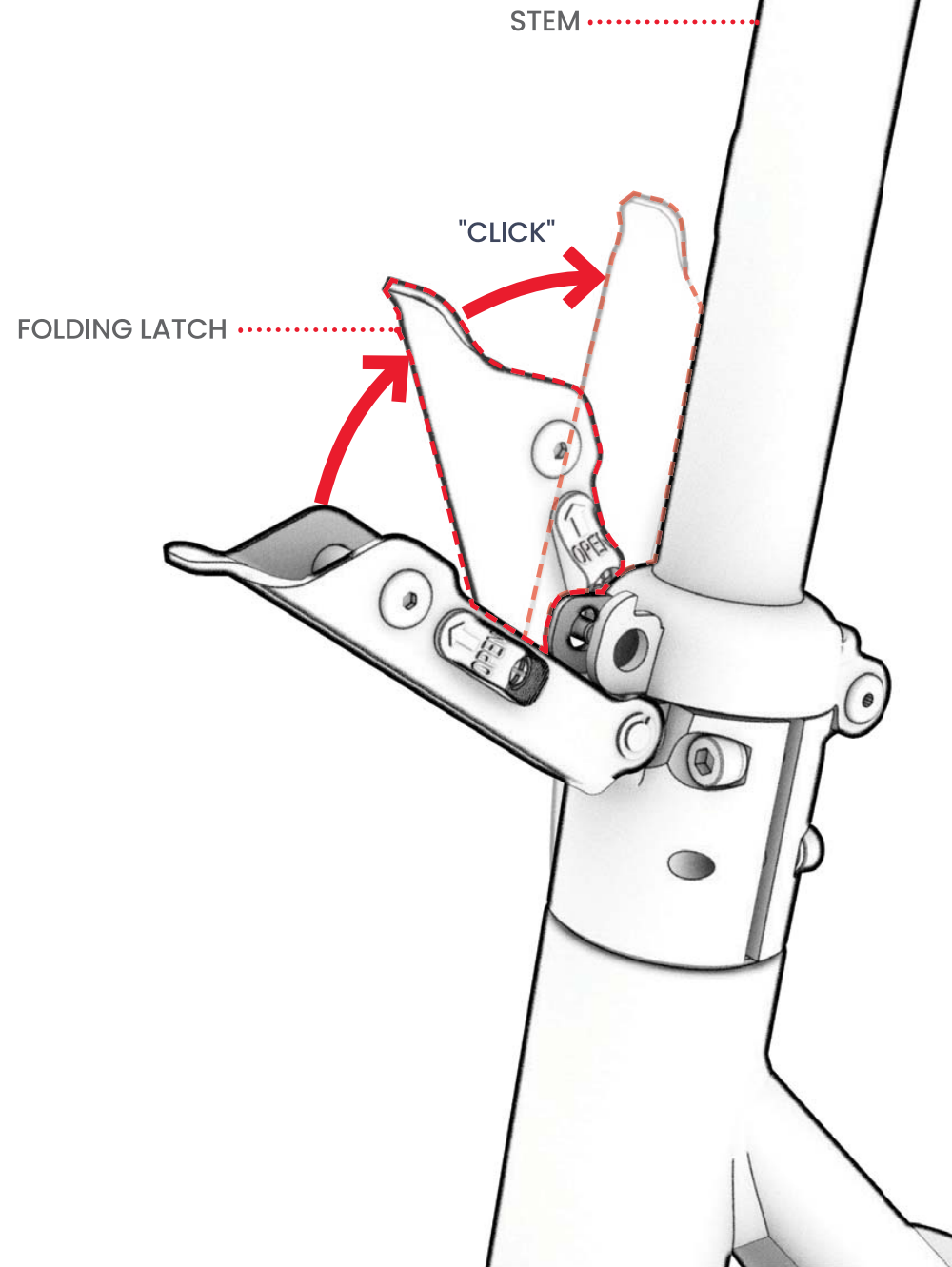

4. CHECK THAT THE STEM IS SECURE IN THE VERTICAL POSITION.

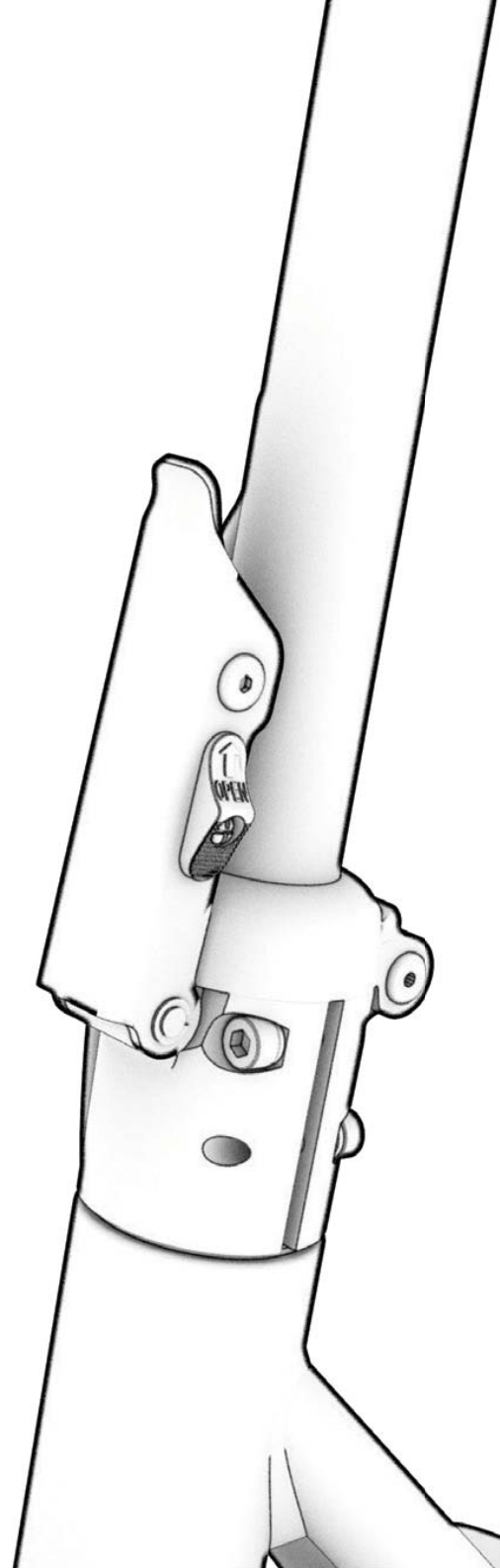

3.2 Powering On & Off

TO POWER ON: PRESS AND HOLD THE POWER BUTTON FOR 1 SECOND.

TO POWER OFF: PRESS AND HOLD THE POWER BUTTON FOR 3 SECONDS.

TO PRESERVE BATTERY POWER, YOUR SCOOTER HAS AN AUTO-OFF FEATURE AND WILL AUTOMATICALLY POWER OFF AFTER 10 MINUTES WITHOUT USE. ALWAYS REMEMBER TO POWER YOUR SCOOTER OFF WHEN MAKING A PIT STOP OR PUTTING IT AWAY FOR THE NIGHT.

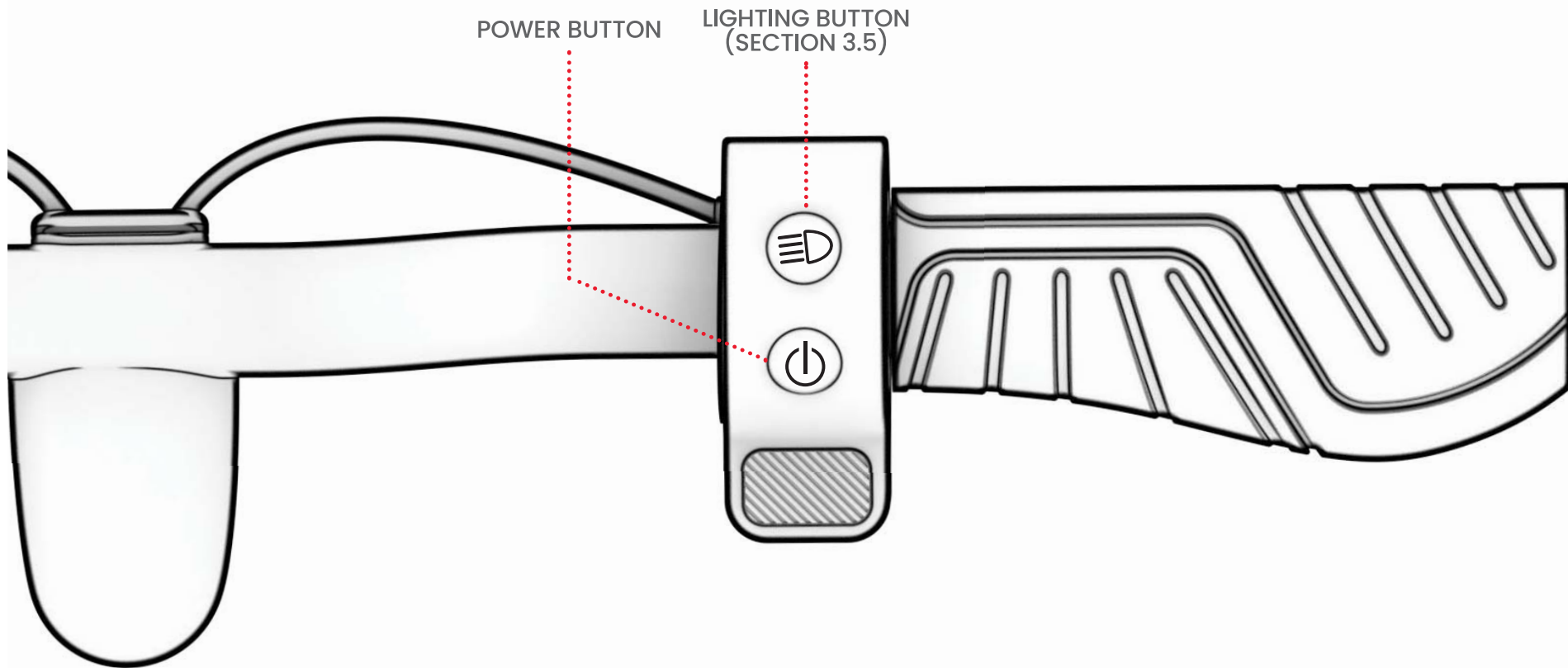

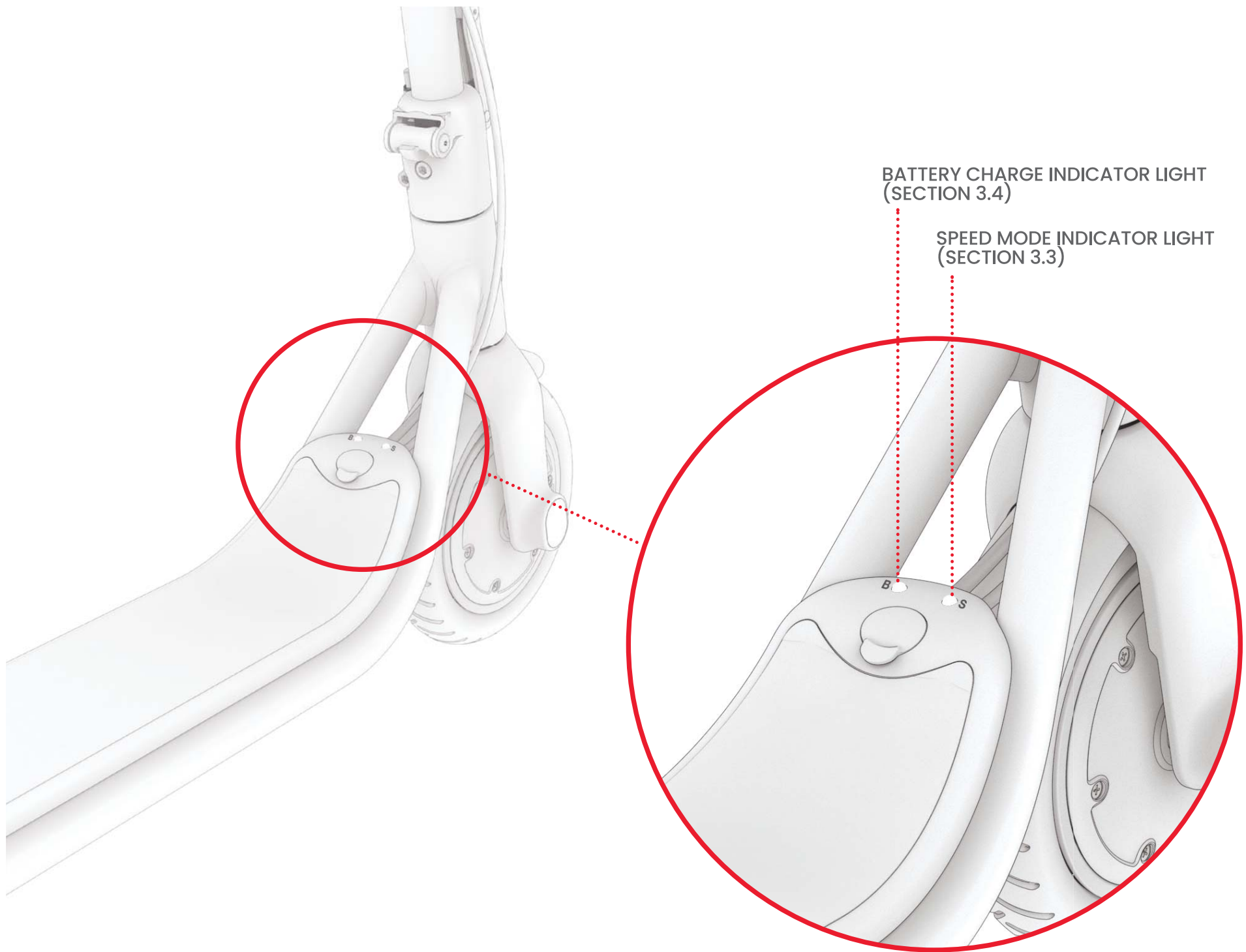



BATTERY CHARGE INDICATOR LIGHT
(SECTION 3.4)

SPEED MODE INDICATOR LIGHT
(SECTION 3.3)

3.3 Using Speed Modes

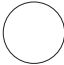
THERE ARE 3 SPEED MODES, EACH OF WHICH ALLOWS YOU TO RIDE A DIFFERENT MAXIMUM SPEED. WITH THE SCOOTER POWERED ON, QUICK-PRESS THE POWER BUTTON TO CHANGE SPEED MODES.

SPEED MODE	MAXIMUM SPEED	SPEED MODE INDICATOR LIGHT (S)
PEDESTRIAN MODE (SLOW)	UP TO 5 MPH	
COMFORT MODE (MIDDLE)	UP TO 10 MPH	
SPORT MODE (FAST)	UP TO 15 MPH	

3.4 Checking Battery Charge Level

YOU CAN KEEP TABS ON YOUR BATTERY'S CHARGE LEVEL BY LOOKING AT THE BATTERY CHARGE INDICATOR LIGHT ON THE DECK.

IMPORTANT: WHEN THE BATTERY CHARGE DEPLETES TO 0%, THE SCOOTER WILL POWER OFF. CHARGE THE SCOOTER TO FULL POWER (SECTION 2.3) PRIOR TO YOUR NEXT RIDE.

BATTERY CHARGE INDICATOR LIGHT (B)	BATTERY CHARGE LEVEL
	76% – 100%
	41% – 75%
	0% – 40%

3.5 Using the LED Lights

TO POWER THE LIGHTS ON OR OFF: PRESS AND HOLD THE LIGHTING BUTTON FOR 2 SECONDS.

TO CYCLE TO ANOTHER OF 5 LIGHTING MODES: WITH THE LIGHTS POWERED ON, QUICK-PRESS THE LIGHTING BUTTON.

WHENEVER MUSIC IS PLAYING THROUGH THE BLUETOOTH® SPEAKER, THE LIGHTS WILL PULSE IN SYNC TO THE MUSICAL BEAT.

3.6 Using the Bluetooth® Speaker

THE LOOMIS COMES EQUIPPED WITH A BUILT-IN BLUETOOTH® SPEAKER.

STREAMING MUSIC THROUGH YOUR HOVERBOARD

YOU CAN CONNECT YOUR HANDHELD DEVICE TO THE SCOOTER'S BUILT-IN BLUETOOTH® SPEAKER TO STREAM MUSIC DURING YOUR RIDE. ONCE THE MUSIC STARTS PLAYING, THE LIGHTS ON YOUR SCOOTER WILL AUTOMATICALLY SYNC WITH THE MUSIC AND FLASH TO ITS BEAT.

TO CONNECT YOUR HANDHELD DEVICE TO THE SCOOTER'S BLUETOOTH® SPEAKER:

1. POWER ON THE SCOOTER. (SECTION 3.2)
2. IN THE SETTINGS SECTION ON YOUR HANDHELD DEVICE, ENABLE BLUETOOTH AND LOOK FOR "LOOMIS" IN THE LIST OF OPTIONS. SELECT IT.
3. PLAY MUSIC THROUGH YOUR FAVORITE APP, AND IT WILL STREAM THROUGH THE SCOOTER'S SPEAKERS.

TROUBLESHOOTING CONNECTIVITY ISSUES

IF YOU ARE HAVING TROUBLE CONNECTING WITH THE SPEAKER, TRY:

1. POWERING THE SCOOTER OFF AND THEN BACK ON.
2. POWERING YOUR PERSONAL DEVICE OFF AND THEN BACK ON.
3. CLICKING THE SCAN BUTTON TO REFRESH THE LIST OF DETECTED PRODUCTS.

THE BLUETOOTH® WORD MARK AND LOGOS ARE REGISTERED TRADEMARKS OWNED BY THE BLUETOOTH SIG, INC. AND ANY USE OF SUCH MARKS BY TRURIDE TECH LLC. IS UNDER LICENSE. OTHER TRADEMARKS AND TRADE NAMES ARE THOSE OF THEIR RESPECTIVE OWNERS.

3.7 Using the Bell

USE THE BELL AS AN ALERT TO OTHER RIDERS AND PEDESTRIANS.

TO SOUND THE BELL, FLICK THE FOLDING CATCH HOOK DOWN AND RELEASE IT QUICKLY.

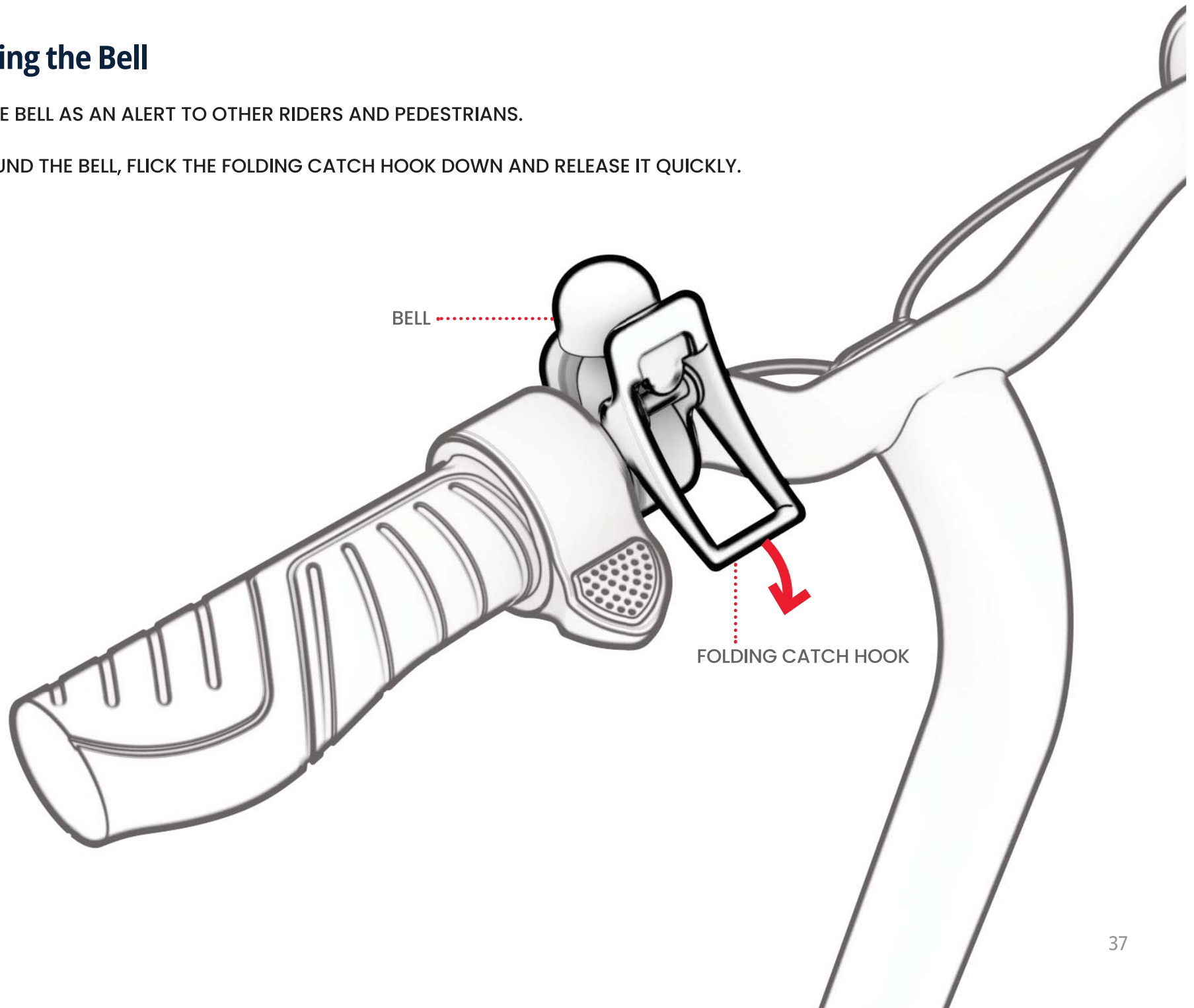

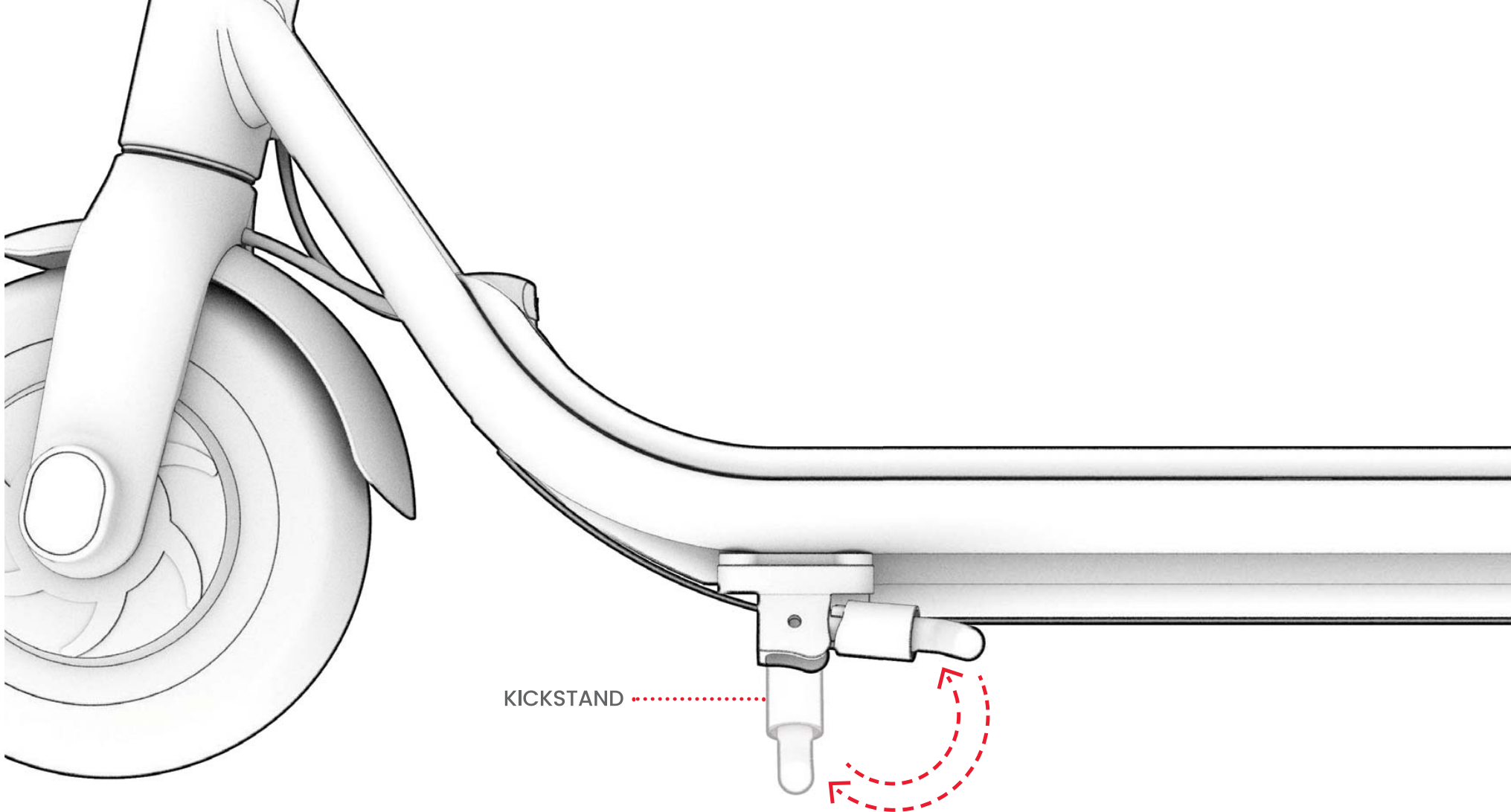

3.8 Using the Kickstand

TO USE THE KICKSTAND, PIVOT IT DOWN AND GENTLY TILT YOUR SCOOTER ONTO IT TO STAND.
TO RAISE THE KICKSTAND, PIVOT IT BACK UP.



IMPORTANT: ALWAYS RAISE THE KICKSTAND BEFORE RIDING.

4. Making Moves

4.1 Using the Brake

PUSH DOWN ON THE E-BRAKE GENTLY TO SLOW DOWN. PUSH MORE FORCEFULLY TO COME TO A COMPLETE STOP.

⚠ IMPORTANT: TO AVOID ABRUPT MOVEMENTS, TRY TO ENGAGE THE E-BRAKE GRADUALLY.

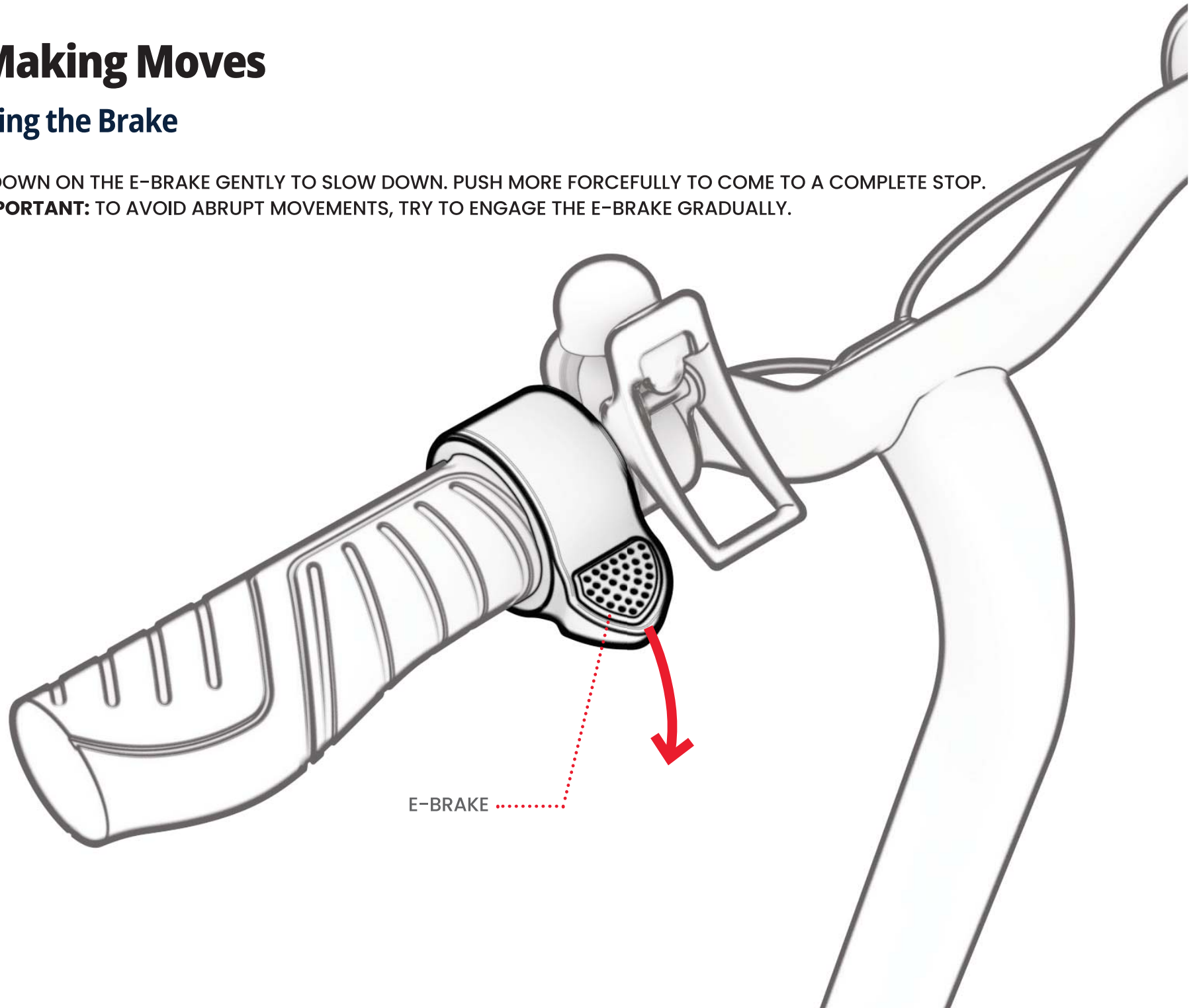

4.2 Riding the Loomis

THIS SCOOTER'S MOTOR REQUIRES KICK-MOTION ACTIVATION TO START.

1. PLACE ONE FOOT AT THE FRONT OF THE DECK FACING FORWARD. PROPEL THE SCOOTER FORWARD BY PUSHING OFF THE GROUND 2 TIMES IN A ROW WITH YOUR OTHER FOOT.
2. PLACE YOUR KICKING FOOT AT THE BACK OF THE DECK, TURNED OUTWARD AT A 70 – 90° ANGLE FOR STABILITY.
3. GRADUALLY PUSH DOWN ON THE THUMB THROTTLE TO ACCELERATE AND THEN MAINTAIN YOUR SPEED.



IMPORTANT: TO AVOID SUDDEN BURSTS OF SPEED, ALWAYS PUSH DOWN ON THE THROTTLE GENTLY.

TO MAKE TURNS: ROTATE THE HANDLEBAR TO THE LEFT OR RIGHT.

4.3 Maximizing Speed & Riding Range

THE HARDER THE MOTOR NEEDS TO WORK, THE FASTER YOUR BATTERY WILL DRAIN. IN IDEAL CONDITIONS, THE MAXIMUM MILEAGE THAT CAN BE ACHIEVED PER BATTERY CHARGE IS 8 MILES AND THE MAXIMUM SPEED IS 15 MPH.

THE FOLLOWING FACTORS WILL ALSO AFFECT SPEED AND RIDING RANGE. THEY INCLUDE:

- **RIDING SURFACE:** TRAVELING OVER A ROUGH SURFACE REQUIRES MOTOR POWER THAN RIDING ON A SMOOTH ONE.
- **CARRYING WEIGHT:** MORE WEIGHT (RIDER PLUS CARGO) DECREASES ACHIEVABLE RANGE.
- **RIDING STYLE:** FREQUENT STARTING AND STOPPING WILL REDUCE THE ACHIEVABLE DISTANCE ON ONE BATTERY CHARGE.
- **AIR TEMPERATURE:** THE IDEAL TEMPERATURE FOR RIDING AND STORING THE SCOOTER IS BETWEEN 50 – 90°F (10 – 35°C).
- **INCLINE:** THE MOTOR HAS TO WORK HARDER TRAVELING UPHILL THAN ON FLAT STRETCHES OR DOWNHILL.
- **BATTERY MAINTENANCE:** TIMELY BATTERY CHARGING AFTER EVERY RIDE HELPS MAINTAIN BATTERY CAPACITY AND STRENGTH.

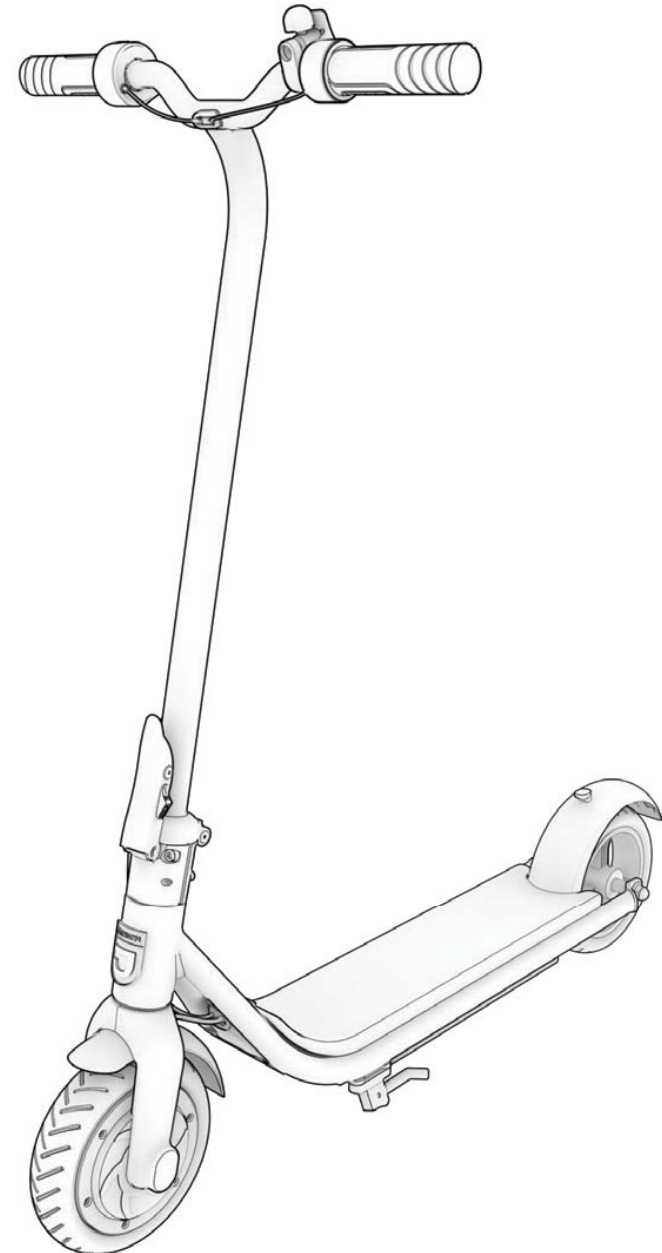

5. Safe Journeying

5.1 Pre-Ride Safety Checks

CONDUCT THESE IMPORTANT SAFETY CHECKS BEFORE EVERY JOURNEY:

BRAKE

MAKE SURE THE BRAKE WORKS PROPERLY SUCH THAT:

- THE E-BRAKE ENGAGES EASILY AND BRINGS THE SCOOTER TO A STOP.

FRAME

- CHECK THAT THE SCOOTER FRAME IS NOT DAMAGED, BENT, OR BROKEN.
- CHECK THAT THE STEM IS SECURED BY THE STEM FOLDING LATCH.

STEERING

- CHECK THAT THE WHEEL AND HANDLEBAR ARE IN ALIGNMENT.

WHEELS

- CHECK THAT WHEELS DO NOT SHOW SIGNS OF EXCESSIVE WEAR OR ARE DAMAGED.

5.2 Helmet Safety

A HELMET SHOULD BE WORN BY THE RIDER AT ALL TIMES.



PROPER POSITIONING:
THE FOREHEAD IS COVERED
BY THE HELMET.



IMPROPER POSITIONING:
THE FOREHEAD IS EXPOSED.
A FALL COULD RESULT IN SERIOUS INJURY.

*** WEAR A HELMET, APPROPRIATE CLOTHING, SHOES, AND SAFETY GEAR. AVOID CLOTHING THAT CAN GET CAUGHT INTO OR UNDER THE WHEELS. CLOSED-TOE, FLAT SHOES ARE RECOMMENDED. WEAR AN ASTM F1492 APPROVED HELMET AND PROTECTIVE GEAR TO PREVENT INJURY IN THE EVENT OF AN ACCIDENT.**

5.3 Care & Maintenance

CLEANING THE LOOMIS

TO CLEAN THE SCOOTER, CAREFULLY WIPE WITH A DAMP CLOTH AND THEN DRY WITH A DRY CLOTH. DO NOT APPLY WATER DIRECTLY TO THE SCOOTER. WATER CAN CAUSE DAMAGE TO THE ELECTRICAL SYSTEMS AND FRAME THAT COULD RESULT IN A MALFUNCTION THAT PUTS RIDER SAFETY AT RISK.

BATTERY PRECAUTIONS

- KEEP AWAY FROM FIRE AND EXCESSIVE HEAT.
- AVOID INTENSE PHYSICAL SHOCK, SEVERE VIBRATION, OR IMPACT.
- PROTECT FROM WATER OR MOISTURE.
- DO NOT DISASSEMBLE THE SCOOTER OR ITS BATTERY.
- IF THERE ARE ANY ISSUES WITH THE BATTERY, CONTACT THE JETSON CARE TEAM.

STORING THE LOOMIS

- FULLY CHARGE THE BATTERY BEFORE STORING. THE BATTERY SHOULD BE FULLY CHARGED ONCE A MONTH DURING EXTENDED PERIODS WITHOUT USE.
- COVER THE SCOOTER TO PROTECT IT AGAINST DUST.
- STORE THE SCOOTER INDOORS, IN A DRY PLACE, AND AT A TEMPERATURE OF AT LEAST 50°F.

FCC NOTE

Note: This equipment has been tested and found to comply with the limits for a Class B digital device, pursuant to Part 15 of the FCC Rules. These limits are designed to provide reasonable protection against harmful interference in a residential installation.

This equipment generates, uses and can radiate radio frequency energy and, if not installed and used in accordance with the instructions, may cause harmful interference to radio communications.

However, there is no guarantee that interference will not occur in a particular installation.

If this equipment does cause harmful interference to radio or television reception, which can be determined by turning the equipment off and on, the user is encouraged to try to correct the interference by one or more of the following measures:

- Reorient or relocate the receiving antenna.
- Increase the separation between the equipment and receiver.
- Connect the equipment into an outlet on a circuit different from that to which the receiver is connected.
- Consult the dealer or an experienced radio/TV technician for help.

Caution: Changes or modifications not expressly approved by the party responsible for compliance could void the user's authority to operate the equipment.

This equipment complies with FCC radiation exposure limits set forth for an uncontrolled environment.

This transmitter must not be co-located or operating in conjunction with any other antenna or transmitter.

Stay connected.

Be sure to follow **@ridejetson** on social media to learn about fantastic offers, giveaways, and all the latest Jetson news.



Loving your ride?

Then be sure to leave a review at ridejetson.com/reviews.
We can't wait to hear from you!

JETSON

#MakeMoves

Questions? Let us help.

ridejetson.com/support
ridejetson.com/chat

To exercise your product's warranty
or inquire about warranty
coverage, contact us directly.

1-844-585-7462

Manufactured in Huizhou, China
Imported by TruRide Tech LLC.
794 School House Road
New Castle, DE 19720

www.ridejetson.com



Made in China
Date Code: 08/2024
Document Edition: v1.0

© 2024, TruRide Tech. ALL RIGHTS RESERVED.
Manufactured for TruRide Tech LLC.

JETSON® is registered trademark used under license from JetStream Brands LLC. No portion of this package, including shape, graphics, and design, may be reproduced or transmitted in any form or by any means.