

12cm

12.5cm

38cm

# Multifunctional four-hole aroma diffuser manual

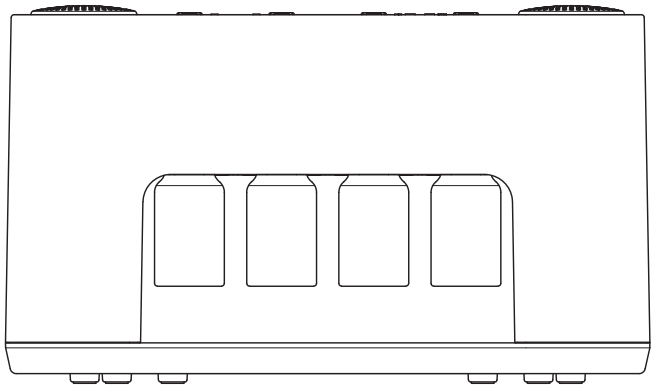

Thank you for purchasing this product.  
order to use this product better and safer, please read this instruction manual carefully before using it correctly.  
In addition, after reading this manual, please be sure to keep this manual in a safe and easy-to-access place. Please refer to it at any time if there is anything unclear.

## Indication of product functionality

### Top view

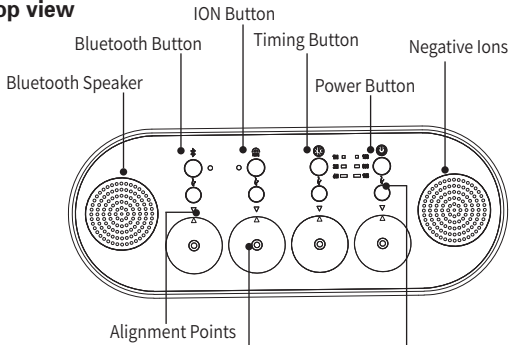

### Rear view

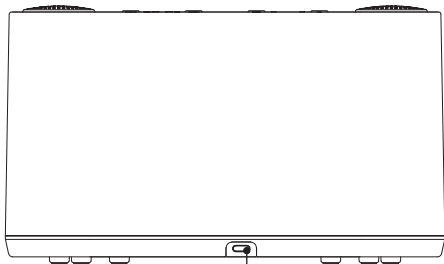

USB Port

### bottom view

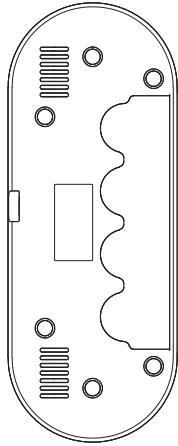

## Button usage instructions

### Power button

Press and hold the power button for 2 seconds to turn the product on/off.  
The default timer mode is 6H mode. The 1S5 light turns on and the 1# nozzle sprays.  
(The nozzle triangle symbol of 1# spray lights up or turns off accordingly.)

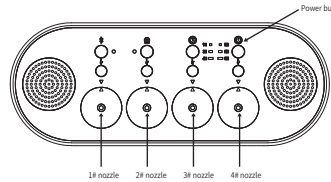

Short press the power button once to cycle through 1S5-60S-120S.  
(The spray time is 180 seconds per cycle, and the working mode of the working air pump can be switched)

### Timing button

Short press the timing button to switch the timing time 1H-3H-6H continuously  
(the timing button light is on) and so on. (This timing mode is to time the time of 4 nozzles)

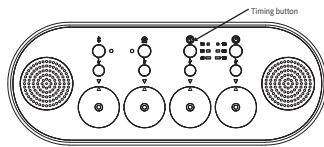

### Aroma button

Short press the 4 nozzle aromatherapy keys to turn on the corresponding nozzle spray function at the same time. Press and hold the nozzle aromatherapy button for two seconds to turn off the spray and light of the corresponding nozzle under any circumstances.  
After spraying, short press the aromatherapy button of the nozzle to turn on the seven-color light of the corresponding nozzle.  
Colorful gradient light (short press once to cycle the colorful light gradient - press once again - the colorful light sets the color until white light is selected and press again to turn off the light)

## Button usage instructions

### Bluetooth button

Short press the Bluetooth button to turn on/off Bluetooth. The Bluetooth function is not controlled by the power switch.  
(Bluetooth can be turned on/off separately as long as it is plugged in. Generally, it is turned on by default) Bluetooth can be connected to a mobile phone to play music. Bluetooth name: SZBT-025

### ION button

Short press the negative ion key to turn on/off negative ions. This function is not controlled by the power switch.  
(As long as the power is plugged in, the negative ions can be turned on/off separately.  
Generally, the negative ions are turned off by default)

## Correct way to replace essential oil bottles

Push the bottom of the essential oil bottle with your right hand and hold the nozzle with your left hand to prevent excessive force from ejecting and damaging the essential oil bottle.

The correct approach is as shown in Figure (1)

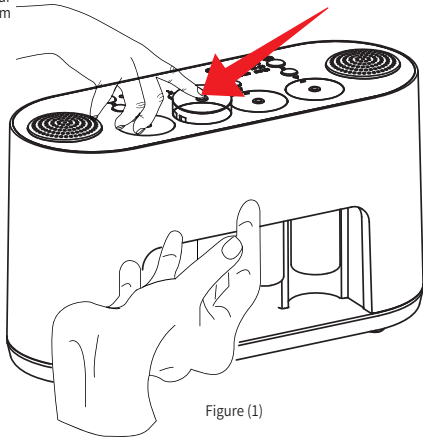

Figure (1)

## Safety Precautions

### Ensure the following items to avoid damaging the product

- Only technicians can modify, disassemble, or repair this product. Consult with the dealer where you purchased it or our company's repair center.
- Do not intentionally pierce, twist, or stretch the machine's adapter cords. Do not place the cords in high-temperature areas or under heavy objects. Avoid using clamps on or repairing the power cords.
- If the USB cord is damaged or the socket is loose, please stop using it.
- Always use the provided USB cable. Using cables other than the provided one may cause fires due to overheating.
- Do not immerse the USB cord in water or use it in damp places like bathrooms, dressing rooms, or greenhouses.
- To ensure the machine operates correctly, if excess essential oil is visible at the misting outlet, wipe it clean with an alcohol swab or cloth.
- Aroma oils may cause staining. If accidentally spilled, immediately wipe with a cloth.
- Use only 100% pure essential oils when replacing them.
- Do not let the mist spray directly onto furniture, clothing, walls, etc.
- Avoid placing in direct sunlight, near air conditioners, fans, or in high-temperature areas.
- Place on a flat surface and avoid setting it on carpets, mats, or unstable places.
- Do not place near other appliances like TVs or audio devices.
- Do not cover the product, as this may cause water accumulation inside and damage it.
- If not using the product for an extended period, remove the essential oil bottle, pour out any excess oil, and store it properly.
- Only use 100% essential oils.
- After installing the essential oil, do not flip or tilt the product.
- Different types of essential oils will produce varying misting effects. (It is recommended to use oily essential oils.)
- Avoid touching the product with wet hands to prevent electric shock.
- Do not place the product where children or pets can reach.
- This product is not suitable for use by children or individuals unfamiliar with the product.

## Reasons for Malfunction

When the aroma diffuser does not operate correctly, please consider the following situations:

If you suspect a malfunction with this product, please check the following points before requesting repair from us:	
Why does it fail to start or shut down?	<ul style="list-style-type: none"><li>Check if the charging head, charging cable, and machine are connected properly and not loose.</li><li>Please use a DC5V2A charging cable that has passed 3C certification.</li></ul>
No mist or abnormal misting?	<ul style="list-style-type: none"><li>For machines that use oil diffusion without water, using essential oils that are too thick or have a high water content can prevent misting.</li><li>The machine atomizes essential oils into nano-sized molecules. The light and angle can affect the visual perception of mist quantity.</li><li>You can shine a light above the misting outlet to observe.</li><li>Press the misting outlet with your hand to feel for pressure.</li></ul>
Why is the aroma machine leaking oil?	<ul style="list-style-type: none"><li>Tighten the bottle and nozzle.</li><li>The machine should not be inverted or tilted for extended periods. Do not move the machine when it contains oil. If relocation is necessary, remove the oil and store it separately.</li></ul>
The machine produces a faint mist?	<ul style="list-style-type: none"><li>The light and angle affect the visual perception of the mist quantity. Ensure the nozzle is in the same plane as the panel when inserting.</li></ul>

### Specifications

Dimensions:	231*89*135mm
Weight:	960g
Power input/output:	DC5V/1A
Power cord length:	about 100cm
Power:	≤5W
Essential oil capacity:	10ml * 4
Charging interface:	Type-c
Accessories:	Instruction manual*1 Data cable*1

FCC Warning:

This equipment has been tested and found to comply with the limits for a Class B digital device, pursuant to part 15 of the FCC Rules. These limits are designed to provide reasonable protection against harmful interference in a residential installation. This equipment generates, uses and can radiate radio frequency energy and, if not installed and used in accordance with the instructions, may cause harmful interference to radio communications. However, there is no guarantee that interference will not occur in a particular installation. If this equipment does cause harmful interference to radio or television reception, which can be determined by turning the equipment off and on, the user is encouraged to try to correct the interference by one or more of the following measures:

- Reorient or relocate the receiving antenna.
- Increase the separation between the equipment and receiver.
- Connect the equipment into an outlet on a circuit different from that to which the receiver is connected.
- Consult the dealer or an experienced radio/TV technician for help.

Caution: Any changes or modifications to this device not explicitly approved by manufacturer could void your authority to operate this equipment.

This device complies with part 15 of the FCC Rules. Operation is subject to the following two conditions:

(1) This device may not cause harmful interference, and (2) this device must accept any interference received, including interference that may cause undesired operation.

This equipment complies with FCC radiation exposure limits set forth for an uncontrolled environment. This equipment should be installed and operated with minimum distance 0cm between the radiator and your body.