



V20

FCC Caution:
This device complies with part 15 of the FCC Rules. Operation is subject to the following two conditions: (1) This device may not cause harmful interference, and (2) this device must accept any interference received, including interference that may cause undesired operation.
Any changes or modifications not expressly approved by the party responsible for compliance could void the user's authority to operate the equipment.
NOTE: This equipment has been tested and found to comply with the limits for a Class B digital device, pursuant to Part 15 of the FCC Rules. These limits are designed to provide reasonable protection against harmful interference in a residential installation. This equipment generates, uses and can radiate radio frequency energy and, if not installed and used in accordance with the instructions, may cause harmful interference to radio communications. However, there is no guarantee that interference will not occur in a particular installation.
If this equipment does cause harmful interference to radio or television reception, which can be determined by turning the equipment off and on, the user is encouraged to try to correct the interference by one or more of the following measures:
— Reorient or relocate the receiving antenna.
— Increase the separation between the equipment and receiver.
— Connect the equipment into an outlet on a circuit different from that to which the receiver is connected.
— Consult the dealer or an experienced radio/TV technician for help.
The device has been evaluated to meet general RF exposure requirement. The device can be used in portable exposure condition without restriction.

OPERATION GUIDE

1.Basic parameters

English

Product model: V20
Bluetooth name: V20
Battery parameters: 3.7V 2000mAh (fast charging not supported, please connect to computer for charging)
Input: 5V 1A
Connection modes: Bluetooth connection (5.0), 2.4G connection
Wireless version: 2.4G, BLE 5.0
Wireless connection distance: 10 meters (in unobstructed open environments)
Charging port: Type-C
Supporting systems: Windows MacOS. iOS. Android

- 1 knob
- 2 Multifunctional buttons
- 3 Num/Caps/battery indicator light
- 4 Type-C interface
- 5 2.4G receiver storage area
- 6 Power switch ON/OFF

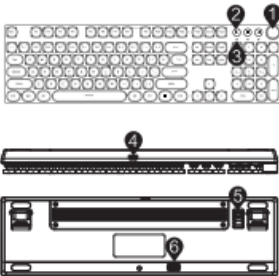

-1-

2.Sleep mechanism

In wireless mode connection mode, if there is no operation status, the backlight will turn off after five minutes, and the keyboard is still in working mode. If any key is triggered, the backlight will light up in a timely manner; After 30 minutes of inactivity, enter deep sleep mode.

3.Power indicator

Low voltage 3.3V low voltage alarm off backlight, indicator light fast, 3.0V shutdown, blue breathing battery indicator light during charging, green constant on battery indicator light when fully charged. Keyboard charging: Connect the DC 5V/1A power adapter and keyboard through the Type-C charging cable standard on the keyboard.

4.Lighting settings

Press and hold FN+ESC for three seconds to restore factory settings

FN+INS key to switch lighting effects:

Constant light mode, pointing the river and mountains, breathing mode, pressing and extinguishing, following the flowDripping ripples, flowing light and colors, catering to both directions, eye-catching highlights, ready to explode at a single touch Stepping on snow without leaving a trace, button ripples, blooming flowers for wealth and prosperity, running errand effect, spinning stormRay flow light, starry dots, interweaving and running, oblique pulling and changing, sinusoidal light waves

FN+6-8 game lighting modes:

FN+6=(Car Race) A S D W R ↑ ↓ ← → Ctrl Shift Alt light up

FN+7=(NBA) A F S W R E Ctrl Shift Alt Space ↑ ↓ ← → Z X C V 1234 on

FN+8=(LOL simple) Q W E R D F B J-G lit

FN+← Slow down light speed FN+→ Speed up light

FN+↑ Brightness increases FN+↓ Brightness decreases

Custom mode button recording storage lighting mode:

FN+END=Record key/Store key

After entering the corresponding custom mode by pressing FN+9 or FN+0, press FN+END to enter the custom point color recording state. The indicator light flashes, and press any key that needs to be turned on or off to the specified state. After completing the setting, press FN+END to store the indicator light normally.

-2-

6.Connection method

2.4G connection

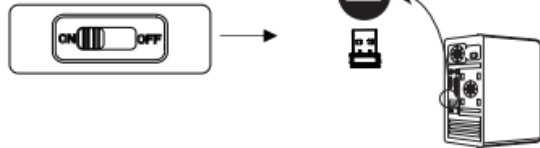

2.4G mode: Insert a dedicated receiver that has been paired with the code, and turn the switch to the "ON" position, FN+4 enables 2.4G mode, and the keyboard can be used normally.

Bluetooth connectivity

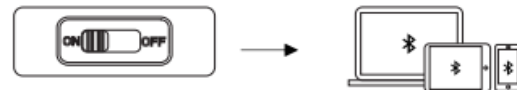

BT Name (V20)

Bluetooth mode: Turn the switch to the "ON" position,

There are three Bluetooth channels in total:

FN+1: Bluetooth 1 FN+2: Bluetooth 2 FN+3: Bluetooth 3.

Turn on Bluetooth pairing on the device, and the keyboard can be used normally.

-4-

Wired connection

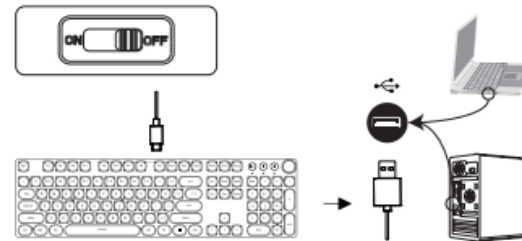

Wired mode: First, plug the connection cable into the TYPE-C interface, and then connect the other end to the computer. Turn the switch to the "OFF" position, and FN+5 will turn on wired mode. The keyboard can be used normally.

7. List of items

1. A keyboard
2. One TYPE-C line
3. 2.4G receiver
4. One instruction manual



V20 keyboard



TYPE-C charging
connection cable



2.4G receiver



Manufacturer: Jiangxi Jishi Technology Co., Ltd.
Building 5, Godfrey Industrial Park, Lubao Avenue, Qingyuan District, Jion City, Jiangxi Province
Contact number: 0794-3388616
Website: www.jishi.cn
Product execution standard number: Mouse GB/T 2024-2010
Attention: The product images are for reference only and may differ from the actual product.
Please refer to the actual product. We apologize for any inconvenience caused.

-5-