

T10 User Manual

Tag Wireless Charger

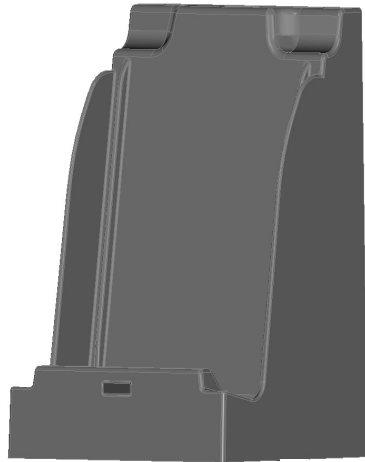

How to USE

1. Connect 12V, 1A power to the 2 ports on the bottom of the product
(Caution: When using the product, 12V, 1A power and USB C type power should not be connected at the same time)
2. The power turns on and the yellow LED indicator blinks approximately 3 to 5 times.
3. Place the tag device you want to charge on the high-speed wireless charging stand.
4. When wireless charging is activated, the red charging/charging complete green LED lights up

Foreign Object Detection(F.O.D) Foreign object detection mode

When the red LED blinks, a foreign object has been detected.
Remove foreign substances (foreign substances: metal, credit cards, other strongly magnetic substances)

T10 User Manual

Parts Components

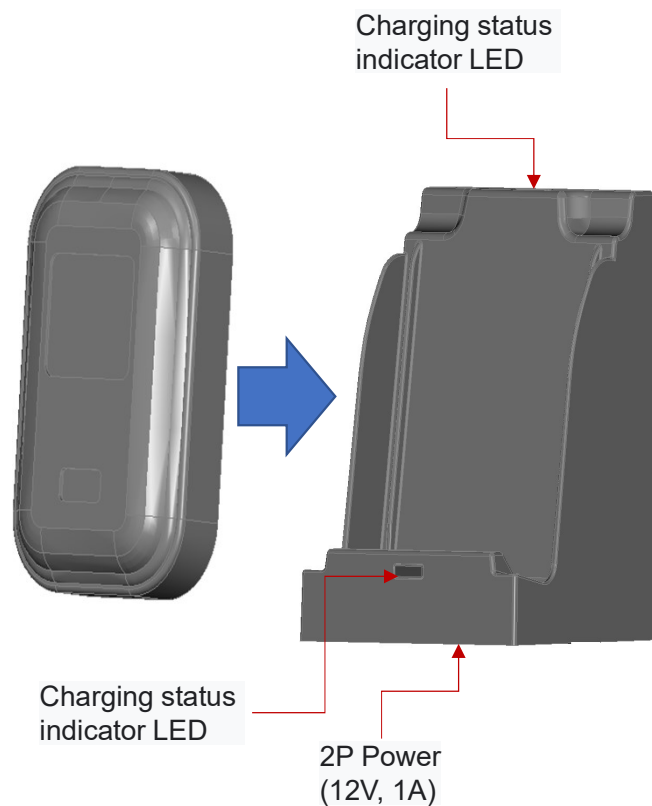

Safety rules

Do not leave the product in a wet place or near fire or high heat where there is a risk of fire.

Do not apply strong shock or pressure to the product.

Be careful not to let any foreign matter enter the product terminal except for the purpose of connecting the charging power.

The product may generate a slight amount of heat during charging, but this is a normal charging process.

To maintain the product, do not use alcohol-based detergent or water.

Do not use products with strong magnetism magnets, metal, credit cards, etc.) close to them

Do not store the product in low or high temperatures and high humidity.

Do not disassemble, modify, or assemble the product arbitrarily

If the product is damaged by intentionally applying physical force to the product, you will not be eligible for quality warranty service.



WARNING: To prevent electrical shock, do not remove covers. Refer all servicing to qualified personnel.

ATTENTION: Pour éviter les chocs électriques, ne retirez pas les couvercles. Renvoyer tous les services à un personnel qualifié.

T10 User Manual

FCC COMPLIANCE

This device complies with part 15 of the FCC Rules. Operation is subject to the following two conditions:

(1) This device may not cause harmful interference, and (2) this device must accept any interference received, including interference that may cause undesired operation.

CAUTION : Changes or modifications not expressly approved by the party responsible for compliance could void the user's authority to operate the equipment.

RF Radiation Exposure Statement:

This equipment complies with FCC radiation exposure limits set forth for an uncontrolled environment and meets the FCC radio frequency (RF) Exposure Guidelines as this equipment has very low levels of RF energy. This transmitter must not be co-located or operating in conjunction with any other antenna or transmitter.