

Bt35 helmet Bluetooth headset

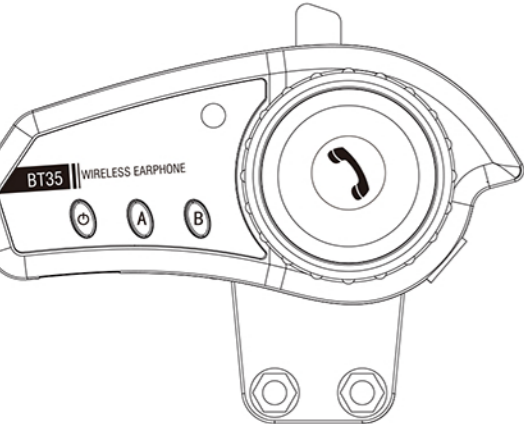

an instruction manual

FCC STATEMENT

1. This device complies with Part 15 of the FCC Rules. Operation is subject to the following two conditions:
 (1) This device may not cause harmful interference.
 (2) This device must accept any interference received, including interference that may cause undesired operation.
 2. Changes or modifications not expressly approved by the party responsible for compliance could void the user's authority to operate the equipment.
 NOTE: This equipment has been tested and found to comply with the limits for a Class B digital device, pursuant to Part 15 of the FCC Rules. These limits are designed to provide reasonable protection against harmful interference in a residential installation. This equipment generates uses and can radiate radio frequency energy and, if not installed and used in accordance with the instructions, may cause harmful interference to radio communications. However, there is no guarantee that interference will not occur in a particular installation. If this equipment does cause harmful interference to radio or television reception, which can be determined by turning the equipment off and on, the user is encouraged to try to correct the interference by one or more of the following measures:
 Reorient or relocate the receiving antenna.
 Increase the separation between the equipment and receiver.
 Connect the equipment into an outlet on a circuit different from that to which the Consult the dealer or an experienced radio/TV technician for help.
 RF warning statement
 The device has been evaluated to meet general RF exposure requirement, The device can be used in portable exposure condition without restriction.

Welcome to use this helmet Bluetooth headset. I hope you can read this manual carefully to make it easier to operate and install.

Product introduction

This product uses the latest 5.0 Bluetooth chip imported from the UK, and uses Bluetooth technology, stereo and strong. Ultra-strong signal transmission, ultra-low power consumption, and support for all Bluetooth devices, the automatic answering function of incoming calls, no longer need to answer calls manually, safe and fast. Use 30 strong magnetic high-quality speakers.

Power on/off:

Press the power-on button ** for two to three seconds to start the machine. At this time, the indicator light will flash alternately red and blue, and it is in the power-on state. When you turn off the machine, you can press the power on symbol key ** for two to three seconds. There will be a prompt tone and the light will not light up after the machine is turned off.

How to switch between Chinese and English voice:

After power-on, the indicator light flashes red and blue alternately. Do not connect with the mobile phone at this time. Press the ** power-on button twice in succession, and switch between Chinese and English voice.

Connect two mobile phones at the same time:

After the Bluetooth headset is turned on, connect with the mobile phone A first, then turn off the Bluetooth of the mobile phone A, and then turn on the Bluetooth of the mobile phone B, and then connect two mobile phones at the same time.

one

How to connect with mobile phone:

After power-on, the indicator light flashes red and blue alternately. At this time, turn on the Bluetooth device on the mobile phone, search for the Bluetooth device on the mobile phone, and find the "BT35" point to connect for a few seconds. Once connected, the next time you use it, the phone Bluetooth and Bluetooth headset will be automatically connected when both are turned on.

Volume up/down/song switching:

Multi-function knob, turn it forward to make the previous song, turn it backward to make the next song, turn it forward to make the volume decrease, and turn it backward to make the volume increase. Press the middle phone symbol ** to pause playback.

Switch between automatic answering and non-automatic answering

When the music pauses, press the "B" key for two seconds and hear a thud, which proves that it has been switched over.

Turn on the night atmosphere light effect

After the product is powered on, press the power button once to turn on the night atmosphere light. At this time, the atmosphere light will be on for a long time. Each press can switch the effect of different colors of the atmosphere light, a total of five color modes.

Answer the phone:

Incoming calls will be answered automatically or manually by pressing the telephone symbol **.

two

Product charging:

The low power of the product will give a voice prompt for charging, which can be fully charged for 5-6 hours. The red light will be on when charging, and the red light will be off when charging.

Package content:

1. A helmet Bluetooth headset.
2. One charging line
3. A manual.
4. Two spare surgical stickers.
5. One spare cotton.
6. A pair of accessories and screws shall be used for installing the thickened helmet.

Product parameters:

1. Bluetooth version: V5.0+EDR
2. Frequency range: 2.402 GHz - 2.480GHz
3. Transmission distance: above 10M
4. MC distance: ≤ 1m
5. Lithium battery: 3.7V/800mA
6. Charging time: 5-7 hours
7. Standby time: about 280 hours
8. Continuous working time: about 30 hours
9. Bluetooth name: BT35

three

Equipment appearance and function introduction:

Figure 1

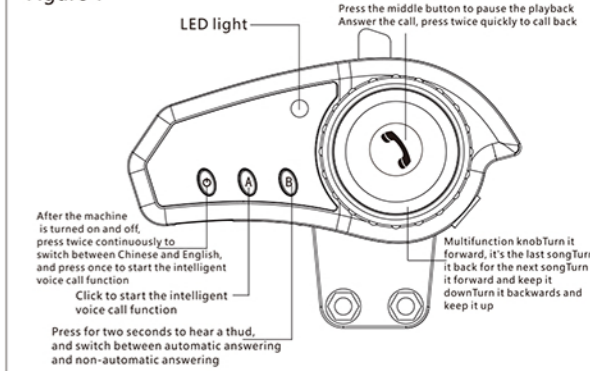
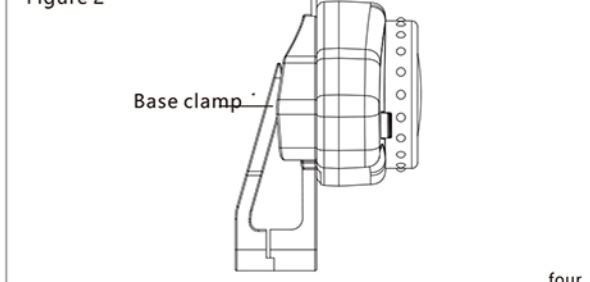
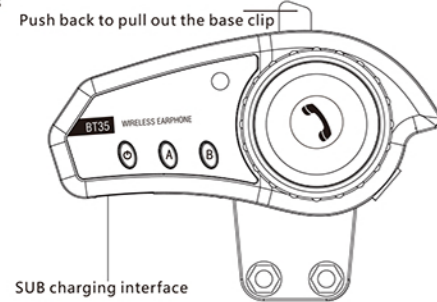

Figure 2



four

Figure 3



SUB charging interface

Bluetooth pairing search device:

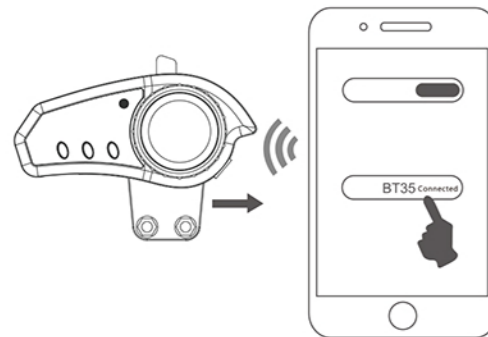

five

Figure 4:

Product host and speaker line group



Upgraded to 3.5 audio interface rugged

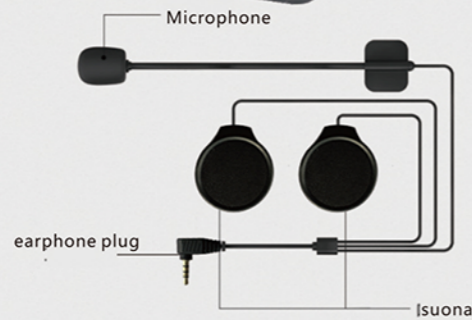

seven

Installation effect:



Figure 1:

Figure 2:



eight



Installation of left horn:
Spare wool round velcro tape, tear off white release paper



Installation of right horn:
Spare round velcro with rough surface tear the white release paper,



See the left figure for installation. The horn is close to the ear, and the microphone rod is installed at a suitable position

nine



Spare round velcro with rough surface, tear off the white release paper, and stick the horn at the correct position



The left and right horn connecting wires are hidden in the interior.

ten

It can be used for the following products:

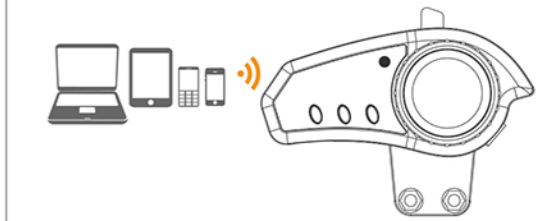

Applicable to the following helmets



Precautions for use of helmet Bluetooth headset

1. In order to protect your eardrum and hearing, do not turn the volume to the maximum
2. Don't listen to music continuously for a long time.
3. Try to avoid collision.
4. Dust prevention, fire prevention and moisture prevention.
- 5 Remember to fully charge before using when going out.



eleven